

L005N User Manual

Contents

Safety Instructions	01
Notice	03
Package List	04
Overview	05
Remote Control.....	06
Power On/Off	07
Focus	08
Getting Started	09
Projector Installation / Technology Features.....	10
Settings	11
Smart Key	16
Source	17
Questions & Answers	18

Safety Instructions

Read all instructions before you use this device. Do not make any changes or create settings that are not described in this manual. If physical damage, loss of data or damage is caused by failure to follow instructions, the warranty does not apply.

Setup

1. To reduce the risk of fire or electric shock, do not expose the device to rain or moisture. Objects filled with liquids, such as vases, should not be placed on this device.
2. Do not place this device on soft surfaces such as tablecloths or carpets, otherwise the device could be a fire hazard.
3. Do not place this device in areas susceptible to excessive dust and dirt or near any appliance generating a strong magnetic field.
4. To prevent overheating, do not block or clog the ventilation holes.
5. Never place this device in a confined space. Always leave enough space around this device for ventilation.
6. Protect this device from overexposure to direct sunlight, heat, large temperature fluctuations and moisture. Avoid extreme temperatures. The suitable operations and storage temperature for this device and its accessories is (0°F to 95°F).
7. When this device is running for a long period of time, the surface may become hot. Shut it down immediately and unplug the charger. Resume operation after this device has cooled down.
8. Always handle this device with care. Avoid touching the lens. Do not allow children to handle the device without supervision.
9. Never place heavy or sharp objects on this device.
10. To avoid electric shock, do not disassemble the device.
11. Use attachments or accessories specified by the manufacturer only.
12. Avoid extreme vibration as it may damage the internal components.

The following safety instructions ensure the long service life of the projector to avoid fire or electric shock. Please read carefully and pay attention to the following warnings.

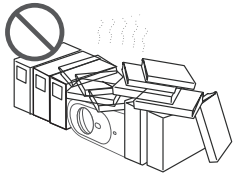

Don't install the projector in sites with improper ventilation.

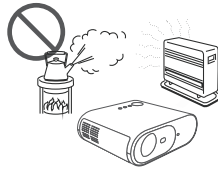

Don't install the projector in hot and humid sites.

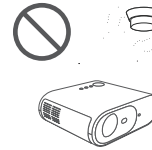

Don't install the projector near the temperature and smoke transducer. It may cause a sensor failure.

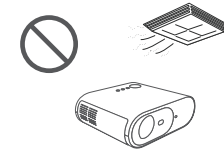

Don't install the projector in sites with direct blowing of warm and cool air-condition wind.



Don't cover the projector ventilation holes with any material.



Don't install the projector in dust and smoke sites.

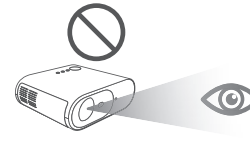

Don't look into the lens when the projector is working, otherwise it may hurt your eyes.



Please keep the projector away from water or any other liquid as it is not waterproof.

Notice

- (1) Please use the power cable with caution to avoid unduly bending. A damaged power cable may cause electric shock.
- (2) Please use the projector with caution to avoid dropping or shocking, which may damage the internal components.
- (3) Please use the same power voltage as marked on the projector.
- (4) Please use the projector in a dark room for the best results.
- (5) Please do not disassemble the projector by yourself, otherwise the warranty will be void.
- (6) Please turn off and unplug from the power supply if not using the projector for a long time.

Package List

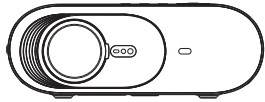

Projector × 1



Remote Control × 1
(Batteries are not included)

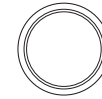

Lens Cover × 1

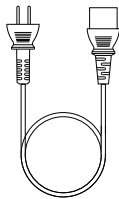

Power Cable × 1

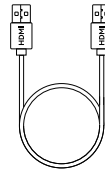

HDMI Cable × 1

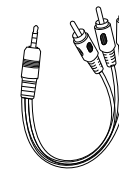

AV Cable × 1



Screw Stand × 1

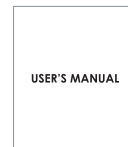

Projector User Manual × 1

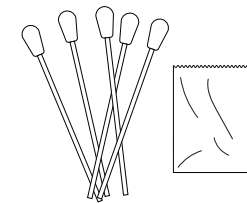

Clean Tool × 1

Overview

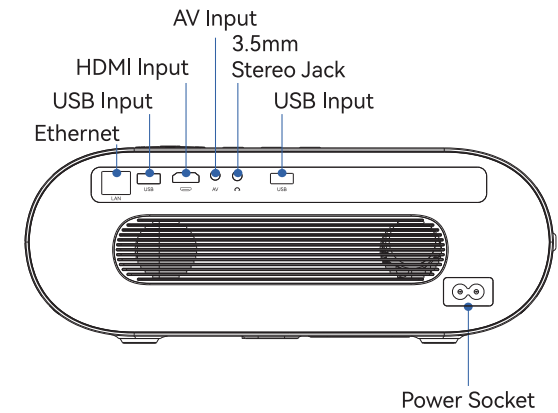
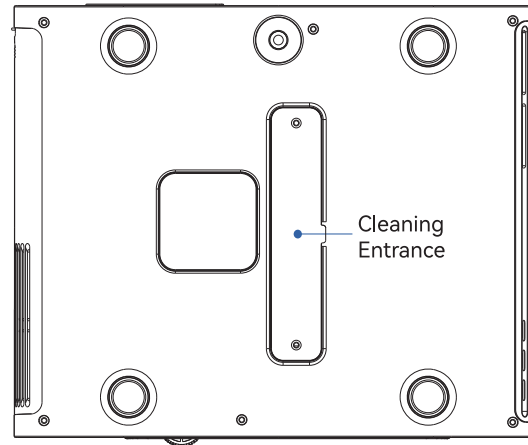
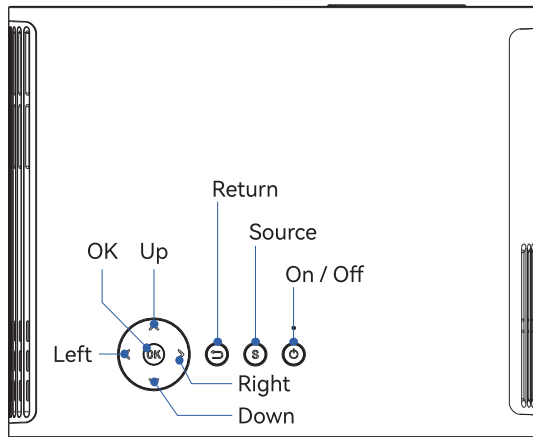

Tips:

1. Blurry Image

- * Slightly correct the keystone to rectangle.
- * Press the focus button on remote control to get the best clarity.
- * Slightly swing the angle of the machine to autofocus.
- * Go to Settings - More Settings - Lens - Autofocus Settings to set Automatically Refocus When Moved or Power-on Autofocus.

2. Mounting Hole

Adopting a single mounting hole dual-use design, the projector is compatible with the standard camera tripod and 1/4 inch screw projector tripod stand. Meanwhile, you can rotate 360° the screw to meet different projection angle needs.

Remote Control

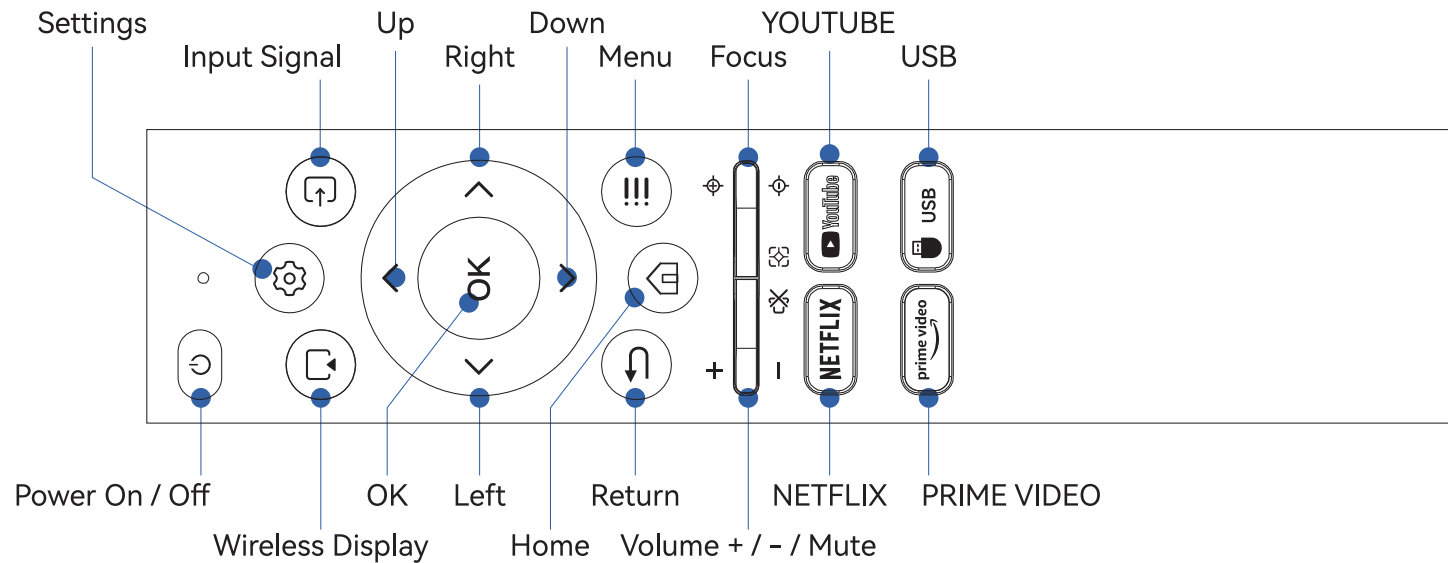

Attention:

1. Do not submerge the remote control in the water.
2. Do not put the remote control near fire or in wet or hot places.
3. Do not use old and new batteries together in the remote control.
4. Please take the batteries out if not using the remote control for a long time to avoid battery leakage.
5. Please point the remote control toward the IR receiver.
6. Please use the remote control within 6 meters distance and 30 degree angle.

Power On/Off

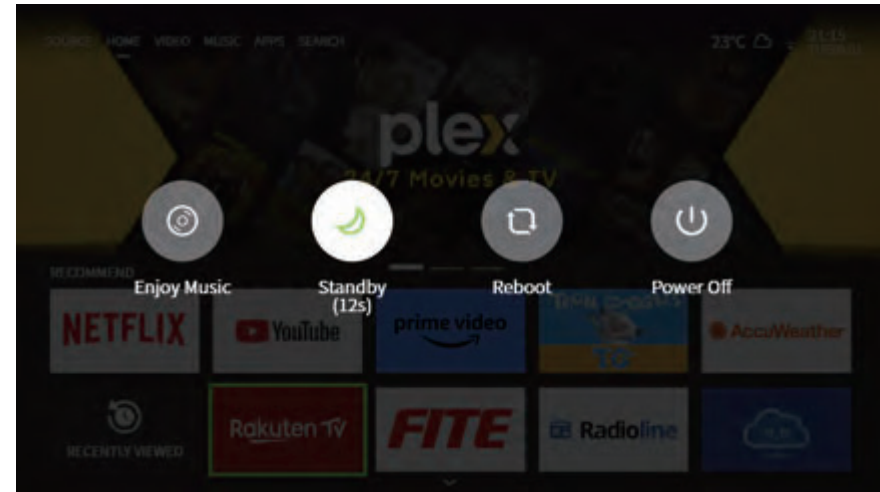
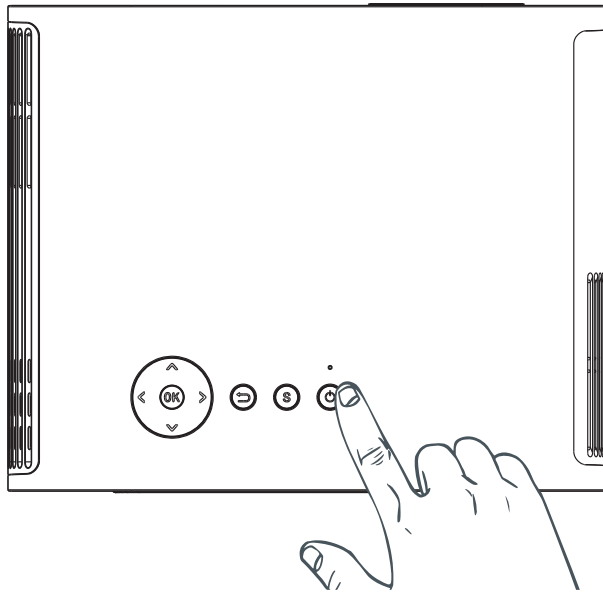

1. Power on: When the projector is power-off, plug the power cable, press the power button on the projector or the remote control to power on.
2. Power off / Reboot / Standby: When the projector is power-on, press the power button on the projector or the remote control to power off / reboot / standby.

Focus

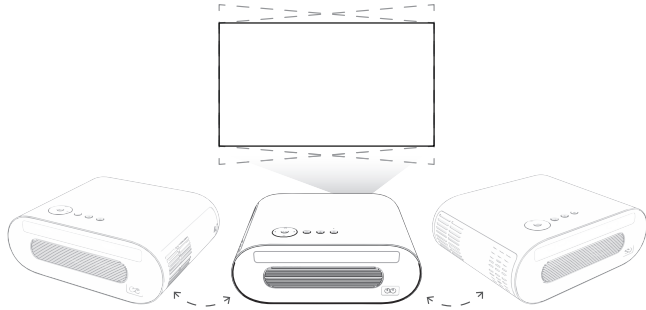

1. Auto Focus:

Go to Settings - More Settings - Lens - Autofocus Settings to enable Automatically Refocus When Moved, slightly swing the angle of the machine to autofocus.

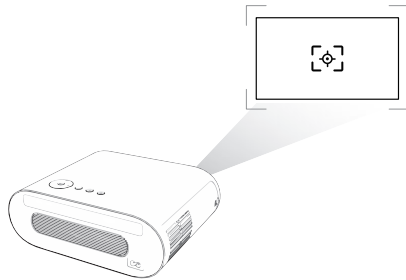

2. Auto Focus:

Go to Settings - More Settings - Lens - Autofocus Settings to enable Power-on Autofocus, it will autofocus to keep image clear when it is power-on.

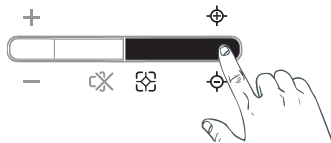

3. Manual focus:

Press the focus button on the remote control to adjust focus.

Getting Started

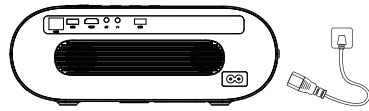

1. Plug the power cable to the projector.

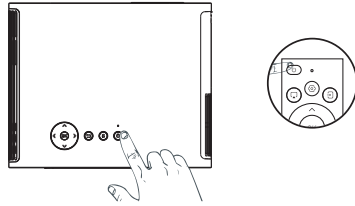

2. Press power button to turn on the projector.

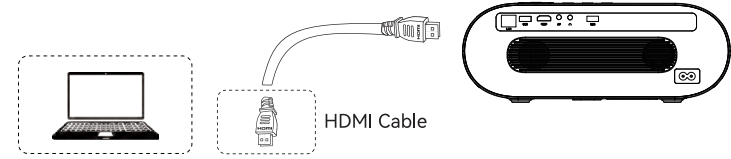

3. Connect projector to HDMI port support device.

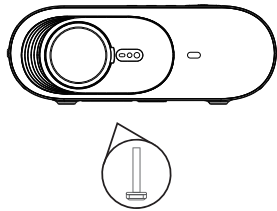

4. Adjust here accordingly.

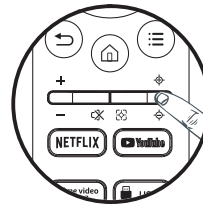

5. Use the manual focus by pressing the "Focus" button on the remote control.

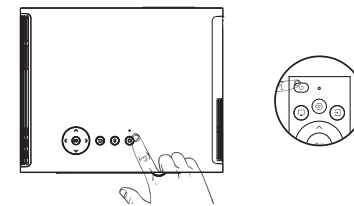

6. Press the power button to turn off the projector.

Tips:

Make sure the projector is horizontal to the projector screen.

Projector Installation

Technology Features

Place your projector on the ceiling

1. When installing the projector on the ceiling, please purchase a projector bracket recommended by an installation professional and follow the instructions supplied with the bracket.
2. Before installing the projector on the ceiling, please check if the mounting structure can support the weight of the projector and the bracket. If in doubt, please consult the advice of an installation.

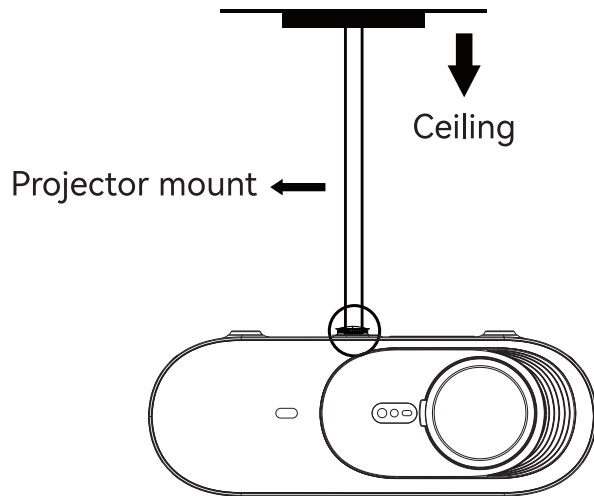

Fixed Hanger Screw Hole Type: 1/4 inch.
 NOTE: Projector bracket and screw(s) are not included.

a. Parameters

Imaging technology	TFT LCD	Aspect ratio	16:9
Resolution	1920×1080	Focus mode	Electrical Focus Autofocus
Maximum compatible resolution	1920×1080, 4K	Power input	100-240V~ 50/60Hz 2.5A
Light	LED	Output	Earphone
Input	AV×1 / USB×2 / HDMI×1 / Ethernet×1	Speaker	8W×1
		Unit size	300×245×107mm
Projection ratio	1.5:1	Net weight	2650g

b. Projection Distance and Screen Size Recommended Projection Distance: 39-90 inches

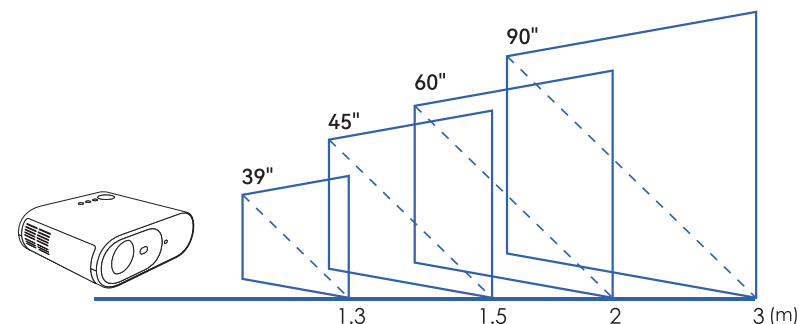

NOTE: Because the optical device has about 3% error, the above data is for reference only, please install the projector according to the actual measurement.

Settings

Press the Settings button on the remote control to choose settings options.

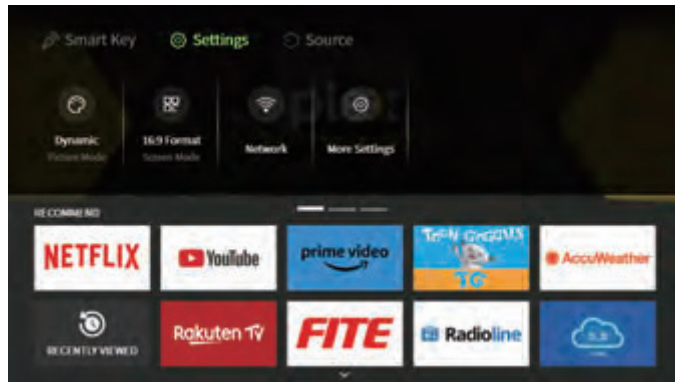

Screen Mode

Settings – Screen Mode > To select different screen size when use HDMI function.

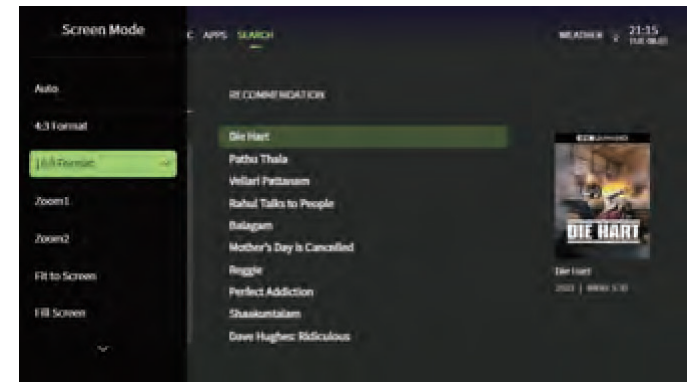

Picture Mode

Settings – Picture Mode > To select different picture mode according to what you need.



Picture

Settings – More Settings – Picture > To set the display parameter, such as color enhancement, color temperature and dynamic contrast.

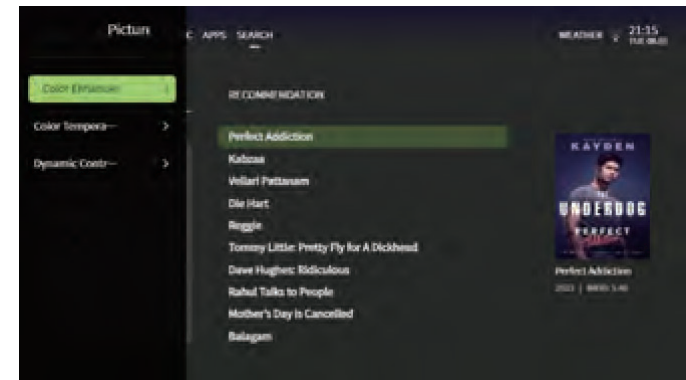

Settings

Sound

Settings – More Settings – Sound > To set function control of audio input, such as audio out, SPDIF type, SPDIF delay, audio delay and audio volume control.

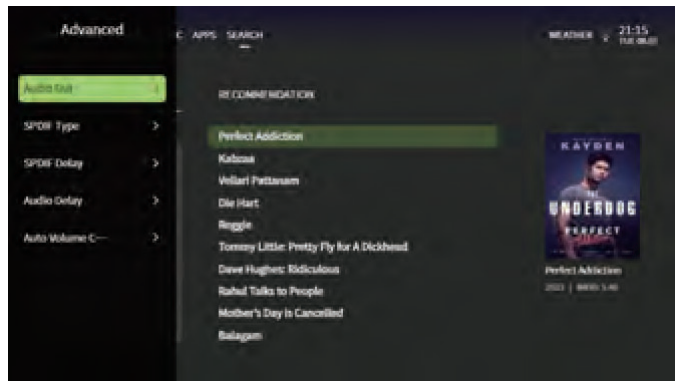

Network

Settings – More Settings – Network > To set the internet connection, wireless connection, wired connection and more network settings.

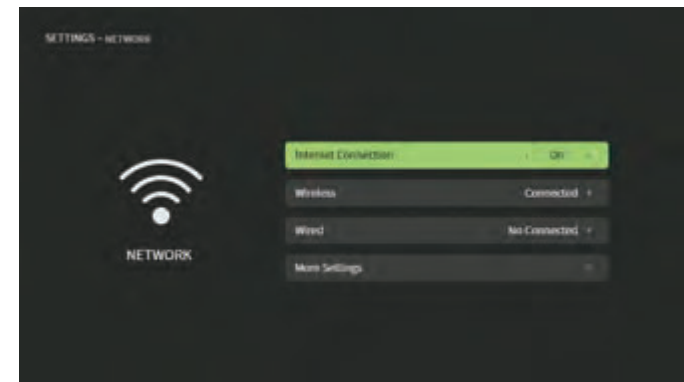

Bluetooth

Settings – More Settings – Bluetooth > Turn on the Bluetooth function, click “Search Bluetooth Device”, the projector will refresh and search devices. Find your Bluetooth device to pair.

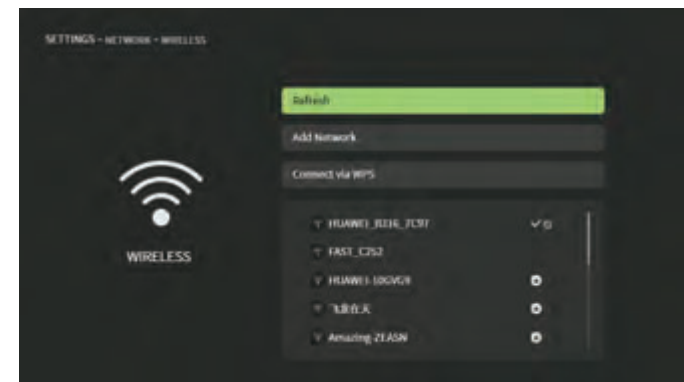
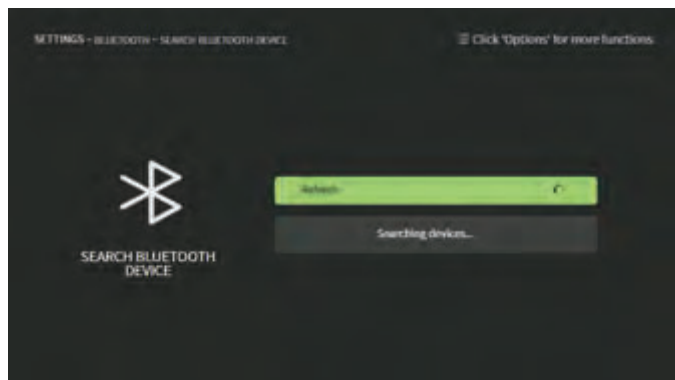

Settings

System

Settings - More Settings - System > To set language, input source, clock, auto standby, screen saver, location.

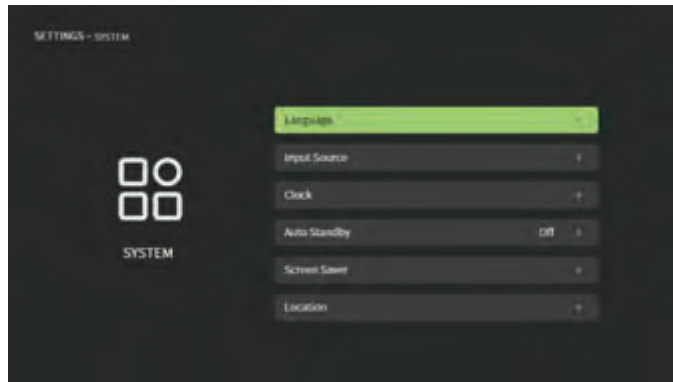

Lens

Settings - More Settings - Lens > To set projection direction, autofocus, keystone correction, digital zoom, smart recognition.

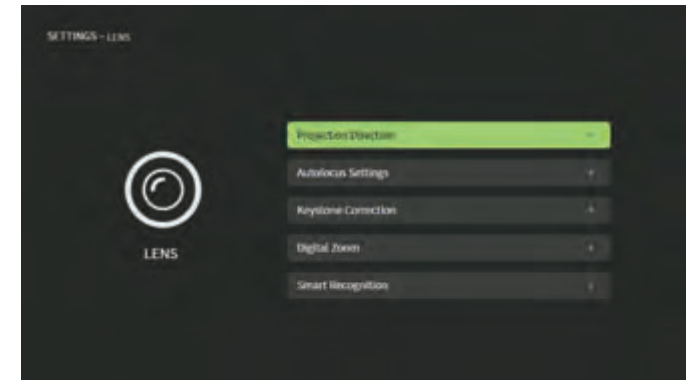

Connectivity

Settings - More Settings - Connectivity > To enable the HDMI-CEC function and set USB keyboard options.

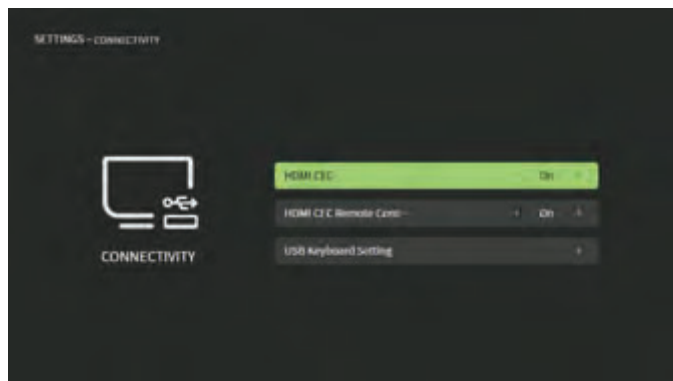

Projection Direction

Projection Direction > Four directions are available < Front, Rear, Ceiling Front, Ceiling Rear >.

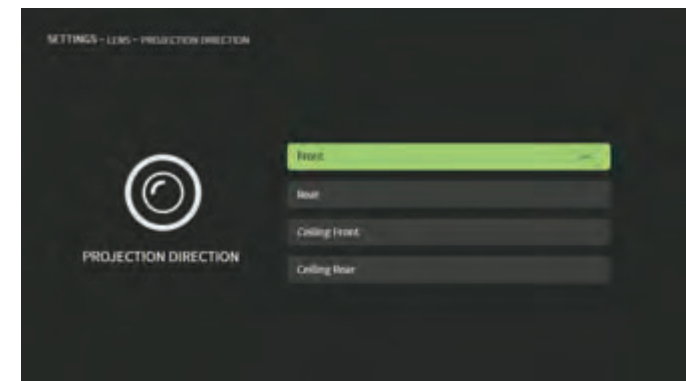

Settings

Autofocus

Autofocus Settings > Two modes are available <Automatically Refocus When Moved, Power-on Autofocus>.

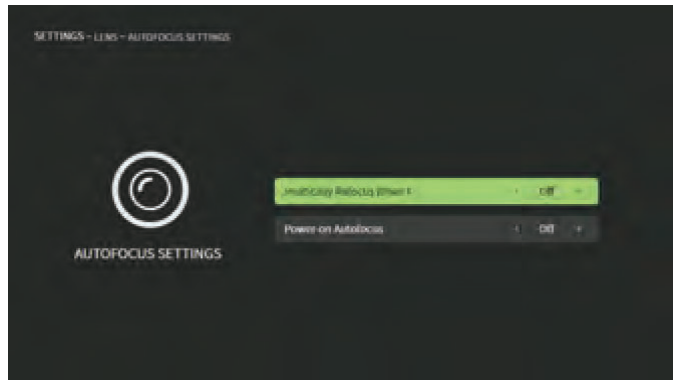

Digital Zoom

Digital Zoom > Use Up / Down keys to adjust screen size.

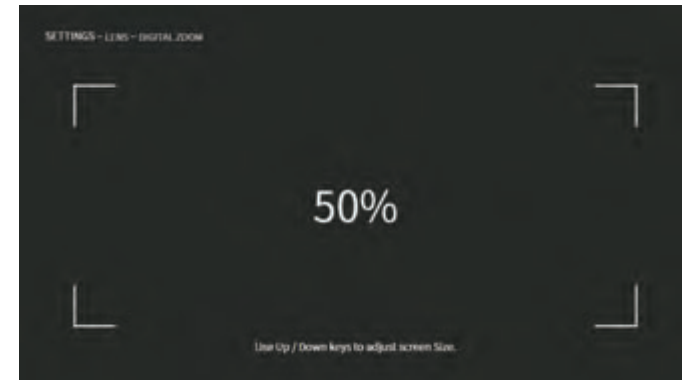

Keystone Correction

Keystone Correction > Two modes are available < Auto Keystone Correction, 4-Corner Correction>.



About Projector

Settings - More Settings - About Projector > To check the product information, update system and restore to default.

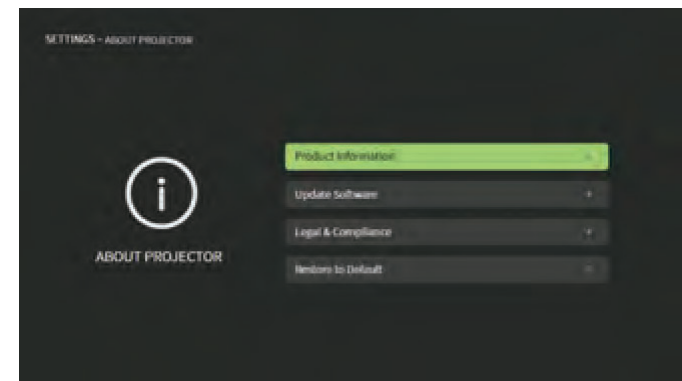

Settings

Product Information

Product Information > To check the software system parameters of the projector.

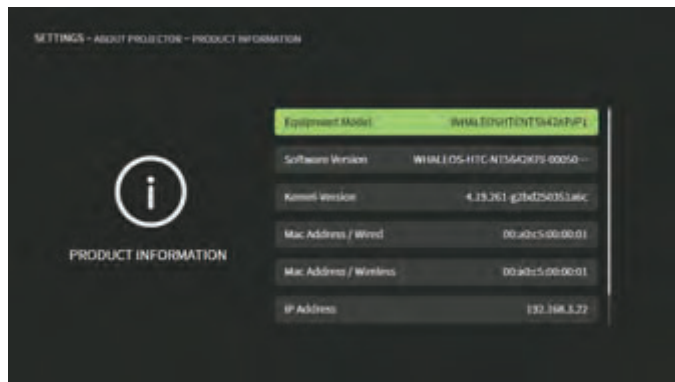

Update Software

Update Software > To check the version update status and upgrade the latest version.

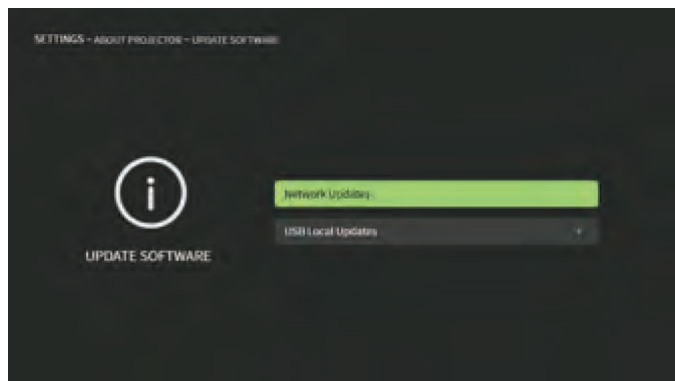

Restore To Default

Restore To Default > Two options are available <Restore Factory Settings, Reset System Settings>.

If select Restore Factory Settings, the system will reset and the user data on the projector will be cleared. If select the Reset System Settings, the picture and sound mode settings will be restored.

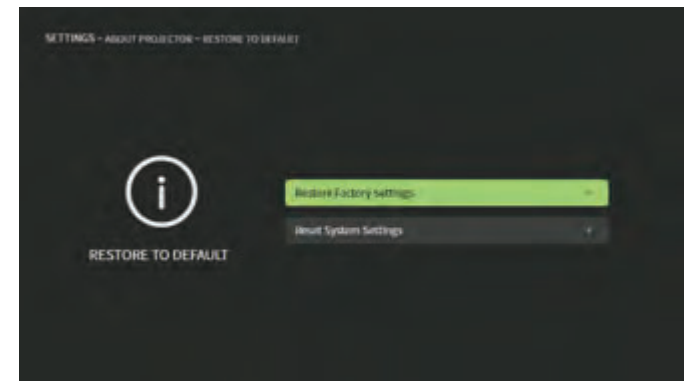

Smart Key

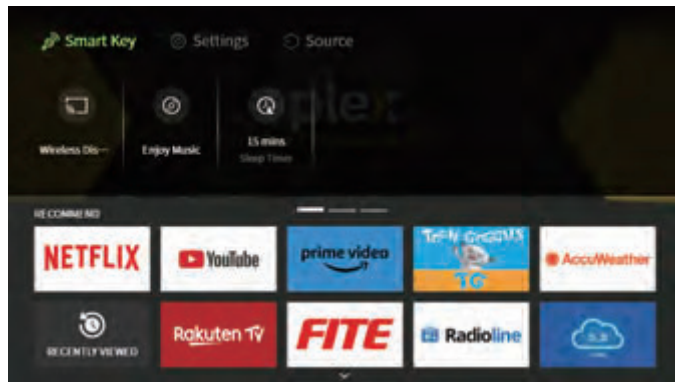

Enjoy Music

Smart Key - Enjoy Music > When using the projector to play audio, turn on this function, the screen will sleep, but you can adjust the volume to enjoy the music.



Wireless Display

Smart Key - Wireless Display > Enter the wireless display, connect the Android device and projector to the same network, then click "Start Wireless Display", find the projector name on the Android device and connect.

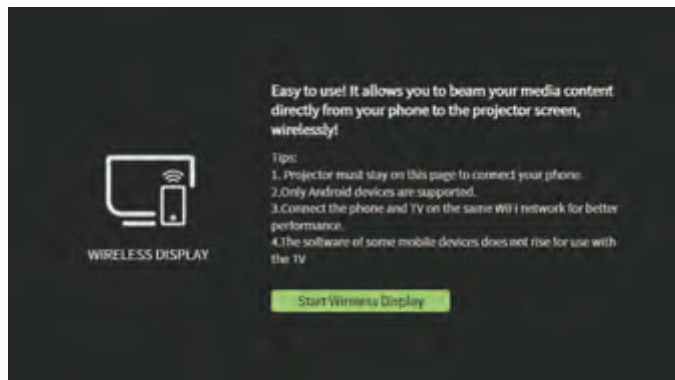

Sleep Timer

Smart Key - Sleep Timer > To set the automatic standby time of the projector.

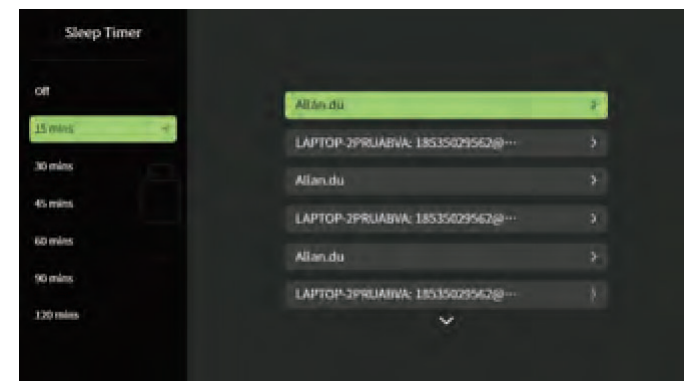

Source

HDMI / AV / USB

Source - HDMI / AV / USB > Choose different input source according to what you connect.

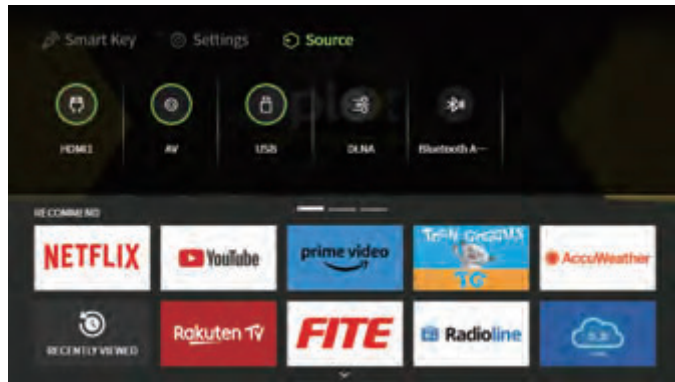

Bluetooth Audio

Source - Bluetooth Audio > Pair your mobile phone with the projector via Bluetooth and select the projector name on your mobile phone.

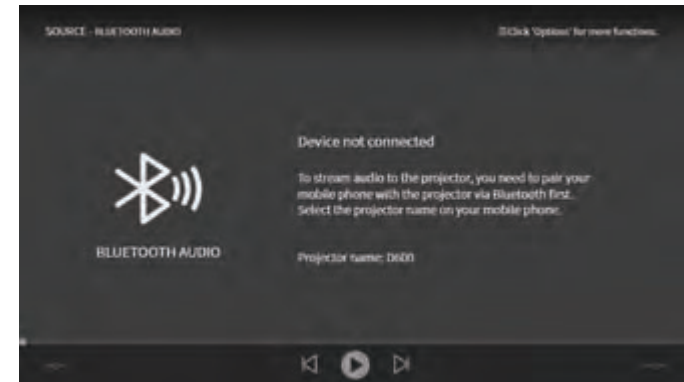

DLNA

Source - DLNA > Connect Mobile / Pad and projector to the same network. Open the video playing app. Click the TV icon and select the projector name.



Questions & Answers

* Problems listed below might occur during the operation of your projector. Please refer to the possible factors which might cause the issue to do troubleshooting.

[Audio]Q: Why is the audio of the projector available but no display?

- A1: The video format is not supported by the projector.
- A2: Encryption applied to the videos or media player which holds the video.
- A3: If the lamp of the projector is off with only audio playing, the lamp is defective.
- A4: Try another HDMI cable if you select the HDMI input source.

[Signal]Q: Why does the projection screen show "No Signal"?

- A1: Make sure all cables are plugged correctly and firmly.

[Mounting]Q: What kind of screws do I need for mounting this projector?

- A1: 1/4 inch.

[Image]Q: What can I do if the image is blurry?

- A1: Press the auto focus button of the remote control / Adjust the focus ring by moving it leftward / rightward till it shows the correct image.
- A2: Place the projector on a flat surface horizontally or vertically. An inclination at any angle may result in blurry displays or uneven colors.
- A3: Darker environment suggested achieving the best projection performance.
- A4: The eligible distance between the projector and projecting screen/wall is 1.25-4 meters.
- A5: Projecting wall or screen is clean white if possible.

[Image]Q: How can I do if the image is up side down?

- A1: Enter Settings – More Settings – Lens – Projection Direction to rotate the image.

[Image]Q: How can I do if the projection screen is not square or allied horizontally?

- A1: Enter Settings – More Settings – Lens to enable the Auto Keystone Correction or use the 4-Corner Correction to adjust the projection area by pressing the remote control.
- A2: Make sure the projector is placed on a flat surface with a projector light in the middle of the screen.
- A3: Make sure the projector screen is placed horizontally.

[Image]Q: How can I do if there is color distortion?

- A1: Make sure the video source has a fine resolution.
- A2: Enter Settings – More Settings – About Projector – Restore To Default to restore the projector.

[Image]Q: How can I do if there is line/blurry screen in the projection picture?

- A1: Please restart it to see if it can be solved. The line/blurry screen is caused by the motherboard or screen.

[Remote Control] Q: How can I do when the remote is unresponsive?

- A1: Make sure the batteries are installed correctly and the power is enough.
- A2: Please make sure the IR receiver is not covered.

[Setting]Q: How can I change the language?

- A1: Enter Settings – More Settings – System > Language to select your language.

[Damage]Q: How should I do if there is expanding dark spot or smoke when using the projector?

- A1: Check if the fan noise increases or the fan stops working.
- A2: Make sure the outlet and projector power adapter are not wet or humid which will cause sparks or smoke on outlet when power on the projector.

[Shut Off]Q: Why does the projector is shut off during playing?

- A1: Make sure the power plug is working and firmly fitted into the outlet.
- A2: Overheat the projector will activate the built-in power-off protection panel. Restart the projector when it gets cooler.



FCC Statement

This equipment has been tested and found to comply with the limits for a Class B digital device, pursuant to part 15 of the FCC Rules. These limits are designed to provide reasonable protection against harmful interference in a residential installation. This equipment generates, uses and can radiate radio frequency energy and, if not installed and used in accordance with the instructions, may cause harmful interference to radio communications. However, there is no guarantee that interference will not occur in a particular installation. If this equipment does cause harmful interference to radio or television reception, which can be determined by turning the equipment off and on, the user is encouraged to try to correct the interference by one or more of the following measures:

- Reorient or relocate the receiving antenna.
- Increase the separation between the equipment and receiver.
- Connect the equipment into an outlet on a circuit different from that to which the receiver is connected.
- Consult the dealer or an experienced radio/TV technician for help.

Caution: Any changes or modifications to this device not explicitly approved by manufacturer could void your authority to operate this equipment.

This device complies with part 15 of the FCC Rules. Operation is subject to the following two conditions: (1) This device may not cause harmful interference, and (2) this device must accept any interference received, including interference that may cause undesired operation.

RF Exposure Information

This equipment complies with FCC radiation exposure limits set forth for an uncontrolled environment. This equipment should be installed and operated with minimum distance 20cm between the radiator and your body.

Disclaimer

This manual is a basic user guide, pictures and functions are subject to the actual product. Our company is devoting to improve product performance and reserve the right to improve product functions and interface described in this manual. Current functions and interfaces are for reference only, due to the continuous upgrading, firmware is subject to change without prior notice.

Please keep your device properly. We're not responsible for any loss caused by wrong operation, repairing, disassembly, and any other reasons.

This manual has been carefully checked by professional engineer, please understand for any inevitable omissions.