

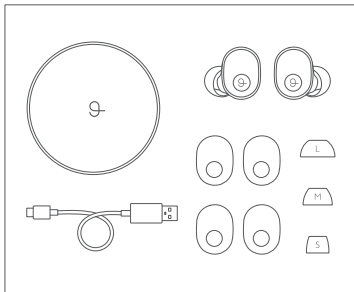

**BGM UNI**  
USER GUIDE

# Packing List

Check the package contents before use.



- UNI earphone (L/R)
- Charging case
- Type-C charging cable
- UNI Cap x 3 sets (of different styles)
- Ear tip x 3 sets (S/M/L size)
- Storage pouch
- User Guide
- Quick Start Guide
- Warranty card

# Earphone

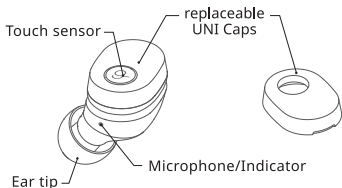

## How to replace UNI Caps?

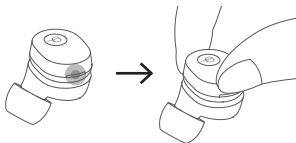

### Removal

Press your finger or fingernail against the hole part of the cap to remove the cap.

### Installation

Place your choice of cap in its position on the earphone and slightly press the cap until you hear a click of the buckle.

# Charging Case

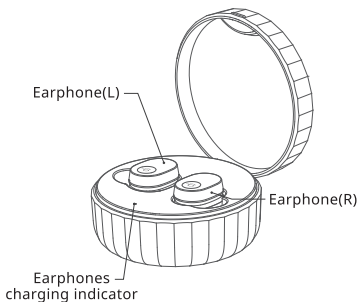
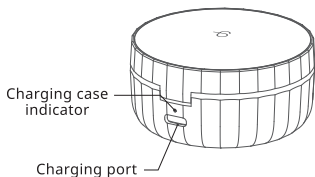

# First Use

Before using the earphones for the first time, do as follows: open the charging case, take out the earphones, remove the transparent protective film, place the earphones back into the case, wait five seconds, and then take them out again.

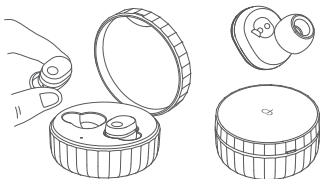

## Power On/Off the Earphone

### By using the charging case

When the earphones are taken out of the charging case, it will automatically power on. Put them back, and they will automatically power off.

### By using the earphone

Press and hold the touch sensor on each earphone for three seconds to power on or off the earphones.

There will be a voice saying "Power on" or "Power off" when you power on or off the earphones.

# Pairing

First, "pair" the earphones with Bluetooth devices, such as mobile phones. The earphones must first be paired with a device connected to the earphones for the first time.

## 1. Take the earphones out of the charging case.

The earphones will give a voice prompt saying "Power on".

Please Note: For first-time pairing, the two earphones must be taken out within a few seconds of each other.

## 2. Enable the Bluetooth function of the device to be connected.

When the earphone is powered on, it will automatically start pairing. Wait and you will hear the voice prompt "Pairing".



## 3. Select "BGM UNI" on the Bluetooth device list of the device to be connected.

If the connection is successful, you will hear a voice prompt saying "Connected".

**4.Five seconds after the successful connection, a request for pairing will appear. Select "Pair" and the pairing is complete.**



iOS



Android

\*Due to software version reasons, the message "unable to pair" may appear on some devices. Nevertheless, the earphones can be normally used without any problems, because connection has been made in step 3.

**Next time when you use the earphones with the paired device, they will be automatically paired once the earphones are powered on.**

# Basic Operation

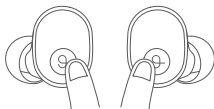

Use the touch sensor to perform the following gesture controls.

Status		L		R
Music	▶   Play/Pause	x2	or	x2
	▶▶ Next track			x3
	◀◀ Previous track	x3		
Call	☎ Accept	x2	or	x2
	☎ End	x2	or	x2
Voice assistant	🗣 On	x4	or	x4
	🗣 Off	x4	or	x4

\*When using only one earphone, triple tap it to skip to the next song but it is not able to skip to the previous song.

\*Double tap the left or right earphone to deactivate voice assistant such as iOS classical voice control.

\*Due to connections to devices or App, some of the above functions may not be available for use.



# Charging

## Low battery indication on the earphone

If the earphones in use are at low battery, a sound prompt saying "Low Battery" is heard. Besides, the indicator of the earphone will also flash red every 5 seconds.

## Charging the earphones

To charge the earphones, just place them in the charging case. The white indicator inside the charging case will keep breathing when charging the earphones in the case. When fully charged, the indicator will stay on for 5 minutes and then go off.

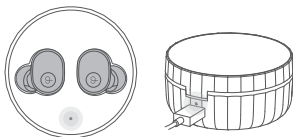

## Low battery indication on the charging case

When the charging case is in low battery, the indicator at the back of the case will flash white every 5 seconds.

## Charging the charging case

Charge the case using Type-C USB cable. The white indicator at the back of the charging case will keep breathing when charging. When fully charged, the indicator turns solid white on and goes off after USB cable is disconnected.

# FAQ

## **Q1 Can either one of the earphones be used independently?**

If both earphones have successfully completed the first pairing, either earphone can be used independently to connect with the paired device.

## **Q2 During music playback, noise or interruption occurs.**

Normally, the working distance between the earphones and connected device is 10m at a non-sheltered area. If the distance is more than 10m or the radio wave is too weak, there may occur noise in the music playback or the playback will be interrupted. Besides, there will be intermittent playback in an environment with very strong wireless interference.

## **Q3 When both earphones are used, either one is placed in the charging case and turned off, the other one will sometimes be disconnected but reconnected after a while.**

The earphones will remember the previous pairing, which is affected by usage status. For example, the earphone which is last disconnected or which is taken out of the charging case first will automatically become the master one. When the master one is turned off, the other one will be reconnected (in 5 seconds), during which music playback pauses.

**Q4 The earphone cannot connect to the devices paired before.**

Please first delete the "BGM UNI" from the Bluetooth device list in the paired device. Then restart the earphone (by placing it back into the charging case and taking it out again) and pair it with the device again. Please refer to the description of "Pairing" in page 5.

**Q5 The earphones cannot be paired properly.**

For example, only one of the earphones is paired successfully.

In case of abnormal pairing, please reset the pairing.

① Continuously tap the touch sensors on both the left and right earphones 7 times each. When a clumping sound is heard, the original pairing is deleted from the earphones.

The pairing of left and right earphones need to be deleted separately.

② Place the two earphones back into the charging case after pairing is deleted.

③ Take out the earphones from the charging case again and the earphones will automatically turn on, which means they have been restarted.

④ Perform initial pairing. Please refer to the description of "Pairing" in page 5.

# Attention

- Please read this user guide carefully before using the product.
- If you listen to music or sound at a high volume for a long time, your hearing may be hurt. Please adjust the volume to a moderate level.
- Do not use the product near medical equipments or equipments requiring high safety and accuracy.
- The product contains small components such as UNI caps. To prevent accidental ingestion, please keep the product out of reach of infants.
- When the built-in battery is not used for a long time, its performance may decrease. Please charge it at least once a month.
- Please use a dry cloth to clean the product.
- Do not disassemble, repair, or modify the product.
- In case of smoke or unusual smell during use, please stop using it immediately.
- Do not use, store, or place the product in high-humidity places such as bathrooms or high-temperature places.
- When unplugging the charging cable, please do it from the connector.
- Use the product within the voltage range indicated in this guide.
- The built-in battery is a consumable part and not covered by the warranty.
- If the battery time drops sharply or the battery cannot be used when fully charged, it has exceeded its lifespan. Because the battery cannot be replaced, it's advised to purchase a new pair of earphones.

# Product Specification

<b>Product Name</b>	UNI
<b>Product Model</b>	UN-100
<b>Battery</b>	450mA (Charging Case); 40mA (Earphone)
<b>Audio Input</b>	Bluetooth 5.0
<b>Playing Time*</b>	7 hours (Earphone); 38 hours (Earphone + Charging case)
<b>Size</b>	22 x 23 x 26mm (Earphone); 67 x 67 x 33mm (Charging case)
<b>Weight</b>	4.5 g (Earphone without UNI Cap); 0.5 g (UNI Cap); 52 g (Charging case)

\*Volume was set to 50%.

\*Battery life depends on device settings, environment, usage, and many other factors.

## FCC Statement

This device complies with part 15 of the FCC rules. Operation is subject to the following two conditions: (1) this device may not cause harmful interference, and (2)

this device must accept any interference received, including interference that may cause undesired operation.

Changes or modifications not expressly approved by the party responsible for compliance could void the user's authority to operate the equipment.

NOTE: This equipment has been tested and found to comply with the limits for a Class B digital device, pursuant to part 15 of the FCC Rules. These limits are designed to provide reasonable protection against harmful interference in a residential installation. This equipment generates uses and can radiate radio frequency energy and, if not installed and used in accordance with the instructions, may cause harmful interference to radio communications. However, there is no guarantee that interference will not occur in a particular installation. If this equipment does cause harmful interference to radio or television reception, which can be determined by turning the equipment off and on, the user is encouraged to try to correct the interference by one or more of the following measures:

- Reorient or relocate the receiving antenna.
- Increase the separation between the equipment and receiver.
- Connect the equipment into an outlet on a circuit different from that to which the receiver is connected.
- Consult the dealer or an experienced radio/TV technician for help.

The device has been evaluated to meet general RF exposure requirement. The device can be used in portable exposure condition without restriction.



BGM Inc.



LH00 00

Made in China



R 210-134471

# BGM

[www.bgm-uni.jp](http://www.bgm-uni.jp)