



Model No.: MH22217

N-LITE 210

QUICK START GUIDE

Please read this Quick Start Guide carefully and keep it for future use.

Product Overview

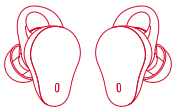

Earphones x2 (L & R)



Charging case x1

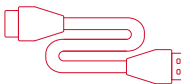

USB-C cable x1

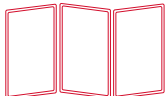

Quick start guide and warranty card



Ear Tips x 2 Pairs (S&L)
(M is on the earphones)



Ear support x 2Pairs (S&L)

Charging

Before using the " **Monster N-Lite 210** " , please connect the USB-C cable to a power adapter to begin charging. Fully charge the earphones and the charging case before the first use.

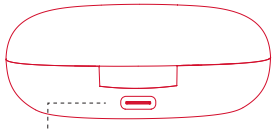

USB-C Port

Power On/Off

When taken out of the charging case, the earphones will turn on and pair other automatically. If you want to turn off the earphones, please put the earphones into the charging case, the earphones will power off and charge at the same time.

Pairing

When taken out of the charging case, the earphones will turn on and pair other automatically.

For new device connection, turn on the Bluetooth in your device and choose " **Monster N-Lite 210** " from the Bluetooth list to connect. You will hear system prompts after the earphones are connected to the device.

If the earphones have been connected before, they will connect to the last connected device automatically after being turned on.

Wearing

Put the " **Monster N-Lite 210** " onto your ears and rotate to fit comfortably to get the best wearing and sound quality experience.

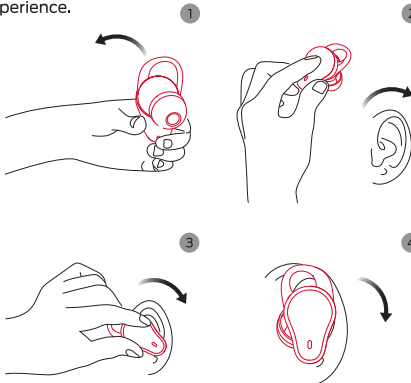

MFB Operation

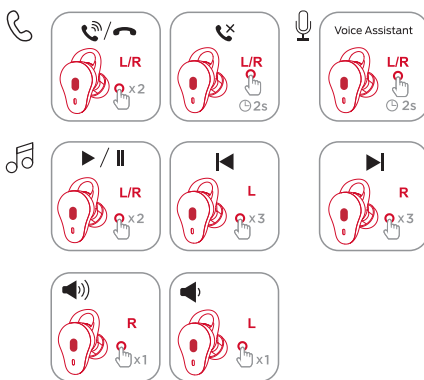

Reset

In the power on state, press the MFB of the earphones 5 times (two earphones at the same time), and the earphones will automatically shut down to reset. Put the earphones in the charging case and then take them out, the earphones will turn on automatically, and enter the pairing mode.

Additional Operation

Answer call	Press L or R twice
End call	Press L or R twice
Reject call	Press MFB on the left or right earphone for 2 seconds
LED indicator (earphone)	
Power on	White flashes
Power off	The red light on 2s and then turn off
Pairing is successful	The white light on 1s and then turn off
Pairing timed out	The red light on 2s and then turn off
Connection is over distance	White flashes
Disconnect the phone	White flashes
Low battery	Red light flashes slowly
Low power off	The red light on 2s and then turn off
LED indicator (charging case)	
Charging	Four white lights blink slowly from left to right. After the battery is fully charged all four lights turn on
Low battery	The first light from the left flashes five times
Discharge	The left 1 light of the left earphone keeps on and goes out when it is fully charged, and the right 1 light of the right earphone keeps on and goes out when it is fully charged

Attention

*Private replacement of batteries without permission is not recommended.

*Batteries [battery packs or battery combinations] should not be exposed to lighting, baking or similar overheating environments.

*The input voltage and current standard $\leq 5V/1A$ when charging the headset charging compartment from an external power source;

FCC Warning

This device complies with part 15 of the FCC Rules. Operation is subject to the following two conditions: (1) This device may not cause harmful interference, and (2) this device must accept any interference received, including interference that may cause undesired operation.

Any Changes or modifications not expressly approved by the party responsible for compliance could void the user's authority to operate the equipment.

Note: This equipment has been tested and found to comply with the limits for a Class B digital device, pursuant to part 15 of the FCC Rules. These limits are designed to provide reasonable protection against harmful interference in a residential installation. This equipment generates uses and can radiate radio frequency energy and, if not installed and used in accordance with the instructions, may cause harmful interference to radio communications. However, there is no guarantee that interference will not occur in a particular installation. If this equipment does cause harmful interference to radio or television reception, which can be determined by turning the equipment off and on, the user is encouraged to try to correct the interference by one or more of the following measures:

- Reorient or relocate the receiving antenna.
- Increase the separation between the equipment and receiver.
- Connect the equipment into an outlet on a circuit different from that to which the receiver is connected.
- Consult the dealer or an experienced radio/TV technician for help.

The device has been evaluated to meet general RF exposure requirement. The device can be used in portable exposure condition without restriction.

FCC ID:2AVD2-MH22217