

Battery Camera

User Manual

Powered By



Contents

1. Products & Packlist

2. Set up Camera

3. Set up APP&Configure Device

3.1. Downloading APP

3.2. Add Device

4. FAQ

5. Safe Battery Handling and Usage

1: Products & Packing list



1.2 Packing list:

1* Camera



1* screw kit

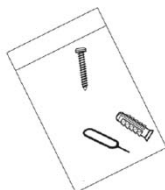

1* 2m micro USB cable

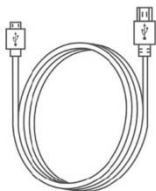

1 * user manual

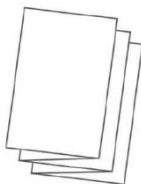

2. Set up Camera

2.1 Slide the latch of the battery compartment to the right.

2.2 Switch on the button on the battery.

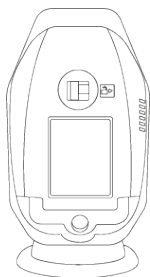

2.3 Insert TF card to TFcard slot (as picture), the TF card can be bought by yourself and it supports max to 128GB.

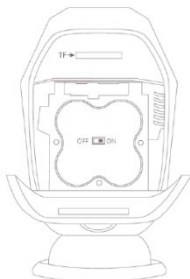

2.4 Close the battery door.

2.5 For reset the device, follow below steps, then you will listen a sound and see the indicator blinks red rapidly. That means reset successfully.



2.6 Please fix the magnet bracket on wall with screws like following pictures.

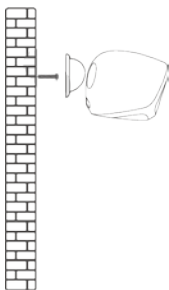

2.7 Notes for installation.

1. The height should be 2.1meters.
2. The camera slopes down 15 degrees.



3. Set up APP&Configure Device

3.1 Search and download “Smart Life” in major application markets or scan the QR code below to download the APP.



3.1.1 Once you download the APP to your smart phone, you may enter the first page which you can Login with existing account or register.

(If you are the new user of Smart Life and don’ t have an account, please choose register first and follow the below screenshots to complete the registration.)

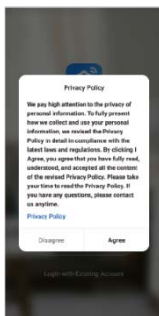
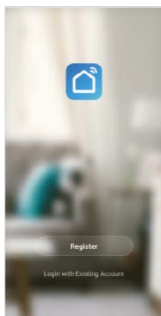

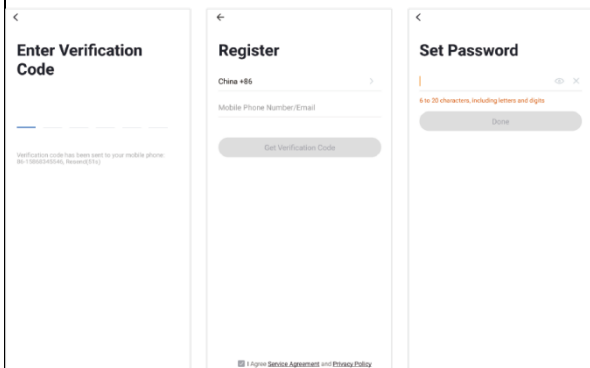

(If you have the existing account, there are two ways to login, one is with SMS verification Code, the other one is with password. In case you forget the password, you may choose login SMS verification Code or you can choose forgot password to reset it by Entering Verification Code which sent to you mobile via message.)

3.1.2 Once the account has been setup successfully, then you will automatically enter the page of "add device" , kindly follow below steps to add the camera.

Step1:click “Add Device” or click “+” on top of right on this page.

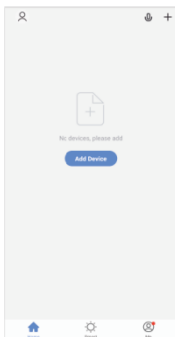

Step2: choose “Security& Sensor” and follow the screenshots below.

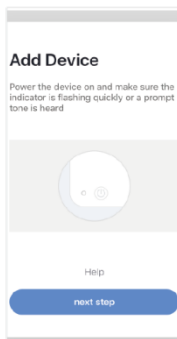

Step3: You may choose next step to go to QR code paring mode or you may go to "other Mode" on top of right to enter the page of choosing QR Code Net-pairing or Smart configuration, if you choose the "next step", you may follow the below screenshots:

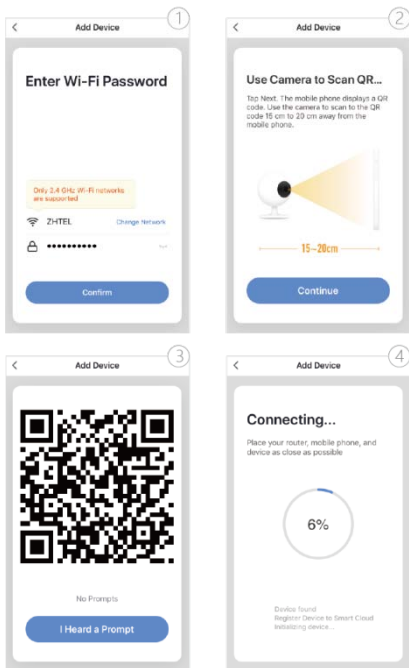

Step4. If you choose “ the other mode ” on the top of the right side, you may find QR Code Net-pairing Which you will go back to the “Add device” page and process it again like above procedure. Or you can choose “Smart configuration” and follow the below screenshots and after that you will see the device added successfully.

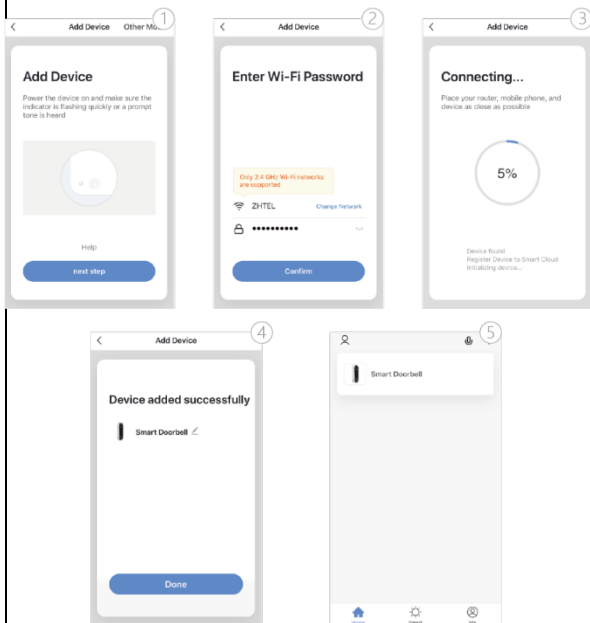

4.FAQ:

After the configuration is done, our device will be showed on Kogan Smarter Home APP which enable you to surf the smart living easily. If you have any questions about App using, you may go to category" me" to find the " Help Center" and check if you have the same issues. If not, you can report the issue and then your problems will be handled and answers will be given soon if you provide as much information as you can.

5.Safe Battery Handling and Usage

DO NOT allow the batteries or battery compartment to get wet prior to or during installation while your Wire-Free camera is weatherproof and safe to use outside.

ALWAYS keep batteries away from children.

Follow local guidelines to dispose of used batteries. To the extent permissible by applicable law, failure to follow these warnings and/or directions could result in damage to your LinkCam Wire-Free cameras that

will not be covered by Linkwil's warranty.

6.FCC Warning:

This device complies with part 15 of the FCC Rules.

Operation is subject to the following two conditions:

(1) This device may not cause harmful interference, and (2) this device must accept any interference received, including interference that may cause undesired operation.

The users manual or instruction manual for an intentional or unintentional radiator shall caution the user that changes or modifications not expressly approved by the party responsible for compliance could void the user's authority to operate the equipment.

This equipment complies with FCC radiation exposure limits set forth for an uncontrolled environment .

This transmitter must not be co-located or operating in conjunction with any other antenna or transmitter.

This equipment should be installed and operated with minimum distance 20cm between the radiator & your body.

7.ISED Warning:

This device complies with Innovation, Science, and Economic Development Canada licence-exempt RSS standard(s). Operation is subject to the following two conditions:

- (1) this device may not cause interference, and
- (2) this device must accept any interference, including interference that may cause undesired operation of the device.

Le présent appareil est conforme aux CNR d'Innovation, Sciences et Développement économique Canada applicables aux appareils radio exempts de licence. L'exploitation est autorisée aux deux conditions suivantes :

- (1) l'appareil n' doit pas produire de brouillage, et*
- (2) l'utilisateur de l'appareil doit accepter tout brouillage radioélectrique subi, même si le brouillage est susceptible d'en compromettre le fonctionnement.*

The device is compliance with RF exposure guidelines,

users can obtain Canadian information on RF exposure and compliance.

Le présent appareil est conforme

Après examen de ce matériel aux conformité ou aux limites d'intensité de champ RF,

les utilisateurs peuvent sur l'exposition aux radiofréquences et la conformité and compliance d'acquérir

les informations correspondantes.

This equipment should be installed and operated with minimum distance 20cm between the radiator & your body.

Cet équipement doit être installé et fonctionner à au moins 20 cm de distance d' un radiateur ou de votre corps.