

70mm

120mm

1 Safety notice

- Please read Manual carefully before you use the projector.
- To ensure stable power supply, please use national standard power cable and power cord with grounding.
- Please use the same power voltage as the projector marked.
- Please do not open the projector, otherwise the supplier will not afford warranty service.
- Do not look directly at the projector lens while the machine is working to avoid damage your eyes.
- To avoid clog of the projector vent, please do not cover with cloth, carpet and other materials.
- This projector does not have waterproof function, please keep it away from rain, moisture and other items containing liquid such as vase, cup, etc.
- To avoid electric please keep the projector away from rain or water or moisture.
- And cut off the power supply if do not use this project for a long time.
- Use the originally foam or other unit-shock material to protect projector, if you need transport this projector.
- If you find the projector have problems, please contact with the supplier, do not repair by yourself.
- To extend the projector life span and protect your eyesight, we suggest you may have a break after 3-4 hours using.

Maintain Indication:
1-year warranty from factory, for more warranty information, please contact with supplier (warranty service is not including the frame, manual, package, and some subjective idea about the video, sound, image aspects).

2 Interface introduction

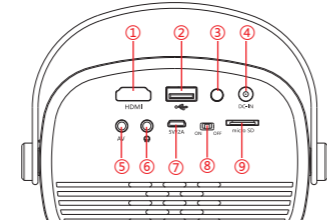

- HDMI input slot
- USB input slot
- IR receiver
- DC Power input
- AV input slot
- Earphone slot
- Micro USB(SV/ZA)
- Switch of battery's power
- Micro SD card slot

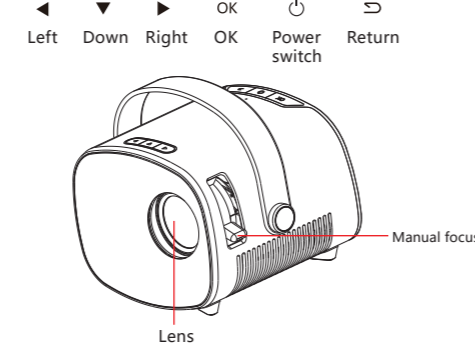

3 Remote control introduction

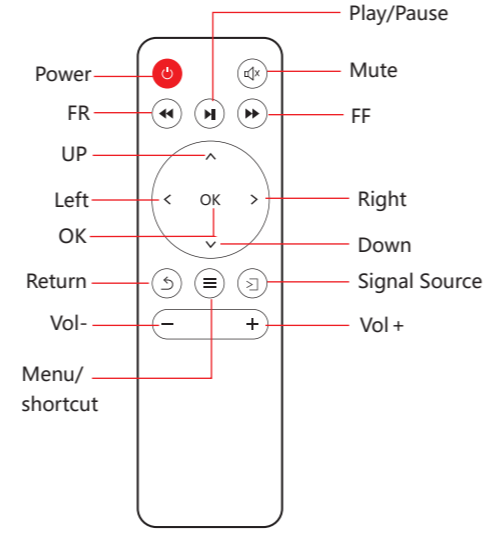

- *NOTE:
- To avoid power shortage, please do not mix use the old and new battery at the same time.
 - To avoid battery leakage corrosion, if do not use remote control for a long time, please take the battery out.
 - When using the remote control, please align the remote control signal transmitter to the projector's infrared signal reception position.

4 Media connection

4.1. Media input slot connection
Connect the USB/Micro SD drive with the content to the projector USB/Micro SD port, select "Media", you can select movies, music, photo, text on the list.

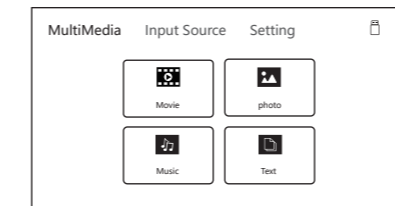
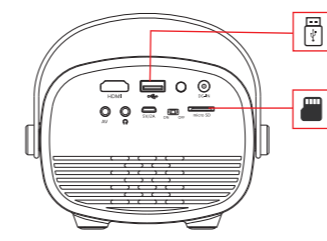

Audio support	MP3/WMA/OGG/AAC/FLAC/APE/WAV
Photo support	JPG/BMP/PNG
Video support	3GP/AVI/MKV/FLV/WMV/MOV/MP4/MPG/VOB/MPG/RMVB/RM
Text support	TXT

4.2. HDMI equipment connection
HDMI slot could connect to computer and all the device with HDMI slot. As connected, choose the option HDMI.

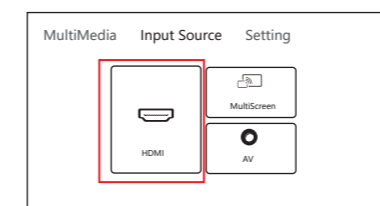
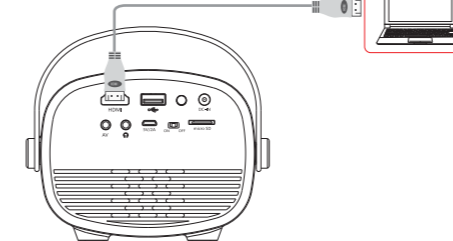

4.3 AV video equipment connection
Use 3 in 1 cable video convert cable, connect projector AV slot, the connection method like the picture, as connected, choose the signal source video.

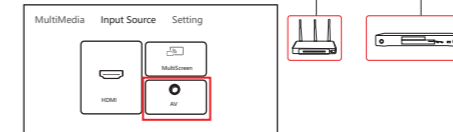
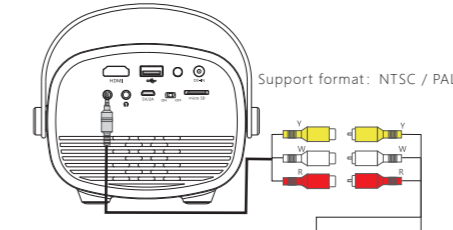

4.4 3.5mm audio device connection
Could connect 3.5mm earphone and speaker equipment.

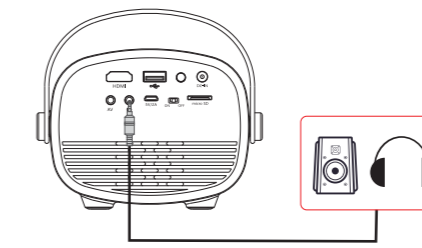

5 Miracast connection

Select the "miracast" in the channel interface and connect the phone to the Cast SSID: NETLNK-E179. Scan the QR code to access the home page of the miracast, or press "OK" on the remote control for three seconds to enter the WIFI setting interface. Also available: <http://192.168.203.1>. Set up the network and start using it. After connecting to the WIFI router, the miracast will automatically switch to the miracast mode.

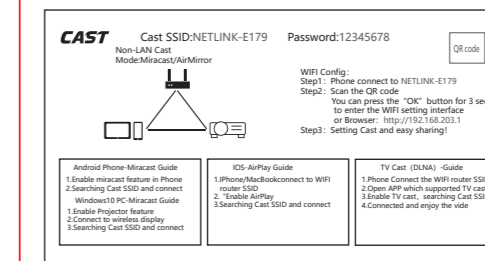
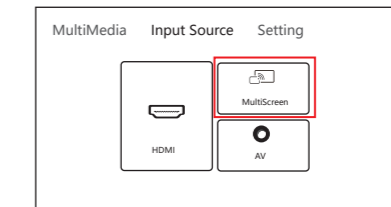

FCC Warning:

This device complies with part 15 of the FCC Rules. Operation is subject to the following two conditions:
(1) This device may not cause harmful interference, and (2) this device must accept any interference received, including interference that may cause undesired operation.
Changes or modifications not expressly approved by the party responsible for compliance could void the user's authority to operate the equipment.

RF exposure warning:

This equipment must be installed and operated in accordance with provided instructions and the antenna(s) used for this transmitter must be installed to provide a separation distance of at least 20 cm from all persons and must not be co-located or operating in conjunction with any other antenna or transmitter.
End-users and installers must be provided with antenna installation instructions and transmitter operating conditions for satisfying RFexposure compliance.

5.1 Android mirroring

Connect the phone to the Cast SSID:NETLNK-E179, Enter-into the mirroring function of the mobile phone, search the mirroring device, directly connect to Cast SSID, and the mirroring is successful.
* Please ensure that the phone and projector are on the same network (the projector displays the Cast SSID in different names here, subject to the actual display).

5.2 IOS miracast

Enter into the control center on the IOS device, click "miracast", Select the corresponding miracast SSID, click the SSID and connect. After successful connection, the screen is projected onto the same screen and the connection status is displayed on the phone.
* Please make sure that the IOS device and the projector are on the same network, or connect the projector to the wifi interface of the IOS device to Cast SSID: Netlink-E179 (the Cast SSID of the projector is different here, depending on the actual display).

5.3 Windows10 mirroring

Computer WiFi connect to Cast SSID: NETLNK-E179, Find "Projection" in the computer function list and click "Connect to wireless monitor", search for Cast SSID of this screen and click "Connect".
* Please ensure that the computer and projector are on the same network (the projector displays the Cast SSID in different names here, depending on the actual display).

6 Projector connection introduction

6.1 Connection introduction

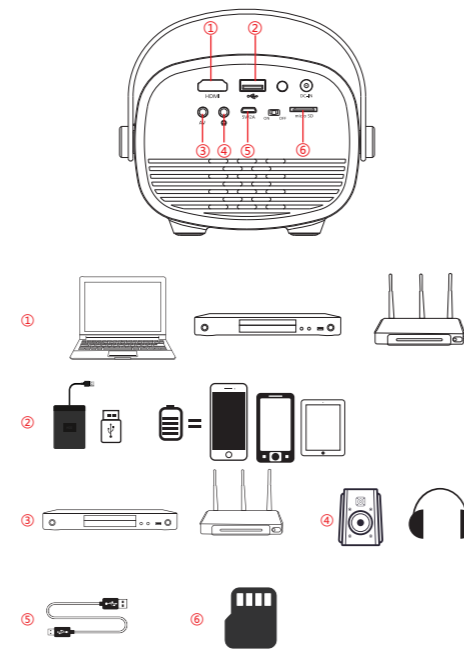

*Could connect multi-device and applications.

6 Setup menu

6.1 Picture setting
Open the home page--"Setting",find the picture setting, you can set up the projection mode, image scaling, aspect ratio, picture mode of the projector.

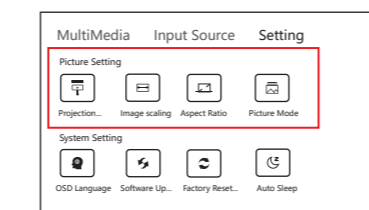

6.2 System setting
Open the home page--"Setting",find the system setting, you can set up the OSD language,software update, factory restore,auto sleep of the projector.

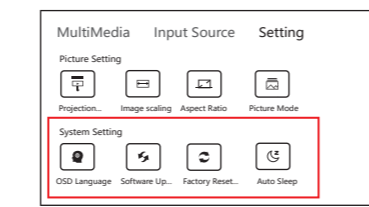

7 Image focus

Put the projector vertical to the projector screen or white wall, adjust the keystone, until the image clearly enough,then the focus is finished.During the focusing,you could display video the menu while adjust the focus.

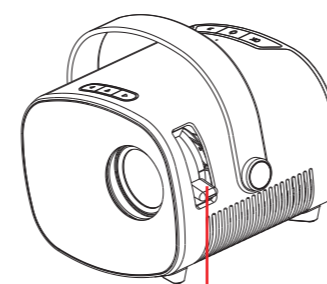

Manual focus

9 Built-in battery power supply (Available for models with built-in battery only)

Fiddle with the button to "on", then projector will be charged by built-in battery. In this situation, projection brightness will be a little lower.
Battery symbol will appear on projection screen to indicate the remained power volume.
*It takes about 3 hours for charging.



10 Switch of battery's power

This switch is only available for the battery built-in version.



11 Technology Features

11.1 Basic parameters

Imaging technology	TFT LCD
Resolution	640*360
Highest resolution	1920*1080
Light	LED
Operation mode	Manual operation
Projection distance	1.5--5M
Projection ratio	1.62:1
Aspect ratio	16:9
Power supply	Standard Adapter:12V-2.5A Built in battery Adapter:12V-3A Lithium battery:7.4V/1600mAh
Input	HDMI/USB/Micro SD/AV/Micro USB
Output	Earphone
Net weight	0.5kg
Unit size	117.8*133.4*94.9mm

User Manual

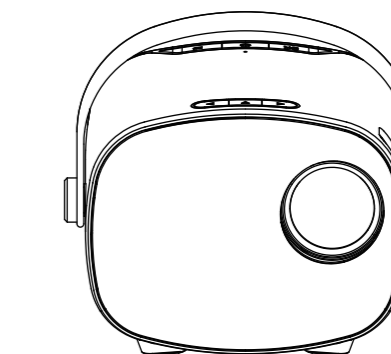

Due to continuous improvement, actual product may differ from the manual, manual is for reference only.

封底

封面