

Donner Podcast Workstation PC-02

User Manual

Thank you for choosing Donner Podsoler All-in-One Podcast Workstation PC-02!

Please read this instruction manual carefully before using this product.

Be sure to save these instructions for future reference.

Introduction

Donner PODSOLER is an all-in-one podcast workstation designed for live streaming & content creators. With the innovative exclusive algorithm and 4 XLR Mic inputs, it supports up to four podcasters to record the program at the same time. Combined with the available motor faders and independently controlled monitors for a better podcast experience. It also comes with 9 customized programmable pads for instant playback of 10 sound effects and samples, which get more fun. Furthermore, a quick connection to the phone, USB, and Bluetooth sources is provided. Podcasts can be recorded directly to a micro SD card, or to PC/MAC via USB. A more professional podcast workstation is assured and suited to create multiple application scenarios: Live streaming, band performances, talk shows, gaming, and music shows.

Important Safety Instructions

- Please use the AC adapter which supplies 12V DC by this product.
- To prevent fire or shock hazard, do not expose this appliance to rain or moisture.
- Please turn off the power supply and pull out the power cord when the product is not in use for an extended period of time.
- Make sure that the power is off when connecting or cutting off the power cord.
- Do not place the product near the strong magnetic field.
- Please do not disassemble or modify this product so as to avoid the danger of fire and electric shock.
- Do not store it in the following environments: Direct sunlight, high temperature, excessive humidity, excessive dust, and strong vibration.
- Do not clean the product with thinners, alcohol, or similar chemicals to avoid discoloration.
- Donner is not responsible for damage caused by improper use or modifications to the device.

Features

- Integrated all-in-one podcast solution
- ...
- Microphone/Instrument inputs come with four XLR connectors and built-in Preamp with 50dB gain.
- Stereo high-quality headphone outputs with four 6.35mm jacks and support high impedance headphones.
- Industry-leading Audio Interface solution: sampling rate XXX, signal to noise ratio XXX, providing first-class sound quality.
- Adopted Donner's exclusive algorithm
- Equipped with four individual microphone inputs to meet the needs of professional singing, performance, and speech.
- ...
- Comes with 27 (9 x 3 Banks) customized programmable pads, illuminated pads that can be triggered during a podcast production, and flexibly assigned new samples when you want to add content.
- Support multi-track recording direct to unit's MicroSD card that allows meeting the needs of the interview, dubbing, band recording, and so on.

Included Items

Donner Podsoler x 1
Power Adapter x 1
USB-C Cable x 1
32GB MicroSD Card x 1
User Manual x 1

Name of Parts

Front Panel

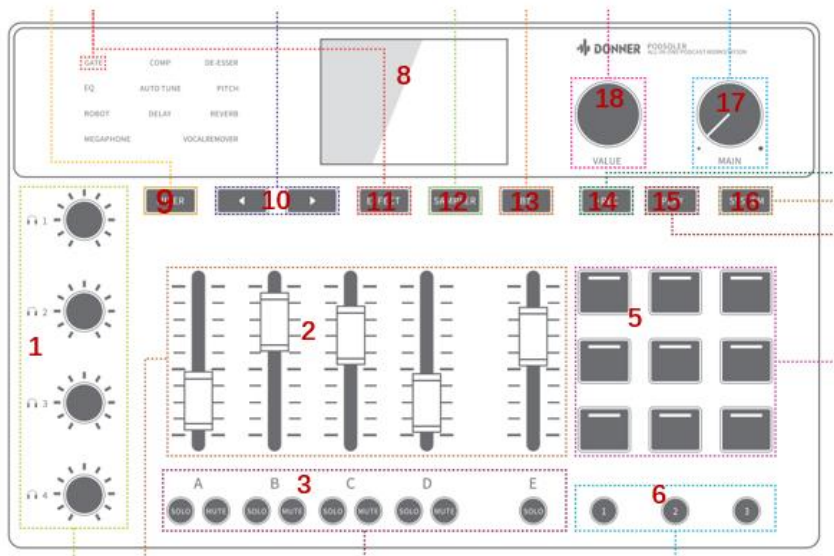

① Phones Knob 1-4

Adjust the output levels of headphones.

Press the knob to select the headphone channel and balance the volume of each channel.

② Motor Fader 1-4

Adjust the volume of each channel.

The fader will display the volume of the main output in the mixer mode

The fader will display the volume of the headphone sending volume of each channel in the monitor mode.

The E channel will display the volume of the sampler by default.

③ Solo/Mute

Press to solo/mute the signal input on that channel.

④

⑤ Sample Pad (Sound Pad)

Press to trigger the preset sound effects.

Users can flexibly record new samples according to the requirements.

⑥ Sample Group Select

Press to switch the sample group.

⑦

⑧ Display Screen

Display input level, main output level, and status parameter of each channel

⑨ Mixer Button

Press to display the mixer setting on the screen.

⑩ Select Button

Press to select the channel in the mixer display.

Press to switch the main channel (4-channel analog mono input) and sub-channel (4-channel stereo external input)

11. Effect Button

Press to enter select effects. Use the Value knob to select or turn on/off the effect units. The effect name will be lighted if the effect is turned on.

12. Sampler Button

Press to enter the sampler setting.

13. BT

Press to turn on/off the Bluetooth. Press and hold for pairing devices.

14. Record Button

Press to start/pause the recording. Press and hold to stop recording and exporting audio to (SD 卡?)

15. Play Button

Press to play/pause the recorded audio. Press and hold to stop playing audio.

16. System Button

Press to enter the system setting.

17. Main Knob

Adjust the output levels of the main out

18. Value Knob

Rotating for selecting the menu and adjusting the parameters.

Pressing for confirming the selection.

Rear Panel

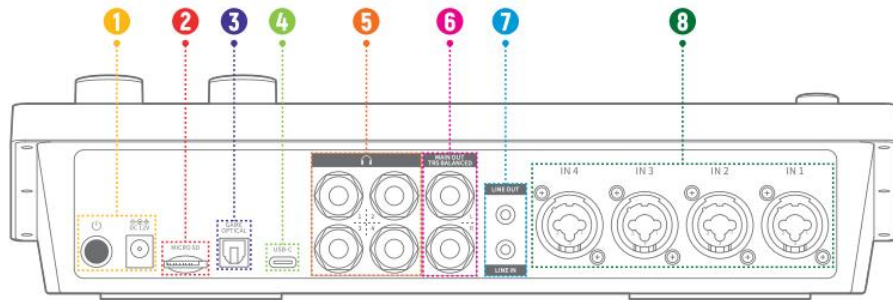

① Power Supply and Power Button

Press the power button to turn the unit off.

② MicroSD Slot

MicroSD slot for direct recording.

③ Game Optical Port

Optical port for connecting the PS4/Xbox devices.

④ USB-C Port

Use this to connect the PC/MAC/IOS/Android devices.

⑤ Main Out for Headphones (耳机?)

Main volume output for connecting the headphones. (接口是 TRS 6.3mm?)

⑥ Main Out for TRS Balanced L/R

Main volume output for connecting the monitor speakers.

⑦ Line Out/Line In

Mini-jack output and mini-jack input for inputting music from other devices or outputting the main signal to the streaming device without main volume knob control.

Connect a media player or other audio device here.

⑧ Input Jacks 1-4

Combo input jacks are compatible including XLR/TS/TRS microphone and musical instrument.

Connection Operation

Connecting audio equipment



! Caution

Please adjust knobs and faders on this unit to a minimum before connecting audio equipment. Failure to do may cause sudden loud noises from monitoring equipment, and this could damage the equipment or harm hearing.

Connection Example

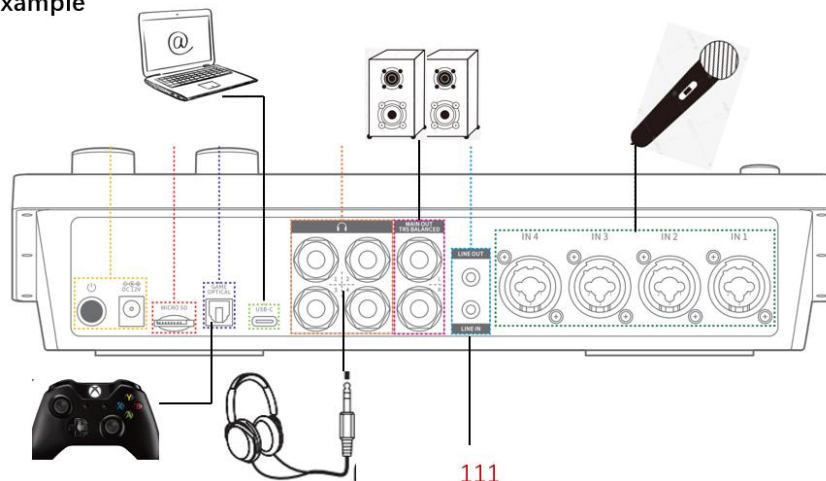

Connecting microphones/musical instruments

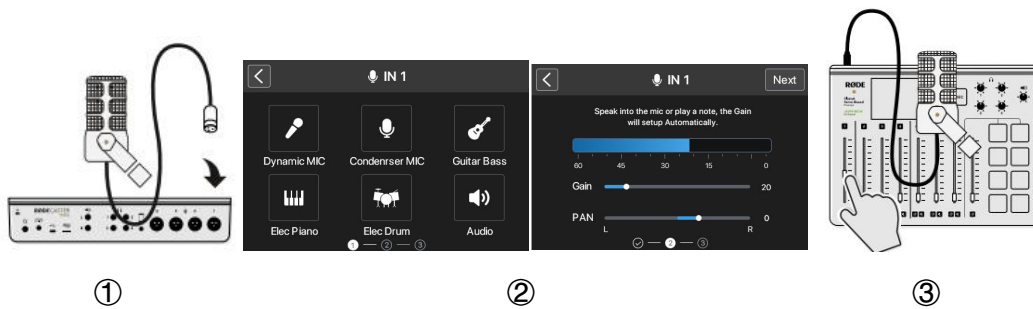

Step 1: Connect your microphone to the XLR Input 1-4 jacks on the back using a standard XLR cable (not supplied). Or connect your musical instrument to the XLR Input 1-4 jacks on the back using a standard TRS cable (not supplied).

Step 2: After connecting them, the screen will pop up the corresponding channel input settings. Please select your device and complete the level settings as prompted.

Step 3: Push up the channel fader slowly to adjust the volume.

Connecting the Android/iOS Devices (Wired)

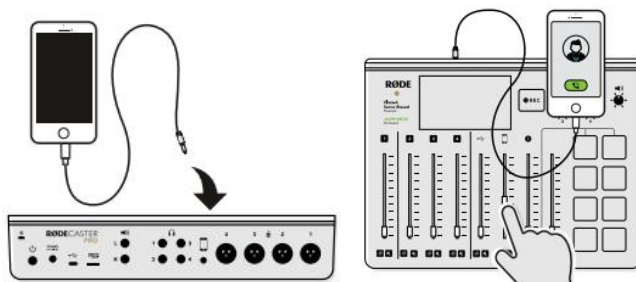

Step 1: Connect your smartphone/tablet to Line In/Out jack (**USB port**) on the back using a 3.5mm cable (not supplied) or supplied USB cable.

Step 2: Push up the channel fader slowly to adjust the volume.

Connecting the Bluetooth Devices

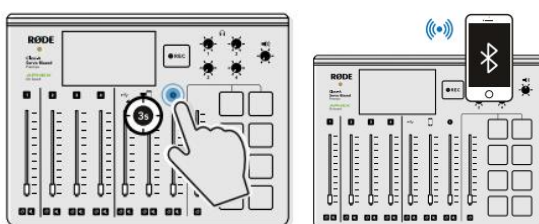

Step 1: To get started, short press the BT button on the front panel to turn on the Bluetooth function, then hold the BT button for pairing nearby devices.

Step 2: Turn on the Bluetooth of your device and select “Donner PC-02” to connect.

Step 3: Turn up the volume of your device and push up the channel fader slowly to adjust the volume.

Connecting the Windows and Mac Devices

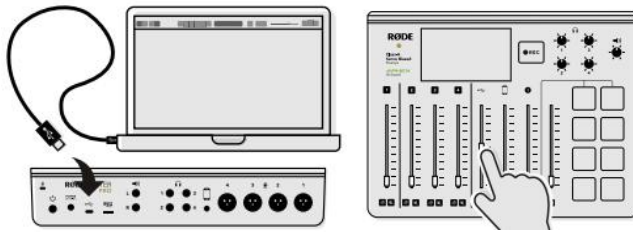

Step 1: Connect your PC/MAC to the USB jack on the back using a supplied USB cable. (知道是什么接口的吗)

Step 2: Push up the channel fader slowly to adjust the volume.

Connecting the Game Consoles and Blu-ray Players

Step 1: Connect your gaming consoles to the OPTICAL port on the back using an optical cable (not supplied).

Step 2: Push up the channel fader slowly to adjust the volume.

Recording to MicroSD Card

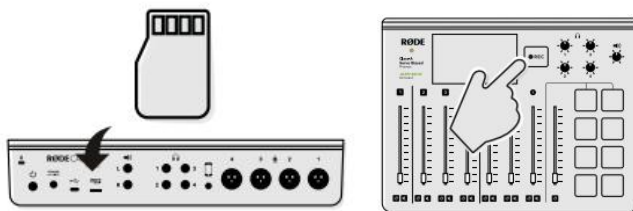

Step 1: To get started, insert a microSD card into the SD slot on the back.

Step 2: After inserting it, press the REC button on the front to start recording, the indicator will light up red. Once press the REC button to pause, the indicator will blink red.

Step 3: Long press the REC button to stop recording when you're finished, the indicator will go off.

Step 4: The indicator of the PLAY button will light up, press it can playback the audio just recorded.

Connecting to Monitor Headphones and Monitor Speakers

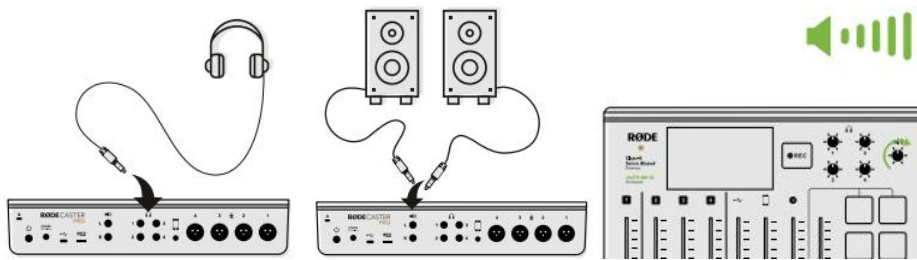

Step 1: Make sure to adjust the knob on this unit to a minimum before connecting audio equipment.



Step 2: Connect your monitor headphones/ monitor speakers to the Main out jacks on the back using a 6.35mm audio cable (not supplied).

Step 3: Rotate the knob slowly to adjust the volume.

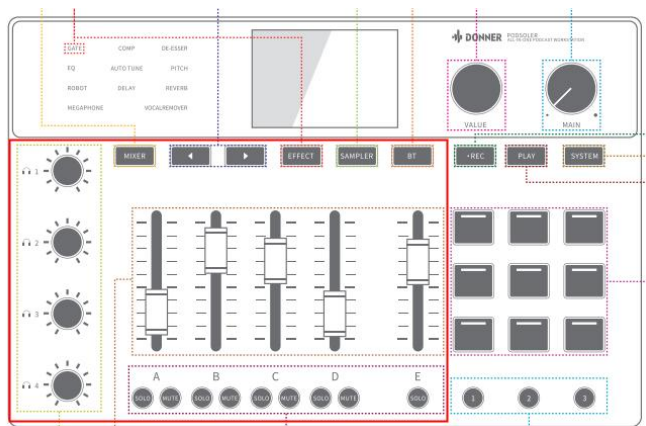
MIXER Operation

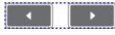

The Podsoler let you efficiently and accurately manage 9 input levels (4 Solo +4 Mute + Sampler) of Main output and 4-channel monitor outputs through our innovative multi-channel smart motor MIXER during the live broadcast. In other words, you can record a total of 5 groups of MIXER data, 45 faders positions. And according to your requirements to quickly switch, so that you achieve a full range of control.

1. Press the **MIXER** button to return home page. Press  the  to switch 主副 channel in the mixer.
2. Press one of the monitor knobs to set the Mixer of the monitoring channel, and the 9 input levels will be automatically saved. Press the monitor knob again to return to MainOut's Mixer.
3. Each time you switch the Mixer, the 5 motor faders will automatically return to the position you set before on the Mixer.
4. Press the SOLO button and MUTE button to solo/mute the signal input on that channel.

Sampler Operation

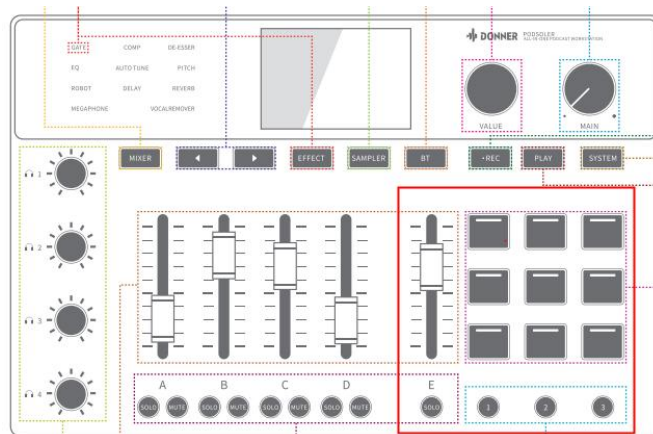

With 27 sample pads (9x3Banks) on the Donner's Podsoler, you can play the preset sound and flexibly record new samples you like during a podcast. It is convenient for players to use and especially adds super fun to the podcast.

1. This machine has 9 preset sound effects that have been saved by default in Bank 1. Press the corresponding PAD to use it directly.
2. Select the sound bank you need by pressing the bank 1/2/3 selection button, and slowly push up/down **the fader of the E channel** to adjust the level.
3. The sample pads can be played at the same time, or paused, and play in a loop.
4. The pads can also be used as shortcuts to access parameters in the sound effect, such as , mute , vocal remover , etc.

Effect Setting

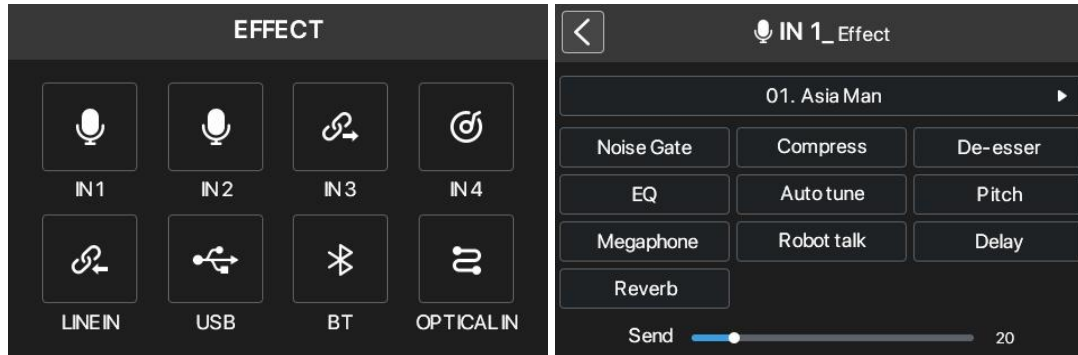

Donner's FX Multieffector allows you to process your main channel input signal, which supports up to 10 effects per channel, greatly optimizing your voice or instrument effects and getting great performance.

1. Press the EFFECT button to enter the effect setting.
2. Rotate and press the Value knob, select the channel and effect you want to adjust.
3. Rotate and press the Value knob, adjust the parameters you want.
4. After setting, save the current parameters as your preset for the next use.
5. All of the controls mentioned above are also available in the "DonnerControl" (for PC/MAC).

Sampler Setting

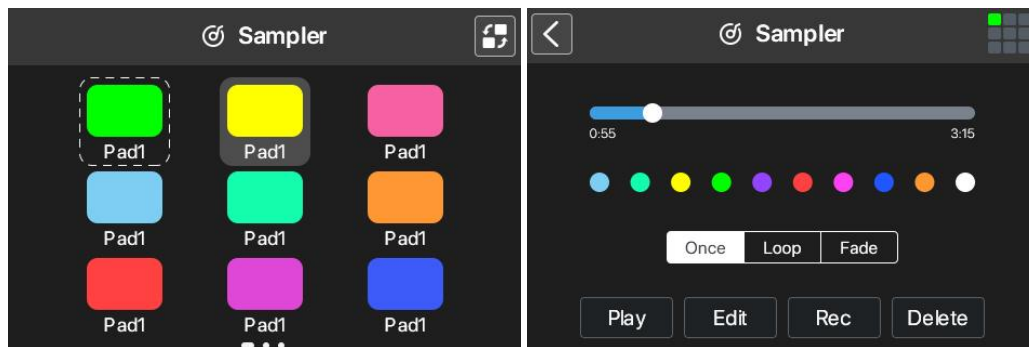

The sampler programmable function of Donner's Podsoler allows you to realize your creation during a broadcast by playing unique sound effects or other shortcut functions.

1. Press the SAMPLER button to enter the sampler setting.
2. Rotate and press the Value knob, and select the pad you want to customize.
3. Rotate and press the Value knob, record the voice you need, or select the EFFECT from preset library.
4. Rotate and press the Value knob, customize your favorite color.
5. Trigger ways setting: 单击触发, 持续触发, 循环触发, 同时触发
6. Supports up to 27 programmable pads by pressing the bank 1/2/3 selection button
7. All of the controls mentioned above are also available in the "DonnerControl" (for PC/MAC).

System Setting

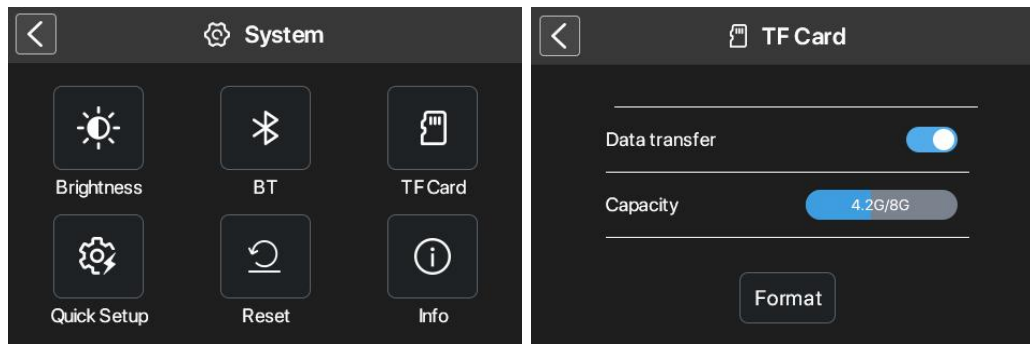

Press the **SYSTEM** button to enter system settings, rotate, and press the Value knob to adjust the settings you want.

Screen	Brightness
BT	
TF Card	
Quick Setup	
Reset	Factory Reset (All data will be deleted! Make sure to back up data before restoring factory reset.
Info	Firmware version

Rotate and press the Value knob to adjust settings, such as: brightness, Bluetooth, MicroSD card, reset function and adjust the light color of the whole machine, etc.

PC02 Specification

Connections

Input	XLR x 4, balanced / TS x 4, unbalanced
Line In	Stereo, 1/8" TRS
Line Out	Stereo, 1/8" TRS
Phones	Stereo, 4 x 1/4" TRS
Main Out	Stereo, 1/4" Balanced TRS
PC/MAC/Android/iOS	USB-C
Game Console	Optical

Electrical Spec

Gain Range	0-57dB
Headphone Output Power	125mW @ 32 Ω
Frequency Response	20Hz~20kHz @ -3dB
Input Impedance	600 ohm(XLR)/1M (TS)
Dynamic Range	110 \pm 0.5dB
S/N Ratio	109 \pm 0.5dB
Bit Depth	24bit
Sample Rates	48kHz
Power Input	12V DC, 2A
Faders	Motorized Faders x 5
LEDs	RGB x 244pcs

FCC Statement

Changes or modifications not expressly approved by the party responsible for compliance could void the user's authority to operate the equipment.

This equipment has been tested and found to comply with the limits for a Class B digital device, pursuant to Part 15 of the FCC Rules. These limits are designed to provide reasonable protection against harmful interference in a residential installation. This equipment generates uses and can radiate radio frequency energy and, if not installed and used in accordance with the instructions, may cause harmful interference to radio communications. However, there is no guarantee that interference will not occur in a particular installation. If this equipment does cause harmful interference to radio or television reception, which can be determined by turning the equipment off and on, the user is encouraged to try to correct the interference by one or more of the following measures:

- Reorient or relocate the receiving antenna.
- Increase the separation between the equipment and receiver.
- Connect the equipment into an outlet on a circuit different from that to which the receiver is connected.
- Consult the dealer or an experienced radio/TV technician for help

This device complies with part 15 of the FCC rules. Operation is subject to the following two conditions (1) this device may not cause harmful interference, and (2) this device must accept any interference received, including interference that may cause undesired operation.

This equipment complies with FCC radiation exposure limits set forth for an uncontrolled environment. This equipment should be installed and operated with minimum distance 20cm between the radiator & your body

IC Statement

This device contains licence-exempt transmitter(s)/receiver(s) that comply with Innovation, Science and Economic Development Canada's licence-exempt RSS(s). Operation is subject to the following two conditions:

- (1) This device may not cause interference; and
- (2) This device must accept any interference, including interference that may cause undesired operation of the device.

The term "IC: " before the certification/registration number only signifies that the Industry Canada technical specifications were met. This product meets the applicable Industry Canada technical specifications.

Cet appareil contient des émetteurs / récepteurs exemptés de licence conformes aux RSS (RSS) d'Innovation, Sciences et Développement économique Canada. L'exploitation est autorisée aux deux conditions suivantes : (1) l'appareil ne doit pas produire de brouillage, et (2) l'utilisateur de l'appareil doit accepter tout brouillage radioélectrique subi, même si le brouillage est susceptible d'en compromettre le fonctionnement.

This equipment should be installed and operated with a minimum distance of 20 centimeters between the radiator and your body.

Cet équipement doit être installé et utilisé à une distance minimale de 20 centimètres entre le radiateur et votre corps.