



FLOOR ONE S3 SERIES

Smart Cordless Vacuum & Washer

Instruction Manual

Manual De Uso

Mode D'emploi



*Actual product may differ from illustration.

TINECO IS HERE TO HELP.

We'll get back to you within 1 business day.



www.tineco.com



1-855-292-8864

Mon. - Fri. 9am - 6pm (CST)

CONTENTS

Important Safety Instructions.....	2
Specifications	6
Overview.....	7
Assembly	9
Operation	10
Maintenance	16
Troubleshooting.....	20
Warranty	21

TINECO IS HERE TO HELP.

We'll get back to you within 1 business day.



www.tineco.com



1-855-292-8864

Mon. - Fri. 9am - 6pm (CST)

Important Safety Instructions

SAVE THESE INSTRUCTIONS

Household use only.

When using an electrical appliance, basic precautions should always be followed, including the following:

READ ALL INSTRUCTIONS BEFORE USING (THIS APPLIANCE). Failure to follow the warnings and instructions may result in electric shock, fire and/or serious injury.

WARNING – To reduce the risk of fire, electric shock, or injury:

1. This appliance can be used by children aged from 8 years and above and persons with reduced physical, sensory or mental capabilities or lack of experience and knowledge if they have been given supervision or instruction concerning use of the appliance in a safe way and understand the hazards involved. Children should not play with the appliance. Cleaning and user maintenance shall not be performed by children without supervision.
2. The appliance is not to be used by persons (including children) with reduced physical, sensory or mental capabilities, or lack of experience and knowledge, unless they have been given supervision or instruction.
3. Use only indoors, on non-carpeted floor surfaces such as vinyl, tile, sealed wood, etc. Be careful not to run over loose objects or edges of area rugs. Stalling the brush may result in premature belt failure.
4. Do not allow to be used as a toy. Close attention is necessary when used by or near children, pets or plants.
5. Use only as described in this manual. Use only manufacturer's recommended attachments.
6. Do not use with a damaged cord or plug. If appliance has been dropped, damaged, left outdoors, dropped into water, or is not working as it should, return it to a service center.
7. Do not handle charger, including charger plug, and charger terminals with wet hands.
8. Do not put any object into openings. Do not use with any opening blocked; keep free of dust, lint, hair, and anything that may reduce air flow.
9. Keep hair, loose clothing, fingers, and all parts of your body away from openings and moving parts.
10. Use extra care when cleaning on stairs.
11. Do not use to pick up flammable or combustible liquids, such as gasoline, or use in areas where they may be present.
12. Do not pick up anything that is burning or smoking, such as cigarettes, matches, or hot ashes.
13. Do not use without filter.
14. Prevent unintentional activation. Ensure the switch is in the off-position before picking up or carrying the appliance. Carrying the appliance with your finger on the switch or energizing appliance that have the switch on invites accidents.
15. Always switch off the appliance before making any adjustments, changing accessories, or storing the appliance. Such preventive safety measures reduce the risk of starting the appliance accidentally.

16. Recharge only with the charger specified by Tineco. A charger that is suitable for one type of battery pack may create a risk of fire when used with another battery pack.
17. Use appliances only with specifically designated Tineco battery packs. Use of any other battery packs may create a risk of injury and fire.
18. Under abusive conditions, liquid may be ejected from the battery; avoid contact. If contact accidentally occurs, flush with water. If liquid comes into eye contact, seek medical help. Liquid ejected from the battery may cause irritation or burns.
19. Do not use a battery pack or appliance that is damaged or modified. Damaged or modified batteries may exhibit unpredictable behavior resulting in fire, explosion or risk of injury.
20. Do not expose a battery pack or appliance to fire or excessive temperature. Exposure to fire or temperature above 266°F (130°C) may cause an explosion.
21. Follow all charging instructions and do not charge the battery pack or appliance outside of the temperature range specified in the instructions. Charging improperly or at temperatures outside of the specified range may damage the battery and increase the risk of fire.
22. Have servicing performed by a qualified repair person using only identical replacement parts. This will ensure that the safety of the product is maintained.
23. This appliance contains battery cells that are non-replaceable. Do not modify or attempt to repair the appliance or the battery pack except as indicated in the instructions for use and care.
24. Always turn off this appliance before connecting or disconnecting the motorized nozzle.
25. Do not charge or store the appliance outdoors or inside the car. Only charge, store or use the battery in a dry indoor area where the temperature is higher than 39.2°F (4°C) but lower than 104°F (40°C). The charger is for indoor use only.
26. Do not use to pick up ultrafine particles, such as lime, cement, sawdust, gypsum powder, or ashes.
27. Do not use to pick up sharp objects, such as metallic nails, pieces of glass, metal paper clips, or pins.
28. Do not use to pick up hazardous material and chemicals, such as solvent, drain cleaner, strong acids, or strong alkali.
29. Stop using immediately if the appliance is overheating, making unusual noises, producing unusual odors, performing low suction, or leaks electricity.
30. Turn cleaner OFF and disconnect from electrical outlet for long-term storage.
31. Always clean the Dirty Water Tank after each use to avoid potential blockage, which may lead to low suction power, motor overheating, or reduce the service life of the appliance.
32. Store appropriately indoors in a dry place after use.
33. Do not place or submerge appliance in standing water or try to clean flooded areas.
34. All data and technical instructions of this manual are based on results from lab tests of Tineco or designated third parties. The company reserves all rights for final explanations.
35. The plug must be removed from the socket-outlet before cleaning or maintaining the appliance.
36. A hazard may occur if the appliance runs over the supply cord.
37. Do not use the appliance when the water depth is more than 5mm above the surface.

38. Do not pull or carry by cord, use cord as a handle, close a door on cord, or pull cord around sharp edges or corners. Do not run appliance over cord. Keep cord away from heated surfaces.
39. Do not unplug by pulling on cord. To unplug, grasp the plug, not the cord.

Range of Usage

1. The cordless hard floor cleaner is to be used on indoor hard floors, such as vinyl, tile, sealed wood, etc. Use on a rough surface may not get the best performance.
2. Keep your appliance away from heat sources, such as fireplace or heater, to avoid casing deformation.
3. Do not use to pick up flammable or combustible liquids, ultrafine particles, sharp objects, hazardous material, chemicals or anything that is burning or smoking, as described above.

About Cleaning Solution

1. A large amount of cleaning solution entering into the motor may cause damage to the appliance.
2. Add solution as instructed in the Product Operation section. We recommend using the provided cleaning solution. Do not use the product with acidic, alkaline solution, or any substances harmful to the environment.
3. Keep out of the reach of children. Avoid contact with eyes and skin, otherwise, rinse thoroughly with water. If irritation persist, seek medical advice. If product is swallowed seek medical advice.
4. Dirty water and solution disposal should comply with local environmental regulations.

About the Appliance

1. Do not modify or attempt to repair the appliance except as indicated in the instructions for operating and cleaning.
2. Charge the appliance with the Tineco adaptor. Input Voltage: AC 100-240V. Both high and low voltages can damage the adaptor, appliance, or even cause danger to the user.
3. Use extra care when cleaning on stairs.
4. Ensure that the Power Switch is in the OFF-position before picking up or carrying the appliance. Do not lay flat or lean the appliance so as to prevent dirty water from entering into the motor.
5. To avoid being tripped accidentally, please put away the appliance on the storage tray.
6. Always install the Dirty Water Tank and Clean Water Tank properly before use.
7. Do not allow the appliance or charger to get wet to avoid risk of fire or injury caused by a short circuit.

FCC Supplier's Declaration of Conformity

TINECO / FLOOR ONE S3 SERIES

This appliance complies with part 15 of the FCC Rules. Operation is subject to the following two conditions:

- (1) This appliance may not cause harmful interference, and (2) this appliance must accept

any interference received, including interference that may cause undesired operation.
TINECO INTELLIGENT, INC.
1700 WESTLAKE AVENUE N., SUITE 200, SEATTLE, WA, 98109, USA
WWW.TINECO.COM
1-855-292-8864

Changes or modifications not expressly approved by the party responsible for compliance could void the user's authority to operate the equipment.

Note: This equipment has been tested and found to comply with the limits for a Class B digital appliance, pursuant to Part 15 of the FCC Rules. These limits are designed to provide reasonable protection against harmful interference in a residential installation.

This equipment generates uses and can radiate radio frequency energy and, if not installed and used in accordance with the instructions, may cause harmful interference to radio communications. However, there is no guarantee that interference will not occur in a particular installation. If this equipment does cause harmful interference to radio or television reception, which can be determined by turning the equipment off and on, the user is encouraged to try to correct the interference by one or more of the following measures:

- (1) Reorient or relocate the receiving antenna.
- (2) Increase the separation between the equipment and receiver.
- (3) Connect the equipment into an outlet on a circuit different from that to which the receiver is connected.
- (4) Consult the dealer or an experienced radio/TV technician for help.

FCC Radiation Exposure Statement

This equipment complies with FCC radiation exposure limits set forth for an uncontrolled environment. This equipment should be installed and operated with a minimum distance of 20cm between the radiator and any part of your body.

Note

The manufacturer is not responsible for any radio or TV interference caused by unauthorized modifications to this equipment, such modifications could void the user's authority to operate this equipment.

IC Note

This appliance contains licence-exempt transmitter(s)/receiver(s) that comply with Innovation, Science and Economic Development Canada's licence-exempt RSS(s). Operation is subject to the following two conditions:

- (1) this appliance may not cause interference.
- (2) this appliance must accept any interference, including interference that may cause undesired operation of the appliance.

-This Class B digital apparatus complies with Canadian ICES-003.

-This equipment complies with ISED RSS-102 radiation exposure limits set forth for an uncontrolled environment. This equipment should be installed and operated with a minimum distance of 20cm between the radiator and any part of your body.

Specifications

Product	FLOOR ONE S3 SERIES
AC Input	100-240V~
Voltage	21.6V== 4000mAh Lion
Rated Power	190 W
Running Time	≥35 mins
Charging Time	~5 hrs
Water Flow Rate	30~100ml per min
CWT Capacity	0.6L
DWT Capacity	0.5L
Waterproof	IPX4
WiFi Frequency Bands	2.4G
WiFi Maximum Output Power	19dBm

Only use the Tineco provided adaptor: KL-WA260080-A3 or YLS0241A-T260080.

Disposal

- The battery contains materials that are harmful to the environment and must be removed from the appliance before it is discarded.
- When removing the battery, the appliance must be powered off.
- Batteries, chargers, accessories and packaging should be sorted for environmental friendly recycling. Do not put them into fire, water or soil. Do not dispose of batteries and chargers into household waste! 
- If battery leakage contacts skin or clothing, immediately flush with water to avoid irritation and seek medical help.

Overview

Note:

Accessories may vary between markets. If you require more accessories, please go to www.tineco.com or store.tineco.com.

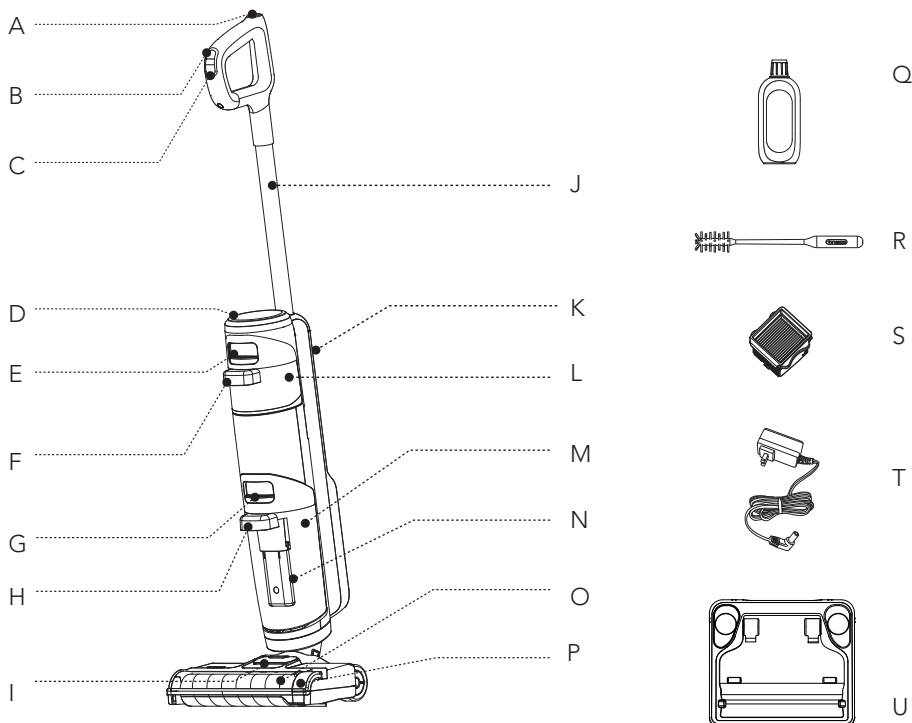

A. Self-cleaning Button

B. AUTO/MAX

C. Power On/Off

D. Digital Display

E. Clean Water Tank Release

F. Clean Water Tank Handle

G. Dirty Water Tank Release

H. Dirty Water Tank Handle

I. Brush Roller Cover Release

J. Tube

K. WiFi/Mute Button

L. Clean Water Tank (CWT)

M. Dirty Water Tank (DWT)

N. Floater

O. Brush Roller Cover

P. Brush Roller

Q. Deodorizing & Cleaning Solution

R. Cleaning Tool

S. Dry Filter

T. Adaptor

U. Storage Tray

Digital Display

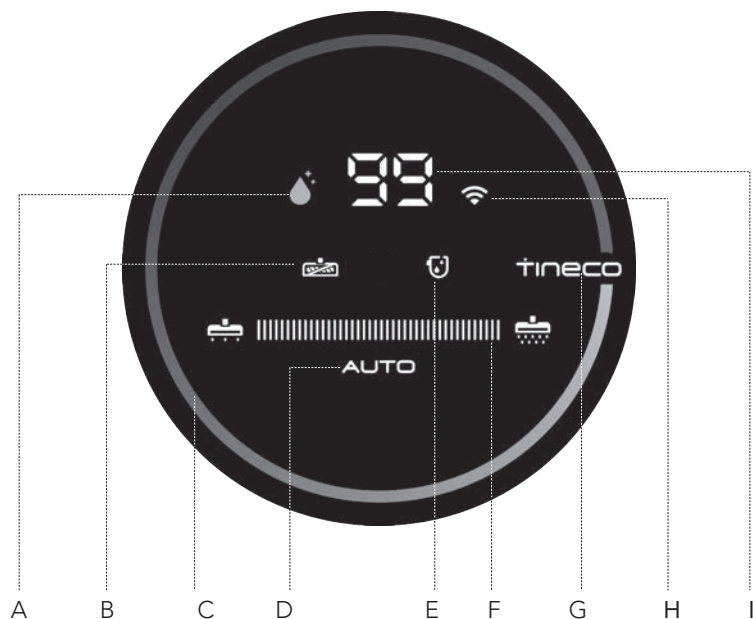

A. Self-cleaning Icon

B. Brush Roller Tangled Indicator

C. Dirt Monitoring Loop
(Blue to red according to the dirt amount)

D. AUTO Mode

E. CWT Empty

F. Power Indicator

G. Tineco Logo

H. WiFi Indicator

I. Battery Level Indicator

Assembly

How to Assemble/Disassemble

Note:

For water tank and brush assembly, please refer to "Operation" and "Maintenance".

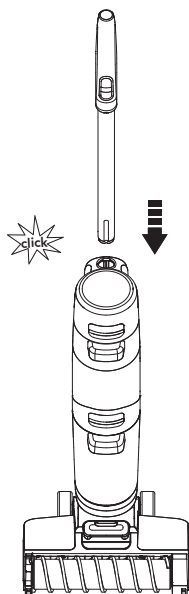

To assemble the handle, insert it into the appliance until you hear a "Click".

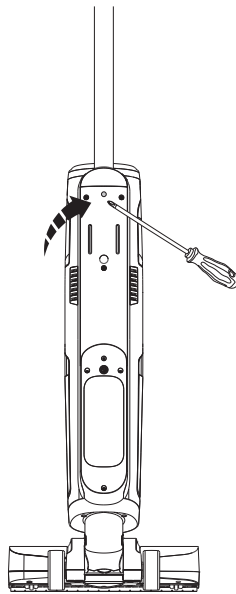

In the event that the handle need to be disassembled, press the spring to release the handle with a tool (like a screwdriver) and lift the released handle from the appliance.

Operation

Preparing for Use

Before first use, please charge the appliance for 5 hours (refer to "Charging Instructions" for details).

* Based on results from Tineco lab tests. Lab temperature 39.2°F (4°C) ~ 104°F (40°C).

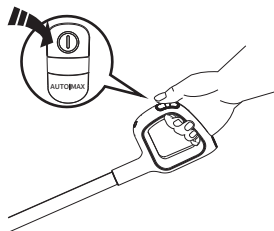

Press the **i** button and the appliance will start in AUTO mode by default. Press it again to turn off the appliance. Switch between AUTO and MAX mode by pressing the **AUTO/MAX** button.

Tips:

- **Solution mode/ Water Only mode:**
Appliance starts with Solution mode by default. Power on while the appliance is upright, long-press **AUTO/MAX** for 3s to switch between the two modes.
- **Switch to Water Only mode:**
LED Loop: Red → Blue (use water only)
- **Switch to Solution mode:**
LED Loop: Blue → Red (use cleaning solution)

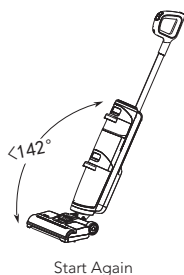
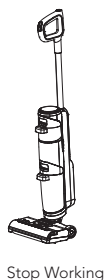

The appliance will stop working when put uprightly and start running again when you recline.

* Do not recline more than 142° to protect against water leakage.

Place the appliance on the storage tray vertically after use.

Note:

- Do not vacuum foamed liquid.
- To vacuum water left on the surface, the appliance will switch off in 3 seconds after power off.

Filling Clean Water Tank

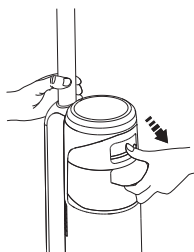

Press the Clean Water Tank release button to remove it from the appliance.

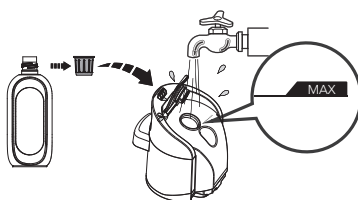

Open the tank cap, and fill with tap water to the Max line. When deep cleaning is necessary, add one bottle cap of solution to the CWT and tightly close the cap.

Note:

**Only use water under 140°F/60°C.
DO NOT USE HOT WATER.**

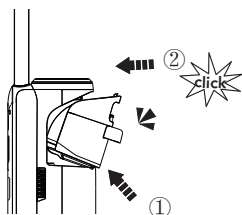

Place the tank back into the appliance. You should hear a "Click" if done correctly.

Charging Instructions

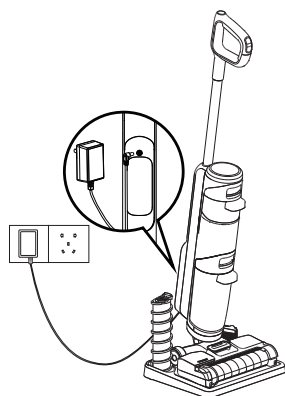

Please charge the appliance when the indicator is blinking.

1. To charge the appliance, connect the external charging cord to the appliance and plug it into the wall outlet.
2. To avoid tripping hazards, please place the appliance on the storage tray near a wall during charging.

Warning:

- Only charge the appliance with the adaptor supplied by Tineco.
- During long periods of not being used, the appliance must be charged once every 3 months for optimal performance.
- Store indoors in a dry place. Do not expose the appliance to sunlight or freezing temperatures. Recommended temperature range: 39.2°F (4°C) ~ 104°F (40°C).

Cleaning Mode Selection

AUTO Mode

- In AUTO mode, the iLoop™ sensor automatically detects how dirty the floor is and applies the appropriate amount of detergent and suction power.
- A red dirt monitoring loop indicates more dirt is detected, and a blue loop indicates less dirt is detected. This mode automatically provides the best cleaning solution.



AUTO



Clean: on Min Power



Vary depending on dirt amount



Heavy dirt: on Max Power

MAX Mode

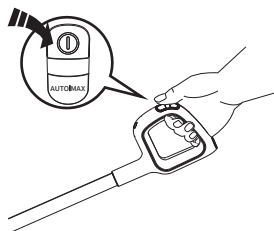

- In AUTO mode, press the AUTO/MAX button to enter MAX mode. The AUTO indicator on the display will turn off.
- In Max mode, the appliance will apply max suction power and will spray water/solution for deeper cleaning.

Note:

Keep sharp objects away from the digital display screen to avoid scratches and scrapes.

Charging Time

- A full charge takes approximately 5 hours.
- Estimated data was obtained by a Tineco Laboratory using ambient temperatures between 39.2°F (4°C) to 104°F (40°C).

Indicator

When in Use



Battery level \geq 10%: battery indicator will be illuminated.



Battery level $<$ 10%: battery indicator will be blinking.



Off: no power detected or possible battery malfunction.



Solid red light: dirt sensor malfunction or blocked.



Indicator blinking: CWT is empty.



Indicator blinking: brush roller is not installed or has a blockage.



Illuminated: WiFi has successfully connected.



Blinking: WiFi is connecting.



Off: Wi-Fi is not connected, please connect to the network.



Indicator blinking: appliance is in need of self-cleaning.

During Charging



Tineco indicator: blinking.

Fully Charged



In 5 minutes: Tineco indicator illuminated.
After 5 minutes: all indicator lights turn off.

App

All the functions can be performed using the Tineco app. Download the Tineco app from the App Store, Google Play and Tineco Official Site.

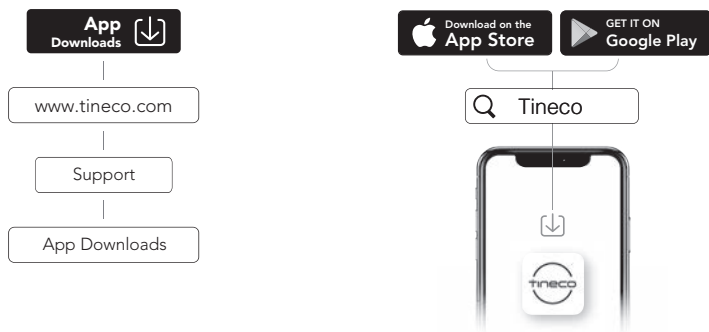

Note:

The default setting for voice prompt is English, you can set other languages via App.

Voice Prompt (Contents may vary, please in kind prevail.)

Status	Reminder
Battery level: 10~20%	Low battery
Battery level: 0~10%	Low battery, please charge
WiFi network connected	Network connected
Clean Water Tank is empty	Clean Water Tank empty, please refill water and cleaning solution
Dirty sensor	Please begin self-cleaning cycle
Dirty dry filter	Please clean the filter in Dirty Water Tank
Brush roller is tangled	Please clean the brush roller
Brush roller not installed	Please install the brush roller correctly
Too much wear of brush roller	Please replace the brush roller
Shutting down (takes 3s to shut down)	Shutting down
Power is off	Power off
Start charging	Charging has commenced. Auto-detecting whether to run self-cleaning cycle
Need self cleaning	Please begin self-cleaning cycle
Press self-cleaning button while appliance not charging	Place the appliance on the storage tray and connect to the charger to start self-cleaning
Battery insufficient for self-cleaning	Low battery, start charging
Sufficient battery to start self cleaning	Start self cleaning
Cleaning brush roller	Cleaning brush roller
Cleaning debris channel	Cleaning debris channel
Auto detecting	Auto detecting
Deep cleaning	Deep cleaning
Self-cleaning completed	Self-cleaning cycle complete. Please clean Dirty Water Tank
Self-cleaning stopped	Self-cleaning cycle stopped. Please clean Dirty Water Tank
Clean with cleaning solution by default	Clean with cleaning solution
Clean with water only	Clean with water only
Auto mode by default	Auto Mode
Switch to Max mode	Max Mode
Voice prompts on	Voice prompts on
Voice prompts disabled	Voice prompts disabled

Maintenance

EN

Note:

- For optimal performance and to prevent odors, always **clean** and **dry** DWT, floater, filters, brush roller, brush roller cover **completely** after each use.
- Please make sure each part is installed correctly or the appliance may not work properly.
- After maintenance, place the appliance on the storage tray vertically. Do not expose the appliance to direct sunlight, and store it indoors in a dry place.

Main Body

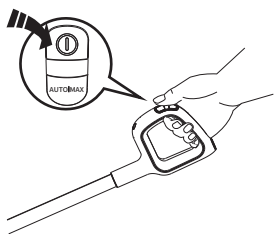

To reduce the risk of injury, switch off before performing maintenance.



Use a cloth to clean the surface with a neutral detergent. The cloth should be dry to prevent water from entering the appliance.

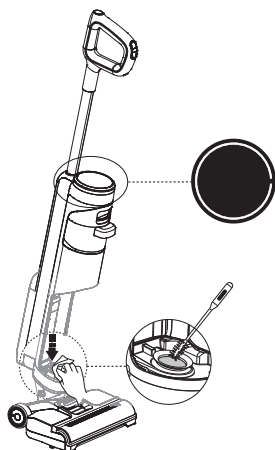

When LED loop illuminates red, remove Dirty Water Tank, clean the dirt sensor with a damp cloth or cleaning tool.