

D-7

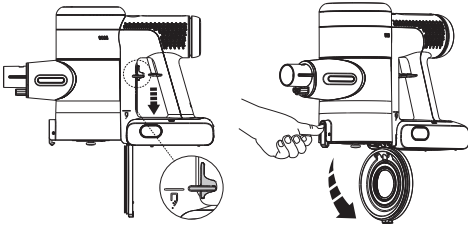

D-8

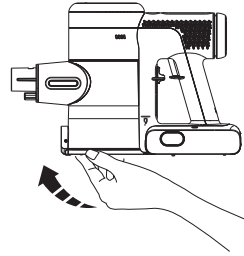

D-9

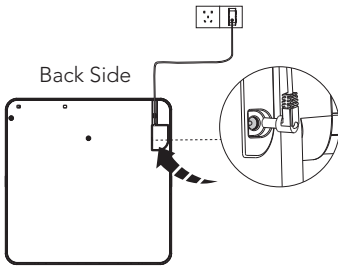

D-10

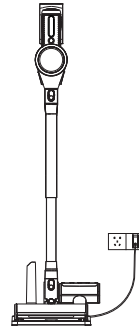

E-1

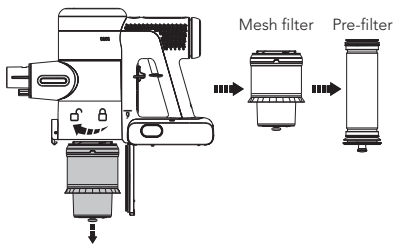

E-2

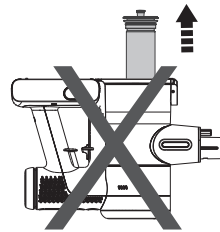

E-3

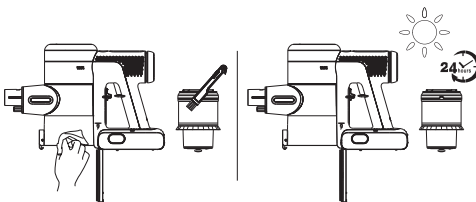

E-4

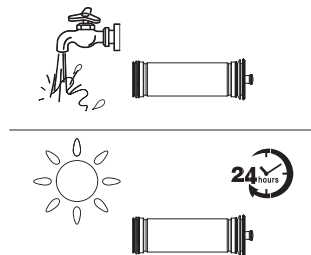

E-5

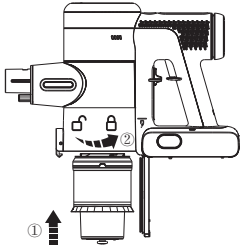

E-6

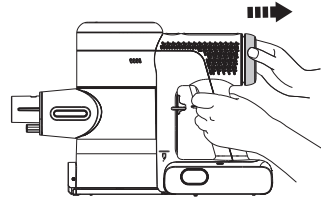

E-7

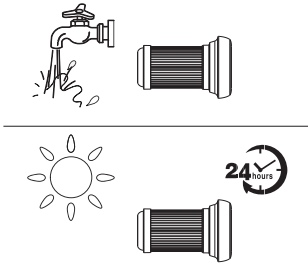

E-8

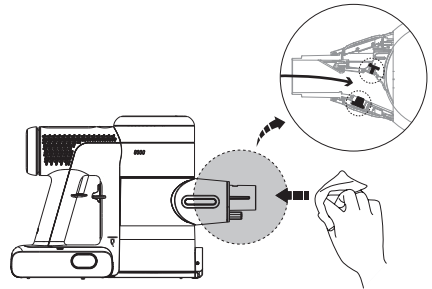

E-9

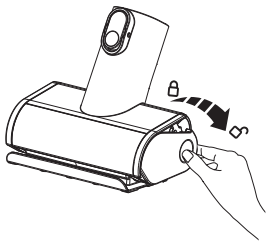

E-10

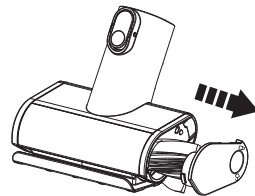

E-11

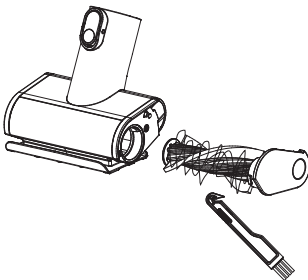

E-12

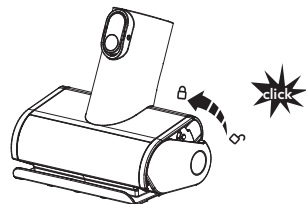

E-13

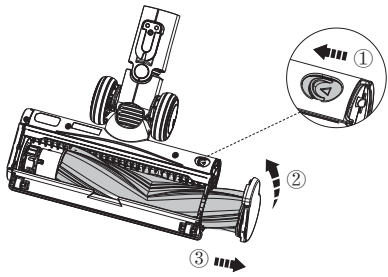

E-14

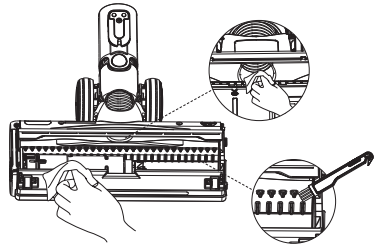

E-15

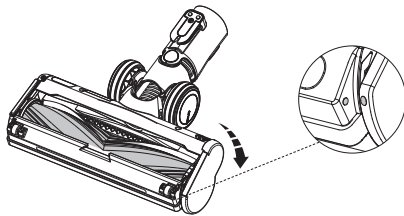

F-1

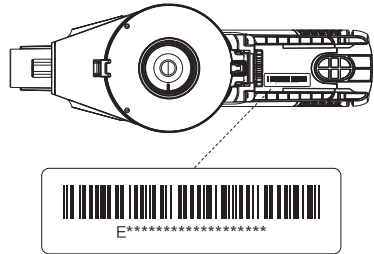

OVERVIEW

- 1 Dust Sensor
- 2 Digital Display
- 3 Dust Empty Release Button
- 4 Dustbin
- 5 Mode Button
- 6 Power Control Slider
- 7 Dust Empty Tab
- 8 Battery Release Button
- 9 Battery Indicator Light
- 10 Power Button
- 11 HEPA Filter

Fig.A

ACCESSORIES

Note:

- Test an accessory on a small, inconspicuous area before use on sensitive surfaces.
- To identify what should be included with your purchase, please refer to the "Included Accessories" located on the packaging box.
- As shown below, there are many components compatible with this model. If you require more accessories, please go to www.tineco.com or store.tineco.com.

1. Direct-drive anti-tangle LED power brush

Very effective for cleaning fine dust on the carpet and hard floor without tangling caused by hairs blocking into roller. LED headlights help you clean the hard-to-see spots.

2. Mini power brush

For vacuuming upholstered furniture, mattresses etc. Vacuums pet hair and removes ingrained dirt.

3. 2-in-1 dusting brush

Switches between a wide and a soft brush by pressing the release button. The soft brush is most effective on hard-surface furniture while the wide brush is effective for upholstered furniture, curtains, etc.

4. Crevice tool

For corners, nooks, and other hard-to-reach places such as around car seats, picture frames, and cupboards.

5. Soft dusting brush

Angled bristles on a slender, oval-shaped rim provide anti-static, cushioned contact. Suitable for dusting shelves, lighting, delicate surfaces, electronics and more.

6. Flexible long crevice tool

Easy to bend, easy to reach tight spots. Suitable for cleaning dust behind and beneath furniture, around refrigerators, and many other tight gaps.

7. Multi-angle folding tube

An articulated joint makes it adjustable to allow for flexibility when cleaning from high to low.

8. Flexible extension hose

Excellent extension and flexibility to access hard-to-reach spaces; perfect for in-care use. Compatible with all non-motorized Tineco accessories.

9. Hair cleaning tool

Use the end with the small blade to remove hair and debris wrapped around the roller. Use the end with the brush to clean the brush window, and the dustbin, as required.

Fig.B

ASSEMBLY

Tube Installation

- Insert tube.
Fig.C-1
- Insert to the main body.
Fig.C-2

- Press the release button to remove the tube.
Fig.C-3

Brush Installation

- Insert the power brush.
Fig.C-4
- Press the release button to remove the power brush.
Fig.C-5

Battery Installation

- Press the battery release button, and remove the battery.
Fig.C-6
- To install, slide the battery into the slot at the base of the main body. The battery will click into position when correctly fitted.
Fig.C-7

Charging Dock Installation

- Lift up the charging post to the upright position.
Fig.C-8
- Press hard to fix the charging post firmly on the dock.
Fig.C-9
- For easy storage, pull up the charging post and then press down.
Fig.C-10

OPERATION

Preparing for Use

Note:

- Before the first use, please charge the appliance (see “Charging the Battery”) for 3-4 hours in an area where the ambient temperature is between 39.2°F (4°C) and 104°F (40°C).
- Select an accessory and attach it to the appliance before use (see “Accessories”).

1. Press the  button to activate the suction. Press it again to turn off the appliance.
Fig.D-1

2. The appliance will start in AUTO mode by default. Press the  button to switch between AUTO and MAX mode. Swipe the power control slider to switch to Manual mode.
Fig.D-2

3. Place the appliance and attachments on the charging dock for convenient storage after use.
Fig.D-3

Cleaning Mode Selection

AUTO Mode

- In AUTO mode, the iLoop sensor automatically detects how dirty the surface is and applies the appropriate suction power.
- A red dust monitoring loop indicates more dust is detected whereas a blue loop indicates less is detected. This mode automatically provides the best cleaning solution.
Fig.D-4

MAX Mode

- In AUTO mode, press the  button to enter MAX mode.
- In MAX mode, the iLoop only displays the dirty amount, and the suction power keeps at the maximum.
Fig.D-5

Manual Mode

- In AUTO or MAX mode, swipe the power control slider to switch to Manual mode.
- In Manual mode, you can control the power as needed.
Fig.D-6

Note:

- Keep sharp objects away from the digital display screen to avoid scratches and scrapes.
- Only use with dry hands. Dirty hands may affect slider operation.

Emptying the Dustbin

1. With the power off, push down the dust empty tab to clean the dustbin. If too much dust causes a blockage, press the release button on the dustbin and empty the contents.
Fig.D-7

2. Close and click the dustbin flap back into place.

Fig.D-8

Charging the Battery

1. Plug the adaptor into the charging port at the bottom of the dock.

Fig.D-9

2. Place the appliance on the charging dock and plug the adaptor into a wall outlet.

Fig.D-10

Warning:

- Only use the Tineco-provided adaptor to charge the appliance.
- To avoid trip hazards, please place the appliance securely on the charging dock, near a wall during charging.
- During long periods of not being used, store the appliance in a cool, dry place. Ensure the battery is fully charged every 3 months.
- Do not expose appliance to sunlight or freezing temperature.
- Recommended temperature range: 39.2°F (4°C)~104°F (40°C).

Runtime

- When in AUTO mode, the runtime is approximately 40 minutes. When MAX power is used, the runtime is approximately 10 minutes.
- Estimated runtime data was obtained by a Tineco Laboratory using one battery and non-motorized accessories.

Charging Time

- A full charge takes approximately 3-4 hours.
- Estimated data was obtained by a Tineco Laboratory using ambient temperatures between 39.2°F (4°C) to 104°F (40°C).

App

All the functions can be performed using the Tineco app. Download the Tineco app from the App Store, Google Play and Tineco Official Site.



Note:

The default setting for voice prompt is English, you can set other languages via App.

Turn On/Off WiFi

- Turn on WiFi: During work, long press the  button for 3 seconds to enter Help Center and go to Connect to network.



- Turn off WiFi: Long press the  button for 20 seconds to turn off.



Voice Prompt (Contents may vary, please in kind prevail.)

Status	Reminder
Quick Start Guide	Welcome to the PURE ONE tutorial, please follow the quick start guide
	This is the power button
	The mode button and power control slider are on the top
	The dust empty tab is on the side of the dustbin
	The filter is on the bottom which is removable for easy cleaning

Status	Reminder
Connect to the appliance	Please download Tineco app and connect the PURE ONE
WiFi network connected	Network connected
WiFi network disconnected	Disconnected
Voice prompts on	Voice prompts on
Voice prompts disabled	Voice prompts disabled
Restore factory settings	Factory settings restored
AUTO mode by default	AUTO Mode
Switch to Manual mode	Manual Mode
Switch to MAX mode	MAX Mode
Low battery	Battery level is below 20%
No battery, please charge	Battery level is at 0, please charge the appliance
Brush roller is tangled	Brush roller tangled, please clean the brush
Dust sensor malfunction	Dust sensor malfunction, please clean the dust on the inner sensor
Air channel blocked	Air channel blocked, please clean the air channel and dustbin
Power is off	Power off
Start charging	Charging
Help Center	Cleaning tutorial
	Voice switch
	Network configuration
	Restore factory settings
	Exit

MAINTENANCE

Note:

- Clean the dustbin and filters after each use.
- To maintain high performance, wash and dry the pre-filter monthly, replacing it every 6 months. Wash and dry the HEPA filter every 3 months, replacing it every 12 months.

Dustbin, Mesh Filter and Pre-filter

1. Turn counter-clockwise to remove the filters.

Fig.E-1

2. Do not turn the appliance upside down when removing or installing the filter to prevent dust from entering the motor.

Fig.E-2

3. Clean the dustbin and mesh filter with a damp cloth or the cleaning tool. Air dry completely before reinstalling.

Fig.E-3

4. The pre-filter can be washed under cold running water and must be completely dry before reinstalling.

Fig.E-4

5. After cleaning, insert the pre-filter into the mesh filter properly and it clicks into place. Install the clean filters back into the main body, then close the dustbin flap.

Fig.E-5

HEPA Filter

1. Pull out the HEPA filter (in magnetic design) for cleaning. Do not use the appliance without first installing the HEPA filter.

Fig.E-6

2. The HEPA filter can be washed under cold running water and must be completely dry before reinstalling.

Fig.E-7

Dust Sensor

- To avoid dust accumulation which can affect cleaning performance, wipe the suction mouth with a damp cloth.

Fig.E-8

Mini Power Brush

1. Press against the roller end cover downward.

Fig.E-9

2. Pull out the brush roller.

Fig.E-10

3. Remove the debris wrapped around the roller with the Tineco Hair Cleaning Tool.

Fig.E-11

4. Fully reinsert the brush roller at an angle and push upward until it clicks securely back into place.

Fig.E-12

Brush Head

1. With the power off, slide the switch to open the brush roller end cover, and rotate it counter-clockwise to pull out the brush roller.

Fig.E-13

2. After removing the brush roller, gently clean the brush window, suction mouth and the row of plastic teeth.

Fig.E-14

3. Fully reinsert the brush roller into the brush window and the end cover can be rotated clockwise until it clicks securely back into place.



Fig.E-15

Warning:

- The power brush contains electrical components which must not be soaked or washed with water.
- Turn the power off and remove the battery before performing maintenance for the brush roller.
- To reduce the injury, do not touch the brush roller while the appliance is in working condition.

TROUBLESHOOTING

Problem	Solution
The appliance does not turn on	Charge the battery
	Restart after cooling down
	Check and remove blockages

Problem	Solution
Weak suction power	Clean the dustbin and filters
	Install the pre-filter
	Remove blockages
	Clean the brush roller
Abnormal sounds or plastic teeth tangled in brush	Pull out the brush roller and remove blockages
Suction mouth blocked	Remove the mesh filter, clean the suction mouth and dustbin
Battery won't charge	Reinsert the adaptor correctly
	Check the main body and battery are correctly placed
	Use the original adaptor
Brush roller tangled  Voice prompt: Brush roller tangled, please clean the brush	Remove blockages
Air channel blocked  Voice prompt: Air channel blocked, please clean the air channel and dustbin	Remove blockages
Dust sensor malfunction  Voice prompt: Dust sensor malfunction, please clean the dust on the inner sensor	Clean the dust on the inner sensor
	Install the dustbin correctly
Battery indicator blinking red on work	Remove the battery pack and let it cool
Battery indicator blinking red during charging	use the original adaptor
Abnormal motor sounds	Remove blockages

Note:

If the above troubleshooting guide fails to provide a solution, please visit our website www.tineco.com for further support.

WARRANTY

2-YEAR LIMITED WARRANTY

- Only applies to purchases made from authorized retailers of Tineco.
- Is subject to the adherence of the requirements outlined in this instruction manual, and is subject to further conditions outlined below.
- This warranty is governed by and construed under the laws of the country in which the purchase took place. We provide 2-year warranty or a warranty period as stipulated by applicable local law, whichever is longer.

WHAT IS COVERED?

- Your Tineco appliance has a 2-year warranty against original defects in material and workmanship, when used for private household purposes in accordance with the Tineco Instruction Manual. Motorized accessories and battery bought separately come with a 1-year warranty.
- This warranty provides, at no extra cost to you, all labor and parts necessary to ensure your appliance is in proper operating condition during the warranty period.
- This warranty will only be valid if the appliance is used in the country in which it was sold.

WHAT IS NOT COVERED?

Tineco shall not be liable for costs, damages or repairs incurred as a result of:

- Appliances purchased from an unauthorized dealer.
- Careless operation or handling, misuse, abuse and/or lack of maintenance or use not in accordance with the Tineco Instruction Manual.
- Use of the appliance other than for normal domestic purposes, e.g. for commercial or rental purposes.
- Use of parts not in accordance with the Tineco Instruction Manual.

- Use of parts and accessories other than those produced or recommended by Tineco.
- External factors unrelated to product quality and use, such as weather, modifications, accidents, electrical outages, power surges or acts of God.
- Repairs or alterations carried out by unauthorized parties or agents.
- Failing to clear blockage and other hazardous material from the appliance.
- Normal wear and tear, including normal wearing parts, such as clear bin, belt, filter, HEPA, brush bar, and power cord (or where external damage or abuse is diagnosed), carpet or floor damage due to use not in accordance with manufacturer's instructions or failure to turn the brush bar off when necessary.
- Reduction in battery discharge time due to battery age or use.

WARRANTY LIMITATIONS

- Any implied warranties relating to your appliance including but not limited to warranty of merchantability or warranty of fitness for a particular purpose, are limited to the duration of this warranty.
- Warranty coverage applies to the original owner and to the original battery only and is not transferable.
- This limited warranty gives you specific legal rights. You may also have other rights which vary by region.
- Manufacturer's warranties may not apply in all cases, depending on factors such as use of the product, where the product was purchased, or who you purchased the product from. Please review the warranty carefully, and contact the manufacturer if you have any questions.

WARRANTY SERVICE

Register:

- We highly recommend that upon purchase, you register your appliance on the Tineco official website (www.tineco.com) and enjoy exclusive benefits. To register, please enter the whole serial number (remove the battery and find it on the bottom of the main body).

Fig.F-1

- Failure to register your product won't diminish your warranty rights.

How to Claim:

- Please retain your proof of purchase. To make a claim under our Limited Warranty, you need to provide your serial number and the original purchase receipt with the purchase date and order number on it.
- All work will be carried out by Tineco or its authorized agent.
- Any replaced defective parts will become the property of Tineco.
- Service under this warranty will not extend the period of this warranty.

Contact our Customer Service
Hotline: **1-855-292-8864**
or Visit Tineco website
www.tineco.com
for expert customer service.

tineco
Live Easy.
Enjoy Life.

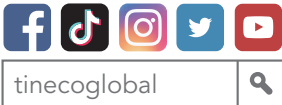

Contact us - We'll get back to you within 1 business day.

Conéctese con nosotros. Nos pondremos en contacto con usted dentro de 1 día laboral.

Contactez-nous. Nous vous répondrons dans 1 jour ouvrable.

 www.tineco.com

 1-855-292-8864

 Mon. - Fri. 9am - 6pm (CST)