

tineco

FLOOR ONE S7 STEAM SERIES Smart Cordless Steam Floor Washer

Instruction Manual

Manual De Uso

Mode D'emploi



*Actual product may differ from illustration.

TINECO IS HERE TO HELP.

We'll get back to you within 1 business day.



 www.tineco.com

 1-855-292-8864

CONTENTS

Important Safety Instructions.....	2
Specifications.....	6
Overview.....	7
Accessories.....	9
Assembly.....	10
Operation.....	11
Maintenance.....	16
Troubleshooting.....	20
Warranty.....	21

TINECO IS HERE TO HELP.

We'll get back to you within 1 business day.

 www.tineco.com

 1-855-292-8864

Important Safety Instructions

EN

SAVE THESE INSTRUCTIONS Household use only.

When using an electrical appliance, basic precautions should always be followed, including the following:

READ ALL INSTRUCTIONS BEFORE USING (THIS APPLIANCE). Failure to follow the warnings and instructions may result in electric shock, fire and/or serious injury.

WARNING – To reduce the risk of fire, electric shock, or injury:

1. This appliance can be used by children aged from 8 years and above and persons with reduced physical, sensory or mental capabilities or lack of experience and knowledge if they have been given supervision or instruction concerning use of the appliance in a safe way and understand the hazards involved. Children should not play with the appliance. Cleaning and user maintenance shall not be performed by children without supervision.
2. The appliance is not to be used by persons (including children) with reduced physical, sensory or mental capabilities, or lack of experience and knowledge, unless they have been given supervision or instruction.
3. Use only indoors, on non-carpeted floor surfaces such as vinyl, tile, sealed wood, etc. Be careful not to run over loose objects or edges of area rugs. Stalling the brush may result in premature belt failure.
4. Do not allow to be used as a toy. Close attention is necessary when used by or near children, pets or plants.
5. Use only as described in this manual. Use only manufacturer's recommended attachments.
6. Do not use with a damaged cord or plug. If appliance has been dropped, damaged, left outdoors, dropped into water, or is not working as it should, return it to a service center.
7. Do not handle charger, including charger plug, and charger terminals with wet hands.
8. Do not put any object into openings. Do not use with any opening blocked; keep free of dust, lint, hair, and anything that may reduce air flow.
9. Keep hair, loose clothing, fingers, and all parts of your body away from openings and moving parts.
10. Use extra care when cleaning on stairs.
11. Do not use to pick up flammable or combustible liquids, such as gasoline, or use in areas where they may be present.
12. Do not pick up anything that is burning or smoking, such as cigarettes, matches, or hot ashes.
13. Do not use without filter.
14. Prevent unintentional activation. Ensure the switch is in the off-position before picking up or carrying the appliance. Carrying the appliance with your finger on the switch or energizing appliance that have the switch on invites accidents.
15. Always switch off the appliance before making any adjustments, changing accessories, or storing the appliance. Such preventive safety measures reduce the risk of starting the appliance accidentally.

16. Recharge only with the charger specified by Tineco. A charger that is suitable for one type of battery pack may create a risk of fire when used with another battery pack.
17. Use appliances only with specifically designated Tineco battery packs. Use of any other battery packs may create a risk of injury and fire.
18. Under abusive conditions, liquid may be ejected from the battery; avoid contact. If contact accidentally occurs, flush with water. If liquid comes into eye contact, seek medical help. Liquid ejected from the battery may cause irritation or burns.
19. Do not use a battery pack or appliance that is damaged or modified. Damaged or modified batteries may exhibit unpredictable behavior resulting in fire, explosion or risk of injury.
20. Do not expose a battery pack or appliance to fire or excessive temperature. Exposure to fire or temperature above 266°F (130°C) may cause an explosion.
21. Follow all charging instructions and do not charge the battery pack or appliance outside of the temperature range specified in the instructions. Charging improperly or at temperatures outside of the specified range may damage the battery and increase the risk of fire.
22. Have servicing performed by a qualified repair person using only identical replacement parts. This will ensure that the safety of the product is maintained.
23. This appliance contains battery cells that are non-replaceable. Do not modify or attempt to repair the appliance or the battery pack except as indicated in the instructions for use and care.
24. Always turn off this appliance before connecting or disconnecting the motorized nozzle.
25. Do not charge or store the appliance outdoors or inside the car. Only charge, store or use the battery in a dry indoor area where the temperature is higher than 39.2°F (4°C) but lower than 104°F (40°C). The charger is for indoor use only.
26. Do not use to pick up ultrafine particles, such as lime, cement, sawdust, gypsum powder, or ashes.
27. Do not use to pick up sharp objects, such as metallic nails, pieces of glass, metal paper clips, or pins.
28. Do not use to pick up hazardous material and chemicals, such as solvent, drain cleaner, strong acids, or strong alkali.
29. Stop using immediately if the appliance is overheating, making unusual noises, producing unusual odors, performing low suction, or leaks electricity.
30. Turn cleaner OFF and disconnect from electrical outlet for long-term storage.
31. Always clean the Dirty Water Tank after each use to avoid potential blockage, which may lead to low suction power, motor overheating, or reduce the service life of the appliance.
32. Store appropriately indoors in a dry place after use.
33. Do not place or submerge appliance in standing water or try to clean flooded areas.
34. All data and technical instructions of this manual are based on results from lab tests of Tineco or designated third parties. The company reserves all rights for final explanations.
35. The plug must be removed from the socket-outlet before cleaning or maintaining the appliance.
36. A hazard may occur if the appliance runs over the supply cord.
37. Do not use the appliance when the water depth is more than 5mm above the surface.

38. Do not pull or carry by cord, use cord as a handle, close a door on cord, or pull cord around sharp edges or corners. Do not run appliance over cord. Keep cord away from heated surfaces.
39. Do not unplug by pulling on cord. To unplug, grasp the plug, not the cord.
40. Do not immerse product in water.
41. "Warning: Danger of scalding, not for Space Heating Purpose"
42. To reduce the risk of scalding, do not turn over the steam-cleaning nozzle, or touch the surface of the nozzle.
43. Only use water to refill the reservoir. Do not use any type of chemicals or additives.
44. Do not apply steam directly to any person or animal.
45. Do not touch the steam-cleaning nozzle or adjacent surfaces when steam-cleaning or when the nozzle is heated.

Range of Usage

1. The cordless hard floor cleaner is to be used on indoor hard floors, such as vinyl, tile, sealed wood, etc. Use on a rough surface may not get the best performance.
2. Keep your appliance away from heat sources, such as fireplace or heater, to avoid casing deformation.
3. Do not use to pick up flammable or combustible liquids, ultrafine particles, sharp objects, hazardous material, chemicals or anything that is burning or smoking, as described above.

About the Appliance

1. Do not modify or attempt to repair the appliance except as indicated in the instructions for operating and cleaning.
2. Charge the appliance with the Tineco adaptor. Input Voltage: AC 100-240V. Both high and low voltages can damage the adaptor, appliance, or even cause danger to the user.
3. Use extra care when cleaning on stairs.
4. Ensure that the Power Switch is in the OFF-position before picking up or carrying the appliance. Do not lay flat or lean the appliance so as to prevent dirty water from entering into the motor.
5. To avoid being tripped accidentally, please put away the appliance on the charging dock.
6. Always install the Dirty Water Tank and Clean Water Tank properly before use.
7. Do not allow the appliance or charger to get wet to avoid risk of fire or injury caused by a short circuit.

FCC Supplier's Declaration of Conformity

TINECO / FLOOR ONE S7 STEAM SERIES

This appliance complies with part 15 of the FCC Rules. Operation is subject to the following two conditions:

(1) This appliance may not cause harmful interference, and (2) this appliance must accept any interference received, including interference that may cause undesired operation.

TINECO INTELLIGENT, INC.

1700 WESTLAKE AVENUE N., SUITE 200, SEATTLE, WA, 98109, USA
WWW.TINECO.COM
1-855-292-8864

Changes or modifications not expressly approved by the party responsible for compliance could void the user's authority to operate the equipment.

NE

Note: This equipment has been tested and found to comply with the limits for a Class B digital appliance, pursuant to Part 15 of the FCC Rules. These limits are designed to provide reasonable protection against harmful interference in a residential installation.

This equipment generates uses and can radiate radio frequency energy and, if not installed and used in accordance with the instructions, may cause harmful interference to radio communications. However, there is no guarantee that interference will not occur in a particular installation. If this equipment does cause harmful interference to radio or television reception, which can be determined by turning the equipment off and on, the user is encouraged to try to correct the interference by one or more of the following measures:

- (1) Reorient or relocate the receiving antenna.
- (2) Increase the separation between the equipment and receiver.
- (3) Connect the equipment into an outlet on a circuit different from that to which the receiver is connected.
- (4) Consult the dealer or an experienced radio/TV technician for help.

FCC Radiation Exposure Statement

This equipment complies with FCC radiation exposure limits set forth for an uncontrolled environment. This equipment should be installed and operated with a minimum distance of 20cm between the radiator and any part of your body.

Note

The manufacturer is not responsible for any radio or TV interference caused by unauthorized modifications to this equipment, such modifications could void the user's authority to operate this equipment.

IC Note

This appliance contains licence-exempt transmitter(s)/receiver(s) that comply with Innovation, Science and Economic Development Canada's licence-exempt RSS(s). Operation is subject to the following two conditions:

- (1) This appliance may not cause interference.
 - (2) This appliance must accept any interference, including interference that may cause undesired operation of the appliance.
- This Class B digital apparatus complies with Canadian ICES-003.
 - This equipment complies with ISSED RSS-102 radiation exposure limits set forth for an uncontrolled environment. This equipment should be installed and operated with a minimum distance of 20cm between the radiator and any part of your body.

Specifications

EN

Product	FLOOR ONE S7 STEAM SERIES
AC Input	100-240V~
Voltage	25.2V== 3900mAh Lion
Rated Power	240W
Running Time	AUTO mode: 40mins STEAM/BOOST STEAM mode:20mins
Charging Time	4~5 hrs
Water Flow Rate	20~200ml/min
CWT Capacity	~0.8L
DWT Capacity	~0.72L
Waterproof	IPX4

- For use only with TINECO charger KL-WA300100-X, YLJX2I-T300100.

Disposal

- The battery contains materials that are harmful to the environment and must be removed from the appliance before it is discarded.
- When removing the battery, the appliance must be powered off.
- Batteries, chargers, accessories and packaging should be sorted for environmental friendly recycling. Do not put them into fire, water or soil. Do not dispose of batteries and chargers into household waste! 
- If battery leakage contacts skin or clothing, immediately flush with water to avoid irritation and seek medical help.

Overview

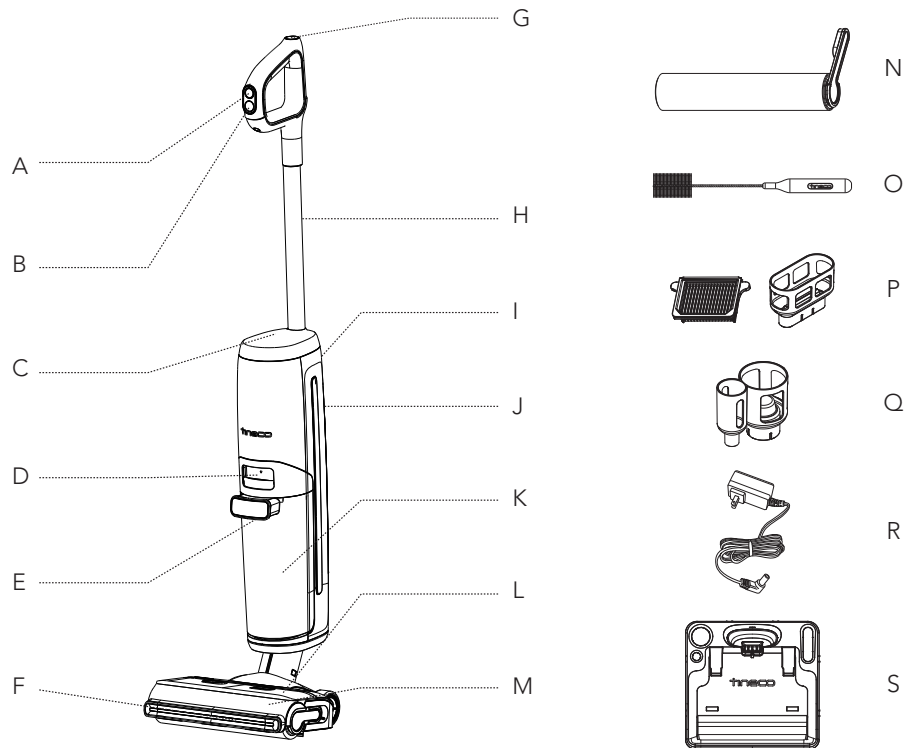

EN

- A. STEAM/BOOST STEAM Button
- B. Power On/Off
- C. Digital Display
- D. Dirty Water Tank Release
- E. Dirty Water Tank Handle
- F. LED Headlights
- G. Self-cleaning Button
- H. Tube
- I. WiFi/Mute/Language Switch Button
- J. Clean Water Tank (CWT)

- K. Dirty Water Tank (DWT)
- L. Brush
- M. Brush Roller Cover
- N. Brush Roller
- O. Cleaning Tool
- P. Dry Filter & Holder
- Q. Accessory Holder
- R. Adaptor
- S. Charging Dock

Digital Display

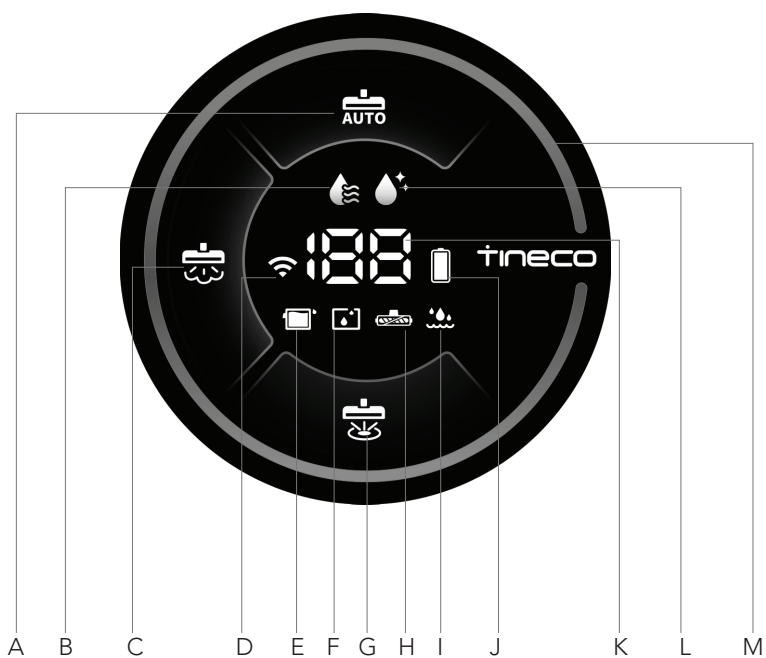

- | | |
|-------------------------|--|
| A. AUTO Mode | I. Boiler Error |
| B. Steam Making | J. Battery |
| C. STEAM Mode | K. Battery level / Steam preparation countdown |
| D. WiFi Indicator | L. Self-cleaning |
| E. DWT Full | M. Dirt Monitoring Loop (Blue to red according to the dirt amount) |
| F. CWT Empty | |
| G. BOOST STEAM Mode | |
| H. Brush Roller Tangled | |

Accessories

Note:

Accessories may vary between markets. If you require more accessories, please go to www.tineco.com or store.tineco.com.

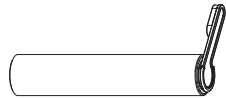

Brush Roller

Soft roller head with bristles can be used to vacuum and wash at the same time. It can be easily cleaned with the self-cleaning function.

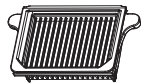

Dry Filter

Dry filter and filter net can block large particles and debris, ensure the appliance's durability.

* Please install the dry filter before use, or it may lead to weak suction.



Cleaning Tool

A full brush to clean the DWT, brush chamber and opening. The tool also has a bristled end to remove dirt and mud on the roller and DWT.

Assembly

EN

How to Assemble/Disassemble

Note:

For water tank and brush assembly, please refer to "Operation" and "Maintenance".

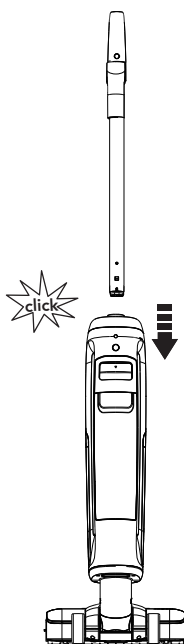

To assemble the handle, insert it into the appliance until you hear a click.

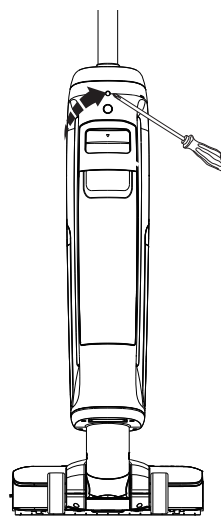

In the event that the handle needs to be disassembled, press the spring to release the handle with a tool (like a screwdriver) and lift the released handle from the appliance.

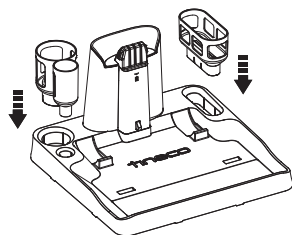

Install the dry filter holder and accessory holder on the dock.

Operation

Preparing for Use

EN

- Before first use, please charge the appliance for 4-5 hours (refer to "Charging Instructions" for details).
* Based on results from Tineco lab tests. Lab temperature 39.2°F (4°C) ~ 104°F (40°C).

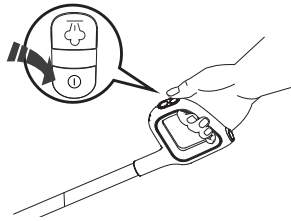

Press the ① button the appliance will start in AUTO mode by default, then press ② button to switch to STEAM mode, BOOST STEAM mode or AUTO mode. Press the ① again to turn off the appliance after cleaning is complete.

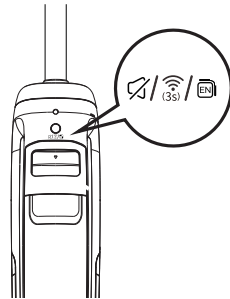

WiFi/Mute/Language Switch Button

- Press to turn on/off the voice prompt.
- Press twice to switch languages. (More voice language options will be added, please refer to the actual product.)
- Hold for 3 seconds to connect to network.

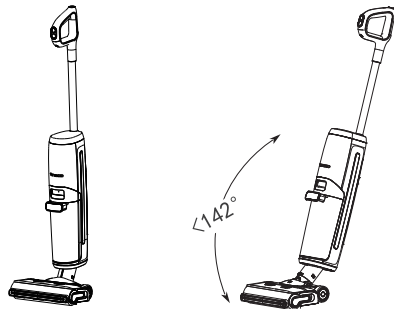

The appliance will stop working when put upright and start running again when reclined.

* Do not recline more than 142° to avoid water leakage.

Note:

- Selection of the appropriate mode depends on the actual demand.
- Do not vacuum foamed liquid.
- To vacuum water left on the surface, the appliance will keep running for 3 seconds after power off.

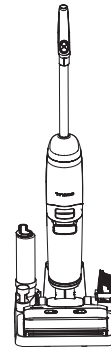

Place the appliance on the charging dock vertically after use for charging and storing.

Filling Clean Water Tank

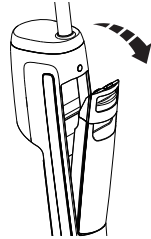

Press the Clean Water Tank release button to remove it from the appliance.

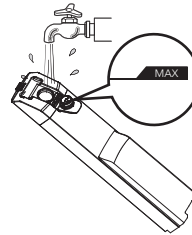

Open the tank cap, and then fill the tank with tap water to the Max line.

Note:

**Only use water under 140°F/60°C, don't mix chemical solution.
DO NOT USE HOT WATER.**

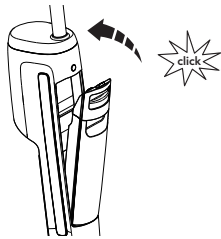

Place the tank back into the appliance. You should hear a "click" sound if done correctly.

Charging Instructions

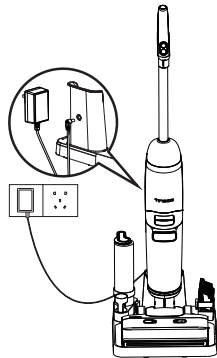

To charge the appliance, place the appliance on the charging dock and plug the adaptor into a power outlet.

1. To charge the appliance, connect the external charging cord to the charging dock and plug it into the wall outlet.
2. To avoid tripping hazards, please place the appliance on the charging dock near a wall during charging.

Warning:

- Only charge the appliance with the adaptor supplied by Tineco.
- In case of long-term non use, the appliance must be charged once every 3 months for optimal performance. It may take 4-5 hours for a full charge.
- Store indoors in a dry place. Do not expose the appliance to sunlight or freezing temperatures. Recommended temperature range: 39.2°F (4°C) ~ 104°F (40°C).

Cleaning Mode Selection

AUTO Mode



- In AUTO mode, the iLoop sensor automatically detects how dirty the floor is and applies the appropriate amount of clean water and suction power accordingly.
- A red dirt monitoring loop indicates pollutant intensive area, and a blue loop indicates less pollutants are detected. This mode automatically applies the best cleaning solution.

STEAM Mode



- Press  button to enter into STEAM mode. It will take 20-50s to prepare steam. And there will be 6 holes to spray steaming. Apply STEAM Mode when deep cleaning is needed.

BOOST STEAM Mode



- Press  button to enter into BOOST STEAM mode. It will take 20-50s to prepare steam. And there will be 2 holes to spray steaming. Apply BOOST STEAM mode when cleaning for heavy-polluted area is needed.

SUCTION Mode



- With wifi connected, open the APP and select the SUCTION mode on APP, the appliance will enter into SUCTION mode.
- In SUCTION mode, the appliance will absorb water. We recommend using this mode on wet surfaces.

Note:

Keep sharp objects away from the digital display screen to avoid scratches and scrapes.

Runtime

- In AUTO mode: ~40 minutes
- In STEAM / BOOST mode: ~20 minutes
- Estimated runtime data was obtained by a Tineco Laboratory.

Charging Time

- A full charge takes approximately 4-5 hours.
- Estimated data was obtained by Tineco Laboratory under ambient temperatures between 39.2°F (4°C) to 104°F (40°C).

App

All the functions can be performed using Tineco App. Download the app from App Store, Google Play and Tineco Official Site.

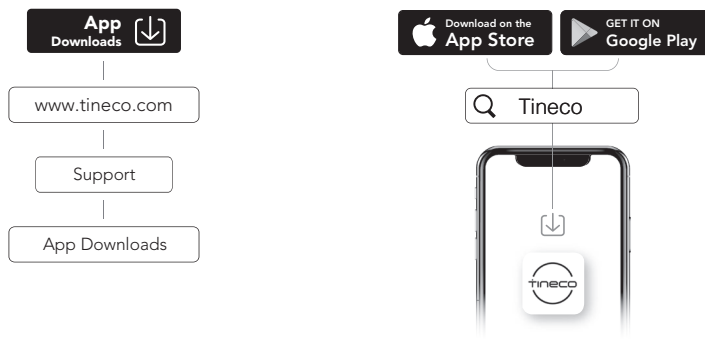

Note:

The default language for voice prompt is English, you can set other languages via App.

Voice Prompt (Contents may vary, please in kind prevail.)

Status	Reminder
Voice prompts on	Voice prompts enabled.
Voice prompts off	Voice prompts disabled.
Connect Tineco app	Download Tineco app and connect with appliance.
Turn on the appliance	Auto mode.
Switch to Steam mode	Steaming Mode.
Switch to Boost Steam mode	Boost Steaming Mode.
First time to start the Steam mode/Boost steam mode	Steam preparation for the first time is relatively long, please wait.
Press the STEAM/BOOST STEAM mode button	Start preparing the steam.
Steam is ready for use	Steam is ready for use.
Clean Water Tank is empty	Insufficient water in the Clean Water Tank. Please add water.
Dirty Water Tank is full	Dirty Water Tank is full.Please empty and clean the Dirty Water Tank.
Need self-cleaning after decting	Please turn on self-cleaning function to ensure effective cleaning.
After self-cleaning	Self-cleaning complete.Please empty and clean the Dirty Water Tank and the Pipe underneath it to prevent odors.
Battery level 10%~20%	Battery low.
Battery level 0%~10%	Battery low. Please charge the appliance.
Turn off the appliance	Powered off. Place appliance on charging dock.
Ready for charging	Charging.
Clean Water Tank is empty during the appliance working	Insufficient water in the Clean Water Tank,turned into AUTO mode.
Clean water tank is empty during Steam/Boost steam mode	Insufficient water in the Clean Water Tank, unable to make steam.
Dirt water tank is uninstalled	Please install the dirty water tank.
Brush cover is uninstalled	Please install the brush roller cover correctly.
When Motor, pump or battery goes wrong	Error! Please contact customer service.
Select Suction mode on APP	Suction Mode.
Detect it is dirty during the appliance works	To optimize cleaning performance, please perform self-clean cycle.
User press the self-cleaning button when the appliance is dormant	Please place appliance on the charging dock to begin self-cleaning.

Maintenance

EN

Note:

- For optimal performance and odor avoidance, always **clean** and **dry** DWT, filters, brush roller, brush roller cover **completely** after each use.
- Please make sure each part is installed correctly or the appliance may not work properly.
- Do not soak the appliance.
- Some water may remain in the appliance due to factory inspection.
- After maintenance, place the appliance on the charging dock vertically. Do not expose the appliance to direct sunlight, store it indoors in a dry place.

Main Body

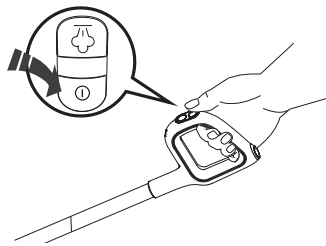

To reduce the risk of injury, switch off before performing maintenance.

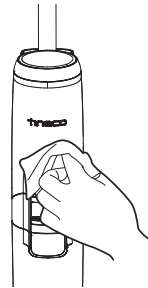

Use a cloth to clean the surface with neutral detergent. The cloth should be dry to prevent water from entering the appliance.

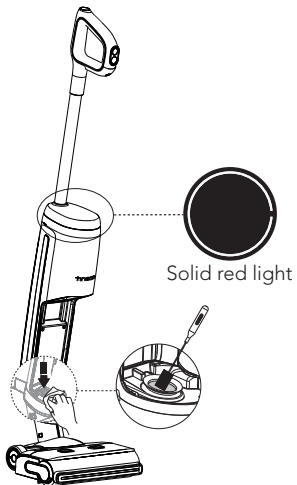

When iLOOP illuminates red, remove Dirty Water Tank, clean the dirt sensor with a damp cloth or the cleaning tool.

Dirty Water Tank

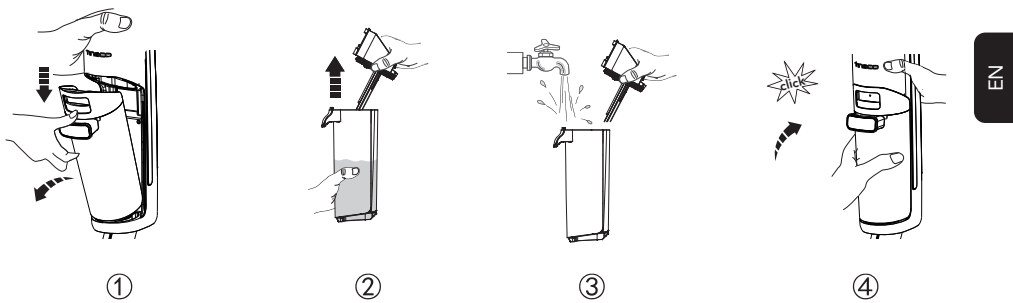

- When dirty water reaches the Max line, the appliance then stops working, shows a remainder on the display and plays a voice prompt.
- Pull up the tank lid to empty the DWT. Use the cleaning tool to remove remaining debris. Rinse the inside of the DWT and then place back into the appliance.

Dirty Water Tank Lid

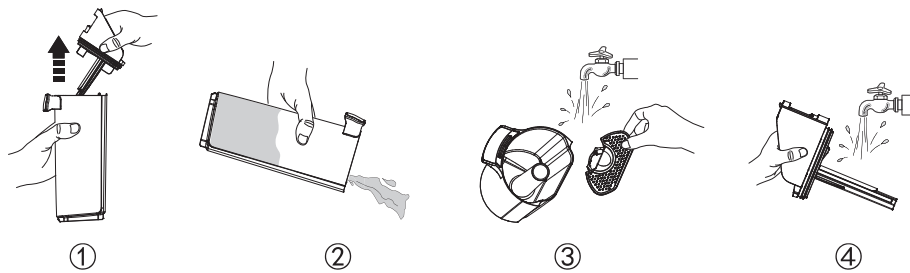

If the Dirty Water Tank lid and the filter inside are blocked, remove the tank lid and the filter, rinse both parts with water.

Dry Filter



Grasp recessed area on each side of the dry filter and pull upward. Rinse the filter under running water and it must be completely dry before recombining with the DWT lid.

*A spare dry filter is provided with your appliance for convenient replacement.

Self-cleaning

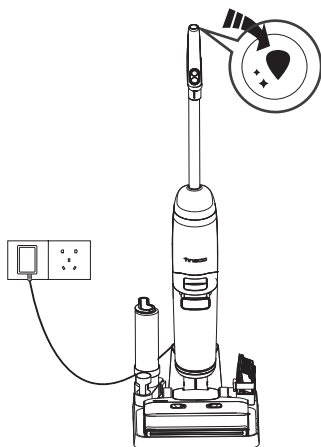

1. Place the appliance on the charging dock after use, the sensor will auto-detect the level of dirt.
2. Press the self-cleaning button, and the appliance will select the self-cleaning mode based on the actual battery level for self-cleaning.
3. Once complete, please clean the Dirty Water Tank. And the appliance will begin charging.

Note:

- Ensure the charging dock is plugged under Self-cleaning mode:
- When battery level < 10%, press the Self cleaning button, charging instead of self-cleaning will be activated first.
- When battery level > 10%, press the Self-cleaning button, self-cleaning with normal water temperature will be activated.
- When battery level > 20%, press the Self cleaning button, self-cleaning with steam will be activated.
- Before self-cleaning cycle, please clean the DWT and ensure the water level in the CWT > 40%.

Brush Roller Cover

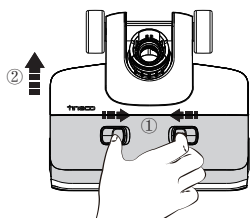

Squeeze latches on the cover and pull upward to remove.

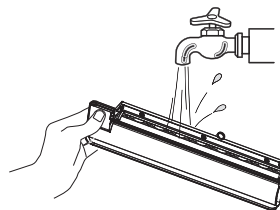

Rinse with water.

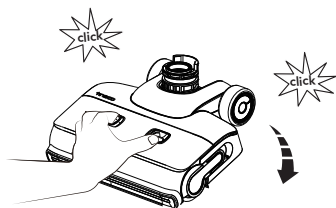

While replacing, always latch the brush cover into place to avoid leakage.

Brush Roller

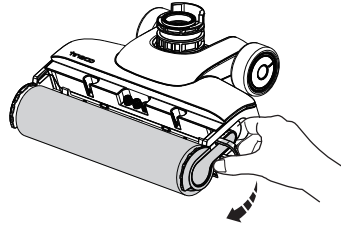

Remove the brush roller by grabbing the brush roller tab and pulling out.

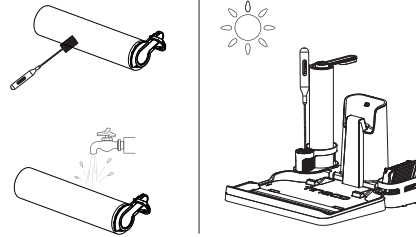

Use the cleaning tool to remove hair and debris wrapped around the roller and rinse the roller with water. Put the brush roller back into the accessory holder, and allow it to dry completely before reinstalling.

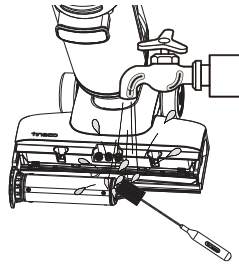

Wash and remove hair and debris from the brush roller chamber with water and cleaning tool.

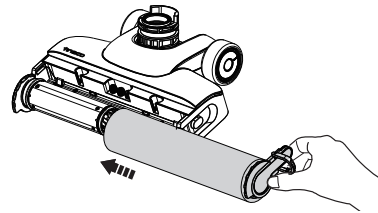

Replace the brush roller by inserting its end into the left side of the holder, then attach the roller tab to the magnetic buckle on the right side to lock into place.











Note:

- A spare brush roller is provided with your appliance for convenient replacement.
- To maintain optimal performance, replace the brush roller every 8 months.

SCAN THE QR CODE BELOW TO
GET PRODUCT CARE VIDEOS.



Troubleshooting

Problem	Possible cause	Solution
The appliance does not turn on	1. No power 2. Auto protection for overheating	1. Charge the appliance 2. Restart after cooling down
Weak suction	The dry filter is not installed, or the dry filter is dirty	Install the dry filter or clean and allow it to dry completely
Brush roller tangled indicator blinking  Voice prompt: 1. Please install the brush roller correctly. 2. Please check the brush roller. 3. Please install the brush roller cover correctly.	 1. The brush roller is blocked 2. The brush roller is not installed 3. Brush roller cover is not installed correctly	1. Remove blockages 2. Install the brush roller correctly 3. Install the brush roller cover correctly
WiFi indicator is off	WiFi is not connected	Follow the in-app guide to connect to WiFi
CWT empty indicator blinking  Voice prompt 1. Insufficient water in the Clean Water Tank, turned into AUTO mode. 2. Insufficient water in the Clean Water Tank, unable to make steam.	 CWT is empty	Refill CWT
DWT full indicator blinking  Voice prompt Dirty Water Tank is full. Please empty and clean the Dirty Water Tank.	 The dirty water in DWT has reached the MAX line	Empty the dirty water and then reinstall the DWT
Boiler error indicator blinking  Voice prompt: Boiler error, please restart the appliance.	 Boiler error	Restart the appliance
All lights off in operation	Battery overheat or malfunction	Cool the appliance down and restart
Battery level < 10%  Voice prompt: Battery low. Please charge the appliance.	Low power	Charge the appliance, or restart
iLoop illuminates red  Voice prompt: Clean the dirty water tank or the debris channel.	Dirt sensor malfunction or blocked	Remove blockages, clean the debris channel, or restart

Note:

If the above troubleshooting guide fails to help, please visit our website www.tineco.com for further support.

Warranty

2-YEAR LIMITED WARRANTY

- Only applies to purchases made from authorized retailers of Tineco.
- Is subject to the adherence of the requirements outlined in this instruction manual, and is subject to further conditions outlined below.
- This warranty is governed by and construed under the laws of the country in which the purchase took place. We provide 2-year warranty or a warranty period as stipulated by applicable local laws, whichever is longer.

NE

WHAT IS COVERED?

- Your Tineco appliance has a 2-year warranty against original defects in material and workmanship, when used for private household purposes in accordance with the Tineco Instruction Manual. Motorized accessories and battery bought separately come with a 1-year warranty.
- This warranty provides, at no extra cost to you, all labor and parts necessary to ensure your appliance is in proper operating condition during the warranty period.
- This warranty will only be valid if the appliance is used in the country in which it was sold.

WHAT IS NOT COVERED?

Tineco shall not be liable for costs, damages or repairs incurred as a result of:

- Appliances purchased from an unauthorized dealer.
- Careless operation or handling, misuse, abuse and/or lack of maintenance or use not in accordance with the Tineco Instruction Manual.
- Use of the appliance other than for normal domestic purposes, e.g. for commercial or rental purposes.
- Use of parts not in accordance with the Tineco Instruction Manual.
- Use of parts and accessories other than those produced or recommended by Tineco.
- External factors unrelated to product quality and use, such as weather, modifications, accidents, electrical outages, power surges or acts of God.
- Repairs or alterations carried out by unauthorized parties or agents.
- Failing to clear blockage and other hazardous material from the appliance.
- Normal wear and tear, including normal wearing parts, such as cleaning bin, belt, filter, HEPA, brush bar, and power cord (or where external damage or abuse is diagnosed), carpet or floor damage due to use not in accordance with manufacturer's instructions or failure to turn the brush bar off when necessary.
- Reduction in battery discharge time due to battery aging or use.

WARRANTY LIMITATIONS

- Any implied warranties relating to your appliance including but not limited to warranty of merchantability or warranty of fitness for a particular purpose, are limited to the duration of this warranty.
- Warranty coverage applies to the original owner and to the original battery only and is not transferable.
- This limited warranty gives you specific legal rights. You may also have other rights which vary by region.
- Manufacturer's warranties may not apply in all cases, depending on factors such as use of the product, where the product was purchased, or who you purchased the product from. Please review the warranty carefully, and contact the manufacturer if you have any questions.

WARRANTY SERVICE

Register: We highly recommend that upon purchase, you register your appliance by logging into our official website (www.tineco.com) or scanning the QR code (see right) to enjoy more exclusive benefits. To register, please enter the whole serial number (on the back of the appliance). Failure to register your product won't diminish your warranty rights.

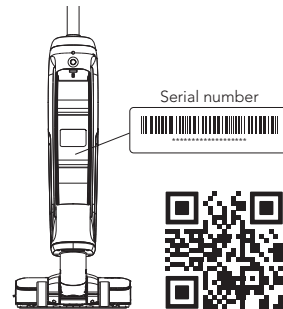

How to Claim: Please retain your proof of purchase. To make a claim under our Limited Warranty, you need to provide your serial number and the original purchase receipt with purchase date and order number on it.

All work will be carried out by Tineco or its authorized agency.

Any replaced defective parts will be retrieved Tineco.

Service under this warranty will not extend the period of this warranty.

Contact our Customer Service
Hotline: **1-855-292-8864**
or Visit Tineco website
www.tineco.com
for expert customer service.

CONTENIDO

Medidas importantes de seguridad	24
Especificaciones.....	29
Descripción general	30
Accesorios	32
Montaje	33
Funcionamiento.....	34
Mantenimiento	39
Resolución de problemas	43
Garantía.....	44

TINECO ESTÁ AQUÍ PARA AYUDAR.

Nos pondremos en contacto con usted dentro de 1 día laboral.

 www.tineco.com

 1-855-292-8864

Medidas importantes de seguridad

CONSERVE ESTAS INSTRUCCIONES

Solo para uso doméstico.

ES

Al usar aparatos eléctricos, se debe seguir siempre una serie de medidas básicas de seguridad, entre ellas las que se indican a continuación.

LEA TODAS LAS INSTRUCCIONES ANTES DE USAR ESTE APARATO. De no seguir todas las advertencias e instrucciones, se podrían producir descargas eléctricas, incendios o lesiones personales graves.

ADVERTENCIA – Para disminuir el riesgo de incendios, descargas eléctricas o lesiones:

1. Este aparato puede ser utilizado por niños a partir de 8 años y personas con discapacidades físicas, sensoriales o mentales, o con falta de experiencia y conocimientos, si están supervisados o han recibido instrucciones sobre el uso del aparato de modo seguro y comprenden los peligros que dicho uso acarrea. Los niños no deben jugar con el aparato. La limpieza y mantenimiento a cargo del usuario no deben ser realizados por niños sin supervisión.
2. El aparato no debe ser utilizado por personas (niños incluidos) con discapacidades físicas, sensoriales o mentales, o con falta de experiencia y conocimientos, a menos que lo hagan bajo supervisión o se les haya dado instrucciones.
3. Use el aparato únicamente en interiores, sobre superficies de suelo sin alfombras como vinilo, azulejos, madera barnizada, etc. Tenga cuidado de no pasar por encima de objetos sueltos ni bordes de alfombras. Si el cepillo se atasca, puede producirse un fallo prematuro de la correa.
4. No permita que se utilice el aparato como un juguete. Es necesario vigilar atentamente el aparato cuando lo usen niños o se utilice cerca de niños, mascotas o plantas.
5. Use el aparato solo como se indica en este manual. Use solo accesorios recomendados por el fabricante.
6. No use el aparato si el cable o el enchufe están dañados. Si el aparato se ha caído o dañado, se ha dejado a la intemperie, ha caído al agua o no funciona como debiera, llévelo a un centro de servicio.
7. No manipule el cargador, incluido el enchufe del cargador, ni los terminales del cargador con las manos mojadas.
8. No introduzca ningún objeto en las aberturas. No use el aparato si alguna de sus aberturas está obstruida. Manténgalo libre de polvo, fibras, pelo y cualquier elemento que pudiera reducir el flujo de aire.
9. Mantenga el pelo, la ropa holgada, los dedos y todas las partes del cuerpo alejados de las aberturas y partes móviles.
10. Tenga mucho cuidado al limpiar escaleras.
11. No aspire líquidos inflamables o combustibles, tales como gasolina, ni lo use en lugares donde pudieran estar presentes.
12. No aspire nada que se esté quemando o humeando como, por ejemplo, cigarrillos, cerillas o cenizas.
13. No use el aparato sin el filtro.

14. Evite puestas en marcha accidentales. Verifique que el interruptor está en posición de apagado antes de tomar el aparato o desplazarlo. Llevar el aparato con el dedo en el interruptor o activar el aparato que tiene el interruptor en posición de encendido puede originar accidentes.
15. Apague siempre el aparato antes de realizar ajustes, cambiar accesorios o almacenarlo. Tales medidas preventivas disminuyen el riesgo de poner el aparato en funcionamiento por accidente.
16. Recargue el aparato únicamente con el cargador especificado por Tineco. Un cargador apto para un tipo de batería podría presentar un riesgo de incendio si se usa con otra batería.
17. Use los aparatos solo con las baterías Tineco especialmente indicadas para ellos. El uso de cualquier otro tipo de batería puede presentar riesgos de incendio y lesiones personales.
18. Si se hace un mal uso de la batería, el líquido de su interior podría salirse. Evite el contacto con ese líquido. Si hubiera un contacto accidental, lávese con agua abundante. Si el líquido entra en contacto con los ojos, solicite ayuda médica. El líquido que sale de la batería puede causar irritación o quemaduras.
19. No use la batería ni el aparato si estuvieran dañados o modificados. Las baterías dañadas o modificadas pueden presentar comportamientos impredecibles y causar un incendio, explosión o riesgo de lesiones personales.
20. No exponga la batería ni el aparato al fuego o al calor excesivo. Su exposición al fuego o a temperaturas superiores a 130 °C puede causar una explosión.
21. Siga todas las instrucciones de carga y no cargue la batería ni el aparato a temperaturas fuera del rango especificado en las instrucciones. Una carga incorrecta o a una temperatura fuera del rango especificado puede dañar la batería y aumentar el riesgo de que se produzca un incendio.
22. Las reparaciones deben ser realizadas por personal cualificado que utilice únicamente piezas de repuesto idénticas a las originales. Esto garantizará que la seguridad del producto se mantenga.
23. Este aparato contiene células de batería no reemplazables. No modifique ni trate de reparar el aparato ni la batería, a excepción de lo indicado en las instrucciones para su uso y cuidados.
24. Apague siempre el aparato antes de conectar o desconectar la boquilla motorizada.
25. No cargue ni guarde el aparato a la intemperie ni dentro de un vehículo. Cargue, guarde o use la batería únicamente en interiores secos donde la temperatura sea superior a 4 °C, pero inferior a 40 °C. El cargador solo es apto para usarse en interiores.
26. No utilice el aparato para recoger partículas ultrafinas, como cal, cemento, serrín, yeso en polvo o cenizas.
27. No utilice el aparato para recoger objetos afilados, como clavos metálicos, trozos de cristal, clips metálicos o alfileres.
28. No utilice el aparato para recoger sustancias químicas y materiales peligrosos, como disolventes, limpiadores de desagües, ácidos fuertes o álcali fuertes.
29. Deje de utilizar el aparato inmediatamente si se sobrecalienta, hace ruidos inusuales, produce olores inusuales, la succión es baja o gotea electricidad.
30. Apague el limpiador y desconéctelo de la toma de corriente para almacenarlo durante un tiempo prolongado.

31. Limpie siempre el depósito de agua sucia después de cada uso para evitar posibles obstrucciones que pudieran provocar una baja potencia de succión, sobrecalentamiento del motor o reducir la vida útil del aparato.
32. Después del uso, guarde el aparato adecuadamente en lugar seco en interiores.
33. No coloque ni sumerja el aparato en agua estancada ni intente limpiar zonas inundadas.
34. Todos los datos e instrucciones técnicas de este manual se basan en resultados de pruebas de laboratorio de Tineco o de terceros designados. La empresa se reserva todos los derechos de explicaciones finales.
35. Se debe desconectar el enchufe de la toma antes de limpiar o realizar el mantenimiento del aparato.
36. Podría presentarse un peligro si el aparato pisa el cable eléctrico.
37. No utilice el aparato si la profundidad del agua es superior a 5 mm por encima de la superficie.
38. No estire ni lo transporte por el cable, ni utilice el cable como asa, no cierre puertas sobre el cable ni lo haga pasar por bordes o esquinas afilados. No coloque aparatos sobre el cable. Mantenga el cable apartado de las superficies calientes.
39. No estire del cable para desenchufar el aparato. Agarre del enchufe, no el cable.
40. No sumerja el producto en agua.
41. "Advertencia: Peligro de quemaduras, no utilizar para calentar espacios"
42. Para reducir el riesgo de quemaduras, no gire la boquilla de limpieza a vapor ni toque la superficie de la boquilla.
43. Utilice únicamente agua para rellenar el depósito. No utilice ningún tipo de químicos ni aditivos.
44. No aplique vapor directamente a ninguna persona ni animal.
45. No toque la boquilla de limpieza a vapor ni las superficies adyacentes cuando limpie con vapor o cuando la boquilla esté caliente.

Ámbito de empleo

1. El limpiador inalámbrico para suelos duros se debe utilizar en suelos duros interiores, como vinilo, azulejos, madera barnizada, etc. Puede que su uso en superficies rugosas no dé resultados óptimos.
2. Mantenga el aparato alejado de fuentes de calor, como chimeneas o radiadores, para evitar la deformación de la carcasa.
3. No utilice el aparato para recoger líquidos inflamables o combustibles, partículas ultrafinas, objetos afilados, materiales peligrosos, productos químicos o cualquier elemento que esté ardiendo o emita humo, tal como se ha descrito anteriormente.

Acerca del aparato

1. No modifique ni trate de reparar el aparato, a excepción de lo indicado en las instrucciones para su uso y limpieza.
2. Cargue el aparato con el adaptador Tineco. Tensión de entrada: 100-240 V CA. Las tensiones altas y bajas pueden dañar el adaptador, el aparato o incluso poner en peligro al usuario.
3. Tenga mucho cuidado al limpiar escaleras.

4. Verifique que el interruptor de encendido está en posición de apagado antes de tomar el aparato o desplazarlo. No deje el aparato tumbado ni inclinado para evitar que entre agua sucia en el motor.
5. Para evitar que la activación accidental del aparato, colóquelo en la base de carga.
6. Instale siempre correctamente el depósito de agua sucia y el depósito de agua limpia antes del uso.
7. Evite que el aparato o el cargador se mojen para evitar el riesgo de incendio o lesiones por cortocircuito.

Declaración de conformidad de la FCC del proveedor

TINECO / SERIE FLOOR ONE S7 STEAM

Este dispositivo cumple las disposiciones de la sección 15 de la normativa de la FCC. Su funcionamiento está sujeto a las dos condiciones siguientes:

(1) el dispositivo no puede causar interferencias perjudiciales; y (2) el dispositivo debe aceptar cualquier interferencia recibida, incluidas las que puedan dar lugar a un funcionamiento no deseado.

TINECO INTELLIGENT, INC.

1700 WESTLAKE AVENUE N., SUITE 200, SEATTLE, WA, 98109, EE. UU.

WWW.TINECO.COM

1-855-292-8864

Los cambios o modificaciones no aprobados expresamente por la parte responsable del cumplimiento pueden anular la autoridad del usuario para utilizar el equipo.

Nota: Este equipo se ha sometido a pruebas y se ha determinado que cumple los límites establecidos para los dispositivos digitales de clase B de acuerdo con las disposiciones de la sección 15 de la normativa de la FCC. Estos límites están diseñados para proporcionar una protección razonable contra interferencias perjudiciales en una instalación residencial.

Este equipo genera, utiliza y puede irradiar energía de radiofrecuencia, por lo que si no se instala y se usa como se indica en estas instrucciones, podría producir interferencias perjudiciales en las comunicaciones por radio. Sin embargo, no se puede garantizar que no se produzcan interferencias en una instalación en particular. Si este equipo causa interferencias perjudiciales en la recepción de señales de radio o televisión (que se pueden detectar apagando y encendiendo el dispositivo), recomendamos al usuario que intente corregir dichas interferencias siguiendo una o varias de las siguientes soluciones:

- (1) Cambie la orientación o la ubicación de la antena receptora.
- (2) Aumente la distancia entre el equipo y el receptor.
- (3) Conecte el equipo a una toma de corriente de un circuito diferente al que esté conectado el receptor.
- (4) Consulte al vendedor o a un técnico experto en radio y televisión para obtener ayuda.

Declaración de exposición a la radiación de la FCC

Este equipo cumple con los límites de exposición a la radiación establecidos por la FCC para un entorno no controlado. Este equipo debe instalarse y utilizarse a una distancia mínima de 20 cm entre el radiador y las partes del cuerpo.

ES

Nota

El fabricante no se hace responsable de las interferencias de radio o televisión provocadas por modificaciones no autorizadas en este equipo. Dichas modificaciones podrían anular la autoridad del usuario para utilizar este equipo.

Nota de IC

Este aparato contiene transmisor(es)/receptor(es) sin licencia conformes a las normas RSS sin licencia de Innovation, Science and Economic Development Canada. Su funcionamiento está sujeto a las dos condiciones siguientes:

- (1) el aparato no puede causar interferencias; y
 - (2) el dispositivo debe aceptar cualquier interferencia, incluidas las que puedan dar lugar a un funcionamiento no deseado del aparato.
- Este aparato digital de clase B cumple con la normativa canadiense ICES-003.
 - Este equipo cumple con los límites de exposición a la radiación establecidos por la ISED RSS-102 para un entorno no controlado. Este equipo debe instalarse y utilizarse a una distancia mínima de 20 cm entre el radiador y las partes del cuerpo.

Especificaciones

Producto	SERIE FLOOR ONE S7 STEAM
Entrada CA	100-240 V~
Tensión	25,2 V== 3900 mAh de iones de litio
Potencia nominal	240 W
Tiempo de funcionamiento	Modo AUTO: 40 min Modo VAPOR/VAPOR POTENCIADO: 20 min
Tiempo de carga	4~5 h
Caudal de agua	20-200 ml/min
Capacidad del DAL	aprox. 0,8 l
Capacidad del DAS	aprox. 0,72 l
Resistente al agua	IPX4

ES

- Para usar solo con el cargador TINECO KL-WA300100-X, YLJX2I-T300100.

Eliminación

- La batería contiene materiales dañinos para el medio ambiente y deben retirarse del aparato antes de desecharlo.
- Al retirar la batería, el aparato debe estar apagado.
- Las baterías, los cargadores, los accesorios y el embalaje deben clasificarse para reciclarlos de un modo respetuoso con el medio ambiente. No los arroje al fuego, al agua ni los entierre. No deseche las baterías ni los cargadores junto con la basura doméstica. ~~X~~
- Si la batería presenta fugas y el líquido entra en contacto con la piel o la ropa, enjuáguelos inmediatamente con agua para evitar irritaciones y consulte con un médico.

Descripción general

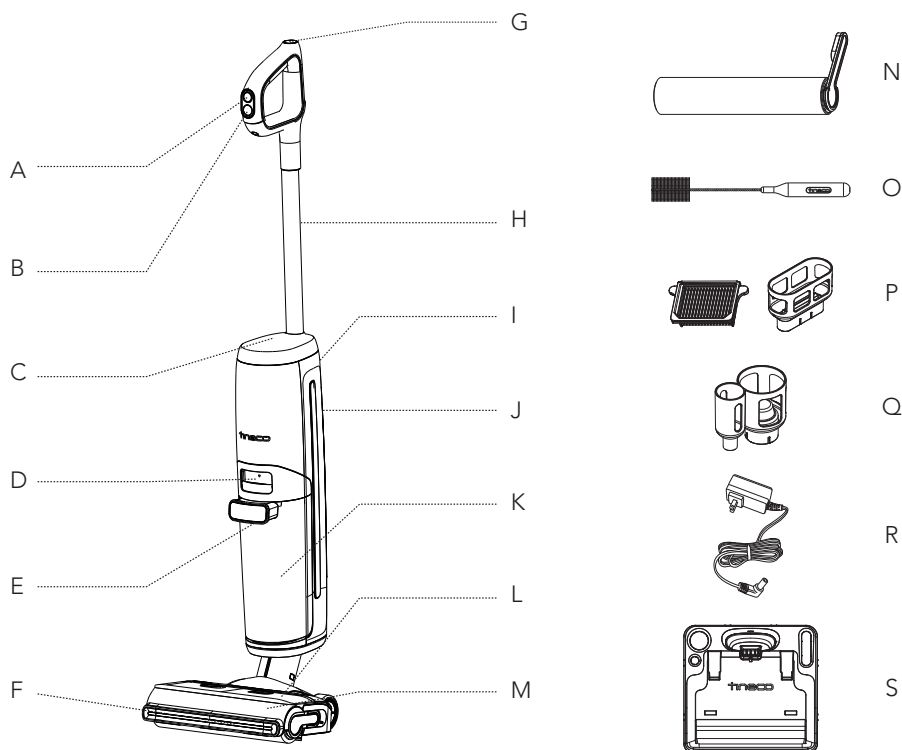

- | | |
|---|------------------------------------|
| A. Botón VAPOR/VAPOR POTENCIADO | J. Depósito de agua limpia (DAL) |
| B. Encendido/apagado | K. Depósito de agua sucia (DAS) |
| C. Pantalla digital | L. Cepillo |
| D. Liberación del depósito de agua sucia | M. Cubierta del cepillo de rodillo |
| E. Asa del depósito de agua sucia | N. Cepillo de rodillo |
| F. Luces LED | O. Herramienta de limpieza |
| G. Botón de autolimpieza | P. Filtro seco y soporte |
| H. Tubo | Q. Soporte de accesorios |
| I. Botón de Wi-Fi/Silencio/Cambio de idioma | R. Adaptador |
| | S. Base de carga |

Pantalla digital

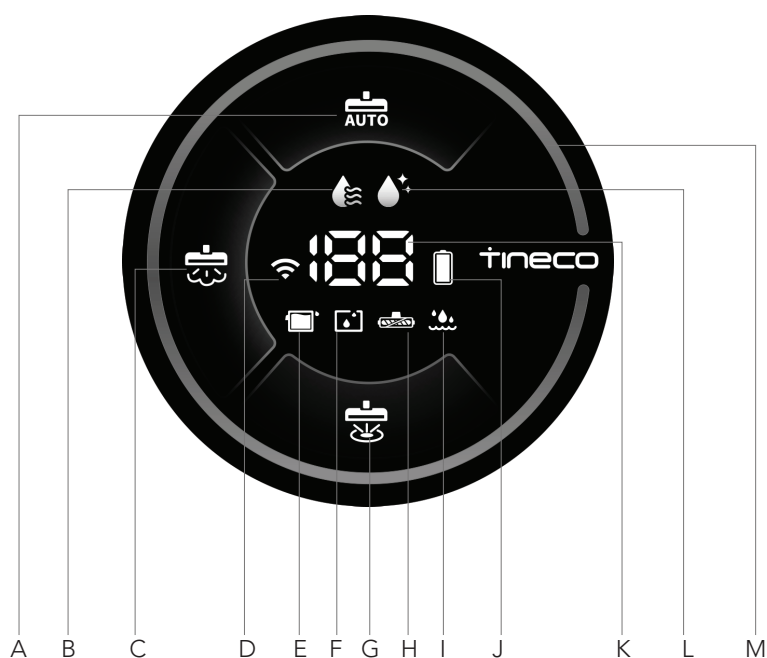

ES

- A. Modo AUTO
- B. Producción de vapor
- C. Modo de VAPOR
- D. Indicador de Wi-Fi
- E. DAS lleno
- F. DAL vacío
- G. Modo VAPOR POTENCIADO
- H. Cepillo de rodillo enredado
- I. Error de caldera
- J. Batería
- K. Nivel de batería/Cuenta atrás de preparación de vapor
- L. Autolimpieza
- M. Bucle de la monitorización de suciedad (azul o rojo según la cantidad de suciedad)

Accesorios

Nota:

Los accesorios pueden variar según el mercado. Si necesita más accesorios, visite www.tineco.com o store.tineco.com.

ES

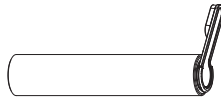

Cepillo de rodillo

El suave cabezal de rodillo con cerdas se puede utilizar para aspirar y lavar al mismo tiempo. Se puede limpiar fácilmente con la función de autolimpieza.

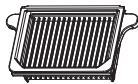

Filtro seco

El filtro seco y la red del filtro pueden bloquear partículas grandes y restos para garantizar la durabilidad del aparato.

* Instale el filtro seco antes de usar el aparato, de lo contrario, podría producirse una succión débil.



Herramienta de limpieza

Un cepillo completo para limpiar el DAS, la cámara del cepillo y la abertura.

La herramienta también tiene un extremo de cerdas para eliminar la suciedad y el barro del rodillo y del DAS.

Montaje

Montaje/desmontaje

Nota:

Para obtener información sobre el conjunto del cepillo y el depósito de agua, consulte los apartados de "Funcionamiento" y "Mantenimiento".

ES

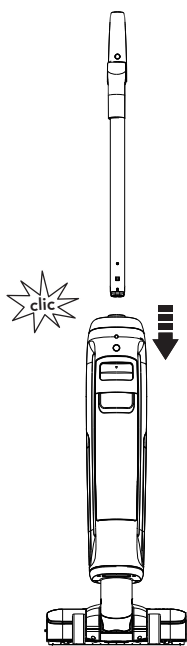

Para montar el asa, insértela en el aparato hasta que oiga un chasquido.

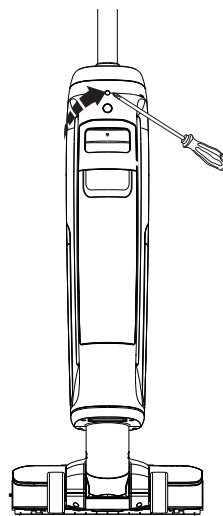

En caso de que se deba desmontar el asa, presione el resorte para liberar el asa con una herramienta (por ejemplo, un destornillador) y separe el asa del aparato una vez liberada.

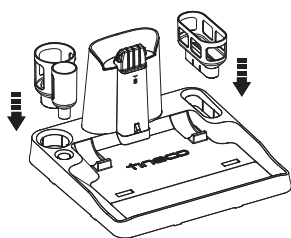

Instale el soporte del filtro seco y el soporte de accesorios en la base.

Funcionamiento

Preparación para el uso

- Antes de utilizar el aparato por primera vez, cárguelo de 4-5 horas (consulte "Instrucciones de carga" para obtener más información).

* Basado en los resultados de las pruebas de laboratorio de Tineco. Temperatura de laboratorio: 4 °C-40 °C.

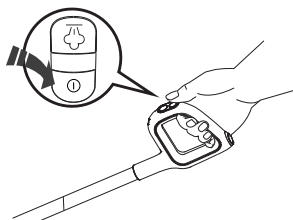

Al pulsar el botón ① el aparato arrancará en modo AUTO por defecto, después pulse el botón ② para cambiar a modo VAPOR, modo VAPOR POTENCIADO o modo AUTO. Pulse de nuevo ① para apagar el aparato una vez finalizada la limpieza.

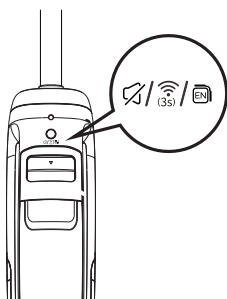

Botón de Wi-Fi/Silencio/Cambio de idioma

- Pulse para activar/desactivar las indicaciones de voz.
- Pulse dos veces para cambiar de idioma. (Se añadirán más idiomas, consulte el producto real).
- Mantenga pulsado durante 3 segundos para conectar a la red.

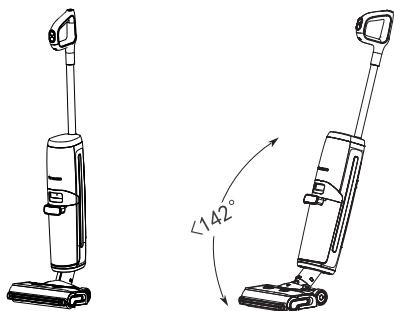

El aparato dejará de funcionar cuando se coloque en posición vertical y volverá a funcionar cuando se recline.

* No incline el aparato más de 142° para evitar fugas de agua.

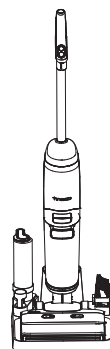

Después del uso, coloque el aparato en la base de carga en vertical para cargarlo y guardarlo.

Nota:

- La selección del modo apropiado depende de la demanda real.
- No aspire líquidos con espuma.
- Para aspirar el agua que queda en la superficie, el aparato seguirá funcionando 3 segundos después de la desconexión.