

tineco

FLOOR ONE S7 PRO SERIES Smart Cordless Vacuum & Washer

Instruction Manual

Manual De Uso

Mode D'emploi



*Actual product may differ from illustration.

TINECO IS HERE TO HELP.
We'll get back to you within 1 business day.



 www.tineco.com

 1-855-292-8864

CONTENTS

Important Safety Instructions.....	2
Specifications	6
Overview.....	7
Accessories.....	8
Assembly	9
Operation.....	10
Maintenance	16
Troubleshooting.....	20
Warranty	21

TINECO IS HERE TO HELP.

We'll get back to you within 1 business day.

 www.tineco.com

 1-855-292-8864

Important Safety Instructions

EN

SAVE THESE INSTRUCTIONS

Household use only.

When using an electrical appliance, basic precautions should always be followed, including the following:

READ ALL INSTRUCTIONS BEFORE USING (THIS APPLIANCE). Failure to follow the warnings and instructions may result in electric shock, fire and/or serious injury.

WARNING – To reduce the risk of fire, electric shock, or injury:

1. This appliance can be used by children aged from 8 years and above and persons with reduced physical, sensory or mental capabilities or lack of experience and knowledge if they have been given supervision or instruction concerning use of the appliance in a safe way and understand the hazards involved. Children should not play with the appliance. Cleaning and user maintenance shall not be performed by children without supervision.
2. The appliance is not to be used by persons (including children) with reduced physical, sensory or mental capabilities, or lack of experience and knowledge, unless they have been given supervision or instruction.
3. Use only indoors, on non-carpeted floor surfaces such as vinyl, tile, sealed wood, etc. Be careful not to run over loose objects or edges of area rugs. Stalling the brush may result in premature belt failure.
4. Do not allow to be used as a toy. Close attention is necessary when used by or near children, pets or plants.
5. Use only as described in this manual. Use only manufacturer's recommended attachments.
6. Do not use with a damaged cord or plug. If appliance has been dropped, damaged, left outdoors, dropped into water, or is not working as it should, return it to a service center.
7. Do not handle charger, including charger plug, and charger terminals with wet hands.
8. Do not put any object into openings. Do not use with any opening blocked; keep free of dust, lint, hair, and anything that may reduce air flow.
9. Keep hair, loose clothing, fingers, and all parts of your body away from openings and moving parts.
10. Use extra care when cleaning on stairs.
11. Do not use to pick up flammable or combustible liquids, such as gasoline, or use in areas where they may be present.
12. Do not pick up anything that is burning or smoking, such as cigarettes, matches, or hot ashes.
13. Do not use without filter.
14. Prevent unintentional activation. Ensure the switch is in the off-position before picking up or carrying the appliance. Carrying the appliance with your finger on the switch or energizing appliance that have the switch on invites accidents.
15. Always switch off the appliance before making any adjustments, changing accessories, or storing the appliance. Such preventive safety measures reduce the risk of starting the appliance accidentally.

16. Recharge only with the charger specified by Tineco. A charger that is suitable for one type of battery pack may create a risk of fire when used with another battery pack.
17. Use appliances only with specifically designated Tineco battery packs. Use of any other battery packs may create a risk of injury and fire.
18. Under abusive conditions, liquid may be ejected from the battery; avoid contact. If contact accidentally occurs, flush with water. If liquid comes into eye contact, seek medical help. Liquid ejected from the battery may cause irritation or burns.
19. Do not use a battery pack or appliance that is damaged or modified. Damaged or modified batteries may exhibit unpredictable behavior resulting in fire, explosion or risk of injury.
20. Do not expose a battery pack or appliance to fire or excessive temperature. Exposure to fire or temperature above 266°F (130°C) may cause an explosion.
21. Follow all charging instructions and do not charge the battery pack or appliance outside of the temperature range specified in the instructions. Charging improperly or at temperatures outside of the specified range may damage the battery and increase the risk of fire.
22. Have servicing performed by a qualified repair person using only identical replacement parts. This will ensure that the safety of the product is maintained.
23. This appliance contains battery cells that are non-replaceable. Do not modify or attempt to repair the appliance or the battery pack except as indicated in the instructions for use and care.
24. Always turn off this appliance before connecting or disconnecting the motorized nozzle.
25. Do not charge or store the appliance outdoors or inside the car. Only charge, store or use the battery in a dry indoor area where the temperature is higher than 39.2°F (4°C) but lower than 104°F (40°C). The charger is for indoor use only.
26. Do not use to pick up ultrafine particles, such as lime, cement, sawdust, gypsum powder, or ashes.
27. Do not use to pick up sharp objects, such as metallic nails, pieces of glass, metal paper clips, or pins.
28. Do not use to pick up hazardous material and chemicals, such as solvent, drain cleaner, strong acids, or strong alkali.
29. Stop using immediately if the appliance is overheating, making unusual noises, producing unusual odors, performing low suction, or leaks electricity.
30. Turn cleaner OFF and disconnect from electrical outlet for long-term storage.
31. Always clean the Dirty Water Tank after each use to avoid potential blockage, which may lead to low suction power, motor overheating, or reduce the service life of the appliance.
32. Store appropriately indoors in a dry place after use.
33. Do not place or submerge appliance in standing water or try to clean flooded areas.
34. All data and technical instructions of this manual are based on results from lab tests of Tineco or designated third parties. The company reserves all rights for final explanations.
35. The plug must be removed from the socket-outlet before cleaning or maintaining the appliance.
36. A hazard may occur if the appliance runs over the supply cord.
37. Do not use the appliance when the water depth is more than 5mm above the surface.

38. Do not pull or carry by cord, use cord as a handle, close a door on cord, or pull cord around sharp edges or corners. Do not run appliance over cord. Keep cord away from heated surfaces.
39. Do not unplug by pulling on cord. To unplug, grasp the plug, not the cord.

Range of Usage

1. The cordless hard floor cleaner is to be used on indoor hard floors, such as vinyl, tile, sealed wood, etc. Use on a rough surface may not get the best performance.
2. Keep your appliance away from heat sources, such as fireplace or heater, to avoid casing deformation.
3. Do not use to pick up flammable or combustible liquids, ultrafine particles, sharp objects, hazardous material, chemicals or anything that is burning or smoking, as described above.

About Cleaning Solution

1. A large amount of cleaning solution entering into the motor may cause damage to the appliance.
2. Add solution as instructed in the Operation section. We recommend using the provided cleaning solution. Do not use the product with acidic, alkaline solution, or any substances harmful to the environment.
3. Keep out of the reach of children. Avoid contact with eyes and skin, otherwise, rinse thoroughly with water. If irritation persists, seek medical advice. If product is swallowed seek medical advice.
4. Dirty water and solution disposal should comply with local environmental regulations.

About the Appliance

1. Do not modify or attempt to repair the appliance except as indicated in the instructions for operating and cleaning.
2. Charge the appliance with the Tineco adaptor. Input Voltage: AC 100-240V. Both high and low voltages can damage the adaptor, appliance, or even cause danger to the user.
3. Use extra care when cleaning on stairs.
4. Ensure that the Power Switch is in the OFF-position before picking up or carrying the appliance. Do not lay flat or lean the appliance so as to prevent dirty water from entering into the motor.
5. To avoid being tripped accidentally, please put away the appliance on the charging base.
6. Always install the Dirty Water Tank and Clean Water Tank properly before use.
7. Do not allow the appliance or charger to get wet to avoid risk of fire or injury caused by a short circuit.

FCC Supplier's Declaration of Conformity

TINECO / Smart Cordless Vacuum & Washer (FW200300US)

This appliance complies with part 15 of the FCC Rules. Operation is subject to the following two conditions:

(1) This appliance may not cause harmful interference, and (2) this appliance must accept any interference received, including interference that may cause undesired operation.

TINECO INTELLIGENT, INC.

1700 WESTLAKE AVENUE N., SUITE 200, SEATTLE, WA, 98109, USA

WWW.TINECO.COM

1-855-292-8864

Changes or modifications not expressly approved by the party responsible for compliance could void the user's authority to operate the equipment.

Note: This equipment has been tested and found to comply with the limits for a Class B digital appliance, pursuant to Part 15 of the FCC Rules. These limits are designed to provide reasonable protection against harmful interference in a residential installation.

This equipment generates uses and can radiate radio frequency energy and, if not installed and used in accordance with the instructions, may cause harmful interference to radio communications. However, there is no guarantee that interference will not occur in a particular installation. If this equipment does cause harmful interference to radio or television reception, which can be determined by turning the equipment off and on, the user is encouraged to try to correct the interference by one or more of the following measures:

- (1) Reorient or relocate the receiving antenna.
- (2) Increase the separation between the equipment and receiver.
- (3) Connect the equipment into an outlet on a circuit different from that to which the receiver is connected.
- (4) Consult the dealer or an experienced radio/TV technician for help.

FCC Radiation Exposure Statement

This equipment complies with FCC radiation exposure limits set forth for an uncontrolled environment. This equipment should be installed and operated with a minimum distance of 20cm between the radiator and any part of your body.

Note

The manufacturer is not responsible for any radio or TV interference caused by unauthorized modifications to this equipment, such modifications could void the user's authority to operate this equipment.

IC Note

This appliance contains licence-exempt transmitter(s)/receiver(s) that comply with Innovation, Science and Economic Development Canada's licence-exempt RSS(s).

Operation is subject to the following two conditions:

- (1) This appliance may not cause interference.
- (2) This appliance must accept any interference, including interference that may cause undesired operation of the appliance.
 - This Class B digital apparatus complies with Canadian ICES-003.
 - This equipment complies with ISED RSS-102 radiation exposure limits set forth for an uncontrolled environment. This equipment should be installed and operated with a minimum distance of 20cm between the radiator and any part of your body.

Specifications

Product	FLOOR ONE S7 PRO SERIES
AC Input	100-240V~
Voltage	25.2V= 3900mAh Lion
Rated Power	230W
Running Time	AUTO/ULTRA/SUCTION: ~40 mins MAX: ~28 mins
Charging Time	4-5 hrs
Water Flow Rate	20~100ml/min
CWT Capacity	~0.85L
DWT Capacity	~0.72L
Waterproof	IPX4

- For use only with TINECO charger KL-WA300100-X.

Disposal

- The battery contains materials that are harmful to the environment and must be removed from the appliance before it is discarded.
- When removing the battery, the appliance must be powered off.
- Batteries, chargers, accessories and packaging should be sorted for environmental friendly recycling. Do not put them into fire, water or soil. Do not dispose of batteries and chargers into household waste! 
- If battery leakage contacts skin or clothing, immediately flush with water to avoid irritation and seek medical help.

Overview

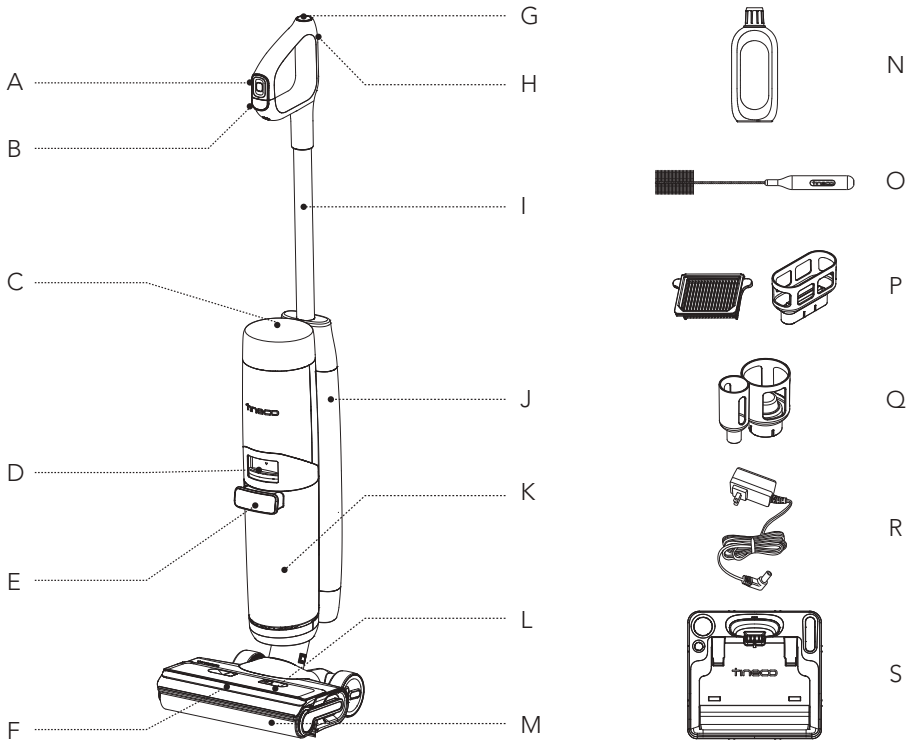

A. Menu Button

B. Power On/Off

C. Digital Display

D. Dirty Water Tank Release

E. Dirty Water Tank Handle

F. LED Headlights

G. Self-cleaning Button

H. WiFi/Mute/Language Switch Button

I. Tube

J. Clean Water Tank (CWT)

K. Dirty Water Tank (DWT)

L. Brush Roller Cover

M. Brush Roller

N. Deodorizing & Cleaning Solution

O. Cleaning Tool

P. Dry Filter & Holder

Q. Accessory Holder

R. Adaptor

S. Charging Base

Accessories

NE

Note:

Accessories may vary between markets. If you require more accessories, please go to www.tineco.com or store.tineco.com.

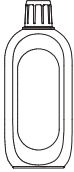

Deodorizing & Cleaning Solution

Removes dirt, grime, grease and tough stains from most types of hard surfaces, like tile, marble, sealed hardwood floors, and more. Always use Tineco solution in your appliance.

Add one bottle cap of solution to each full tank of clean water.



Brush Roller

Soft roller head with bristles can be used to vacuum and wash at the same time. It can be easily cleaned with the self-cleaning function.

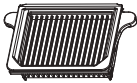

Dry Filter

Dry filter and filter net can block large particles and debris, ensure the appliance's durability.

* Please install the dry filter before use, or it may lead to weak suction.



Cleaning Tool

A full brush to clean the DWT, brush chamber and opening.

The tool also has a bristled end to remove dirt and mud on the roller and DWT.

Assembly

How to Assemble/Disassemble

Note:

For water tank and brush assembly, please refer to "Operation" and "Maintenance".

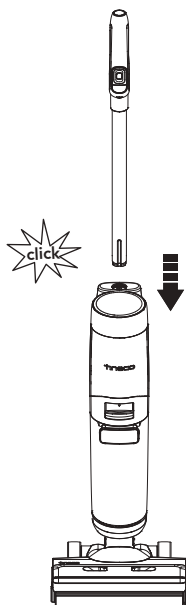

To assemble the handle, insert it into the appliance until you hear a click.

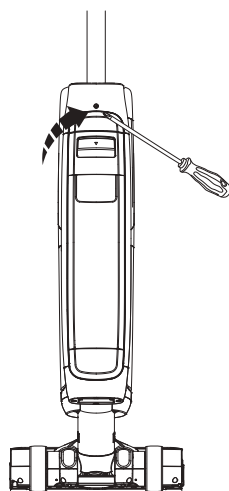

In the event that the handle need to be disassembled, press the spring to release the handle with a tool (like a screwdriver) and lift the released handle from the appliance.

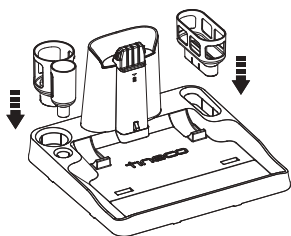

Install the dry filter holder and accessory holder on the base.

Operation

EN

Preparing for Use

- Before first use, please charge the appliance for 4-5 hours (refer to "Charging Instructions" for details).
* Based on results from Tineco lab tests. Lab temperature 39.2°F (4°C) ~ 104°F (40°C).
- For the first use, the appliance will display the Quick Start Guide and Interactive Tutorial, press the Self-cleaning button to exit.



Quick Start Guide

Brief introduction to the buttons and how to use the appliance.



Interactive Tutorial

Tutorial for the interactive operations, including Fill up the Clean Water Tank, Start cleaning, Pause cleaning and Clean the Dirty Water Tank.

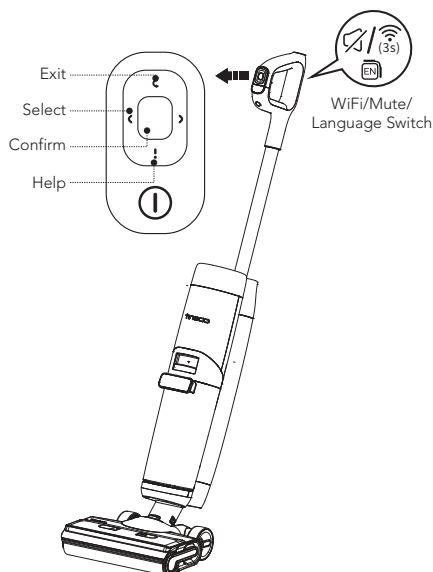

Menu Button

- ☪ Exit: Press to exit the current interface.
- ☞ Select: During cleaning, press the left or right button to switch between different modes.
- Confirm: Press to enter a certain mode when switching.
- ! Help: Press to enter Tineco assistant which contains Quick Start Guide, Maintenance, WiFi Connection, Handle Disassembly and Customer Service.

WiFi/Mute/Language Switch Button

- Press to turn on/off the voice prompt.
- Press twice to switch languages. (More voice languages will be added, please refer to the actual product for now.)
- Hold for 3 seconds to connect to network.

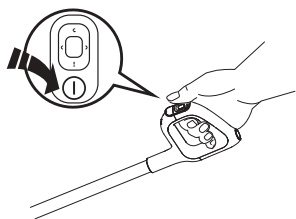

Press the **I** button and the appliance will start in AUTO mode by default, press the Select button to switch between different modes.

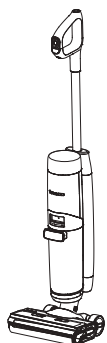

Stop Working

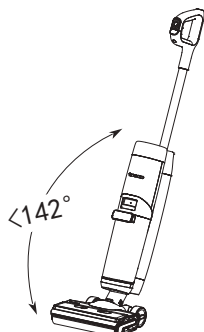

Start Again

The appliance will stop working when put uprightly and start running again when you recline.

* Do not recline more than 142° to protect against water leakage.

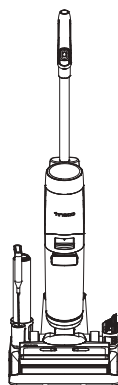

Place the appliance on the charging base vertically after use for recharge and storage.

Note:

- Selecting the appropriate mode depending on the CWT contents is vital for maximum dirt detection effectiveness.
- Do not vacuum foamed liquid.
- To vacuum water left on the surface, the appliance will switch off in 3 seconds after power off.

Filling Clean Water Tank

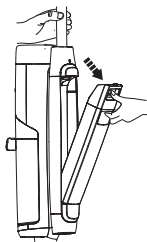

Press the Clean Water Tank release button to remove it from the appliance.

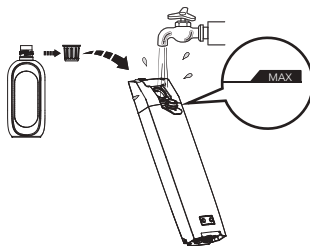

Open the tank cap, and fill with tap water to the Max line. When deep cleaning is necessary, add one bottle cap of solution to the CWT and tightly close the cap.

Note:

**Only use water under 140°F/60°C.
DO NOT USE HOT WATER.**

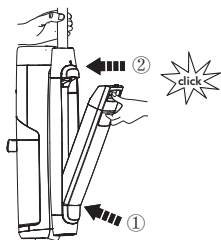

Place the tank back into the appliance. You should hear a "Click" if done correctly.

Charging Instructions

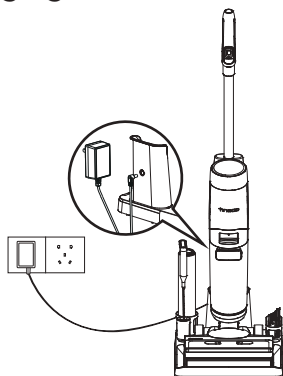

To charge the appliance, place the appliance on the charging base and plug the adaptor into a power outlet.

1. To charge the appliance, connect the external charging cord to the charging base and plug it into the wall outlet.
2. To avoid tripping hazards, please place the appliance on the charging base near a wall during charging.

Warning:

- Only charge the appliance with the adaptor supplied by Tineco.
- During long periods of not being used, the appliance must be charged once every 3 months for optimal performance. It may take 4-5 hours for a full charge.
- Store indoors in a dry place. Do not expose the appliance to sunlight or freezing temperatures. Recommended temperature range: 39.2°F (4°C) ~ 104°F (40°C).

Digital Display

An updated display shows everything with interactive animation, giving you a brand new experience during and after cleaning.

Note:

Keep sharp objects away from the digital display screen to avoid scratches and scrapes.

Cleaning Mode Selection

AUTO Mode



- In AUTO mode, the iLoop sensor automatically detects how dirty the floor is and applies the appropriate amount of detergent and suction power.
- A red dirt monitoring loop indicates more dirt is detected, and a blue loop indicates less dirt is detected. This mode automatically provides the best cleaning solution.

MAX Mode



- Press the left or right Select button to enter MAX mode.
- In MAX mode, the appliance will apply max suction power and will spray water/solution for embedded stains.

ULTRA Mode



- Press the left or right Select button to enter ULTRA mode.
- In ULTRA mode, the appliance will prepare for 30 seconds and then start to work. This mode is suitable for deep cleaning.

SUCTION Mode

EN



- Press the left or right Select button to enter SUCTION mode.
- In SUCTION mode, the appliance will absorb water. We recommend using this mode on the wet surface.

Runtime

- In AUTO/ULTRA/SUCTION mode: ~40minutes
- In MAX mode: ~28minutes
- Estimated runtime data was obtained by a Tineco Laboratory.

Charging Time

- A full charge takes approximately 4-5 hours.
- Estimated data was obtained by a Tineco Laboratory using ambient temperatures between 39.2°F (4°C) to 104°F (40°C).

App

All the functions can be performed using the Tineco app. Download the Tineco app from the App Store, Google Play and Tineco Official Site.



Note:

The default setting for voice prompt is English, you can set other languages via App.

Voice Prompt (Contents may vary, please in kind prevail.)

Status	Reminder
Before first use	Hi, welcome to Tineco Assistant. Let's begin the Quick Start Guide.
Voice prompts on	Voice prompts on.
Voice prompts off	Voice prompts off.
Connect the Tineco app	Scan QR code to download app and connect appliance.
Auto mode by default	Auto mode.
Switch to Suction mode	Suction mode.
Switch to Max mode	Max mode.
Switch to Ultra mode	Ultra mode.
Battery level: 10~20%	Battery low.
Battery level: 0~10%	Battery low. Please charge the appliance.
Clean Water Tank is empty	Insufficient water in the Clean Water Tank. Please add water.
Need self cleaning	To optimize cleaning performance, please perform self-clean cycle.
Can not perform self-cleaning	Please place appliance on the charging base to begin self-cleaning.
Dirty Water Tank is full	Dirty Water Tank full. Please empty.
Dirty Water Tank not installed	Please install the Dirty Water Tank.
Clean Water Tank not installed	Please install the Clean Water Tank.
Prepare the solution in Ultra mode	Solution is ready. Please start cleaning.
Brush roller is tangled	Please clean the brush roller.
Power off	Powering off.
Battery insufficient for self-cleaning	Battery low. Please charge before initiating self-cleaning.
Cleaning the brush roller	Cleaning the brush roller.
Cleaning the pipe	Cleaning the pipe.
Drying the Brush Roller	Drying the Brush Roller.
Deep cleaning	Deep cleaning.
Self-cleaning complete	Self-cleaning complete. Please empty and clean the Dirty Water Tank to prevent odors.
Start charging	Charging.
Insufficient water for self-cleaning	Please add water and start self-cleaning.

Maintenance

EN

Note:

- For optimal performance and to prevent odors, always **clean** and **dry** DWT, filters, brush roller, brush roller cover **completely** after each use.
- Please make sure each part is installed correctly or the appliance may not work properly.
- Do not soak the appliance or wash it under water.
- Some water may remain in the appliance due to factory inspection.
- After maintenance, place the appliance on the charging base vertically. Do not expose the appliance to direct sunlight, and store it indoors in a dry place.

Main Body

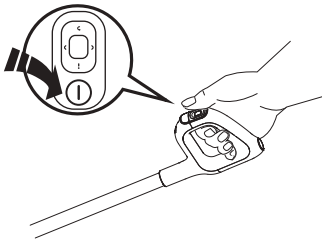

To reduce the risk of injury, switch off before performing maintenance.



Use a cloth to clean the surface with a neutral detergent. The cloth should be dry to prevent water from entering the appliance.

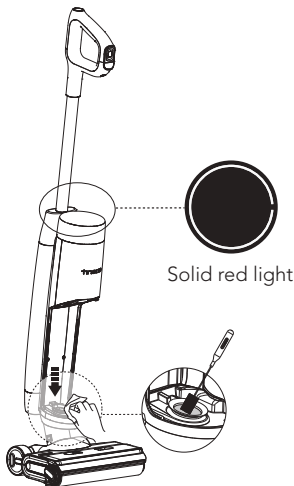

When LCD loop illuminates red, remove Dirty Water Tank, clean the dirt sensor with a damp cloth or the cleaning tool.

Dirty Water Tank

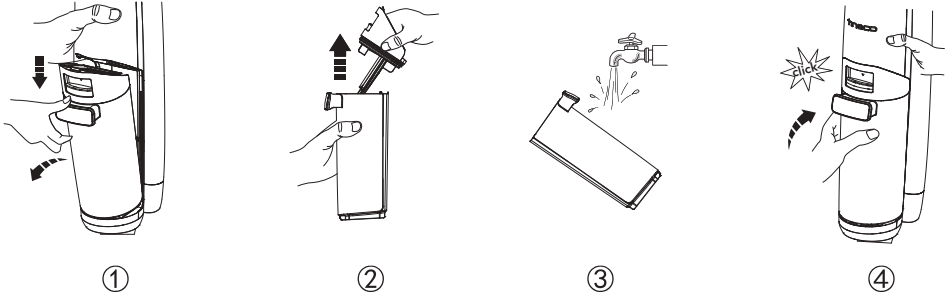

- When dirty water reaches the Max line, the appliance will stop working and show a reminder on the display and play a voice prompt.
- Pull up the tank lid to empty the DWT. Use the cleaning tool to remove remaining debris. Rinse the inside of the DWT and place back into the appliance.

Dirty Water Tank Lid

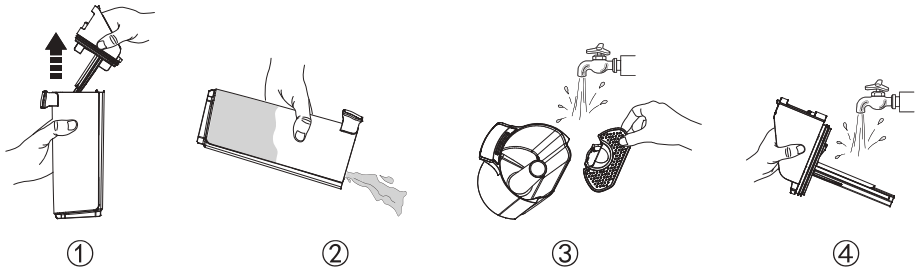

If the Dirty Water Tank lid and the filter inside have been blocked, remove the tank lid and the filter, rinse both parts with water.

Dry Filter



Grasp recessed area on each side of the dry filter and pull upward. Rinse under running water and must be completely dry before recombining with the lid of the DWT.

*A spare dry filter is provided with your appliance for convenient replacement.

Brush Roller Self-cleaning

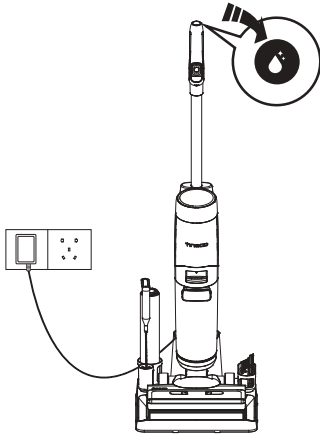

1. Place the appliance on the charging base after use, the sensor will auto-detect the level of dirt.
2. Press the self-cleaning button and you can select the Quick Self-cleaning (takes 2 minutes) or Super Self-cleaning (takes 6 minutes) to begin the process.
3. Once complete, please clean the Dirty Water Tank. And the appliance will begin charging.

Note:

- Ensure the charging base is plugged in and the battery level is >10%.
- Before self-cleaning cycle, please clean the DWT and ensure the water level in the CWT exceeds 40%.

Brush Roller Cover

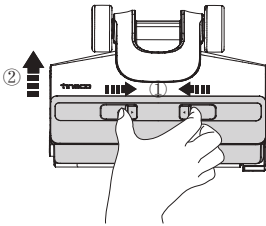

Squeeze latches on the cover and pull upward to remove.

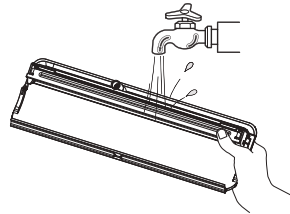

Rinse with water.

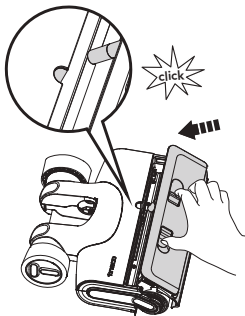

When replacing, always latch the brush cover into place to avoid leakage.

Brush Roller

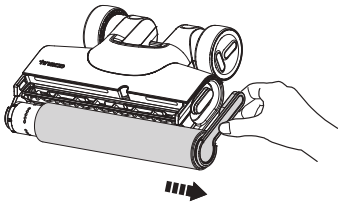

Remove the brush roller by grabbing the brush roller tab and pulling out.

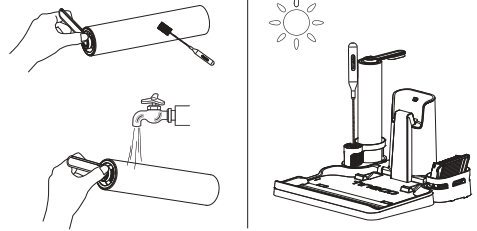

Using the cleaning tool, remove the hair and debris wrapped around the roller and rinse with water. Replace the brush roller back into the accessory holder, and allow it to dry completely before reinstalling.

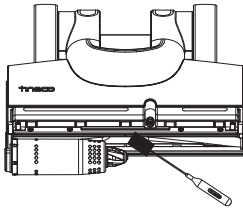

Remove hair and debris from the brush roller chamber and the opening with the cleaning tool.

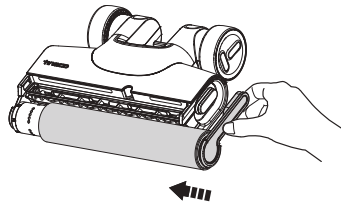

Replace the brush roller by inserting its end into the left side of the holder, then attach the roller tab to the magnetic buckle on the right side to lock into place.

Note:

- A spare brush roller is provided with your appliance for convenient replacement.
- To maintain high performance, replace the brush roller every 8 months.

Troubleshooting

Problem	Possible cause	Solution
The appliance does not turn on	1. No power 2. Auto protection for overheating	1. Charge the appliance 2. Restart after cooling down
Weak suction	The dry filter is not installed, or the dry filter is dirty	Install the dry filter or clean and allow it to dry completely
Brush roller tangled in animation 🔊 Voice prompt: 1. Please clean the brush roller 2. Please check the brush roller	1. The brush roller is blocked 2. The brush roller is not installed	1. Remove blockages 2. Install brush roller correctly
WiFi indicator is off	WiFi is not connected	Follow the in-app guide to connect to WiFi
CWT empty in animation 🔊 Voice prompt: Insufficient water in the Clean Water Tank. Please add water.	CWT is empty	Refill CWT
DWT full in animation 🔊 Voice prompt: Dirty Water Tank is full. Please empty it.	The dirty water in DWT has reached the MAX line	Empty the dirty water and then reinstall the DWT
All lights off in operation	Battery overheat or malfunction	Cool the appliance down and restart
Battery level < 10% 🔊 Voice prompt: Battery low. Please charge the appliance.	Low battery	Charge the appliance, or restart
LCD loop illuminates red 🔊 Voice prompt: Please perform self-cleaning to ensure cleaning performance	Dirt sensor malfunction or blocked	Remove blockages, clean the debris channel, or restart

Note:

If the above troubleshooting guide fails to provide a solution, please visit our website www.tineco.com for further support.

Warranty

2-YEAR LIMITED WARRANTY

- Only applies to purchases made from authorized retailers of Tineco.
- Is subject to the adherence of the requirements outlined in this instruction manual, and is subject to further conditions outlined below.
- This warranty is governed by and construed under the laws of the country in which the purchase took place. We provide 2-year warranty or a warranty period as stipulated by applicable local law, whichever is longer.

WHAT IS COVERED?

- Your Tineco appliance has a 2-year warranty against original defects in material and workmanship, when used for private household purposes in accordance with the Tineco Instruction Manual. Motorized accessories and battery bought separately come with a 1-year warranty.
- This warranty provides, at no extra cost to you, all labor and parts necessary to ensure your appliance is in proper operating condition during the warranty period.
- This warranty will only be valid if the appliance is used in the country in which it was sold.

WHAT IS NOT COVERED?

Tineco shall not be liable for costs, damages or repairs incurred as a result of:

- Appliances purchased from an unauthorized dealer.
- Careless operation or handling, misuse, abuse and/or lack of maintenance or use not in accordance with the Tineco Instruction Manual.
- Use of the appliance other than for normal domestic purposes, e.g. for commercial or rental purposes.
- Use of parts not in accordance with the Tineco Instruction Manual.
- Use of parts and accessories other than those produced or recommended by Tineco.
- External factors unrelated to product quality and use, such as weather, modifications, accidents, electrical outages, power surges or acts of God.
- Repairs or alterations carried out by unauthorized parties or agents.
- Failing to clear blockage and other hazardous material from the appliance.
- Normal wear and tear, including normal wearing parts, such as clear bin, belt, filter, HEPA, brush bar, and power cord (or where external damage or abuse is diagnosed), carpet or floor damage due to use not in accordance with manufacturer's instructions or failure to turn the brush bar off when necessary.
- Reduction in battery discharge time due to battery age or use.

WARRANTY LIMITATIONS

- Any implied warranties relating to your appliance including but not limited to warranty of merchantability or warranty of fitness for a particular purpose, are limited to the duration of this warranty.
- Warranty coverage applies to the original owner and to the original battery only and is not transferable.
- This limited warranty gives you specific legal rights. You may also have other rights which vary by region.
- Manufacturer's warranties may not apply in all cases, depending on factors such as use of the product, where the product was purchased, or who you purchased the product from. Please review the warranty carefully, and contact the manufacturer if you have any questions.

WARRANTY SERVICE

Register: We highly recommend that upon purchase, you register your appliance on the Tineco official website (www.tineco.com) and enjoy exclusive benefits. To register, please enter the whole serial number (found on the back of the appliance).

Failure to register your product won't diminish your warranty rights.

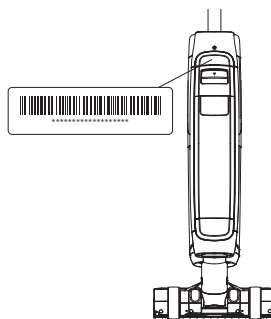

How to Claim: Please retain your proof of purchase. To make a claim under our Limited Warranty, you need to provide your serial number and the original purchase receipt with the purchase date and order number on it.

All work will be carried out by Tineco or its authorized agency.

Any replaced defective parts will become the property of Tineco.

Service under this warranty will not extend the period of this warranty.

Contact our Customer Service
Hotline: **1-855-292-8864**
or Visit Tineco website
www.tineco.com
for expert customer service.

SOMMAIRE

Consignes de sécurité importantes	47
Spécifications	52
Présentation	53
Accessoires	54
Assemblage	55
Fonctionnement	56
Entretien	62
Guide de dépannage	66
Garantie	67

Consignes de sécurité importantes

CONSERVEZ CES INSTRUCTIONS

Usage domestique exclusivement.

Lorsque vous utilisez un appareil électrique, veuillez respecter les précautions de sécurité élémentaires, notamment celles indiquées ci-dessous :

LISEZ TOUTES LES INSTRUCTIONS AVANT L'UTILISATION (DE CET APPAREIL). Le non-respect des consignes de sécurité et des instructions peut provoquer une décharge électrique, un incendie et/ou des blessures graves.

AVERTISSEMENT – Afin de réduire le risque d'incendie, de décharge électrique ou de blessures corporelles :

1. Cet appareil peut être utilisé par des enfants à partir de 8 ans et par des personnes dont les capacités physiques, sensorielles ou mentales sont réduites, ou des personnes dénuées d'expérience ou de connaissance, si elles ont pu bénéficier, par l'intermédiaire d'une personne responsable de leur sécurité, d'une surveillance ou d'instructions préalables concernant l'utilisation de l'appareil. Les enfants ne doivent pas jouer avec cet appareil. Le nettoyage et l'entretien ne doivent pas être effectués par des enfants sans surveillance.
2. Cet appareil n'est pas destiné à être utilisé par des personnes (y compris les enfants) ayant des capacités physiques, sensorielles ou mentales limitées, ou manquant d'expérience et/ou de connaissances, sauf si elles sont surveillées ou ont reçu des instructions.
3. Veuillez à uniquement utiliser l'appareil en intérieur, sur des sols dépourvus de moquette, par exemple en vinyle, en carrelage, en parquet, etc. Veuillez à ne pas passer sur des objets non fixés ni sur les bords de tapis. Le blocage de la brosse peut entraîner une défaillance prématurée de la courroie.
4. Cet appareil ne doit pas servir de jouet. Une attention particulière est nécessaire lorsque l'aspirateur est utilisé près d'enfants, d'animaux domestiques ou de plantes.
5. Utilisez l'appareil uniquement de la manière décrite dans ce manuel. Utilisez exclusivement les accessoires recommandés par le constructeur.
6. N'utilisez pas l'appareil si son câble d'alimentation ou sa prise est endommagé. Si l'appareil est tombé, est endommagé, a été laissé à l'extérieur ou en contact avec de l'eau ou ne fonctionne pas correctement, retournez-le à un centre d'entretien.
7. Ne manipulez pas le chargeur, y compris la prise et/ou les bornes du chargeur, les mains mouillées.
8. N'insérez aucun objet dans les ouvertures. N'utilisez pas l'appareil si l'une des ouvertures est obstruée. Veuillez à éviter l'accumulation dans les ouvertures de tout ce qui pourrait diminuer le flux d'air (poussières, peluches, poils, etc.).
9. Gardez les cheveux, les vêtements amples, les doigts et autres parties du corps éloignés des ouvertures et des pièces en mouvement.
10. Soyez particulièrement vigilant(e) en passant l'aspirateur dans les escaliers.
11. N'utilisez pas cet appareil pour aspirer des liquides combustibles ou inflammables, comme de l'essence, et ne passez pas l'aspirateur dans une pièce où se trouvent de tels liquides.

12. Ne passez en aucun cas l'aspirateur sur des objets brûlants ou incandescents, comme des cigarettes, des allumettes ou des cendres chaudes.
13. Ne faites pas fonctionner cet appareil sans le filtre.
14. Évitez la mise en marche accidentelle. Vérifiez que l'interrupteur marche/arrêt est en position d'arrêt avant de saisir l'appareil ou de le porter. Transporter l'appareil avec un doigt sur l'interrupteur ou le brancher sur une alimentation électrique alors que son interrupteur est en position de marche favorise les accidents.
15. Éteignez toujours l'appareil avant d'effectuer un réglage, de changer un accessoire ou de ranger l'appareil. Ces mesures de sécurité permettent de réduire les risques de démarrage accidentel de l'appareil.
16. Rechargez uniquement l'appareil avec le chargeur spécifié par Tineco. Un chargeur adapté à un seul type de batterie peut présenter un risque d'incendie s'il est utilisé avec une batterie différente.
17. Utilisez cet appareil uniquement avec des batteries Tineco spécialement conçues pour cet usage. L'utilisation de toute autre batterie peut créer un risque de blessures et d'incendie.
18. Si la batterie est soumise à des conditions abusives, du liquide peut s'en échapper. Évitez tout contact avec ce liquide. En cas de contact accidentel, rincez à grande eau. Si du liquide entre en contact avec les yeux, consultez un médecin. Le liquide qui s'échappe de la batterie peut provoquer des irritations ou des brûlures.
19. N'utilisez pas l'appareil si la batterie ou l'appareil lui-même est endommagé ou modifié. Les batteries modifiées ou endommagées peuvent produire un fonctionnement imprévisible pouvant provoquer un incendie, une explosion ou un risque de blessure.
20. N'exposez pas la batterie ou l'appareil à des flammes ou à une température excessive. L'exposition au feu ou à des températures supérieures à 130 °C peut provoquer une explosion.
21. Respectez toutes les instructions de recharge. Ne rechargez pas la batterie ou l'appareil quand la température ambiante est hors de la plage spécifiée dans les instructions. Une recharge incorrecte ou recharger une batterie sous des températures hors de la plage spécifiée peut endommager la batterie et accroître le risque d'incendie.
22. Faites réparer votre appareil par un réparateur qualifié qui ne devra utiliser que des pièces de rechange identiques. Cela garantira une utilisation sûre de l'appareil.
23. Cet appareil contient des éléments de batterie non remplaçables. Ne modifiez pas et n'essayez pas de réparer l'appareil ou la batterie sans suivre les instructions d'utilisation et d'entretien.
24. Éteignez toujours cet appareil avant de brancher ou de débrancher l'embout motorisé.
25. Ne chargez et ne rangez pas l'appareil en plein air ou à l'intérieur d'une voiture. Chargez, stockez ou utilisez la batterie uniquement dans une zone intérieure sèche où la température est supérieure à 4 °C, mais inférieure à 40 °C. Le chargeur est conçu exclusivement pour une utilisation en intérieur.
26. N'utilisez pas l'appareil pour ramasser des particules ultra-fines telles que la chaux, le ciment, la sciure de bois, la poudre de gypse ou les cendres.
27. N'utilisez pas l'appareil pour ramasser des objets pointus, tels que des clous métalliques, des morceaux de verre, des trombones métalliques ou des épingles.

28. N'utilisez pas l'appareil pour ramasser des matières dangereuses et des produits chimiques, tels que des solvants, des produits de nettoyage pour vidange, des acides forts ou des alcalis puissants.
29. Cessez immédiatement d'utiliser l'appareil en cas de surchauffe, de bruits inhabituels, de mauvaises odeurs, de faible aspiration ou de fuite d'électricité.
30. Éteignez le nettoyeur et débranchez-le de la prise électrique avant de le ranger pour une longue période.
31. Nettoyez toujours le réservoir d'eau sale après chaque utilisation afin d'éviter tout blocage, ce qui peut entraîner une faible puissance d'aspiration, une surchauffe du moteur et une réduction de la durée de vie de l'appareil.
32. Après utilisation, rangez l'appareil en intérieur, à l'abri de l'humidité.
33. Ne posez pas et ne plongez pas l'appareil dans de l'eau stagnante et n'essayez pas de nettoyer les zones inondées.
34. Toutes les données et instructions techniques de ce manuel sont basées sur les résultats des tests effectués en laboratoire par Tineco ou des tiers désignés. La société se réserve tous les droits pour les explications finales.
35. La fiche doit être retirée de la prise avant tout nettoyage ou entretien de l'appareil.
36. Un accident peut se produire si l'appareil passe sur le cordon d'alimentation.
37. N'utilisez pas l'appareil si la surface à nettoyer est couverte par plus de 5 mm d'eau.
38. Il ne faut pas tirer ou transporter l'appareil par le cordon, ou utiliser le cordon comme une poignée, fermer une porte sur le cordon ou tirer sur le cordon autour des bords ou des coins tranchants. Ne faites pas rouler l'appareil sur le cordon. Garder le cordon loin de surfaces chauffées.
39. Ne débranchez pas l'appareil en tirant sur le cordon. Pour débrancher, saisissez la fiche, pas le cordon.

Applications

1. Ce nettoyeur de sol sans fil doit être utilisé sur les sols durs en intérieur, tels que le vinyle, le carrelage, le parquet, etc. L'utilisation sur une surface rugueuse ne permet pas d'obtenir les meilleures performances.
2. Tenez votre appareil à l'écart des sources de chaleur, telles que la cheminée ou le chauffage, afin d'éviter toute déformation du boîtier.
3. N'utilisez pas l'appareil pour ramasser des liquides inflammables ou combustibles, des particules ultra-fines, des objets pointus, des matières dangereuses, des produits chimiques ou tout autre produit brûlant ou fumant, comme décrit ci-dessus.

À propos de la solution de nettoyage

1. Une grande quantité de solution de nettoyage pénétrant dans le moteur peut endommager l'appareil.
2. Ajoutez la solution comme indiqué dans la section Fonctionnement. Nous vous recommandons d'utiliser la solution de nettoyage fournie. N'utilisez pas le produit avec une solution acide, alcaline ou toute substance nocive pour l'environnement.
3. Tenir hors de portée des enfants. Éviter le contact avec les yeux et la peau, sinon rincer abondamment à l'eau. Consulter un médecin si l'irritation persiste. En cas d'ingestion du produit, consulter immédiatement un médecin.

4. La mise au rebut de l'eau sale et de la solution doit être conforme aux réglementations environnementales locales.

À propos de l'appareil

1. Ne modifiez pas et n'essayez pas de réparer l'appareil sauf comme indiqué dans les instructions de fonctionnement et de nettoyage.
2. Chargez l'appareil avec l'adaptateur Tineco. Tension d'entrée : 100 - 240 V c.a. Les tensions élevées et basses peuvent endommager l'adaptateur, l'appareil ou même entraîner un danger pour l'utilisateur.
3. Soyez particulièrement vigilant(e) en passant l'aspirateur dans les escaliers.
4. Vérifiez que l'interrupteur marche/arrêt est en position d'arrêt avant de saisir l'appareil ou de le porter. Ne posez pas l'appareil à l'horizontale et ne le penchez pas afin d'éviter que de l'eau sale ne pénètre dans le moteur.
5. Pour éviter tout risque de trébuchement, veuillez ranger l'appareil sur la base de recharge.
6. Installez toujours correctement le réservoir d'eau sale et le réservoir d'eau propre avant l'utilisation.
7. Veillez à ne pas mouiller l'appareil ou le chargeur afin d'éviter tout risque d'incendie ou de blessure causé par un court-circuit.

Déclaration de conformité FCC du fournisseur

TINECO / SÉRIE FLOOR ONE S7 PRO

Cet appareil est conforme à la section 15 de la réglementation FCC. Son fonctionnement est soumis aux deux conditions suivantes :

(1) Cet appareil ne doit pas provoquer d'interférences nuisibles, et (2) cet appareil doit accepter toutes les interférences reçues, y compris celles susceptibles de provoquer un fonctionnement indésirable.

TINECO INTELLIGENT, INC.

1700 WESTLAKE AVENUE N., SUITE 200, SEATTLE, WA, 98109, USA

WWW.TINECO.COM

1-855-292-8864

Tout changement ou toute modification non expressément approuvé par la partie responsable de la conformité peut annuler le droit de l'utilisateur à utiliser l'équipement.

Remarque : cet équipement a été testé et déclaré conforme aux limites définies pour un appareil numérique de classe B, conformément à l'article 15 de la réglementation FCC. Ces limites sont conçues pour fournir une protection raisonnable contre les interférences nuisibles dans une installation résidentielle.

Cet équipement génère, utilise et peut émettre de l'énergie par radiofréquence. S'il n'est pas installé et utilisé conformément aux instructions, il peut provoquer des interférences nuisibles aux communications radio. Toutefois, il n'est pas garanti que des interférences ne se produiront pas dans une installation particulière. Si cet équipement provoque des

interférences nuisibles à la réception des signaux de radio ou de télévision, ce qui peut être déterminé en éteignant et en rallumant l'équipement, il est recommandé à l'utilisateur d'essayer de corriger les interférences en prenant une ou plusieurs des mesures suivantes :

- (1) Réorienter ou déplacer l'antenne de réception.
- (2) Augmenter la distance entre l'équipement et le récepteur.
- (3) Brancher l'appareil sur une prise située sur un circuit différent de celui auquel le récepteur est connecté.
- (4) Consulter le concessionnaire ou un technicien radio/TV expérimenté pour obtenir de l'aide.

Déclaration FCC relative à l'exposition aux rayonnements

Cet équipement est conforme aux limites d'exposition aux radiations définies par la FCC pour un environnement non contrôlé. Cet équipement doit être installé et utilisé avec une distance minimale de 20 cm entre l'émetteur de radiations et n'importe quelle partie de votre corps.

Remarque

Le fabricant n'est pas responsable des interférences radio ou TV causées par des modifications non autorisées de cet équipement. Ces modifications peuvent annuler le droit de l'utilisateur à utiliser cet équipement.

Remarque IC

Cet appareil contient des émetteurs/récepteurs exempts de licence qui sont conformes aux normes RSS exemptes de licence d'Innovation, Sciences et Développement économique Canada. Son fonctionnement est soumis aux deux conditions suivantes :

- (1) Cet appareil ne doit pas provoquer d'interférences.
 - (2) Cet appareil doit accepter toutes les interférences, y compris celles susceptibles de provoquer un fonctionnement indésirable de l'appareil.
- Cet appareil numérique de classe B est conforme à la norme canadienne ICES-003.
 - Cet équipement est conforme aux limites d'exposition aux radiations définies par la ISED RSS-102 pour un environnement non contrôlé. Cet équipement doit être installé et utilisé avec une distance minimale de 20 cm entre l'émetteur de radiations et n'importe quelle partie de votre corps.

Spécifications

Produit	SÉRIE FLOOR ONE S7 PRO
Entrée CA	100-240 V~
Tension	25,2 V== 3 900 mAh Lion
Puissance d'alimentation	230 W
Autonomie	AUTO/ULTRA/ASPIRATION : environ 40 minutes MAX : environ 28 minutes
Durée de la recharge	4 à 5 heures
Débit d'eau	20~100 ml/min.
Capacité du REP	environ 0,85 L
Capacité du RES	environ 0,72 L
Étanchéité	IPX4

- À n'utiliser qu'avec le chargeur TINECO KL-WA300100-X.

Élimination des déchets

- La batterie contient des matériaux nuisibles à l'environnement. Elle doit donc être retirée de l'appareil avant l'élimination de celui-ci.
- Éteignez l'appareil avant d'enlever la batterie.
- Les batteries, les chargeurs, les accessoires et l'emballage doivent faire l'objet d'un tri dans l'optique d'un recyclage écologique. Ne les jetez pas au feu, à l'eau ou dans le sol. Les chargeurs et batteries ne doivent en aucun cas être jetés avec les ordures ménagères ! 
- En cas de contact du liquide de batterie avec la peau ou les vêtements, rincez immédiatement à l'eau afin d'éviter toute irritation, puis consultez un médecin.