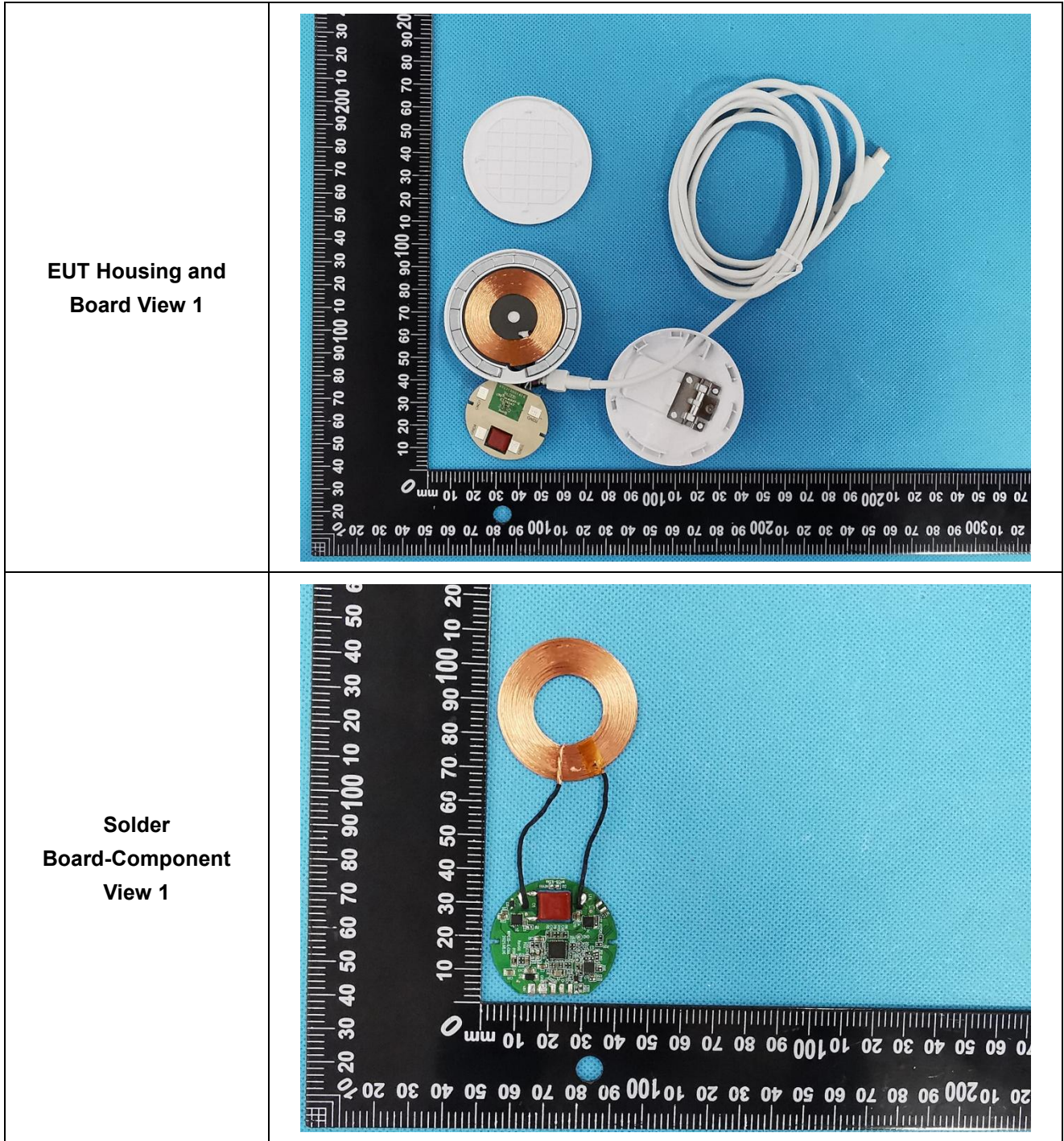

EXHIBIT 3 - EUT INTERNAL PHOTOGRAPHS



| | |
|---|---|
| <p style="text-align: center;">Solder Board-Component View 2</p> | <p>A photograph showing a circular green PCB component with a red DCDC converter chip and a toroidal inductor. The component is placed next to a metric ruler for scale. The ruler shows measurements in millimeters and centimeters. The component is approximately 60mm in diameter. The PCB has various components and markings, including 'WPC15-1L1CNA' and 'REV00'.</p> |
| <p style="text-align: center;">Solder Board-Component View 3</p> | <p>A close-up photograph of the underside of the circular green PCB component. The board is populated with various electronic components, including a large red DCDC converter chip, several capacitors, resistors, and integrated circuits. The board is marked with 'WPC15-1L1CNA' and 'REV00'. Two black wires are connected to the board.</p> |

