

USER MANUAL

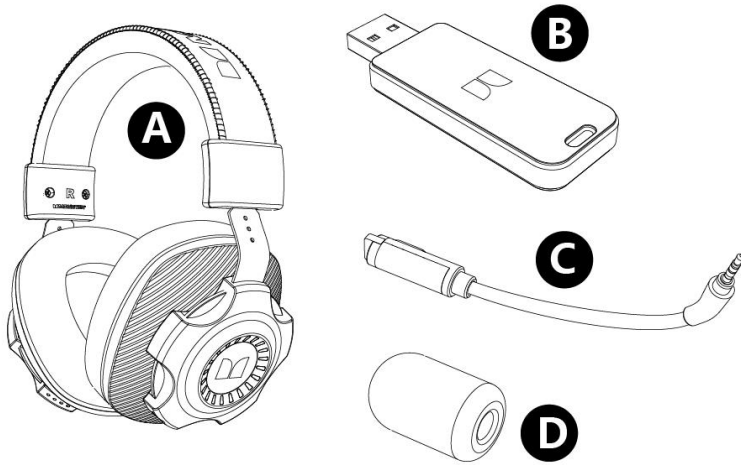

Package list

- A Wireless headset x1
- B USB transmitterx1
- C Detachable microphone x1
- D Microphone protective foam x1

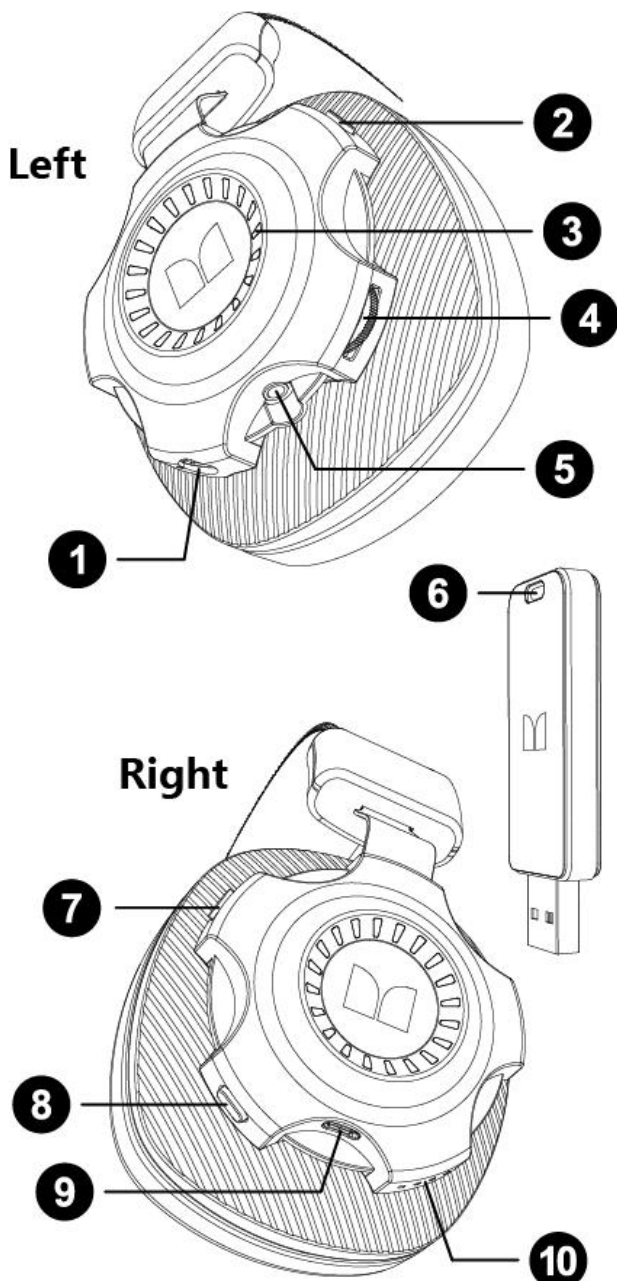

Headset introduction

- 1 Microphone plug in port
 - Make alignment of a point in microphone and b point in the headset microphone plug in port then plug in microphone.
- 2 Microphone on/off
 - Lighting effect is breathing effect
 - Light will be on when headset connected with USB transmitter.
- 3 LED light (red)
 - Plug in 3.5mm audio cable port, wireless headset will switch to wired headset. Power on/off switch will be unusable.
- 4 Volume turning wheel
- 5 3.5mm audio port
 - Plug in 3.5mm audio cable port, wireless headset will switch to wired headset. Power on/off switch will be unusable.
- 6 USB transmitter indicate light(blue)
 - When headset is not connected to USB transmitter, the indicator light is flashing in blue;
 - When headset is connected to USB transmitter, the indicator light is on.
- 7 LED light switch
- 8 Power on/off switch
 - Long press 3seconds, headset powered on with power on music
 - Long press 3seconds, headset powered off with power off music
- 9 Charging port
 - Charging the headset when it' s powered on, headset will power off automatically
 - When headset in charging mode, power indicator light will on.
- 10 Power indicator light
 - 4 indicator light stands for battery capacity
 - When headset is not connected to USB transmitter, the indicator light is flashing
 - When headset is connected to USB transmitter, the indicator

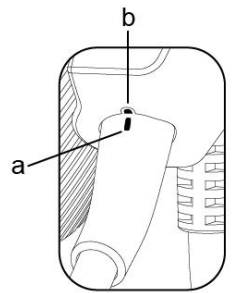

light is on.

- When battery low, single one indicator light will flash, headset will have low power music notice.

FCC STATEMENT OF COMPLIANCE

This device complies with Part 15 of the FCC rules. Operation is subject to the following two conditions:

- 1) This device may not cause harmful interference.
- 2) This device must accept any interference received, including interference that may cause undesired operation.

Warning: Changes or modifications to this unit not expressly approved by the party responsible for compliance could void the user's authority to operate the equipment.

NOTE: This equipment has been tested and found to comply with the limits for a Class B digital device, pursuant to Part 15 of the FCC rules. These limits are designed to provide reasonable protection against harmful interference in a residential installation. This equipment generates, uses and can radiate radio frequency energy and, if not installed and used in accordance with the instructions, may cause harmful interference to radio communications. However, there is no guarantee that interference will not occur in a particular installation. If this equipment does cause harmful interference to radio or television reception, which can be determined by turning the equipment off and on, the user is encouraged to try to correct the interference by one of more of the following measures:

Reorient or relocate the receiving antenna.

Increase the separation between the equipment and the receiver.

Connect the equipment into an outlet on a circuit different from that to which the receiver is connected. Consult the dealer or an experienced radio/TV technician for help.

The device has been evaluated to meet general RF exposure requirement. This device should be installed and operated with a minimum distance of 5mm between the device and your body.