



Package

尺寸/Size	65x90mm
材质 Paper type	封面105g哑粉/内文80g哑粉 Cover 105g Matt art paper/Text 80g Matt art paper
工艺 Print and Finish	单色印刷/骑马订 1color print/Saddle stitching

RMP2106/FCC/WiFi版 65x90mm, 双面印刷, 105g哑粉(封面封底)+80g亚粉(内页), 钉装, K=90%

封底



封面



封底内页留白

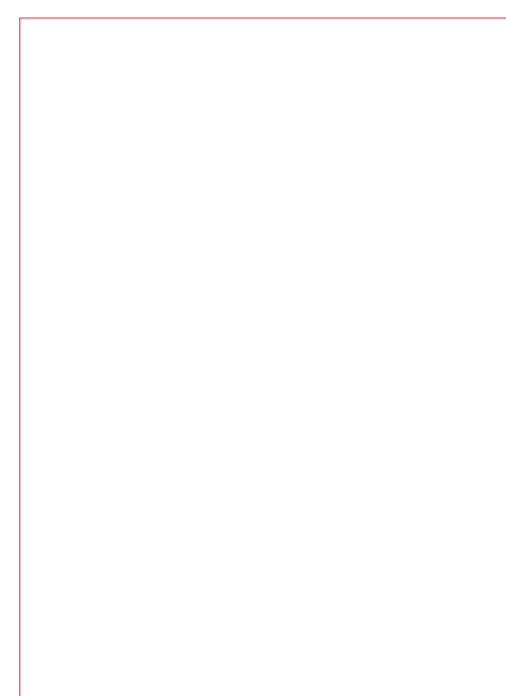

封面内页留白

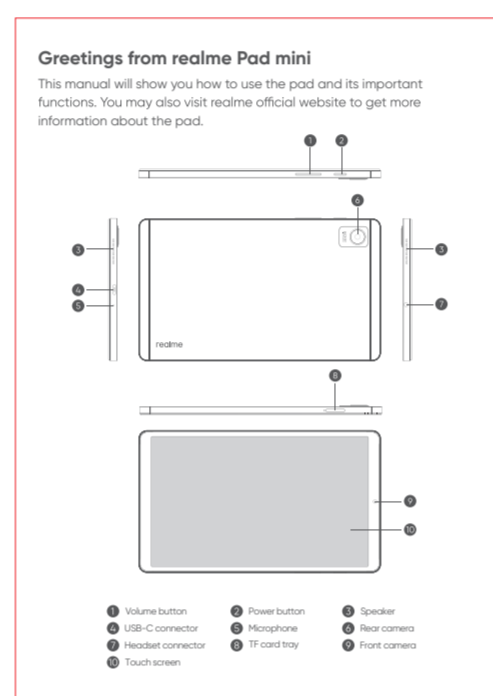
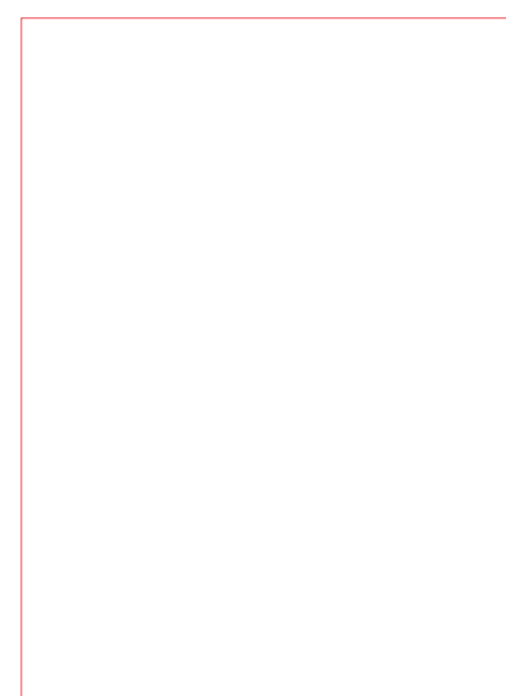

**Warning**  
Do not place the tablet or battery near or inside heating equipment, cooking equipment, high pressure vessels (such as microwave ovens, induction cookers, electric kettles, hot water pressure cookers, water heaters, gas stoves, etc.) to prevent the battery overheating which may lead to an explosion.  
The original charger, data cable and battery shall be used. Unapproved charger, data cables, or batteries that are not certified by the manufacturer may result in electric shock, the explosion, or other hazards.  
When charging, please place the device in an environment that has a normal room temperature and good ventilation. It is recommended to charge the device in an environment with temperature ranging from 5°C-35°C.  
The battery can not be removed from the device. If you need to replace, please contact nearest Authorized Service Center.

**Standard accessories**  
You are provided with the following standard accessories:  
Pad x 1, Charger x 1, Data Cable x 1, User Manual x 1, SIM Pin x 1.

**Specification**

Product	RMP2106
Main screen parameter	22.0mm x 8.71
Dimension	218.4 x 154.5 x 7.6mm
Battery	6300mAh (24.22Wh) 6600mAh (26.16Wh)
Camera	Rear: 8MPixel Front: 8MPixel
Operating temperature	0°C-35°C
SAR Values	FCC SAR: 1.93W/kg (Body) X-ROF (W): (Body)

**Radio Wave Specifications**

Radio	Frequency	Max Output Power
Bluetooth	2.4-2.4835GHz	10.5dBm(EIRP)
	2.4-2.4835GHz	10.5dBm(EIRP)
2.4G Wi-Fi	5.15-5.35GHz	17.0dBm(EIRP)
	5.47-5.725GHz	19.2dBm(EIRP)
5G Wi-Fi	5.02-5.85GHz	18.8dBm(EIRP)

This user manual provides the product safety information. Before using the tablet, please read the Safety Guide carefully.

**Statement**  
The User Manual contains information regarding safety, operation and customer service. Before using the realme Tablet, please read the instructions and the safety information below, and keep it for backup. More detailed instructions are listed in this product on electronic file. Please read the built-in instructions on the realme Tablet. For the latest information, please visit <https://www.realme.com>.

**Security information**  
This tablet is suitable for working in an environment of 0°C to 35°C. Temperature for storage should be between -20°C and 45°C. Excessively high or low temperatures can affect the use of tablet and even damage the tablet and battery. When using this tablet, please avoid places near telephones, televisions, radios, and other automation machines. Please charge this tablet in an environment between 0°C and 35°C, so as not to reduce battery performance and standby time. If the tablet has a flash charging function, it may not be able to enter the flash charging mode when the temperature is below 10°C or over 35°C.

The operating system of this product supports official system updates. If the user rooted the ROM system of any third party or modified the system file by cracking, it may lead to security risks of the system. realme will not provide any support nor take any responsibility for the first user in these cases.

**Battery precautions in use**  
1. Please do not weld battery terminals. Otherwise, it may cause battery leakage, overheat, explosion and fire.  
2. Please do not press or pierce the battery with hard objects. For example nails or other sharp objects, to avoid damage, battery leak, overheating or fire.

3. Battery liquid may be harmful if contacted with skin or clothes, your skin might be hurt. Please immediately wash it with water, or go to hospital at once to seek medical help if necessary.  
4. If there are any abnormalities like high temperature, discoloration, distortion bulging, leakage, etc. during operation, charging or preservation, please cease to use the device.  
5. When happens, wash your feet immediately or go to the hospital if serious.  
6. Do not disassemble or modify the battery, as it may cause battery leakage, overheating, explosion or fire.  
7. Do not place or use the battery near fire, heater or other high temperature places. Otherwise, it may cause battery leakage, overheat, explosion or fire.  
8. If there is battery leakage or strange smell, please immediately move it from open flame in order to avoid fire or explosion.  
9. Please keep the battery away from metal or areas from moisture. Otherwise, it may cause battery overheat, lumping and corrosion.  
10. Do not place the battery directly in sunlight or other high temperature areas. Otherwise, battery leakage and overheating may reduce battery performance and service life affected. Keep the battery in a well-ventilated area.  
11. Do not use the battery or connect it with a high-voltage power supply, otherwise it may cause a short circuit or burn.  
12. The battery can be charged and discharged hundreds of times at least, but it will eventually wear out.  
13. Do not dispose the battery on household waste. Dispose the battery according to local regulations.  
Caution: Risk of explosion! Battery is replaced by an incorrect type. Dispose of used batteries according to the user manual.

**Warning:** Please do not charge the battery over 12 hours.  
**Other matters of attention**  
1. Adapter shall be installed near the equipment and shall be easily accessible.  
2. If any part of the product is cracked or damaged, discontinue use immediately and contact the realme Service Center.  
3. To prevent possible heating damage, do not lean or high volume lean for long periods.  
**Waste Electrical and Electronic Equipment (WEEE)**  
This symbol means that according to local laws and regulations your product and/or its battery shall be disposed of separately from household waste. When this product reaches its end of life, user has the choice to give to the product to a compliant recycling organization. Proper recycling of your product will protect human health and the environment.  
realme will seek shared responsibility and cooperation from customers in reducing the environmental impact of their products.  
realme will comply with all the applicable laws related to WEEE management.  
**EU Declaration of Conformity (DoC)**  
Hereby, realme Chongqing Mobile Telecommunications Corp., Ltd. declares that this wireless device is in compliance with the essential requirements and other relevant provisions of Directive 2014/53/EU. The full text of the EU declaration of conformity is available at the following internet address: <https://www.realme.com/global/support/ku-declaration>.

**CE certification information (SAR)**  
This device was tested for typical body-worn operations with the back of the tablet kept 5.0cm away. To maintain compliance with RF exposure requirements, use accessories that maintain a 5.0cm separation distance between the user's body and the back of the tablet. The use of both clips, holsters and similar accessories should not contain metal components in its assembly. The use of accessories that do not satisfy these requirements may not comply with RF exposure requirements, and should be avoided.  
If you are using powerbank, hearing aid, cochlear implant or other device, please use the tablet according to the doctor's advice.  
**Notice:**  
Observe national and local regulations where the device is used. This device may be restricted for use, depending on the local network. The operation frequency in 300-550MHz of Wi-Fi 5G are restricted to indoor usage only.  
**RF Exposure Information (SAR)**  
This tablet is designed and manufactured not to exceed the emission limits for exposure to radio frequency (RF) energy set by the Federal Communications Commission of the United States.  
During SAR testing, this device was set to transmit at its highest certified power level in all tested frequency bands, and placed in positions that simulate RF exposure in near the body with the separation of 0 mm. Although the SAR is determined at the highest certified power level, the actual SAR level of the device while operating can be well below the maximum value. This is because the Tablet is designed to operate at multiple power levels so as to use only the power required to

reach the network. In general, the closer you are to a wireless base station antenna, the lower the power output.  
The exposure standard for wireless devices employing a unit of measurement is known as the Specific Absorption Rate, or SAR. The SAR limit set by the FCC is 1.6W/kg.  
This device is certified with SAR for general population (uncontrolled exposure limits in ANSI/IEEE C95.1-1992 and had been tested in accordance with the measurement methods and procedures specified in IEEE 1528.  
The FCC has granted an Equipment Authorization for this tablet with all reported SAR levels evaluated in compliance with the FCC RF exposure guidelines. SAR information on this tablet is on file with the FCC and can be found under the Display Grant section of [www.fcc.gov/etf/ku](http://www.fcc.gov/etf/ku) folder after searching on FCC ID: Z4UW19P0000.  
For this device, the highest reported SAR value for charge test the body is 1.93 W/kg.  
While there may be differences between the SAR levels of various tablets and at various positions, they all meet the government requirements. SAR compliance for body-worn operation is based on a separation distance of 5.0 mm between the unit and the human body. Carry this device at least 5.0 mm away from your body to ensure RF exposure level complies or lower to the reported level. To support body-worn operation, choose the built clips or holsters, which do not contain metallic components, to maintain a separation of 5.0 mm between this device and your body.  
RF exposure compliance with any body-worn accessories, which contain metal, was not tested and certified, and use such body-worn accessory should be avoided.  
**Regulatory**  
Please to search E-label: Go to Settings>About tablet>Regulatory.

**Product Warranty Information**  
**1. Service Terms**  
Thank you for using realme tablet. We will provide our product with comprehensive warranty services in accordance with applicable national laws and regulations, in case of any conflict between the following policies and the National Policies, or Commissions, the national policies shall prevail.  
Within 12 months from the purchasing date, in the event that performance failure occurs from normal use, customer can claim for maintenance. The accessories such as charger, data cable have a 6-month warranty. The battery (including internal battery) has a 12-month warranty.  
Please see the dealer to issue an invoice and keep it in a safe to avoid warranty services.  
Valid purchase invoice: the invoice shall include the serial number of the tablet, factory serial number, batch number of the accessories (battery and charger), product model, sales date, Seller's seal, amount and so on.  
A valid invoice are essential for protecting your warranty rights. Invalid invoice: the information filled in shall be complete, true and correct without alteration. If you lose the valid invoice and are unable to provide us with a photocopy of them, we will provide your tablet with a 12-month warranty.  
Our warranty does not cover the other accessories for the product (for instance: the user manual, warranty card, etc.).  
**2. Note:** The above warranty is only valid for the products sold in this country, neither have the right of final review and interpretation for the warranty policy.  
**3. Warranty Instructions and Conditions**  
I. Service Terms  
Thank you for using realme tablet. We will provide our product with comprehensive warranty services in accordance with applicable national laws and regulations, in case of any conflict between the following policies and the National Policies, or Commissions, the national policies shall prevail.  
Within 12 months from the purchasing date, in the event that performance failure occurs from normal use, customer can claim for maintenance. The accessories such as charger, data cable have a 6-month warranty. The battery (including internal battery) has a 12-month warranty.  
Please see the dealer to issue an invoice and keep it in a safe to avoid warranty services.  
Valid purchase invoice: the invoice shall include the serial number of the tablet, factory serial number, batch number of the accessories (battery and charger), product model, sales date, Seller's seal, amount and so on.  
A valid invoice are essential for protecting your warranty rights. Invalid invoice: the information filled in shall be complete, true and correct without alteration. If you lose the valid invoice and are unable to provide us with a photocopy of them, we will provide your tablet with a 12-month warranty.  
Our warranty does not cover the other accessories for the product (for instance: the user manual, warranty card, etc.).  
**2. Note:** The above warranty is only valid for the products sold in this country, neither have the right of final review and interpretation for the warranty policy.  
**3. Warranty Instructions and Conditions**  
I. Service Terms  
Thank you for using realme tablet. We will provide our product with comprehensive warranty services in accordance with applicable national laws and regulations, in case of any conflict between the following policies and the National Policies, or Commissions, the national policies shall prevail.  
Within 12 months from the purchasing date, in the event that performance failure occurs from normal use, customer can claim for maintenance. The accessories such as charger, data cable have a 6-month warranty. The battery (including internal battery) has a 12-month warranty.  
Please see the dealer to issue an invoice and keep it in a safe to avoid warranty services.  
Valid purchase invoice: the invoice shall include the serial number of the tablet, factory serial number, batch number of the accessories (battery and charger), product model, sales date, Seller's seal, amount and so on.  
A valid invoice are essential for protecting your warranty rights. Invalid invoice: the information filled in shall be complete, true and correct without alteration. If you lose the valid invoice and are unable to provide us with a photocopy of them, we will provide your tablet with a 12-month warranty.  
Our warranty does not cover the other accessories for the product (for instance: the user manual, warranty card, etc.).  
**2. Note:** The above warranty is only valid for the products sold in this country, neither have the right of final review and interpretation for the warranty policy.  
**3. Warranty Instructions and Conditions**

1. Your warranty (please refer to the Warranty Information Card) is only valid under normal use of your device. All man-made damages and any of the following conditions are out of free warranty, but a repair can be still implemented at your own cost:  
A. The warranty period has expired.  
B. Damages caused by human factors, including damages caused by usage under improper operating environment and the failure to the user manual.  
C. Damage caused by a force majeure (such as floods, fire, earthquakes and lightning).  
D. The user is unable to provide valid proof of purchase or the product model and barcode do not match or are others.  
E. Natural wear and tear of the product such as casing, keypad, display screen, antenna and other accessories.  
F. Faults, damages or defects not caused by the company.  
G. Barcode and warranty labels are damaged and unreadable.  
H. External damage/including wear, tear, and scratched are not attributed to the warranty service.  
I. Our warranty does not cover services wholly promised by the dealer which violate program set forth on the warranty card. For products that meet the replacement requirements, you can visit to our nearest Authorized Service Center for replacement. Upon replacement, if the device is faulty, we can replace it with a device of the same specification and model. If any accessory is faulty, the faulty accessory will be replaced. Both replacements are free of charge.

3. If any of our products is required to be fixed, you may take it to any realme Authorized Service Center.  
4. If the product requires repair after water enters the device or it is seriously damaged by human factors, the customer needs to sign the repair job sheet form with the realme Authorized Service Center firstly.  
5. All components, parts and accessories replaced during the warranty period shall become the property of the Company.  
**III: Considerations for Sending the Device for Repair and Collecting It**  
1. When completing the realme tablet Repair Form, the customer must fill in valid information in clear handwriting on required (name, address, phone number and fault symptoms).  
2. Before sending your device for repair, please back up all information and data you have saved on the tablet (such as phone numbers, text messages and pictures) before you delete them to prevent loss or damage during the testing and inspection process. In any circumstances, realme Authorized Service Center staff will not be responsible or obligated to back up or recover your information and data, or accept responsibility for any consequence arising from the loss, damage or leakage of your information and data. Please ensure the legitimacy of the information and data you have saved. To respect your privacy, we will not transfer, backup or examine your information and databases they are necessary for us to provide you with services, and we reserve the right to refuse to provide services for illegal content.  
3. The Customer shall collect the tablet by presenting the realme tablet Repair Form. In case the Customer loses the Customer Copy, the Customer shall go through the lost reporting procedures with his/her personal ID or valid proof of identity before collecting the tablet.

**WARRANTY CARD (Stub Copy)**  
Respectable customer, this warranty card is your proof of applying for warranty in the future. Please cooperate with the seller to fill in and keep it properly for future use!

User Information	Name	
	Address	
	Mobile No.	
	City	
Product Information	Product Name	
	Product Model	
	Product SN	
	Vendor/Company Name	
	Address	
Vendor Information	Mobile No.	
	Sales date	
	Invoice number	
remark		

**WARRANTY CARD (Customer Copy)**  
Respectable customer, this warranty card is your proof of applying for warranty in the future. Please cooperate with the seller to fill in and keep it properly for future use!

User Information	Name	
	Address	
	Mobile No.	
	City	
Product Information	Product Name	
	Product Model	
	Product SN	
	Vendor/Company Name	
	Address	
Vendor Information	Mobile No.	
	Sales date	
	Invoice number	
remark		

技术要求/Notes:

公差/Tolerance: ± 1.0mm

套印/Overprinting variance: ± 0.1mm

颜色色差/Ink Density: 3或依照限度样品/ 3 or follow limit board

A. 所有材料必须符合RoHS、HF无卤和REACH的要求

All materials need to meet the requirements of RoHS、Halogen-Free and REACH

B. 符合Accord With:

包装指令Packaging instructions CP65 其他Other\_\_\_\_\_ [勾选Check ]

供应商代码：  
自行添加供应商代码后四位位于包材隐蔽处，以便识别。

标识内容：  
需要标注包装材料、材料加工工艺、设计尺寸。



项目名称\国家:  
RM

版本: V1.0  
页码: P01

图纸尺寸: A3  
比例: 1:1

绘图: 张艳群 日期: 2022.03.04  
检查: 黎孔刚 日期: 2022.03.04  
审批: 董小林 日期: 2022.03.04

**THIS DOCUMENT CONTAINS PROPR - IERARY INFORMATION AND SHALL NOT BE DUPLICATED OR DISCLOSED TO OTHERS WITHOUT THE PRIOR WRITTEN PEMISSION OF NEWIDEA.**