

Massage Chair

User Manual

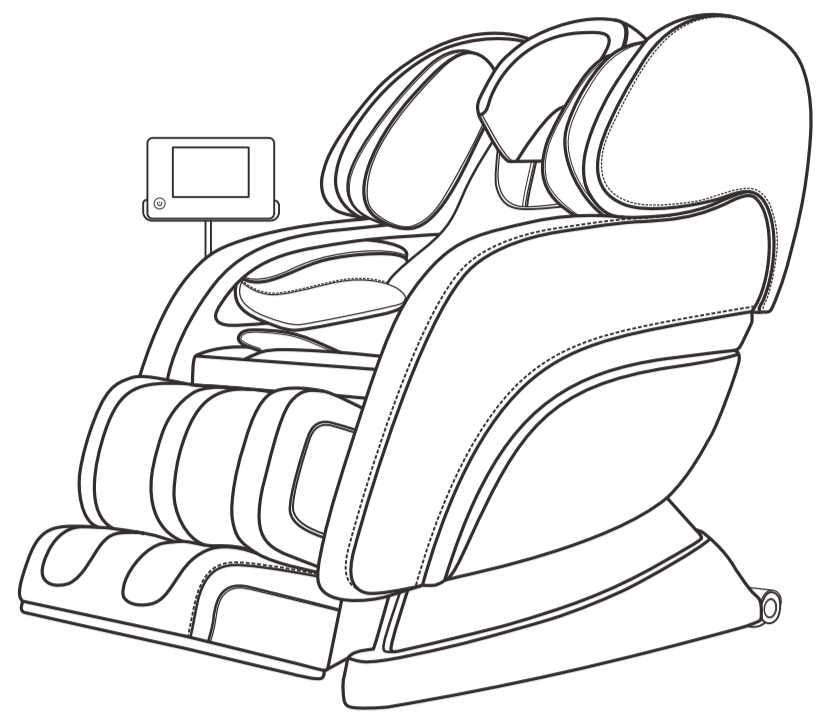

User Manual

Thank you for purchasing your Ultimate Health massage chair. Before operating your new chair please read this instruction manual carefully. Please pay attention to the important safety warnings and keep this manual for future use.

Contents

Safety Warnings & Restricted Use	2
Chair Overview	3
Installation and Set Up	4-7
Set Up and Preparation	8
Remote Control Functions	9
How to Use the Remote Control	10-12
LCD monitor	13
How To Use The Mini Control	14
Operational Instructions	15
Troubleshooting & Maintenance and Cleaning & Storage	16
Warranty	17
Product Specifications	18

Safety Warnings

- Use only according to the rated voltage.
- Ensure hands are dry when handling the power cord.
- Do not use the chair if the power cord becomes wet or damaged.
- If the power cord becomes damaged, please ensure it is repaired or replaced by a qualified professional.
- Pull out the cord and turn off the power if there is an outage or interruption to mains power.
- Ensure you are positioned correctly in the chair prior to use. Do not place fingers or any part of the body into gaps while the chair is in operation.
- Children should always be supervised while the chair is in operation.
- Be careful to ensure there is nothing underneath the leg massage unit when it is being lowered.
- Watch children and pets closely.
- Do not sit on the chair footrest while in operation to avoid accidents.
- Do not use the chair if the outer PU coverings are torn or damaged.

Restricted Use (Please read carefully)

- Please avoid using the massage chair or consult a medical professional prior to use if:
- you suffer from osteoporosis, bone disease or any form of bone weakness.
 - you are suffering from any spinal injury or serious back pain.
 - you have suffered a recent bone fracture or other significant injury.
 - you suffer from high blood pressure, cardiac disease, cerebral atherosclerosis or cerebral thrombosis.
 - you are currently undertaking treatment for any post-surgery or serious health issue.
 - you have a cardiac pacemaker or other implantable medical device.
 - you are pregnant or have recently given birth.
 - you are suffering from a fever or excessive body temperature.
 - you are suffering from a significant skin irritation.

Chair Overview

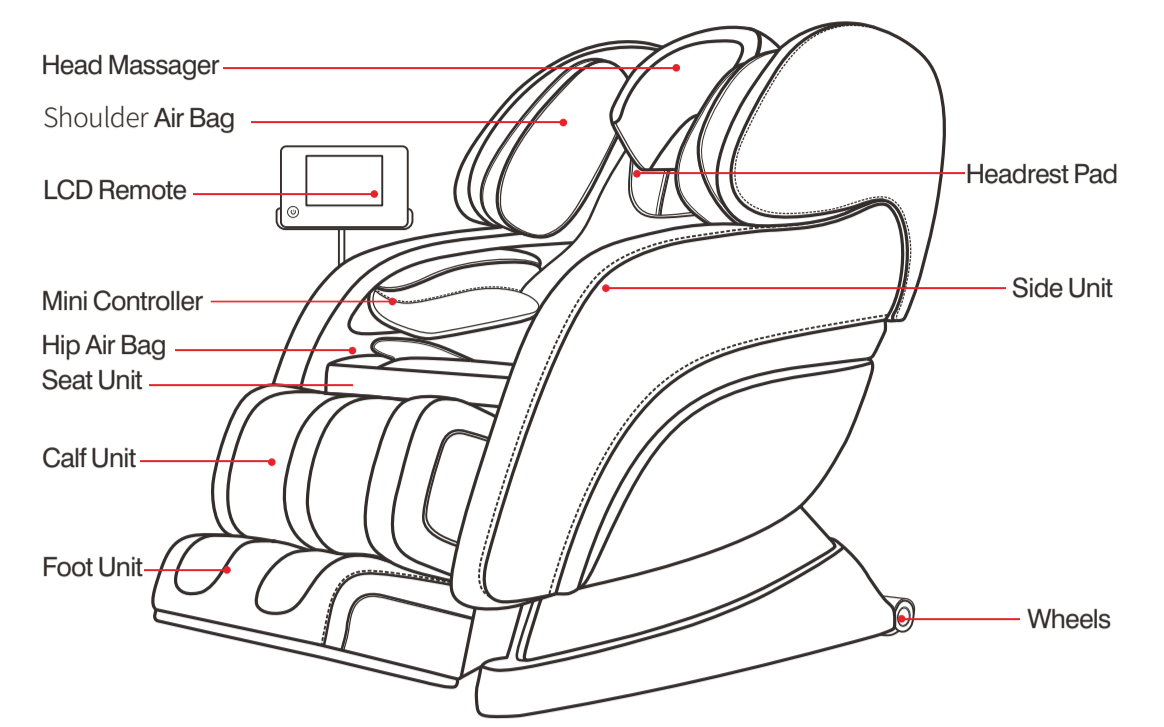

Installation and Set Up

1. Unpacking
 - a) Carefully remove the outer packaging from the massage chair.
 - b) Carefully remove the Armrests from the 2nd carton and place next to the chair.
2. Attach the Armrests
 - a) Connect the armrest tubes and chair connection together by matching the same colours.
3. Attach the Footrest
 - a) Lift the armrest and align the 3 nuts of the armrest with the corresponding grooves on the side of the chair.
 - b) Insert the 2 lower nuts into the metal frame of the chair. After inserting the nuts push the armrest forwards and upwards. The armrest should click into the chair to complete this step.
 - c) Repeat step a to complete both the left and right hand armrests.
4. Attach the Backrest Pad
 - a) Fix the bottom of the armrest to the seat cushion with the screws provided.
 - b) Fix the upper section of the armrest to the shoulder of the chair with the screws provided.

3. Attach the Footrest

- a) Connect the footrest tubes and chair connections together by matching the same colours.
- b) Connect the footrest onto the bottom of the massage chair using the brackets provided.
- c) Insert screws into the circular grooves then place a round pin on each screw to secure them in place.

4. Attach the PU Leather Covers

- a) Connect the backrest pad to the top of the chair using the zippers attached.
- b) Connect the headrest pad and waist cushion to the chair using the hook & loop attachments.

5. Attach the LCD Remote Screen

- Attach one end of the controller cord to the connection at the back of the chair and the other end into the attachment on the right hand armrest.

Set Up and Preparation

- Attention: Do not use in a wet area such as bathrooms or saunas. Place the chair on a flat, non-slippery surface. Do not place in direct sunlight or other hot or dusty locations.
- When positioning the massage chair be sure to leave 15cm space at the back of the chair and 15cm space in front of the chair so that the legs and backrest can be reclined and raised without contacting walls or other items.
- Do not place the power cord in the electric control box at the rear of the chair.
- Check to ensure the cord is not under the massage chair.

Check if preparation is complete insert the plug into the power outlet and turn on the power switch.

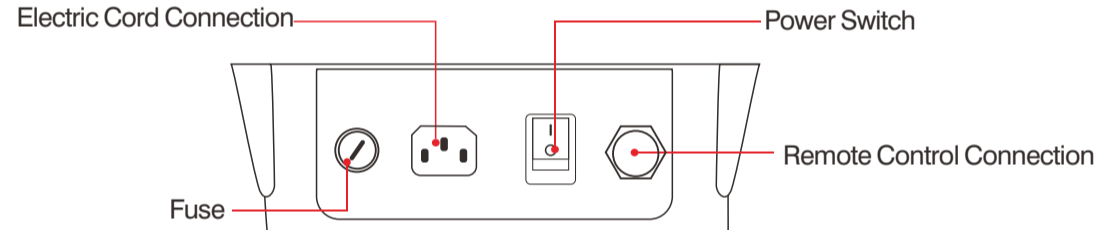

Remote Control Functions

- 1. Power
- 2. Auto program: Relaxation, Thai, Chinese, Morning, Night
- 3. Air Bag pressure
- 4. Backrest control
- 5. Footrest control
- 6. Zero Gravity (3 steps)
- 7. Heating
- 8. Air pressure Section: Air pressure Intensity Control (1. Legs, Feet; 2. Hip, Waist; 3. Arms, Shoulders)
- 9. Foot Roller / Rolling speed control
- 10. Massage section (1. Full; 2. Section; 3. Point)
- 11. Back Massage Manual program (1. Kneading; 2. Tapping; 3. Dual action; 4. Knocking; 5. Finger-pressing)
- 12. Position Control
- 13. Width control (3 steps)
- 14. Back Massage Intensity Control
- 15. Time

How to Use the Remote Control

1. Power: Press to turn the Massage Chair On or Off.
2. Auto Program: Press to select from 5 automated massage programs: Relaxation, Thai, Chinese, Morning, Night.
3. Air Bag Control: While in Auto Mode use this option to turn each airbag section On or Off as desired (3 sections: Legs & Feet, Hip & Waist, Arms & Shoulders).
4. Time: Use this button to change the massage time anywhere between 5 and 30 minutes. The default time is 20 minutes.
5. Backrest Control: Backrest Up: Press to raise the backrest; Backrest Down: Press to lower the backrest.

Footrest Control

6. Footrest Control: Footrest Up: Press to raise the footrest; Footrest Down: Press to lower the footrest.
7. Zero Gravity: Press to move the chair into the zero gravity position (3 steps).
8. Air Pressure: Select the section required (Legs & Feet, Hip & Waist, Arms & Shoulders) then adjust the air pressure to the desired level (3 levels).
9. Foot Roller: Press to turn the foot roller On/Off or adjust the speed (3 levels).
10. Heating: Press to turn the heating On/Off.
11. Back Massage Manual Program: Press to select from 5 massage options: Kneading, Tapping, Dual Action, Knocking, Finger Pressing.

- 12. Back Massage Intensity Control: In the Manual Mode this can be used to adjust the massage intensity.
- 13. Width Control: Use this button to adjust the width between the massage heads (3 levels). This option is available in Tapping, Finger Pressing & Knocking modes.
- 14. Massage Section: Use this button to select the location of the back you wish to massage while in manual mode (Full, Section or Point).
- 15. Position Control: Use this button to move the position of the massage while in manual mode.

LCD monitor

- Time remaining (default time is 20 mins)
- Auto Program Indicator: A) Relaxation B) Thai C) Chinese D) Morning E) Night
- Full / Section / Point Indicator
- Massage Width Indicator
- Massage Strength Indicator
- Air Pressure Indicator
- Foot Roller Speed Indicator
- Shoulder Scan Indicator
- Back Massage Indicator
- Massage position and air pressure indicator
- Heating Indicator

How To Use The Mini Control

- 1. Zero G: Press to move the chair to the zero gravity position.
- 2. Backrest Control: Press to alter the backrest position up or down.
- 3. Footrest Control: Press to alter the footrest position up or down.
- 4. Pause: Press to Pause the massage operation. Press again to restart. The chair will automatically restart after pause is in place for one minute.
- 5. Auto Program: Press to move between the 5 Auto massage programs (Relaxation, Thai, Chinese, Morning, Night).
- 6. Shoulder Up: Press to move the shoulder massage position upwards (when in Manual mode).
- 7. Shoulder Down: Press to move the shoulder massage position downwards (when in Manual mode).

Operational Instructions

- Press the power button to turn on the massage chair.
- Use the remote control touch screen to select the desired massage program:
 - a) Automatic (Choose one of 5 pre-programmed options)
 - b) Manual (Use manual option to select desired massage modes, functions and intensity levels)
 Refer to previous sections above for specific details around control options and functions.
- Press the power button to turn off the massage chair (the chair will automatically return to its original position).

Troubleshooting

- If the chair stops working, fails to function normally or makes unusual sounds:
- Disconnect the power from the mains.
 - Check all connections are secure and undamaged.
 - If there is damage to the power cords or connections do not attempt to restart the machine. Ensure the damage is repaired by a qualified professional prior to re-use.
 - If all connections are secure connect the power and restart the machine (it is recommended to wait 20-30 mins to allow the machine to fully cool down).
 - If problems persist, contact your local agent or place of purchase to arrange servicing by a qualified technician.

Maintenance and Cleaning

- Prior to cleaning make sure the unit is turned off and the power cord unplugged.
- Some chair cushions and airbags are attached by zips and are able to be removed for cleaning and re-fitted. Please take special care to ensure no damage occurs during this process.
- Wipe the PU leather cushions or other chair exterior with a damp cloth. Use very low concentrations of neutral cleaning detergents if required.
- Use leather-care products for additional wear and tear maintenance.
- Do not use corrosive cleaners under any circumstances.
- Ensure hands are dry before handling the power cords, remote control or plugging the unit in to the mains.

Storage

- Handle carefully at all times to avoid damage and follow the instructions provided when moving the chair.
- Avoid exposure to moisture, direct sunlight or hot temperatures.
- Use a dust cover for long periods of storage to prevent dust falling into the unit.

Warranty

- This product is guaranteed for one year from the date of purchase.
- Any manufacture faults during this time will be repaired or a replacement provided.
- If required please contact your local sales agent or place of purchase to discuss maintenance needs.
- This warranty does not cover any damage or fault resulting from mistreatment by the user or failure to follow the instructions provided.

Product Specification

Product Name	Massage Chair
Rated Voltage	AC120V - 60Hz
Rated Power	180W
Weight	140KG

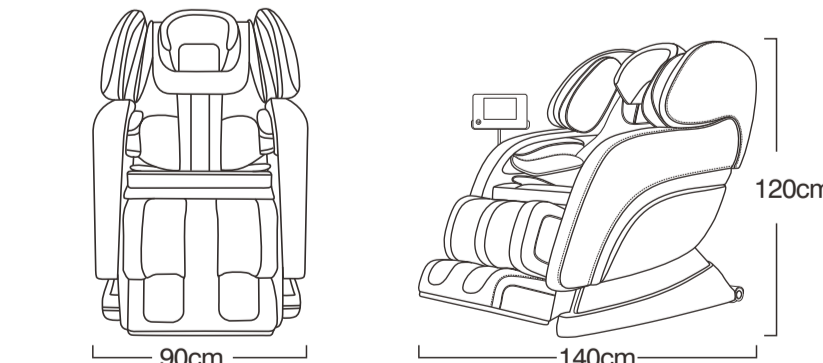

FCC STATEMENT

1.This device complies with Part 15 of the FCC Rules.

Operation is subject to the following two conditions:

(1)This device may not cause harmful interference, and

(2)This device must accept any interference received, including interference that may cause undesired operation.

2.Changes or modifications not expressly approved by the party responsible for compliance could void the user's authority to operate the equipment.

FCC Radiation Exposure Statement:

This equipment complies with FCC radiation exposure limits set forth for an uncontrolled environment. In order to avoid the possibility of exceeding the FCC radio frequency exposure limits, Human proximity to the antenna shall not be less than 20cm (8 inches) during normal operation.

NOTE – This equipment has been tested and found to comply with the limits for a Class B digital, pursuant to Part 15 or the FCC Rules. These limits are designed to provide reasonable protection against harmful interference in a residential installation. This equipment generates, uses and can radiate radio frequency energy and, if not installed and used in accordance with the instructions, may casue harmful interference to radio communications, However, there is no guarantee that interference will not occur in a particular installation. If the equipment does cause harmful interference to radio or television reception, which can be determined by turning the equipment off and on, the user is encouraged to try to correct the interference by one or more of the following measures:

- Reorient or relocate the receiving antenna.
- Increase the separation between the equipment and receiver.
- Connect the equipment into an outlet on a circuit different from that to which the receiver is connected.
- Consult the dealer or an experienced radio/ TV technician for help.