

---

# FitGrip

---

## User manual

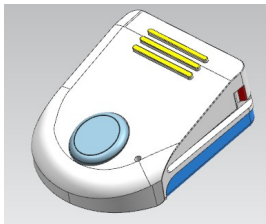

## OVERVIEW

---

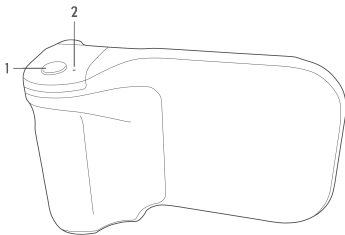

1. Remote Control Shutter Button
2. Remote Control LED Indicator

### **Packing List:**

FitGrip (SR01) plus case x1  
Tripod x1

## QUICK GUIDE

---

### **Turn ON Remote Control**

1. Click the shutter button to turn on. LED will begin to slowly flash green until the Bluetooth is connected.
2. Go into Bluetooth settings on the mobile device and select Adonit Photo Remote, the green flashing light will turn off when connected. If Bluetooth is not connected in 30 seconds, Remote Control will automatically turn off, please refer to Step 1 to re-connect the Bluetooth setting.
3. Go into Camera App to start shooting.

\*for more information on Bluetooth pairing, please refer to our support page at [adonit.net/support](https://adonit.net/support)

## Turn OFF Remote Control

1. Press the shutter button for 3 seconds to turn off and the Green LED light will be off.
  2. Remote shutter will automatically turn off when inactive for 10 minutes.
- \*If Remote Control can not be turned on, please change the battery.

## USER TIPS

---

### Remote Control

Detach the remote shutter from the grip to take photos at a distance. Click the button once to take photos.

## REMOTE CONTROL BATTERY INSTALLATION

---

Battery: CR2016

Please remove insulation sheet before use.

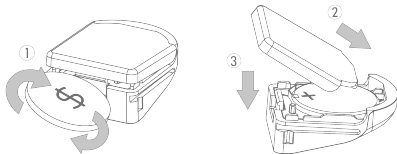

\*Please keep away from any liquid.

\*Please keep battery and remote control away from children.

## 总览

---

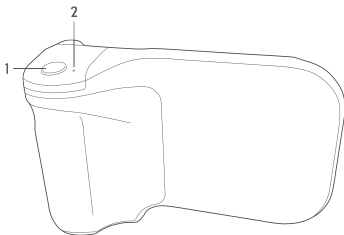

1. 遥控器快门按钮
2. 遥控器 LED 指示灯

**包装清单:**  
FitGrip (SR01) plus case x 1  
三脚架 x 1

## 快速指南

---

### 打开快门遥控器

1. 点击一次蓝牙快门后，LED 绿灯亮一秒后开始闪烁。
2. 在手机上前往蓝牙设定，再选择 Adonit Photo Remote，连接成功后，绿灯将熄灭。若30秒内无联机蓝牙，快门遥控器将自动关机，如需重新联机请参考步骤1说明。
3. 前往相机应用程序开始拍摄。

\*欲知更多蓝牙配对信息，请参见 [adonit.net/support](https://adonit.net/support) 上的支持页面

## 关闭快门遥控器

1. 长按快门按钮 3 秒钟即可关闭电源，绿色 LED 灯熄灭表示电源已关闭。

2. 无使用状态达 10 分钟后，遥控快门将自动关闭。

\*如快门遥控器无法开机，请尽速更换电池。

## 用户提示

---

### 遥控功能

从握把上取下遥控快门可远镜头拍照。单击按钮即可拍下照片。

### 快门遥控器的电池安装

---

电池：CR2016

请在使用前取下绝缘片。

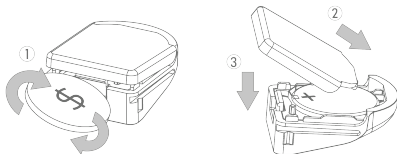

\*请远离任何液体。

\*请将电池和遥控器远离儿童。

This equipment has been tested and found to comply with the Limits for a Class B digital device, pursuant to Part 15 of the FCC Rules. These Limits are designed to provide reasonable protection against harmful interference in a residential installation. This equipment generates, uses and can radiate radio frequency energy and, if not installed and used in accordance with the instructions, may cause harmful interference to radio communications. However, there is no guarantee that interference will not occur in a particular installation. If this equipment does cause harmful interference to radio or television reception, which can be determined by turning the equipment off and on, the user Is encouraged to try to correct the interference by one of the following measures:

Reorient or relocate the receiving antenna. Increase the separation between the equipment and receiver. Connect the equipment into an outlet on a circuit different from that to which the receiver is connected. Consult the dealer or an experienced radio/TV technician for help. This device complies with Part 15 of the FCC Rules. Operation is subject to the following two conditions: (1) This device may not cause harmful interference, and (2) this device must accept any interference received,

or modifications not expressly approved by the party responsible for compliance could void the user's authority to operate the equipment.

This device complies with Industry Canada Licenceexempt RSS standard(s). Operation is subject to the following two conditions: (1) this device may not cause interference, and (2) this device must accept any interference, including interference that may cause undesired operation of the device.

Le present appareil est conforme aux CNR d'industrie Canada applicables aux appareils radio exempts de licence. L'exploitation est autorisee aux deux conditions suivantes: (1) l'appareil ne doit pas produire de brouillage, et (2) l'utilisateur de l'appareil doit accepter tout brouillage radioelectrique subi, même si Le brouillage est susceptible d'en compromettre le fonctionnement.

## 聲明文

第十二條 經型式認證合格之低功率射頻電機，非經許可

公司、商號或使用者均不得擅自變更頻率、加大功率或變更原設計之特性及功能。

第十四條 低功率射頻電機之使用不得影響飛航安全及干擾合法通信；

經發現有干擾現象時，應立即停用，並改善至無干擾時方得繼續使用。

前項合法通信，指依電信法規定作業之無線電通信。

低功率射頻電機須忍受合法通信或工業、科學及醫療用電波輻射性電機設備之干擾。

產品名稱：無線行動電源藍芽自拍器

產品規格：輸入5V~2.1A內部電芯容量: 3.7V, 3000mAh

行動電源使用注意事項：

1. 不得拆解、開啟或撕裂行動電源。
2. 不得使用行動電源於曝露於熱或火源，避免放在陽光直射處。
3. 當不使用時，勿使行動電源長時間處於充電狀態。
4. 行動電源務必依照使用手冊說明方式，以正確之程序進行充電。
5. 棄置時應妥善處理。

環境操作溫度：0°C~45°C

AFitGrip

M/N: SR01

Made in China



Complies with  
IMDA Standards  
DBXXXX

