

# 快速安装指南

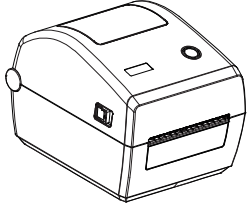

iD888

**警告：**  
在居住环境中，运行此设备可能会造成无线电干扰。

## 开箱清单

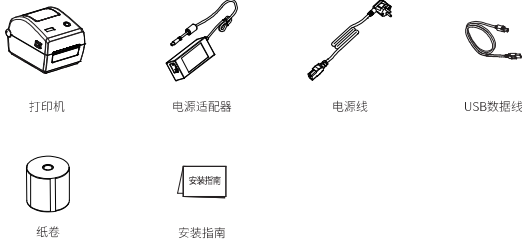

**注意：**箱内实际内容以出货清单为准。

## 外观及组件

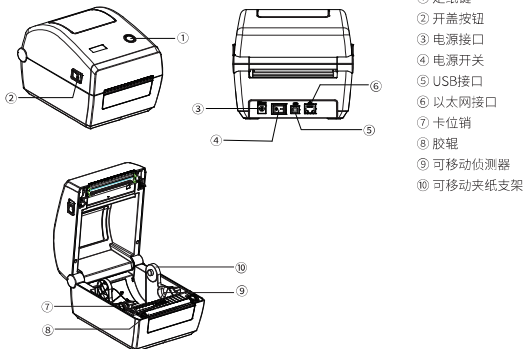

**注意：**接口因客户选择而异，上图所示接口仅供参考。

## 连接电源

1. 确认打印机电源开关处于关闭状态；
2. 将电源适配器连接到打印机；
3. 将电源线连接到电源适配器；
4. 将电源线另一端连接到插座。

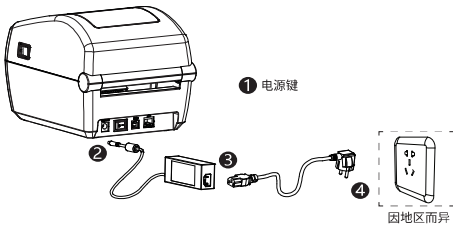

因地区而异

## 安装纸卷

1. 扣动开盖按钮，向上掀起顶盖。
2. 根据纸卷宽度适当拉开夹纸支架，将纸卷芯对准支架凸起圆轴，放入纸卷。

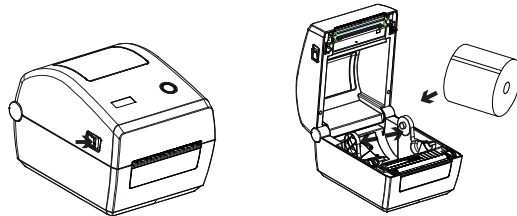

3. 确认纸卷紧紧贴着夹纸支架，按下卡位锁。
4. 按下顶盖，听到顶盖咔一声，确认锁闭。

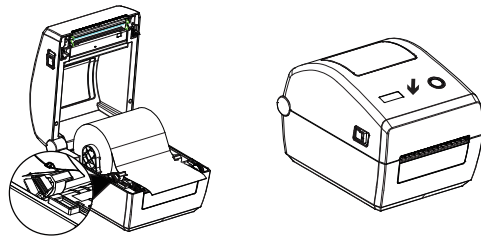

**注意：**驱动、配置工具等相关软件安装详见用户手册。

## 产品保修卡

尊敬的用户：  
为了保障您的权益以及为您提供更优质的售后服务，请您在购买产品时仔细阅读并保留此卡，进行保修服务时请与购买发票一同出示！

用户名称： \_\_\_\_\_  
联系地址： \_\_\_\_\_ 省 \_\_\_\_\_ 市 \_\_\_\_\_ 区(县)  
联系电话： \_\_\_\_\_  
产品型号(序列号)： \_\_\_\_\_  
经销商名称(盖章)： \_\_\_\_\_  
联系地址： \_\_\_\_\_  
联系电话： \_\_\_\_\_  
购买日期： \_\_\_\_\_ 年 \_\_\_\_\_ 月

## 保修条款

- 一、自出厂之日起，本产品热写头片保修3个月或30KM(以先到为准)，如热写头出现划伤、刮伤、烧痕、腐蚀等不可抗拒因素不在保修范围内，其余部件保修12个月。
- 二、存在以下情况之一者，不属于保修范围之内：
  1. 未经我公司及授权维修人员许可，擅自对产品进行拆卸，或产品序列号标贴被撕去及模糊不清，无法辨认；
  2. 由于固体颗粒刮伤热敏头片，引起的打印白线，则头片不属于保修范围；
  3. 其他人为引起的故障。
- 三、保修期内，维修时所更换的产品零配件归我公司所有；
- 四、用户负责将产品寄送至我公司售后服务部或我公司授权的维修站点进行保修服务；
- 五、厦门汉印股份有限公司拥有本保修条款的最终解释权。

厦门汉印股份有限公司  
电话: 400-766-7666  
地址: 中国福建省厦门市同安区梧槽路96号  
官网: cn.idprt.com  
邮箱: support@idprt.com



关注汉印人文公众号  
获取产品介绍、操作视频等



在线客服  
(保修/售后/技术支持)

## 产品中有毒物质的名称及含量

部件名称	铅 (Pb)	汞 (Hg)	镉 (Cd)	六价铬 (Cr <sup>6+</sup> )	多溴联苯 (PBB)	多溴二苯醚 (PBDE)
塑料件	0	0	0	0	0	0
五金件	0	0	0	0	0	0
电路板	X	0	0	0	0	0
马达	0	0	0	0	0	0
线材	0	0	0	0	0	0
电路板组件	X	0	0	0	0	0
打印头组件	X	0	0	0	0	0

注：本表依据GB 17526 的规定编制。  
0 表示该有害物质在该部件所有均质材料中的含量均在GB/T 26574标准规定的限值以下。  
X 表示该有害物质在该部件某些均质材料中的含量超过GB/T 26574标准规定的限值要求，但符合含有害物质的限制要求。



欧盟所示的电子信息技术产品污染控制标志适用于在中华人民共和国境内销售的电子信息产品。标志中的数字代表环保使用期限的数值。



**警告：**热零部件！触摸该零部件时会烫伤手指，关闭电源等待半小时才能触摸零部件。



**警告：**有尖锐边缘，不要接触。



**警告：**运动零部件，身体部位远离动作路径。



### FCC COMPLIANCE STATEMENT:

This device complies with part 15 of the FCC Rules. Operation is subject to the following two conditions: (1) This device may not cause harmful interference, and (2) this device must accept any interference received, including interference that may cause undesired operation.

Note: This equipment has been tested and found to comply with the limits for a Class B digital device, pursuant to Part 15 of the FCC Rules. These limits are designed to provide reasonable protection against harmful interference in a residential installation. This equipment generates, uses and can radiate radio frequency energy and, if not installed and used in accordance with the instructions, may cause harmful interference to radio communications.

However, there is no guarantee that interference will not occur in a particular installation. If this equipment does cause harmful interference to radio or television reception, which can be determined by turning the equipment off and on, the user is encouraged to try to correct the interference by one or more of the following measures: Reorient or relocate the receiving antenna. Increase the separation between the equipment and receiver.

Connect the equipment into an outlet on a circuit different from that to which the receiver is connected. Consult the dealer or an experienced radio/TV technician for help.

Warning: Changes or modifications to this unit not expressly approved by the part responsible for compliance could void the user's authority to operate the equipment.

### FCC Radiation Exposure Statement

This equipment complied with FCC radiation exposure limits set forth for an uncontrolled environment. This equipment should be installed and operated with minimum distance 20cm between the radiator & your body.

# Quick Start Guide

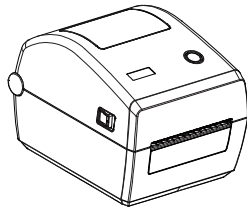

iD888

Manufacturer: Xiamen Hanin Co., Ltd.

Address: No.96, Rongyuan Road, Tong'an District, Xiamen, Fujian, China 361100

E-mail: support@idprt.com

Web: www.idprt.com

## Packing List



Printer



Power Adapter



Power Cord



USB Cable



Paper Roll



Quick Start Guide

⚠ Note: The packing items are based on the order.

## Appearance and Components

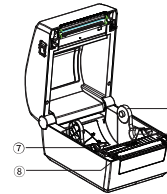
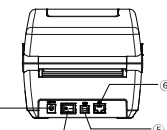
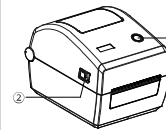

- ① Feed Button
- ② Cover Opening Button
- ③ Power Receptacle
- ④ Power Switch
- ⑤ USB Interface
- ⑥ Ethernet Interface
- ⑦ Locking Tab
- ⑧ Platen
- ⑨ Movable Sensor
- ⑩ Movable Roll Holders

⚠ Do not touch the sharp edges.

⚠ Note: The interface shown in the figure above is for reference only.

-1-

-2-

## Power Supply

1. Make sure the printer is turned off.
2. Connect the power adapter to the printer.
3. Connect the power adapter to the power cord.
4. Plug the other side of the power cord into the socket outlet.

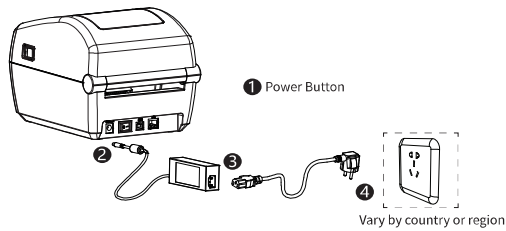

## Paper Loading

1. Press the cover opening button and lift the cover.
2. Pull the roll holders open and place the roll between them.

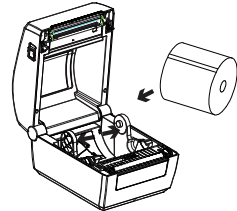
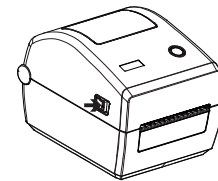

3. Confirm that the paper roll is tightly attached to the roll holders, and press down the locking tab.
4. Press down the cover until it snaps closed.

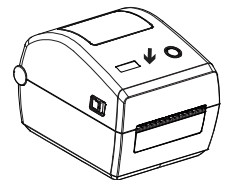
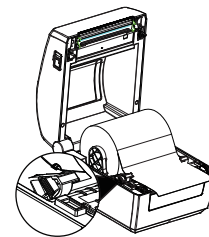

⚠ Note: Please refer to windows driver installation in the user manual.

-3-

-4-