

Product Introduction

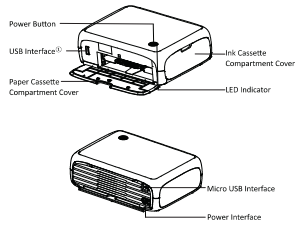

Accessory List



Note: ① Only for cameras that support PictBridge connection.
② Purchase a Color Ink / Paper Set separately.

01

Power On and Connection

- 1 Connect the power cord

Insert the power cord into the power interface on the back of the printer.

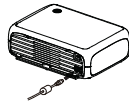

- 2 Power on

Hold down the power button to turn on the printer. The yellow LED indicator is lighting, which indicates the printer is waiting for connection.



- 3 Download App

Scan the QR code below to download the App "C-Printer", and choose the model "CP4000L".



02

Loading the Ink Cassette

- 1 Open the ink cassette compartment cover



- 2 Insert the new ink cassette and make it click into place

Load the ink cassette into the printer in the direction of the arrow marked on the cassette until it clicks into place.



- 3 Close the ink cassette compartment cover



03

Loading the Photo Paper

- 1 Open the covers of paper cassette

First open the outer cover ①, then the inner cover ②.

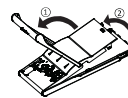

- 2 Load the photo paper with glossy side face up

Note: Placing more than 18 sheets of paper may damage the printer or cause malfunction. Do not touch the glossy side, except for the non-printable area.

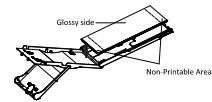

- 3 Close the inner cover of paper cassette

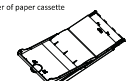

04

Loading the Paper Cassette

- 1 Open the paper cassette compartment cover



- 2 Make sure the outer cover of paper cassette is open

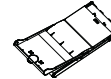

- 3 Load the paper cassette to the printer

Please make sure to fully insert the paper cassette into the compartment. (It slides about 2cm into the compartment.)

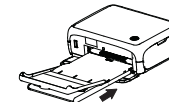

05

Replacing the Ink Cassette

- 1 Open the ink cassette compartment cover



- 2 To remove the used ink cassette, move the lock upward that it will be ejected automatically

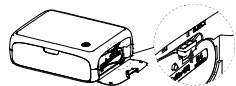

- 3 Load the new ink cassette and make it click into place, then close the ink cassette compartment cover



06

Instructions for Button Operation

- Turn on the printer: hold down the power button for 3 seconds, the yellow LED indicator is lighting;
- Turn off the printer: hold down the power button for 3 seconds and then release it, the LED indicator will be off;
- Reset AP mode: in power-on status, hold down the power button until the blue LED indicator flashes three times, release the button and reset the Wi-Fi configuration; after resetting, the LED indicator will turn white

Instruction for LED Indicator

LED Indicator	Status
Yellow, lighting	The system is starting
White, lighting	The printer is ready (Wi-Fi is in AP mode)
Green, lighting	The printer is ready (Wi-Fi is in STA mode)
White, slow flash	Printing
Red, lighting	Ink cassette has run out Ink cassette is abnormal Photo paper has run out
Red, quick flash	Paper jam or ink cassette is jammed
Red, slow flash	TPH is over temperature
Yellow, slow flash	Firmware is updating

Working Position

- Please place the printer on the desk or other flat and stable surfaces;
- Leave some space (at least 30cm) behind the printer for paper out when printing.

Printing Wirelessly from Smartphones (AP Mode)

- 1 Please make sure that the LED indicator of the printer shows white all the time, or else hold down the power button to switch to AP mode;
- 2 Open the App, click "Album", select the images to print and then click "Next";
- 3 Adjust the images in print preview and click the printer icon on the top right corner;
- 4 Select "Connect via printer hotspot"; wait for the Bluetooth searching until it shows "PRT:XXXX" and click to connect; XXXX is last four digits of Bluetooth MAC address showed on the bottom of the printer)
- 5 After connecting, the printer will start to print the photo.

Printing Wirelessly from Smartphones (STA Mode)

- 1 Make sure the smartphone has been connected to the Wi-Fi hotspot;
- 2 Open the App, click "Album", select the images to print and then click "Next";
- 3 Adjust the images in print preview and click the printer icon on the top right corner;
- 4 Select "Connect hotspot"; wait for the Bluetooth searching until it shows "PRT:XXXX" and click to connect; XXXX is last four digits of Bluetooth MAC address showed on the bottom of the printer)
- 5 Enter the passwords of Wi-Fi hotspot, click "Configure WIF" and the green LED indicator will flash slowly; (The time consuming of Wi-Fi configuration is related to the actual Wi-Fi network, please wait patiently)
- 6 After connecting, the green LED indicator is lighting, and the printer will start to print the photo.

Note: The above instructions take photo album printing for example, for IOMD, AR Photo and Credentials printing, please experience on your own according to the guide of App.

Printing via USB from a Computer

- 1 Connect one end of the USB cable to your computer and the other end to the Micro USB port on the back of the printer;
- 2 Turn on the printer;
- 3 Download the printer driver from HPRT website and install it on your computer;
- 4 After connecting, you can print the photos from the computer.

Precautions

- The best operating temperature is 0°C-40°C, if the environmental temperature is too high, the print quality may be affected.
- Please do not use the unofficial adaptor, color ink and photo paper to ensure the print quality.
- Do not touch the film of color ink and the glossy side of photo paper in case of fingerprints that may affect the print quality.
- During printing, the area around the thermal print head is very hot. Do not touch it, as you could be burned.
- Do not pull out the photo paper by force during printing, or else it may damage the printer.
- Please remove the paper cassette when it is not used for a long time, and close the covers of the printer and the paper cassette to avoid dust entering.

ISED RSS Warning/ISED RF Exposure Statement

This device complies with Innovation, Science and Economic Development Canada licence-exempt RSS standard(s). Operation is subject to the following two conditions: (1) this device may not cause interference, and (2) this device must accept any interference, including interference that may cause undesired operation of the device.

Le présent appareil est conforme aux CNR d'ISED applicables aux appareils radio exempts de licence. L'exploitation est autorisée aux deux conditions suivantes:
(1) l'appareil ne doit pas produire de brouillage, et
(2) l'utilisateur de l'appareil doit accepter tout brouillage radioélectrique subi, même si le brouillage est susceptible d'en compromettre le fonctionnement.

ISED RF exposure statement:

This equipment complies with ISED radiation exposure limits set forth for an uncontrolled environment. This equipment should be installed and operated with minimum distance 20cm between the radiator& your body. This transmitter must not be co-located or operating in conjunction with any other antenna or transmitter.

Le rayonnement de la classe B respecte ISED fixaient un environnement non contrôlé. L'installation et mise en ŷuvre de ce matériel devrait avec échangeur distance minimale entre 20 cm (ou) votre corps. L'émission ou ne peuvent pas coexister cette antenne ou capteurs avec d'autres.

FCC Statement:

Any Changes or modifications not expressly approved by the party responsible for compliance could void the user's authority to operate the equipment.
This device complies with part 15 of the FCC Rules. Operation is subject to the following two conditions:

- (1) This device may not cause harmful interference, and
- (2) This device must accept any interference received, including interference that may cause undesired operation.

FCC Radiation Exposure Statement:

This equipment complies with FCC radiation exposure limits set forth for an uncontrolled environment. This equipment should be installed and operated with minimum distance 20cm between the radiator& your body.

Note: This equipment has been tested and found to comply with the limits for a Class B digital device, pursuant to part 15 of the FCC Rules. These limits are designed to provide reasonable protection against harmful interference in a residential installation. This equipment generates, uses and can radiate radio frequency energy and, if not installed and used in accordance with the instructions, may cause harmful interference to radio communications. However, there is no guarantee that interference will not occur in a particular installation. If this equipment does cause harmful interference to radio or television reception, which can be determined by turning the equipment off and on, the user is encouraged to try to correct the interference by one or more of the following measures:
—Reorient or relocate the receiving antenna.
—Increase the separation between the equipment and receiver.
—Connect the equipment into an outlet on a circuit different from that to which the receiver is connected.
—Consult the dealer or an experienced radio/TV technician for help.

HPRT Photo Printer Quick Start Guide

CP4000L

Please read the guide carefully before using the product and keep it properly

HPRT Photo Printer

Product Name: Photo Printer	Dimension: 183x126x95mm
Product Model: CP4000L	Weight: About 1.0kg
Input: 24V 2A	Operating Temperature: 0°C-40°C
Executive Standard: GB4943.1-2011, GB/T9254-2008, GB 17625.1-2012	
Wi-Fi Connection: Wi-Fi IEEE 802.11b/g/n 2.4GHz	
Manufacturer: Xiamen Hanin Electronic Technology Co.,Ltd.	
Addr: 8# 8# A# Aide Airport Industrial Park, Huli District, Xiamen, China	
Tel: +86-0592-5885991	
Web: www.hpirt.com	
Product Homepage: cp.hpirt.com	