

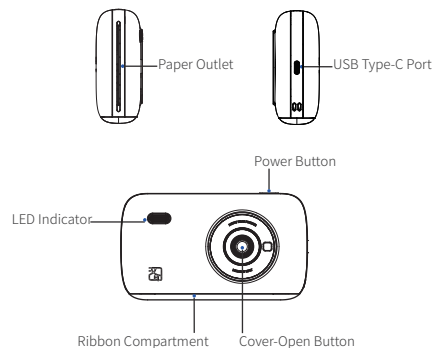

HCP-2TS22H

Portable Photo Printer

Note: The items in the package are actually based on the order.



Packing List



USB Type-C Cable



Quick Start Guide

⚠ If the paper jam or ribbon error cannot be removed, please contact after-sales service, please do not violently disassemble.

LED Indicator Status

- Red LED**
 - ON: Paper jam/Out of Paper/Cover Opened/Ribbon Error
 - Slow Flash: Low Power
 - Quick Flash: High Temperature
- Blue LED**
 - ON: Standby/Printing/Charging Finished
 - Slow Flash: Charging
 - Quick Flash: Starting
- Red Blue LED** --- Alternately Flashing: Firmware Updating

Product Parameters

Name	Portable Photo Printer
Module	HCP-2TS22H
Dimensions	146*83*34mm
Net Weight	280g
Print Method	Thermal Dye Sublimation
Print Width	53*86mm
Resolution	300dpi
Battery Capacity	800mAh
Power Input	5V / 2A, type-C Port
Operation Temperature	5°C-40°C

⚠ Please check Bluetooth connection status of device through the APP.

Paper Loading

Steps & Notes

01

Open the ribbon compartment by pressing the Cover-Open button.

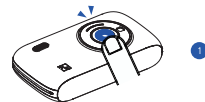

02

Take out a ribbon cartridge, place it in the ribbon compartment in the direction shown, and press the "Push" position until it is clicked into place.

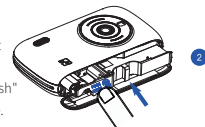

03

Close the ribbon compartment.

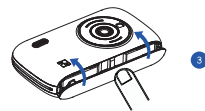

- ⚠** 1. The printing paper is easily exposed to moisture, so please use the ribbon cartridge as soon as possible after opening.
- 2. This device only supports dedicated photo paper printing, the ribbon cartridge has built-in photo paper, please do not replace it by yourself.
- 3. Avoid excessive direct sunlight and low temperature.
- 4. If the ribbon cartridge is damaged or deformed by external force, please do not force it into the device.

How to Print

Steps & Notes

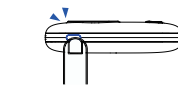

- 1 Hold down the power button for 3 seconds until the blue LED is flashing, the printer will be turned on.

Turn on the Bluetooth on your mobile phone, then select "HCP-2TS22H_XXXXXX" in the Bluetooth list to connect.

Remark: "XXXXXX" indicates last six digits of Bluetooth address.



- 3 Open the photo printer APP, choose "HCP-2TS22H", select the photos and enter the print preview.

Click the print icon that it will show the device list, click the same model ("HCP-2TS22H_XXXXXX") and confirm printing. Then the printer will conduct printing.



- ⚠** 1. When using it for the second time, just click the print icon that the printer will be connected automatically and send data to print.
2. Please do not exit the app during the printing process or it may lead to print failure.



APP Download

Scan the QR code to download APP.

Manufacturer: Xiamen Hanin Electronic Technology Co., Ltd.

Address: Room 305A, Angye Building, Pioneering Park, Torch High-tech, Zone, Xiamen, China

E-mail: support@hpert.com

Web: www.hpert.com



Precautions for Printing

1. The best working temperature of the printer is 5°C~40°C, if the ambient temperature is too high, it may affect the print quality.
2. Do not use unofficial ribbon cartridges and photo paper to ensure print quality.
3. Avoid disassembling the ribbon cartridge and photo paper by yourself, if the glossy surface of the photo paper is contaminated, the print quality will be affected.
4. Do not pull out the ribbon cartridge forcefully during the printing process to avoid damage to the printer.
5. When the printer is not in use for a long time, close the door of the printer compartment to prevent dust from entering.
6. After printing sheets continuously, the printer may have overheat protection for the print head, and the printing will be suspended forcibly, which is a normal phenomenon. It can be printed again after cooling the print head.

Operating Position

1. Please place the printer on a table or other flat, stable surface for use.
2. Please make sure to leave more than 10cm of space at the paper outlet of the printer.

Battery Charging

1. When the battery power is low, the LED indicator will turn red and flash slowly. Please charge it by the supplied USB cable in time. If you continue printing, it may power off automatically.
2. To charge, insert one end of the USB cable into the printer and the other end to the AC adapter. When connected, the LED indicator will turn blue and flash slowly to indicate charging.
3. It takes about 60 to 90 minutes for fully charge. After that, the blue LED indicator will be lighting all the way.

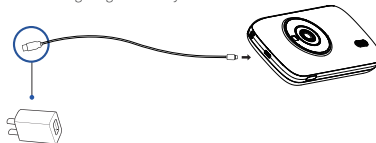

Charge via AC Adapter

- ⚠** 1. The printer can be charged via computer USB port or AC adapter. Please note that the AC adapter is not supplied. Consumers who use the power adapter for power supply should purchase and use the power adapter that has obtained CCC certification and meets the requirements of the standard.
2. Customers are forbidden to disassemble the machine and there is a risk of explosion if the wrong type of battery is used for replacement. Please make sure to dispose of the used battery according to the instructions.

Warning: Operation of this device in a residential environment may cause radio interference.

FCC WARNING

This device complies with part 15 of the FCC Rules. Operation is subject to the following two conditions: (1) this device may not cause harmful interference, and (2) this device must accept any interference received, including interference that may cause undesired operation.

Any changes or modifications not expressly approved by the party responsible for compliance could void the user's authority to operate the equipment.

NOTE: This equipment has been tested and found to comply with the limits for a Class B digital device, pursuant to Part 15 of the FCC Rules. These limits are designed to provide reasonable protection against harmful interference in a residential installation. This equipment generates, uses and can radiate radio frequency energy and, if not installed and used in accordance with the instructions, may cause harmful interference to radio communications.

However, there is no guarantee that interference will not occur in a particular installation. If this equipment does cause harmful interference to radio or television reception, which can be determined by turning the equipment off and on, the user is encouraged to try to correct the interference by one or more of the following measures:

- Reorient or relocate the receiving antenna.
- Increase the separation between the equipment and receiver.
- Connect the equipment into an outlet on a circuit different from that to which the receiver is connected.
- Consult the dealer or an experienced radio/TV technician for help.

The device has been evaluated to meet general RF exposure requirement. The device can be used in portable exposure condition without restriction.