

## Packing List



S1



Quick Start Guide

**Note:** The packing items are actually based on the order.

## Using Guide

### **Power Button Status** Hold down for 2 seconds to ON/OFF

- Lighting: Standby / Charging completed
- Slow flash: Charging
- Fast flash: Supplies near end, cover open, Firmware updating, low battery, the print head is overheated

### **Charging** Use it for the first time after purchase

- Recommended to use after full charge
- Charge via DC adapter or computer USB port

## LED Indicator Definitions

### In use

- Normal: always on
- Exception: flashes slowly, view tips in the APP.

### Charging process

- Charge normally: flashes slowly
- Full of anomalies: flashes quickly
- Battery charged: always on

## Appearance and Components

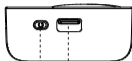

① ②

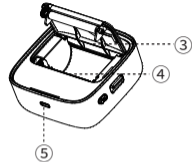

- ① Power Button
- ② Cover Opening Button
- ③ Upper Cover
- ④ Paper Tearing Knife
- ⑤ USB Interface



**Warning:** The paper tearing knife has sharp edges and should not be touched.

## Download APP

Scan the QR code below and install the App.



## Connect the device

Download Hereprint - APP, turn on Bluetooth on your phone, enter the APP, click Add Device, and connect by searching Bluetooth.

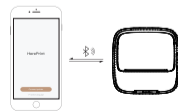

## APP Setting



### Simple Operation APP Setting

- You can view information such as remaining power, firmware version in device management.

## Replace Supplies

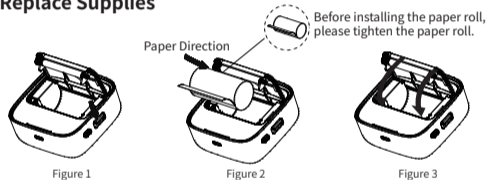

- With reference to figure 1, Pull the cover opening button down and open the top cover.
- When replacing supplies, place the supplies in reference to the direction shown in figure 2.
- Close the top cover after loading paper. Please make sure both sides click into place.

**When changing supplies , do not touch the print head in case of injury caused by overheating.**

## Safety Precautions



### Battery Overheating Battery Management and Precautions

- When charging is completed, please unplug the USB cable.
- To avoid fire, do not charge at high temperature (e.g. sweating rooms, bonfire nearby, etc.).



### Charger Attention Print Head Management and Precautions

- There may be damage to the print head due to improper charging.
- We recommend not to use printer in high humidity or dusty areas.



### Burn Hazard Print Head Overheating

- After printing, do not touch the print head directly in case of injury caused by overheating.



### Charging Port Damage Charging Precautions

- Please gently insert or unplug the USB cable to prevent excessive damage to the charging port.

## FCC

This device complies with part 15 of the FCC Rules. Operation is subject to the following two conditions: (1) this device may not cause harmful interference, and (2) this device must accept any interference received, including interference that may cause undesired operation.

Warning: Any changes or modifications not expressly approved by the party responsible for compliance could void the user's authority to operate the equipment.

NOTE: This equipment has been tested and found to comply with the limits for a Class B digital device, pursuant to Part 15 of the FCC Rules. These limits are designed to provide reasonable protection against harmful interference in a residential installation. This equipment generates, uses and can radiate radio frequency energy and, if not installed and used in accordance with the instructions, may cause harmful interference to radio communications. However, there is no guarantee that interference will not occur in a particular installation. If this equipment does cause harmful interference to radio or television reception, which can be determined by turning the equipment off and on, the user is encouraged to try to correct the interference by one or more of the following measures:

- Reorient or relocate the receiving antenna.
- Increase the separation between the equipment and receiver.
- Connect the equipment into an outlet on a circuit different from that to which the receiver is connected.
- Consult the dealer or an experienced radio/TV technician for help.

To maintain compliance with FCC's RF Exposure guidelines, This equipment should be installed and operated with minimum distance between 20cm the radiator your body: Use only the supplied antenna.

#### FCC Radiation Exposure Statement

The device has been evaluated to meet general RF exposure requirement.  
The device can be used in portable exposure condition without restriction.

FCC ID: 2AUTE-2DT24J



# Quick Start Guide

S1

