

# VIDEO DOORBELL

---

**100%**  
WIRE-FREE

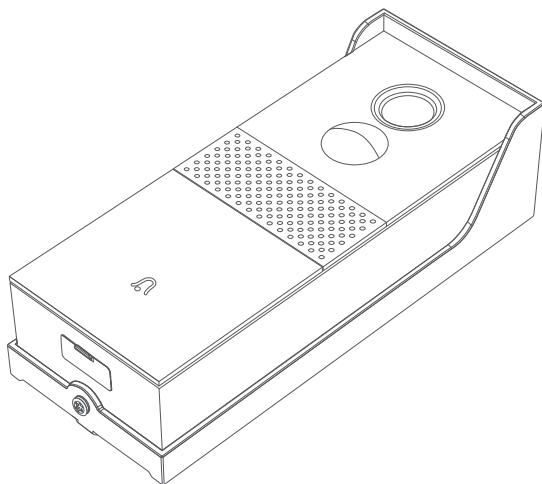

## QUICK START GUIDE

\* Thanks for purchasing and using our product. Please read this quick start guide before using, and keep it for future reference.

\* Manual contents are subject to change without notice in accordance with our policy of continuous product improvement.

# 1. WHAT'S IN THE BOX

Please consult below checklist for all the components.

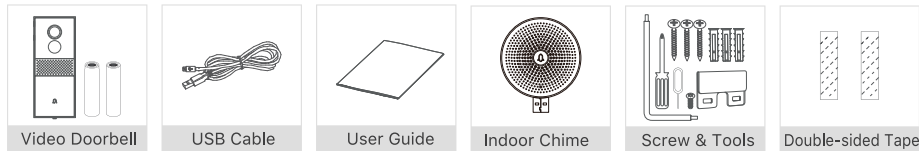

## 2. MEET THE DOORBELL

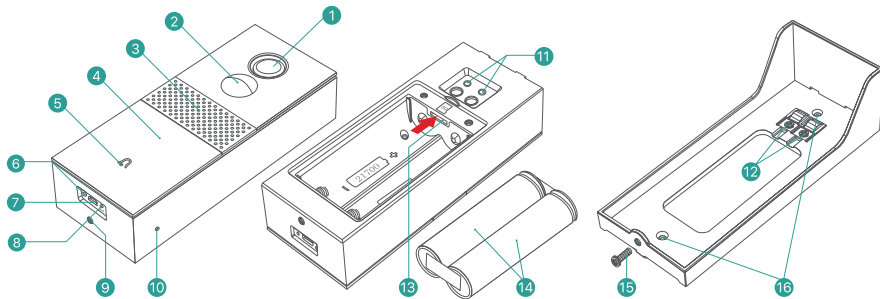

- |                     |                      |                          |                         |
|---------------------|----------------------|--------------------------|-------------------------|
| 1 2MP camera        | 5 LED indicator      | 9 Security screw hole    | 13 Micro-SD card slot   |
| 2 PIR motion sensor | 6 Charging indicator | 10 Microphone            | 14 21700 Battery × 2    |
| 3 Speakers          | 7 Micro-USB port     | 11 AC electric contact   | 15 Security screw       |
| 4 Doorbell button   | 8 Reset hole         | 12 AC hardware terminals | 16 Mounting screw holes |

## 3. MEET THE CHIME

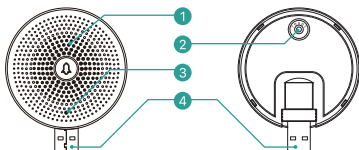

- |            |                       |
|------------|-----------------------|
| 1 Speakers | 3 LED Indicator       |
| 2 Reset    | 4 USB Port (Type-A/M) |

## 4. BATTERY INSTALLATION

The batteries are pre-installed in the doorbell, with an isolating film inserted in the positive poles. **Please peel off the isolating film before battery installation.** Please insert the batteries with positive poles upward!

**NOTE:**

Improper battery installation will cause damage to the internal components and may result in serious injury.

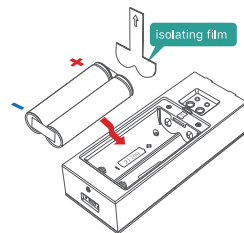

## 5. BATTERY CHARGING

The batteries inside the doorbell are not fully charged in accordance with transportation safety regulations.

Please charge the batteries with a USB compatible wall charger (not included) and the provided USB cable for about 8~10 hours prior to installation.

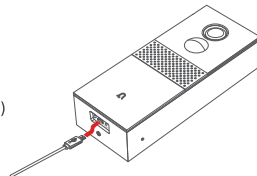

## 6. DOWNLOAD THE APP

Download and install the 'CloudEdge' App from Google Play™ or the App Store™. The App is also available by scanning the QR codes on the right, using your QR code scanner on your smart phone.

**NOTE:**

Google Play™ is a trademark of Google Inc. App Store™ is a service mark of Apple Inc.



iOS



Android

## 7. WI-FI SET UP

Before you start the Wi-Fi configuration, please note below:

- 1). The doorbell works with 2.4 GHz Wi-Fi, but not with 5 GHz Wi-Fi.
- 2). Avoid using special characters or symbols like )(!@~!#\$%^&\*..., either in your Wi-Fi name or in the password.
- 3). Perform the configuration near your Wi-Fi router.

Launch the 'CloudEdge' App and register an account with your mobile phone number or email ID. And start the Wi-Fi configuration, following the in-App instructions, or referring to the following guiding steps:

## GUIDING STEPS:

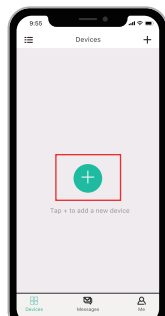

1. Tap "+" to add device

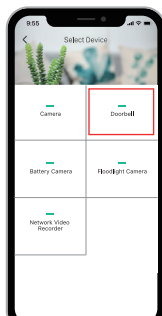

2. Select Doorbell

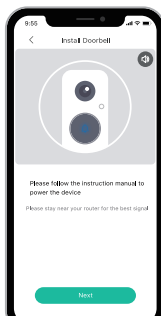

3. check power status

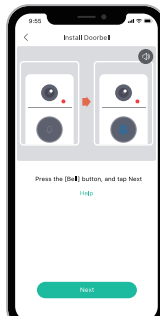

4. Activate the doorbell

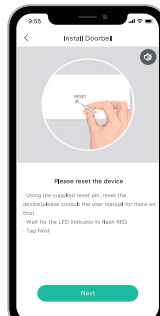

5. Reset device



6. Input Wi-Fi password



7. Prepare Code Scanning



8. Generate QR Code

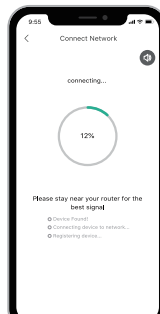

9. Wait for connection

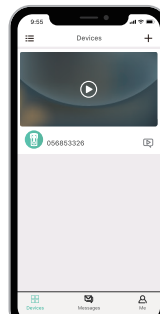

10. Adding device complete

## 8. RUN A TEST

After setup, tap on the live view window in the App for a test. Then take your doorbell outside to the installation spot and run a test there. Make sure the installation spot is covered by strong 2.4 GHz Wi-Fi signal.

### NOTE:

If the video quality from the doorbell outside is not as good as it was indoors, you may need to move your router closer to your installation spot, or invest in a Wi-Fi extender.

## 9. LIVE VIEW

1 Quit live viewing	2 Setting menu	3 Battery status
4 Volume on/off	5 HD/SD switch	6 Wi-Fi signal status
7 Stream bit rate	8 Wi-Fi signal status	9 Screenshot button
10 Speak to the scene	11 Record on the phone	12 Body detection on/off
13 Notification history	14 Cloud storage service	

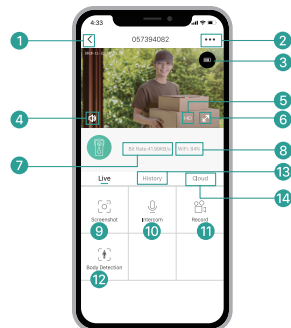

Live view interface

## 10. PLAYBACK

If the Micro-SD card is properly installed, you can playback the video clips taken after detected motions or visitor calls. Video clips can also be recorded to the cloud, if you have activated the cloud storage service (Charge after a 7-Days-Free trial).

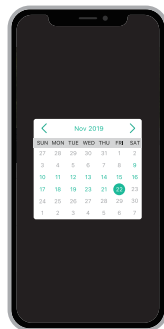

Search video clips by date

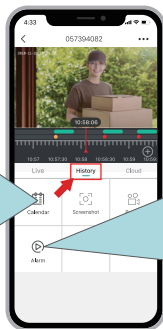

Playback interface

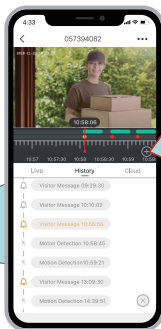

Search video clips by events



Timeline zoom in/ zoom out

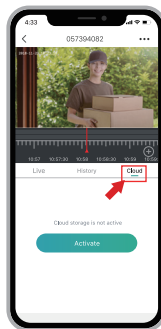

Cloud storage interface

## 11. LEAVE VOICE MESSAGES

Maximum 3 voice messages (Max. 10 seconds each) can be pre-recorded into the doorbell, which enables you to quickly respond to your visitors when you are not convenient to answer the doorbell call.

**STEPS:** Settings --> Basic function --> Host Leaves Message --> Press and hold this icon  to record voice messages  
--> Play the selected voice message in reply to doorbell call

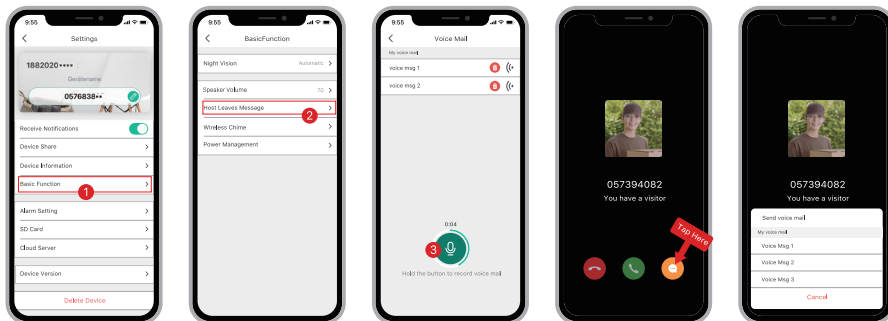

## 12. DEVICE SHARE

### ➤ SHARING BY ACCOUNT SEARCHING

**STEPS:** Settings --> Device Share --> Tap on "Add" --> Tap on "Account" --> Type in account ID --> Confirm Sharing.

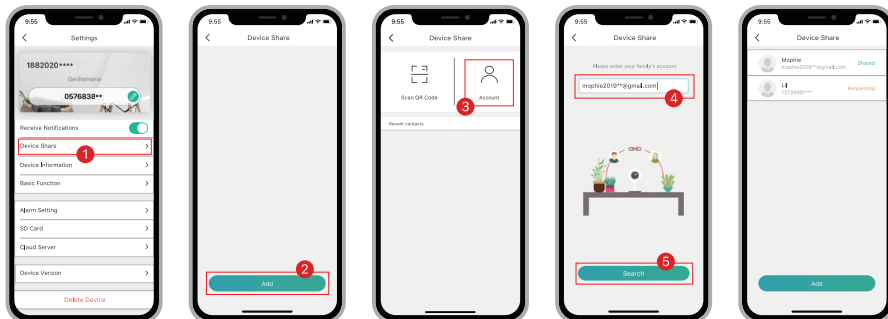

## ➤ SHARE BY QR CODE SCANNING

The new users can find out their QR codes in the App, and let the administrator scan the QR Code and share device.

**FIND YOUR QR CODE:** Run **CloudEdge** App --> Tap on  " --> Tap on  " --> Tap on " **My QR Code** " --> Let the administrator scan your QR Code

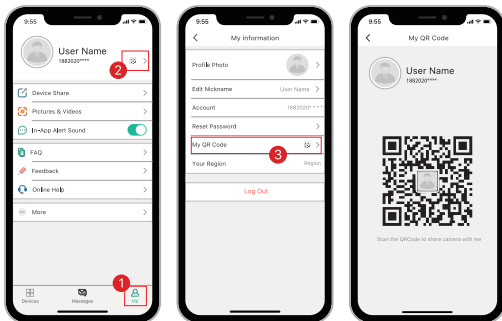

### NOTE:

1. Guide your family members to download and install the CloudEdge App, and register an account before device-sharing.
2. There is no limitation on numbers of users sharing one device.
3. Only the administrator got access to the setting menu. Other users can only live view & playback.
4. All users can receive doorbell calls and alarm notifications.
5. Many users can access to the doorbell simultaneously, to live view or playback.

## 13. CONNECT THE CHIME

### ➤ SUPPLY POWER TO THE CHIME

The chime can be powered by an USB compatible phone charger (DC5V 1.2A). You can also plug the chime to the USB port on your PC/notebook to supply power.

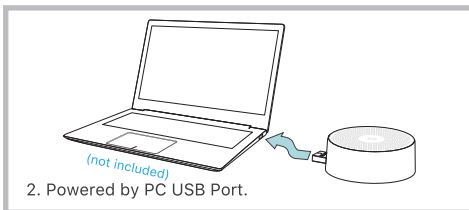
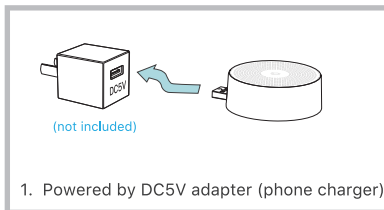

## ➤ PAIR WITH DOORBELL

1). Tap on "... " and enter into [Settings-> Basic function](#), select [Wireless Chime](#) page.(refer to [Picture.4](#))

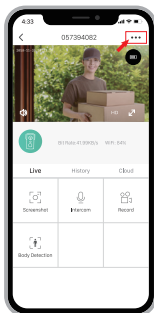

Picture.1

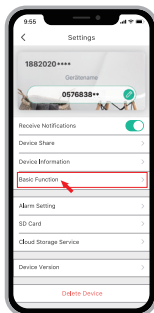

Picture.2

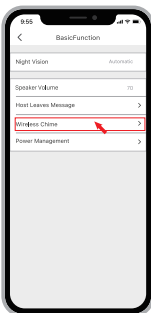

Picture.3



Picture.4

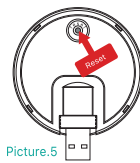

Picture.5

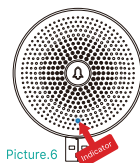

Picture.6

2). A short click on the reset button behind the chime(refer to [Picture.5](#)), and the LED indicator will flash blue, indicating the device is in pairing mode.

3). Tap " [Chime Pairing](#) " button in the APP (refer to [Picture.4](#)), and the doorbell will send a wireless pairing signal to the chime. Pairing succeeds and the indicator on the Chime will be in **solid blue**. All set! Congratulations! You can push the doorbell button to test the result.

## ➤ SELECT RINGTONE

Enter into Settings->[Wireless Chime](#), there are 4 ringtones available (refer to [Picture.4](#)).

## ➤ VOLUME CONTROL

Drag the [Ring Volume](#) bar to control the volume level for the chime (refer to [Picture.4](#)).

## ➤ UNBIND

1. Press and hold reset button on the chime for about 5 seconds till the indicator flashes blue twice, and the chime will be restored to factory default.

2. You can also tap on " [One-button unbind](#) " (refer to [Picture.4](#)) in the App to release the connection between the doorbells and the wireless chimes.



## 14. INSTALLATION

### ▶ SELECT LOCATION

Your doorbell has 166-degree view angle and 120-degree human detection range.

It is suggested to mount your doorbell at least 5 feet (160 cm) above the ground for the best angle of view and motion detection performance.

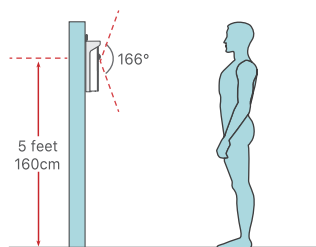

### ▶ HARDWIRE YOUR DOORBELL (OPTIONAL)

If replacing an existing doorbell, please shut off the power breaker in advance, and remove it from the wall and disconnect the wires. Our doorbell works with both 12V - 24V AC and 12V DC power source.

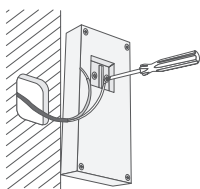

1. Shut off power at the breaker, remove the old doorbell from the wall and disconnect the wires.

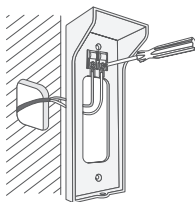

2. Connect the wires to the screw terminals on your mounting bracket. Either wire can be connected to either terminal.

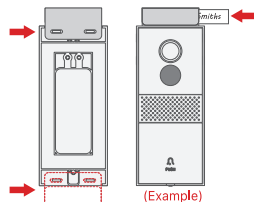

3. (Optional) The nameplate holder can be mounted on the top rear/ bottom rear of the bracket, prior to bracket installation.

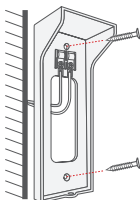

4. Drive the screws into the anchors, or directly into your wall until the bracket is tightly fastened on your wall.

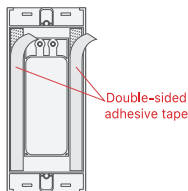

5. (Optional) You can also use the provided double-sided tape instead of screws.

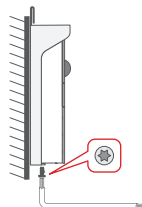

6. Mount the doorbell to the bracket, and secure it with the provided star-shape security screw and screw driver. All set!

## ➤ GO WIRELESS INSTALLATION

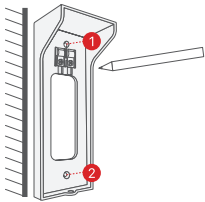
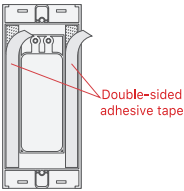
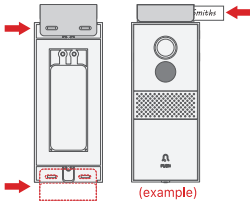
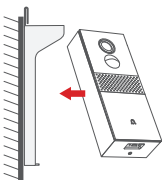
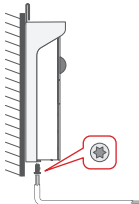
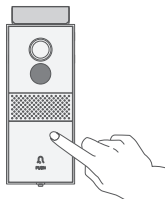
 <p>1. Locate the installation spot, and mark the screw positions to mount your bracket on your wall.</p>	 <p>2. (Optional) You can also use the provided double-sided tape instead of screws.</p>	 <p>3. (Optional) The nameplate holder can be mounted on the top rear/ bottom rear of the bracket, prior to bracket installation.</p>
 <p>4. Mount your doorbell to the fixed bracket. Make sure it reaches the bottom where you can hear a click.</p>	 <p>5. Secure your doorbell with the provided star-shape security screw and screw driver.</p>	 <p>6. All set, congratulations! Now you can press the doorbell button to try it out.</p>

### NOTE:

1. When hardwire your doorbell, please operate under the guide of the professionals.
2. The doorbell works with 12V - 24V AC and 12V DC power source. And either cable can connect to either terminals. The connecting order doesn't matter.
3. If your doorbell is powered solely on batteries, you may need to charge your doorbell once in a while. Lab-tested battery life: 12 month standby, 6 month regular using(activate 20 time per day). The actual battery life may be different due to different activation frequency.

## 14. SPECIFICATION

### ► VIDEO DOORBELL

Video & Audio	
Image Sensor	1/2.7" CMOS (2.0MP)
OS	Hisilicon Lite-OS
Resolution	1920 × 1080 px
Stream	HD/SD dual stream
Infrared LED	High power IR LED with ICR
Lense	1.7mm/F2.0
Angle of view	166°
Min. Illumin.	Color: 0.01 Lux; B&W: 0.001Lux
WDR	Digital WDR
Audio	2-way audio with noise cancellation
Storage	
Storage Type	Micro SD Card (Max 128G)
Cloud storage	Support
Recording	Triggered by PIR motion sensor
Network	
Wifi Frequency	2.4 GHz ~ 2.4835 GHz
Standards	IEEE 802.11 b/g/n
Live View Speed	Within 3 ~ 4 Sec
Software	
App Name	CloudEdge
OS	iOS, Android
Remote View	Within 2~4 sec
Notification	Push notification within 2~4 sec
General	
Working Temp. & Humidity	-20°C ~ 50°C; <90% (No condensation)
Power Source	21700 Li-ion Battery (3.5-4.2V, Max 4800mAh) × 2/ AC 12V ~ 24V hardwire power / DC 12V hardwire power
Standby Current	300μA
Working Current	250mA
Standby Time	about 12 Months
Working Time	about 6 Months (20 times wake up per day)
Battery Charging	DC5V 1A-2A (Micro USB Port)
Firmware Upgrade	OTA (on the air)
Dimension (mm)	61× 41 × 144
Weight (g)	161 + 138.5(Battery weight)

### ► INDOOR CHIME

General	
Power source	DC 5V 1.2A
Power port	USB (Type-A)
Consumption	0.2W
Ringtones	4 ringtones optional
Volume	Max 100dB
Volume control	Low(mute), middle, high
Place of use	indoor
LED	Flashing blue: pairing mode Solid blue: power on/pairing succeeded Flash blue twice: reset to factory default
Working Temp.	-30°C ~ 70°C
Humidity	< 90%, no condensation
Dimension(mm)	Ø60 × 24
Weight (g)	33

## 15. FCC & IC WARNING

### ➤ FCC Warning

Any Changes or modifications not expressly approved by the party responsible for compliance could void the user's authority to operate the equipment.

This device complies with part 15 of the FCC Rules. Operation is subject to the following two conditions: (1) This device may not cause harmful interference, and (2) this device must accept any interference received, including interference that may cause undesired operation.

Note: This equipment has been tested and found to comply with the limits for a Class B digital device, pursuant to part 15 of the FCC Rules. These limits are designed to provide reasonable protection against harmful interference in a residential installation. This equipment generates, uses and can radiate radio frequency energy and, if not installed and used in accordance with the instructions, may cause harmful interference to radio communications. However, there is no guarantee that interference will not occur in a particular installation. If this equipment does cause harmful interference to radio or television reception, which can be determined by turning the equipment off and on, the user is encouraged to try to correct the interference by one or more of the following measures:

- Reorient or relocate the receiving antenna.
- Increase the separation between the equipment and receiver.
- Connect the equipment into an outlet on a circuit different from that to which the receiver is connected.
- Consult the dealer or an experienced radio/TV technician for help.

This equipment complies with FCC radiation exposure limits set forth for an uncontrolled environment. This equipment should be installed and operated with minimum distance 20cm between the radiator& your body.

### ➤ IC Warning

This device complies with Industry Canada licence-exempt RSS standard(s). Operation is subject to the following two conditions:

- (1) This device may not cause interference, and
- (2) This device must accept any interference, including interference that may cause undesired operation of the device.

Le présent appareil est conforme aux CNR d'Industrie Canada applicables aux appareils radio exempts de licence. L'exploitation est autorisée aux deux conditions suivantes:

- (1) l'appareil ne doit pas produire de brouillage, et
- (2) l'utilisateur de l'appareil doit accepter tout brouillage radioélectrique subi, même si le brouillage est susceptible d'en compromettre le fonctionnement

The device has been evaluated to meet general RF exposure requirement. To maintain compliance with RSS102 — Radio Frequency (RF) Exposure guidelines, this equipment should be installed and operated with a minimum distance of 20cm between the radiator and your body.

Cet équipement est conforme aux limites d'exposition de rayonnement d'IC RSS-102 déterminées pour un environnement non contrôlé. Cet équipement devrait être installé et actionné avec la distance minimum 20 cm entre le radiateur et votre corps.