

T1 Series Label Printer  
**User Manual**

## **Copyright Statement**

Edition 1.0 issued in April 2018

All rights reserved 2018MAKEiD Printer

This manual includes the professional information of Chongqing Jingranyouxu Science and Technology Co., Ltd., which are only for commercial customers' reading and reference. The contents herein shall not be used, copied or spreaded, publicized by any means for any reason or purpose without the written permission of Chongqing Jingranyouxu Science and Technology Co., Ltd., otherwise, we will investigate and affix the legal liability.

Chongqing Jingranyouxu Science and Technology Co., Ltd. reserves the amendment right without further notice.

## **Trademark**

MAKEiD is the registered trademark of Chongqing Jingranyouxu Science and Technology Co., Ltd.

Microsoft is the registered trademark of Microsoft Corporation.

Windows is the registered trademark of Microsoft Corporation.

# Contents

|                                                                                                                                  |    |
|----------------------------------------------------------------------------------------------------------------------------------|----|
| Foreword .....                                                                                                                   | 1  |
| Disclaimer .....                                                                                                                 | 2  |
| Safety Instructions .....                                                                                                        | 3  |
| 1.1 Overview .....                                                                                                               | 8  |
| 1.2 Unpacking .....                                                                                                              | 8  |
| 1.3 Packing List .....                                                                                                           | 8  |
| 1.4 Main Parts .....                                                                                                             | 9  |
| 1.5 Technical Parameters and Specification<br>.....                                                                              | 10 |
| .....                                                                                                                            | 12 |
| 2.1 Installation of Label Box and Cautions                                                                                       | 12 |
| 2.1.1 Check the label box and make sure that all<br>parts are in good status and there is no breakage<br>or other problems. .... | 12 |
| 2.1.2 Insert the label box into the printer as<br>shown in Figure 2-1. Close the printer cover. ..                               | 12 |
| 3.1 Printer Operation .....                                                                                                      | 13 |
| 1. Power on the printer .....                                                                                                    | 13 |
| 2. Turn on the printer.....                                                                                                      | 13 |
| 3. Alarm .....                                                                                                                   | 14 |
| 4. Print test .....                                                                                                              | 14 |
| 10. Turn off the printer.....                                                                                                    | 14 |
| 3.2 Description of Indicators .....                                                                                              | 14 |
| 3.4 Connect a mobile device to operate the<br>printer.....                                                                       | 14 |
| Chapter IV Maintenance.....                                                                                                      | 15 |

|                                            |    |
|--------------------------------------------|----|
| 4.1 Preparation before maintenance:.....   | 15 |
| 4.2 Cleaning of the Label Box Reader ..... | 15 |
| 4.3 Maintenance of Print Head .....        | 16 |
| 4.5 Cleaning of Internal Space .....       | 16 |
| Chapter V Failure Treatment.....           | 17 |
| 5.1 Failure Indication .....               | 17 |
| 5.2 Minor Failures.....                    | 18 |
| 1. Failure of print head .....             | 18 |
| 2. Shutdown of printer .....               | 18 |
| 3. The printing quality is not good .....  | 18 |
| 4. The printer cannot be turned off.....   | 18 |
| 5.3 Failure due to other unknown causes .  | 19 |
| Annex.....                                 | 19 |

## **Foreword**

Dear users:

Thanks for choosing T1 series portable label printer designed and manufactured by Chongqing Jingranyouxu Science and Technology Co., Ltd.

T1 series portable label printer is a light, handy and convenient thermal wax printer which can realize printing via mobile phone, tablet PC and other devices. It is with good performance, easy operation, durability and wide application range.

This manual specifies the installation, operation and maintenance of printer, cautions for operation, setting and maintenance and solutions for minor failures. Please read this manual carefully before operation and keep it properly for further use.

## **Disclaimer**

This manual expounds the specification and instructions. However, specification and configuration of the printers manufactured thereafter may be altered. The manufacturer and dealers will not be responsible for any direct or indirect loss arising from the difference between manual and the printer.

This manual lists problems that may occur, however, unforeseen situation may occur during use. For any problem during printer operation, such as failure to work, defect or unclearness of printed contents, the manufacturer and dealers are only responsible for failure debugging (in line with the articles of warranty card) rather than other direct or indirect loss therefrom, including but not limited to loss of business interest, business interruption, business information and other financial loss.

## Safety Instructions

Personal safety is all-important during operation and maintenance. Warnings and cautions for printer operation are detailed in this manual. Please read carefully before operation and maintenance.

Do not try to repair or adjust it by yourself. In case that the failure cannot be solved in line with this manual, please **turn off the printer! Disconnect the power supply.**

Please contact Customer Service Dept. of Chongqing Jingranyouxu Science and Technology Co., Ltd. via 400-158-9100 for help.

### Marks

To ensure safety during operation, please pay attention to the following marks.



Warning: this mark indicates that the items shall be paid special attention to. Financial loss or personnel injury may occur in case of improper use.



Note: this mark indicates that the items shall be paid attention to. Material damage may occur or the printer may fail to work in case of improper use.

### Cautions for printer operation



- Please take out the label at the exit after printing, otherwise sluggish printing may occur.
- Do not disassemble the printer, otherwise electric shock, personal injury due to rotating part, part damage and other accidents may

occur.

- In case of abnormalities, such as smoking and odor, please disconnect the power supply to avoid burn.
- Do not take out the label box during printing, otherwise unforeseen circumstances may occur.
- The printer is hot after printing. Do not touch it, otherwise scald may occur.



- Do not use inferior label box (the ones not manufactured by MAKEiD), otherwise the print head may be damaged and the service life of printer may be shortened. Damage of print head due to inferior materials is not included in the warranty range.
- Do not touch the print head, otherwise sensing element may be damaged due to static electricity.
- Please turn off the power if the printer will not be used for a long time.
- Do not press or strike the printer, otherwise the part may be damaged or the printer working may be abnormal.
- In case of soaking or crash of printer or battery, please do not use the printer and make it repair at the maintenance center designated by MAKEiD.
- To ensure the printing effect and avoid damage of print head, please do not use the printer at the environment with a tempera-



ture below 0 °C and a relative humidity over 80%. Meanwhile, when the temperature difference between indoor area and outdoor area is large, do not use the printer immediately after taking it into indoor area. Please use it after the printer has no frosting.

- The print head is a precise part. To better protect the print head and extend the service life, the suggested workload is as follows:

- \* The single printing length shall not exceed two meters

- \* The printing length per day shall not exceed twenty meters

- Temperature of the print head may be high after continuous printing. Please be careful during operation so as to avoid burn.
- Do not scrape the print head with hard object. Damage of print head due to improper maintenance and use are not included in the warranty range.
- The print head is a quick-wear part. To avoid corrosion, please pay attention to the following items:
  - \* Do not touch the print head with hands;
  - \* Do not use ribbon and thermo-sensitive paper with Na, K and Cl ions;
  - \* The print head cannot contact any liquid or moist object;
  - \* Only anhydrous alcohol is applicable for print head cleaning.

## Cautions for battery use

Please read this manual and mark on the battery carefully before operation. Do not remove the battery optionally.



- Please store the charged battery properly. Contact between battery electrode and conductor such as key and jewelry may cause short circuit, hot, even burn and property loss or personal injury.
- Do not place battery in fire, otherwise electrolyte leakage may occur. In case that the electrolyte gets into eyes, do not knead with hands. Clean eyes with water. In case of serious damage, go to a doctor for treatment. If the electrolyte spills on skin or clothes, clean it with water immediately.
- Do not place battery in water, internal short circuit may occur. In this case, the battery will get hot, smoke, deform, damage, even explore.
- The battery is with special circuit protection and device. Do not open it optionally, otherwise short circuit or electrolyte leakage may occur.
- Please use the genuine battery. Battery made by other manufacturers may cause burn of printer or injury of operator. Damage arising from non-genuine battery shall not be included in the warranty range and the manufacturer and dealers shall bear no responsibility therefrom.



- Replace the battery immediately in case of color change or deformation.

- Do keep battery out of reach of children so as to avoid damage.

### Cautions for power adapter

Please read this manual and mark on the power adapter carefully before operation.



- Do not use damaged or worn power line, otherwise electric shock or fire may occur.
- Do not contact the power adapter, power plug and power output with wet hand, otherwise electric shock may happen.
- Do not overbend or pull the power line hard and do not place heavy articles on it, otherwise it may be damaged and fire or electric shock may occur.
- When pulling out the power plug, just hold the plug and do not pull the power line, otherwise it may be damaged and fire or electric shock may occur.



- Do keep power adapter out of reach of children so as to avoid damage.
- Disconnect power supply before printer maintenance so as to avoid damage.
- No power adapter is provided with the printer. All standard USB plugs are applicable to.

## 1.1 Overview

T1 series portable label printer is a smart, portable and interconnected label printer manufactured by Chongqing Jingranyouxu Science and Technology Co., Ltd. With MAKEiD APP, it can realize printing via mobile phone and tablet PC.

## 1.2 Unpacking

After receiving the printer, check it carefully. In case of damage during transportation, claim against the carrier immediately. If there is no damage, check the accessories in line with the packing list. For any short item, please contact with the dealer immediately.



1. Check the printer **carefully** for damage or scratch. For any damage during transportation, MAKEiD will bear no responsibility.
2. Please keep the packaging box for transfer in the future.

## 1.3 Packing List

Packing list (product in kind prevails)

1. Printer 1pc
2. USB cable 1pc
3. Label box 1pc
4. User manual (including warranty card and certifi-

cate of qualification)

1pc

## 1.4 Main Parts

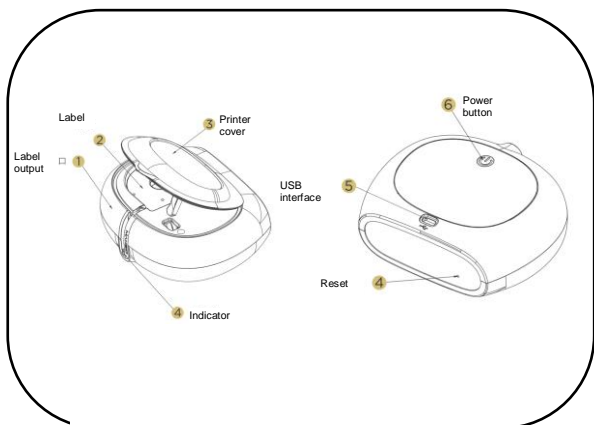

Fig. 1-1

1. Label output
3. Printer cover
5. USB interface
7. Reset

2. Label
4. Indicator
6. Power button

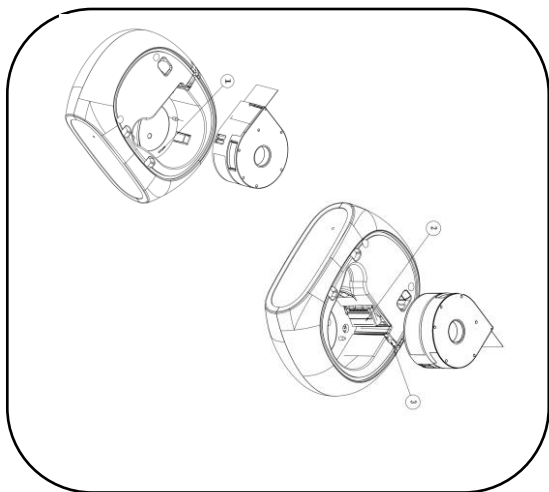

Fig. 1-2

- 1. Label box reader
- 3. Paper outlet

- 2. Print head

## 1.5 Technical Parameters and Specification

Table 1-1 Specification and Parameters of Printer

| Function and Specification | Parameters       |
|----------------------------|------------------|
| Printing method            | Thermal printing |
| Paper detection mode       | Reflection-type  |

|                              |                                                                    |
|------------------------------|--------------------------------------------------------------------|
| Processor                    | STM32F401                                                          |
| Resolution                   | 178dpi                                                             |
| Interface                    | Type-C, bluetooth                                                  |
| Effective printing width     | 18mm                                                               |
| Maximum printing speed       | 15mm/s                                                             |
| Width of roll label          | 12Mm, 16mm, 20mm, 24mm                                             |
| Outer diameter of roll label | Maximum outer diameter: 36mm<br>Inner diameter: 18mm               |
| Label thickness              | 0.06 ~ 0.15mm                                                      |
| Printer dimension            | 56*130*101mm                                                       |
| Weight                       | 0.4kg                                                              |
| Working environment          | Temperature: 15~35°C<br>Relative humidity: 30~80% (non-condensing) |
| Storage environment          | Temperature: -10~55°C<br>Relative humidity: 5~80% (non-condensing) |

Table 1-2 Specification of Power Adapter

| Function and Specification | Parameters |
|----------------------------|------------|
| INPUT                      | 5V 1A      |

## 2.1 Installation of Label Box and Cautions

2.1.1 Check the label box and make sure that all parts are in good status and there is no breakage or other problems.

2.1.2 Insert the label box into the printer as shown in Figure 2-1. Close the printer cover.

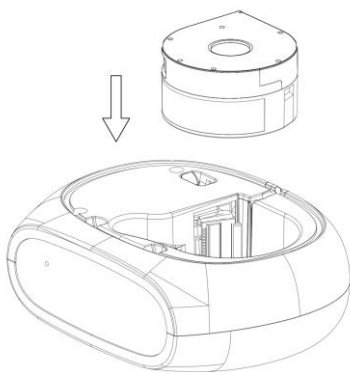



Figure 2-1 Installation Diagram of Label Box



Please take good care of the environment. The old label box belongs to recyclable garbage. Please do not throw it away at will.

### 3.1 Printer Operation

1. Power on the printer
  - Li-ion battery pack: 7.4V, 1200mAh
  - Power adapter
    - \* Input: 5V 1A
    - \* When the printer is turned on, the indicator indicates nothing after the adapter connected. When the printer is turned off, the lighting will flash after the adapter connected and it means the printer is not fully charged. The green lighting is normally on when the printer is fully charged.

2. Turn on the printer

Press down the power button for two seconds. The printer is ready after the green lighting is normally on.

### 3. Alarm

- Battery alarm: when the battery level is low, the red lighting will flash. If the printer is interconnected to a mobile phone, an alarm of low battery will show on the APP.

### 4. Print test

When the printer is turned on, connect the mobile phone to the printer and perform self-inspection on the APP.

### 8. Printer Setting

When the printer is turned on, users can set up printing parameters via the APP according to the cases.

### 9. Print

When the printer is turned on, users can edit contents on the APP and then print it out.

### 10. Turn off the printer

When the printer is turned on, press down the power button for two seconds. After the indicator extinguishes, release it, then the printer will be turned off.

## 3.2 Description of Indicators

- Turnon: the green lighting is normally on
- Failure: the red lighting flashes
- Charging (when the printer is turned off): the green lighting flashes
- Fully charged (when the printer is turned off): the green lighting is normally on

## 3.4 Connect a mobile device to operate the printer

The printer is with bluetooth, which can connect to mobile devices. The wireless printing software has label templates. Users can use the template for editing, then print it out. When a mobile device is connected to the printer and the label template inputted and the built-in template are inconsistent, the later one will



- Note Please choose wireless editing software matching with the mobile device (please see the installation QR code in the annex herein).
- 

## Chapter IV Maintenance

### 4.1 Preparation before maintenance:

---



- Please read the “Safety Instructions” herein carefully before printer maintenance.
- Use anhydrous alcohol with a concentration over 99% for cleaning.



- Do disconnect the power supply before printer maintenance.
- 

### 4.2 Cleaning of the Label Box Reader

Dust and dirt is harmful to the contact between label box reader and label box sensing chip. Do clean it timely as required hereunder:

- Turn off the power;
- Open the cover and take the label box out;
- Use a piece of soft cloth (lens wiping paper) with anhydrous alcohol to clean the surface of sensing chip gently. The alcohol shall not permeate into the product.
- Do not clean the operation panel with corrosive organic solvents, such as machine cleaner and in-

dustrial alcohol.

### **4.3 Maintenance of Print Head**

To ensure the printing quality and reduce damage of print head from paper scrap, sand, dust particle, glue and other materials, it is suggested that the print head shall be cleaned once every month if it is used frequently and it shall be cleaned before each use if it is not used frequently. Cleaning procedure:

- Turn off the power;
- Open the cover and take the label box out;
- Use swabs with anhydrous alcohol to clean the print head. Clean it repeated until there is no more dirt on the swab, which means the print head is clean.

### **4.5 Cleaning of Internal Space**

A clean internal space is good for the print head and can effectively extend the service life of print head. Use cotton cloth with anhydrous alcohol to clean the surfaces of all internal parts.



# Chapter V

## Failure Treatment

### 5.1 Failure Indication

Normally, when the printer is out-of-order or unusual, a prompt message will show on the panel, meanwhile, the communication between printer and host and printing will stop.

Table 5-1 Printer Failure and Solutions

| Icon                                                                                        | Description and Cause             | Solution                                 |                                                |
|---------------------------------------------------------------------------------------------|-----------------------------------|------------------------------------------|------------------------------------------------|
| <br>电量低    | The battery is running out        | The battery is low                       | Connect the power for charge                   |
| <br>纸带异常 | The material cannot be recognized | The chip is damaged                      | Replace the material                           |
|                                                                                             |                                   | The contact of security chip is not good | It shall be returned to the factory for repair |
|                                                                                             | The printing is sluggish          | The paper is stuck in the machine        | Contact the customer service                   |

|                                                                                   |                |                              |                 |
|-----------------------------------------------------------------------------------|----------------|------------------------------|-----------------|
|  | Open the cover | The print head is not locked | Close the cover |
|-----------------------------------------------------------------------------------|----------------|------------------------------|-----------------|

## 5.2 Minor Failures

### 1. Failure of print head

If there are fixed vertical white lines on the print file, the print head may be dirty or damaged (as shown in the following figure).



Output direction 

Clean the print head first. If the failure cannot be solved, replace the print head.

### 2. Shutdown of printer

- Is the power turned on?
- Is there any piece of paper?
- Is the print head locked?

If the printer doesn't work, please contact the customer service.

### 3. The printing quality is not good

If the printing quality is not good, please solve it as required below:

- Clean the related parts in line with the maintenance instructions herein;
- The label may not be standard. Replace the label box;

### 4. The printer cannot be turned off

If the printer cannot be turned off by pressing down the power button for a long time, press down "reset" at the side of printer with a sharp point to turn it off.

### **5.3 Failure due to other unknown causes**

For failure due to other unknown causes, please contact the Customer Service Dept. of MAKEiD. Telephone: 400-158-9100.

### **Annex**

Please scan the QR code to get the link for installation of editing software.



#### **FCC STATEMENT**

1. This device complies with Part 15 of the FCC Rules. Operation is subject to the following two conditions: (1) This device may not cause harmful interference, and (2) This device must accept any interference received, including interference that may cause undesired operation.
2. Changes or modifications not expressly approved by the party responsible for compliance could void the user's authority to operate the equipment.

This equipment has been tested and found to comply with the limits for a Class B digital device, pursuant to part 15 of the FCC Rules. These limits are designed to provide reasonable protection against harmful interference in a residential installation. This equipment generates, uses and can radiate radio frequency energy and, if not installed and used in accordance with the instructions, may cause harmful interference to radio communications. However, there is no guarantee that interference will not occur in a particular installation. If

this equipment does cause harmful interference to radio or television reception, which can be determined by turning the equipment off and on, the user is encouraged to try to correct the interference by one or more of the following measures:

—Reorient or relocate the receiving antenna.

—Increase the separation between the equipment and receiver.

—Connect the equipment into an outlet on a circuit different from that to which the receiver is connected.

—Consult the dealer or an experienced radio/ TV technician for help.

#### FCC Radiation Exposure Statement:

This equipment complies with FCC radiation exposure limits set forth for an uncontrolled environment. In order to avoid the possibility of exceeding the FCC radio frequency exposure limits, Human proximity to the antenna shall not be less than 20cm (8 inches) during normal operation