

TOMOLOO



Shenzhen TOMOLOO Technology Industrial Co., Ltd

Add: #7 Cofco (Guang) Robotics Industrial Park, Dawang Road, Fuyang Street, Shean District, Shenzhen, China
Tel: +86-755-2988 6605 E-Mail: support@tomoloo.com
Website: www.tomoloo.com www.tomoloo365.cn alibaba.com

TOMOLOO



Two Wheels
Folding Electric Scooter
L1-1

About the Manual

This manual applies to two wheel electric scooter. Please read this manual carefully to ensure that

1. Quickly grasp the basic operating procedures and riding methods of two wheel electric scooter.
2. Familiar with safe driving rules for a safe and enjoyable cycling experience.
3. Understand the composition and safety of two wheel electric scooter

If you have any questions or need more information, please contact the franchised dealer or after-sales service.

Please pay attention to the following signs and relating content:



Dangers!
Could cause serious property
damage or personal injury



Warnings!
Improper operations can
lead to malfunction of the product



Information tips

Contents

About the manual.....	1
Contents.....	2
Chapter 1: Products and components.....	4
Chapter 2: Function Icon and description.....	5
Chapter 3: Two wheel scooter installation guide.....	7
Chapter 4: Charging instructions	10
Chapter 5: How to ride the two wheel electric scooter.....	11
Chapter 6: Riding security.....	13
Chapter 7: Folding and transportation.....	15

Chapter 8: Routine maintenance	18
Chapter 9: Mode parameter table	21
Chapter 10: Name and content of hazardous substances	23
Chapter 11: Trademarks and copyright instructions	24
Chapter 12: Quick Installation guide	25

Chapter 1

Products and components



components

User manual x1

Screw M3 x4



Knob x2



Hex wrench M5 x1, M3 x1, M4x1



Charger adapter x1

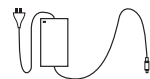

*Please check carefully that the parts in the package are intact.

- 04 -

Chapter 2

Function Icon and description

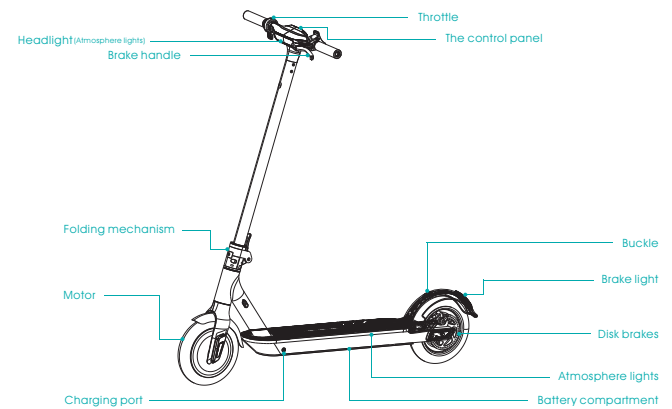

- 05 -

Control panel

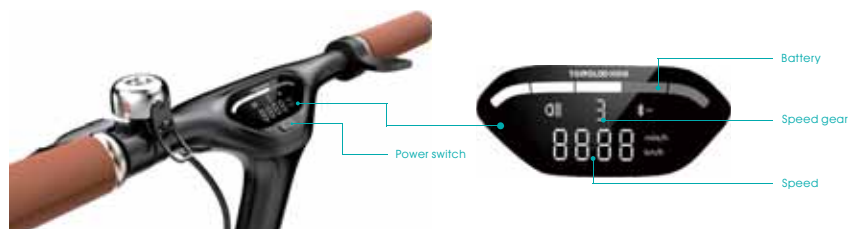

Control instructions

Use control panel to control scooter, the specific features are as follows.

1. Long press the power switch button to turn on the machine, and the front light, bottom atmosphere light, tail light, and brake light are all on. The control panel shows the power and speed.
2. After turn on, the control panel display shows "1", indicating that the speed is 1st gear. Press the button to display 2nd gear; the highest display is 3rd gear.
3. Press the button twice the front light is on and press the button twice the front light goes out.
4. Press the button three times to display the total mileage, then press the button three times to display the speed.
5. When the brakes are applied in emergency, the brightness of the brake light increases after the brake handles are gripped.
6. Battery status indicating: four lights are 100%, three lights are 75%, two lights are 50%, three lights are 25%.
7. The scooter will power off automatically after 15 minutes without riding and operation.

Chapter 3

Installation Guide

1. Install the brakes to correct position with the Hex wrench (M5 in the tool box).

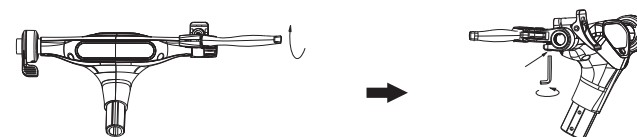

2. Install the handlebars, pay attention to the installation direction.

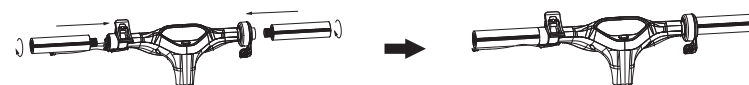

3. Hold up the scooter, flip up the buckle and move the safety buckle to the left

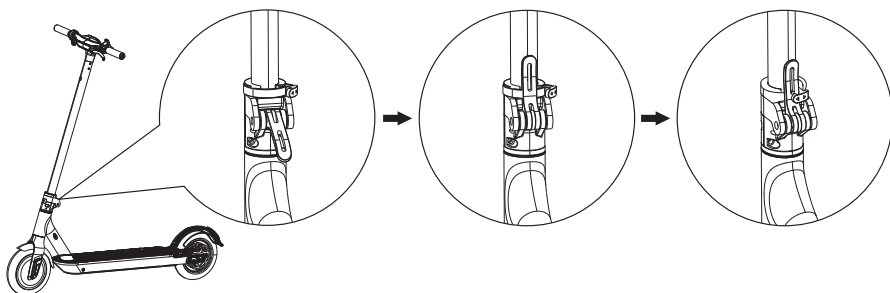

- 08 -

4. Install the handlebar to the standpipe.



6. After the installation is completed, switch on and off to confirm if scooter operable.



5. Use the Hex wrench M3 in the tool bag to lock the screws M3 x 4 on both sides of the standpipe as below picture referred.

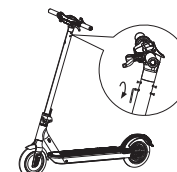

- 09 -

Chapter 4

Charging instructions

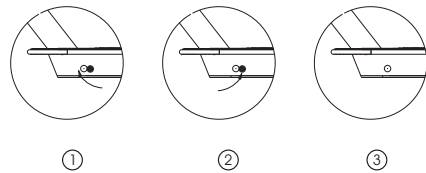
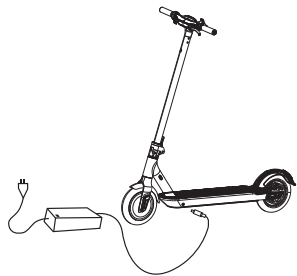

- Open rubber cap.
- Insert in the charging plug.
- Close the rubber cap, after charging is completed.

- 10 -

Chapter 5

How to ride the two e-scooter



*There are risks of falling and injury when study riding, so please wear a helmet and protective gear as shown in the picture.



1. Turn on the power and check the power indicator.



2. One foot stands on the pedal, the other foot kicks backward.

- 11 -

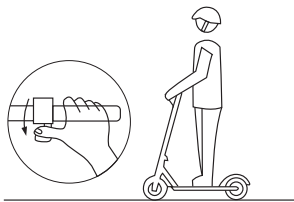

3. When the electric scooter is sliding, the other foot steps on the pedal. After the feet step on the pedal, slightly press the throttle (speed above 5km/h will start the throttle).

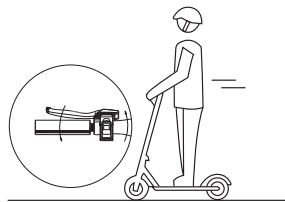

4. Release the throttle can slow down the speed, and automatic energy recovery system can help to slow down. Emergent brakes need to pull the handle brake on the left side.

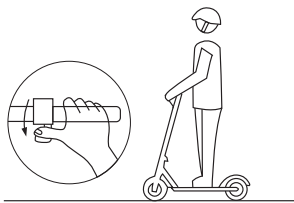

5. Keep one speed for 8 seconds to start the cruise control at a constant speed-release the throttle and the speed remains unchanged. To cancel the cruise control, push the throttle or operate the brakes.

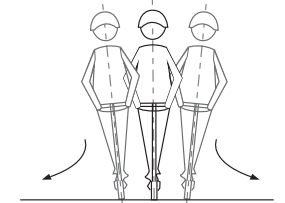

6. When turning, you need to lean the body slightly toward the direction of turning and turn the handle slowly.

Chapter 6

Riding security



⚠ Please avoid riding in the rain.

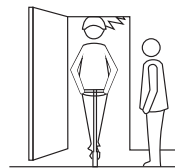

⚠ To avoid the head hit the door frame, elevators and other obstacles.



⚠ Encounter deceleration zone/elevator threshold /potholes and other unconventional road pavement, please do not pass at high-speed. Encounter rough road please keep in the low speed (5-10km/h). Aslight kneeling allows you to better adapt to the complex road.

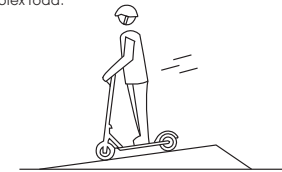

⚠ Do not accelerate at downhill.

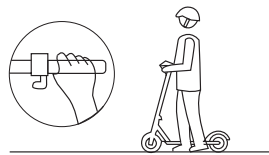

⚠ Do not press on the accelerator pin while walking with the e-scooter.

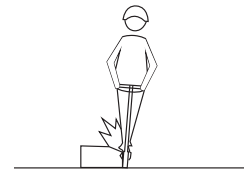

⚠ Avoid barriers while driving.

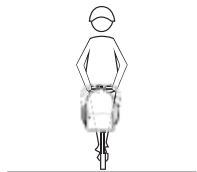

⚠ Do not hang any heavy items on the handlebar.



⚠ Do not stand with one foot on the pedal or on floor while driving.

Chapter 7

Folding and Transportation

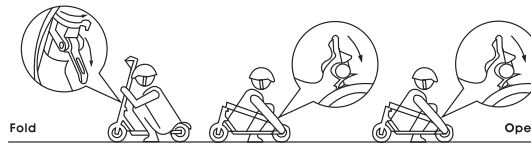

Make sure that the e-scooter has been turned off, then to pull the folding-finger-pull out meanwhile holding the standpipe, then open up the folding spanner, aim it at the bell and the fender hook, then buckle the bell with the back-fender. Press the bell hook while opening it, after both the bell and hook have been separated from the fender-hook, pull the folding-finger-pull back to the original place after both of the standpipe and locking-folding plate have been straightened up.

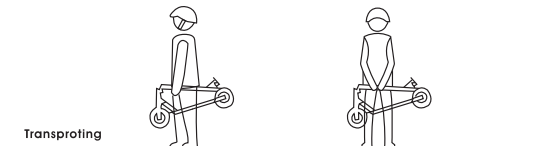

After the e-scooter has been folded successfully, use one hand or two to hold the folding-level to transit.

Warning Reminder

Do not try to do any dangerous movement.

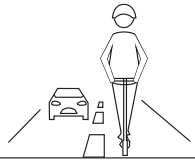

⊗ Forbidden to drive on the driveways or in crowded residential areas.

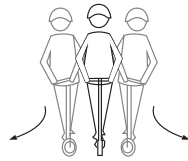

⊗ Forbidden to rotate the handle strongly while driving with high speed.



⊗ Forbidden to drive on ponding water areas that deeper than 2cm.

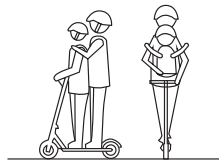

⊗ Forbidden to drive it while there are more than one person, and/or holding a child while driving.

Safety instructions

• An electric scooter is a sporting entertainment tool that is not a vehicle, but once you drive it into a public area, it will also have a vehicle property, so there are also possible safety risks for all modes of transport. Strictly follow the instructions in this manual to drive for the maximum safety to protect you and the others' safety, and to ensure compliance with national and provincial regulations and traffic regulations.

• At the same time, you need to understand: Once you have an electric scooter on a public road or other public place, you may be exposed to the risk of unauthorized driving / improper operation of others or vehicles, even if you are in full compliance with this safe driving guide. Like walking or cycling may also be hurt by other means of transport; As with all vehicles, the faster the electric scooter is driving, the longer the brakes need, and the emergency brakes on some smooth surfaces can also cause the wheels to slip and lose balance or even fall. Therefore, It is important to be vigilant and maintain the proper speed during driving, and it is important to maintain a reasonable safety distance with others and the transport means. Please be vigilant and drive at low speed before entering unfamiliar terrain.

• Please respect the right of pedestrian way when driving. Avoid frightening pedestrians, especially the children. When pedestrians passing through, remind pedestrians and slowing down when passing. As far as possible from the left side of the pedestrian (applicable to the country where the vehicle is traveling right). Face to face with pedestrians, keep on the right and lower speed.

• We must strictly follow the safety requirements of this manual for drivers in countries and regions, where there are no national standards and regulations for electric scooters, Tomoloo shall not be liable for any liability, personal injury, accident, legal dispute, and all other unfavorable events resulting from the use of violating the instructions indicated in this manual.

• Do not lend the electric scooter to a person who never operate to avoid injury. If give the electric scooter to a friend, be sure to be responsible for the safety of your friends, you should teach him (her), and tell him (her) must wear safety care.

• Please check the electric scooter for each time before driving. If you find that the parts are loose, the battery life is obviously reduced, the tire is slow to leak or excessive wear, turn to abnormal sound or malfunction, please stop using it immediately, and do not driving force. And call Millet Service number: 400-160-6198 for professional guidance or maintenance services.

Chapter 8

Daily Maintenance

Electric scooter cleaning and storage

If there is a crack in the body of the electric scooter, wipe it with a small amount of water with a soft cloth. If it is difficult to clean, you can use a toothbrush with toothpaste to brush it repeatedly and then use a damp cloth to clean it. If the body plastic has scratches, you can use sandpaper or other abrasive materials for polishing.

Note:

1. Do not use alcohol, gasoline, kerosene or other corrosive, volatile solvents to clean, otherwise it will seriously damage the body and internal structure. It is forbidden to use pressure gun spray and flush, make sure that the charging cable is unplugged and the rubber cap has been tightened when cleaning, otherwise it may cause electric shock or accident due to water intake.
2. Store electric scooter in a dry room and cool place as much as possible to avoid accelerating of aging for electric scooter and tire because of long time storage outside the room, which will also reduce the usage life of the battery.

Electric scooter battery maintenance

1. Do not use other models or brands of batteries, otherwise there may be security risks.
2. Do not touch the battery contacts and do not open the battery compartment to avoid the metal objects to touch the battery contacts, which may cause a short circuit or may damage the battery, or cause personal injury.
3. Only use the original charger for charging, otherwise it may cause damage or fire.
4. Inappropriate disposal of used batteries may result in serious environmental pollution, disposal of waste battery packs must be in accordance with local regulations. Do not handle the battery pack to protect the natural environment.
5. Do not place the battery in a high temperature environment higher than 50°C or lower than -20°C (for example, do not expose the electric scooter or its battery pack to the car in summer), otherwise it may cause malfunction, fire, or even fire risk.

To avoid power consumption and recycling, use batteries that can greatly extend battery life. In addition, at room temperature, the battery pack can play a higher mileage and performance, if it is used in environments below 0°C, battery life and performance will decline. In some areas, at -20°C, the mileage may be only half or less than at room temperature.

If there is a crack in the body of the electric scooter, wipe it with a small amount of water with a soft cloth. If it is difficult to clean, you can use a toothbrush with toothpaste to brush it repeatedly and then use a damp cloth to clean it. If the body plastic has scratches, you can use sandpaper or other abrasive materials for polishing.

Note:

It is forbidden for non-professionals to remove the battery pack. Failure to do so may result in serious electrical faults or safety short-circuits.

Disc brakes debug

If you feel the brake is tight when you are riding, you can adjust the disc brake by loosening the screw on the Rotary Knob with a M5 hex wrench (As shown in below picture), turn the Rotary knob to the right by a little and tighten the screw with a M5 hex wrench. If you feel the brake is loose, you can turn the Rotary knob to the left by a little after loosening the screw on the Rotary Knob with M5 hex wrench, and then tighten the screw.

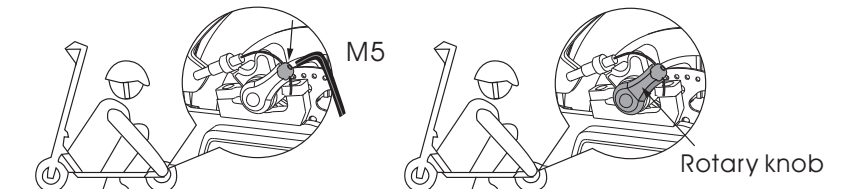

Handle shake debug

If you feel the standpipe is loose and shakes when you are riding, please use the M5 & M4 hex wrench to reinforce the screw as below picture referred.

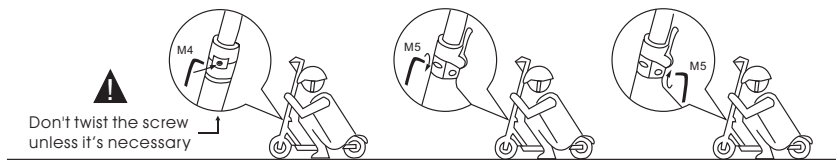

Use of inflatable mouth

When the front and rear wheels of the electric scooters have insufficient air pressure, inflate the tires with air tube. First, unscrew the air cap on the tire, and then tighten the extended inflatable tube and air tube on the tire, and connect the inflator to the air tube on the tire to inflate.

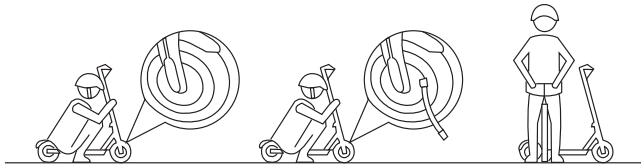

Chapter 9

Mode Parameter Table

Parameters	Description	Specifications
Product Dimensions	LxWxH(cm)	1200mmx550x1180mm
	Folding Size LxWxH(cm)	1200mmx550mmx495mm
Weight	Total Scooter(kg)	12.9
	Rider Weight Limit(kg)	100
Ride Limits	Rider Age	16-50
	Rider Height(cm)	120-200
	Max Speed(MPH)	15
Main Parameter	Max Mileage(MILES)	18.6
	Max Slope	14°
	Road	Cement, asphalt, flat roads, etc., shall not exceed 1 cm steps, and shall not exceed 3cm.
	Working Temperature	0-40°C
	Stock Temperature	-20-45°C

Parameters	Description	Specifications
Battery Pack	Rated voltage(VDC)	36
	Maximum Charge Voltage(VDC)	42
	Rated Capacity	7.5Ah
	Protection	Temperature, short circuit, undervoltage, overcurrent, overcharge, overdischarge
Motor	Rated Power(W)	250
	Max. Power(W)	500
Charger	Rated Power(W)	84
	Rated Voltage input(VAC)	100-240
	Rated Voltage output(VDC)	42
	Rated Current Output(A)	2
	Charging time(H)	4-6
	E350715	FY-4202000

Height: The height of the body to the ground.

Endurance: Electric scooters are fully charged, load is 220 lbs, ambient temperature is 25 degrees without wind, maximum 25 per hour in safe mode Kilometers. However, the actual cruising range varies with driving habits, roads, ambient temperature, wind speed or other factors.

Note:
Data and parameters vary by mode. Subject to change without notice.

Chapter 10

Name and Content of Hazardous Substances

Component Name Harmful Substance	Harmful Substance					
	Pb	Hg	Cd	Chromium (C)	(PBB)	(PBDE)
Charger	X	O	O	O	O	O
Battery	X	O	O	O	O	O
Air tap	X	O	O	O	O	O
Charging Port	X	O	O	O	O	O
Main Board	X	O	O	O	O	O
Instrument board	X	O	O	O	O	O
Wheel Motor	X	O	O	O	O	O
Frame	O	O	O	O	O	O
Tire	O	O	O	O	O	O

This Table is formulated in line with the SJ/11 364

O: Indicate that the content of this harmful substance in all homogeneous materials of this component is below the limit prescribed in GB/T 26572
X: Indicate that the content of this harmful substance in at least one homogeneous materials of this component is beyond the limit prescribed in GB/T 26572

Chapter 11

Trademark and Copyright Description

Electric scooters service strictly according to the People's Republic of China "Consumer Protection Law" and "Product Quality Law of the People's Republic of China" law to implement Three Guarantees Services with the following content:

Item	Warranty content	Period
Frame	Frame, four-wheel drive, controller assembly, handlebars, forehead main body, intermediate fuel tank instrument panel, rear wheel, brake disc, disc brake assembly, folding handle, front fork, front fork front tube rotating parts, control Bus and brake lines.	One year
Accessories	Battery, charger, brake and finger switch	Six months
Wear equipment and appearance	Crash Bar, Headlight, Gauge, Tires, Tubes, Bell Parts, Mudguards, Rear Taillights, Decorative Covers, Foot Mounts, Battery Covers, Foot Mats, Charging Seats, and Rubber Plugs.	Three months

WARNING – Risk of Fire – No User Serviceable Parts.
Prolonged Exposure to UV Rays, Rain and the Elements May Damage the Enclosure Materials, Store Indoors When Not in Use.

Chapter 12

Quick Installation Guide

In the APP application library, search and scan the QR code below to download and install.



Contact us

In the process of using the two-wheel electric skateboard, if you have any questions about riding, maintenance, security, please contact us as following.

We are very pleased to provide service to you.



***Two-Wheels
Electric Scooter***

TOMOLOO

FCC Warning Statement

Changes or modifications not expressly approved by the party responsible for compliance could void the user's authority to operate the equipment. This equipment has been tested and found to comply with the limits for a Class B digital device, pursuant to Part 15 of the FCC Rules. These limits are designed to provide reasonable protection against harmful interference in a residential installation. This equipment generates uses and can radiate radio frequency energy and, if not installed and used in accordance with the instructions, may cause harmful interference to radio communications. However, there is no guarantee that interference will not occur in a particular installation. If this equipment does cause harmful interference to radio or television reception, which can be determined by turning the equipment off and on, the user is encouraged to try to correct the interference by one or more of the following measures:

- Reorient or relocate the receiving antenna.
- Increase the separation between the equipment and receiver.
- Connect the equipment into an outlet on a circuit different from that to which the receiver is connected.
- Consult the dealer or an experienced radio/TV technician for help.