



eclips²

Electronic Cutter Fabric Starter Kit w/Bluetooth[®]
Cutter Électronique Kit de Démarrage Pour Tissu avec Bluetooth
Guillotina Electrónica Kit Básico de Telas con Bluetooth

————— **USER'S GUIDE** —————
GUIDE DE L'UTILISATEUR
MANUAL DE USO



eCAL2 Software included!

Logiciel eCAL2 inclus!

¡Incluye el Software eCAL2!



Read Guide Before
Operating Product.
Save Guide For Reference.



Veuillez lire ce Guide avant
d'utiliser le produit.
Conservez ce Guide pour le
consulter au besoin.



Lea el manual antes de
operar el producto.
Guarda el manual para
futuras referencias.

IMPORTANT SAFETY INSTRUCTIONS



READ THESE IMPORTANT SAFETY INSTRUCTIONS

THIS DEVICE IS INTENDED FOR HOUSEHOLD USE ONLY

WARNING

To reduce the risk of fire, electrical shock or personal injury, it is important that you read and understand all the instructions and warnings that come with your eclips®2 Electronic Cutter (“Product”).



ELECTRICAL SHOCK HAZARD

Product is an electrical device. Use with caution. Observe the following precautions:

- Do not operate Product on wet surfaces or near any water sources (tub, shower, sink, etc.).
- Keep liquids and beverages away from Product.
- Unplug Product from outlet when not in use or before cleaning.
- Unplug Product when removing or installing Blades or Blade Holder.



PINCH HAZARD

Cutting Carriage can pinch fingers or hand. Feed Rollers can catch hair or clothing.

- Keep fingers away from moving parts.
- Keep hair and clothing away from moving parts.



CUTTING HAZARD

Cutting Blades are sharp. Handle with care.

- Keep fingers away from exposed blade.



Keep away from Children

- Choking hazard. Small parts.



This Product has a Class 1 laser and complies with International Standards EN 60825-1; a Class 1 laser product is safe under reasonably foreseeable conditions of operation. Use of controls or adjustments or performance of procedures other than those specified herein may result in hazardous radiation exposure.

- DO NOT disassemble the device.
- DO NOT shine the laser on a reflective surface.
- DO dispose of the Product according to the local laws and regulations of your region.
- DO NOT look directly at laser at any time.

GENERAL SAFETY RULES:

- Read and understand all the instructions and warnings that come with the Product.
- Always operate Product on a dry, clean, level surface.
- Do not operate Product with wet hands.
- Keep area of operation well lit.
- Do not operate Product near flammable liquids or gases.
- Do not operate Product out of doors.
- Do not unplug Product by tugging or pulling the power cord.

SAVE THESE INSTRUCTIONS AND WARNINGS and keep them near your eclips®2 Electronic Cutter. Please visit sizzix.com for more information.

NOTICE

The device complies with Part 15 of the FCC Rules. Operation is subject to the following two conditions: (1) this device may not cause harmful interference, and (2) this device must accept any interference received, including interference that may cause undesired operation.

CONTENTS

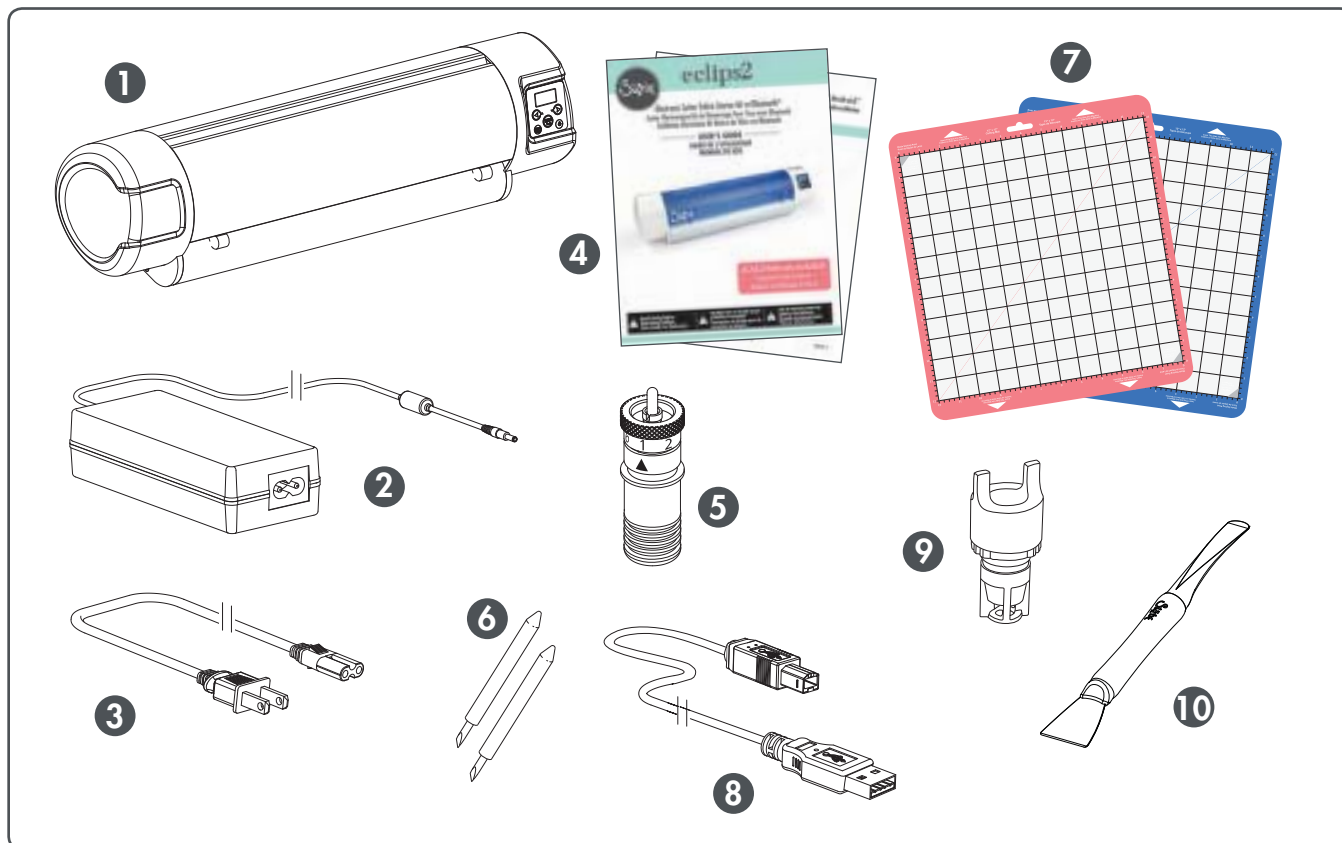

CONTENTS

- | | |
|--|---|
| <ol style="list-style-type: none"> 1. eclips®2 Electronic Cutter (26" x 6 1/2" x 7")
(Model # EC-C1400) Bluetooth® 2. Universal Power Supply 3. Power Cord 4. eclips®2 User's Guide and Bluetooth® Instructions 5. Blade Holder | <ol style="list-style-type: none"> 6. Blades, Standard, 2 Pack 7. (2) 12" x 12" Cutting Mats**:
(1) for fabric (Coral); (1) Standard (Blue) 8. 6ft USB 2.0 Cable 9. Pen Holder 10. Scraper |
|--|---|

To install eCAL2 Software for your new eclips®2 Electronic Cutter:

1. Go to <http://www.sizzix.com/eCAL2>
2. Enter your Email Address and serial number below. Click the SUBMIT button.
3. Click the Windows® or Mac® link to download the eCAL2 software.
4. Open up the eCAL2 installer on your computer and follow the Setup Wizard instructions.

5. After successfully ACTIVATING eCAL2 software on your computer*, connect the eclips2 Electronic Cutter to your computer using the enclosed Bluetooth instructions.

*If your software doesn't activate, go to www.craftedge.com.

**12" x 24" Cutting Mats also available (sold separately). Visit sizzix.com to see a complete selection of available accessories.

SET UP

CONNECTING

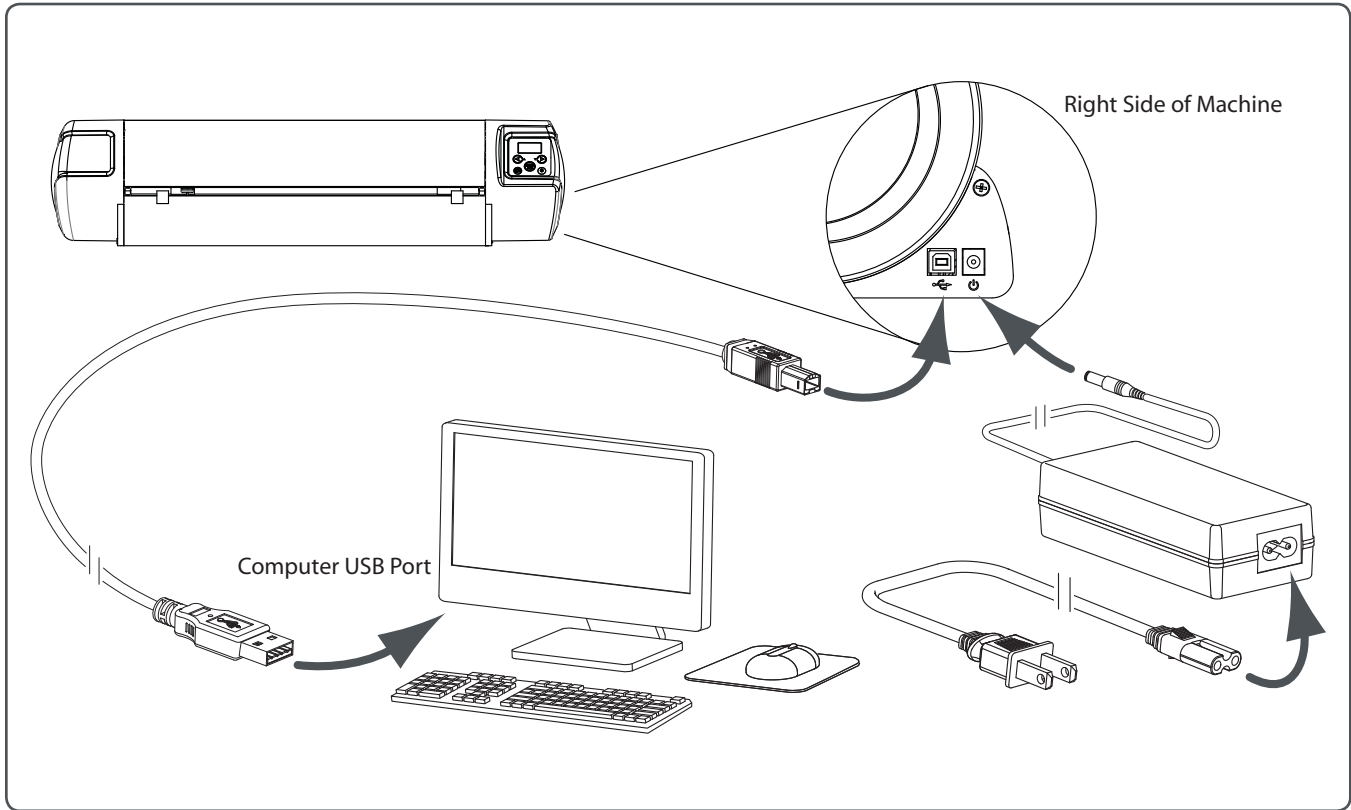

1. Plug Power Cord into Universal Power Supply.
2. Plug Universal Power Supply into side of eclips[®]2 Machine.
3. See Bluetooth[®] Instructions or for USB connection:
 1. Plug USB cable into back of eclips2 Machine.
 2. Plug flat end of USB cable into USB port of computer.

SETTING THE BLADE DEPTH

NOTICE DO NOT adjust blade depth while Machine is operating.

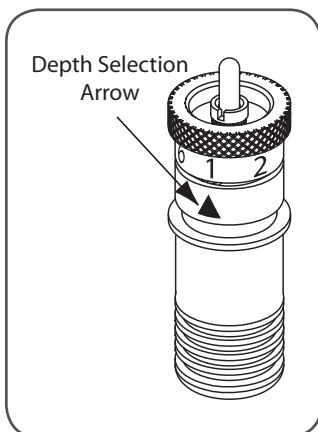

Printed on a ring around the Blade Holder Top are Blade Depth Settings, ranging from 1 to 6. These numbers can be selected individually by setting the Depth Selection Arrow on the number relative to the material you will be cutting.

As a general rule, thinner materials, such as cotton fabric, paper and vinyl, require a lower number Blade Depth Setting, while thicker materials, such as fabric with iron-on backing, light chipboard and heavy cardstock, require a higher number Blade Depth Setting. For optimal results, try a test cut and make the necessary adjustments to the settings before performing the final cut.

**✓ Lower Number for Thinner Material
Higher Number for Thicker Material**

INSERTING THE BLADE INTO THE BLADE HOLDER



CAUTION: CUTTING HAZARD Blade is sharp, handle with care.

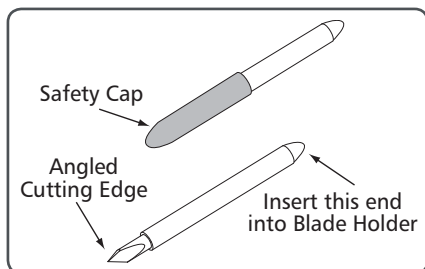

- 1 Carefully remove Safety Cap from Blade, exposing Angled Cutting Edge.

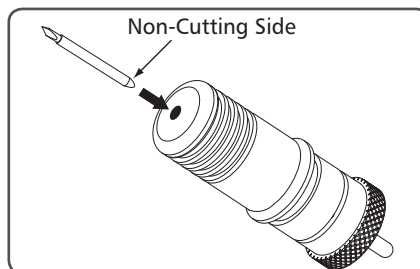

- 2 Carefully insert Non-Cutting Side of Blade into hole at bottom of Blade Holder. Blade is held in place magnetically.

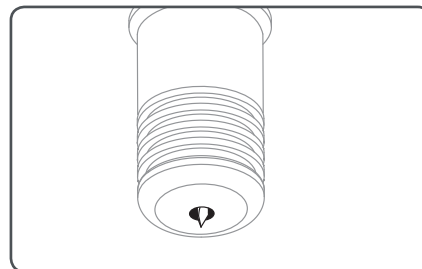

- 3 Note that Blade is exposed, but barely visible, when inserted properly.

INSTALLING THE CUTTING BLADE HOLDER



WARNING: MOVING PARTS Keep fingers, hair and clothing away.



CAUTION: Always unplug Machine before removing or installing Blade Holder.



CAUTION: CUTTING HAZARD Keep fingers away from exposed blade.

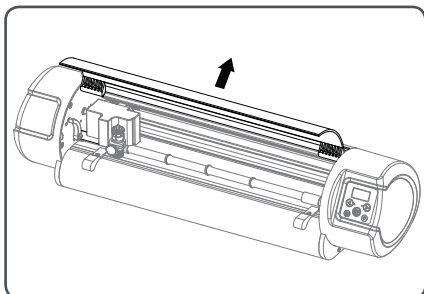

- 1 Lift open Machine Cover to expose Carriage and Blade Holder Clamp.

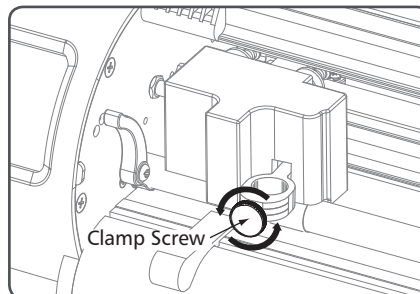

- 2 Loosen Clamp by turning Clamp Screw counterclockwise, approximately 1/4 of a turn. **IMPORTANT:** Spring on end of Clamp Screw **MUST** be kept in place.

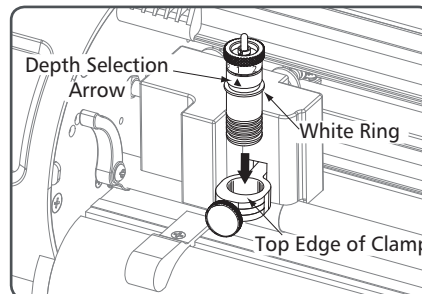

- 3 Place Blade Holder into Clamp, making sure that Depth Selection Arrow is facing out.

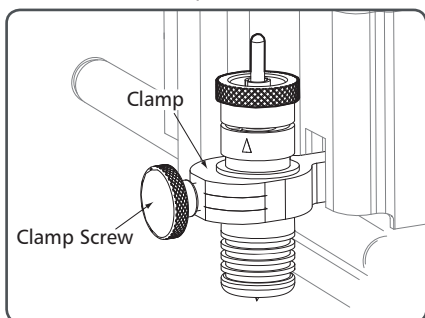

- 4 Tighten Blade Holder by turning the Clamp Screw clockwise, until Blade Holder is secure.

WORKSPACE

PLACEMENT

Leave 12 to 24 inches of clear space behind your eclips² Machine to allow full Cutting Mat movement.
Place your eclips² Machine at least 12 inches from the edge of your work surface to prevent it from tipping over and causing possible injury.

ENVIRONMENT

Place eclips² Machine on a clean, level, dry and sturdy surface.

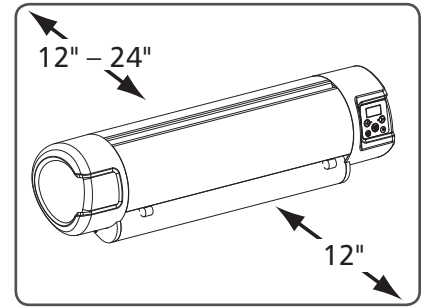

STARTING THE MACHINE

NOTICE

DO NOT unplug USB cable from computer while Machine is in use.
This will cause loss of data.

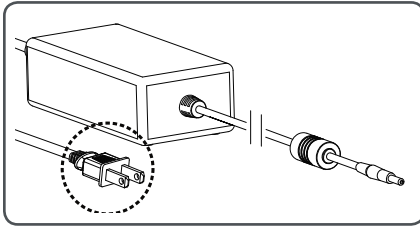

1 Plug Power Cord into wall outlet. Plug the other end into your eclips² Machine.

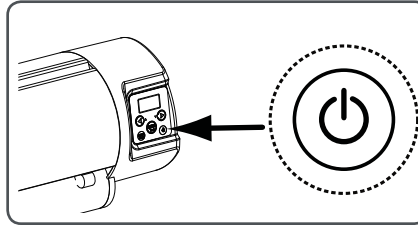

2 Press Power button (front of Machine shown). Unplug Machine when not in use.

✓ Pressing Power button again will turn the Machine OFF.

CUTTING MATS

■ PLACING MATERIAL ON THE CUTTING MAT

✓ Only use fabric on Coral color fabric Cutting Mat.

✓ Replace plastic cover on Cutting Mat when not in use.

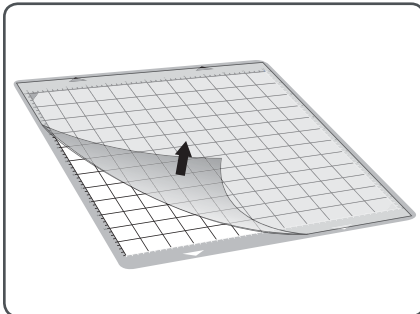

1 Peel back and remove plastic cover from Cutting Mat.

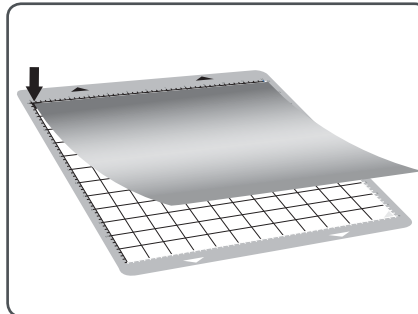

2 Align material to be cut with top-left edge of Cutting Mat. Press evenly into place.

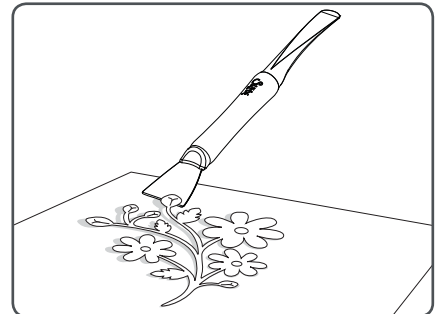

3 When removing more intricate shapes from Cutting Mat, an eclips Die Pick or Scraper is recommended.

■ LOADING THE CUTTING MAT INTO THE MACHINE



WARNING: MOVING PARTS Keep fingers, hair and clothing away.

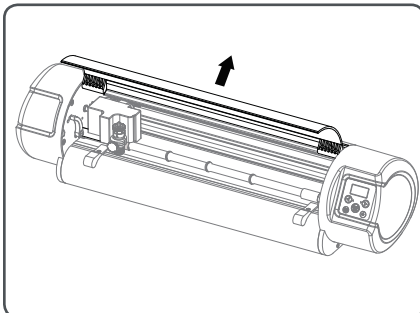

1 Open cover (Cutting Mat can also be loaded with Machine cover closed.)

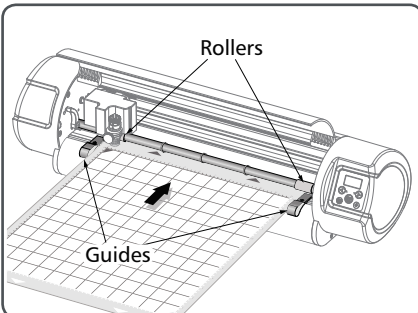

2 Place Cutting Mat between Alignment Guides and insert into Machine until the leading edge touches the Rollers.

✓ Activate loading using eCAL software on your Computer.

MAINTENANCE

CUTTING BLADE MAINTENANCE

CLEANING THE CUTTING BLADE



CAUTION: Always unplug Machine before removing or installing Blade Holder.

After prolonged use, the Cutting Blade may not cut as precisely as it once did. To help prolong the life of the Cutting Blade, remove it from the Blade Holder and clean it with Isopropyl Alcohol (rubbing alcohol) poured onto a clean paper towel. Remove any material left inside the Cutting Blade Holder, using a Die Pick Tool.

Visit sizzix.com to see a complete selection of available accessories.

ADJUSTING THE CUTTING BLADE DEPTH



CAUTION: CUTTING HAZARD Blade is sharp, handle with care.



WARNING: CHOKING HAZARD Small parts. Keep away from children.

Printed on a ring around the Blade Holder Top are Blade Depth Settings, ranging from 1 to 6. These numbers can be selected individually by turning the wheel to the number relative to the material you are using. Refer to page 4 for more information about setting the Blade Depth.

REPLACING THE CUTTING BLADE



CAUTION: CUTTING HAZARD Keep fingers away from exposed blade.

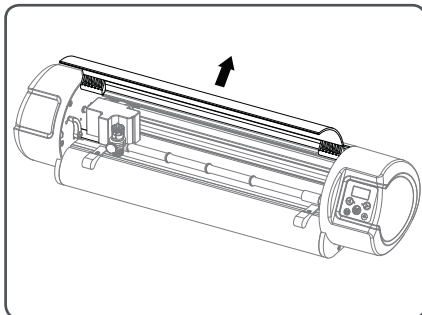

- 1 Lift open Machine Cover to expose Carriage and Blade Holder Clamp.

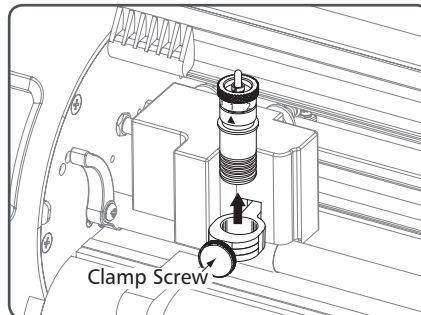

- 2 Loosen Blade Holder Clamp by turning Clamp Screw counterclockwise. Remove Blade Holder.

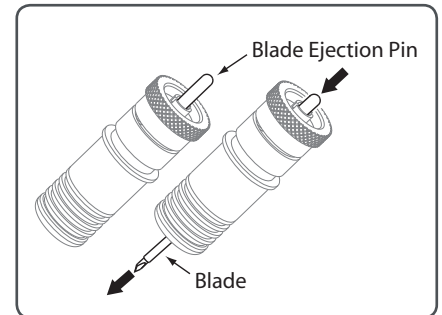

- 3 Push down on Blade Ejection Pin to reveal Blade. Carefully remove and discard used Blade.

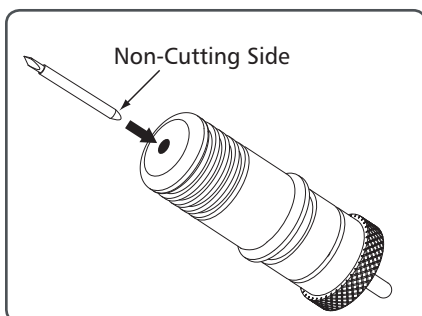

- 4 Carefully insert new Blade into hole at bottom of Blade Holder; Blade is held in place magnetically. Replace Blade Holder in Machine, as shown on page 5.

TROUBLESHOOTING

■ Problem: eclips[®]2 system will not turn on _____

- Unplug system from wall outlet before troubleshooting. Make sure all components and connectors are plugged in properly (see pg. 4). When everything is connected, plug system into wall outlet and press power ON (see pg. 6).

■ Problem: eclips2 Machine freezes up _____

- Turn off Machine and restart (see pg. 6).

■ Problem: Machine is not cutting with its usual pristine quality _____

- Your Cutting Blade may be worn and need replacing (see pg. 7).
- Make sure material to be cut was correctly selected in the eCAL application's cut settings.
- If you are using a material not listed, manually change the Speed, Pressure and Blade Depth using the eCAL application. Please note that not all materials will be compatible with the Machine.

■ Problem: Cutting Blade does not cut all the way through my material _____

- Make sure Cutting Blade is installed properly (see pg. 5).
- Make sure material to be cut was correctly selected in the eCAL application's cut settings.
- Increase cutting pressure or decrease cutting speed manually using the eCAL application. If Blade still does not cut through the chosen material, the Blade needs to be adjusted (see pg. 4) or replaced (see pg. 7).

■ Problem: The corners of my cutouts are wrinkled _____

Make sure you are using recommended materials with the correct eCAL settings. If you have confirmed this:

- Blade may need to be replaced for a sharper cut.
- Pressure setting may be too high (change to a lower number for lesser pressure).
- Cutting Mat may have lost its adhesion.
- Speed setting may be too fast (change speed to a slower, lower number).
- Blade Depth Setting may be too high (change Blade Depth to a lower number).

■ Problem: Machine is cutting outside of material _____

- Laser preview the image before you cut it to see how it will fit on the material. Make any necessary adjustments.

■ Problem: Material keeps shifting from its original position during cutting _____

- Fabric must be starched, stabilized, or have an iron-on backing before cutting.
- If your material is no longer adhering to the Cutting Mat, it is time to replace the Cutting Mat* or re-coat it with eclips Spray Adhesive (sold separately)*. Fabric mats will require 2 or 3 coats of Spray Adhesive.
- If you are using a material that has an adhesive side covered by a protective, slippery backing, turn the adhesive side face-up, so that the material can better adhere to the Cutting Mat. Be sure to use the Mirror feature to reverse the artwork to its proper orientation. Clean the cutting blade after use.

■ Problem: Material does not stick to Cutting Mat _____

- Remove clear protective sheet from Cutting Mat (see pg. 6). Using the eclips Scraper Tool, make sure all debris has been removed from the Cutting Mat. Align material to top-left corner of Cutting Mat and press evenly into place. If material will not stick to Cutting Mat, replace it or re-coat it with eclips Spray Adhesive (sold separately)*.

■ Problem: Cutout cannot be removed from Cutting Mat _____

- Use a tool, such as the eclips Scraper when removing cutouts from the Cutting Mat.

*For a complete selection of available accessories and replacement Cutting Mats, visit sizzix.com.

For latest updates to the User's Guide, please visit sizzix.com.

END USER LICENSE AGREEMENT

ECLIPS®2 ELECTRONIC CUTTER BY SIZZIX®

Ellison Educational Equipment, Inc., doing business as Sizzix® (“Sizzix”) is willing to grant to you a license to use the eclips®2 Electronic Cutter (the “Product”), subject to your acceptance of the following terms and conditions. Please read the terms of this Agreement carefully. Your use of the Product or any components will constitute acceptance of the terms of this Agreement. If you do not agree to these terms, you may not use the Product and you should contact Sizzix for instructions regarding the return of the Product.

1. License. Subject to the terms of this Agreement, Sizzix hereby grants you a non-exclusive, non-transferable, royalty-free, limited license to use the Product and any associated components, software, firmware and documentation for personal, non-commercial purposes solely in connection with the use of the Product for its intended purpose as described in the applicable documentation. You may assign this license only as part of a sale or transfer of the Product and all components, and only if the recipient agrees to comply with the terms of this Agreement. Your rights under this Agreement will terminate upon such assignment.

2. Restrictions. Except to the extent expressly permitted under applicable law, you may not reverse engineer, decompile, or otherwise attempt to make a copy of, or publish, the software, firmware or documentation included with the Product. Sizzix retains ownership of the Product design and associated software, firmware and documentation, together with all related intellectual

property rights, subject only to the limited rights granted to you in this Agreement. No right to use Sizzix, eclips2 or any other brand of Ellison Educational Equipment is granted under this Agreement. You agree to comply with all export laws and regulations applicable to the Product and its components.

3. Warranty. The product is subject to the Limited Warranties included in the Product documentation, which is hereby incorporated into this Agreement.

4. General. This agreement is governed by the laws of the State of California. All disputes relating to the Product or this Agreement shall be subject to the exclusive jurisdiction of the state and federal courts in Orange County, California. This Agreement is the entire agreement between you and Sizzix relating to the Product, and it supersedes any prior communications and any conflicting terms contained in any purchase order, quote or acknowledgment. No amendment to this Agreement shall be binding unless signed by Sizzix and you.

5. Contacting Sizzix. For Product inquiries, please contact:

North America:

sizzix.com

877-355-4766 toll-free in USA

949-598-8821 outside USA

Revised: 013116/T15_0195

WARRANTY

ECLIPS®2 ELECTRONIC CUTTER BY SIZZIX®

90-DAYS LABOR, ONE-YEAR PARTS LIMITED WARRANTY

What Does This Warranty Cover?

This Limited Warranty covers only manufacturing defects in material and workmanship in the hardware components of your eclips®2 Electronic Cutter (the "Product").

How Long Does The Warranty Last?

Labor: For a period of 90 days from the original date of purchase of the Product ("Labor Warranty").

Parts: For a period of 1 year from the original date of purchase of Product ("Parts Warranty"). You should retain your receipt as proof of purchase, which may be required in connection with obtaining warranty service.

What Will Sizzix Do?

Labor Warranty: Sizzix will, at our option, repair or replace with new or refurbished product or parts, product determined to be defective. If Sizzix elects to replace the product after this Labor Warranty has expired but while the Parts Warranty below is still in effect, it will do so for the applicable labor charge.

Parts Warranty: Sizzix will supply new or refurbished replacement parts in exchange for parts determined to be defective.

"Refurbished" means a product or part that has been returned to its original specifications. In the event of a defect, these are your exclusive remedies. Any product or parts replaced under this Limited Warranty will become the property of Ellison Educational Equipment, Inc. ("Sizzix").

What Does This Warranty Not Cover?

It does not cover technical assistance for hardware, firmware or software usage and it does not cover any software products, whether or not contained in the Product. Any such software is provided "AS IS". Please refer to the End User License Agreement included with the Product for your rights and obligations with respect to the software. Further, this Limited Warranty does not cover damages or defects caused by misuse or abuse of the Product; modification of or to any part of the Product; use of any third-party software, firmware and/or hardware with

the Product; acts of God; limitations of technology; or use of the Product for commercial, rather than personal, applications. The cutting blades, blade housing, cutting mat and any accessories are also excluded from this Limited Warranty. Opening any of the Product housing or tampering with the Notice label on the underside of the housing will automatically void the warranty.

Disclaimers. SIZZIX SHALL NOT BE LIABLE FOR CONSEQUENTIAL AND INCIDENTAL DAMAGES, DAMAGES FOR BODILY INJURY (INCLUDING DEATH) AND DAMAGE TO PROPERTY. THE DURATION OF ANY IMPLIED WARRANTIES SHALL BE LIMITED TO THE DURATION OF THE EXPRESS WARRANTY SET FORTH ABOVE. SOME STATES DO NOT ALLOW THE EXCLUSION OR LIMITATION OF INCIDENTAL OR CONSEQUENTIAL DAMAGE, DAMAGES FOR PERSONAL INJURY OR THE LENGTH OF IMPLIED WARRANTIES, SO THESE LIMITATIONS MAY NOT APPLY TO YOU. THIS WARRANTY GIVES YOU SPECIFIC LEGAL RIGHTS AND YOU MAY ALSO HAVE OTHER RIGHTS, WHICH VARY FROM STATE TO STATE.

How Do You Get Warranty Service?

If you believe that there is a manufacturing defect in material and workmanship in the hardware components packaged with your Product during the Limited Warranty Period, please contact Sizzix Customer Relations at the following telephone number or website:

North America:

sizzix.com

877-355-4766 toll-free in USA

949-598-8821 outside USA

A Return Authorization (RA), along with shipping information, will be issued. Following a determination by Sizzix that a fault covered by this Limited Warranty may have occurred, Sizzix will: (a) ship you replacement parts or (b) ship you a replacement Product. Product not covered by this Limited Warranty will be returned at your expense.

The device has been evaluated to meet general RF exposure requirement.

The device can be used in portable exposure condition without restriction.

Changes or modifications not expressly approved by the party responsible for compliance could void your authority to operate the equipment.