

User Manual

Rootzone sensor – M/US

RZ001

The Rootzone sensor is part of a sensor platform that contains a number of sensors and enables growers to read out data from their growing rooms in data on an app or in graphs on their desktop or laptop. The platform is aimed for the North American market – US and Canada

For onboarding the sensor in the platform, please download the “Companion” App from the Apple App Store or Google Play Store.



App: Companion
Owner: ROCKWOOL International A/S

Follow the instructions in the app to configure and connect the sensor.

1 Placement

1A 1B

- Place sensor 8 – 10 cm left from the 2nd block from the drain hole.
- Distance 1st to 2nd block, always more than 2/3 – 1/3 if blocks are close to each other, minimum 5 cm.
- Antenna, by placing sensor always furthest away from the block.

2A 2B

In case, sensor over the width is on a slope, place sensor at the lowest site of the slab.

Setting the support plate for different slab heights of the GroSens sensor.

For all slabs with a height of 7,5 cm. The support plate must be placed in the standard (lowest) position, see picture.



For all slabs with a height of 10 cm. The support plate must be placed in the upper (highest) position, see picture.

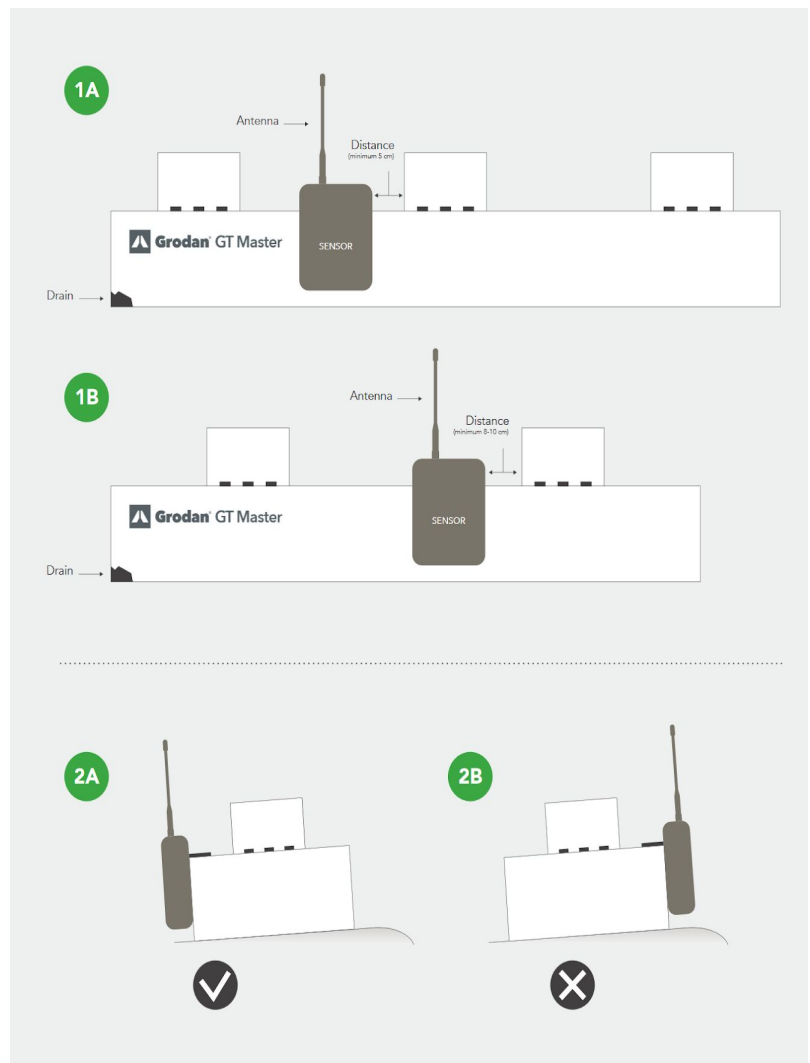

2 Radio Frequency - declaration of Conformity

North America

FCC Declaration of Conformity (for USA)

This device complies with part 15 of the FCC Rules. Operation is subject to the following two conditions: (1) This device may not cause harmful interference, and (2) this device must accept any interference received, including interference that may cause undesired operation.

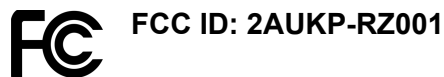

NOTE: This equipment has been tested and found to comply with the limits for a Class A digital device, pursuant to part 15 of the FCC Rules. These limits are designed to provide reasonable protection against harmful interference when the equipment is operated in a commercial environment. This equipment generates, uses, and can radiate radio frequency energy and, if not installed and used in accordance with the instruction manual, may cause harmful interference to radio communications. Operation of this equipment in a residential area is likely to cause harmful interference in which case the user will be required to correct the interference at his own expense

The provided antenna must be used with this unit to ensure compliance.

Canada

Industry Canada Declaration of Conformity

This device complies with Industry Canada licence-exempt RSS standard(s). Operation is subject to the following two conditions: (1) this device may not cause interference, and (2) this device must accept any interference, including interference that may cause undesired operation of the device.

Le présent appareil est conforme aux CNR d'Industrie Canada applicables aux appareils radio exempts de licence. L'exploitation est autorisée aux deux conditions suivantes: (1) l'appareil ne doit pas produire de brouillage, et (2) l'utilisateur de l'appareil doit accepter tout brouillage radioélectrique subi, même si le brouillage est susceptible d'en compromettre le fonctionnement

IC ID: 25447-RZ001

3 Product Details

Applicable Product Number: Rootzone sensor – M/US (RZ001)

LoRa

Operating Frequency Range: 902-915 MHz (900 MHz ISM band)

Maximum Output Power: 16.10 dBm (40.7 mW) (radiated)

BLE

Operating Frequency Range: 2402-2480 MHz (2.4 GHz ISM band)

Maximum Output Power: 6.21 dBm (4.2 mW) (radiated)

Power

Operating voltage: 6V DC (4 Alkaline batteries 1.5V)

Standby current: 20-30 uA

Operating current: 120 mA Maximum, 8 mA Typical

4 Warranty

For Warranty information, please contact our Customer Service Departments.

*Roxul Inc. - Grodan 8024 Esquesing Line
Milton ON L9T 6W3
Canada*

Phone : (1) 905 636 0611