

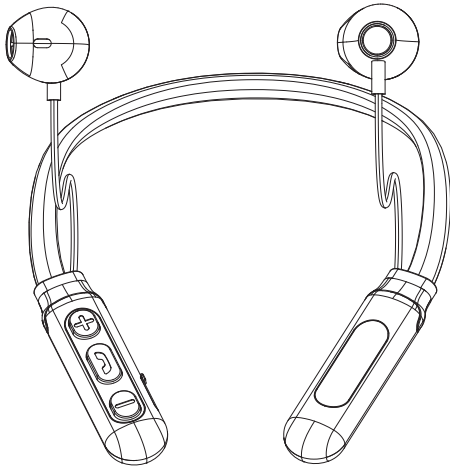

Instruction Manual



Bluetooth Neckband
MODEL:BE-190

FCC ID: 2AUJJ-BE-190

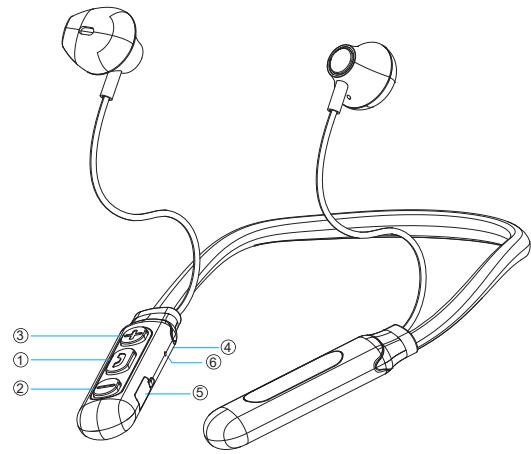

1. ON/OFF / Answer Call / Play/Pause
2. Previous Track / Volume -
3. Next Track / Volume +
4. LED Indicator Light
5. Charging Port
6. Microphone

Charging Your Headset

Your headset have a built-in, rechargeable lithium ion battery. To avoid damage, do not attempt to remove the battery. The full performance of the battery is only achieved after a few charging-discharging cycles. Charge the battery fully before first use. To do so, follow the steps below:

1.Connect one end of the included Micro USB charging cable to the charging port on your headset. Then plug the other end of the charging cable into a USB port on your computer or a suitable power adapter in order to recharge the internal rechargeable battery.

NOTE: The internal battery of your headset takes approximately two hours to charge when completely drained.

2.When the battery is charging, the LED indicator light will turn red. The LED indicator light will turn blue when the battery is fully charged. Unplug when charging is complete.

NOTE: Overcharging could reduce the life of the battery. A charged battery will lose its capacity if it is not used on a regular basis.

Important:

To avoid a complete discharge of the battery, charge your headset at least once every six months.

Pairing Your Headset with a Bluetooth Device

Your headset can be paired with most Bluetooth devices including iPads, iPhones, iPod Touches, and most smartphones, laptops and tablets. In order to pair your headset with a phone, follow the steps below:

- 1.Press and hold the ON/OFF button in order to power on your headset. Once your headset is powered on, the LED indicator light will alternately blink red and blue. This indicates that your headset is in pairing mode.
- 2.Go to the Bluetooth Manager of your Bluetooth device.
- 3.Search Bluetooth devices and select "Bolt4 BE-190" to start connecting.
- 4.Enter "0000" if your device asks for the PIN code.
- 5.Once paired, the LED indicator light will stop blinking and steadily shine blue. Note that anytime music is playing, the light will slowly blink blue every few seconds.

Using Your Headset

Powering Your Headset On and OFF

1.Press and hold the ON/OFF button in order to power on your headset. If you have paired your headset to your Bluetooth device previously, they will automatically remain paired everytime you power on your headset.

2.Press and hold the ON/OFF button in order to power off your headset.

Listening to Music

- Play/Pause Button : Press to play or pause a track.
- Press and hold the "NEXT TRACK/VOLUME UP" button to advance to the next song in a playlist.
- Press and hold the "PREVIOUS TRACK/VOLUME DOWN" button to go back to the previous song in a playlist.
- Quickly tap the "NEXT TRACK/VOLUME UP" button to increase the volume.
- Quickly tap the "PREVIOUS TRACK/VOLUME DOWN" button to decrease the volume.

Using the Phone Function

- Last Number Re-dial: Double tap the answer call button to re-dial the last number called.
- Answering a Call: Quickly press the answer call button to answer an incoming call.
- Reject an Incoming Call: Press and hold the answer call button to reject an incoming call.
- Ending a Call: Quickly press the answer call button to end a call.

One Year Limited Warranty

BOLT4, LLC sells its products with the intent that they are free of defects in manufacture and workmanship for a period of one year from the date of original purchase, except as noted below. BOLT4, LLC warrants that its products will be free of defects in material and workmanship under normal use and service. This warranty extends only to consumers and does not extend to Retailers.

To obtain warranty service on your BOLT4, LLC product, contact a Consumer Relations Representative by email at info@bolt4.com for assistance. Please make sure to have the model number of the product available.

BOLT4, LLC does not authorize anyone, including, but not limited to, Retailers, the subsequent consumer purchaser of the product from a Retailer or remote purchasers, to obligate BOLT4, LLC in any way beyond the terms set forth herein. This warranty does not cover damage caused by misuse or abuse; accident; the attachment of any unauthorized accessory; alteration to the product; improper installation; unauthorized repairs or modifications; improper use of electrical/power supply; loss of power; dropped product; malfunction or damage of an operating part from failure to provide manufacturer's recommended maintenance; transportation damage; theft; neglect; vandalism; or environmental conditions; loss of use during the period the product is at a repair facility or otherwise awaiting parts or repair; or any other conditions whatsoever that are beyond the control of BOLT4, LLC.

This warranty is effective only if the product is purchased and operated in the country in which the product is purchased. A product that requires modifications or adoption to enable it to operate in any other country than the country for which it was designed, manufactured, approved and/or authorized, or repair of products damaged by these modifications is not covered under this warranty.

THE WARRANTY PROVIDED HEREIN SHALL BE THE SOLE AND EXCLUSIVE WARRANTY. THERE SHALL BE NO OTHER WARRANTIES EXPRESS OR IMPLIED INCLUDING ANY IMPLIED WARRANTY OF MERCHANTABILITY OR FITNESS OR ANY OTHER OBLIGATION ON THE PART OF THE COMPANY WITH RESPECT TO PRODUCTS COVERED BY THIS WARRANTY. BOLT4, LLC SHALL HAVE NO LIABILITY FOR ANY INCIDENTAL, CONSEQUENTIAL OR SPECIAL DAMAGES. IN NO EVENT SHALL THIS WARRANTY REQUIRE MORE THAN THE REPAIR OR REPLACEMENT OF ANY PART OR PARTS WHICH ARE FOUND TO BE DEFECTIVE WITHIN THE EFFECTIVE PERIOD OF THE WARRANTY. NO REFUNDS WILL BE GIVEN. IF REPLACEMENT PARTS FOR DEFECTIVE MATERIALS ARE NOT AVAILABLE, BOLT4, LLC RESERVES THE RIGHT TO MAKE PRODUCT SUBSTITUTIONS IN LIEU OF REPAIR OR REPLACEMENT.

This warranty does not extend to the purchase of opened, used, repaired, repackaged and/or resealed products, including but not limited to sale of such products on Internet auction sites and/or sales of such products by surplus or bulk resellers. Any and all warranties or guarantees shall immediately cease and terminate as to any products or parts thereof which are repaired, replaced, altered, or modified, without the prior express and written consent of BOLT4, LLC.

This warranty provides you with specific legal rights. You may have additional rights which may vary from state to state and country to country. Because of individual state and country regulations, some of the above limitations and exclusions may not apply to you.

FCC Warning Statement

Changes or modifications not expressly approved by the party responsible for compliance could void the user's authority to operate the equipment. This equipment has been tested and found to comply with the limits for a Class B digital device, pursuant to Part 15 of the FCC Rules. These limits are designed to provide reasonable protection against harmful interference in a residential installation. This equipment generates uses and can radiate radio frequency energy and, if not installed and used in accordance with the instructions, may cause harmful interference to radio communications. However, there is no guarantee that interference will not occur in a particular installation. If this equipment does cause harmful interference to radio or television reception, which can be determined by turning the equipment off and on, the user is encouraged to try to correct the interference by one or more of the following measures:

- - Reorient or relocate the receiving antenna.
- - Increase the separation between the equipment and receiver.
- - Connect the equipment into an outlet on a circuit different from that to which the receiver is connected.
- - Consult the dealer or an experienced radio/TV technician for help.

This device complies with part 15 of the FCC Rules. Operation is subject to the following two conditions: (1) This device may not cause harmful interference, and (2) this device must accept any interference received, including interference that may cause undesired operation.