

# Smart Light Strip



## Package Contents

- 1 × RGB+White LED Strip
- 1 × Wi-Fi Controller
- 1 × IR Remote
- 1 × User Manual

## Connection

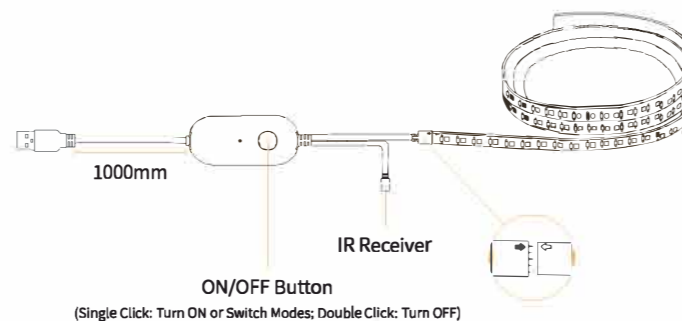

**Warm Tips:** Long press the ON/OFF button on the controller till the strip light flashing to enter the pairing mode and reach more APP functions;

### Note:

- Required Power: 5W (USB 5V, 1A)  
Please note that few Sony TV USB ports can't sync power off with the TV, if then, please turn the lights off with the remote.
- Please keep the IR Receiver visible when installing.
- Ensure the connection is right before powering.

## IR Remote Control

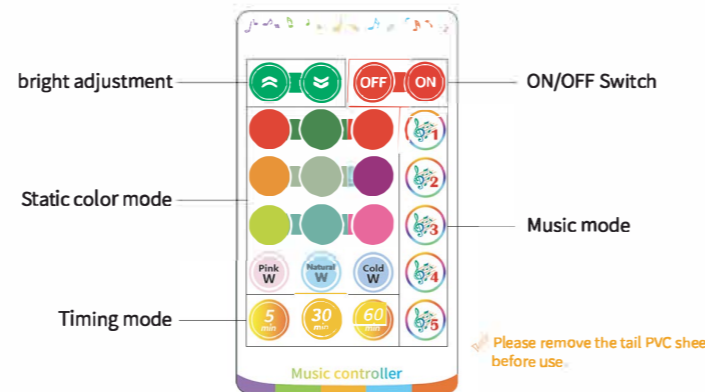

Features	Operation	Buttons	Phenomenon
ON/OFF	Short press	OFF ON	ON/OFF
Adjustment	Short press	[Brightness Up/Down]	Increase or decrease brightness
	Long press	[Brightness Up/Down]	Increase or decrease brightness quickly
Static color	Short press	[Color Buttons]	Display the corresponding color light
White light	Short press	[Pink W, Natural W, Cold W]	Pink/natural white/blue and white
Timing	Short press	[5, 30, 60]	Turn off the light regularly, receive the signal, the light flashes once, press and hold the timer button for more than 5 seconds, the light flashes twice (timed release)
Music	Short press	[Music Mode Buttons]	Music mode 1, 2, 3, 4, 5

## APP Control

### 1. Download APP

Search "Smart Life" from App store or Google play.



Or scan the QR code to download APP



Android 4.1  
ios 8.1

The App is compatible with Android 4.1 and ios 8.1 and higher version.

### 2. Log in/Register Account

Open the Smart Life APP, sign up for a new account or log in with an existing account.

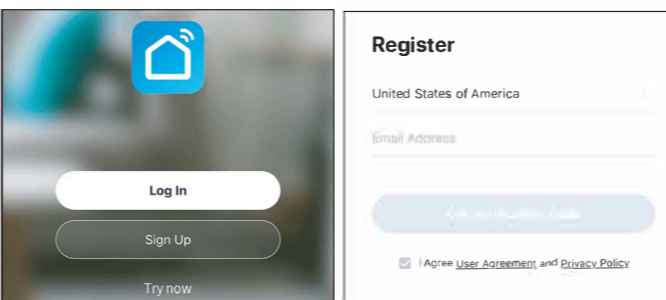

**IMPORTANT:** When you're connecting the LED strip to Alexa, make sure you enter the same account to ENABLE the skill of "Smart Life".

### 3. Add Device [Add Manually]

Before connecting, please make sure your smart phone or device is connecting with your home Wi-Fi 2.4GHz successfully.

#### I . Auto Scan

--- Please open the phone BLE+Wi-Fi, ensure that the device is ready for network connection.

#### II . Add Manually

##### a. Simple Method: EZ Mode (Recommend)

--- Reset the LED strip by long pressing reset button for more than 5 seconds to reach EZ Mode. Ensure the light flashing quickly [2 times per second].

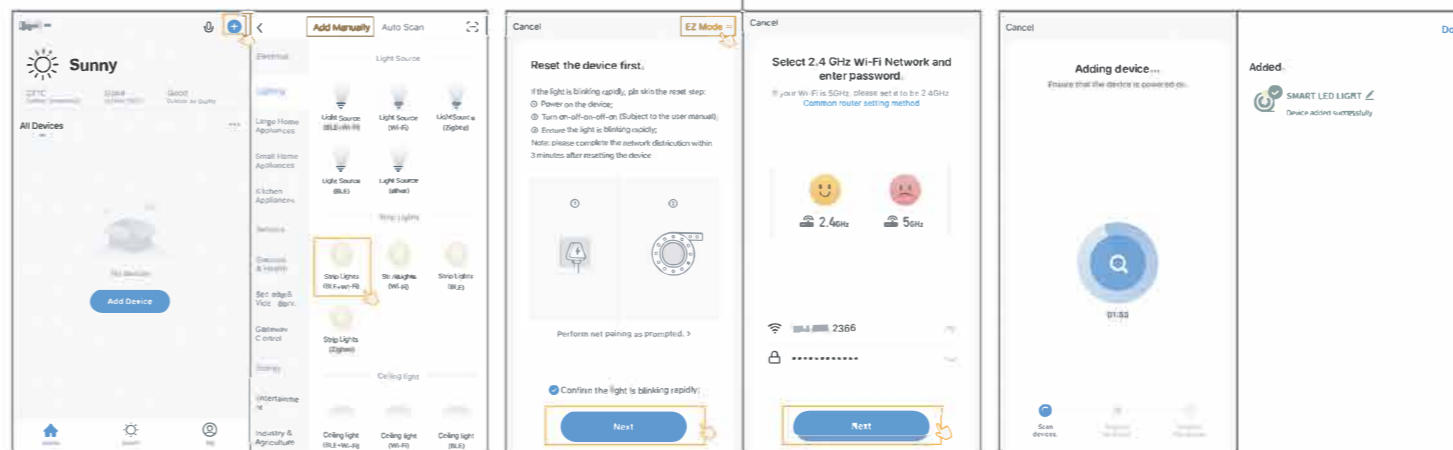

#### STEP 1

Enter the app, click "+" and select "lighting" - "Strip Lights (BLE+ Wi-Fi)".

#### STEP 2

Ensure the lights is now flashing rapidly, 2x per second, meaning the device is ready to connect. Then input the Wi-Fi password. The equipment connected to the internet.

#### STEP 3

The app will try to connect your device; Distribution network success. Re-name the device, and done jump to the user panel;

#### b. Backup Method: AP Mode

If you have problems to connect the device to your Wi-Fi, please try this mode.

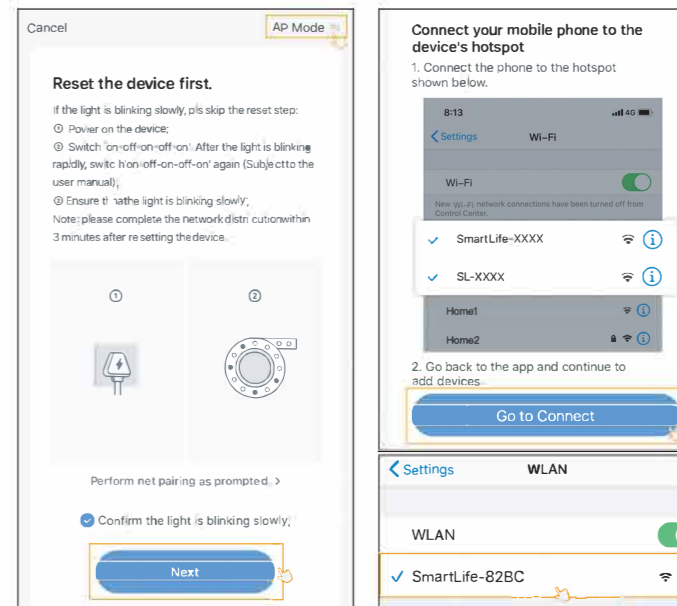

#### STEP 1

Select AP Mode on the top corner of the screen.

Reset the LED strip by long pressing reset button for more than 5 seconds until the lights flashing slowly, to reach AP Mode. Ensure the LEDs blinking slowly [blink, every 3 seconds]. indicating the device is ready to connect. Then input the Wi-Fi password.

#### STEP 2

Click and connect the device's hotspot, Wi-Fi name is like "SmartLife-XXXX" or "SL-XXXX", then go back to the APP and add devices.

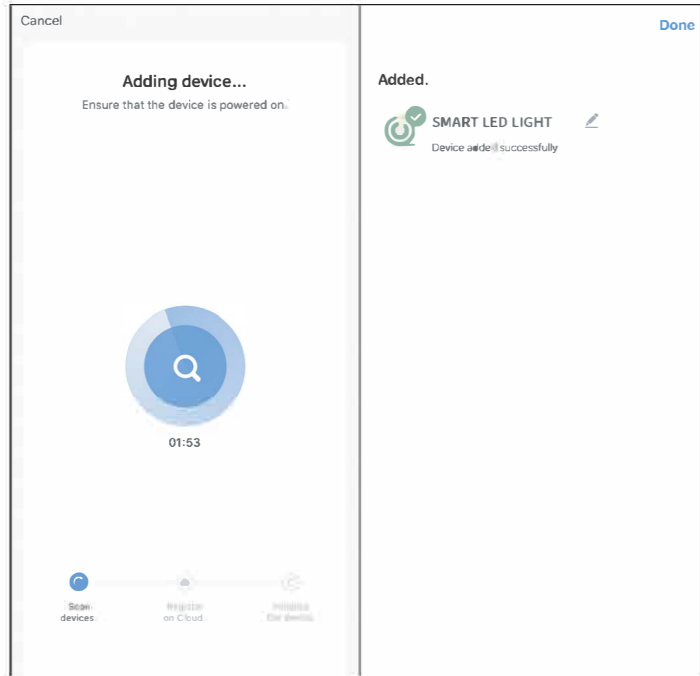

**STEP 3**  
The app will try to connect your device;  
The device added successfully, and you may re-name the device, to more convenience,  
you can easily use voice to control the strip through Amazon Alexa or Google Assistant.

#### 4. Support 3<sup>rd</sup> Party Control

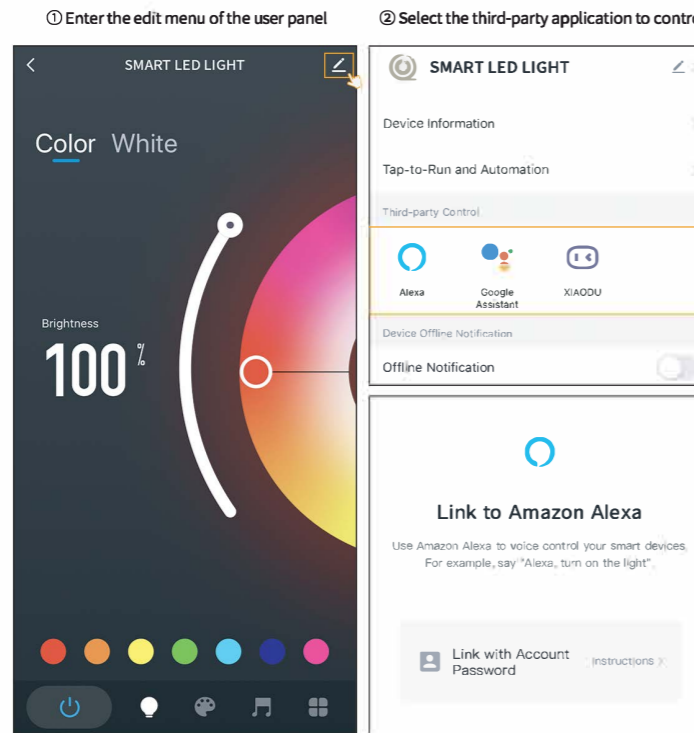

① Enter the edit menu of the user panel

② Select the third-party application to control

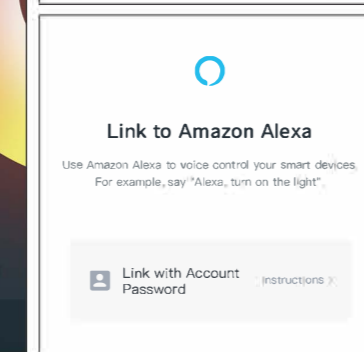
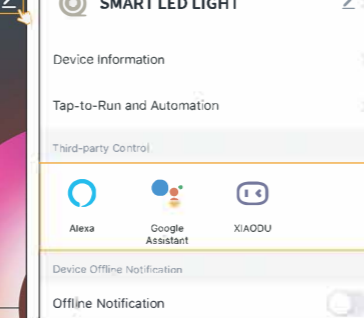

③ Follow the instruction in the tutorial to connect and use. APP for more functions, please refer to the corresponding application tutorial

#### User Panel Functions

1. In white light mode, the brightness and color temperature can be adjusted.
2. In RGB mode, you can adjust any color under the RGB mixing mode, and adjust the brightness and saturation.

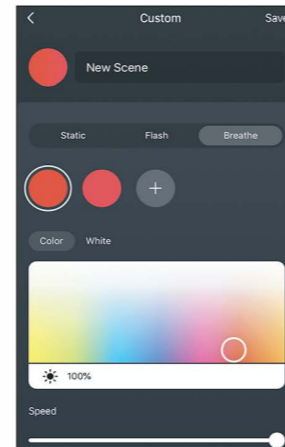
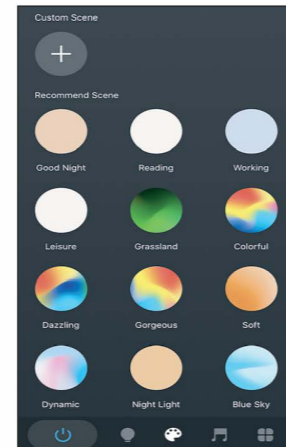

3. In the scene mode, there can be multiple scene mode choices, and you can DIY suitable lighting by yourself. In the music mode, the device will change the light mode according to the rhythm of the sound.

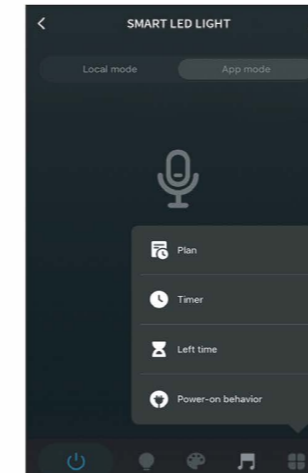
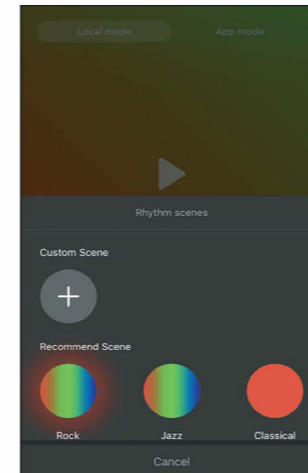
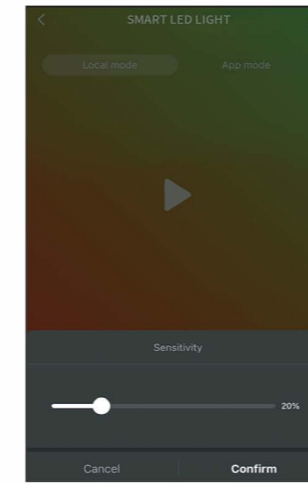
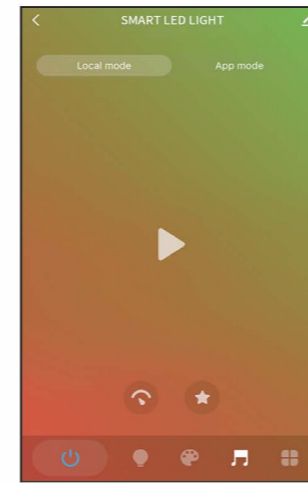

#### Plan Your Route

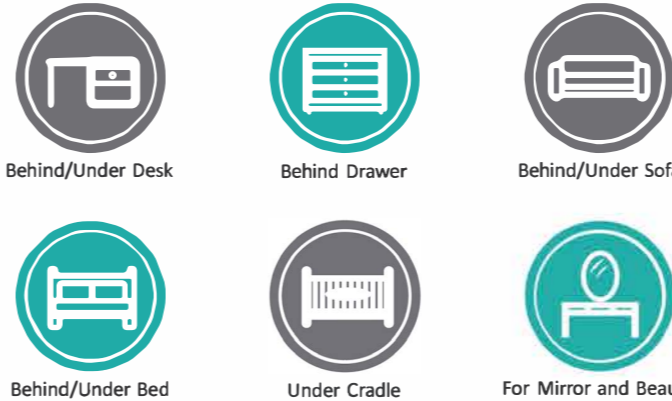

In addition to being installed on the back of the TV, the light can also be installed in cabinets, bed-sides or other places.

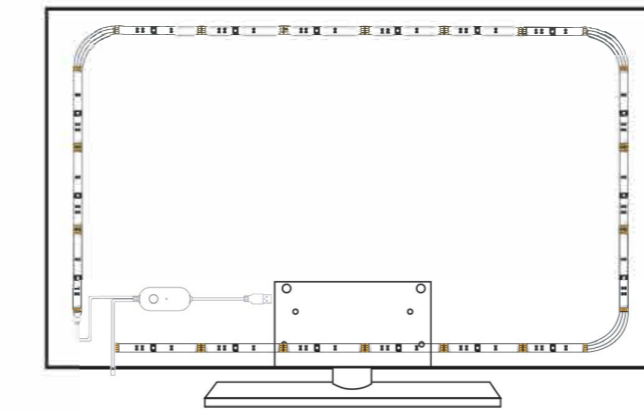

Customized design, can cover 4/4 sides of your TV.  
There are 4 pieces pre-cut strips, easily to go around the corners of your TV.

#### Troubleshooting

1. Why do the strip lights not connect with Wi-Fi?
  - 1) 2.4GHz internet only. Please check your Wi-Fi type. Please set a different SSID for the 2.4G Wi-Fi and 5G Wi-Fi, if you have a dual-band router.
  - 2) The Wi-Fi signal should be strong. Please take the LED light strip closer to the router or reboot your router, and also ensure there is stable private Wi-Fi internet.
  - 3) Complicated Wi-Fi name and password. Type in the correct Wi-Fi password. Please set the Wi-Fi letters and Arabic numbers only.
  - 4) Smart phone operation system is iOS 8.1 or Android 4.1 and higher.
  - 5) A very few smart phones, even they are iOS 8.1 or Android 4.1 and higher, they may still not be connecting with the light strip. How to fix it?

1) Please prepare 2 smart phones, set one of them as a Wi-Fi hotspot, and download the smart home app on the other phone, try to connect the light strip with these phones. Please make sure that the hotspot is set to 2.4GHz, and hotspot password letters and numbers only.

#### 2. The device is offline or unreachable.

- Make sure your Wi-Fi router is online and in range
- Make sure you have the latest Smart Life, by clicking "Me" - "Setting" - "About" - "Check for Updates"
- Make sure the Wi-Fi password has not been changed.

#### 3. Light strip falls down.

The strip is made of very strong foam tape. Please clean the mount surface, keep it free from dust and oil, the tape will hold the light strip for years.

#### Attention:

1. Test the light before installation.
2. Read the user manual carefully before use.
3. Stick the strip on TV back or suitable surface, not on dusty wall, forested glass, and so on.
4. Please do not use this product in the water or humid environment.
5. The led strip must be unplugged while making any modifications to the device.

#### Need Any Support? Message us!

Please find us customer-care team on the cable sticker of led strip, and we will respond within 12 hours, thanks

**FCC Statement**  
This equipment has been tested and found to comply with the limits for a Class B digital device, pursuant to part 15 of the FCC Rules. These limits are designed to provide reasonable protection against harmful interference in a residential installation. This equipment generates, uses and can radiate radio frequency energy and, if not installed and used in accordance with the instructions, may cause harmful interference to radio communications. However, there is no guarantee that interference will not occur in a particular installation. If this equipment does cause harmful interference to radio or television reception, which can be determined by turning the equipment off and on, the user is encouraged to try to correct the interference by one or more of the following measures:  
•Reorient or relocate the receiving antenna.  
•Increase the separation between the equipment and receiver.  
•Connect the equipment into an outlet on a circuit different from that to which the receiver is connected.  
•Consult the dealer or an experienced radio/TV technician for help.  
Caution: Any changes or modifications to this device not explicitly approved by manufacturer could void your authority to operate this equipment.  
This device complies with part 15 of the FCC Rules. Operation is subject to the following two conditions: (1) This device may not cause harmful interference, and (2) this device must accept any interference received, including interference that may cause undesired operation.

**RF Exposure Information**  
This equipment complies with FCC radiation exposure limits set forth for an uncontrolled environment. This equipment should be installed and operated with minimum distance 20cm between the radiator and your body.