

LED Floor Light User Manual

Features



16 million colors, RGB+IC dream color lighting.



Multiple control ways available, can be controlled by controller's switch button, IR remote and APP.



Support music sync function and various music modes available.



Voice controllable by third-party intelligent speaker like Alexa and Google Assistant etc.



180° beam angle, larger lighting area.



5V USB power supply, low power consumption, safe and energy saving.

Product Parameters

Dimension	30*1250mm
Material	ABS+PVC
Working voltage	DC 5V
Rated power	4.5W
Communication protocol	Wifi(IEEE 802.11a/b/g/n)+BLE
Product function	Dream color, Music sync
Switch button function	ON/OFF switch, Modes adjustment,
APP control	Smart Life(Support various functions like brightness adjustment, music sync, mode switch and set timer etc.) 
IR remote control	Control distance: 0-5 meters
Voice control	Support third-party intelligent speaker like Alexa and Google Assistant etc.
Installation ways	Three-segment connection
Working environment	-20~40°C

Operation

Short press: Turn on the light, or modes adjustment

Long press: Turn off the light

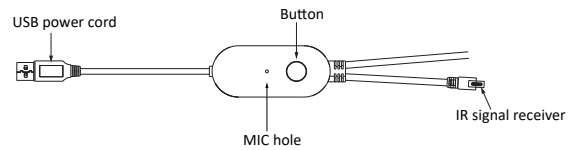

APP Operation

- 1) Download and install the APP of Smart Life, open your mobile phone's WiFi and BLE, long press the switch button for over 3 seconds to make the light into quick flash internet pairing mode. Search or add the device on the APP, and log in with the WiFi password to start internet pairing.
- 2) After pairing success, you can start to operate the APP to control the light to change colors, adjust brightness, change the modes, set timer and share your accounts etc.

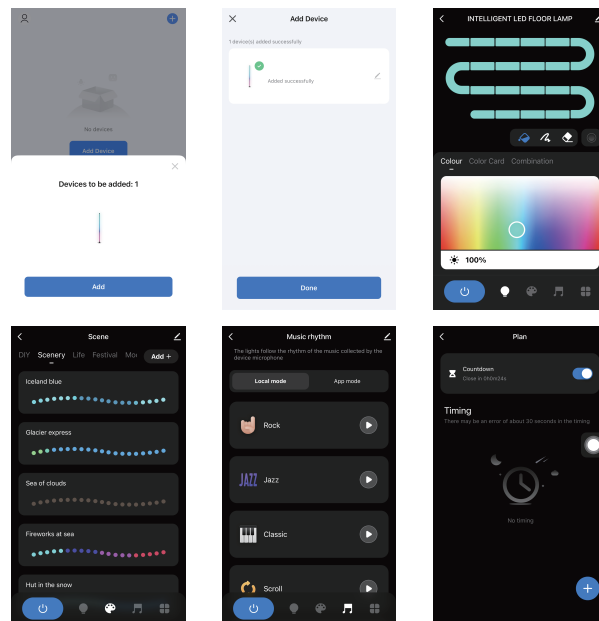

Voice control

Turn on the third-party intelligent speaker you want to connect like Alexa, Google Assistant etc. Make sure they connect to same WiFi, and go to the APP to search for the devices and get authorized, then you can voice control the lights with the standard command words.

Installation

1. Take the base, pass the power input cable of the light body through the base, twist the tail plug into the nut of the base.
2. Take one segment of the light and install the intermediate plug, then align it with the guide slot then plug int.(install all three segments of the light body with same way)
3. Clamp the first plug tightly to the top.
4. Plug the light body's connection cable into the controller tightly, plug in the 5V power supply and start using.

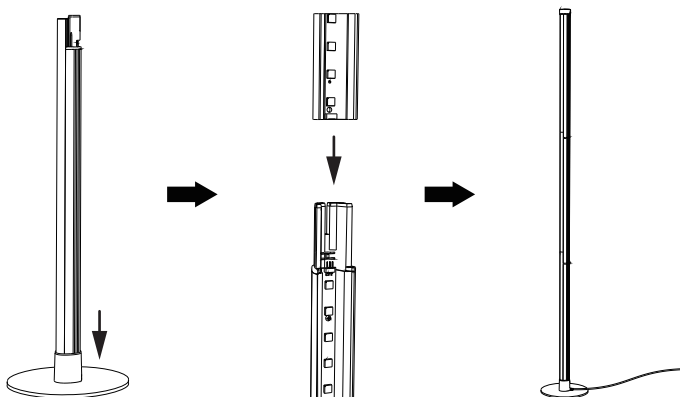

Remote controller operation

Power supply: 3V button cell

Control distance: 5-8 meters in open area

Remove the PVC film on the back of the remote controller before use, and press the power button before operation.



Features	Action	Remote control buttons
ON/OFF	Short Press	
Pause/beat	Short Press	
Speed/sensitivity	Short Press	
Dynamic mode switching	Short Press	
Music mode	Short Press	
Automatic mode	Short Press	
Brightness +/-	Short Press	
Static color switching	Short Press	
W R G B	Short Press	

FCC Statement

This device complies with Part 15 of the FCC Rules. Operation is subject to the following two conditions:

- (1) This device may not cause harmful interference.
- (2) This device must accept any interference received, including interference that may cause undesired operation.

2. Changes or modifications not expressly approved by the party responsible for compliance could void the user's authority to operate the equipment.
Note: This equipment has been tested and found to comply with the limits for a class B digital device, pursuant to Part 15 of the FCC Rules. These limits are designed to provide reasonable protection against harmful interference in a residential installation.

This equipment has been tested and found to comply with the limits for a Class B digital device, pursuant to part 15 of the FCC Rules. These limits are designed to provide reasonable protection against harmful interference in a residential installation. This equipment generates, uses and can radiate radio frequency energy and, if not installed and used in accordance with the instructions, may cause harmful interference to radio communications. However, there is no guarantee that interference will not occur in a particular installation. If this equipment does cause harmful interference to radio or television reception, which can be determined by turning the equipment off and on, the user is encouraged to try to correct the interference by one or more of the following measures:

- Reorient or relocate the receiving antenna.
- Increase the separation between the equipment and receiver.
- Connect the equipment into an outlet on a circuit different from that to which the receiver is connected.
- Consult the dealer or an experienced radio/TV technician for help.

This equipment should be installed and operated with a minimum distance of 20 cm between the radiator and your body