

Pro 3D Printer

Quick Start Guide

Congratulations!

In this brief guide, we're going to show you how to set up and make your first model on the new SprintRay Pro Desktop 3D Printer.

Your purchase comes with a complimentary, live training session with one of our technicians. For advanced users, see our website for tips & tricks.

We're so excited to see what you make!

Training and Support

Sign up for free training and contact our support team with questions.

Visit support.sprinray.com
Call 800-914-8004
Email support@sprinray.com

1 In the Box

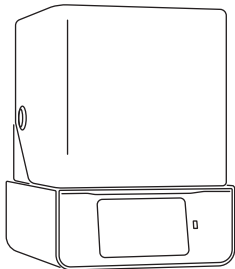

Pro 3D Printer

The print platform and resin tank are pre-installed and have a protective film that must be removed prior to first use.

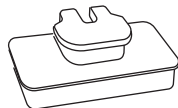

Print Platform
Pre-installed



Resin Tank
Pre-installed

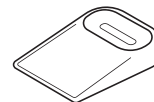

Resin Wiper

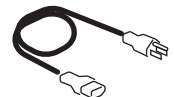

Power Cord

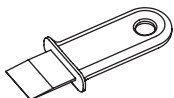

Print Removal Tool

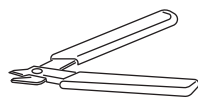

Support Snipper

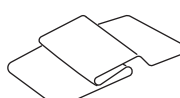

Cleaning Cloth

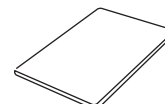

Onboarding Card

2 Where to Set Up

Situate your Pro 3D printer in a well-ventilated area on a flat and level surface. Keep it away from extreme temperatures, windows, bright UV light sources, and direct sunlight.

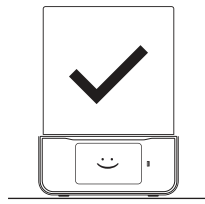

Level Surface

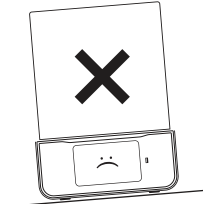

Uneven Surface

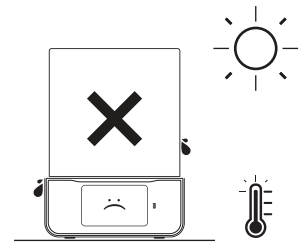

Warm Environment

3 Plug in Your Pro

Use the provided power cable to plug your printer into a surge protector or uninterrupted power supply.

Pro automatically goes to sleep to save energy after a period of inactivity. Interaction with the touchscreen or sending a print job will reactivate it.

Use the power switch if you need to perform a hard reset or disconnect your Pro from its power source.

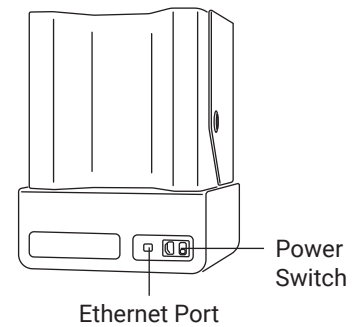
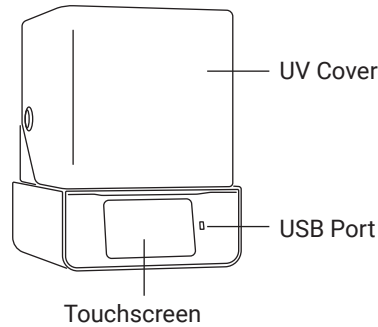

4 Connect to a Wireless Network

Using the touchscreen, follow these steps:
Settings > Wireless Network > Select a Network

Once connected to a wireless network, Pro will be discoverable by SprintRay Desktop Software.

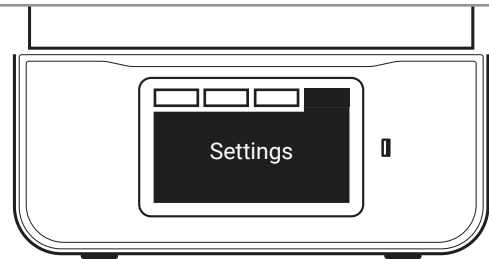

5 Print Platform

(Pre-installed)

To minimize cleanup, always remove the platform before removing your resin tank.

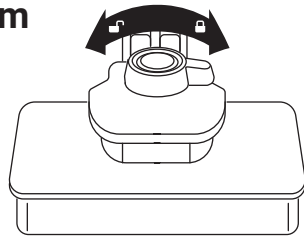

Turn to lock/unlock.

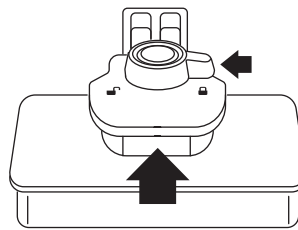

Insert and lock.

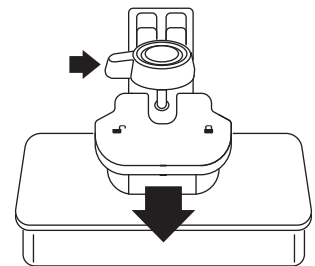

Unlock and pull to remove.

6 Resin Tank

(Pre-installed)

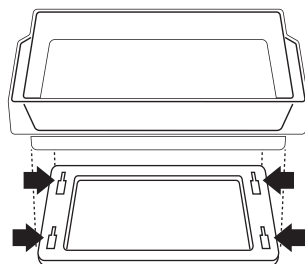

Align resin tank with tank cradle, place it, and slide it into the tracks.

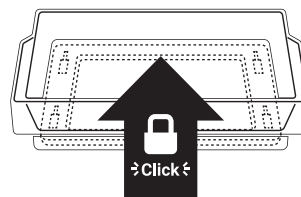

Push away from you to lock it in place. You will hear a "click" when the resin tank is properly locked.

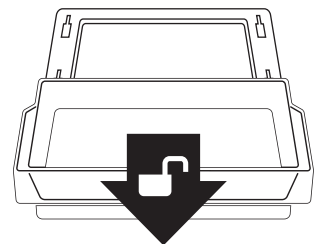

Gently pull toward you to unlock and then lift up to remove the resin tank.

7

Get Software

Download SprintRay Software from sprintray.com/software



Compatible with
Mac and Windows

8

Prepare a Print Job

Using Desktop Software to Prepare a Print

After launching SprintRay Software, begin by selecting your printing material and the desired layer thickness. Next, import your STL model, orient the model, and add supports if necessary. If you are new to 3D printing, consult our website and full user manual for more detailed information.

The model is now ready for printing. Now that everything is set on the software side, follow the below instructions to prepare your Pro printer.

Make sure your printer and your computer are both connected to the same wireless network.

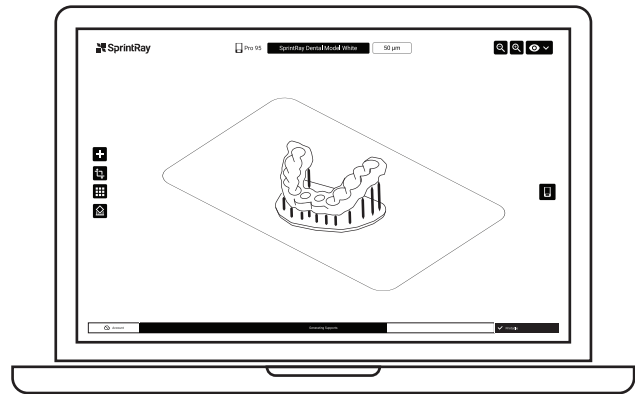

Ensure Your Pro is Ready

Install resin tank and build platform in their places. It is extremely important to make sure both the build platform and resin tank are fully secured and locked before you start a print.

Refer to steps 5-7 to ensure your equipment is ready before starting the print.

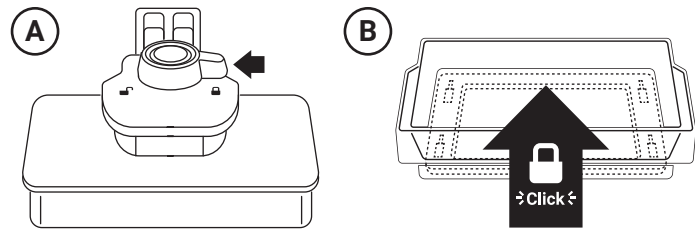

9

Fill the Resin Tank

Before you pour resin into your Pro's tank, it is important to shake the bottle until it is thoroughly mixed.

When starting a print, the desktop software or touchscreen of your Pro will display the resin level necessary for the planned job.

Fill the tank to the suggested level, ensuring even distribution of the resin across the tank.

Close the lid of the printer or cover the resin tank at all times to minimize light exposure.

MAX 500mL
MED 400mL
MIN 300mL

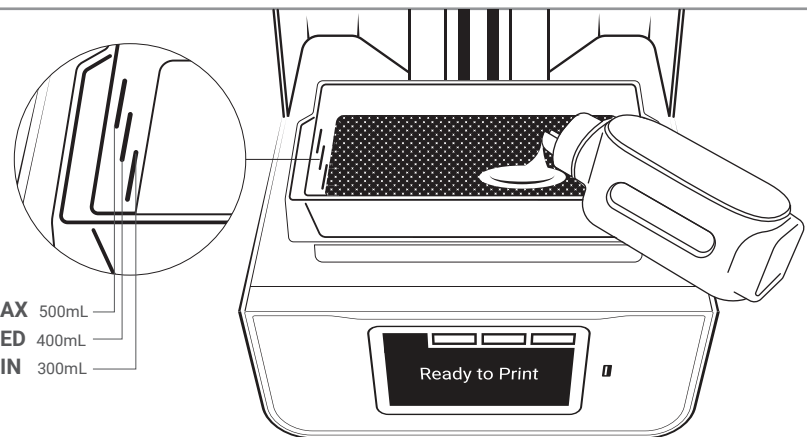

10

Start a Print

Once you've prepared both the software and hardware for your print, click on the printer icon in SprintRay Software.

The software will process the job and send it to your printer. The build platform should slowly descend into the resin tank. Once this has happened, the print process has begun.

Your printer runs independently once it begins its print process. Any changes to your network or computer will not effect print progress as long as Pro maintains power.

Note: It's very important to ensure that the lid remains closed during the entire print cycle.

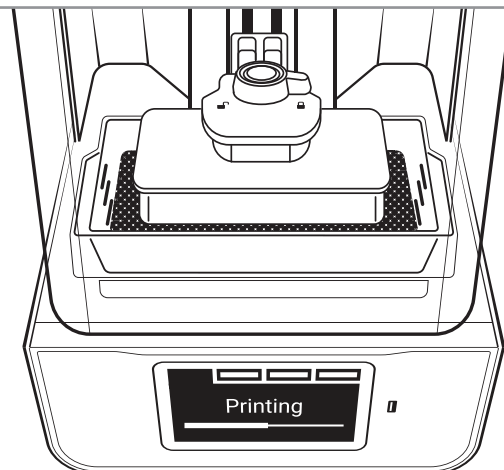

11 Finishing a Print Job

Removing Prints from Print Platform

Note: We recommend wearing gloves in order to complete this step.

When the print job is complete and the build arm has fully raised, remove the platform and place it on a flat surface.

Using the provided print removal tool, detach the part from print platform. Using the clipping tool, remove the supports from your part.

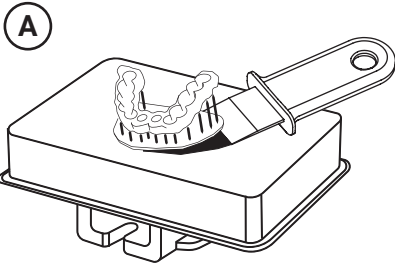
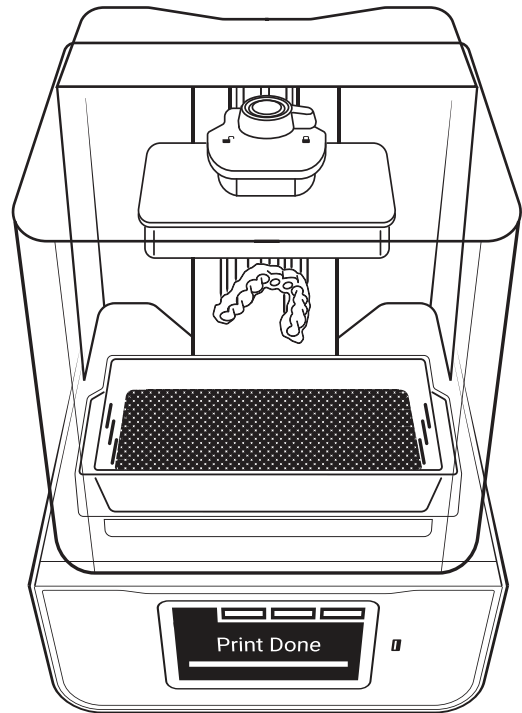

Wear Gloves

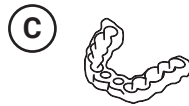

Wash and Air Dry

Use IPA 91% to wash the parts. To ensure complete cleanliness, the washing process can be repeated.

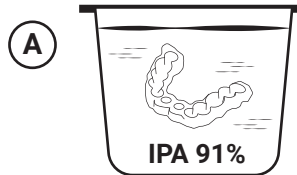

Air Dry or Blow Dry

Post Curing

Depending on the material specifications and FDA requirements, you may need to post-cure the printed part after wash.

Please refer to the application guides to complete the post-curing.

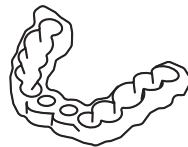

SprintRay ProCure

You can use presets on SprintRay ProCure to complete post-curing process.

SprintRay ProCure is sold separately.

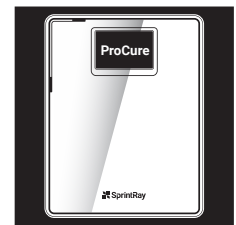

12 Maintenance

Resin Tank Inspection

Gently drag the resin wiper across the surface of the tank to ensure there are no hard particles in the tank.

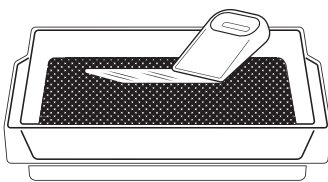

Inspect resin tank with resin wiper.

Mixing Resin Before Print

If you keep resin in the tank between jobs, use the resin wiper to mix the tank before every print.

Cleaning the Printer

Use the cleaning cloth provided with the printer to clean the glass on the printer.

Clean the printer with a soft damp cloth.

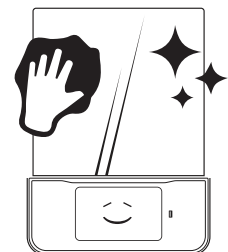

Resin Care

Cured resin can be discarded as regular trash. Never dispose of liquid resin in your sink or other plumbing.

Resin should not be left out of the bottle for more than three days. If it has been exposed to air for less than three days, it is safe to pour it back into the bottle through a paper filter or loose mesh.

Warning:

Changes or modifications to this unit not expressly approved by the party responsible for compliance could void the user's authority to operate the equipment.

NOTE:This device is a fix location and is dangerous. Please be careful when using it.

NOTE:When the instrument is in normal working condition, please keep at least 20CM distance to avoid high temperature or splashing objects.

NOTE :

This device complies with part 15 of the FCC Rules. Operation is subject to the following two conditions: (1) This device may not cause harmful interference, and (2) this device must accept any interference received, including interference that may cause undesired operation.

NOTE :

This equipment has been tested and found to comply with the limits for a Class B digital device, pursuant to part 15 of the FCC Rules. These limits are designed to provide reasonable protection against harmful interference in a residential installation. This equipment generates, uses and can radiate radio frequency energy and, if not installed and used in accordance with the instructions, may cause harmful interference to radio communications. However, there is no guarantee that interference will not occur in a particular installation. If this equipment does cause harmful interference to radio or television reception, which can be determined by turning the equipment off and on, the user is encouraged to try to correct the interference by one or more of the following measures:

- Reorient or relocate the receiving antenna.
- Increase the separation between the equipment and receiver.
- Connect the equipment into an outlet on a circuit different from that to which the receiver is connected.
- Consult the dealer or an experienced radio/TV technician for help.

RF exposure compliance statement:

This equipment complies with FCC radiation exposure limits set forth for an uncontrolled environment.