

Fast Wireless Charger



Model: S6

About adapter

The Max Output: Apple 7.5W, Samsung 10W. Please use PD or QC 3.0 adapter.
The wireless charging can be 5W only if choosing a 5V2A adapter.



Tips: PD/QC 3.0 adapter need to be purchased separately.

Holder installation method

1. Follow the arrows to install 3 parts.



2. Adjust the screw cap to the best active status.



3. Press the button of clip to fix, then adjust the angle and tighten the fixed nut.

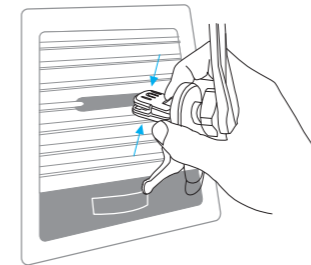

4. Installation completed.



Step to Install Suction Cup

1. Follow the arrows to install 3 parts.



2. Adjust the screw cap to the best active status.



3. Adjust the angle of suction cup and empty air.



- 1 Tear off the red protective film and stick it on the dashboard
- 2 Paste the suction cup on the 3M auxiliary fixing plate, press it for 1 minute and let it stand for 1 hour.
- 3 Press the lever
- 4 Adjust the appropriate angle

4. Installation completed.



LED indicator light



Product Specification

Fast Wireless Charger

- Input: 5V=2A/9V=2A
- Output: 5V=1.0A/9V=1.20A
- Charging Efficiency: 70%

⚠ The LED light turns red during wireless charging to indicate a charging failure.

The following situation can cause failures, like charging slowly, stop charging, over-temperature for charging position.

1. The adapter is not run up to standard (No PC USB output power supply).
2. The charging cable is not up to standard.
3. The phone case is too thick (within 2mm thickness phone case recommended).
4. There is metal on the back of cell phone or phone case.
5. Smartphone does not support wireless charging function.

⚠ Attention

1. Please keep the charger away from water or other liquid.
2. If you need to clean the charger, please make sure it is not connected to power supply.
3. Using Environment temperature remains -20~45°C.

FCC Requirement

Any changes or modifications not expressly approved by the party responsible for compliance could void the user's authority to operate the equipment. This device complies with Part 15 of the FCC Rules. Operation is subject to the following two conditions: (1) this device may not cause harmful interference, and (2) this device must accept any interference received, including interference that may cause undesired operation.

Note: This equipment has been tested and found to comply with the limits for a Class B digital device, pursuant to Part 15 of the FCC Rules. These limits are designed to provide reasonable protection against harmful interference in a residential installation. This equipment generates, uses, and can radiate radio frequency energy, and if not installed and used in accordance with the instructions, may cause harmful interference to radio or television reception, which can be determined by turning the equipment off and on, the user is encouraged to try to correct the interference by one or more of the following measures:

- Reorient or relocate the receiving antenna.
- Increase the separation between the equipment and receiver.
- Connect the equipment into an outlet on a circuit different from that to which the receiver is connected.
- Consult the dealer or an experienced radio/TV technician for help.



MADE IN CHINA