

INSTALLATION INSTRUCTIONS

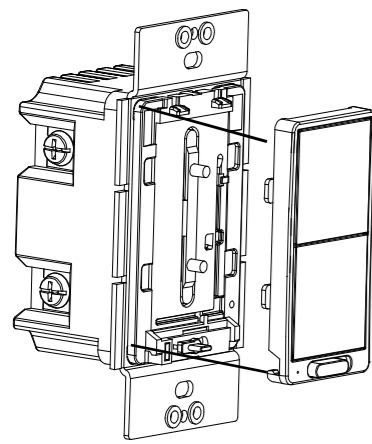

SQR22601WHW WIFI 600W DIMMER SINGLE POLE

◆ SPECIFICATIONS

Voltage.....	120VAC, 60Hz
Incandescent.....	600W
CFL/LED/Electronic self-ballasted.....	2A (150W)
Operating Temperature.....	32°F~104°F(0°C~40°C)
Wire Strip Length.....	16mm(5/8 in.)
Supply Connection.....	14 AWG wires
Screw Torque.....	20 lbf-in
Protocol.....	IEEE 802.11b/g/n
Wireless Type.....	2.4GHz

◆ FEATURES

- Perfect Replacement for regular wall ON/OFF & Dim switch, 120VAC
- Manual and Remote ON/OFF& Dim control of any permanently installed incandescent, dimmable LED and CFL lamp fixture
- Preset light level option allows the dimmer will turn on to the light level that it was adjusted to the previous time when the light was on
- Can be used for single pole or 3-Way (Multi-location) with WF3K Auxiliary Switch (sold separately)
- Air-Gap Switch feature meets UL requirement and disconnect power from load locally.

◆ DESCRIPTION

The SQR22601WHW Dimmer Switch is a perfect wireless manual and remote on/off/ dim bright control replacement of regular on/off and dimmer switch, controlling incandescent, dimmable LED and CFL. Sliding Air-Gap switch to a totally disconnect power while replacing light bulbs and preventing from leakage current from the fixture(s). This SQR22601WHW dimmer works with WF3K 3-Way Auxiliary Switch that reducing energy consumption, enhancing the value of technology of your home, condominiums and apartment. The LED dimming performance may vary based upon dimmer type, model, manufacturer, circuit wiring and circuit loading. No specific recommendation on product selection and there are no warranties of performance or compatibility implied.

WARNINGS AND CAUTIONS

Be sure to read the instruction carefully before installation, and the manufacturer will not be responsible for any product damage that does not follow the instruction

1. Wet hands are strictly prohibited.
2. Must work strictly according to the rated load.
3. Do not continue to work after self-disassembly of any nature and damage of external forces.

◆ INSTALLATION

This SQR22601WHW dimmer switch may be used in new installations or replace an existing wall switch.

Typical Dimmer Wiring Schematic:

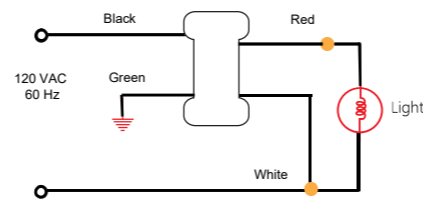

3-Way Wiring Schematic using one SQR22601WHW and one WF3K

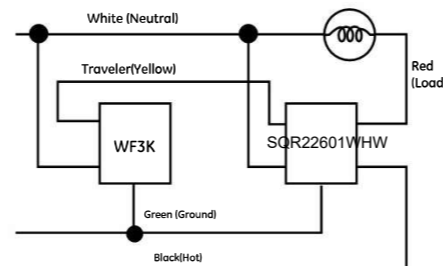

Traveler works with WF3K for 3-way control, WF3K sold separately.

Wiring Diagram:

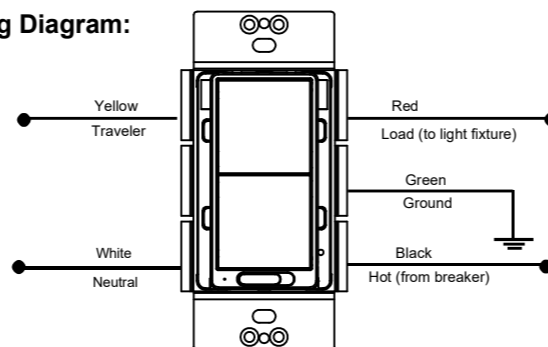

1. WARNING : To avoid fire, shock, or death. High Voltage - Turn off power at circuit breaker or fuse and test that power is off before wiring.
2. CAUTION : To Reduce The Risk of Overheating and Possible Damage to Other Equipment, Do Not Install to Control a Receptacle, a Motor-Operated Appliance or a Fluorescent Lighting Fixture or a Transformer Supplied Appliance.
3. Remove wall plate and existing switch mounting screws.
4. Carefully remove the existing switch from the switch box.
5. Disconnect the wiring from the existing switch.
6. Connect the dimmer switch as shown in the wiring diagram: Black lead to hot wire, white lead to neutral wire, red lead to load wire, green lead to ground wire.
7. Check connections to be sure they are tight and no bare conductors are exposed.
8. Insert the SQR22601WHW dimmer switch into the standard outlet box carefully.
9. Make sure the SQR22601WHW dimmer switch to the box using the supplied screws.
10. Attach the wall plate.
11. Restore power at the circuit breaker and test the system.

Air Gap Switch

During normal operation, there is a small amount of power passing through the switch to the load even when the dimmer switch is turned off. The SQR22601WHW has an air gap switch on the lower right side to completely disconnect power to the

load. Slide the air gap switch to left to disconnect the power while replacing light bulbs and slide it to right for normal operation. The air gap switch must be all the way in for the dimmer to function and control the lighting.

◆ MULTIGANG INSTALLATION

When installing more than one control in the same wall box, it may be necessary to remove the side tabs before installing (see below). Using pliers, bend each tab back and forth until they break off. Repeat for each tab to be removed. Removal of tabs WILL REDUCE MAXIMUM LOAD CAPACITY.

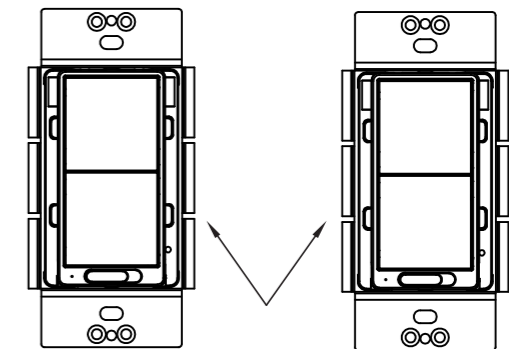

Tabs Removed for Multigang installation

LED/CFL Derating Chart			
Load Capacity when Tabs are removed from:			
Dimmable LED/CFL	0 Sides	1 Side	2 Sides
		150W	150W

When using the Dimmer to control LED/CFL lights in conjunction with another Dimmer to control Incandescent /Halogen lights follow this Derating Chart for Maximum Capacity on EACH device.

If the combined Wattage of ALL LED/CFL bulbs on 1 dimmer is:	Then the Maximum COMBINED Wattaged for the Incandescent/Halogen bulbs on EACH attached dimmer:		
	If NO Tabs are removed then Max Wattage is:	If 1 side of Tabs are removed then Max Wattage is:	If 2 sides of Tabs are removed then Max Wattage is:
0W	600W	500W	400W
1-25W	500W	400W	300W
26-50W	400W	300W	200W
51-75W	300W	200W	100W
76-100W	200W	100W	50W
101-125W	100W	50W	0W
126-150W	0W	0W	0W

If you are using ONLY LED/CFL bulbs on ALL Dimmers, DO NOT USE this Derating Chart. Follow the LED/ CFL Derating Chart.

◆ OPERATIONS

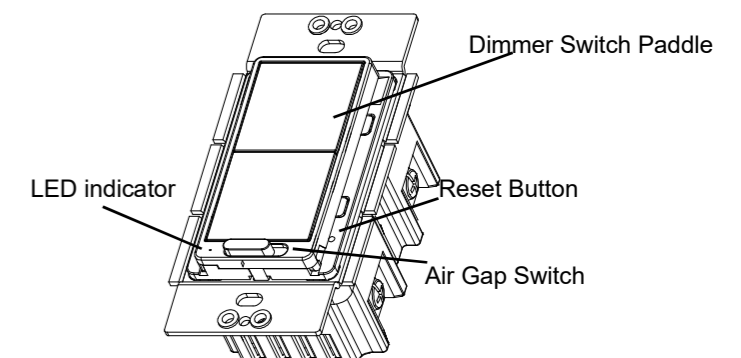

INSTALLATION INSTRUCTIONS

Manual Control

The SQR22601WHW dimmer switch allows the user to:

Turn ON/OFF and control the brightness level of the connected lighting.

1. To turn the connected lighting ON: Tap the top of the dimmer switch paddle. The LED indicator will be turned on in blue.
2. To turn the connected lighting OFF: Tap the bottom of the dimmer switch paddle again. The LED indicator will be turned off.
3. To brighten the connected lighting: Press and hold the top of the dimmer switch paddle, release when desired level is achieved.
4. To dim the connected lighting: Press and hold the bottom of the dimmer switch paddle, release when desired level is achieved.

Please note: pressing and holding the dimmer switch paddle until the light intensity is at the minimum setting does not turn the power OFF, you must still tap (short press) the bottom of the dimmer switch paddle to turn the power OFF.

SE Wiser Smart App Control

1. Download SE Wiser app from the App Store or Google Play.



2. Connect mobile device to your 2.4GHz WIFI network. Please note this Smart Dimmer Switch can only be connected to 2.4GHz network.



3. Launch SE Wiser and follow the in-app instructions to connect the Smart Dimmer Switch to your network.

- a. Login the SE Wiser
- b. Click the button "+"

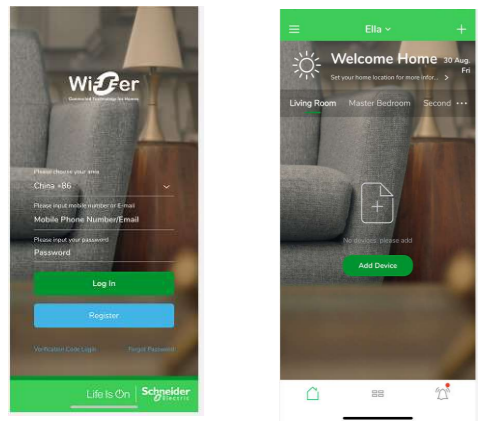

- c. Select the "WIFI Smart Dimmer"

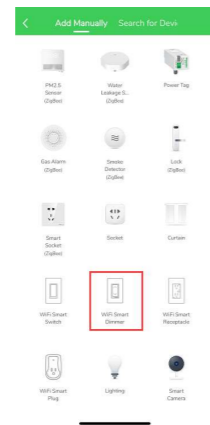

- d. Click the bottom button
- e. Enter your Wifi password

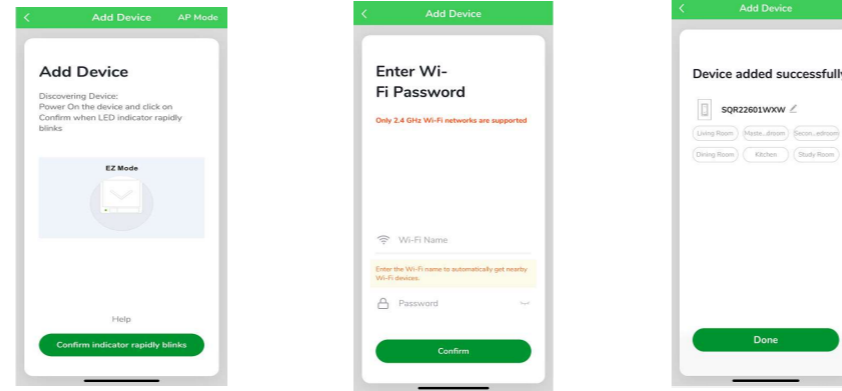

- f. Finished

4. When the device is added successfully, this WIFI Dimmer can be turned ON/OFF dimmed, countdown and making weekly schedule.

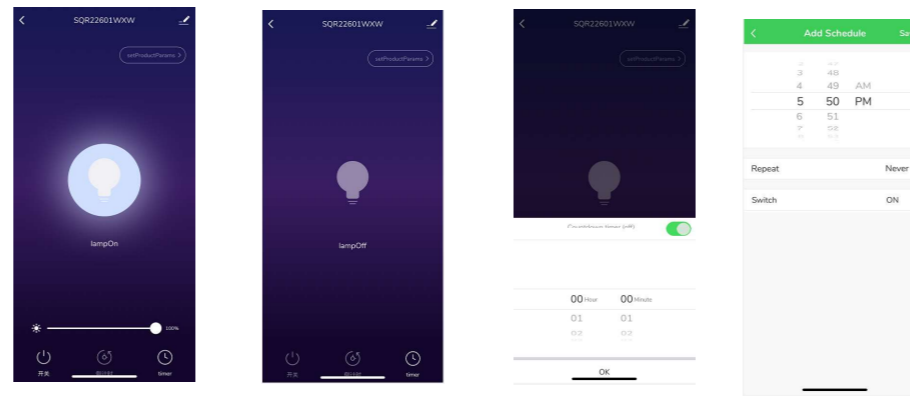

Please Note:

1. During the process of adding device, you must select the correct name of WIFI router and fill in the correct WIFI password, otherwise the device will not be able to add successfully.
2. This WIFI Switch can only be paired with one phone device. If you want multiple phones to control the WIFI Switch, click below place then chose the " Device Sharing".

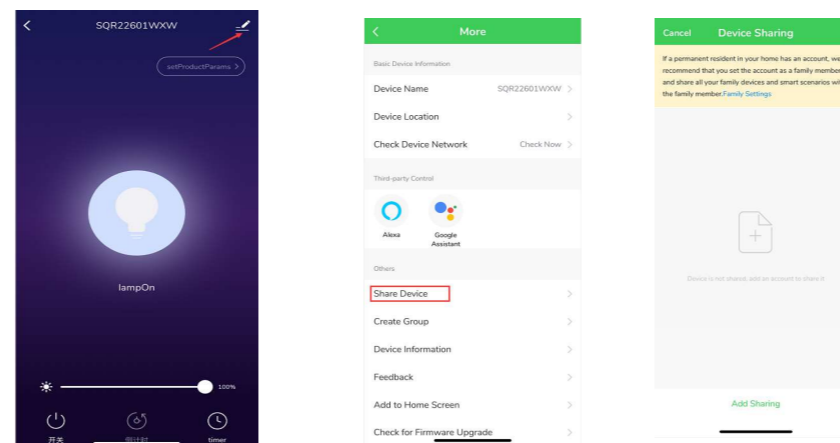

3. When the device fail to add in the App, please try to enter the AP mode. Before enter the AP mode please press the top or bottom button 5 times continuously, then press and hold at the sixth for 5 seconds then release, or press and hold the Rest button with a ball point 3 seconds then release. the LED indicator in green and slowly blinks.

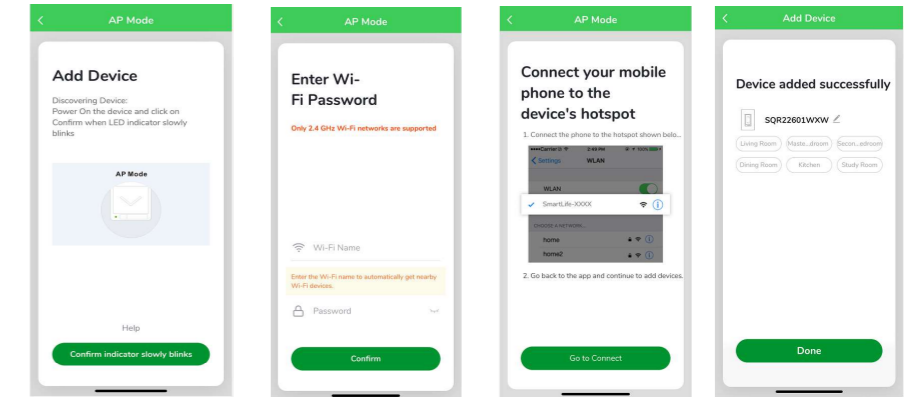

Restoring Factory Defaults

When power on the device and confirm that indicator light if rapidly blinks, if not please press the top or bottom button 5 times continuously, then press and hold at the sixth time for 5-8 seconds then release, or press and hold the Rest button with a ball point 3 seconds then release. The LED indicator in green and flashes quickly.

Please Note: When power is reconnected after the interruption, the LED indicator in green will flash quickly which means that the Dimmer is searching for WIFI. It will stop flashing and turn off when WIFI is connected successfully for 5 seconds. when the LED indicator in solid green that means your network anomaly, pls check the network.

LED INDICATION

- Quick Blinking Green:** Connecting to the network.
- Slow Blinking Green:** AP mode.
- Green bright after 2 seconds off:** Connected to the network.
- Sold Green:** Network abnormaly .
- Solid Blue:** The WIFI Dimmer is switched on.
- Off Blue:** The WIFI Dimmer is switched off.

WARRANTY INFORMATION

Our company warranties its products to be free of defects in materials and workman-ship for a period of two (2) years. There are no obligations or liabilities on the part of our company for consequential damages arising out of or in connection with the use or performance of this product or other indirect damages with respect to loss of property, revenue, or profit, or cost of removal, installation or reinstallation.

Aug, 2019

ISED Statement

This device contains licence-exempt transmitter(s)/receiver(s) that comply with Innovation, Science and Economic Development Canada's licence-exempt RSS(s). Operation is subject to the following two conditions:

1. This device may not cause interference.
2. This device must accept any interference, including interference that may cause undesired operation of the device.

L'émetteur/récepteur exempt de licence contenu dans le présent appareil est conforme aux CNR d'Innovation, Sciences et Développement économique Canada applicables aux appareils radio exempts de licence. L'exploitation est autorisée aux deux conditions suivantes :

1. L'appareil ne doit pas produire de brouillage;
2. L'appareil doit accepter tout brouillage radioélectrique subi, même si le brouillage est susceptible d'en compromettre le fonctionnement.

FCC Supplier's Declaration of Conformity

Model number : SQR22601WHW

This device complies with part 15 of the FCC Rules. Operation is subject to the following two conditions: (1) This device may not cause harmful interference, and (2) this device must accept any interference received, including interference that may cause undesired operation.

Suppliers Name: Schneider Electric

Suppliers Address (USA) : 6700 Tower Circle, Suite 700 Franklin, TN 37067, United States

Suppliers Website: <https://www.schneider-electric.com/en/home/>

This equipment complies with ISED RSS-102 radiation exposure limits set forth for an uncontrolled environment. This equipment should be installed and operated with a minimum distance of 20cm between the radiator and any part of your body.

Ce dispositif est conforme à la limite d'exposition aux rayonnements ised - RSS - 102 prescrite pour un environnement non contrôlé. Lors de l'installation et de l'exploitation de ce dispositif, la distance minimale entre le radiateur et toute partie du corps doit être de 20 cm.

◆ FCC COMPLIANCE STATEMENT

Federal Communication Commission Interference Statement

The equipment has been tested and found to comply with the limits for a class B Digital Device, pursuant to part 15 of the FCC Rules. These limits are designed to provide reasonable protection against harmful interference in a residential installation. This equipment uses, generates and can radiate radio frequency energy and, if not installed and used in accordance with the instruction, may cause harmful interference to radio communication. However, there is no guarantee that interference will not occur in a particular installation. If this equipment does cause harmful interference to radio or television reception, which can be determined by turning the equipment off and on, the user is encouraged to try to correct the interference by one or more of the following measures:

- Reorient or relocate the receiving antenna.
- Increase the separation between the equipment and receiver.
- Connect the equipment into an outlet on a circuit different from that to which the receiver is connected.
- Consult the dealer or an experienced radio/TV technician for help.

FCC Caution:

This device complies with part 15 of the FCC Rules. Operation is subject to the following two conditions: (1) This device may not cause harmful interference, and (2) this device must accept any interference received, including interference that may cause undesired operation.

cause undesired operation.

FCC Radiation Exposure Statement:

This equipment complies with FCC radiation exposure limits set forth for an uncontrolled environment. This equipment should be installed and operated with minimum distance 20cm between the radiator & your body.

RF Exposure: A distance of 20 cm shall be maintained between the antenna and users, and the transmitter module may not be co-located with any other transmitter or antenna.

Non-modification Statement:

Any changes or modifications not expressly approved by the party responsible for compliance could void the user's authority to operate this equipment.