

  
**h2oaudio®**



# **TRI2** PROMULTI-SPORT

WITH **PLAYLIST+**

**WATERPROOF** OPEN EAR HEADPHONES

**SWIM**



**BIKE**



**RUN**





# TABLE OF CONTENTS:

---

WHAT'S IN THE BOX

CHARGING, POWER ON & BATTERY

BUTTON FUNCTIONS

MEMORY MODE, FOLDERS & SHUFFLE

BLUETOOTH CONNECTION & PAIRING

PLAYLIST+

H2O AUDIO APP

DIRECT DOWNLOAD VIA USB

HOW TO WEAR

SWIMMING WITH TRI PRO

BIKING & RUNNING WITH TRI PRO

WARRANTY, SUPPORT & CONTACT





# WHAT'S IN THE BOX

## WELCOME TO YOUR TRI PRO 2 MULTI-SPORT EXPERIENCE!

---

CONGRATULATIONS ON YOUR NEW H2O TRI PRO  
MULTI-SPORT! INSIDE YOUR BOX, YOU'LL FIND EVERYTHING  
YOU NEED TO DIVE INTO YOUR AUDIO ADVENTURE.

### QUICK START GUIDE

Get started with your TRI PRO 2 in minutes with this handy guide, leading you through the basics to get you up and running swiftly.

### USER MANUAL

Your comprehensive guide to all things TRI PRO 2. From features and functions to troubleshooting tips, everything you need to know is right here.

### CUSTOMER SUPPORT CONTACT INFO

We're here for you! Inside, you'll find all the information you need to reach out for support, ensuring peace of mind no matter where your TRI PRO takes you.



# WHAT'S IN THE BOX

## **TRI PRO 2 HEADSET:**

The heart of your listening experience, designed to deliver unparalleled sound quality whether you're underwater or on the go.

## **USB CABLE**

For easy and fast charging of your headset, ensuring your beats go on as long as your adventures do.

## **SOLID EARPLUGS**

For the best audio experience and sound quality while swimming we recommend using the included solid blue earplugs to reduce the ambient sound of water splashing.

## **LEASH**

Keep your TRI PRO secure and always within reach, no matter the activity. Designed for convenience and security you can attach the leash to a goggle strap or glasses, so you can focus on what truly matters.



# WHAT'S IN THE BOX



TRI PRO 2 HEADSET



SOLID EARPLUGS



USB CABLE



# CHARGING, POWER ON & BATTERY

## HOW TO CHARGE

---

Connect the 4 pin USB cable to the TRI PRO 2  
(It will attach only 1 way with the magnets).

- BATTERY CHARGING: Red LED
- BATTERY FULL: Blue LED
- FULL BATTERY PLAY TIME: ~5 hrs

**When you turn ON the TRI PRO**  
you will hear the current battery level  
status.



## POWER ON/OFF

---

### TURN ON/OFF:

Press and hold the middle  
button for 3 seconds.

To RESET - hold for 12 sec





# BUTTON FUNCTIONS

## M (MIDDLE/MODE BUTTON)

### POWER ON/OFF:

Hold (3 sec) to Power ON/OFF

### PLAY/PAUSE:

1-Click to Play/Pause audio

### MODE CHANGE (MEMORY<-> BLUETOOTH):

2-Click (Double Click)

### RESET:

Hold for 12 seconds to Reset.  
Make sure headphones are off.  
After 12 seconds you will see  
the LED light blink 3 times.



**BUTTON  
PLACEMENT**

## +/- BUTTONS

**VOLUME UP/DOWN:** 1-Click

**SKIP SONG:** Hold + or - to skip to next  
or previous track.

**SKIP FOLDER:** Quick double click to  
advance to next/previous folder (only  
in memory play mode)

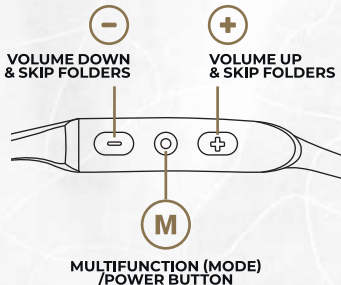



# BUTTON FUNCTIONS (CONTINUED)

## PLAYLIST+

---

Quick double-press + button to start/stop Loading (Only in Bluetooth Mode)

## SHUFFLE MODE:

---

3-click (triple click) to turn on/off  
**(ONLY IN MEMORY MODE)**

## SIRI/VOICE ASSISTANT

---

Long Press  
**(ONLY IN BLUETOOTH MODE)**

## ANSWER INCOMING CALL

---

1-click **(ONLY IN BLUETOOTH MODE)**

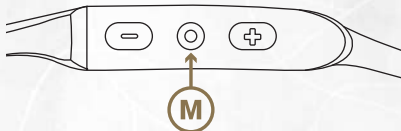





# MEMORY MODE, FOLDERS, PLAY ORDER & SHUFFLE

## MEMORY MODE

When you power on the Tri Pro 2 it will announce which mode you are in, either Memory Mode or Bluetooth Mode. Double click the **“M” button** to toggle between Memory Mode (Swimming) & Bluetooth mode. Use Memory Mode to play back your files which have been added to memory via PLAYLIST+ or direct download via USB.

## FOLDERS

You can organize your music into folders. There are two ways to create and manage folders. Either via your computer and a USB connection or via the H2O Audio App.

Your TRI PRO 2 comes with two folders installed into the memory, (LOAD & FAVORITE). The LOAD folder is where all of your audio loaded via the PLAYLIST+ Feature can be found.

A quick DOUBLE-CLICK on the **“+/-” button** will skip to or go back to the previous folder.



# MEMORY MODE, FOLDERS, PLAY ORDER & SHUFFLE (CONTINUED)

## PLAY ORDER

You can determine the play order by assigning a sequential numerical value to the beginning of each audio title. It is important to always use 3 digits for the numerical assignment otherwise it will not play in order. (000,001,002,003,004 etc all the way to 999)

## SHUFFLE MODE

The TRI PRO 2 has the ability to randomly shuffle the play order of your stored audio files. Please note it will only shuffle the music contained within a folder and not across all folders. A **QUICK TRIPLE CLICK** on the **“M” button** will turn on/off SHUFFLE MODE.



# BLUETOOTH CONNECTION & PAIRING

**CONNECT YOUR H2O AUDIO DEVICE TO A SMARTPHONE OR SMARTWATCH FOR DIRECT LIVE STREAMING OF AUDIO CONTENT WITH THESE SIMPLE STEPS:**

## **ENABLE BLUETOOTH ON SOURCE DEVICE**

- On your smartphone or smartwatch, navigate to the settings menu.
- Find the Bluetooth section and ensure Bluetooth is turned on.

## **POWER ON THE TRI PRO**

- Turn on your H2O Audio device and listen carefully to the audio prompts.
- By default, the device will start in either Bluetooth (BT) or Memory Mode

## **SWITCH TO BLUETOOTH MODE**

- If your device starts in Memory Mode, switch to Bluetooth Mode by double clicking the middle multi-function button.

## **PAIRING YOUR DEVICE**

- For first-time pairing, wait for your H2O Audio Device's name (TRI PRO 2) to appear on the Bluetooth screen of your source device.
- Once it appears, tap on the device name (TRI PRO) to complete the Bluetooth pairing process.



# **BLUETOOTH CONNECTION & PAIRING** (CONTINUED)

## **RECONNECTING PREVIOUSLY PAIRED DEVICES**

- If your TRI PRO 2 has been paired with the source device before, it should automatically reconnect.

## **START STREAMING**

- Play audio content from your preferred app on the source device to start streaming through your H2O Audio Tri PRO 2.

## **DISCONNECTING**

- To disconnect, you can either turn off your H2O Audio device, disconnect from the Bluetooth settings on your source device, or simply stop the Bluetooth connection directly from your source device.



# PLAYLIST+

The **PLAYLIST+** feature marks a significant innovation in the H2O Audio Pro Series, offering an unparalleled audio experience for enthusiasts of all activities, including swimming, trail running, skiing, and more. This feature revolutionizes how you interact with your streaming music, podcasts, and audiobooks, allowing seamless playback anywhere without the need for a connected smartphone.

## KEY BENEFITS OF PLAYLIST+

### UNIVERSAL STREAMING CONTENT ACCESS

- With **PLAYLIST+** you can record and load content from any streaming app directly to your H2O Audio device, making your favorite playlists, podcasts, and audiobooks readily accessible.

### TRUE MOBILITY

- Designed for the adventurer, **PLAYLIST+** liberates you from carrying a phone. Your streaming content is available in memory mode, facilitating uninterrupted playback both above and below water, in any environment.

### EASE OF USE

- Adding content to your device is straightforward—no tangled USB cables, no complex setups. A simple button press begins the loading process, or you can opt for the H2O Audio app for a more intuitive interface to manage extensive playlists.



# **PLAYLIST+** (CONTINUED)

## **COMPATIBILITY**

- PLAYLIST+ is a standard feature across all Pro Series models, including TRI PRO 2 for triathletes, SnowPro for winter sports enthusiasts, SONAR PRO for advanced audio quality, and STREAM PRO for everyday use.

## **HOW PLAYLIST+ WORKS**

### **CHOOSE YOUR CONTENT**

- Start by selecting your desired audio from any streaming application, be it music, podcasts, or audiobooks.

### **LOAD TO YOUR DEVICE**

- Utilize the PLAYLIST+ feature to record the streaming content via Bluetooth directly to your H2O Audio Pro Series device. This can be done either through a simple button press on the device or via the H2O Audio app for a more guided experience.

### **ENJOY ANYWHERE**

- Once your content is loaded, switch to memory mode to play back your audio without needing a phone or Bluetooth connection. Your audio is now ready to accompany you on any adventure, uninterrupted by environmental conditions.



# PLAYLIST+ HOW TO LOAD AUDIO

**LOADING MUSIC TO YOUR PLAYLIST+ FEATURE ON H2O AUDIO PRO SERIES DEVICES IS STRAIGHTFORWARD AND CAN BE DONE IN TWO PRIMARY WAYS. DIRECTLY VIA BLUETOOTH OR THROUGH THE H2O AUDIO APP.**

## OPTION 1: DIRECT LOADING VIA BLUETOOTH

### PAIR YOUR DEVICE

- Ensure your Pro Series headphones are in Bluetooth mode.
- On your smartphone, go to Bluetooth settings and pair with the H2O PRO headphones. After the initial pairing, the headphones will automatically reconnect in the future.

### PLAY YOUR DESIRED AUDIO

- Open any music app on your phone and start playing the audio you wish to load.
- Confirm that you can hear the audio through the PRO headphones.
- When loading audio make sure your play volume is set high enough. Any changes in volume while loading is recorded and stored in the memory.

### BEGIN LOADING

- To start recording the audio onto your device, double-click the "+" button.
- A rapidly blinking LED light indicates that loading is active.



# PLAYLIST+ HOW TO LOAD AUDIO

(CONTINUED)

## COMPLETING THE LOAD

- To stop the loading process and save the audio, double-click the "+".
- The audio is now stored in your device's memory for future playback.

## PLAYING BACK LOADED AUDIO

- To play back your audio added via the PLAYLIST+ feature power on your set, enter memory mode, and skip to the load folder, (2 clicks on the + button). Your loaded Audio should begin playing.

DOUBLE CLICK "+" BUTTON







# PLAYLIST+ H2O AUDIO APP

## OPTION 2: LOADING VIA THE H2O AUDIO APP

### INSTALL THE H2O AUDIO APP

- Download the H2O Audio App from the Apple App Store or Google Play Store.

### CONNECT YOUR DEVICE

- With Bluetooth enabled on your smartphone or watch, power on your Pro Series device and enter Bluetooth mode.
- Open the H2O Audio App and link your device by clicking the 'Link Your Device' button. Once detected, connect to your headphones.

### 3. SET LOAD TIME AND START MUSIC

- In the app, set the desired duration for recording.
- Play your music through any app on your phone, ensuring the audio plays through the headphones.
- When loading audio make sure your play volume is set high enough. Any changes in volume while loading is recorded and stored in the memory.

### 4. START LOADING VIA APP

- Navigate to the "Load" page in the app and hit "START." An announcement will confirm "Loading audio," and the LED will blink rapidly.



# PLAYLIST+ H2O AUDIO APP (CONTINUED)

## 5. FINALIZE LOADING

- After the preset time elapses, loading will cease, and the audio will be saved in the device's memory.
- Ensure the audio level is set before recording, and maintain the phone's audio playback and proximity to the headphones to avoid interruption.

## 6. PLAYING BACK THE AUDIO

- To play back your audio added via the PLAYLIST+ feature power on your set, enter memory mode, and skip to the load folder, (2 clicks on the + button). Your loaded Audio should begin playing.



# PLAYLIST+

## TIPS FOR SUCCESSFUL LOADING

- **Audio Management:** Keep your phone's audio playing and within range to ensure seamless loading. Incoming calls or stopping the audio may disrupt the process.
- Use an iPad or tablet to record and load content so you are not tying up your phone.
- While streaming audio via Bluetooth, if you want to save the audio you are listening to, simply double-click the "+" button. This activates the PLAYLIST+ feature, saving the track directly to your set's memory.
- Load Music Overnight: While you charge the Tri Pro, set the app's load time and record your playlist.
- **Charge the battery while loading: Connect your headphones to a charger during loading. Make sure you hear the music you want to load before you connect the USB cable to charge. When PLAYLIST+ is actively loading and you connect the charger the audio will become silent and the loading will resume.**



# **PLAYLIST+**

## **TIPS FOR SUCCESSFUL LOADING**

### **PLAYING LOADED AUDIO**

- Access the "LOAD" folder in memory mode on your device to play back your recorded content without needing a Bluetooth connection or phone.

### **MANAGING AUDIO FILES**

- In Memory mode, you can manage audio files through the app. Options include renaming, deleting, moving files, and creating new folders for organization.



# **H2O AUDIO APP**

## **DOWNLOAD THE APP**

Available on both the iTunes and Android Store, Scan the QR codes below for direct download of the H2O Audio App. Follow the installation prompts to ensure it's correctly set up on your smartphone or tablet.





# H2O AUDIO APP

## PAIR YOUR TRI PRO WITH A SMARTPHONE OR TABLET

- See BLUETOOTH CONNECTION & PAIRING

## LINK THE TRI PRO TO THE APP

- Open the app and press, “Link Your H2O Device” The app will guide you through the pairing process, establishing a connection that enables direct management of your music and device settings.



Link Your H2O Device



# H2O AUDIO APP

## DEVICE INFORMATION

### BATTERY

Check the current battery level.

### MEMORY

See the available memory.

### SOFTWARE UPDATES

Whenever a software update is available, the app will notify you ensuring your device remains up-to-date with the latest enhancements. The update process is straightforward, with step-by-step guidance provided within the app to facilitate a smooth upgrade.

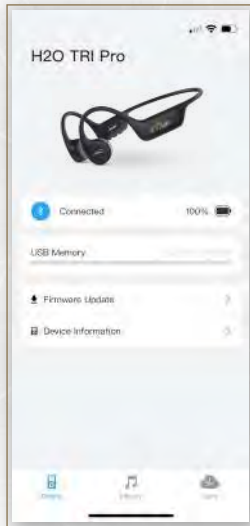



# H2O AUDIO APP

## COMPREHENSIVE MUSIC MANAGEMENT

- **ORGANIZE YOUR MUSIC**
- **NAME FILES**
- **CREATE & MANAGE FOLDERS**
- **CREATE PLAYLISTS**

With your device connected, dive into the app's features. Start by organizing your music library, creating new playlists, and exploring the settings to personalize your audio experience. This includes naming audio files for easy identification, creating and organizing your music into folders for quick access, and crafting the perfect playlists to match your mood or activity.

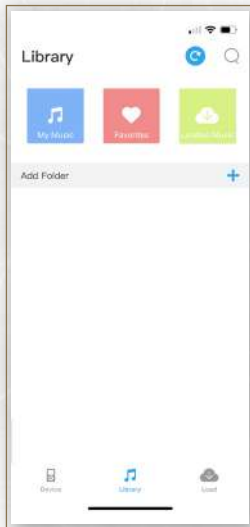





# H2O AUDIO APP

## PLAYLIST+ SIMPLIFIED AUDIO LOADING & MANAGEMENT

### PLAYLIST+ BLUETOOTH AUDIO LOADING

Load audio files directly from your smartphone or tablet to your Tri Pro via the app. This app simplifies the process of adding new music to your collection, ensuring you're always equipped with music that motivates and moves you.

### OFFLINE PLAYBACK

With PLAYLIST+, prepare your device for offline play. This means your carefully curated playlists are available anytime, anywhere, without the need for an active Bluetooth connection. It's perfect for environments where connectivity is limited, such as swimming pools or remote outdoor locations.

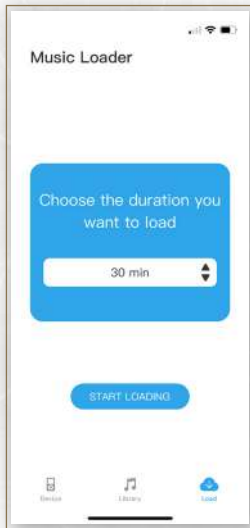



# DIRECT DOWNLOAD VIA USB

**ENSURE THE AUDIO FILES YOU INTEND TO DOWNLOAD ARE IN ONE OF THE SUPPORTED FORMATS, (MP3, M4A, WMA, FLAC, APE) AND ARE FREE FROM ANY DIGITAL RIGHTS MANAGEMENT (DRM) PROTECTION.**

## **CONNECT YOUR DEVICE**

- Use the USB cable provided with your TRI PRO to connect it to your computer or laptop. Make sure there is enough charge in the battery to complete a secure connection to enable file transfer. If the battery on the device is too low the USB connection may fail.

## **DEVICE RECOGNITION**

- Upon successful connection, your computer should automatically detect the device and display it as an external drive. If the device does not appear automatically, check your computer's file manager (for PC users) or Finder (for Mac users).

## **LOCATE MUSIC FILES**

- Find the music files you wish to transfer on your computer. These could be in your iTunes library or any other folder where you store audio files.

## **TRANSFER MUSIC FILES**

- Find the music files you wish to transfer on your computer. These could be in your iTunes library or any other folder where you store audio files.



# DIRECT DOWNLOAD VIA USB

## MANAGING DEVICE CONTENT

- To remove files from your device, navigate to the device folder, select the unwanted files, and either right-click to delete or drag them to the trash.

## SAFELY DISCONNECTING THE DEVICE

- Before disconnecting the USB cable, ensure you safely eject the device from your computer to prevent data corruption.

## LISTENING TO MUSIC

- Power on your H2O Audio device, switch to memory mode, and enjoy your music underwater without interruptions.

## IMPORTANT NOTE

**SUBSCRIPTION-BASED MUSIC LIKE SPOTIFY, APPLE MUSIC, PANDORA, ETC ARE COPYRIGHT PROTECTED AND CAN NOT BE DIRECTLY DOWNLOADED VIA USB. SEE THE PLAYLIST+ FEATURE ON HOW TO RECORD AND LOAD SUBSCRIPTION-BASED AUDIO TO THE MEMORY OF YOUR TRI PRO SET.**



# HOW TO WEAR

The **TRI PRO 2 headphones** are **OPEN EAR** and use Bone Conduction. The Speakers are sitting **IN FRONT** of the ear vs in the ear, leaving your ear open for other surrounding sounds.

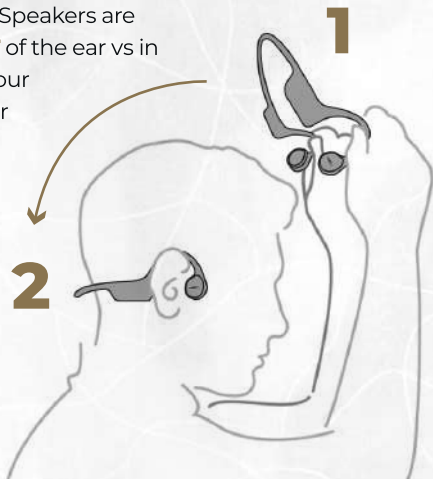



# SWIMMING WITH TRI PRO 2

## USE MEMORY MODE WHEN SWIMMING

For optimal performance while swimming with the Tri Pro 2, it's essential to switch the device to Memory Mode. This allows you to play audio files stored directly on the device. You have two options for loading your music: directly transfer valid music files using the provided USB cable, or use the PLAYLIST+ feature to record and load app-based audio.

## HOW TO WEAR DURING SWIMMING

Secure the headphones in place by fitting them under your swim goggle strap or swim cap, ensuring a snug and stable fit during your swim.

## TIP

### SOLID EAR PLUGS

For the best audio experience and sound quality while swimming we recommend using the included solid blue earplugs to reduce the ambient sound of water splashing.

### LEASH

Keep your TRI PRO 2 secure and always within reach, no matter the activity. Designed for convenience and security you can attach the leash to a goggle strap or glasses, so you can focus on what truly matters.



# SWIMMING WITH TRI PRO

## IMPORTANT NOTE

Bluetooth Mode is not advised for swimming. As the effective range under water is just a few inches. This can cause the audio and Bluetooth signals to drop out or cut off.

Despite the underwater limitations, there are several water-related activities where Bluetooth streaming remains viable. You can successfully live stream via Bluetooth while boating, kayaking, stand up paddle boarding, water aerobics, treading water or any activity where the **TRI PRO** and **source device** are **not submerged**.



# BIKING & RUNNING WITH TRI PRO 2

**WHEN BIKING OR RUNNING YOU CAN LIVE STREAM VIA BLUETOOTH OR PLAY BACK YOUR STORED AUDIO IN MEMORY MODE.**

## **BLUETOOTH MODE**

Utilize Bluetooth mode to live stream audio from your favorite apps by pairing your smartphone or smartwatch to the **Tri Pro Set**

## **MEMORY MODE**

Playback audio which has been stored to the internal memory of the Tri Pro 2 without the need of any other devices i.e. you can leave your phone at home. You can also listen to previously loaded content which was added using the PLAYLIST+ Feature.

## **TIP**

If you're streaming audio via Bluetooth, you can save this content directly to your device's memory using the PLAYLIST+ feature. To do this, double-click the "+" button while you're listening. This action saves the audio to your device's memory. Later, you can access and play this stored audio offline in Memory Mode, perfect for uninterrupted listening while swimming.

## **SAFETY TIP**

It is important to adjust the audio level so that you are able to hear ambient sounds from around you – cars, traffic, etc. The H2O Tri Pro has an open ear design that will allow you to hear what's around you.



# **WARRANTY & SUPPORT**

## **1-YEAR WARRANTY**

All H2O Audio products include a 1-year warranty starting from the date of purchase. This warranty covers any manufacturing defects encountered under normal usage conditions. If you experience any issues covered by our warranty, please contact our customer support for assistance and resolution.

## **GO BEYOND 2-YEAR WARRANTY**

Extend your warranty to two years by registering your product on our website. Successful registration qualifies you for the 2-Year Go Beyond Warranty, offering extended protection for your purchase.

## **SUPPORT**

Unlock More with a Scan: Looking for extra tips, guidance, or detailed how-to videos? Scan the QR Code below to access a wealth of resources and enhance your H2O Audio journey. Or visit us at

**[h2oaudio.com/pages/h2o-tri-pro-headphones-support](https://h2oaudio.com/pages/h2o-tri-pro-headphones-support)**





## CONTACT



SCAN ME

### CONTACT

Need Help? We're Here for You! If you have any questions or need support, our customer service team is eager to assist. We're committed to ensuring your H2O Audio experience is both seamless and enjoyable.

**LIVE CHAT:**

[h2oaudio.com](https://h2oaudio.com)

**EMAIL:**

[support@h2oaudio.com](mailto:support@h2oaudio.com)

**CALL:**

858.771.4410

## FCC Statement

This equipment has been tested and found to comply with the limits for a Class B digital device, pursuant to part 15 of the FCC Rules. These limits are designed to provide reasonable protection against harmful interference in a residential installation. This equipment generates, uses and can radiate radio frequency energy and, if not installed and used in accordance with the instructions, may cause harmful interference to radio communications. However, there is no guarantee that interference will not occur in a particular installation. If this equipment does cause harmful interference to radio or television reception, which can be determined by turning the equipment off and on, the user is encouraged to try to correct the interference by one or more of the following measures:

- Reorient or relocate the receiving antenna.
- Increase the separation between the equipment and receiver.
- Connect the equipment into an outlet on a circuit different from that to which the receiver is connected.
- Consult the dealer or an experienced radio/TV technician for help.

Caution: Any changes or modifications to this device not explicitly approved by manufacturer could void your authority to operate this equipment.

This device complies with part 15 of the FCC Rules. Operation is subject to the following two conditions: (1) This device may not cause harmful interference, and (2) this device must accept any interference received, including interference that may cause undesired operation.

### RF Exposure Information

The device has been evaluated to meet general RF exposure requirement. The device can be used in portable exposure condition without restriction.