

DAILYJET HP I200

OPERATION MANUAL

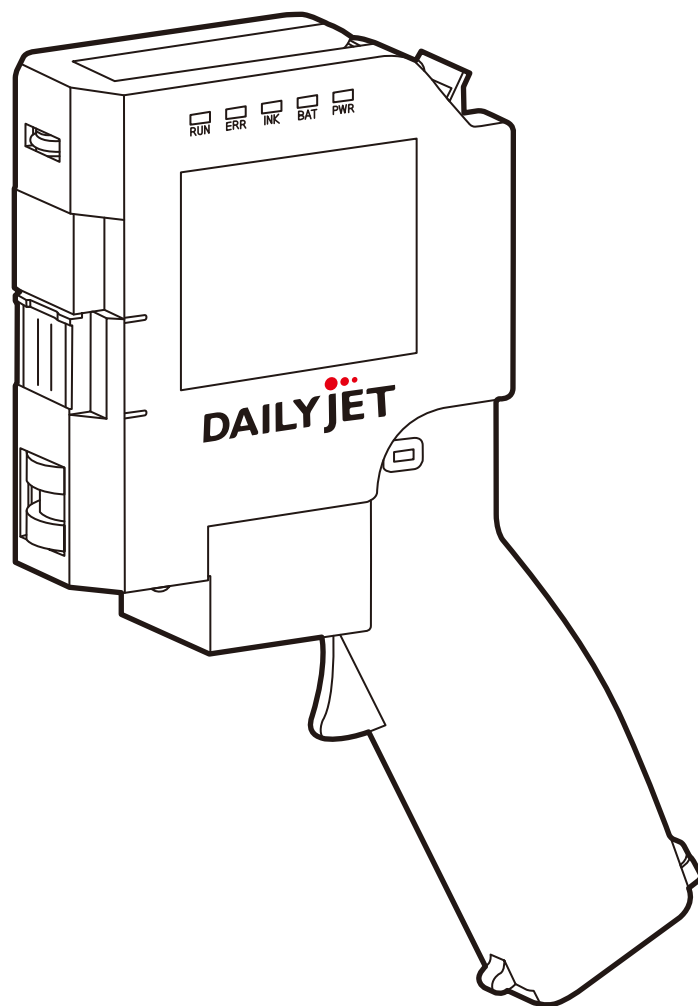

This device complies with part 15 of the FCC Rules. Operation is subject to the following two conditions:

(1) This device may not cause harmful interference, and (2) this device must accept any interference received, including interference that may cause undesired operation.

The users manual or instruction manual for an intentional or unintentional radiator shall caution the user that changes or modifications not expressly approved by the party responsible for compliance could void the user's authority to operate the equipment. In cases where the manual is provided only in a form other than paper, such as on a computer disk or over the Internet, the information required by this section may be included in the manual in that alternative form, provided the user can reasonably be expected to have the capability to access information in that form.



Inkjet
Technology

Copyright

The contents of this manual, including text, images, and illustrations, are subject to copyright protection.

Any reproduction, dissemination, transmission, forwarding, publishing, or disclosure of the manual’s contents without written permission, is strictly prohibited.

Important Notices

The warranty will be voided if any unauthorized alteration or modification of the hardware or software occurs. Furthermore, any damage and injury resulting from unauthorized alteration modifications of the hardware or software is not covered by the warranty. The Manufacturer does not have any legal responsibility for the results of any unauthorized alteration or modifications.

Use of any unauthorized ink cartridges, hardware, or software will void the warranty. Any damage or injury resulting from the use of unauthorized ink cartridges, hardware or software is not covered by the warranty. The Manufacturer does not have any legal responsibility for the results of use of unauthorized ink cartridges, hardware, or software.

This machine is a precision instrument. Please do not drop it, soak it in water or intentionally operate the machine in harsh environments. Doing so will result in the warranty being voided. The Manufacturer does not have any legal responsibility for the results of inappropriate use of the machine.

To ensure high quality printing and optimal machine function, please follow all instructions laid out in this manual.

Cartridge Information

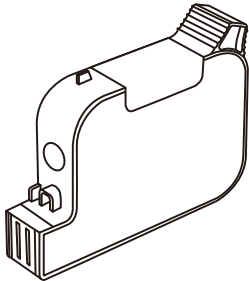
	Inkjet technology: HP Thermal Inkjet Chip technology: HP I-Code encryption
	The model of ink cartridge may vary based on geographic location.

We strongly recommend that you use genuine HP ink cartridges.

The manufacturer cannot guarantee printing quality or device function if genuine HP cartridges are not used.

Use of non-genuine HP ink cartridges will void the warranty and may result in device malfunction.

Use of non-genuine HP ink cartridges may result in the inability to read the I-Code, set the correct voltage, and display ink levels.

Copyright ©2018 SINLETAI CO., LTD. All rights reserved.

Contents

1	Safety Precautions	3
2	Product Overview	5
3	Printer Setup	8
	Ink Cartridge Installation	8
	Micro SD Card	9
	Turning on the Printer	10
	Software Installation	12
4	Basic Operations	16
5	Creating Print Messages	18
	Basic Operations	18
	Creating a Text Message	20
	Creating Serial Numbers	21
	Creating a Time Stamp	22
	Creating a Barcode	24
	Creating a Matix Barcode	25
	Creating an Image	26
6	Connecting the Printer to a PC	27
7	Transferring Print Messages	28
8	Printer Settings	29
	Description of All Settings	29
	Configuring Operating Direction	31
	Configuring Dynamic Serial Number	32
	Configuring Active Nozzles	33
	Configuring Print Density	34
	Printhead Printing Test	35
	Configuring Software Language	36
9	Basic Cleaning Guide	37
	Cleaning the Printhead	37
10	Troubleshooting	38
	Ink Level	38
	Low Battery	38
	Resolving Poor Print Quality	39
	Troubleshooting	40
	Firmware Updates	41
11	Technical Information	42

1 Safety Precautions

Please follow the safety precautions to operate the hand printer safely and correctly.

Please follow the safety precautions to avoid any injury and any damage to the printer and the cartridge.

Please follow the safety precautions to avoid damage resulting from improper usage that would void the warranty.



Warning

Warning: Failure to follow the instructions when operating the printer may cause bodily injuries or severe damage to the printer.



Caution

Caution: Failure to follow the instructions while operating the printer may cause bodily injuries or severe damage to the printer.



This symbol denotes procedures that are absolutely prohibited.



This symbol denotes that the procedures that must be followed.



Warning



Do not use any third-party power adapters.

Use of other power adapters may cause fire or electric shock.



Only use the power adapter included in the original package.

Ensure the power adapter complies with local safety standards.



Do not cause any damage to the power adapter.

Please store the power adapter appropriately. A damaged power adapter may cause fire or electric shock.



Do not use the printer in the following conditions or environments. Please store the printer and ink cartridges appropriately.

- Direct sunlight or strong light.
- Abnormally high temperature.
- Near open flames.
- In excessively dusty environments.
- In very damp or moist environments.
- Near corrosive or flammable material.
- Near paints, oils, or other chemicals.
- In environments with high static electricity.



Ink cleaning procedure

If your skin directly contacts the ink, please wash thoroughly with soap and water. If the ink contacts your eyes, immediately flush them with clean water. If the ink contacts your mouth, immediately rinse and wash with clean water. If you do not feel well, please seek immediate medical attention.



Do not attempt to disassemble or repair the printer.

Please do not attempt to disassemble, repair, or modify the printer. If have any questions, please contact the distributor.



Should the printer malfunction or enter an otherwise abnormal state, immediately stop using it.

Please keep foreign materials away from the printer or ink cartridge. If there is smoke or odors coming out of the printer, immediately cease operation, turn off the printer, unplug the power adapter, and contact the Manufacturer.



Caution



Do not mix different brands of batteries.

Mixing may result in abnormal heat, battery rupture, or leaking battery fluid.



Please remove the batteries and store them safely if the printer will not use for a long period.

Leaking battery fluid may cause damage to the printer.



Do not use non-genuine ink cartridges.

Such use may cause poor printing, ink leakage, or damage to the printer.



Do not intentionally shake the printer.

Shaking may cause ink to leak from the cartridge and other damage to the printer.



Do not touch the printhead with your hand or strike the printerhead with any hard object.

This may cause poor printing, ink leakage, or damage to the printer.



Do not use any corrosive solvent to clean the printerhead.

This may cause inkjet deformation or splitting, as well as ink deterioration or discoloration.



Please use the printerhead cap appropriately.

Please use the printhead cap after printer usage, or cartridge replacement. The cap protects the printerhead from foreign materials that could degrade print quality.



Please store the printer appropriately if it will not be used for a long period.

For long-term storage, please place the printer into the toolbox to avoid dust, moisture, or other contaminants.



Please store the ink cartridge safely.

Please store the ink cartridges in a location out of reach of children.



Please do not intentionally shake ink cartridges.

Intentional shaking may cause ink to leak from the cartridge.

Auxiliary Roller

The auxiliary roller assists the main roller ensuring the printer runs smoothly to achieve quality prints.

Printhead Cap

Please use the printhead cap after printer usage or cartridge replacement. This protects the printhead ensuring quality prints.

Ink Cartridge Slot

The ink cartridge will be inserted here.

Main Roller

When printing, the main roller must be able to roll on the print surface.

Active Button

In order to print, hold the active button while rolling the printer flush with the print surface.

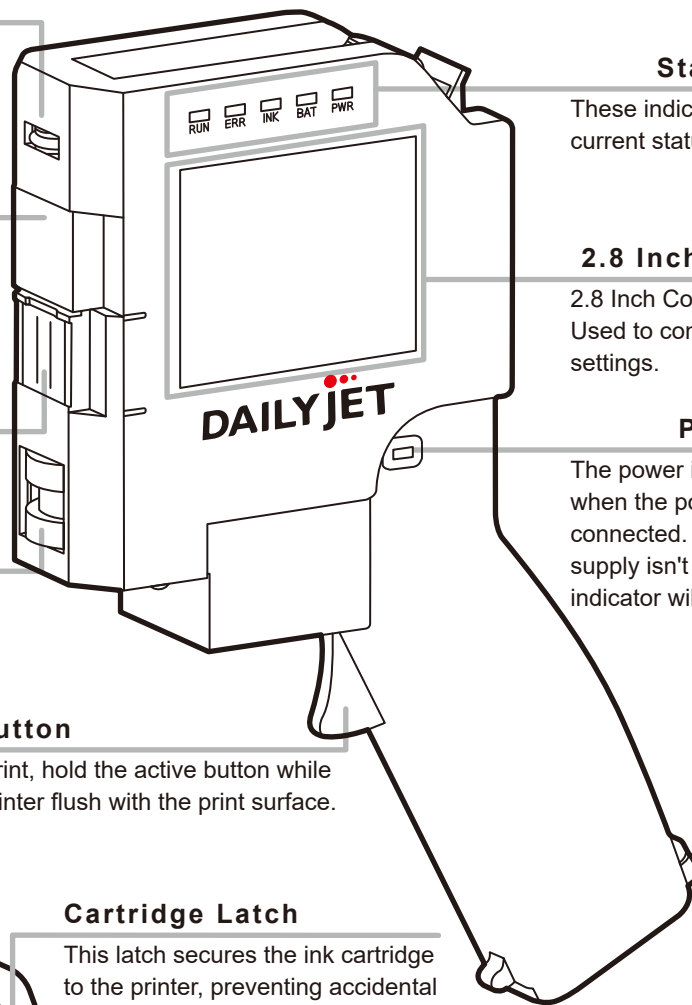

Status Indicators

These indicators display the current status of the printer.

2.8 Inch Touch Screen

2.8 Inch Colorful Touch Screen
Used to configure printing and settings.

Power Indicator

The power indicator will light up when the power supply is connected. When the power supply isn't connected, the indicator will turn off.

Cartridge Latch

This latch secures the ink cartridge to the printer, preventing accidental cartridge release.

Mini USB Port

The mini USB port is used to transfer print messages and printer settings from your computer.

Micro SD Slot

Insert the micro SD card used for storing print messages in this slot. This printer only supports cards formatted in FAT32.

Power Switch

Toggles power states. The printer must be turned on in order to configure settings and print messages.

AC Power Port

Plug in the power supply to give power.

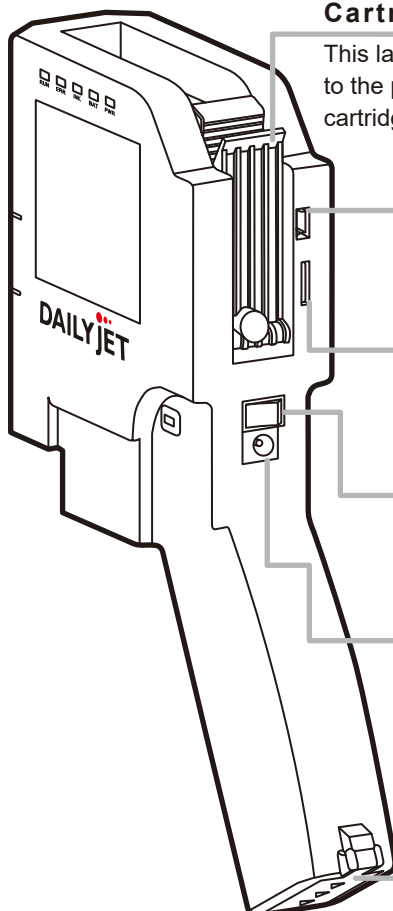

Battery Compartment

Used to store two 18650 Lithium-ion batteries. Open the cap to place the two batteries in the compartment.

Handy Printer Operating Display Panel

The actual display panel may differ slightly from the one depicted in this manual.

Status Indicators

RUN: Active Printing (Green)

This indicator will blink whenever the active button is depressed and will remain blinking until the active button is released.

ERR: Error Status (Red)

This indicator will light up whenever the printer encounters an error. A numeric error code will be displayed on the mode indicator panel as well as a brief description on the LCD preview.

INK: Low Ink Warning (Yellow)

When the ink level reaches pre-determined value the indicator will light up. The low ink threshold can be configured in the settings.

PWR: Power On (Green)

When the printer is turned on, this LED will light up and will stay lit until the printer is turned off.

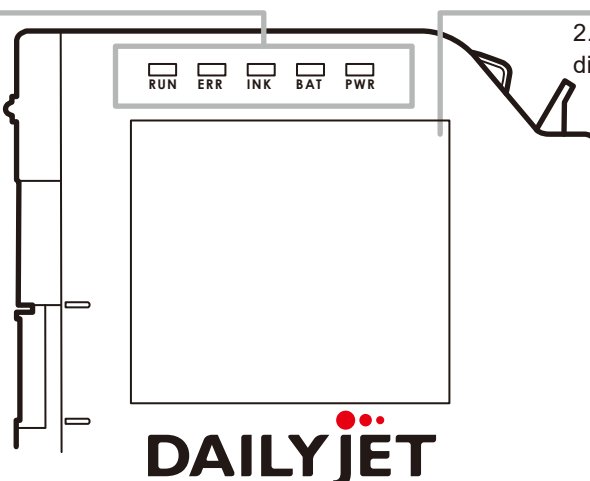

2.8 Inch Touch Screen

2.8 Inch Touch Screen preview displays the print message contents, settings, and error messages.

Use it to set printing mode and settings configuration mode, confirm the actions in print or settings configuration mode, or change print messages or change settings.

BAT: Battery Low (Red)

When the battery is lower than the pre-set value, this LED will light up. Low battery may result in low quality prints, or inability to print.

Parts and Accessories

The actual parts and accessories may differ slightly from the ones depicted in this manual.

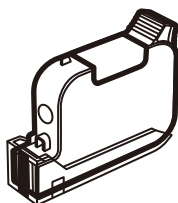

Genuine HP Ink Cartridge

The Ink cartridge must be purchased separately and does not come with the printer.

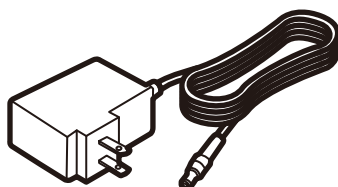

AC Power Adapter

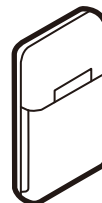

Lithium-ion Battery Charger

This is used to charge the printer's batteries.

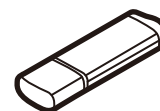

USB Flash Drive

The printer software and operation manual are stored on the USB flash drive.

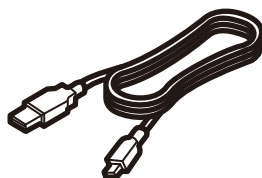

USB Cable

Use the USB cable to connect the printer to your computer.



Micro SD Card

The micro SD card is used to store the print messages. The card comes already installed on the printer.



Lithium-ion Battery Batteries (2)

Place the Lithium-ion batteries in the battery compartment prior to operating the printer. Use the original factory supplied the Lithium-ion batteries.

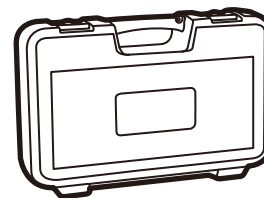

Toolbox

Parts and accessories should be stored in the toolbox.

Software Configuration

The actual interface may differ slightly from the one depicted in this manual.

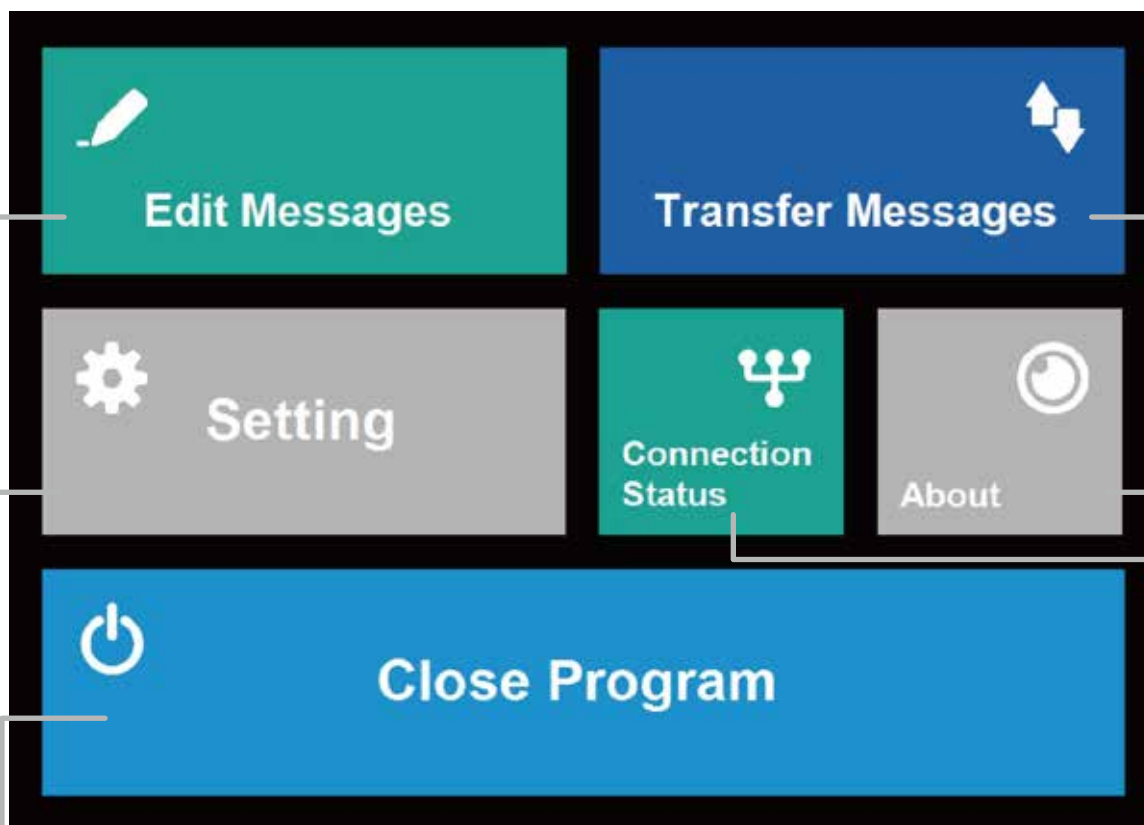

Close Program

Used to close program.

Setting

Contains printer settings and operations.
When connected printer, you can set and inquire printer settings or PC software informations.

Edit Messages

Used to set messages of text, time, barcode, matrix barcode, serial number and image.
It has five message groups, one group has 10 message slots (0-9).
Allow for up to 50 messages to be stored in five message groups.

Connection Status

Used to connect to the printer.
When connected printer, you can send messages to printer, settings configuration mode, set printing mode.

About

Used to inquire PC software informations.

Transfer Messages

Export a message or group of messages to the printer.
When disconnect the printer, you can printing of export messages.

3 Printer Setup

Ink Cartridge Installation

The actual ink cartridge may differ slightly from the one depicted in this manual.

Warning

Please turn off the power when installing or removing ink cartridges.

1

Take out the ink cartridge from the package and remove the printhead cap.

Warning

Do not touch the inkjet head or soft plate electrodes at the bottom of the cartridge to avoid any damage or oxidation.

Please do not discard the printhead cap. When the printer is not in use, please remove the ink cartridge and put the printhead cap back on.

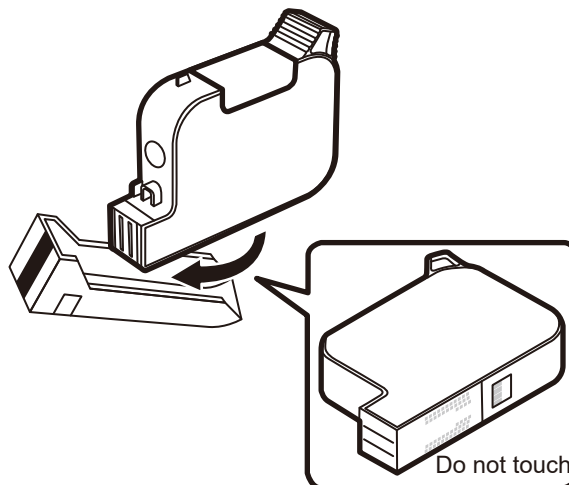

2

Open the cartridge latch and slowly insert the ink cartridge from the back of the printer. When the cartridge is properly installed, the printhead is exposed at the front of the printer. Please make sure that the ink cartridge is properly installed in the handy printer.

During installation of the ink cartridge, please do not bump into the wafer detector or ink cartridge detector. This may cause damage to the detectors or poor printing.

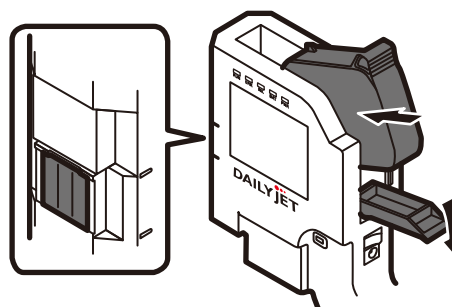

3

After checking that the cartridge is properly installed in the printer, close the cartridge latch. At this point, the ink cartridge is securely installed in the printer.

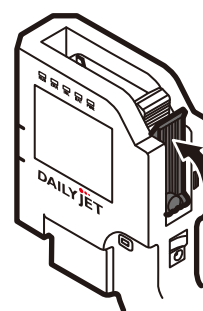

Warning

Please use the printhead cap after printer usage. The cap protects the inkjet head from foreign materials as well as drying.

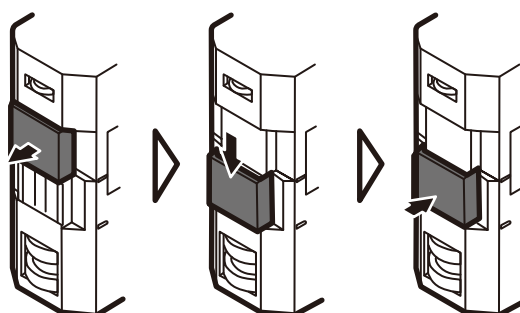

Micro SD Card

The actual micro SD card may differ slightly from the one depicted in this manual.

The micro SD card should be already installed in the printer.
Please check to see whether the micro SD card is installed in the printer.

Warning

The micro SD card stores the print messages. The printer cannot be operated without the micro SD card.

Please keep the micro SD card securely locked in the printer at all times. Please do not remove the micro SD card unless absolutely necessary.

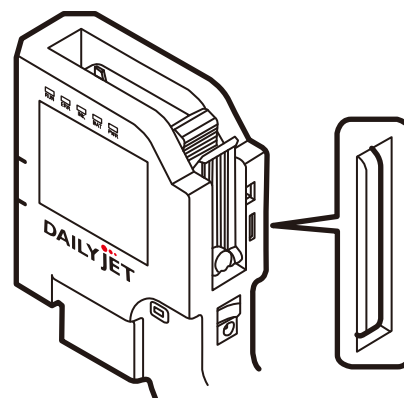

Micro SD Card Insertion and Removal

Push the micro SD card in the slot until it clicks in.

Push the micro SD card slot again to release it.

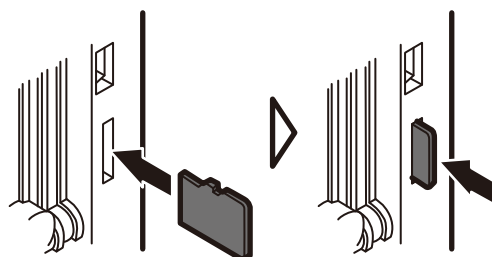

Warning

Please insert the micro SD card in the correct direction. Otherwise, the printer cannot be operated.

Please carefully remove the micro SD card. The card may fall out of the slot during removal.

If you do not use the micro SD card that comes with the printer, please format the micro SD card to FAT32.

Turning on the Printer

Lithium-ion Batteries

The actual lithium-ion batteries may be differ slightly from the ones depicted in this manual.

- 1 Open the cap of battery compartment and place the two batteries inside.

Warning

Please ensure the batteries are placed correctly. Incorrect placement will prevent the printer from turning on.

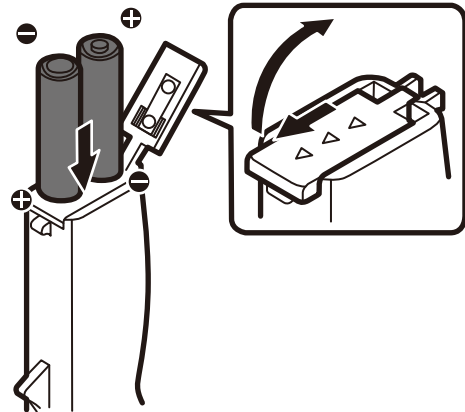

- 2 After correctly placing the batteries, securely close the battery compartment's cap.

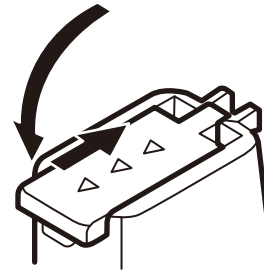

- 3 Turn on the power switch. When turn on the power, you will hear a power on sound and the PWR LED light will light up.

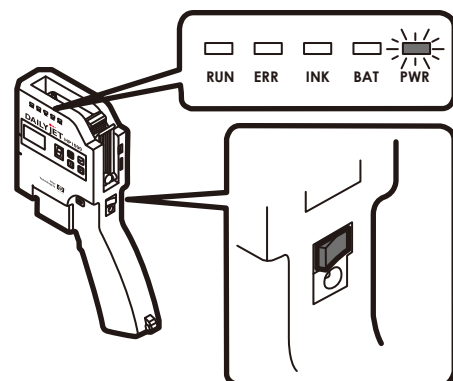

Warning

The printer cannot be operated without the two lithium-ion batteries correctly secured in the battery compartement.

AC Power

The actual AC Power adapter may differ slightly from the one depicted in this manual.

AC Power Adapter

You can choose to use lithium-ion batteries or AC adapter to give power for printer.

If you want to use handheld printer for long time, used AC adapter is the best choosing.

- 1** Make sure the AC power adopter is plugged in to the printer and the AC power socket.
When the power is connected, the power Indicator light will turn on.

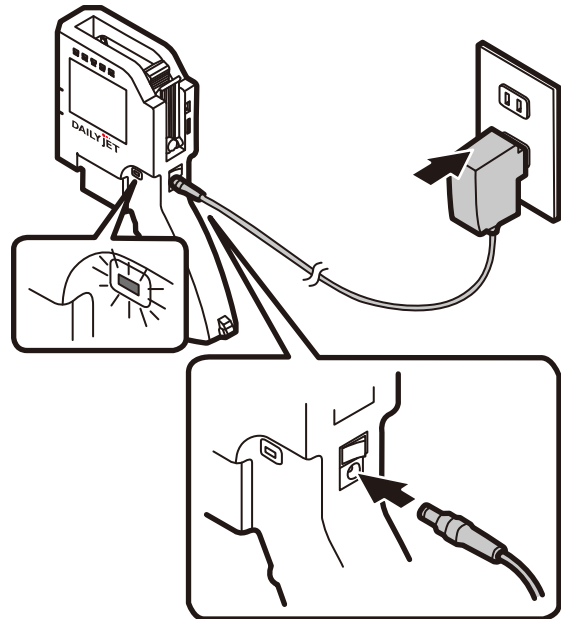

- 2** Turn on the power switch.
You will hear the power on sound and the PWR LED will light up.

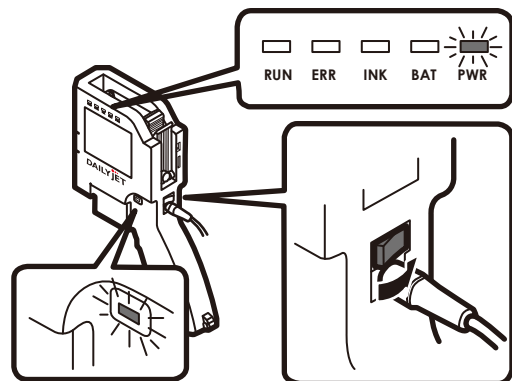

Software Installation

The actual software may differ slightly from the version depicted in this manual.

In order to create new print messages, the software must be installed on your computer or Android system (Not yet to support).

All required installation files are on the USB flash drive that is included with the printer.

Supported Operating Systems

- Windows 10 (32bit/64bit)
- Windows Vista (32bit/64bit)
- Windows 8 (32bit/64bit)
- Windows XP (32bit)
- Windows 7 (32bit/64bit)

Warning

- ".NET Framework 4.0" is required to install this software.
- The software installer will automatically check for ".NET Framework 4.0" on your computer. If it is not installed, the installer will notify you. The installer for ".NET Framework 4.0" can be found on the USB drive provided with the printer. You may also download ".NET Framework 4.0" from the internet.

- 1** Please plug the flash drive into your computer.

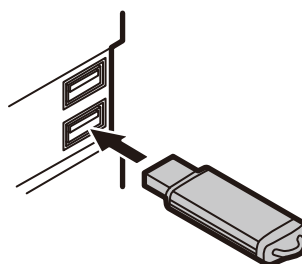

- 2** Double-click the "DAILYJET HP1200Setup" installation file on the USB flash drive to begin the installation.



- 3** Click the "Next" button on to begin the installation process.



4

You may change the directory where the software is installed, or leave it in the default location. Click the “next” button to proceed.

To change the installation directory, click the “Browse...” button on the installation screen.

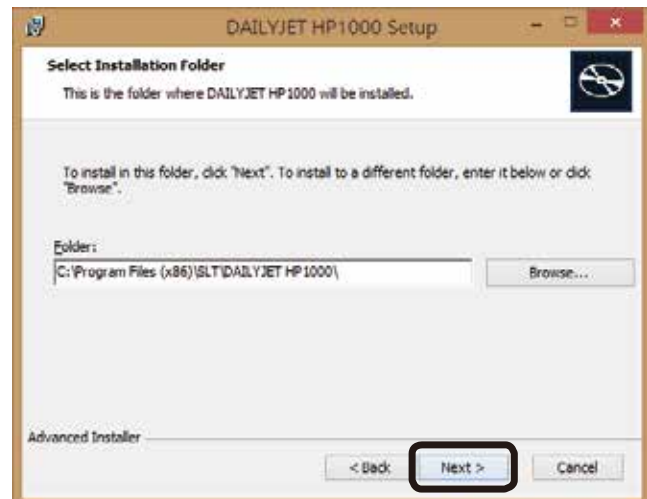

5

Click "Install" begin installation.



6

To complete installation, the FTDI CDM driver package must be installed. Click “Extract” to begin installing the drivers.



- 7** Click "Next" to continue installing the drivers.

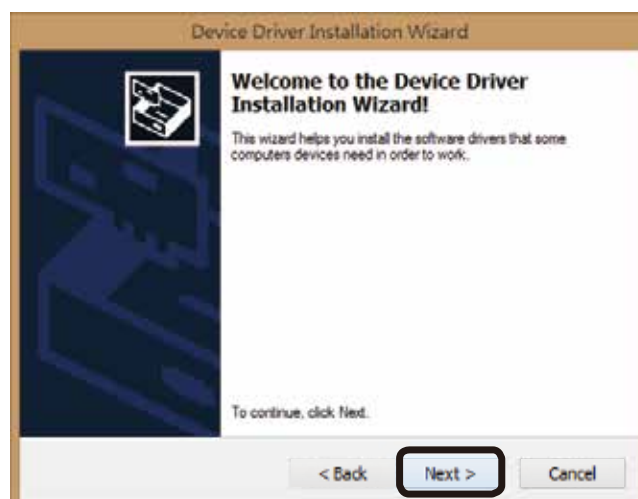

- 8** The FTDI CDM driver package installation is now complete. Click the "Finish" button in the installation window to continue.



- 9** All required files have now been installed. Click "Finish" to exit the installer.

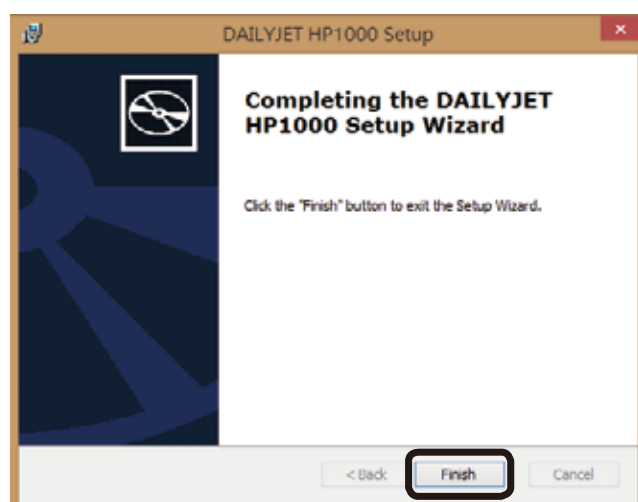

10

After the software is installed, please copy the "programsetting" file from HP1200_programsetting of USB file, and put it into "setting file" of the directory where the software is installed, and replace the original file of "programsetting".

Warning

Please don't change the name of "programsetting" file.
If the name is changed, PC software isn't opened and operated.



11

After the file is replaced, there will be a shortcut for the software on the desktop. Double click the shortcut to open the software.

Warning

If you cannot open the software, please reboot your computer.
If the software still cannot be opened, please uninstall and then reinstall the software.
If you still cannot open the software please contact the distributor.

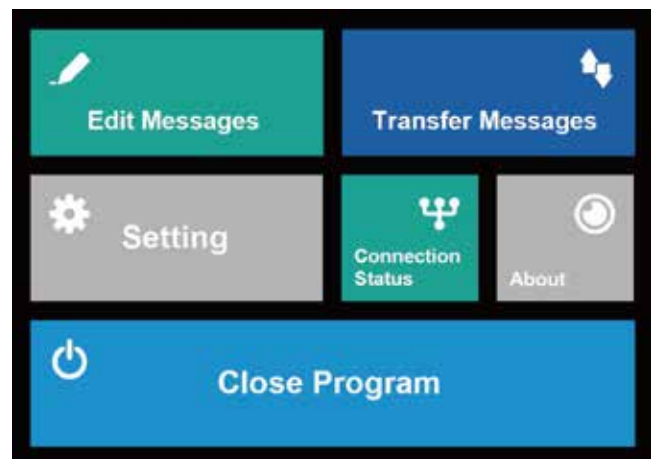

12

Please unplug the flash drive and store it properly after completing the software installation.

Warning

Please safely remove the USB flash drive from the computer to avoid data corruption.

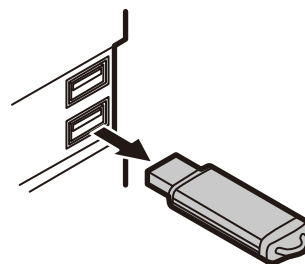

Uninstalling the Software

To uninstall the software, click "Uninstall DAILYJET HP1200" in the installation directory.
In addition, the software can also be uninstalled from the Control Panel (Control Panel→Programs→Uninstall a Program).



4

Basic Operations

The printer comes with sample print messages pre-loaded.
This manual will use the sample messages to illustrate basic operations.

- 1** Click Setting mode on the 2.8 Inch Touch Screen to switch between settings configuration mode and print mode.
When in printing mode, the 2.8 Inch Touch Screen will display printing informations.
When in settings configuration mode, the 2.8 Inch Touch Screen will display setting informations.

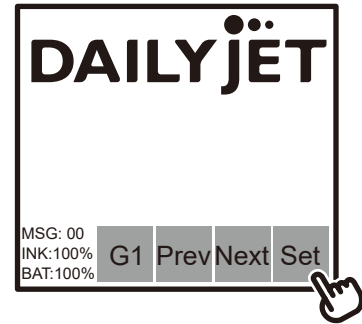

- 2** Press the selection keys to select different print messages.
The current print message will be displayed on the 2.8 Inch Touch Screen.

⚠ Note

The printer comes with 10 preloaded print messages in message group one. (numbered 0-9) for testing purposes.

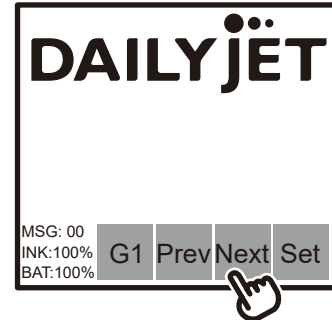

- 3** When in function setting mode, the 2.8 Inch Touch Screen will display settings options. You then click setting option to confirm the setting you are changing.

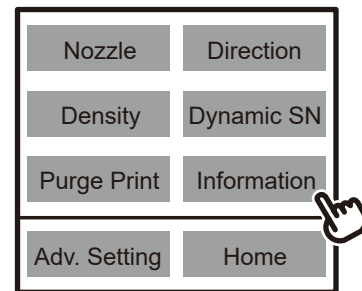

- 4** Place the printer flush against the printing surface, ensuring that the main and auxiliary printer are properly positioned.
Use the vertical reference line to correctly position the printer on the print surface.

⚠ Warning

To maintain quality printing, make sure that the main and auxiliary roller are directly in contact with the print surface.

On uneven surfaces, the auxiliary roller can be lifted slightly off the print surface to ensure quality printing. However, if the gap between the auxiliary roller and print surface is too big, it may result in poor printing. Please test multiple times when lifting the auxiliary roller off the print surface.

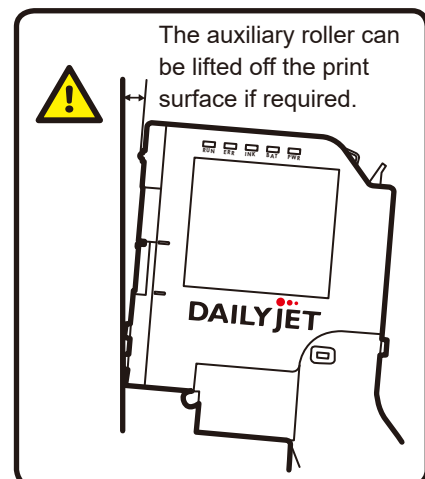
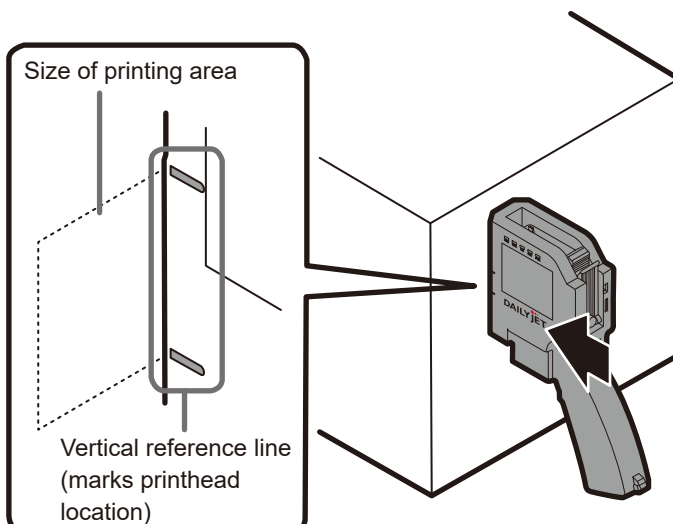

5

Once the printer is correctly aligned and flush with the print surface, hold down the active button. When the active button is held down, the RUN LED will light up. The 2.8 Inch Touch Screen will turn off. Then the printer will beep indicating that it is ready to print. While holding the active button, move the printer until the message is printed completely. After the message has been printed, the printer will beep again. At this point, release the active button. The RUN LED will turn off, the 2.8 Inch Touch Screen will turn on.

⚠ Warning

- If the active button is released prematurely during printing, the printer will detect an error. It will beep three times indicating that the printing was interrupted.
- Please roll the printer at a reasonable and consistent speed. There may be a degradation of quality if the printer is moving too quickly, slowly, or if there is a large change in rolling speed.
- The specific speed that the printer must be rolled at depends on print density.
If print density is set to "1": the printer should be rolled at about 30m/1min.
If print density is set to "2": the printer should be rolled at about 15m/1min.
(Please refer P35. Configuring Print Density)

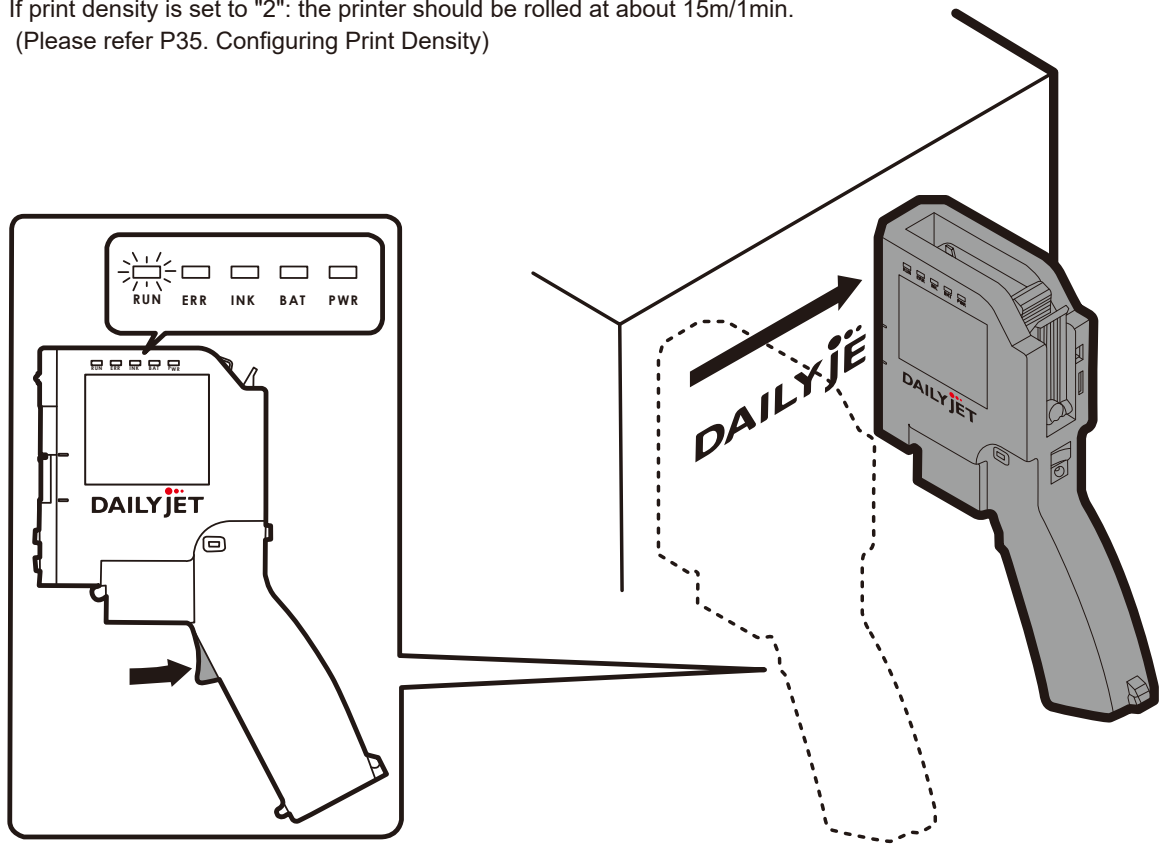

⚠ Warning

Please use the printhead cap after printer usage. The cap protects the inkjet head from foreign materials as well as drying.

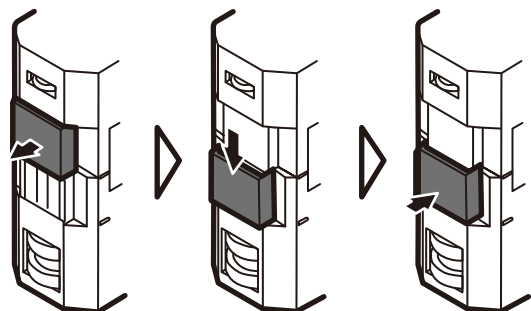

Print messages must be created using the software included with the printer.
This section describes how to create new print messages.

Basic Operations

- 1 Select the slot you would like to create your message in (0-9).

- 2 Select the message type.

- 3 The message type you selected will now be highlighted. Now you can begin creating the message in the editing window. You can access the advanced editing menu by double clicking the recently created message. This menu allows font, text size, and formatting to be changed. You can also move the message within the editing window by left clicking and dragging it about. Changing message position within the window will affect the print layout.

⚠ Warning

To change the vertical position of the message, right click and drag up or down. To delete the message right click, and the delete menu will pop up.

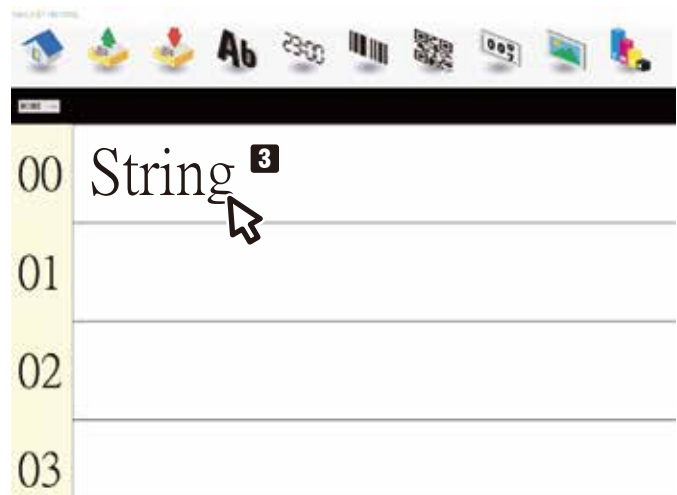
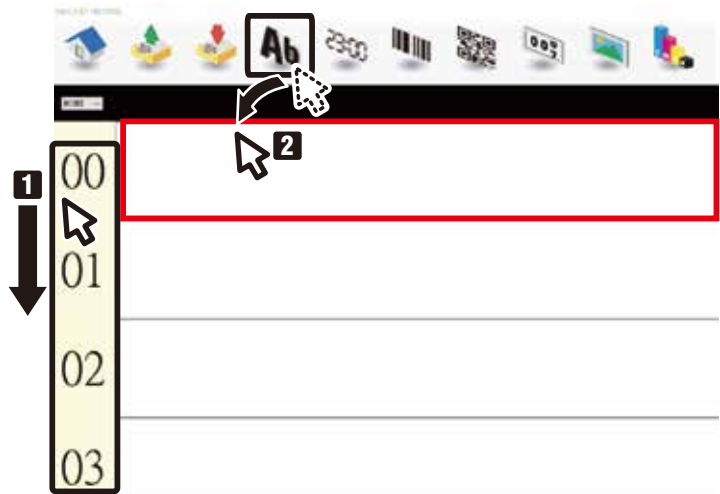

Create One or More Print Messages

- 1 Left click on print message number. You can choose "Clear this message" or "Clear all messages" to create one or more new print messages.

⚠ Warning

If you create new messages in slots with existing messages, the previous messages will be overwritten.

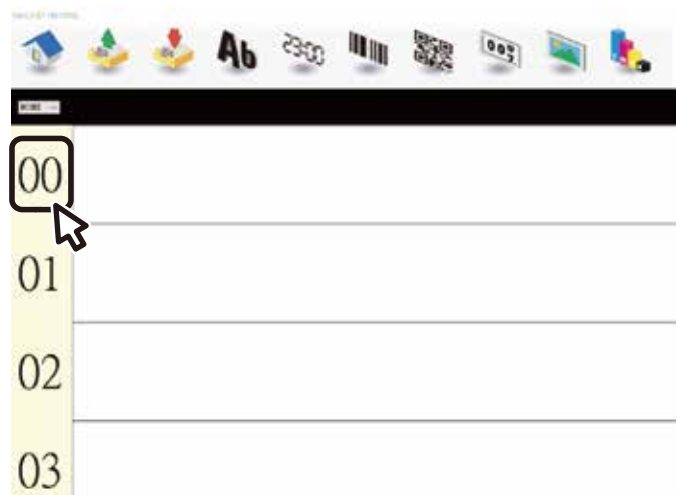



Saving Print Message

- 1 Left click on  to save the current message that is being worked on.



- 2 Select the location you wish to store the file, enter the file name, and click "save" to save the message file.

Warning

PBM files are used to store single messages.
PGF files are used to relate multiple PBM files in a group.



Opening Existing Messages

- 1 Left click on  to open your print messages.



- 2 From the file selection menu, navigate to where the messages are stored and chose a message (PBM) or a message group (PGF) to open.

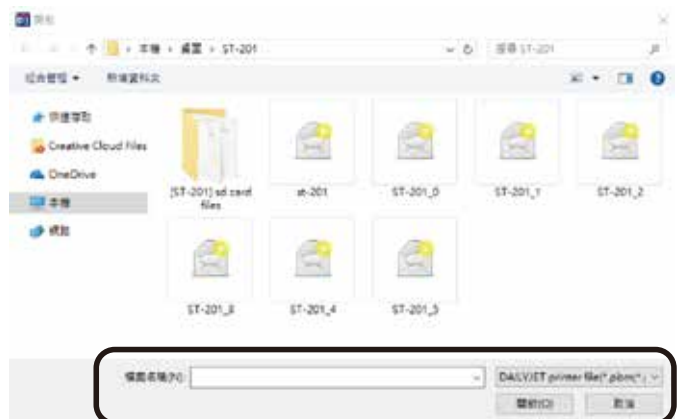

- 3 The PBM file stores individual message files.
The PGF file stores message group files.



Ab Creating a Text Message

1

Left click on **Ab** to create a new text message.

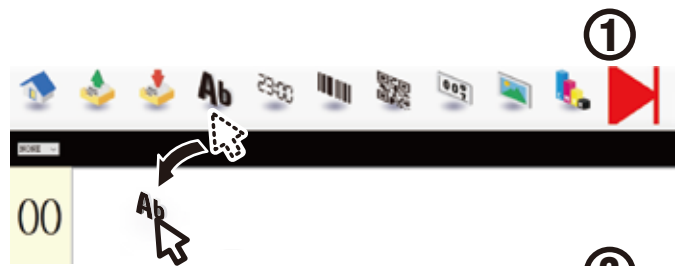

2

The editing window will now contain the default message text.

⚠ Note

To enter typing mode, click on the message. A black frame should appear, indicating that typing mode is now active. To exit typing mode, click the message again. The message cannot be edited outside of typing mode.



3

Double click the message to enter advanced editing mode. Here you can change the font, font size, and formatting.

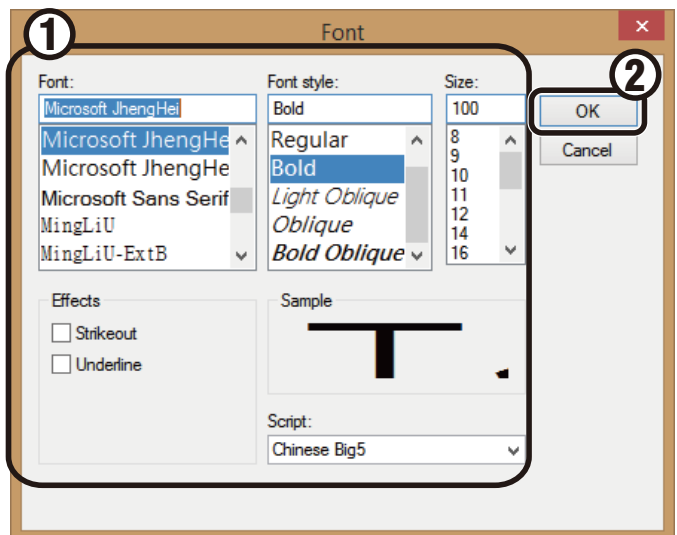



Creating Serial Numbers

Select the base serial number, all subsequent serial numbers will increase or decrease by one.

You can combine a serial number with other message types in a single message.

1

Left click on  to create a serial number.

Move to the editing window and click the background to begin editing the serial number.

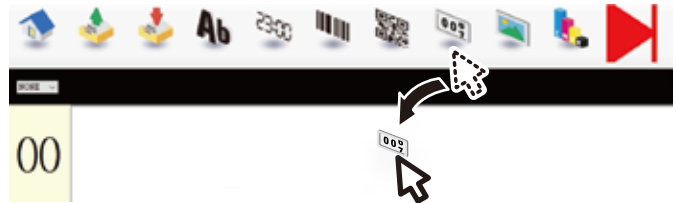

2

Set the start value, step value, number of digits, end value, repeat After End, and font size. Click OK to complete the setup.

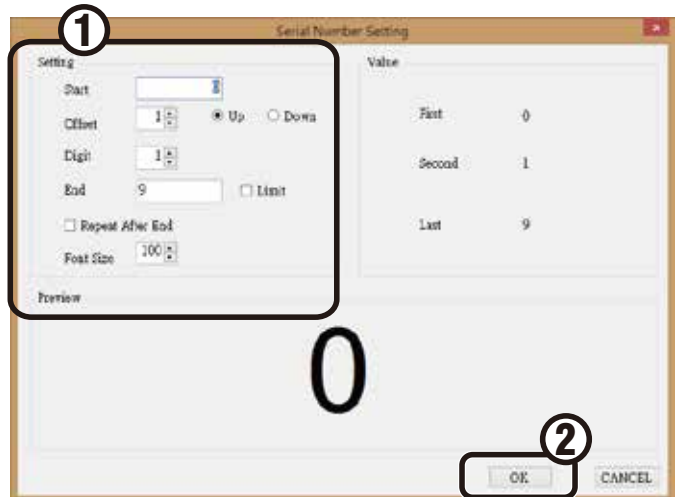

Parameters	Description
Start value	The initial value of the serial number. This can range from 0 to 99,999,999.
Step value	The number the start value changes by every print. Select add or subtract, and make sure that the step value is between 1 and 100.
Number of digits	The number of digits of the serial number, ranging from 1 to 8. If the number of digits specified is greater than the base serial number, leading zeroes will be added. For example, if the base number was 33 and the number of digits selected was 4, then two extra zeroes would be appended, making the base 0033.
End value	When the serial number reaches this value, it will either restart from the base or stop incrementing/decrementing. The behavior is dependent on if cycling is turned on or off. If there is no end value set, the end value will default to 99,999,999.
Repeat After End	Determines if the serial number will continue incrementing/decrementing from the base after reaching the end value.
Font size	Font size of serial number.

3

The serial number's base value will now be displayed in the editing window. To modify the serial number, double click the serial number to return to the serial number configuration window.



23:00 Creating a Time Stamp

You can create a time stamp to keep track of date or time.

The printer will automatically update the time stamp's date and time.

1 Left click on 23:00 to create a time stamp.

The click on the editing window to enter the time stamp configuration menu.

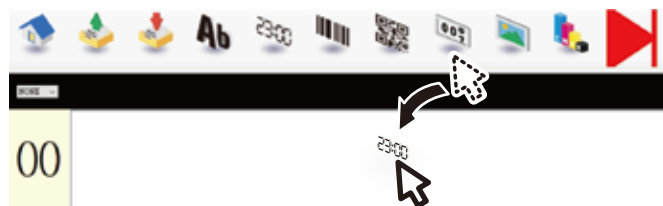

2 Configure the format of time stamp, batch modification, and time displacement. The time stamp can be previewed on the right side of the configuration menu.

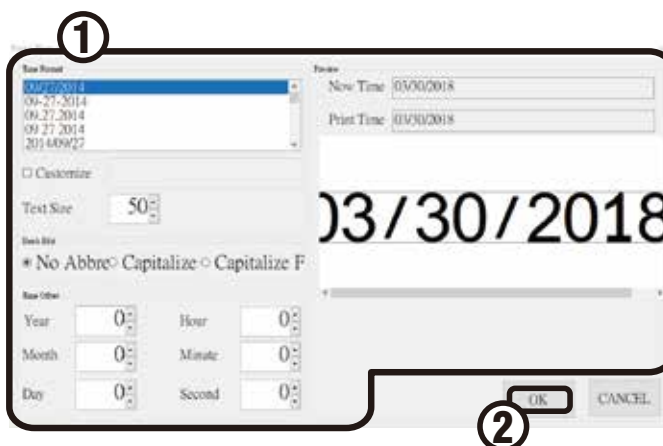

Parameters	Description
Time stamp format	Commonly used formats are listed in the settings. Select your format from the list of formats. To create your own format, select the customize option. After selecting the customize option, enter your desired format. To learn more about creating a custom time format, see the next page.
Time displacement	The printer can be configured to add a fixed amount of time to the time stamp from the date of printing. For example, if displacement was set to 15 days and the print date was 2/11/2016, the time stamp would display 2/26/2016.
Preview	The preview will display the current time and the print time. The current time will be displayed on top, and the print time on the bottom. The print time will include any time displacement you have added, and will be output in the format of your choice.

3 The timestamp will be shown in the editing window after the time stamp setup is completed. To return to the time stamp setup, just double click the time stamp.



Custom Time Format

Note

If the format is entered correctly, the printer will display a .

If the format is entered incorrectly, the printer will display a .

Output	Code	Description
Year	yy	Two-digit year (20YY).
	yyyy	Four-digit year (YYYY).
Month	M	Month without a leading zero if less than 10.
	MM	Two-digit Month with a leading zero if less than 10.
Day	d	Day without a leading zero if less than 10.
	dd	Two-digit Day with a leading zero if less than 10.
Hour	H	24-hour format without a leading zero if less than 10.
	HH	24-hour format with a leading zero if less than 10.
	h	12-hour format without a leading zero if less than 10.
	hh	12-hour format with a leading zero if less than 10.
Minute	m	Minute without a leading zero if less than 10.
	mm	Two-digit Minute with a leading zero if less than 10.
Second	s	Second without a leading zero if less than 10.
	ss	Two-digit Second with a leading zero if less than 10.
Other	tt	Display AM or PM based on the time.
	W	Display the week number without a leading zero if less than 10.
	WW	Display a two-digit number indicating week number with a leading zero if less than 10.
	x	Display day number completely without leading zeroes.
	xxx	Display the day number with all leading zeros.
Symbol	/	These symbols are delimiters that can be used in time stamps. They must be enclosed by single quotes, e.g. ' '.
	:	
	—	
	•	
	Space	

Creating a Barcode

- 1 Left click on  to create a barcode.
A sample barcode will appear in the editing window.

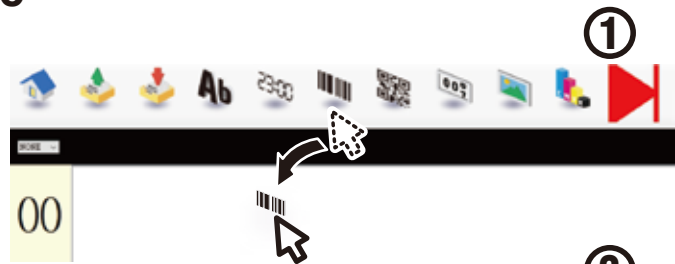

- 2 Double-click the preset barcode message to enter barcode configuration mode.



- 3 Configure the format, text, height, width, and if the text should be displayed under the barcode. To preview the barcode, click the "generate" button. Click the OK button after completing barcode configuration.

Warning

Number 3 can set changing barcode, this setting depends on the initial serial number settings. (Please see P21. Creating Serial Number)

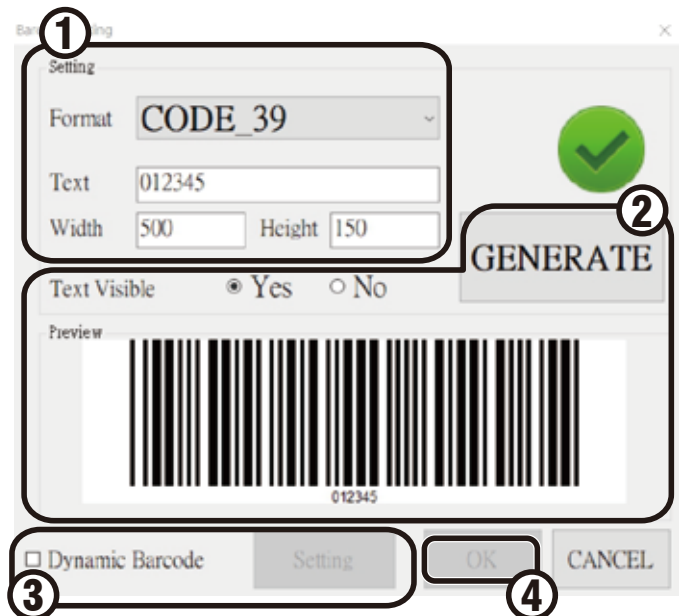

Parameters	Description
Format	The printer currently supports six types of barcode formats. CODEBAR CODE39 CODE93 CODE128 EAN8 EAN13
Text	Enter text here to convert it into a barcode.
Width	Set the width of the barcode in pixels.
Height	Set the height of the barcode in pixels.
Text visible	Toggles whether barcode text is displayed under the barcode.



Creating a Matix Barcode

1

Left click on  to set up a matrix barcode.

Click the editing window, and the preset matrix barcode will appear.

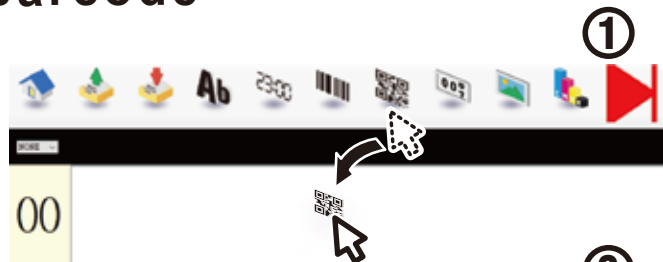

2

Double-click on the preset matrix barcode to enter matrix barcode setup.



3

Configure the format, text, width, height, and quality.

Then click generate to preview the matrix barcode.

Click ok to finish setup.

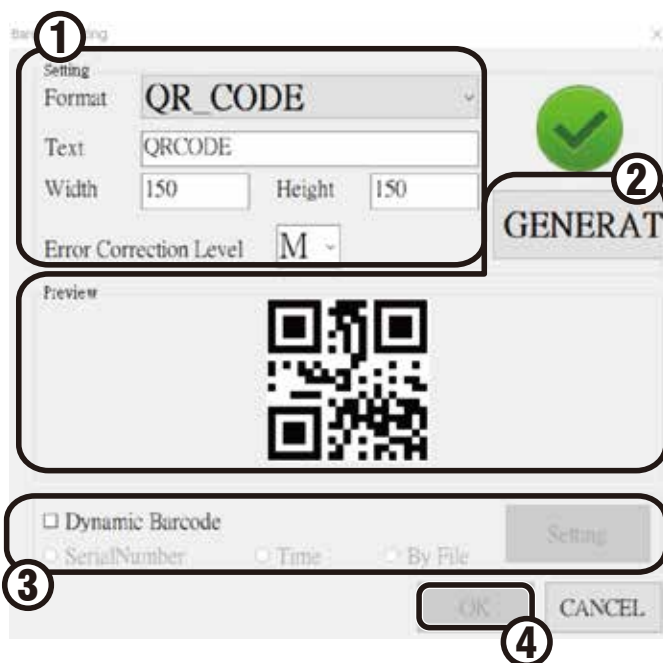

⚠ Warning

Number 3 can set changing matrix barcode, this setting depends on the initial serial number settings or the time stamp settings.

(Please see P21. Creating Serial Number)

(Please see P22. Creating a Time Stamp)

Parameters	Description
Format	The printer currently supports four types of matrix barcode formats. QR CODE DATA MATRIX PDF417 AZTEC
Text	Enter the text here to generate a matrix barcode.
Width	Set the width of the matrix barcode in pixels.
Height	Set the height of the matrix barcode in pixels.
Error Correction Level	Set up the level of error correction level for the matrix barcode. The error correction level percentage indicates the percentage of error allowed. There are four levels of error correction level choose from. · L (7%) · M (15%) · Q (25%) · H (30%)



Creating an Image

1

Left click on  to create an image message.

Click the editing window to select an image to use.



2

Select an image to use.

Note

Make sure your image is in one of the four supported image formats:

- BMP
- JPG
- GIF
- PNG

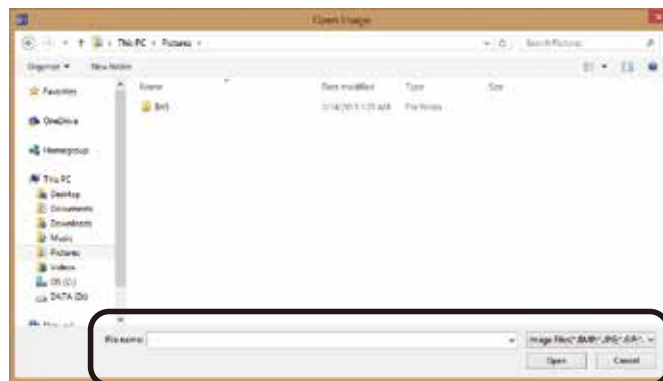

3

After selecting an image, it will be imported as a message and displayed in the editing window.

Warning

This printer only prints in black and white. If a color image is selected, it will automatically be converted into black and white. It is recommended that you convert the image into black and white before importing to maintain image integrity.

If converting into black in white beforehand is not possible, it is strongly recommended that the image be converted into grayscale prior to importing. This will lead to higher image quality when compared to directly importing a color image.

Importing native black and white images will have the best effect.

The maximum supported image dimensions are 150 dot by 4800 dot.

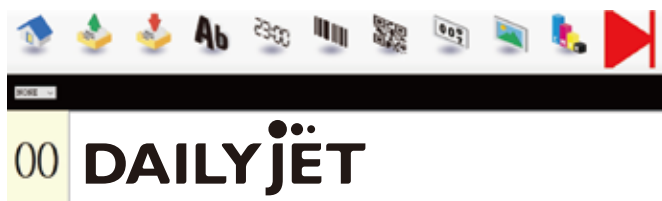

If the image exceeds the maximum dimensions, the image will be automatically scaled back to fit.



Disconnecting the Printer

Click the connect icon  to disconnect the computer software.

After the printer is disconnected, it will beep. On the menu bar, the connect icon  will be replaced by the

disconnect icon . To reconnect the software, please click the Disconnect Icon  to restore the connection.

In order to transfer print messages or configure settings it is necessary to connect the printer to a computer. This section describes how to connect the printer to a computer using the included software.

- 1 Please unplug the AC power adapter before connecting the printer to a computer. Make sure to turn on the printer before connecting it to a computer. When the printer is turned on the PWR LED will light up.

⚠ Warning

Do not plug in the AC power adapter into the printer while it is connected to a computer. This may result in serious damage to the printer.

If you want to use Bluetooth to connect to computer, please must turn on the printer power.



- 2 Please launch the included software before connecting the printer to a computer. Please use the supplied USB cable or Bluetooth to connect the printer to a computer. Use "Scan BT devices" to search the printer.

⚠ Warning

Make sure to connect the smaller end of the USB cable to the printer and the larger end to the computer. Make sure to open Bluetooth of computer.

- 3 Once connected, the computer will automatically detect the printer. The printer will beep when the connection is

established. On the menu bar, the disconnect

icon  will be replaced by the connect icon .

⚠ Warning

If the connection cannot be established, please try the following troubleshooting.

About USB connected:

1. While the printer and computer are still connected, re-open the software.
 2. When the printer and the computer are still connected, click the Disconnect Icon.
 3. Reconnect the USB cable.
 4. Check if there are multiple instances of the software running.
 5. Check whether the software supports your computer's operating system.
- If you cannot resolve the problem, please contact the distributor for assistance.

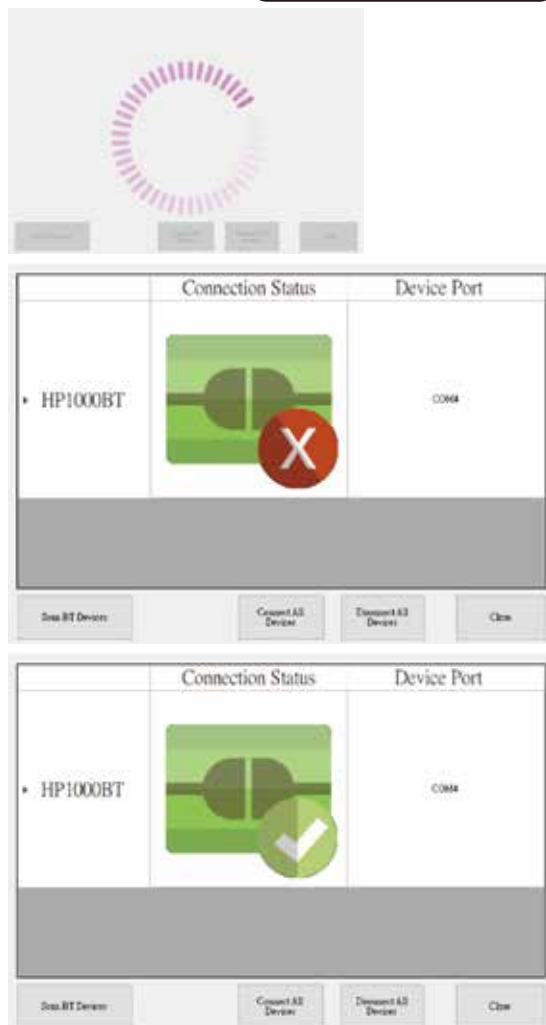
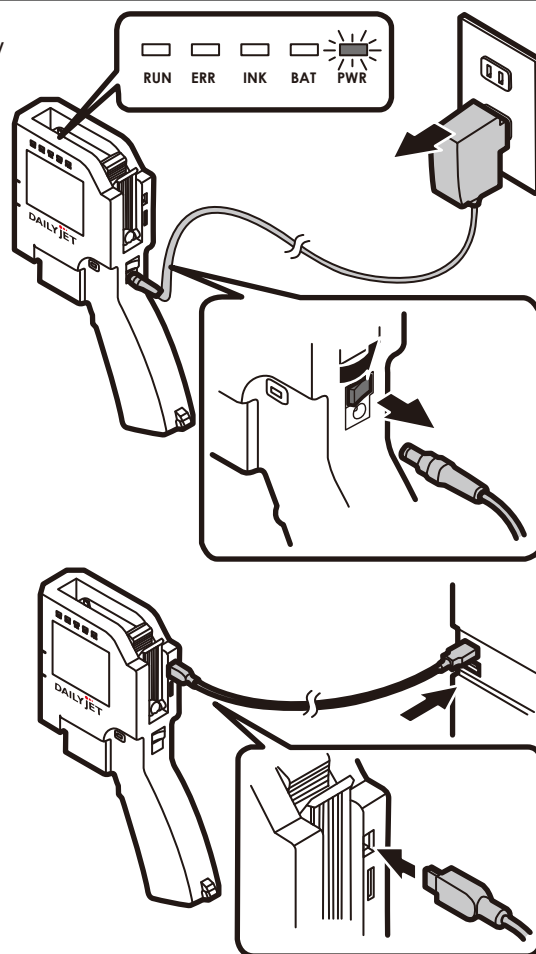

7

Transferring Print Messages

The printer will only print messages that have been transferred to it through the provided software. This section describes how to transfer messages to the printer using the provided software.

1

Make sure the printer is connected to the computer.
(Please see P27. Connecting the Printer)

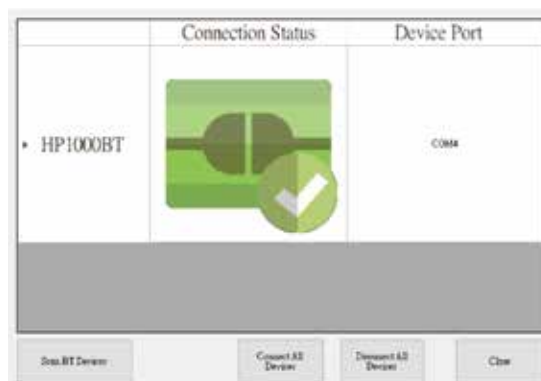

2

Click the transfer messages icon to enter the selection menu.

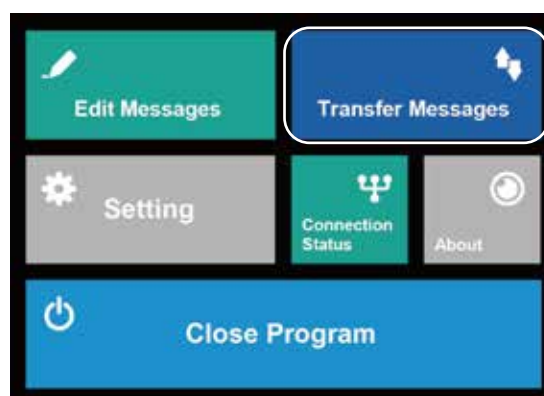

3

Select the first radio dial to transfer the currently selected message slot.
Select the second radio dial to transfer multiple messages. When transferring multiple messages make sure to select all the messages that will be transferred below. Click Data Transfer to begin the transmission process.

⚠ Warning

During transmission, please do not turn off the power of the printer and computer.
This may cause message corruption and damage to the printer and computer.



4

When all transmissions are completed, check the printer to ensure that all messages have been transferred.

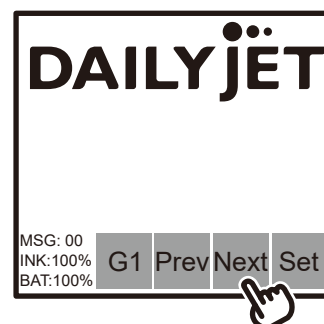

8 Printer Settings

Description of All Settings

Use settings configure mode to modify these settings.

Settings	Description
NOZZLE Set the printhead to only use a group of nozzles.	Display: Touch the icon to modify nozzle setting. Then choose the setting between using all nozzles("Both"), just even nozzles("Even"), just odd nozzles ("Odd"), or Auto mode. Touch the OK key to save this setting. (Please see P33. Configuring Active Nozzles)
DIRECTION Set the operating direction, LEFT-to-RIGHT or RIGHT-to-LEFT.	Display: Touch the icon to modify direction setting. Then choose the setting to switch between left-to-right and right-to-left operating mode. Touch the OK key to save this setting. (Please see P.31 Configuring Operating Direction)
DENSITY Set the printing density.	Display: Touch the icon to modify this setting. Then choose the setting to switch between the various density options. Touch the OK key to save this setting. The four options are normal ("1") and increasing shades of darkness ("2", "3", "4"). (Please see P34. Configuring Print Density)
DYNAMIC SN Serial Number Jump. (Backwards or Forwards)	Display: Touch the icon to modify this setting. Choose a information of serial number , use the Next key or Last key to change the serial number. Also use the Reset key to reset the serial number. Touch the OK key to save this setting. (Please see P.32 Configuring Dynamic Serial Number)
PURGE PRINT Test the printhead.	Display: Touch the icon to start at this setting. Hold the active button while rolling the printer to print information of test. When the test is finish, touch the OK key or Gancel key to return to the main screen. (Please see P35. Printhead Printing Test)
INFORMATION Some system information of printer.	FW Version: Show the FW version of that printer, when you have a new FW version, touch the icon of FW update to update the new FW version. Serial: Show the serial number of that printer. You can touch the icon of reboot to reboot the printer. Booting time: It show how long about the booting time of that printer. Pringing time: It show how long about the pringing time of that printer. You can touch the icon of screen saving to set the time of screen saving. Language: It show what language about the system of that printer. You can touch the icon of language to set the language of system. Time: It show the time about the system of that printer. You can touch the icon of set time to set the time of system.
Adv. setting Set some Adv. setting of printer.	Adv. setting Set some Adv. setting of printer. Drive Voltage: Touch the icon of Drive Voltage to set the voltage for the best of ink cartridge. Drive Pulse: Touch the icon of Drive Pulse to set the pulse for the best of ink cartridge. Auto Spit: Touch the icon of Auto Spit to set how long to print out a little of ink from the ink cartridge. This setting can prevent to be dry of printing head. Calibration Touch: Touch the icon of Calibration Touch to calibrate the touch screen of printer.

Move between Settings

1 Please touch the icon of Set to enter the setting configuration mode.

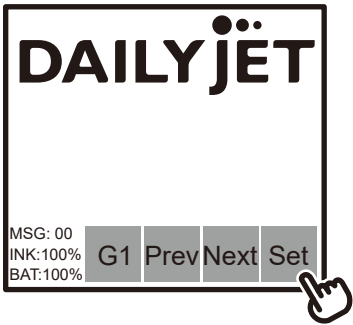

2 You can select the setting to be configured.

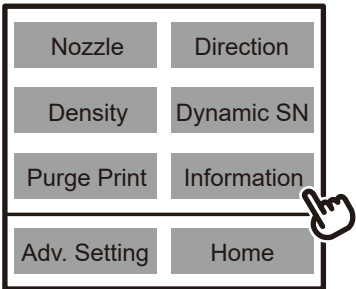

Configuring Operating Direction

You can change between left-to-right and right-to-left operation.

- 1 Touch the icon of Direction to modify direction setting.

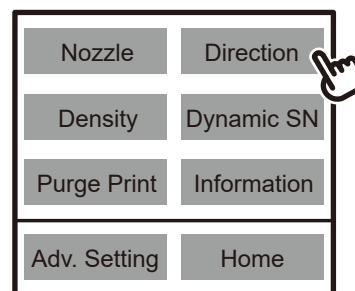

- 2 Then choose the setting to switch between left-to-right and right-to-left operating mode.

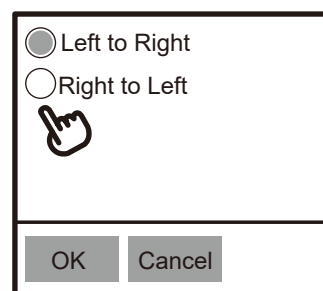

- 3 Touch the OK key to save this setting.

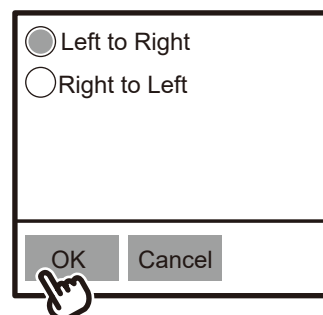

- 4 Once this setting is changed, the printing procedure remains the same except operating direction.

Warning

Switching operating directions does not switch the message direction. It only changes the direction that the printer is scrolled.

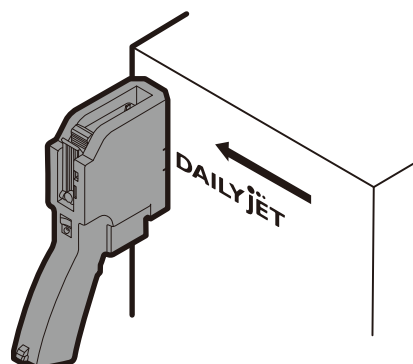

Configuring Dynamic Serial Number

The serial number may be configured to jump forwards or backwards some values.

1

Touch the icon to modify this setting.

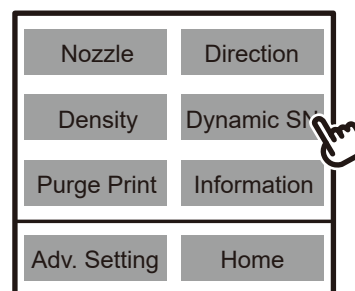

2

Jump the serial number forwards or backwards.

Choose a information of serial number, use the Next key or Last key to change the serial number.

⚠ Warning

If some serial numbers are in the one printing information. You can choose one of the serial number to jump forwards or backwards some values.

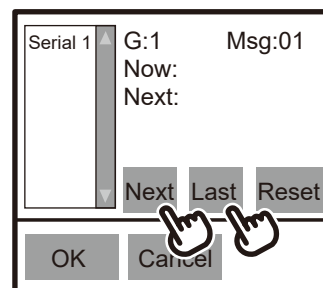

3

Also use the Reset key to reset the serial number.

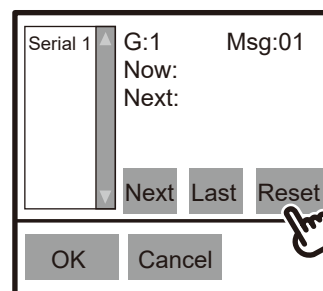

4

Touch the OK key to save this setting.

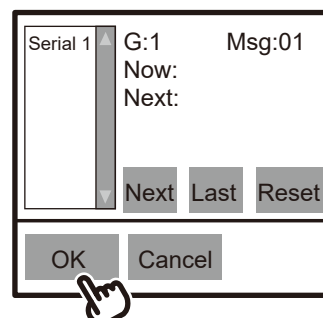

Configuring Active Nozzles

The nozzles in use can be configured based on your printing needs.
Use of different nozzle modes will result in different print results.

- 1 Touch the icon to modify nozzle setting.

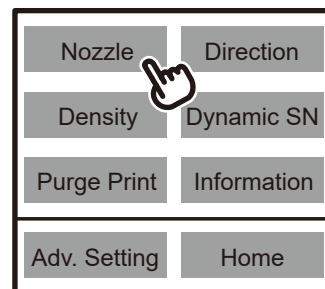

- 2 Then choose the setting between using all nozzles("Both"), just even nozzles("Even"), just odd nozzles("Odd"), or Auto mode.

Function Items	Description
Both	Configure the printer to use all nozzles
Even	Configure the printer to use only even nozzles
Odd	Configure the printer to use only odd nozzles
Auto	Configure the printer to use auto setting

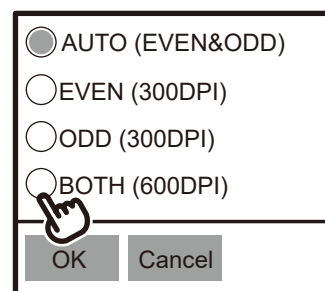

Warning

Using "both" will result in darker print results.

If the printing surface is rough, "both" mode may result in undesirable print results. For uneven surfaces, use of "even" or "odd" modes is recommended.

Print density will affect the printing results in these three modes. Please see the next page for more information about print density.

It is recommended not to use "both" mode for fine printing (e.g. detailed images, barcodes, QR codes).

- 3 Touch the OK key to save this setting.

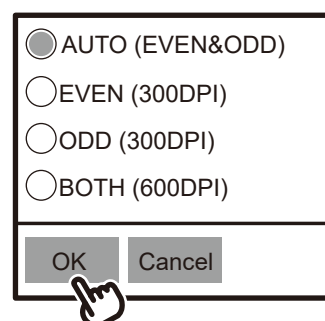

Configuring Print Density

Change print density.

1 Touch the icon to modify this setting.

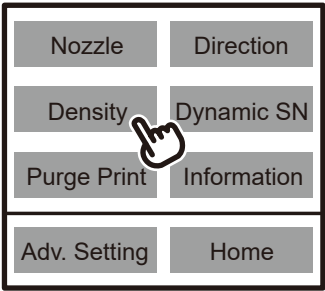

2 Then choose the setting to switch between the various density options.
The four options are normal ("1") and increasing shades of darkness ("2", "3", "4").

Function Items		Description
1	1	Normal density
2	2	High density (darker)
3	3	Higher density (even darker)
4	4	Highest density (darkest)

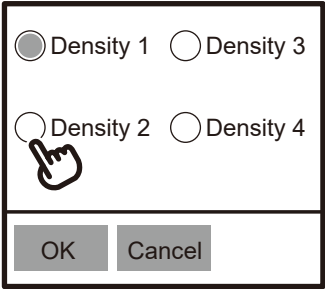

3 Touch the OK key to save this setting.

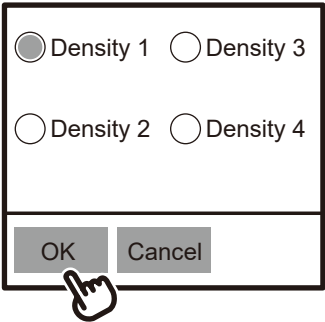

Printhead Printing Test

Use the PURGE PRINT setting to test the printer.

- 1 Touch the icon to start at this setting.

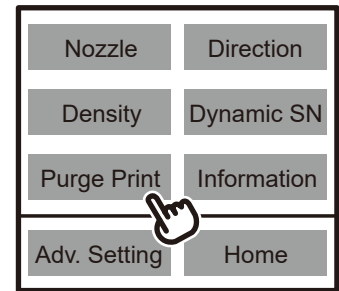

- 2 Hold the active button while rolling the printer to print information of test.
Then position the printer flush against the print surface and scroll normally to test the printer. At first the printer will release a small amount of ink to clean the printhead before continuing to print the test pattern. When the test is completed the printer will beep.

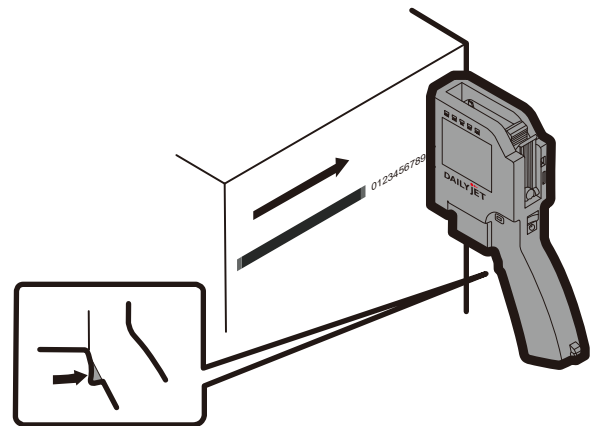
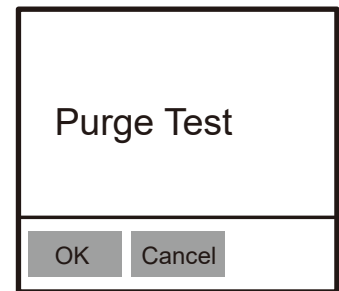

- 3 Please check the print results.
If the printing test results in horizontal or vertical bending, please repeat the printhead printing test.
(Please see P39. Cleaning the Printhead)
If the test results do not improve, then there may be blockage in the printhead or scratches on the printhead surface. If required, please replace the ink cartridge, replace the rechargeable batteries, or recharge the batteries.
Please install a new ink cartridge.
(Please see P8. Ink Cartridge Installation)



- 4 When the test is finish, touch the OK key or Cancel key to return to the main screen.

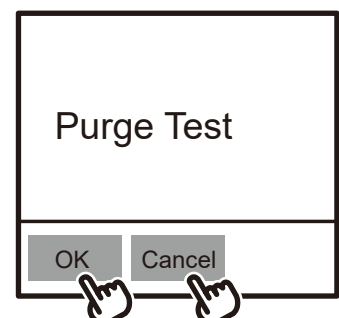

Configuring the Software Language

- 1 Click "Setting" tab on the menu bar.

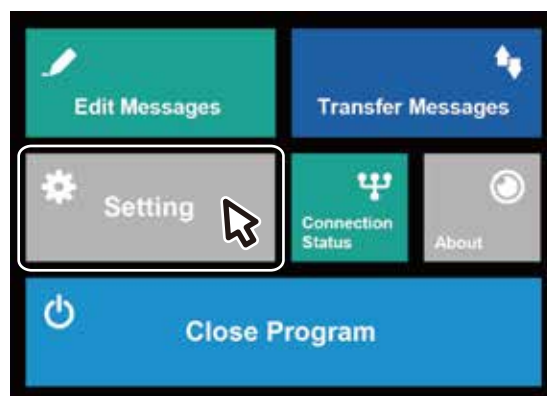

- 2 Select your desired language from the menu of software setting.

- English(en-US)
- Traditional Chinese(zh-TW)
- Simplified Chinese(zh-CN)
- Japanese(jp-JP)



Configuring the Printer Language

- 1 Touch the icon to modify information setting.

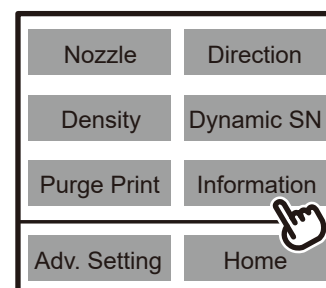

- 2 Touch the icon of Language to modify language setting.

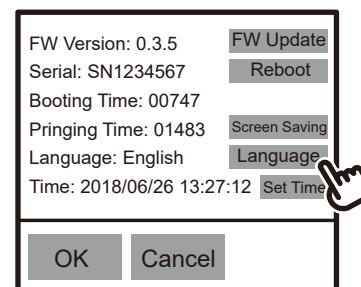

- 2 Select your desired language from the drop down menu.
Touch the OK key to save this setting.

- English(en-US)
- Japanese(jp-JP)
- Traditional Chinese(zh-TW)
- Vietnamese



Cleaning the Printhead

Please clean the printhead when the print quality deteriorates, or when the printhead has collected dust or contaminants.

Use a clean tissue to gently and slowly wipe the inkjet head surface from top to bottom or bottom to top. Do not wipe horizontally, horizontal wiping may result in damage to the printhead. After cleaning, please perform the automatic printing tests. If the results are clean and clear, no further cleaning is required. If the results are not clean and clear, please repeat the above cleaning process.

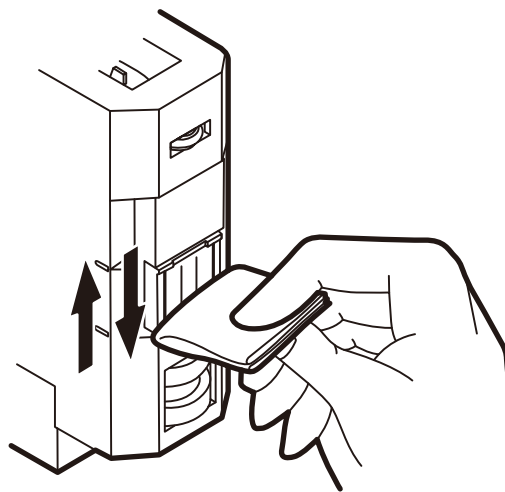

Warning

Please follow one direction (only top to bottom or bottom to top) during the cleaning process. Do not wipe the inkjet head from both directions. Use clean mineral water to slightly moisten the clean tissue, then clean the inkjet head. Do not use any detergent, cleaning products or gasoline to clean the printhead.

During the cleaning process, please wipe printhead gently. Using excess force may cause damages to the printhead. The nozzle will be hot after a print job. Please do not touch the nozzle and the surrounding area immediately after printing.

Ink Level

When the ink level is low, the INK LED will light up.

The INK LED lights up when the ink level is below 20%. When the ink level is below 10%, print quality will begin to decline.

The INK LED will remain lit until the cartridge is empty. When the cartridge is empty, please replace it with a new one.

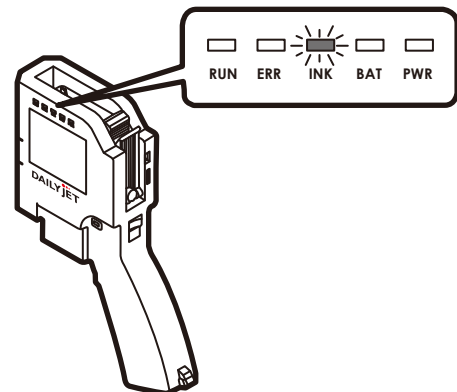

You can change the level at which the INK LED lights up through the firmware settings.

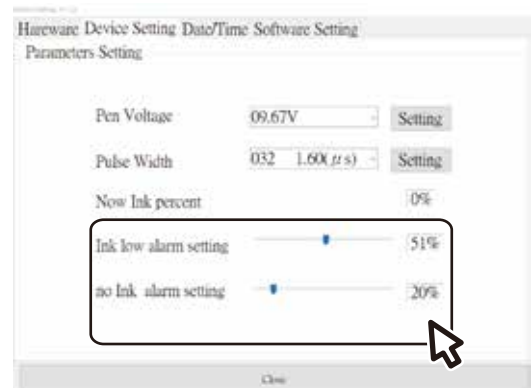

⚠ Warning

Please discard used ink cartridges in accordance with local disposal or recycling requirements. To purchase additional cartridges, please consult the distributor for the best cartridge to use.

Low Battery

When the battery level is low, the BAT LED will light up.

When the BAT LED is lit, the printer cannot perform any printing operations. The screen preview will display "battery low". To return the printer to normal function, either replace the rechargeable batteries, recharge the batteries using the provided battery charger, or use the provided AC power adapter to turn on the printer.

(Please see P10. Turning on the Printer and P11. AC power)

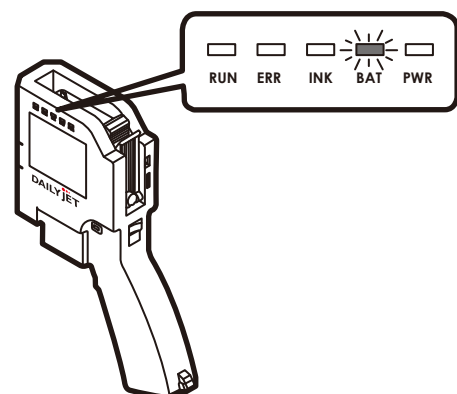

⚠ Warning

You may use the provided battery charger or the provided AC power adapter to recharge the batteries.



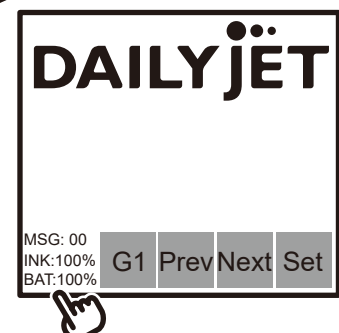

(Please see P6. Parts and Accessories)

Please discard used batteries in accordance with local disposal or recycling requirements.

If additional rechargeable batteries must be purchased, please follow the specifications listed in the manual.



Resolving Poor Print Quality

Print Result		Description
	Print is horizontally stretched	Check if the main roller is not contacting the print surface. The main roller must be flush with the print surface. If it is not flush with the surface, this printing condition may occur.
	Vertical misalignment or banding	This printing condition may be caused by an uneven print surface. Special printing equipment will be required to resolve this issue. (Please see P16. Basic Operations)
	Print message printed several times	This printing condition may result from the main roller moving too fast during a print. This printing condition can occur if the printing speed is too fast. When the printing speed exceeds the guidelines, the printer will automatically stop printing. Please maintain an appropriate printing speed to achieve good print results. (Please see P16. Basic Operations)
	Print message is slanted to one side	Check whether the printer is tilted during printing. The printer needs to be held parallel to the print surface. (Please see P16. Basic Operations)
	Print message printed several times	
	Blurry or smeared prints	Check whether the auxiliary roller is in contact with the print surface during printing. The auxiliary roller needs to be on the printing surface. Otherwise, it may cause this print result. (Please see P16. Basic Operations)
	Poor Printing quality	
	Incorrect print density	Check if the ink or battery level is low. If required, please replace the ink cartridge, replace the rechargeable batteries, or recharge the batteries. (Please see P8. Ink Cartridge Installation)
	Interrupted print job	(Please see P10. Turning on the Printer, P11. AC power and P38. Low Battery) This printing condition can occur if the printing speed is too fast. When the printing speed exceeds the guidelines, the printer will automatically stop printing. Please maintain an appropriate printing speed to achieve good print results. (Please see P16. Basic Operations)
	Horizontal misalignment or banding	The printout has horizontal misalignment or banding. Please conduct a printhead printing test. If the test results in the same printing issues, please clean the printhead a few times. Perform the printhead printing test again. (Please see P35. Basic Cleaning Guide and P37. Printhead Printing Test) If cleaning doesn't resolve the print condition, the printhead surface may be scratched, or have a blockage. Please replace the ink cartridge. (Please see P8. Ink Cartridge Installation)

Troubleshooting

If the printer does not function properly, refer to this page for troubleshooting. If the problem cannot be resolved, please contact the distributor for further information.

Issue	Potential Solution
Printer will not turn on	<p>Check if the battery level is low or if batteries were properly installed. Please check if the battery level is low. Please check if the batteries were installed properly. (Please see P10. Turning on the Printer and P38. Low Battery) Check if the power socket and AC power supply are work ing. Please switch power plugs to check if to see AC power adapter is working. (Please see P11. AC Power) If still you cannot turn on the power, there may be hardware damage. Please contact the distributor for further information.</p>
AC power adapter is not working	<p>Please check whether the batteries are installed correctly. (Please see P10. Turning on the printer) Please check whether the power indicator is lit up. If the power indicator is not on, there may be hardware damage. Please contact the distributor for further information.</p>
Printer cannot print	<p>Check if the BAT LED is lit up. (Please see P10. Turning on the printer and P.40 Low Battery) Is the ink cartridge is a genuine HP cartridge or if the ink level is too low. The printer will read the cartridges lcode to identify if the cartridge is a genuine HP cartridge. (Please see P8. Ink Cartridge Installation) Please check if the printhead cap is still on. Printing cannot occur when the printhead cap is on. Please remove the printhead cap in order to print. (Please see P16. Basic Operations) Please check if the touch screen is off. Please touch the screen to exit from standby mode. If the problem cannot be resolved, there may be hardware damage. Please contact the distributor for further information.</p>
The printer cannot connect to the software	<p>Please use the following methods to troubleshoot. USB: 1. When the printer is connected to the computer, please close and re-open the software. 2. When the printer is connected to the computer, please click the Disconnect Icon. 3. Reconnect the USB cable at both ends. 4. Check if multiple instances of the software are open. 5. Check whether your operating system is supported. Check if the USB cable in use is the one provided with the printer. Other USB cables may cause bad connections. Check whether the USB cable is plugged in correctly. Both ends of the USB cable need to be plugged in completely. Bluetooth: 1. Check Bluetooth of your computer is opened. 2. If your computer cannot connect the printer, please modify setting of bluetooth of your computer to remove the setting of printer, and try to connect the printer again. 3. If you want to connect the other printer, please modify setting of bluetooth of your computer to remove the setting of old printer, and try to connect the new printer again. If the problem cannot be resolved, there may be hardware damage. Please contact the distributor for further information.</p>

Firmware Updates

Please use the provided software to update your printer's firmware.

Warning

The distributor will provide the firmware update files.

- 1** Your printer needs to be connected to computer software.
(Please see P27. Connecting the printer to a PC)

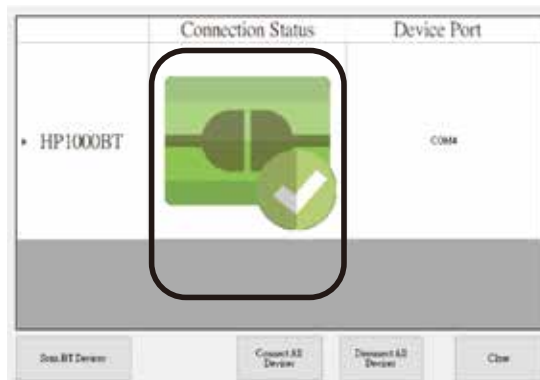

- 2** Please click the "Firmware Update" button in the menu bar.



- 3** When "Firmware Update" is clicked, all the status indicators on the handy printer will light up.

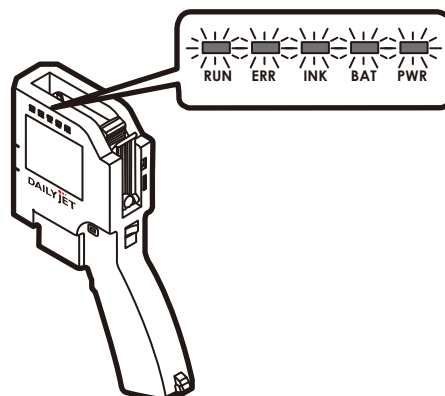

- 4** Click the "Choose File" button to select the firmware file that you want to update to. Select the firmware file and click the "Burn In" to perform the firmware update.

Warning

During the firmware update process, please do not disconnect the printer or close the computer software. The disconnection may cause the update to fail, and may result in printer damage.

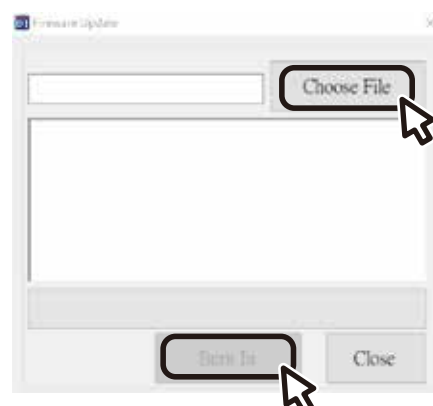

- 5** When the firmware is updated, the printer will automatically reboot and close the firmware update page. The handy printer will the reconnect with the computer software.

Warning

If the printer cannot reconnect with the computer software, please disconnect and reconnect the USB cable, and the USB cable or Bluetooth. The printer will automatically reconnect to the software.

Technical Information

Item	Description
Printing technology	HP Thermal Inkjet
Chip technology	HP I-Code encryption
Printing speed	Maximum 30m / min
Nozzle array	300 points (150 points x 2 columns)
Inkjet printing direction	Transverse printing/from top to bottom
Printing height	Maximum 12.7mm
Number of inkjet head	One inkjet head Compatible with genuine HP ink cartridges
Number of print messages	Fifty messages
Size of a print message	Maximum 150 x 4800 dot
Supported fonts	Fonts within the user's computer
Time stamp	Year (AD)/Month/Day/Hour/Minute/Second
Serial number messages	Up to 8 numbers/Cycle/Initial value/End value/Set shift
Applicable barcode specifications	CODEBAR/CODE39/CODE128/EAN8/EAN13
Applicable matrix barcode specifications	QR CODE/DATA MATRIX/PDF417/AZYEC
Applicable image specifications	BMP/JPG/GIF/PNG
Supported operating system	Windows 10 (32bit/64bit)/Windows 8 (32bit/64bit)/Windows 7 (32bit/64bit)/ Windows Vista (32bit/64bit)/Windows XP (32bit)
Fonts	Windows Fonts
Power system	18650 Lithium-ion battery x 2pcs / AC Power Adapte
Standby time	About 24 hours (It varies depending on the usage.)
Continuous operation time	About 10 hours (It varies depending on the usage.)
Operating environment	5 to 45 degrees Celsius and 10% - 80% relative humidity
Country of Origin	TAIWAN
Net Weight	450g
Weight	550g (with batteries) / 650 (with batteries and ink cartridge)
Manufacture year and serial number	Please see the label of the printer
Warnings	Only use specified power requirements for the printer Please use in a well ventilated environment. Use caution to avoid damage.

DAILYJET^{HP} HP I200

Best Professional Handy Printers



To purchase ink cartridges or for maintenance , please contact the distributor.