

# Xlife X1说明书

尺寸: 57x160mm

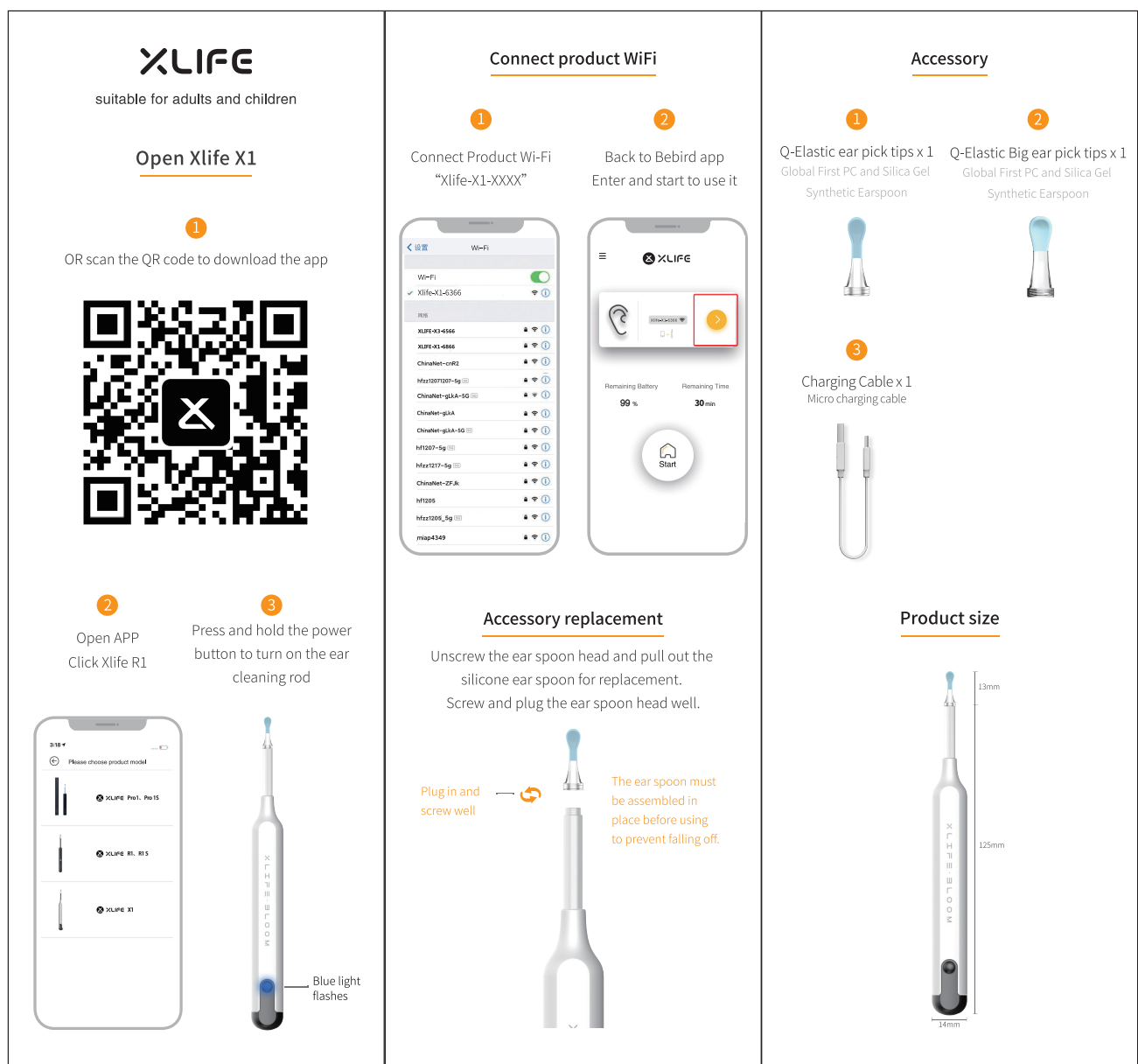

## Troubleshooting

Trouble	Solution
starting up and no response	Please use the attached charging cable for quick charging. The charging time is 50 minutes
Camera does not turn on	Close and open the cover to try a few times
APP quit quickly	Delete the existing APP and re-scan the QR code for installation
Installation of tools in accessory barrel is not smooth	Unscrew the ear spoon head and pull out the silicone ear spoon for replacement. Screw and plug the ear spoon head well
Rod's power indicator is red	Please use the attached charging cable for charging. The charging time is 50 minutes
The display on the app is not reading properly.	Disconnect the phone with product and open cover to restart it, then set phone to reconnect product
WiFi connection is unstable, sometimes it is disconnected in seconds	Close and open the cover to restart rod and restart app in phone to connect rod

If you still have problems with the above procedures, please contact our Customer Service Representatives directly for further assistance

Hazardous substance

Part name	Hazardous material					
	(Pb)	(Hg)	(Cd)	(Cr(VI))	(PBB)	(PBDE)
Printed Circuit Components	×	○	○	○	○	○
Case	○	○	○	○	○	○
Plastic rubber accessory	○	○	○	○	○	○

This form is formulated in accordance with SJ/T 11364  
 ○ : represent the hazardous materrial ratio is below GB/T26572-2011  
 × : represent the hazardous materrial ratio is over GB/T26572-2011

### Product parameters

Brand	Xlife
Product Name	Smart visual ear-cleaning Robot
Model	Xlife X1
Rod weight	14g
Network standard	IEEE 802.11b/g/n
Antenna	Internal FPC antenna
Working frequency	2.4GHz
Image transmission rate	20fps
Image sensor	CMOS
Working temperature	-10 ~ 45°C
Battery	130mAh lithium battery
Battery life	30 minutes
Charging time	30 minutes
Input current	DC 5V 300mA
Lens diameter	3.5mm
Optimum focal length	15 ~ 50mm
Depth of field	5 ~ 20mm
Pixel	3 Mega-pixels
Gyroscope	3 axis



## Attention

1. When cleaning lens, please wipe it carefully with professional alcohol cotton swab.
2. Make sure the ear spoon is well installed before using, to prevent the ear spoon from falling off.
3. Please don't use it while you are moving, and protect from being hit by others.
4. It is forbidden for children to use this product alone in order to avoid accidental harm.
5. Please do not put the product in liquid to avoid damage.
6. Product built-in polymer battery, so it must be charged once a month If it is not used frequently.
7. Avoid product exposure to sunshine directly, especially the accessories, in order to avoid softening.
8. During using it, the temperature of the product will rise slightly(Data from Xlife lab, the maximum temperature of the machine doesn't exceed about 35°C), please rest assured to use.

## Warranty

User info

User name: Telephone number:

Address:

Seller: Telephone number:



XLIFE

Enable everyone to enjoy visible ear cleaning

This device complies with part 15 of the FCC Rules. Operation is subject to the following two conditions: (1) This device may not cause harmful interference, and (2) this device must accept any interference received, including interference that may cause undesired operation.

Any Changes or modifications not expressly approved by the party responsible for compliance could void the user's authority to operate the equipment.

**Note:** This equipment has been tested and found to comply with the limits for a Class B digital device, pursuant to part 15 of the FCC Rules. These limits are designed to provide reasonable protection against harmful interference in a residential installation. This equipment generates uses and can radiate radio frequency energy and, if not installed and used in accordance with the instructions, may cause harmful interference to radio communications. However, there is no guarantee that interference will not occur in a particular installation. If this equipment does cause harmful interference to radio or television reception, which can be determined by turning the equipment off and on, the user is encouraged to try to correct the interference by one or more of the following measures:

- Reorient or relocate the receiving antenna.
- Increase the separation between the equipment and receiver.
- Connect the equipment into an outlet on a circuit different from that to which the receiver is connected.
- Consult the dealer or an experienced radio/TV technician for help.
- Radiation Exposure Statement

The device has been evaluated to meet general RF exposure requirement. The device can be used in portable exposure condition without restriction.