



Open bebird M9 Pro

1 Scan QR code to download APP



3 Open bebird APP
Select bebird M9 Pro

3 Open products cover
Power on



Connect Product WiFi

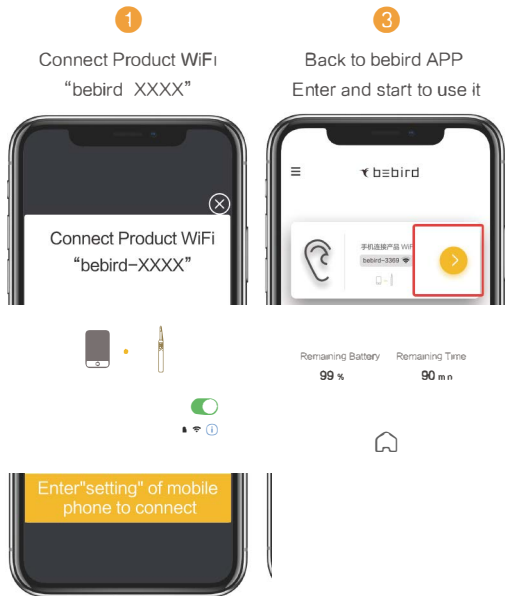

Accessory Replacement

It can be replaced by side folding



Magnetic charging base

Two in one function
Follow the below guide to plug it



Bottom Storage Box

Spinning to open the charging base
The accessory can be replaced



Accessory

- 1 Q elastic Ear Spoon × 2
The world's first version of combined PC with silica gel
- 3 Silver Needle Goose's Villi Rod × 1
Gently massage the auricle to relax the body and mind
- 3 Deep Ear Digging Spoon × 2
Dig the ear canal deep y and take out a large amount of earwax
- 3 Silver Needle Crane's Villi Rod × 1
Massage the external auditory canal to stimulate sympathetic nerve
- 3 Annular Ear Spoon × 2
Dig out the earwax easily from up and down of left and right
- 7 Silver Needle Horsetail Villi Rod × 1
Massage the eardrum to enjoy high purity white noise
- 1 Enjoyable Cotton Swab × 4
Clean and comfortable after removing the earwax debris
- 3 Alcohol Cotton Swab × 3
For lens cleaning or ear canal disinfection

Product Size



Troubleshooting

Trouble	Solut on
Starting up and no response	Please try several more times according to the correct boot-up method Please use the attached charging base for charging. The charging time is about 1.5h
Camera does not turn on	Shut down and restart the ear cleaning rod
APP quit quickly	Delete the existing APP and re-scan the QR code for installation
Rod's power indicator is red	Please use the attached charging base for charging. The charging time is about 1.5h
WiFi connection is unstable, sometimes it is disconnected in seconds	Restart ear cleaning rod, reconnect bebird APP
The product faied to display the real-time image after successfully connecting the bebird APP	Disconnect the phone from WiFi, restart the product and reconnect the WiFi
If the above operation still fails to solve the problem, please contact bebird Customer Service for further assistance	

Attention

- When cleaning lens, please wipe it carefully with professional alcohol cotton swab.
- Before use it, please check the surrounding environment. Do not use the product in the environment where someone runs, in order to avoid strike.
- This product is not suitable for children under three years old
- It is forbidden for children to use this product alone in order to avoid accidental harm.
- Do not use the endoscope in liquid to avoid damage caused by immersion.
- Product which is built-in rechargeable lithium batteries, if not often used, must also be charged once a month.
- Avoid product exposure to sunshine directly, especially the storage box's accessories, in order to avoid softening.
- During using it, the temperature of the product will rise slightly (up to 35 C). Please rest assured that it can be used.
- In order to ensure the best using experience, please keep the child in a sitting position and operate the product horizontally
- For your ear cleaning experience, please replace the spoon's end after more than 6 months of use



Product parameters

Brand	bebird
Product Name	Smart Visual Ear Cleaning Rod
Model	M9
Rod weight	32.2g
Network standard	IEEE 802.11b/g/n
Antenna	Internal FPC antenna
Working frequency	2.4Ghz
Image transmission rate	30fps
Image sensor	CMOS
Working temperature	-10 ~ 50°C
Battery	350mAh lithium battery
Battery life	About 90 minutes
Charging time	1.5h
Input Parameters	5V --- 0.4A
Working Voltage	4.7V
Amount of Power	5W
Lens diameter	4.5mm
Optimum focal length	1.5 ~ 2cm
Pixel	3M
Gravity Sensor	4 Axis



Family joy with ear cleaning

Hazardous substance

Part name	Hazardous material				
	(Pb)	(Hg)	(Cd)	(PBB)	(PBDE)
Printed Circuit Components	X	O	O	O	O
Charging Base	X	O	O	O	O
Case	O	O	O	O	O
Plastic Rubber Accessory	O	O	O	O	O

Warranty

User information	
User name	Telephone number
Address	
Seller	Telephone number

FCC Statement
This device complies with part 15 of the FCC rules. Operation is subject to the following two conditions: (1) this device may not cause harmful interference, and (2) this device must accept any interference received, including interference that may cause undesired operation.

Changes or modifications not expressly approved by the party responsible for compliance could void the user's authority to operate the equipment.

NOTE: This equipment has been tested and found to comply with the limits for a Class B digital device, pursuant to part 15 of the FCC Rules. These limits are designed to provide reasonable protection against harmful interference in a residential installation. This equipment generates uses and can radiate radio frequency energy and, if not installed and used in accordance with the instructions, may cause harmful interference to radio communications. However, there is no guarantee that interference will not occur in a particular installation. If this equipment does cause harmful interference to radio or television reception, which can be determined by turning the equipment off and on, the user is encouraged to try to correct the interference by one or more of the following measures:

- Reorient or relocate the receiving antenna.
- Increase the separation between the equipment and receiver.
- Connect the equipment into an outlet on a circuit different from that to which the receiver is connected.
- Consult the dealer or an experienced radio/TV technician for help.

The device has been evaluated to meet general RF exposure requirement. The device can be used in portable exposure condition without restriction.