



bebird
Enjoy Ear clean, Easy to use
Bebird Smart Visual Ear-Clean Rod
A2



Start Bebird A2

Scan QR code to download APP



1 Open APP
Click Bebird A2



2 Open the cover
Power on automatically

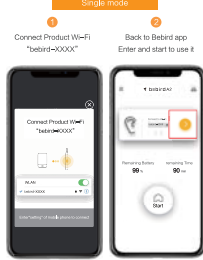

Accessory replacement

Clipped end of ear spoon
It can be replaced once it's pulled out.



Accessory

- 1 D-Elastic Ear Spoon *4
Stimulate ear canal
Stimulate Eustachian tube
- 2 Silver Needle
Crane Hair Stick *1
Massage eardrum
with 4.0 probe and hair
- 3 Annular Ear Spoon *2
Tap on the eardrum
Short Ears from deep to shallow
- 4 Silver Needle
Crane Hair Stick *1
Massage eardrum
with 4.0 probe and hair
- 5 Deep Ear Digging Spoon *2
Deep to the ear canal
to remove waxer corners
- 6 Silver Needle
Horizontal stick *1
Massage Eustachian tube
to enjoy high and low noise
- 7 Enjoibe cotton swab *5
Clean ear remove earwax debris
- 8 Alcohol cotton swab *5
For skin disinfection
and sterilization

Troubleshooting

Trouble	Solution
Starting up and no response	1. Please use the attached charging cable for quick charging. The charging time is 1.5hr.
Camera does not turn on	Close and open the cover to try a few times
APP not available	Delete the existing APP and re-install the QR code for installation
Intentional lock in accessory (battery not shown)	Finally align the ear-cleaning rod with the lens. Remove the rod and try to reinsert it.
Red's power indicator is red	Please use the attached charging cable to charge. The charging time is 1.5hr.
The display or the app is not reading properly	Disconnect the phone with product and place cover to restart times of 5.
WiFi connection is unstable, sometimes it is disconnected in seconds	Close and open the cover to restart and restart app in phone to connect it.

If you still have problems with the above procedures, please contact our Customer Service Representative directly for further assistance.

Hazardous substance

Part name	Hazardous material			
	(Pb)	(Hg)	(Cd)	(PBB) (PBDE)
Printed Circuit Components	X	0	0	0
Case	0	0	0	0
Plastic outer accessory	0	0	0	0

This form is formulated in accordance with IEC 61274
 0: represent the hazardous material is below 0.1% (1000PPM) (Wt/Wt)
 X: represent the hazardous material is over 0.1% (1000PPM) (Wt/Wt)

bebird

Product parameters

Brand	bebird
Product Name	Bebird Smart Visual Ear-Clean Rod
Model	A2
Net weight	29g
Network standard	IEEE 802.11b/g/n
Antenna	External FPC antenna
Working frequency	2.4GHz
Image transmission rate	30fps
Image sensor	CMOS
Working temperature	-10 ~ 50°C
Battery	350mAh lithium battery
Runtime life	about 90 minutes
Charging time	1.5h
Input current	DC 5V 420mA
Lens diameter	3.2mm
Optimum focal length	1.5 ~ 2cm
Pixel	5M
Gravity Sensor	3 axis

Attention

- When cleaning ears, please wipe it carefully with professional alcohol cotton swab.
- Before use it, please check the surrounding environment. Do not use the product in the environment where someone smokes, in order to avoid stroke.
- This product is not suitable for children under one year old.
- It is forbidden for children to use this product alone in order to avoid accidental harm.
- Do not use the endoscope in liquid to avoid damage caused by immersion.
- Please use our product once a month and charge it in order to keep the rechargeable polymer battery in good condition.
- Avoid product exposure to sunlight directly, especially the accessories in the tank, in order to avoid softening.
- During using, the temperature of the product will rise slightly (up to 35°C). Please rest assured that it can be used.
- In order to ensure the best usage, please keep the device in a sitting position and operate the product horizontally.

Warranty

User Info

User name:	Telephone number:
Address:	
Self:	Telephone number:

Warning:
This device complies with Part 15 of the FCC Rules. Operation is subject to the following two conditions: (1) this device may not cause harmful interference, and (2) this device must accept any interference received, including interference that may cause undesired operation.

changes or modifications not expressly approved by the party responsible for compliance could void the user's authority to operate the equipment.
NOTE: This equipment has been tested and found to comply with the limits for a Class B digital device, pursuant to Part 15 of the FCC Rules. These limits are designed to provide reasonable protection against harmful interference in a residential installation. This equipment generates, uses and can radiate radio frequency energy and, if not installed and used in accordance with the instructions, may cause harmful interference to radio communications. However, there is no guarantee that interference will not occur in a particular installation. If this equipment does cause harmful interference to radio or television reception, which can be determined by turning the equipment off and on, the user is encouraged to try to correct the interference by one or more of the following measures:
 -- Reorient or relocate the receiving antenna.
 -- Increase the separation between the equipment and receiver.
 -- Connect the equipment into an outlet on a circuit different from that to which the receiver is connected.
 -- Consult the dealer or an experienced radio/TV technician for help.
NOTE: This device and its antenna(s) must not be co-located or operation in conjunction with any other antenna or transmitter