

# iGPSPORT

## GPS CYCLING COMPUTER

### iGS520



## QUICK START MANUAL

### 1. BUTTON FUNCTIONALITY

- ① POWER / MENU
- ② BACK / LAP
- ③ ENTER / START
- ④ SCROLL UP
- ⑤ SCROLL DOWN

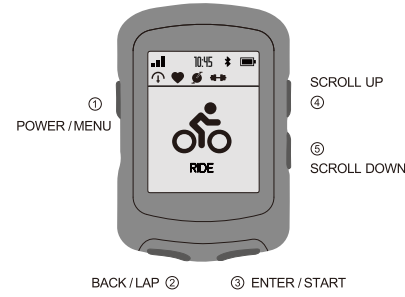

### 2. PAIR PHONE

- Download **iGPSPORT** APP (Ensure Bluetooth is on).
- Press ① to get to the menu.
- Select **Pair Phone**, then press ③.

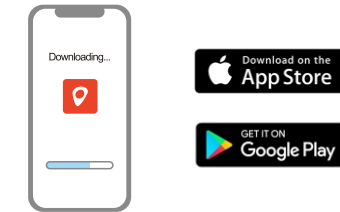

### 3. INSTALL THE STANDARD MOUNT

- Use the included zip ties to attach to bike stem.

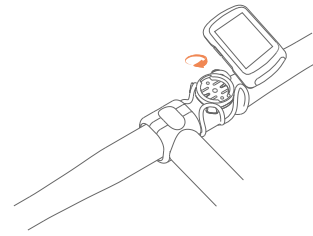

### 4. PAIR SENSORS

- Press ① to get to the menu.
- Select **Sensors**.
- Activate the sensor and hold near iGS520.
- Select the sensor and press ③ to save.

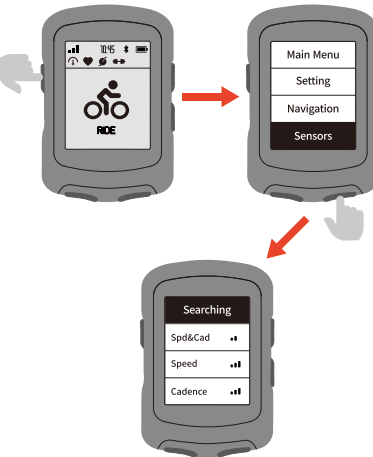

### 5. GO FOR A RIDE

- Go outside, and wait while the device locates satellites.
- Press ③ to go to ride page.
- Press ③ to start / stop an activity.
- Press ① to get to the menu and select **Save** to save ride.

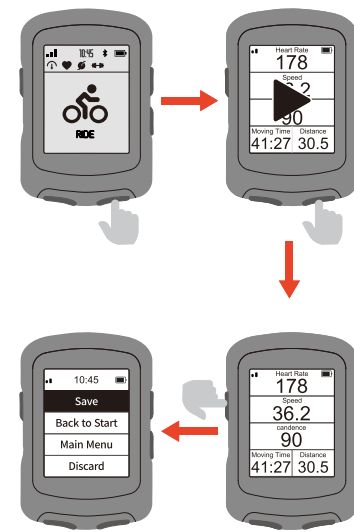

\* Go to [www.igpsport.com](http://www.igpsport.com) for detailed instruction manual.

### CONTACT US

www.igpsport.com  
 Wuhan Qiniu Technology Co., Ltd  
 Hongshan District, Wuhan City, Hubei Province, China.  
 (86)27-87835568  
 info@igpsport.com, service@igpsport.com

### 简体中文

#### 1. 按钮功能

- ① 电源/菜单
- ② 返回/计圈
- ③ 确认/开始
- ④ 向上
- ⑤ 向下

#### 2. 手机配对

- 下载 **iGPSPORT** APP ( 确保手机蓝牙是打开的 ) ;
- 按下 ① 键进入菜单页面;
- 选择**手机配对**, 然后按 ③。

#### 3. 安装标准底座

- 使用随附的扎带将其固定在自行车把上

#### 4. 配对传感器

- 按 ① 键进入菜单页面;
- 选择**传感器**;
- 唤醒传感器并保持在iGS520附近;
- 选择传感器并按 ③ 键保存。

#### 5. 开始骑行

- 在室外, 等待设备搜索卫星定位;
- 按 ③ 键进入骑行页面
- 按 ③ 键选择开始或者暂停本次骑行活动
- 按 ① 键进入菜单页面, 选择**保存**来保存本次骑行行程

\* 详细使用说明请登录[www.igpsport.cn](http://www.igpsport.cn)

### 联系我们

www.igpsport.cn  
 武汉齐禧科技有限公司  
 武汉市洪山区书城路文秀街中石数据工业孵化园B栋2楼  
 027-87835568  
 info@igpsport.com, service@igpsport.com

### WARNING

This device complies with part 15 of the FCC Rules. Operation is subject to the condition that this device does not cause harmful interference (1) this device may not cause harmful interference, and (2) this device must accept any interference received, including interference that may cause undesired operation.

Any changes or modifications not expressly approved by the party responsible for compliance could void the user's authority to operate the equipment.

NOTE: This equipment has been tested and found to comply with the limits for a Class B digital device, pursuant to Part 15 of the FCC Rules. These limits are designed to provide reasonable protection against harmful interference in a residential installation. This equipment generates, uses and can radiate radio frequency energy and, if not installed and used in accordance with the instructions, may cause harmful interference to radio communications. However, there is no guarantee that interference will not occur in a particular installation.

If this equipment does cause harmful interference to radio or television reception, which can be determined by turning the equipment off and on, the user is encouraged to try to correct the interference by one or more of the following measures:

- Reorient or relocate the receiving antenna.
- Increase the separation between the equipment and receiver.
- Connect the equipment into an outlet on a circuit different from that to which the receiver is connected.
- Consult the dealer or an experienced radio/TV technician for help.

To maintain compliance with FCC's RF Exposure guidelines, This equipment should be installed and operated with minimum distance between 20cm the radiator your body. Use only the supplied antenna.

FCC ID:2AU4M-IGS520

### SPECIFICATIONS:

Operating Temperature:-10~50°C