

85mm

90mm

Packing Contents

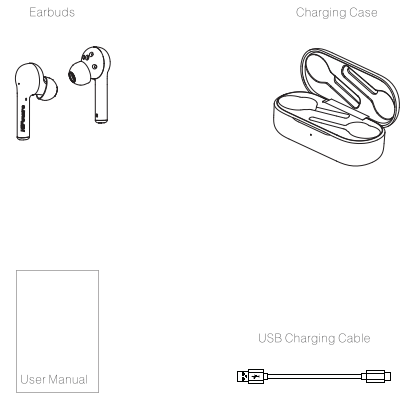

Technical Specification:

Earphone Type: TWS Earbuds (Stereo Talk & Music)
 Bluetooth Version: V5.0+EDR, BLE
 Bluetooth Chipset: BES2300H
 Bluetooth Profile: HSP, HFP, A2DP, AVRCP
 Bluetooth Role Switch: Support
 Support Decoder: MP3, AAC
 Sensors: Hall Sensor (Auto ON/OFF)
 Optical Sensor (In-ear Detection)
 Triaxial Accelerometer (Tap Control)
 Operating range: 10M
 Frequency Range: 2.4GHz-2.48GHz
 Frequency Response: 20Hz-20 KHz
 Speaker: Dynamic 6mm, N40 Neodymium magnet
 Speaker impedance: 16 Ω ± 15%
 Speaker Sensitivity: 103dB (± 3dB) @ 1 KHz, 126mV
 Rated power: 3mW
 SPL: 105dB @1K
 THD+N: =5% @ 200Hz ~3 KHz
 Battery: Li-Polymer 500mAh Charging Case + 55mAh X 2 Earbuds
 Playback time: Up to 6hours* + 20 hours with charging case
 RF: 2.4GHz, 3.04dB
 EMC Standard: CE EN61000-4-2
 Mic: Dual MEMS Microphone (Left & Right)
 Mic Sensitivity: -42dB ± 3dB (0dB=1V/Pa @ 1 KHz)
 Mic THD+N: =2%
 Ear earplugs: Hybrid Silicone Bullet Type L, M, S Size
 Charging port: Type-C
 Charging Voltage: 4.6~5.3V
 Charging Current: 5V 500mA for charging case, 5V 60mA for earbuds
 Charging time: < 1.5hour for earbuds, < 2 hours for charging case
 Waterproof: IPX4 earbuds
 N.W.: 4g/headset, 45g charging case
 Headset Dimensions: 43*16*22.2mm (HWD)
 Charging Case Dimensions: 26.8*76.6*32.6mm (HWD)
 Operation: -15 °C to 60 °C, 10%~80% Relative humidity

*Testing conducted by HiFuture in using preproduction FutureBuds units and software paired with preproduction iPhone X/11 and software. The volume was set to 50%. Battery life depends on device settings, usage, and many other factors.

FAQ

Q: The FutureBuds cannot be switched on?
Ans: Please check the battery status of your headset as well as the charging case's battery. Don't forget to remove the seal sticker from each earbud on the first use.

Q: Can I change the battery for the headset?
Ans: No, this headset use a built-in non-detachable Li-Polymer battery, it cannot be removed.

Q: Why I could not find FutureBuds on my Bluetooth device's list or disconnecting/instable connection while using?
Ans:
 1. Make sure FutureBuds and your device are within Bluetooth working distance
 2. Make sure the FutureBuds has been charged and has enough power
 3. Put earbuds into charging case and close the cover for 3 seconds, open the cover and push the rear MFB for 3 seconds until Blue blinks then go to your mobile phone's Bluetooth settings, find and select FutureBuds to make the connection.
 4. If above 3 steps did not make succeed connection, please restore the FutureBuds to factory setting: - Press the Rear MFB for 10 seconds until RED lights blinks. Remarks: You should remove the "FutureBuds" from your device's Bluetooth List, and pairing them again.

Q: FutureBuds headsets disconnected from your Bluetooth device within 10 meters?
Ans: Check if the earbuds are connecting with your Bluetooth device, if not, please connect them before using. We suggest the connected devices above IOS8.0 or Android 4.3. The tap sensor activate 1 seconds after connection to avoid disoperation. Check "Tap Controls Instructions" page in this User Manual for more actions and responses.

Q: Sound stuck or desultory?
Ans: Avoid using Bluetooth device and FutureBuds under strong interference, don't block earbuds by metal objects or wall or human bodies. Try to put earbuds into charge case and covered them, re-connect them again. Or restore to factory setting and pairing them again.

Q: Why could not charge the charging case and earbuds?
Ans: Check if the terminal plugged tight or not and try to use another new charging cable. Check if the seal sticker on earbuds charging pins had been removed.

Q: Why the earbuds power off automatically?
Ans: After Powered ON without any connection with phone or devices for 5 minutes, the earbuds will AUTO OFF. Please re-connect earbuds.

Safety Rules

1) Please follow the rules depicted in this manual closely to ensure your safety. Before using this TWS Stereo Headphone, we would strongly encourage you to read through this user manual.

2) Be more wary of any edges, uneven surfaces, metal parts, accessories and its packaging so as to prevent any possible injury or damage.

3) Do not modify, repair or dismantle this TWS Stereo Headsets. Doing so may result in fires, electric shocks, complete breakdown of this TWS Stereo Headsets, etc. All of which, are not covered under warranty.

4) Do not use any diluents or volatile liquid to clean the TWS Stereo Headsets.

5) Do not use the TWS Stereo Headsets in a hazardous location.

Service and Support
 If your device is not performing as it should, please take it to your local service providers or dealer for service.

FutureBuds

HiFuture
 WE MAKE THE SOUND
 MORE VALUABLE



HiFuture

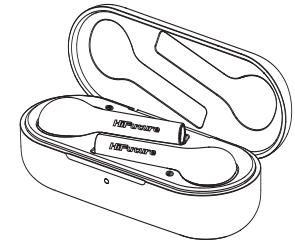

FutureBuds
 TWS Earbuds
 Quick Start Guide

1 / POWER ON & Pairing



Step 1. Open the cover
 Step 2. Push the rear button for 3 seconds until Blue lights blinks
 Step 3. Find "FutureBuds" in your mobile Bluetooth Devices List and tap it to connect.

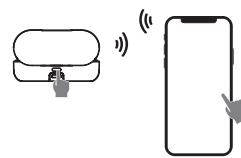

Remarks: Make sure to charge FutureBuds before using. Make sure Devices are within Bluetooth working distance (within 10 meters). Make sure there's only one device connecting at the same time.

2 / Turn on Bluetooth®

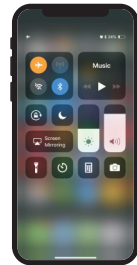

Turn on the Bluetooth® on your device (IOS/ANDRIOD/Others)

Apple iOS
 Go to Settings > Bluetooth. Move the Bluetooth slider to On. A list of Bluetooth devices will appear. Tap your "FutureBuds" in the list to connect.

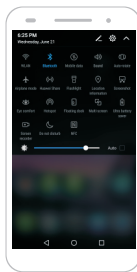

Android
 Go to Settings > Wireless & Networks > Bluetooth settings. Check the box next to Bluetooth to turn Bluetooth on. A list of Bluetooth devices will appear. Tap your "FutureBuds" in the list to connect.

3 / Full operation guidelines

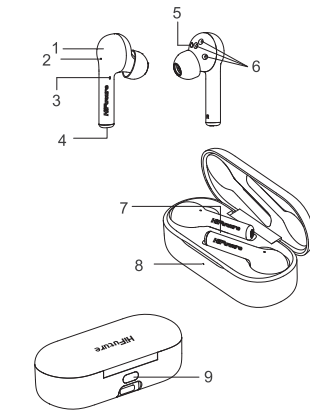

1. Tap control area
2. Sound pressure relief orifice.
3. ENC microphone
4. Main microphone
5. Optical sensor
6. Charging points
7. Hall sensor
8. Charging case and power indicator
9. Rear: MFB

4 / Tap Control Instructions

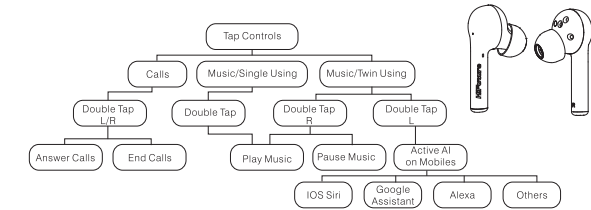

5 / Restore to factory setting

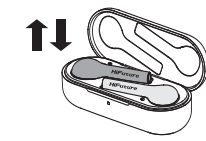

Put both Earbuds into the charging case and remain cover opening
 Press the Rear MFB for 10 seconds until RED lights blinks, the earbuds had been restored to factory setting now.
 Remarks: You should remove the "FutureBuds" from your device's Bluetooth List, and follow Step 1 & Step 2 before reconnection.

6 / Charging

Charging by the charging case

Charging Ways of Headset

When earbuds been put into charging case will activate charging automatically. The Charging case's indicator lights Red while closing cover tells battery low. The Charging case's indicator lights Orange while closing cover tells 50% charged. The Charging case's indicator lights Green while closing cover tells fully charged.

Charging by Micro USB to the charging case

Use the USB type C cable to charge FutureBuds with computer. Use the USB type C cable to charge FutureBuds with charger.

Warning:
 You must select a qualified charger from a regular manufacturer. (Charging Voltage: 5V Charging Current: 500mA)
 A fully charged headset will lose its power automatically if left unused. It is recommended to charge the headset each week. Do not leave the headset in a too hot or too cold condition (best between -10°C and 50°C) which may affect the headset's operations although it is fully charged.
 Do not dispose of the headset into fire or water.

FCC Statement

This equipment has been tested and found to comply with the limits for a Class B digital device, pursuant to part 15 of the FCC Rules. These limits are designed to provide reasonable protection against harmful interference in a residential installation. This equipment generates, uses and can radiate radio frequency energy and, if not installed and used in accordance with the instructions, may cause harmful interference to radio communications. However, there is no guarantee that interference will not occur in a particular installation. If this equipment does cause harmful interference to radio or television reception, which can be determined by turning the equipment off and on, the user is encouraged to try to correct the interference by one or more of the following measures:

- Reorient or relocate the receiving antenna.
- Increase the separation between the equipment and receiver.
- Connect the equipment into an outlet on a circuit different from that to which the receiver is connected.
- Consult the dealer or an experienced radio/TV technician for help.

Caution: Any changes or modifications to this device not explicitly approved by manufacturer could void your authority to operate this equipment.

This device complies with part 15 of the FCC Rules. Operation is subject to the following two conditions: (1) This device may not cause harmful interference, and (2) this device must accept any interference received, including interference that may cause undesired operation.

RF Exposure Information

The device has been evaluated to meet general RF exposure requirement. The device can be used in portable exposure condition without restriction.