



POWERFLIGHT™ SMART MOTION MALLARD™

USER'S MANUAL



MOBILE APP REMOTE CONTROL

The Avian-X Smart Motion decoy can be remotely controlled by either the provided hardware remote or from your mobile device through the Avian-X Factor™ app. The hardware remote controls the decoy's simplest functions, but to harness the full customization and control of the decoy you'll want to download and use the mobile app.

1. After you've assembled the decoy and powered it on, flip the switch on the underside of the decoy to the "Remote/App position".
2. Download the Avian-X Factor™ app from the Apple app store or Google Play.



3. Register a new account or login.
4. To add a Smart Motion decoy, locate the "Decoys" tab in the footer navigation. Click "ADD" in the upper right-hand corner to pair to the decoy. Add as many decoys as you'd like in the app using this method.
5. Name the decoy, select the desired mode, start and stop this single decoy all within that individual decoy's device card.

NOTE: Please see page 12 to reset to new pairing mode.

Page 1

DECOY ASSEMBLY

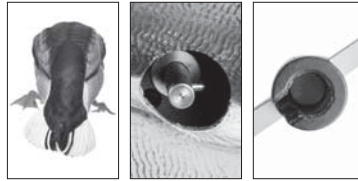

1. Face the decoy with the head pointed away from you and the top of the decoy facing up.
2. Take the wing with the "L" on the shaft. Line up the pin on the decoy shaft with the female pin slot on molded wing shaft on the left side of the decoy.
3. Push wing onto decoy shaft.
4. Take the wing with the "R" on the shaft. Line up the pin on the decoy shaft with the female pin slot on molded wing shaft on the right side of the decoy.
5. Push wing onto decoy shaft.

Page 2

BATTERY INSTALLATION



1. With the decoy head facing away and the bottom of the decoy facing up, insert battery and battery cover into female battery chamber.
2. Make sure to align battery terminal with connection terminals located in battery chamber.
3. Press downward until you hear snapping sound and battery cover is flush with bottom of decoy.
4. Test to make sure battery is secured correctly before placing decoy on stake.

Page 3

BATTERY REMOVAL

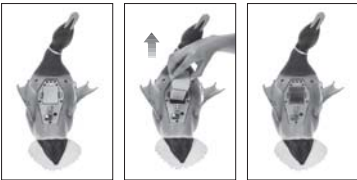

1. With the decoy head facing away and the bottom of the decoy facing up grasp both battery cover clips by pressing inward, until battery cover is released from battery chamber.
2. With one motion pull upward removing battery from battery chamber.

Page 4

STAKE ASSEMBLY

3 Sections 2 Sections

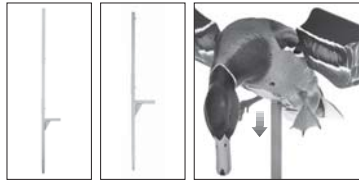

1. The stake can be used with 2 or 3 sections depending on how high off the ground you want the decoy.
2. To assemble the stake follow the diagram.
3. To mount to the decoy, take the square end and push square post of decoy into the stake.

Page 5

DECOY OPERATION



1. To power on the decoy, use the switch on the bottom of the decoy. The switch is printed with "I" which means REMOTE, "O" which means OFF, and "II" which means SPIN.

Page 6

REMOTE OPERATION



1. Turn switch to "REMOTE" position on the decoy.
2. For "SPIN" motion press the button that is printed with "SPIN".
3. For "INTERMITTENT" motion press the middle button that is printed with "INTERMITTENT".
4. To turn motion "OFF" press the bottom button that is printed with "OFF".

Page 7

REMOTE BATTERY REPLACEMENT



1. Turn the remote so the back is facing up.
2. Remove the two screws holding the battery cap on.
3. Lift Battery cap off to expose the battery.
4. Replace battery with new CR2032 (Positive/+ side up).

Page 8

REMOTE PAIRING

Remote Pairing: these instructions can be used to pair a replacement remote to current decoy or to pair multiple decoys to one remote.



1. Turn on decoy with battery in decoy and turn switch to "REMOTE".
2. Press and hold "SPIN" button on remote for more than 4 seconds and release.
3. The LED inside decoy will be flashing.
4. Press the "SPIN" button once and release.
5. The LED inside the decoy will stop flashing when it is paired.

Page 9

CHARGING BATTERY



1. With battery removed, locate the charging port on side of battery.
2. Insert charger cord and plug charger in.
3. Light on battery will be RED when charging and GREEN when Charged.
4. When complete remove charging cord and reinsert battery into decoy.

Page 10

STORAGE & TRANSPORTATION

1. When storing the decoy, the wings should be removed and stored flat and in a safe place to avoid damage.
2. The battery should also be removed and stored in a cool dry location.
3. For transporting the decoy, the wings should be removed to avoid damage to the wings.

Page 11

PARTS LIST

- Charger
- Stake
- Feet (set)
- Remote
- Wings (set)
- Battery
- Battery Cover

Page 12

NOTES

Page 13

WARRANTY

Avian-X products are covered by a One Year Limited Warranty. For more information go to: <https://www.avian-x.com/shipping-returns/>

DISCLAIMER

Avian-X is not responsible for damage, expense or injury caused by the unauthorized use of, alterations to, improper connection of and abuse or neglect of Avian-X products.

Avian-X reserves the right to make changes to product features, functionality and physical design at its sole discretion. As a result, such changes may not be reflected in this version of the manual.

Page 14

FCC & ICC

FCC STATEMENT

Product Name: Power Flight Smart Duck
Trade Name: Avian-X
Model#: AVXDPI00 (Main Unit)
Model#: AVXDPI00 (Remote)
This device complies with Part 15 of the FCC Rules. Operation is subject to the following two criteria: (1) This device may not cause harmful interference, and (2) This device must accept any interference received, including interference that may cause undesired operation.
Warning: Changes or modifications to this unit not expressly approved by the party responsible for compliance could void the user's authority to operate the equipment.
NOTE: This equipment has been tested and found to comply with the limits for a Class B digital device, pursuant to Part 15 of the FCC Rules. These limits are designed to provide reasonable protection against harmful interference in a residential installation. This equipment generates, uses and can radiate radio frequency energy and, if not installed and used in accordance with the instructions, may cause harmful interference to radio communications.
However, there is no guarantee that interference will not occur in a particular installation. If this equipment does cause harmful interference to radio or television reception, which can be determined by turning the equipment off and on, the user is encouraged to try to correct the interference by one or more of the following measures:
-Reorient or relocate the receiving antenna.
-Increase the separation between the equipment and receiver.
-Connect the equipment into an outlet on a circuit different from that to which the receiver is connected.
-Consult the dealer or an experienced radio/TV technician for help.

BED COMPLIANCE STATEMENT

This device contains licence-exempt transmitter(s)/receiver(s) that comply with Innovation, Science and Economic Development Canada's licence-exempt RSS(s). Operation is subject to the following two conditions: (1) This device may not cause interference. (2) This device must accept any interference, including interference that may cause undesired operation of the device.
This equipment complies with FCC/ICES radiation exposure limits set forth for an uncontrolled environment. This equipment complies with FCC and IC radiation exposure limits set forth for an uncontrolled environment. This equipment should be installed and operated with minimum distance 20cm between the radiator & your body.
GSM, LLC
AVXDPI001
FCC: 2AU3A-AVXDPI00
IC: 25750-AVXDPI00

Page 15

