

NOTIFAI

Multi Sensor

Model: ELT-100005

INSTRUCTION MANUAL



The NotifAi ELT-100005 is designed for professional installation by NotifAi trained installation engineers. Please refer to this instruction manual for important limitations of use and disposal information.

Introduction

The ELT-100005 Multi sensor is designed for indoor use, to be used as part of the Ell-iot cloud sensor platform. The Ell-iot dashboard will provide notifications of abnormal sensor readings and battery low warnings.

The multi sensor will provide the following information to the Ell-iot cloud sensor platform

Light Level (Red Green Blue and IR / ALS)

Temperature

Humidity

Moisture Level (Use External Sensor Cable)

Usage Limits

Indoor use only

Operating Temperature range : -10 to 60C

Operating Humidity : 0-90% non condensing.

There are no user service parts inside and battery replacement must be done by an Ell-iot Inc trained service engineer.

Operating Instructions

Installation by Ell-iot trained engineers only. For use with the ELT-100004 Sensor Hub.

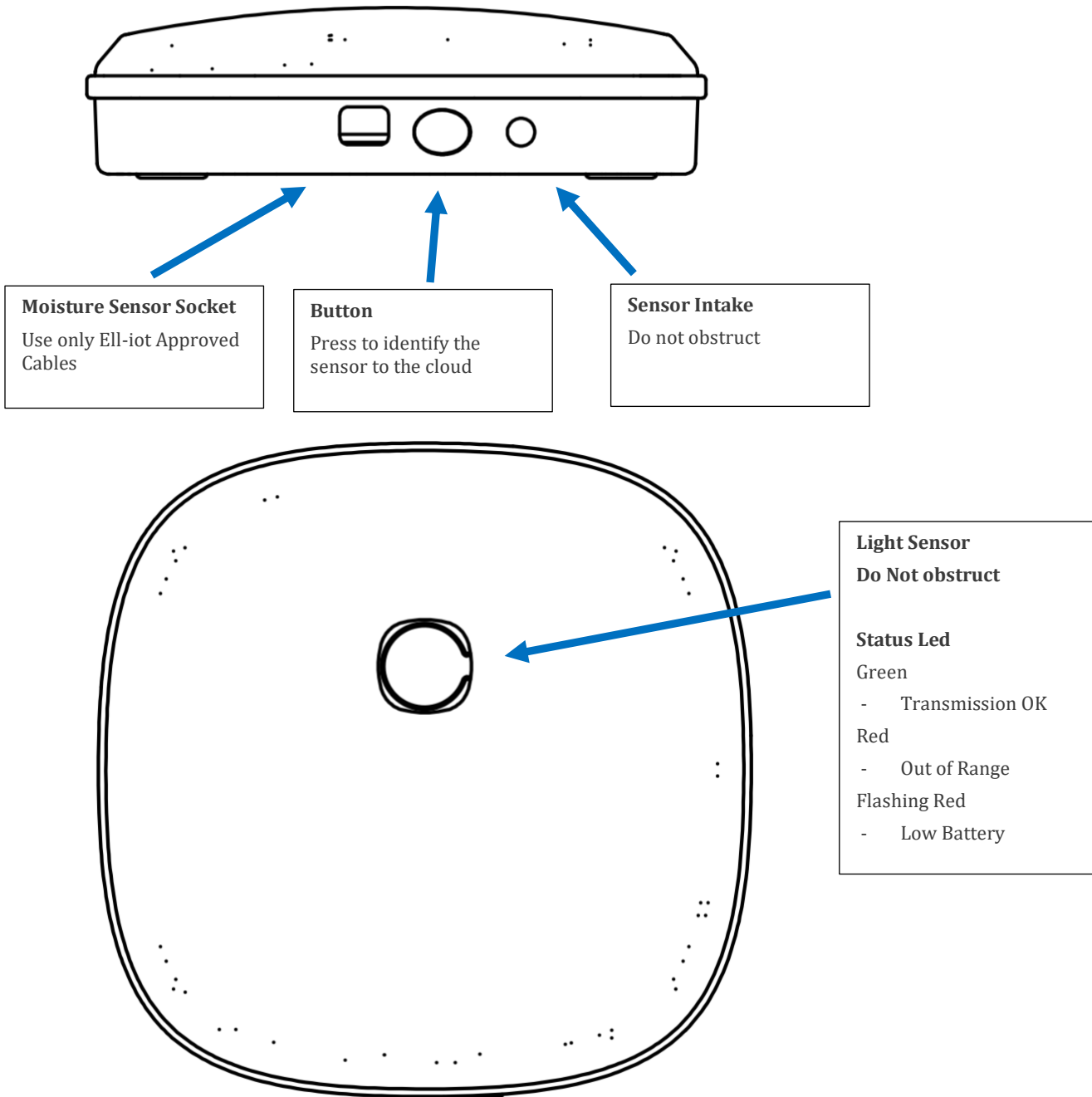

FCC Compliance Statement

for Model No. ELT-100005

This Statement is part of the User Manual



Caution: This marking indicates that the user should read all included documentation before use. Retain this supplement for future reference

Users of this product are cautioned to use accessories and peripherals approved by Ell-iot Inc . The use of accessories other than those recommended, or changes to this product that are not approved by El-iot INC, may void the compliance of this product and may result in the loss of the user's authority to operate the equipment.



Caution: For use with ELT-100004 Receiver Hub only. See battery instructions. No user-serviceable parts.

Battery Recycling Information

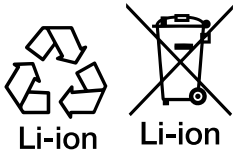

This product contains or uses a lithium-metal (Li-metal) primary main battery. When the battery reaches the end of its useful life, the spent battery should be disposed of by a qualified recycler or hazardous materials handler. Do not mix this battery with the solid waste stream. Contact your Ell-iot Service Center for recycling or disposal information.



For Indoor Use only

Radiation Exposure Statement



WARNING

The device has been evaluated to meet general RF exposure requirement. To maintain compliance with FCC's RF exposure guidelines, the distance must be at least 20 cm between the radiator and your body, and fully supported by the operating and installation configurations of the transmitter and its antenna(s).

U.S.A. Digital Emissions Compliance

This device complies with part 15 of the FCC Rules. Operation is subject to the following two conditions: (1) This device may not cause harmful interference, and (2) this device must accept any interference received, including interference that may cause undesired operation.

Note: This equipment has been tested and found to comply with the limits for a Class B digital device, pursuant to part 15 of the FCC Rules. These limits are designed to provide reasonable protection against harmful interference in a residential installation. This equipment generates, uses and can radiate radio frequency energy and, if not installed and used in accordance with the instructions, may cause harmful interference to radio communications. However, there is no guarantee that interference will not occur in a particular installation. If this equipment does cause harmful interference to radio or television reception, which can be determined by turning the equipment off and on, the user is encouraged to try to correct the interference by one or more of the following measures:

- Reorient or relocate the receiving antenna.
- Increase the separation between the equipment and receiver.
- Connect the equipment into an outlet on a circuit different from that to which the receiver is connected.
- Consult the dealer or an experienced radio/TV technician for help.

Note: The Grantee is not responsible for any changes or modifications not expressly approved by the party responsible for compliance. such modifications could void the user's authority to operate the equipment.

CE Compliance Statement



Caution: This marking indicates that the user should read all included documentation before use. Retain this supplement for future reference

Users of this product are cautioned to use accessories and peripherals approved Ell-iot Inc. The use of accessories other than those recommended, or changes to this product that are not approved by Ell-iot Inc, may void the compliance of this product and may result in the loss of the user's authority to operate the equipment.



Caution: For use with ELT-100004 Receiver Base only. See battery instructions. No user-serviceable parts.

Battery Recycling Information

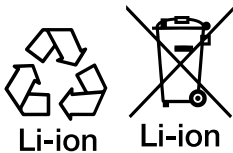

This product contains or uses a lithium-metal (Li-metal) main battery. When the battery reaches the end of its useful life, the spent battery should be disposed of by a qualified recycler or hazardous materials handler. Do not mix this battery with the solid waste stream. Contact Ell-iot Inc Service Center for recycling or disposal information.



Indoor Use Only

Radiation Exposure Statement



Warning: This equipment complies with International Commission on Non-Ionizing Radiation Protection (ICNIRP), IEEE C95.1, Federal Communications Commission Office of Engineering and Technology (OET) Bulletin 65, Canada RSS-102, and European Committee for Electrotechnical Standardization (CENELEC) limits for exposure to radio frequency (RF) radiation.

EU – R&TTE Declaration

Elliot Inc declares that this device is in accordance with the essential requirements and other provisions of R&TTE Directive (1995/5/EC).



This product is marked with this logo and uses radio frequency bands that are not harmonized throughout the European Union and other countries as noted in the table below.

This equipment may be operated in the following countries without restriction:

AT, BE, CY, CZ, DK, EE, FI, DE, GR, HU, IE, IT, LV, LT, LU, MT, NL, PL, PT, SK, SI, ES, SE, GB, IS, LI, CH, BG, RO, TR

Copyright© 2019 Elliot Inc

The contents of this document, either in part or in their entirety, may not be reproduced, forwarded, distributed or saved in any way without Elliot Inc prior written consent.

The contents of this document are presented as they currently exist. Elliot does not provide any express or tacit guarantee for the correctness or completeness of the contents of this document, including, but not restricted to, the tacit guarantee of market suitability or fitness for a specific purpose unless applicable laws or court decisions make liability mandatory. Elliot Inc reserves the right to make changes to this document or to withdraw it any time without prior notice

Elliot Inc 32 Journey, Aliso Viejo, California, USA

Phone: xxxxxxxxx

E-Mail: sales@elliot.com .