

# User Manual

## Wireless Bluetooth Speaker PentaClass G2

### ※ Brief Introduction

The wireless Bluetooth speaker has all the outstanding performances of the previous generation products. High integration, strong anti-interference, generous input connectors, and the sound quality is good, as its sound quality reaches to the level of HDCD, having a good reputation of the highest sampling rate at present and the best sound quality in the industry. At the same time, the following features have been added.

### ※ Packing List

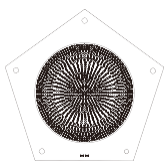

● Bluetooth Speaker



● Mounting Bracket

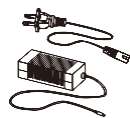

● Power Cord  
Power Adapter

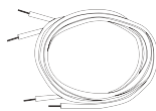

● Audio Cable

### ※ Function Parts

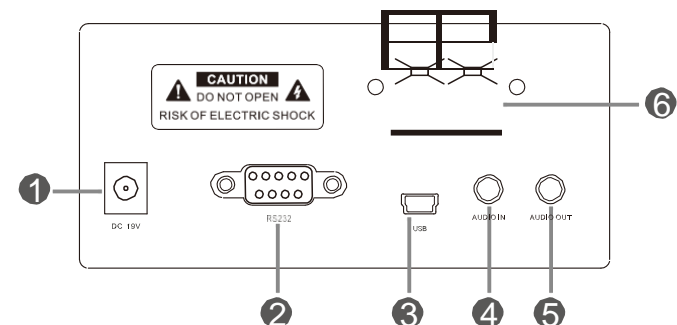

- |               |                 |                   |
|---------------|-----------------|-------------------|
| 1 DC IN       | 3 USB Interface | 5 Audio Out       |
| 2 RS-232 Port | 4 Audio In      | 6 Broadcast input |

### ※ Operation guide

When in daily use, please power on and power off, when you don't use it. Operating steps.

#### Step1. Turn on the bluetooth speaker and prepare your bluetooth device.

- Press/hold the power switch for 3 seconds to turn on the speaker, The power status light will now shine red.
- Turn on the bluetooth on your device, and prepare to sync devices.

#### Step2. Bluetooth connection

Search for device from your bluetooth device, no password is needed. Connect to the device and you will hear "Pairing completed." When connected, the bluetooth indicator will shine green.

#### Step3. Play music

After the bluetooth is connected, open the music player from your bluetooth device and play. When playing music the bluetooth indicator will shut off.

#### Step4. Turn off the speaker bluetooth device

- Press/hold the power switch for 3 seconds to turn off the speaker, the power status light will shut off.
- Turn off your bluetooth device as necessary.

### Wired Audio mode/aux line in Plug an

auxiliary audio cable, 3.5mm jack into the speaker Connect the other end of the jack into your music device Then you can play music.



● Cellphone & Bluetooth devices

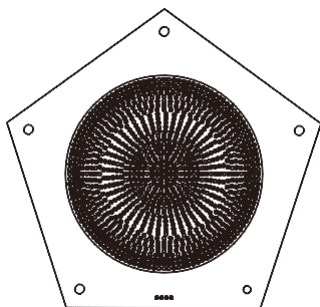

● Bluetooth speaker



**Note:** Don't use the bluetooth mode while using the wired audio mode  
Volume adjustment from your music play or the bluetooth speaker maybe necessary

### ※Trouble Shooting

#### 1. Can not find BT device with your bluetooth device when pairing.

Reason 1: Bluetooth speaker battery could be low

Solution 1: Please charge the speaker

Reason2: The speaker could not be powered or

Solution2: Please make sure the speaker is on

Reason3: The speaker could be out of bluetooth range

Solution3: Please make sure the range is not beyond 10meters 30 feet)

#### 2. Can not connect to BT device with your blue-tooth device

Reason 1: bluetooth device could be paired with another device

Solution 1: Turn off the other connected device and pair again

Reason2: bluetooth may need to be restarted

Solution2:Power the speaker off and on Connect devices and pair

### ※ Safety Precautions and Procedures

**Attention! Safety Operation Procedures: To avoid injury from electric shock adhere to the following safety procedures:**

- ◇ **DO NOT** touch the power plug with wet hands.Power outlet mustbe 110V AC.
- ◇ **DO NOT** pull on the power cord to disconnect from the outlet.Stress to the cord can result in pulling the cord from the plug.
- ◇ **DO NOT** place transmitter or receiver around direct sunlight orany heat source such as electric/gas stove or heaters of anykind.Do not place near an open flame.
- ◇ **DO NOT** place anything on top of the receiver or transmitter. Allow the unit to sit in an “openair” environment with plenty ofroom around it. Unit can overheat when notinan“open air”environment.
- ◇ **DO NOT** take apart the transmitter orreceiver for any reason.this could cause electric shock. please direct questions to customer support

**NOT FOLLOWING SAFETY PROCEEDURES VOIDS ALL WARRANTIES!**

### ※ Specifications

NO.	Description	Parameter
1	Frequency Response	20Hz-20KHz
2	Operating Voltage	AC120V/60Hz
3	S/N Ratio	95dB
4	Sensitivity	>85dB
5	THD	0.3% @ 1KHz
6	Resolution	>40dB
7	Sound Latency	<0.5ms
8	Working Temperature	-25°C-85°C

# FCC Warning

## **a、 § 15.19 Labeling requirements.**

This device complies with part 15 of the FCC Rules. Operation is subject to the following two conditions: (1) This device may not cause harmful interference, and (2) this device must accept any interference received, including interference that may cause undesired operation.

## **b、 § 15.21 Changes or modification warning.**

Any Changes or modifications not expressly approved by the party responsible for compliance could void the user's authority to operate the equipment.

## **c、 § 15.105 Information to the user.**

**Note:** This equipment has been tested and found to comply with the limits for a Class B digital device, pursuant to part 15 of the FCC Rules. These limits are designed to provide reasonable protection against harmful interference in a residential installation. This equipment generates uses and can radiate radio frequency energy and, if not installed and used in accordance with the instructions, may cause harmful interference to radio communications. However, there is no guarantee that interference will not occur in a particular installation. If this equipment does cause harmful interference to radio or television reception, which can be determined by turning the equipment off and on, the user is encouraged to try to correct the interference by one or more of the following measures:

- ▶ -Reorient or relocate the receiving antenna.
- ▶ -Increase the separation between the equipment and receiver.
- ▶ -Connect the equipment into an outlet on a circuit different from that to which the receiver is connected.
- ▶ -Consult the dealer or an experienced radio/TV technician for help.

The device has been evaluated to meet general RF exposure requirement.

The device can be used in portable exposure condition without restriction.