

# "Dimming switch panel" instruction manual

**Shanghai Unisplendor Lelian  
Internet of Things Technology  
Co.,Ltd**

## **R&D department**

文件标识:	UIOT-YFB-DETAILDOC
应用部门:	R&D department
保存期限:	

---

## Document revision history

date	version	Description	Author	Approver
2019-10-09	V1.0.0	Initial release	Guangyue Hu	

U10T-超级智慧家

---

# Dimming switch panel

## 1 Product Features

### 1.1. Functional description

1. This device only supports resistive load and dimmable LED lamps.
- 2, with local control / remote control two control methods, you can control dimming through the client or button.
3. When the light is turned on, the brightness of the light will remain the state of the light before the last time the light was turned off.
4. Power-off recovery function: After power-off and power-on, restore the state before power-off (set by mobile APP).



---

## 2 Product structure

### 2.1. Product panel diagram

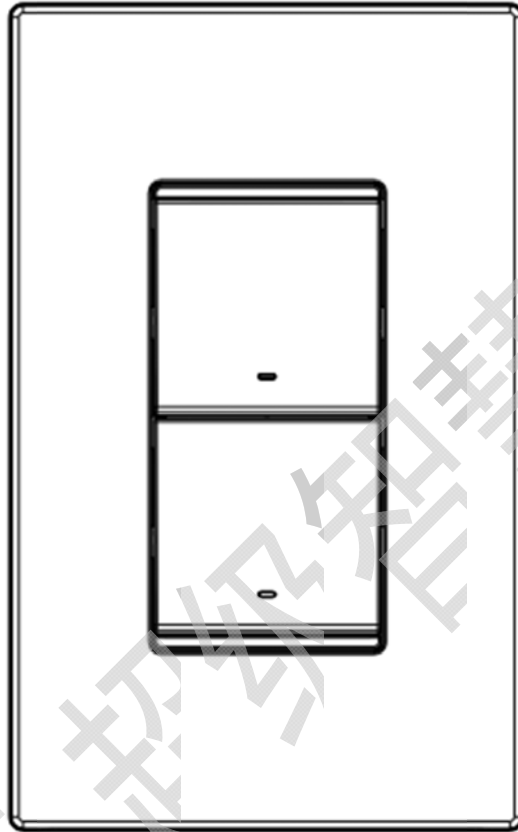

### 2.2. Product wiring instructions

Blue line (zero line), brown line (hot line), red line (output line), yellow-green line (ground line)

---

### 2.3. Product Structure

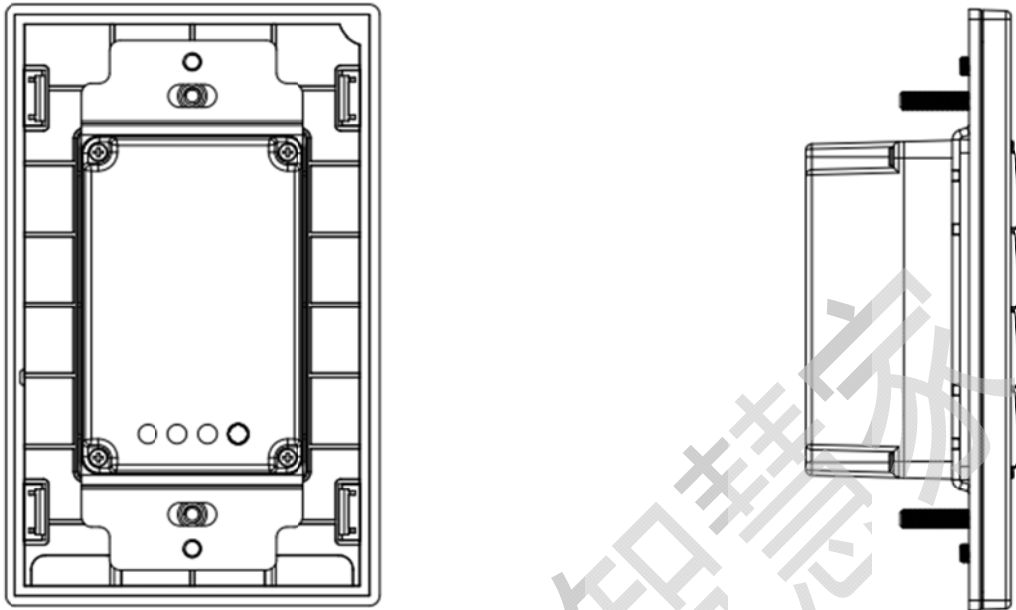

## 3 installation steps

### 3.1. Installation requirements

1. The product housing is a special housing for the dimmer switch;
2. The installation cassette is an American UL certified junction box with position adjustment;
3. Cannot be installed outdoors.

### 3.2. Product installation steps

1. Cut off the mains power supply, follow the wiring diagram, connect the line, be sure to confirm the wiring is correct.
2. Put the dimmer switch flat into the wall prefabricated American UL certification junction box, and manage the line.

---

3. Fix the bottom case to the American UL-certified junction box of the indoor wall with screws, pay attention to the installation direction.

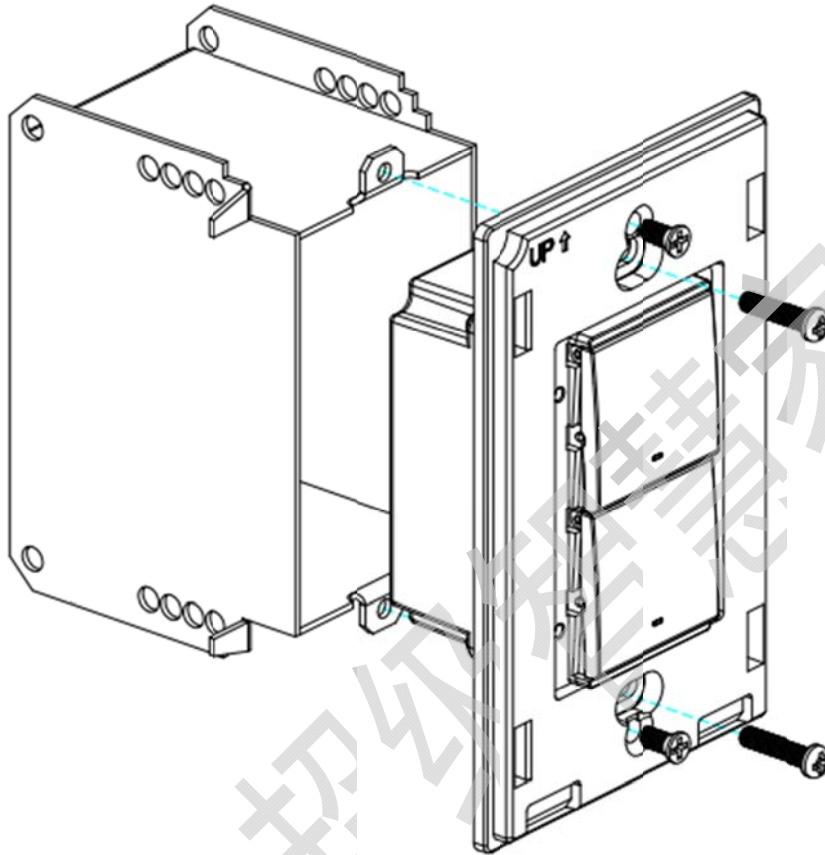

4. Align the top end of the panel with the bottom case and place it in the bayonet.

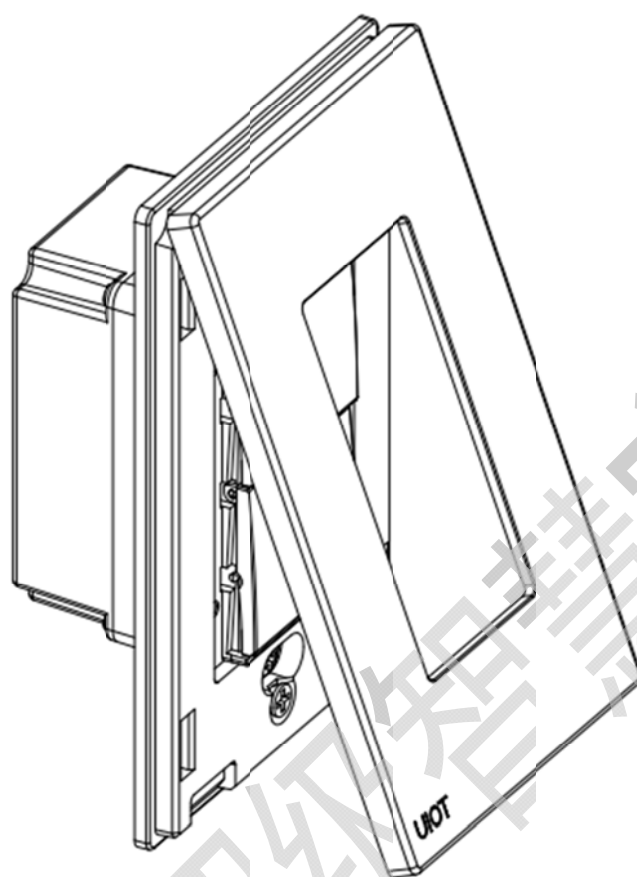

5. Press the lower end of the panel to the bottom of the shell to complete the product installation.

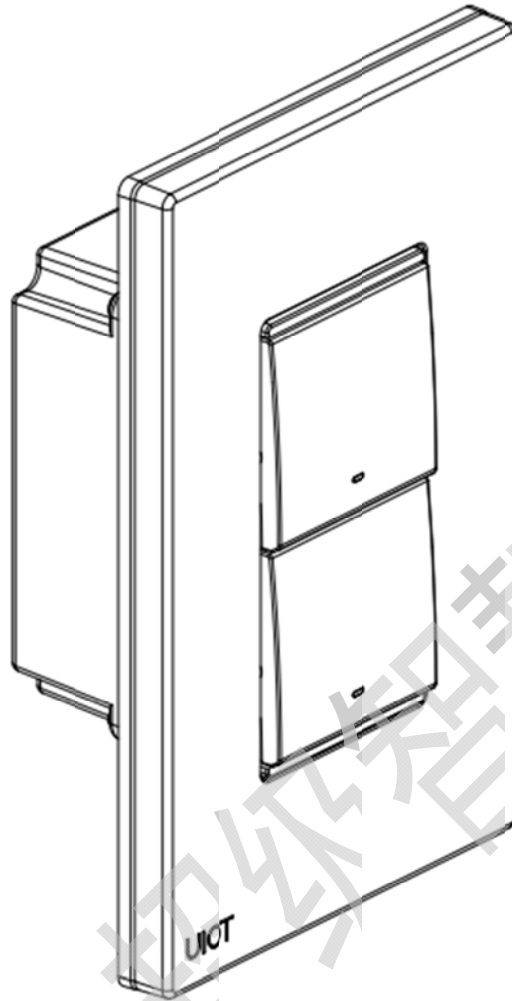

## 4 Network access instructions

### 4.1. Network access instructions

1. After the device is powered normally, connect the smart server, register and log in to the smart home APP as shown below: Click “My” in the area indicated by the arrow in the lower right corner.



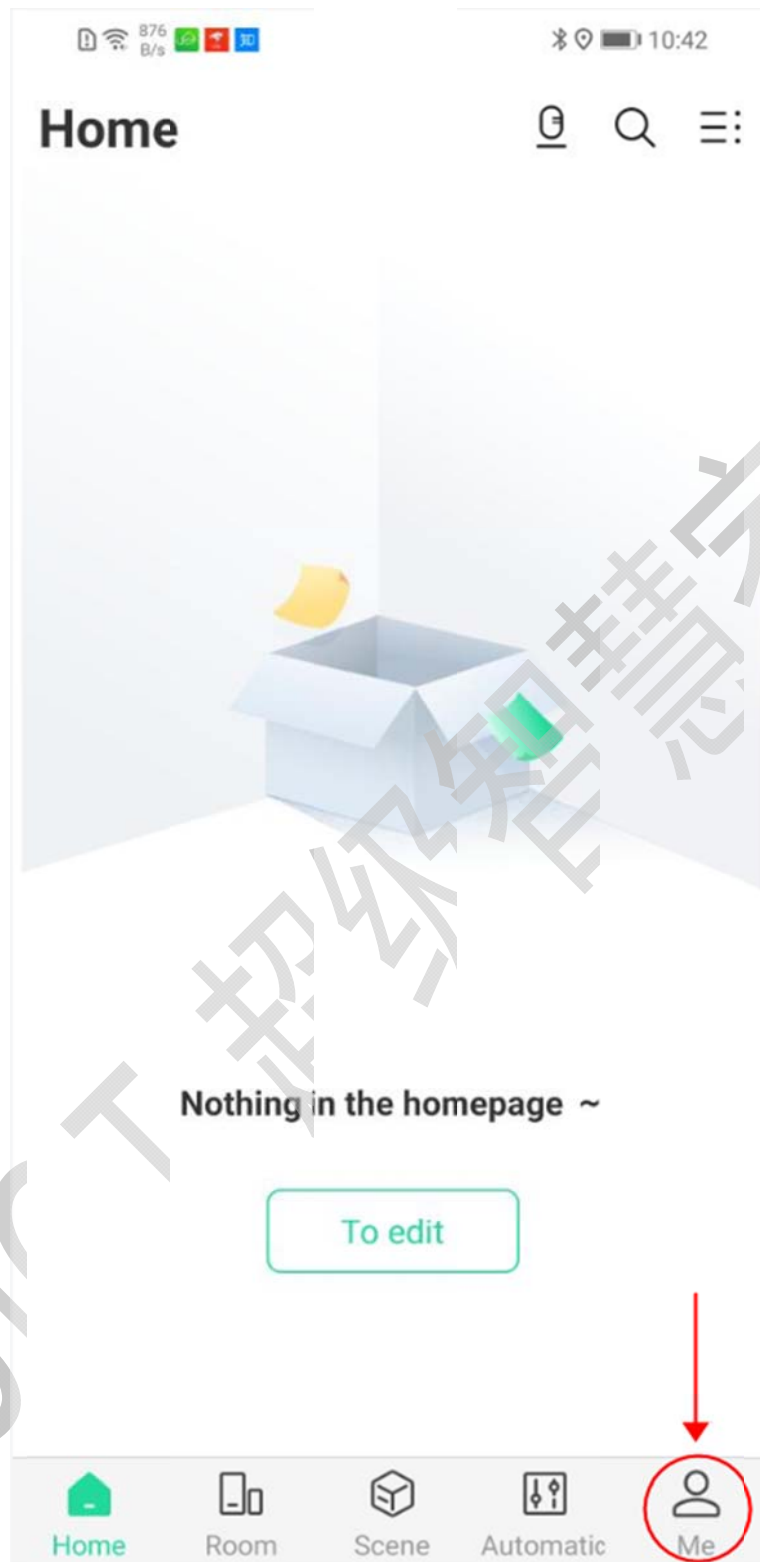

2. Go to the interface shown below and click on “Device Management” at the red arrow in the upper left corner of the interface shown below.

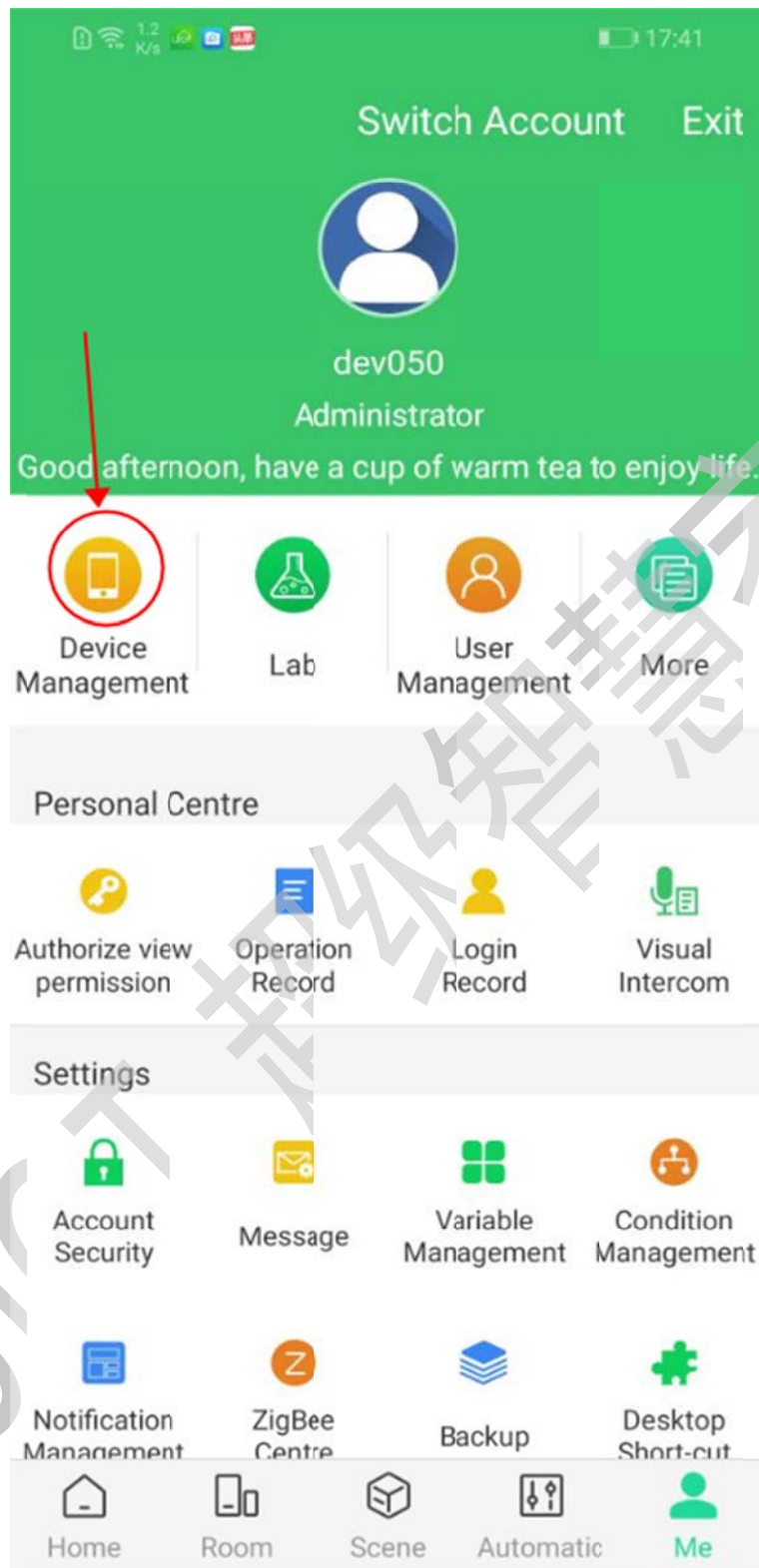

3. Go to the device management interface below and click the “+” sign in the red arrow at the top right of the screen to add the device.

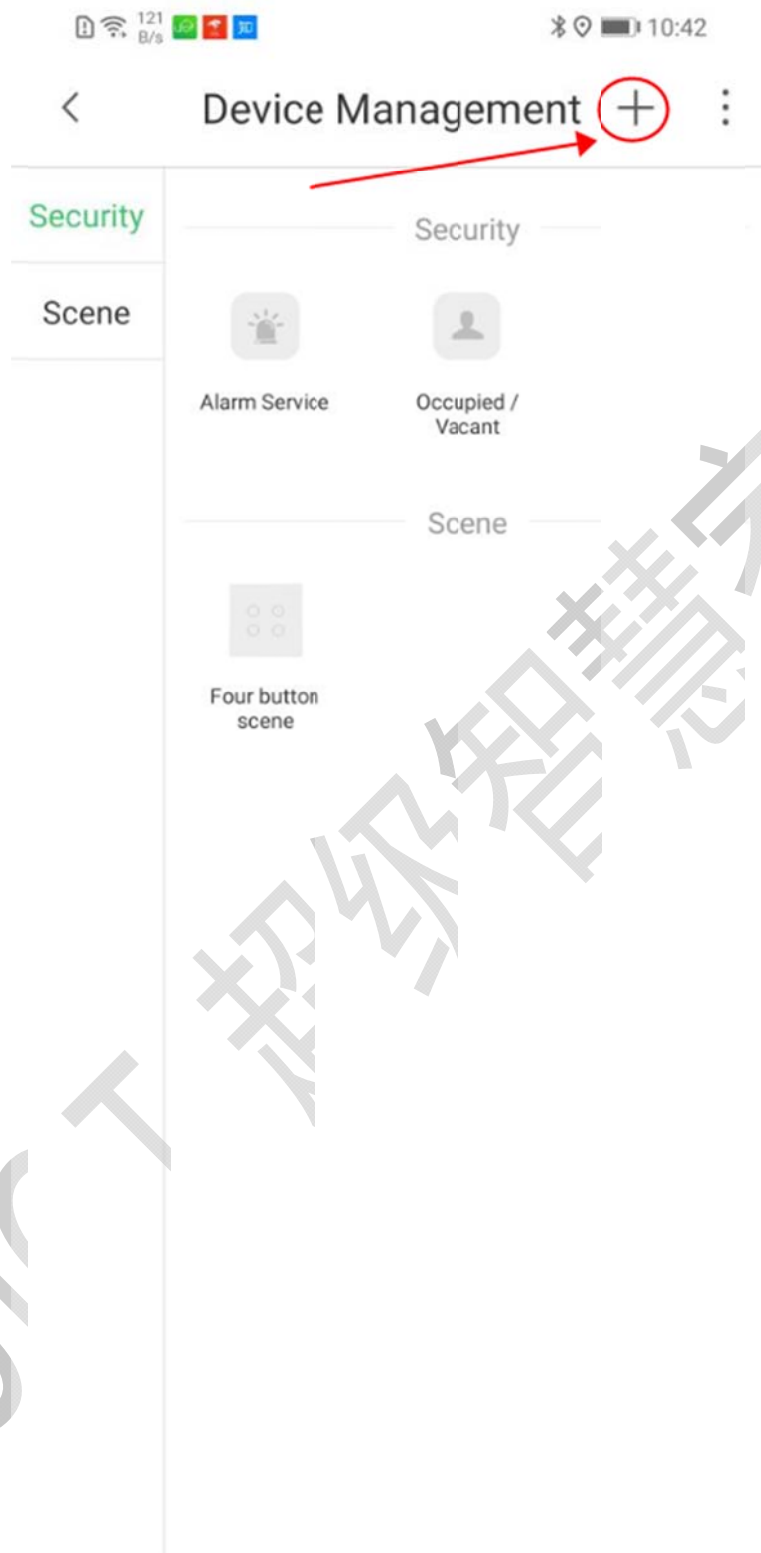

4. After entering the device type selection interface, as shown in the figure below, find the “lighting” indicated by the red arrow in the figure below and click to proceed to the next step.

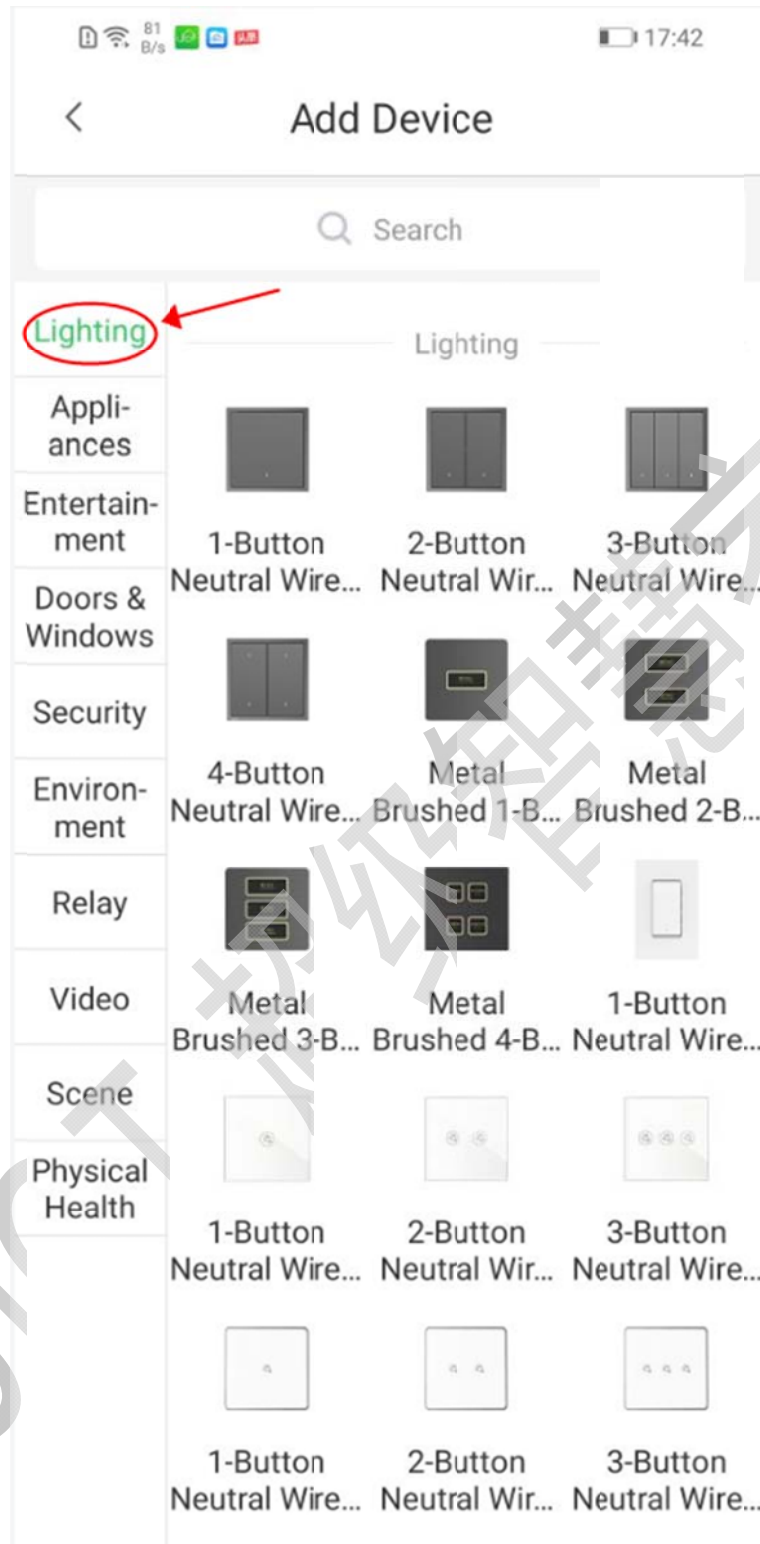

5. In the "Select Device Type" interface, find the "LED Dimming Switch Machine" icon as shown in the figure below, and click to go to the next step.

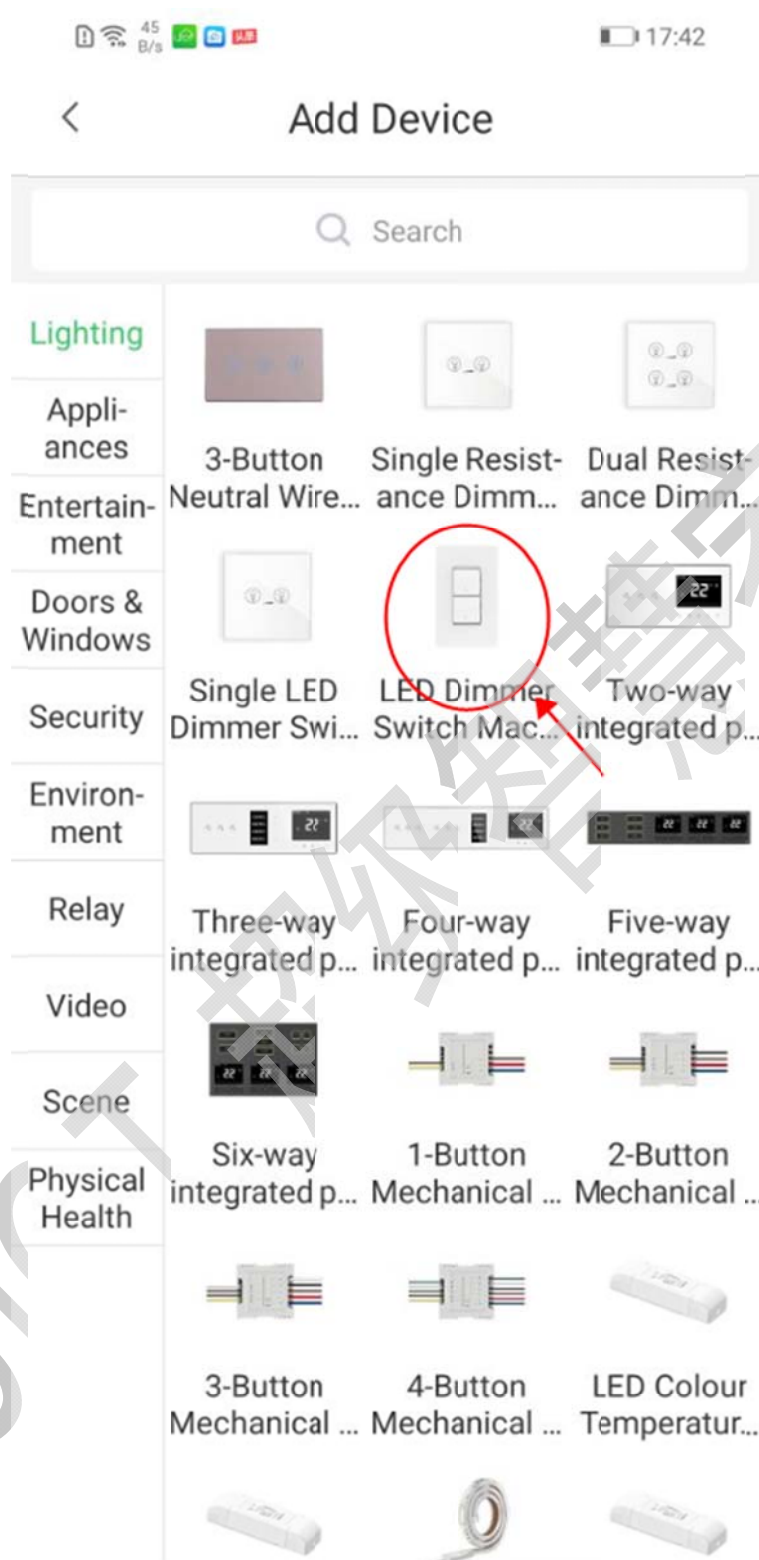

6. After clicking, enter the “Add LED Dimming Switch Machine” interface below, and follow the interface prompts to enter the network. After entering the network,

you can put the device into the created room and name the device for easy operation and management.

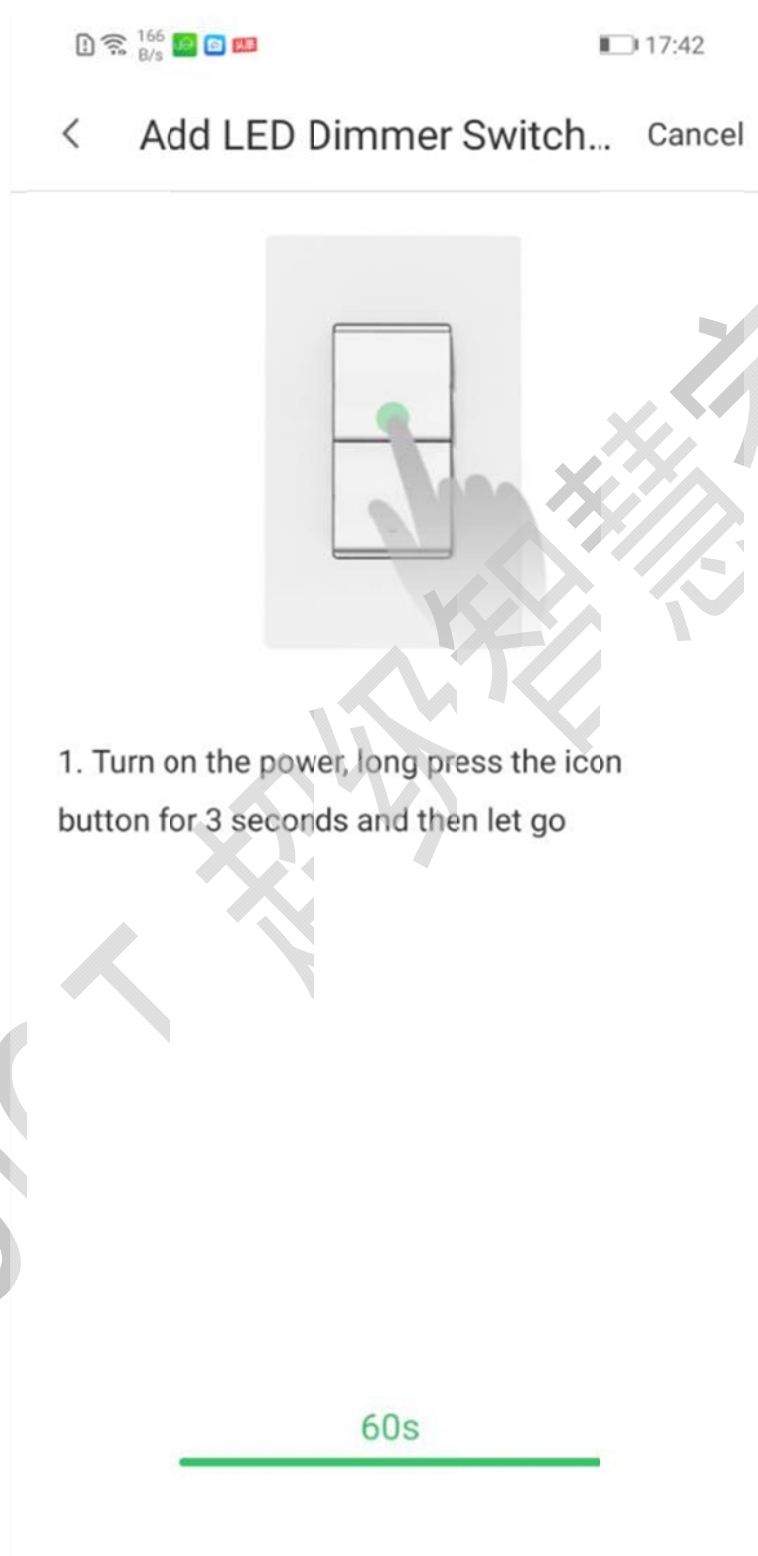

- 
7. After the network is successfully accessed, you can find the room you created and the equipment after the network. Quick operation of power-on and power-off in the room.



---

## 5 Instructions for use

### 5.1. Instructions for use

1. After the device is connected to the network, the control of turning on and off the lights and adjusting the light can be performed on the APP.

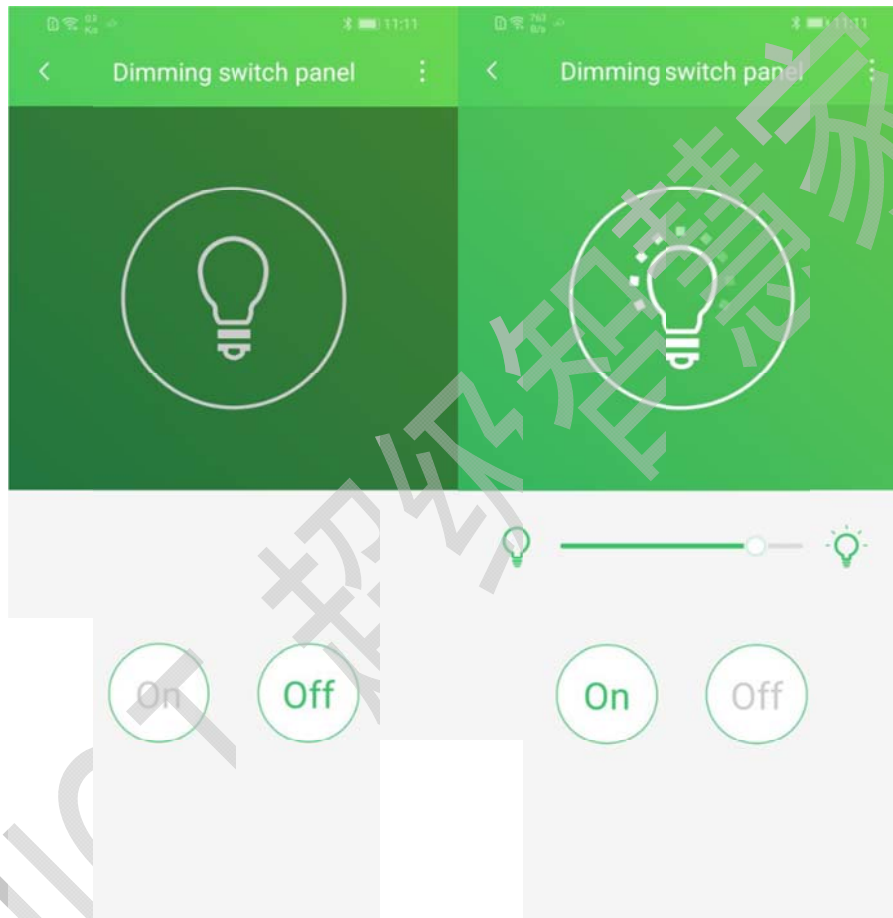

2. Device control page, the button in the upper right corner of the device, you can view more functions:



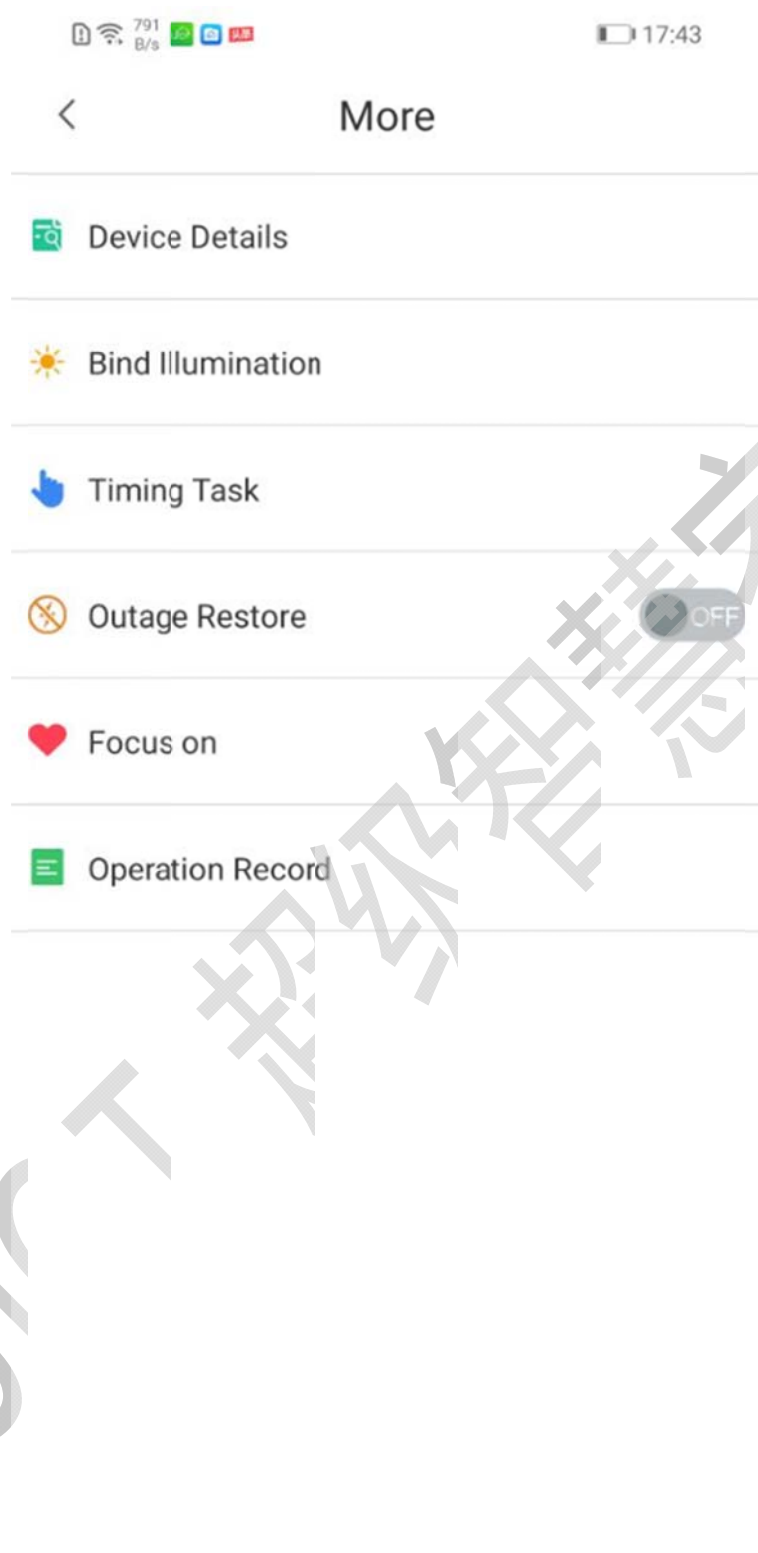

### 5.1.1. **Device details**

Click on device details to view device details data:

- 
- (1) Device information: view the device name, its own room, and control method
  - (2) Status: Online / Offline
  - (3) Signal strength: show the signal strength of the product
  - (4) Power supply mode: the power supply mode of the product
  - (5) Software version: software version information of the product
  - (6) Hardware version: hardware version information of the product
  - (7) Address: Product Identification Number



### 5.1.2. **Power failure recovery**

The product has a memory feature, and you can choose whether to remember the power-off state before power-off.

---

If you select memory, you will return to the pre-power-off state when you call again.

For example, the power-off recovery function is turned on, and the power is turned on before the power is turned off.

After the call is made, the device remains in the state before the power is turned off.

U/IOT-超级智慧家

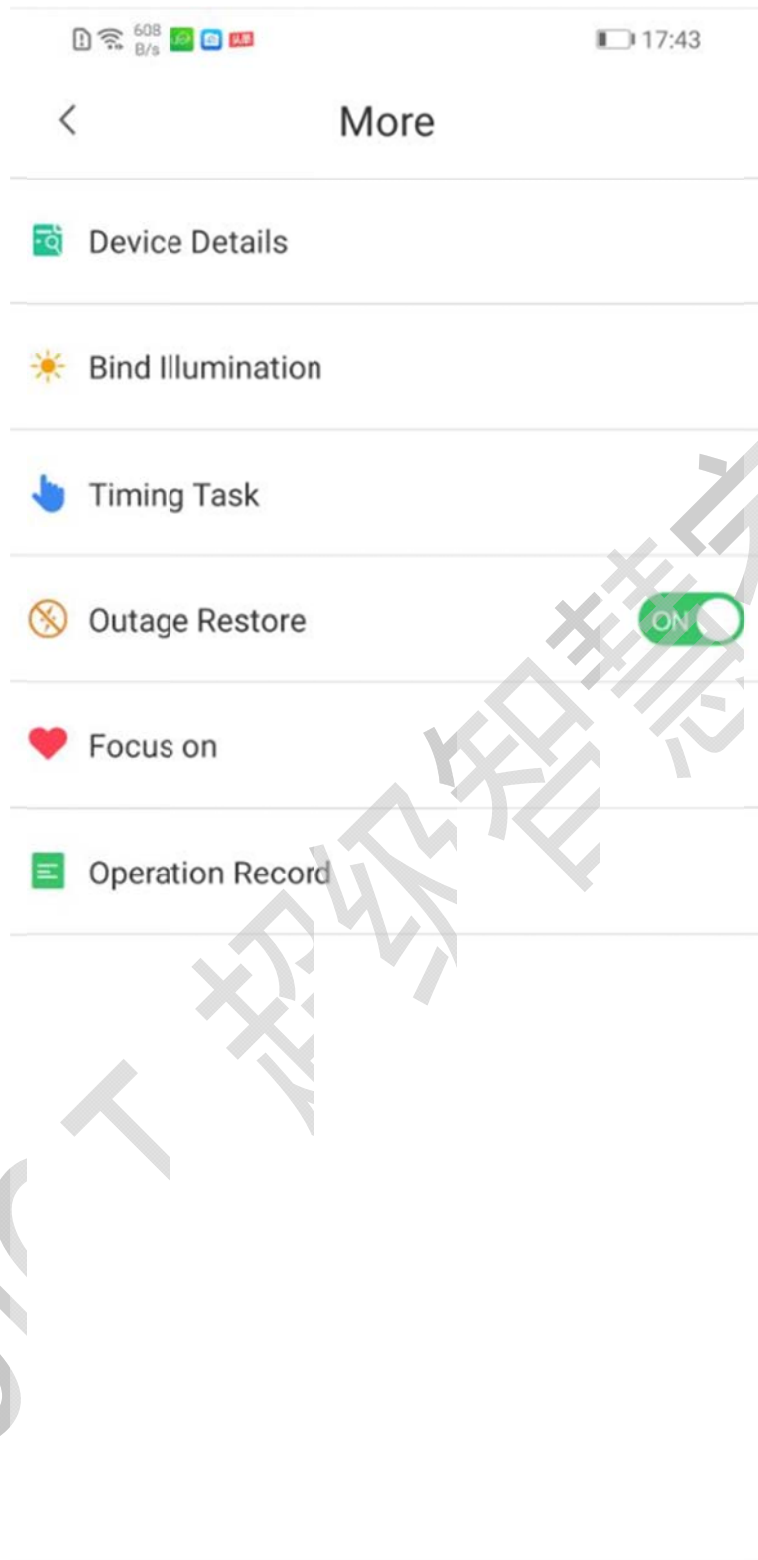

### 5.1.3. Operation record

On this page you can view the history of the device being operated.

## Operation Record

10.11 Friday

Just now	dev050 Control Enable power-off recovery
Just now	dev050 Control On
16:09:58	dev050 Control Close power-off recovery
16:09:55	dev050 Control Enable power-off recovery
16:09:28	dev050 Control Off
16:09:22	dev050 Control Dimming78%
16:09:21	dev050 Control Dimming13%
16:09:19	dev050 Control On
16:09:17	dev050 Control Off
16:09:16	dev050 Control On
16:09:14	dev050 Control Off
16:09:13	dev050 Control Dimming100%
16:09:10	dev050 Control Dimming26%
16:09:07	dev050 Control Dimming61%
16:09:03	dev050 Control On

### 5.1.4. Backlight

Click on “Backlight” to set the device backlight. Such as: turn on the backlight, turn off the backlight. In the state

---

of "turning on" the backlight, you can set the backlight brightness according to your needs.

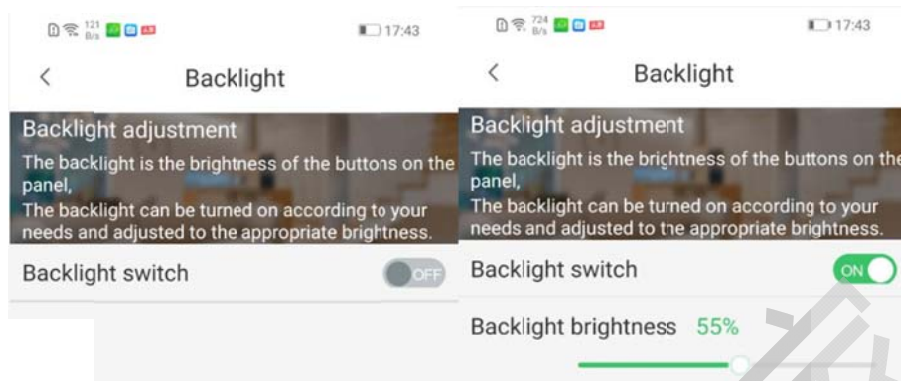

## 6 Product parameters

### 6.1. Product parameters

- 1.Product Size:119X74X40.5 mm
- 2.Operating Voltage: AC120V±10% 50/60Hz
- 3.Operating Temperature: -10℃~40℃
- 4.Working Humidity: <90% RH(non-condensing)
- 5.Communication Mode: IEEE 802.15.4(Zigbee)
- 6.Load: LED / CFL load ≤ 450W, halogen / incandescent ≤ 600W

**Note: It must be confirmed that the load current connected to the product meets the above requirements to avoid accidents!**

---

## 7 Common problem

## 8 Precautions

### 8.1. Installation and use precautions

1. There are fragile devices in the product. Please avoid destructive actions such as dropping and heavy pressure.
- 2, the product is a precision electronic device, pay attention to waterproof and avoid high temperature during use.
3. Do not drop foreign objects into the machine.
4. Do not disassemble or modify the unit in any way.
5. The main power supply must be cut off during installation to avoid accidents.
6. Wire the product in strict accordance with the product wiring diagram.
7. Do not press the device hard during the wiring process to avoid damage to the device.
8. When fixing the bottom case, do not press hard to avoid damage to the case.
9. Do not install the equipment in a humid environment.

### 8.2. Caveat

To prevent damage or property damage, be sure to follow the instructions and instructions below.



What this picture shows is that you cannot do the following [prohibited] content:

1. Absolute prohibition of disassembly: Non-professionals are prohibited from disassembly and modification to avoid damage or harm.



- 
2. Prohibit product water: It may cause short circuit and electric shock. The water on the panel will affect the sensitivity of the button.
  3. It is forbidden to use other AC power sources: using the power supply beyond the specifications will damage the product or cause harm.
  4. It is forbidden to use in high temperature, humidity and water in the bathroom: it is easy to cause leakage, electric shock, fire and other hazards.



As shown in this figure, be sure to perform the following [mandatory] contents.

1. Do not touch flammable substances or sources of ignition.



The content indicated by this mark is [indoor use].



What this sign indicates is [assuming the possibility of death or serious injury].

1. It is forbidden to use alcohol or organic solvent to wipe: it is responsible for damage or fire caused by electric shock or fire.



The content indicated by this mark is [cannot be placed in the trash can].



The content indicated by this mark is [high voltage danger].



The content represented by this mark is [Class 2].

### **RF exposure statement**

This equipment complies with the FCC RF radiation exposure limits set forth for an uncontrolled environment. This equipment should be installed and operated with a minimum distance of 20cm between the radiator and any part of your body.

This equipment meets the exemption from the routine evaluation limits in section 2.5 of RSS-102. It should be installed and operated with a minimum distance of 20cm between the radiator and any part of your body.

### **FCC Warning**

This device complies with Part 15 of the FCC Rules. Operation is subject to the following two conditions:

(1) This device may not cause harmful interference, and (2) this device must accept any interference received, including interference that may cause undesired operation.

NOTE 1: This equipment has been tested and found to comply with the limits for a Class B digital device, pursuant to part 15 of the FCC Rules. These limits are designed to provide reasonable protection against harmful interference in a residential installation. This equipment generates uses and can radiate radio frequency energy and, if not installed and used in accordance with the instructions, may cause harmful interference to radio communications. However, there is no guarantee that interference will not occur in a particular installation. If this equipment does cause harmful interference to radio or television reception, which can be determined by turning the equipment off and on, the user is encouraged to try to correct the interference by one or more of the following measures:

- Reorient or relocate the receiving antenna.
- Increase the separation between the equipment and receiver.
- Connect the equipment into an outlet on a circuit different from that to which the receiver is connected.
- Consult the dealer or an experienced radio/TV technician for help.

NOTE 2: Any changes or modifications to this unit not expressly approved by the party responsible for compliance could void the user's authority to operate the equipment.

### **IC WARNING**

This device contains licence-exempt transmitter(s) that comply with Innovation, Science and Economic Development Canada's licence-exempt RSS(s). Operation is subject to the following two conditions:

- (1) This device may not cause interference.
- (2) This device must accept any interference, including interference that may cause undesired operation of the device.

L'émetteur/récepteur exempt de licence contenu dans le présent appareil est conforme aux CNR d'Innovation, Sciences et Développement économique Canada applicables aux appareils radio exempts de licence. L'exploitation est autorisée aux deux conditions suivantes:

1. L'appareil ne doit pas produire de brouillage;
2. L'appareil doit accepter tout brouillage radioélectrique subi, même si le brouillage est susceptible d'en compromettre le fonctionnement.