

FRONT

All in one wireless charger station



Model No.:CP022
 Type C Input: 9V \Rightarrow 2A
 USB-1 Output: 5V \Rightarrow 0.5A
 USB-2 Output: 5V \Rightarrow 0.5A
 Wireless Output: 5W/7.5W/10W(Max)
 FCC ID: 2ATWU-CP022
 Made in China



FCC Warning

This device complies with part 15 of the FCC Rules. Operation is subject to the following two conditions: (1) This device may not cause harmful interference, and (2) this device must accept any interference received, including interference that may cause undesired operation. Any Changes or modifications not expressly approved by the party responsible for compliance could void the user's authority to operate the equipment. This equipment has been tested and found to comply with the limits for a Class B digital device, pursuant to part 15 of the FCC Rules. These limits are designed to provide reasonable protection against harmful interference in a residential installation. This equipment generates uses and can radiate radio frequency energy and, if not installed and used in accordance with the instructions, may cause harmful interference to radio communications. However, there is no guarantee that interference will not occur in a particular installation. If this equipment does cause harmful interference to radio or television reception, which can be determined by turning the equipment off and on, the user is encouraged to try to correct the interference by one or more of the following measures:

- Reorient or relocate the receiving antenna.
 - Increase the separation between the equipment and receiver.
 - Connect the equipment into an outlet on a circuit different from that to which the receiver is connected.
 - Consult the dealer or an experienced radio/TV technician for help.
- The device has been evaluated to meet general RF exposure requirement. The device can be used in portable exposure condition without restriction.

FCC RF exposure statement:

The equipment complies with FCC Radiation exposure limit set forth for uncontrolled environment. This equipment should be installed and operated with minimum distance 20cm between the radiator and your body.

Safety Warnings and Legal

- Do not disassemble
- Keep charger away from extreme heat or water
- Keep away from strong magnetic fields
- Use only proper power adapter (9V, 1.67A or above)
- If device becomes too hot, remove your phone and unplug device from power immediately. Device may shut off on its own if it becomes too hot. Wait until completely cooled to use again

This device complies with part 15 of the FCC Rules. Operation is subject to the following two conditions: (1) This device may not cause harmful interference, and (2) this device must accept any interference received, including interference that may cause undesired operation.

Caution: Changes or modifications not expressly approved by the party responsible for compliance could void the user's authority to operate this device.

NOTE: This equipment has been tested and found to comply with the limits for a Class B digital device, pursuant to part 15 of the FCC Rules. These limits are designed to provide reasonable protection against harmful interference in a residential installation. This equipment generates, uses, and can radiate radio frequency energy and, if not installed and used in accordance with the instructions, may cause harmful interference to radio communications. However, there is no guarantee that interference will not occur in a particular installation. If this equipment does cause harmful interference to radio or television reception, which can be determined by turning the equipment off and on, the user is encouraged to try to correct the interference by one or more of the following measures:

- Reorient or relocate the receiving antenna.
- Increase the separation between the equipment and receiver.
- Connect the equipment into an outlet on a circuit different from that to which the receiver is connected.
- Consult the dealer or an experienced radio/TV technician for help

BACK

Product Description



Product Description

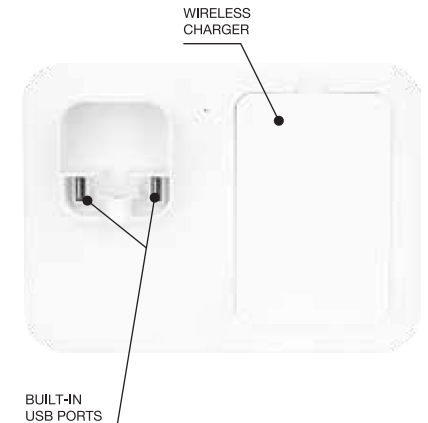

Operation

Installation Steps:

(Airpods & Apple watch chargers not included in package)

1. Use original Apple Watch® charger with a cable lengths of 1ft (0.3m), 3ft (1m), or 6.5ft (2m)
2. Remove tower to reveal built-in USB ports
3. Place the watch charger in the opening provided and plug into one of the USB ports
4. Plug standard apple lightning™ cable into other USB and use tower to hide away excess cable
5. Place head of lightning cable through provided cover
6. Plug hub in with provided USB-C cable

Wireless Charging

- Please make sure to use a wall adapter or USB port that is 1A for optimal charging speeds
- Recommended not to use any USB ports producing under 1A
- Use only USB-C cables to power device
- Computer USB ports are typically under 1A

Troubleshooting

- If you are experiencing issues with wireless charging make sure your phone is centered on the charger (see image below)
- If you are experiencing slow charging be sure to use a USB port or wall adapter that is rated for 1A
- Computer USB ports are typically under 1A



INCORRECT PLACEMENT



CORRECT PLACEMENT

Product Specs

Package contains: All in one wireless charger station
 USB-C to USB-A Cable (1), User Manual (1)

Wireless charger compatibility:

iPhone® X, iPhone® 8 Plus, iPhone® 8, Samsung Galaxy S8®, & Note 8 & Newer

Input: 9V 2A USB-C Port

Output: 5V/0.5A for USB 1, 5V/0.5A for USB2

Wireless Output: 5W/7.5W/10W

Product weight: 0.74lbs

Product dimensions: 8in x 6in x 4in

APPLE WATCH CABLE NOT INCLUDED
 WILL ONLY CHARGE THROUGH CASES
 5MM THICK OR LESS