

105 mm

140 mm

ELECTRONIC BABY AND MOTHER SCALE

Instruction Manual



Thank you very much to choose our digital baby scale. Please read the user's manual and warnings before using the device for the first time. Pay special attention to safety tips to avoid accidents and/or damage to the product when using it. Keep the user's manual for reference purposes.

封面

This electronic scale is a device for checking the user's weight household, it is appropriate for infants, toddler and adult, useful for a whole families. We used our best efforts to make sure the product is on top quality, comfortable and safe during weighing.

I. Device instruction

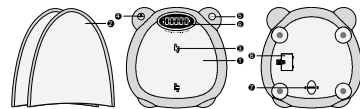

- Scale body
 - Weighing scale
- Detachable Trays
 - Assembly two pieces of detachable trays together to a full tray for baby weighing.
- Assembly groove
 - To put trays in.
- ON/OFF/Tare button
 - A. Press the button to switch on/off scale;
 - B. Press the button "Tare", if you put a towel on the scale before put baby on it, make display back to 0.00.
- Unit button
 - A. Press the button to switch unit: kg / lb / st.lb.
 - B. Long press (2~3 seconds) the button to change display direction.
- Display (LED)
 - Size: 90x26mm
- Safety buckle
 - To lock the trays.
- Battery Installation
 - Insert 3xAAA battery.

01

II. Product Specification

- 1) Size: 650x320x88mm
- 2) Material: Full ABS plastic.
- 3) Capacity: 20KG for baby weighing mode; Max. 20kg for adult mode.
- 4) Accuracy: D=5g (Weight in 50g~20kg), D=50g (weight in 20kg~120kg).
- 5) Unit: kg, lb, st.lb.
- 6) Touch ON/OFF.
- 7) 4 high precision strain gauge sensor.
- 8) Tare function.
- 9) Auto lock/hold function (easier weighing of moving babies-the result is automatically locked weight).
- 10) Low battery and over load indicate.
- 11) LED display size: 90x26mm.
- 12) Touch switch display direction.
- 13) Power: 3x1.5V AAA battery

III. Device Installation

1. Trays Installation for baby used
 - 1) Place the scale on hard & flat surface. Do not weight on carpet or any soft surface as it may affect accuracy.
 - 2) Put two pieces of split trays into each groove, make trays in a parallel line, be sure they are in the right place perfectly; then pull two trays in opposite direction.
 - 3) Press the safety buckle, to lock trays.
2. Trays Disassembling
 - 1) Pull the safety buckle.
 - 2) Pull two trays in opposite direction to split them.
 - 3) Pick up the trays, and stock them in dry and flat place.
3. Insert Battery
 - 1) Insert the batteries (3 x 1.5V AAA) into the battery compartment, then put on the battery cover. Make sure the positive and negative contacts are properly aligned. Remember to take off all batteries if no used scale in a long time, to protect scale.

02

IV. Device Operation

1. Weight in baby mode
 - 1) Please use the scale on the hard & flat surface. Do not weight on carpet or any soft surface as it may affect accuracy;
 - 2) Insert batteries, press "ON/OFF" button to turn on scale;
 - 3) Assembly trays perfectly, as above Part III-1 instruction;
 - 4) After display comes "0.00g", long press "UNIT" button to make the display direction as same as reader's side;
 - 5) Put baby on the trays safety to weighing;

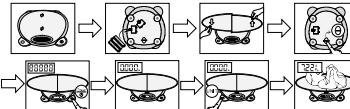

- Auto lock function

Do not move baby off from the tray when scale is working, the data will auto lock after 3 ticks.
- Reset and tare function

A. Press "TARE" if you need to put a towel/cloth on the tray before baby in, make display turns to "0.00".

B. Press "TARE", if data locked and keep the last one when you need to weight another baby, make display turns to "0.00", then put a new baby on it. (this function is repeatable)



03

- Unit conversion

Press "UNIT" button to convert "kg" "lb" and "st.lb".



- Overload Indication

If the weight is over loaded "max capacity", LED display shows "O-LD".
- Low Power Indication

When LCD display shows "LO", Please replace the new battery with correct polarity.
- Auto Off without any operation after 60 seconds.

2. Weight in Mother mode

- 1) Please use the scale on the hard & flat surface. Do not weight on carpet or any soft surface as it may affect accuracy;
- 2) Disassembling trays as above Part III-2 instruction;
- 3) Insert batteries, press "ON/OFF" button to turn on scale;
- 4) After display comes "0.00g", long press "UNIT" button to make the display direction as same as reader's side;
- 5) Stand on the scale surface to weighing.

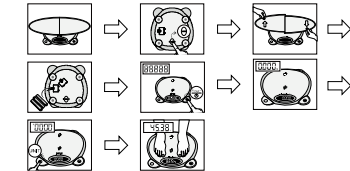

04

VI. Connect with AiLink APP

- 1) Open the APP and the Bluetooth of the phone. After entering the APP, click the "+" button in the right corner as shown in Figure 1.
- 2) The APP automatically scans nearby devices when entering the interface to add devices, as shown in Figure 2.

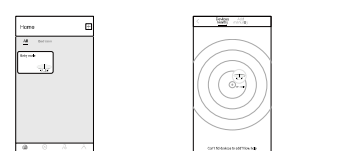

- 3) Click the scanned device to add automatically, and it will be displayed after successful addition as shown in Figure 3.
- 4) Select the weighing position on the APP and click "Start using".

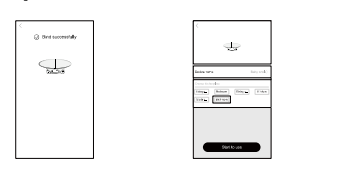

05

- 5) Set the units on the APP.
- 6) Select or add family members that need to be measured in the APP.

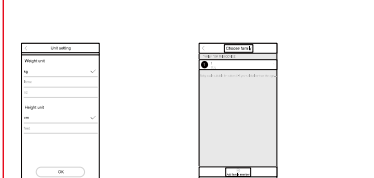

06

V. Safety precautions

- When in use, the scale should be placed on flat, dry and hard surface.
- Use to this device for its intended purpose at home.
- Do not overload the scale's capacity, the max is 120kg.
- Avoid shaking or hitting the scale.
- Do not submerge in water.
- When in storage, do not place anything on the scales.
- The optimal temperature for operating and storing the scales is 5°C ~ 40°C.

THIS DEVICE IS ONLY HOUSEHOLD USE.
NO MEDICAL OR COMMERCIAL USE.
THANKS!

封底

FCC Caution:

This device complies with part 15 of the FCC Rules. Operation is subject to the following two conditions: (1) This device may not cause harmful interference, and (2) this device must accept any interference received, including interference that may cause undesired operation.

Any Changes or modifications not expressly approved by the party responsible for compliance could void the user's authority to operate the equipment.

Note: This equipment has been tested and found to comply with the limits for a Class B digital device, pursuant to part 15 of the FCC Rules. These limits are designed to provide reasonable protection against harmful interference in a residential installation. This equipment generates uses and can radiate radio frequency energy and, if not installed and used in accordance with the instructions, may cause harmful interference to radio communications. However, there is no guarantee that interference will not occur in a particular installation. If this equipment does cause harmful interference to radio or television reception, which can be determined by turning the equipment off and on, the user is encouraged to try to correct the interference by one or more of the following measures:

- Reorient or relocate the receiving antenna.
- Increase the separation between the equipment and receiver.
- Connect the equipment into an outlet on a circuit different from that to which the receiver is connected.
- Consult the dealer or an experienced radio/TV technician for help.

The device has been evaluated to meet general RF exposure requirement. The device can be used in portable exposure condition without restriction.