

版本	修改日期	修改内容	签名
1.0	20230523	刁以文 AMOOWA M1S 说明书whale os-en 20230523_V1.0	

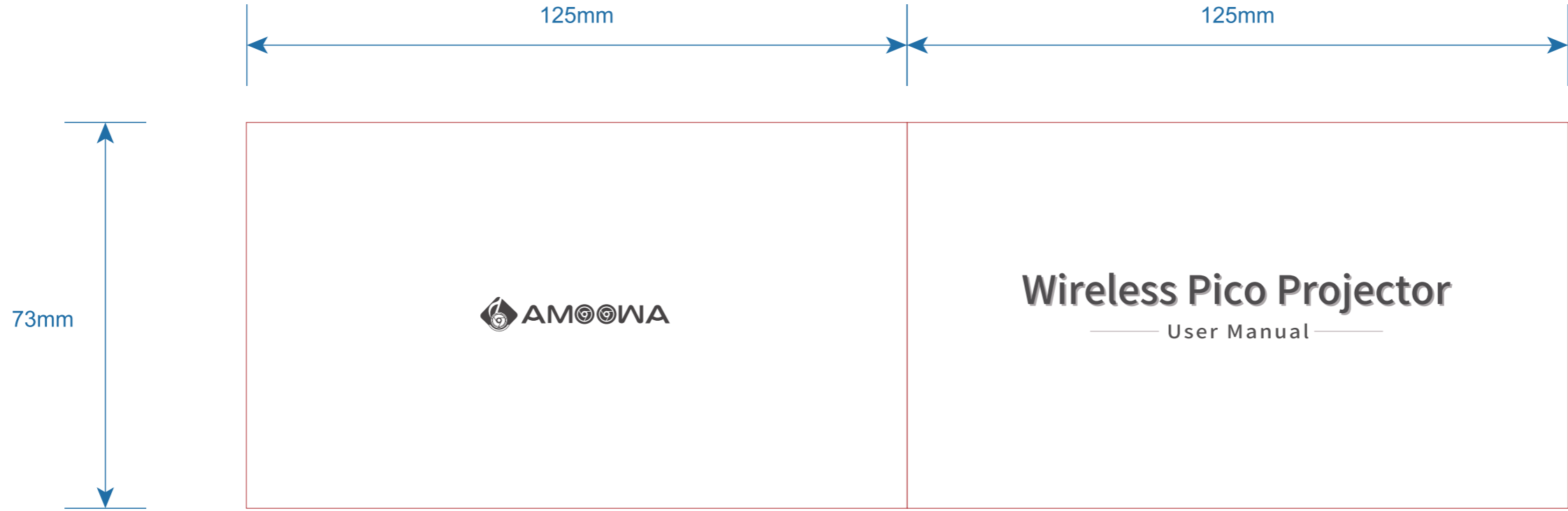

尺寸:125x73mm  
 材 质: 封页157g铜版纸覆哑膜  
           内页100g铜版纸  
 装订方式: 骑马订  
 印刷方式: 四色印刷

深圳市随晨科技有限公司				
项目名称	AMOOWA M1S说明书whale os-en 20230523_V1.0			
材质	157g双铜+100g双铜	尺寸	125x73mm	
公差	0			
设计	刁以文	审核		批准

## Contents

---

<b>Brief of Projector</b> .....	<b>3-5</b>
1.1 Packaging overview .....	3
1.2 Protocol Introduction .....	4
1.3 Instruction of Remote Control .....	5
<b>Use projector</b> .....	<b>6-17</b>
2.1 Turn on/off projector .....	6
2.2 Focus adjustment .....	6-7
2.3 Bluetooth controller pairing .....	8
2.4 Connect to the WIFI .....	9
2.5 Operation interface .....	10
2.6 Instruction of the top navigation bar .....	11
2.7 Mirror function .....	12-15
2.8-3.1 Other functions .....	16-20
<b>FCC Statement</b> .....	<b>22</b>
<b>Product Specifications</b> .....	<b>23</b>

# Projector Introduction



Projector

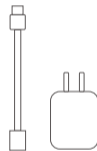

Adaptor



User manual



Remote Controller

# Projector Introduction

## 1.2 Introduction of the protocol

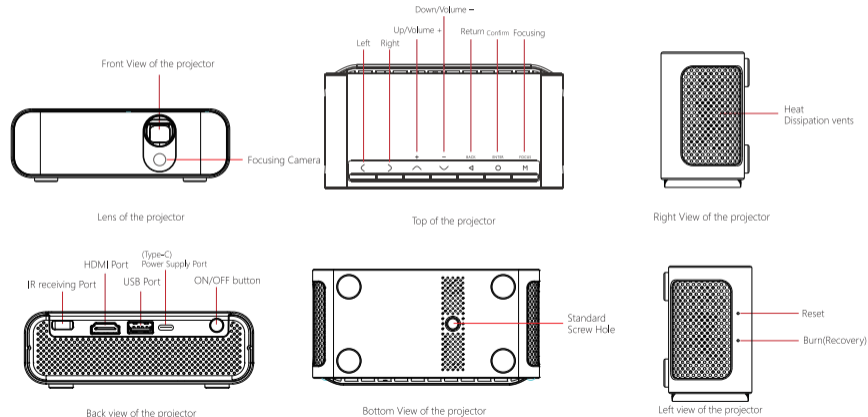

# Projector Introduction

## 1.3 Remote Control Description

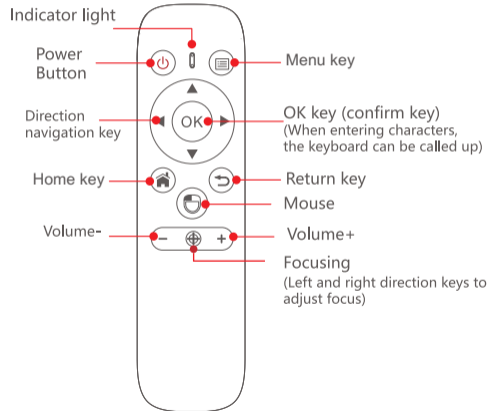

### Bluetooth pairing mode

Hold both "OK" and "Volume -" button five seconds to start remote control pairing mode

### Mouse mode

Start: click mouse button

Close: click navigation up-button

### Indicator light status

Slow flash: unpaired mode

# Use Projector

## 2.1 Turn on/off the projector

### 1. Turn on

Press and hold the right on/off button for 3 seconds to turn on the device.

### 2. Turn off

Press and hold the power button for 1 second to turn off the device, or press and hold the power button on the remote control to power off.

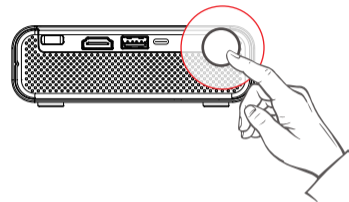

## 2.2 Focus adjustment

### 1. Manual focus

1.1 Press and hold the "M" button of the projector for about 1 second to bring up the focus circle, and then press and hold the projector's "left/right" direction arrow to focus manually;

1.2 Press and hold the "⊕" button of the remote control for 1 second. After the focusing circle appears, press and hold the "Left/Right" direction key of the remote control to focus manually.

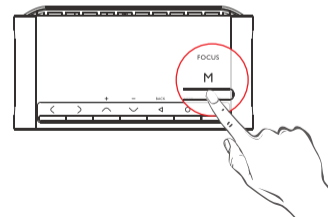

# Use Projector

## 2. Auto focus method

2.1. The distance between the projector and the wall is about 0.5-1.5M, short press the "M" button of the projector, the focus circle will pop up and auto focus will be performed, and the focus circle disappears after focusing;

2.2. Tilt the projector back and forth about 45 degrees, the focusing ring will pop up, and auto focus will be activated and complete itself;

2.3. Short press the "🌐" button of the remote control, the focus ring will pop up, and the auto focus will be activated and complete itself;

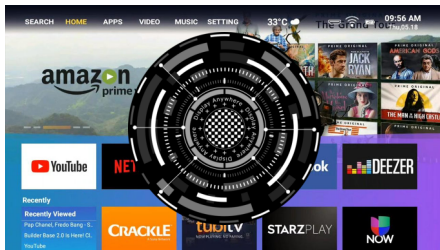

# Use Projector

## 2.3 Bluetooth remote control pairing

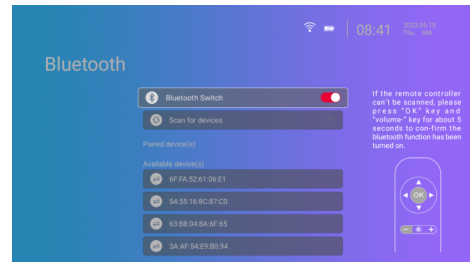

### Pairing method:

1. When the Bluetooth interface appears for the first time as the device is turned on, press the "OK + Volume -" button of the remote controller for about 5 seconds, the remote controller indicator flashes quickly, and the remote controller enters automatic pairing mode.
2. Enter the "Settings-Bluetooth" interface through the "Direction/Confirm" button on the body, press the "OK + Volume -" button of the remote controller for about 5 seconds, the remote control indicator flashes quickly, and then click "Scan to find Device", the remote controller enters automatic pairing mode.

# Use Projector

## 2.4 Connect to Wi-Fi network

1. Enter the system, Settings → WiFi → select network and enter the password;

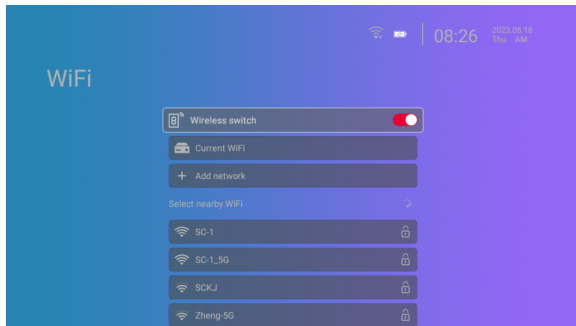

# Use Projector

## 2.5 Operation main interface

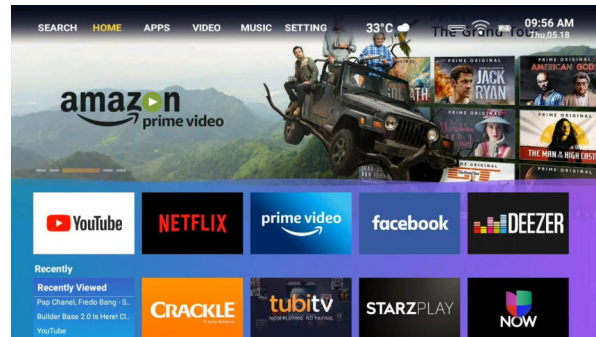

Scan this QR code to know more about Whale system.



## Use Projector

### 2.6 Instruction of the top navigation bar

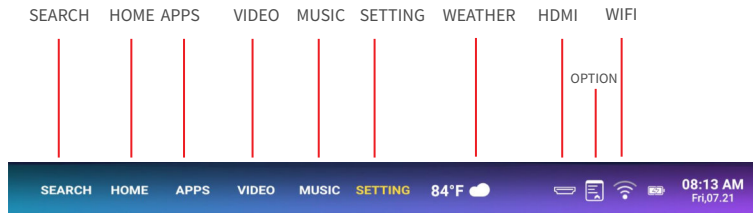

## Use Projector

### 2.7 How to use mirror function

According to the devices of the mirror function, open the corresponding applications (Apple Screen Mirror / Android Mirror/ Apple wired Mirror), or you can open the relevant applications in "Settings-Mirror" interface to start Screen Mirror function.

#### Apple Mirror function

##### 1. iPhone device connection

1) Connect the device to the network;

2) Enter iPhone connection operation, there are two methods for iPhone

① Under Wi-Fi environment: Open the "Settings" of the mobile phone --- "Wireless LAN",

Connect the mobile phone to the same network as the projector;

② Without Wi-Fi environment: Open the "Settings" of the mobile phone --- "Personal Hotspot",

Turn on the hot spot and connect the projector to the hot spot;

3) Go back to the main interface of the phone, slide up to open the control panel, and click Airplay;

4) Select "XXX-XXXXXX-XXX", open "Mirror", complete



## Use projector

### 2. Mac device connection



1. The projector is connected to the internet: Click "📶", select and connect to the same network as the projector;
2. Click "🖥️" and select "M1S-XXXXXX" to finish.

## Use Projector

### 3. Android screen mirror function

1. Open the "Android Projection Screen" application on the projector;
2. Connect the Android phone and the projector under the same WiFi;
3. In the mobile phone "Settings" → "WLAN" → "Wireless Screen projection", turn on the wireless projection function, and search for the device "M1S-XXXXXX" (random number), select connection;
4. Most Androids can be found in the "Shortcut Bar → Screen Sharing/Screen mirroring/projection screen/WLAN/wireless display/multi-screen interaction" Search the device under the menu and connect.

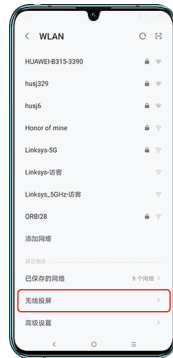



## Use Projector

### 4 Wired screen mirror function (IOS)

1. Please connect Iphone and projector as picture shows(Picture 3)

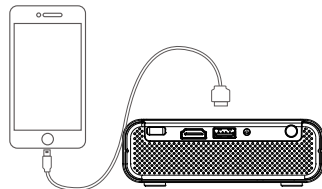

Cell phone Microcast

Picture 3

2. Please select "Trust" in the pop-up question of the phone (Picture 4).

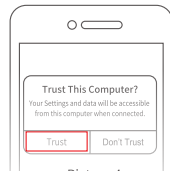

Picture 4

Tips: The first connection takes about 45 seconds, please be patient!

## Use Projector

### 2.8 Description of external equipment

How to connect a USB flash drive

1、 Insert the U disk into the USB port, open the "File Management" application, and the device can be identified.

2、 You can also go to “MY APPS --> File Manager” to check

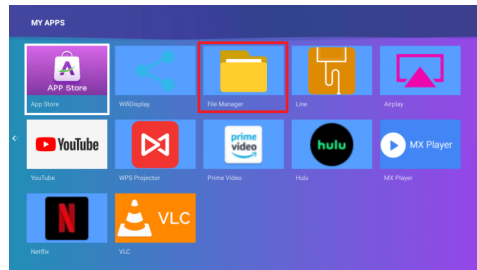

## Use projector

### 2.9 Software upgrade

#### Local upgrade:

Copy the downloaded firmware update.zip file to the root directory of the USB flash drive, and insert the USB flash drive (in FAT32 format); the system can automatically recognize the upgrade package and follow the prompts to upgrade (make sure the battery is sufficient when upgrading).



Update

#### Online upgrade:

In the "Settings-Software Update-System Update" interface, search for the new version upgrade.

### 3.0 Adjust Brightness

There are three brightness modes of "Energy Saving/Normal/Highlight" for selection under the interface of Settings-Image-Brightness Mode.

## Use projector

### 3.1 How to connect HDMI

After inserting the HDMI device into the HDMI interface, open the "HDMI switch" icon and click to confirm; or after connecting the HDMI device, enter the "Settings-Image-HDMI Connection" interface and confirm to open.

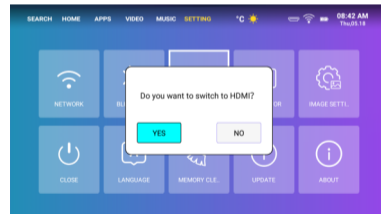
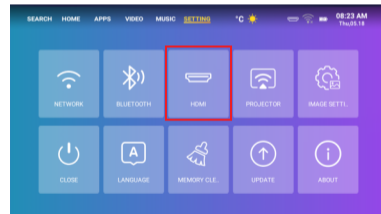

## Use projector

### 3.2 System Settings

Reset the system in "Settings-Software Update-Restore Factory Settings". System reset will clear the local data and local files in your device and restore it to the state when the device was shipped. Please use this function with caution

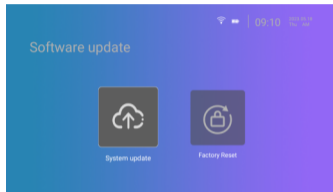

### 3.3 How to charge

Connect the power adapter to the Type-C charging port (Figure 7). The power indicator light is steady red, which means it is charging. The blue power indicator light is on, indicating that the charging is complete.

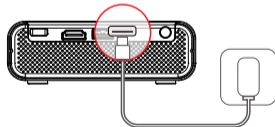

Figure 7

## Use projector

### 3.4 Introduction of other functions

#### 1. Screen display abnormal situation handling method

- 1.1. When the screen shows the trapezoid, you can perform horizontal calibration under the "Settings-Image-Keystone Correction" interface; or turn off the "Automatic Keystone Correction" to perform custom corrections, which can solve the problem of image errors.
- 1.2. When the auto focus of the screen is not clear, place the machine horizontally about 1-2 meters away from the wall, and in the "Settings-Image-Auto Focus" interface, select "AI Mode" for "AI Auto Focus Machine Learning", It can solve the problem of unclear auto focus of the machine.

#### 2. How to connect Bluetooth speakers

1. Enter settings---Bluetooth.
2. Turn on the Bluetooth speaker and enable the Bluetooth pairing mode (for pairing mode, please check the Bluetooth speaker manual).
3. Click "Scan for device" on the interface of the micro projector.
4. Then the available Bluetooth speaker name will be displayed in the available devices.
5. Click Connect to display the Bluetooth speaker shows "Connected" on the projector to complete.

## FCC Statement

---

This equipment has been tested and found to comply with the limits for a Class B digital device, pursuant to part 15 of the FCC rules. These limits are designed to provide reasonable protection against harmful interference in a residential installation. This equipment generates, uses and can radiate radio frequency energy and, if not installed and used in accordance with the instructions, may cause harmful interference to radio communications.

However, there is no guarantee that interference will not occur in a particular installation. If this equipment does cause harmful interference to radio or television reception, which can be determined by turning the equipment off and on, the user is encouraged to try to correct the interference by one or more of the following measures:

- Reorient or relocate the receiving antenna.
- Increase the separation between the equipment and receiver.
- Connect the equipment into an outlet on a circuit different from that to which the receiver is connected.
- Consult the dealer or an experienced radio/TV technician for help.

To assure continued compliance, any changes or modifications not expressly approved by the party.

Responsible for compliance could void the user's authority to operate this equipment. (Example- use only shielded interface cables when connecting to computer or peripheral devices).

## FCC Statement

---

This equipment complies with Part 15 of the FCC Rules. Operation is subject to the following two conditions:

- (1) This device may not cause harmful interference, and
- (2) This device must accept any interference received, including interference that may cause undesired operation.

FCC Radiation Exposure Statement:

The equipment complies with FCC Radiation exposure limits set forth for uncontrolled environment. This equipment should be installed and operated with minimum distance 20cm between the radiator and your body.

## Product specifications

---

Wireless module	IEEE 802.11 a/b/g/n/ac, 2.4G/5G Dual band WiFi
Bluetooth	4.0
Battery Capacity	Polymer battery 3420mAh 25.99Wh
Battery Duration	Up to 100 minutes (Max Volume)
Power input	12V/3A (Type - C, PD agreement)
Power Consumption (Whole machine)	34W
Android System	Android 7.1
Wireless protocol	Airplay / Miracast / DLNA
Product weight	360g / 0.79LB
Physical size	132(L)x64(W)x43(H)mm/5.2(L)x2.5(W)x1.7(H) inch
Working temperature	0°C~35°C/ 32°F~95°F

Note: This manual is for reference only, and the information in the manual is subject to change without notice. The manufacturer does not assume any direct or indirect responsibility resulting from changes to the manual.