

DynamicBar Instructions



1. Brief:

Thank you for choosing our DynamicBar ambient lighting lamp. DynamicBar supports Dynamic Lighting effects on Windows without the need for third-party software. It can be directly controlled with in the Windows 11 OS and also supports control via the BanlanX App, offering a rich variety of lighting effects. In addition to the colorful ambient lighting effects, DynamicBar also supports pure white light illumination, making it a highly functional and versatile lighting product.



Supports Windows 11 / BanlanX App

2. Features:

- Supports Windows Dynamic Lighting, the native RGB lighting management tool in Windows 11, requiring no installation of third-party App lications, plug and play.
- Supports control via the BanlanX App, featuring a beautiful and refined UI interface, providing a richer variety of dynamic effects and music effects.
- Provides practical standalone white light illumination with high-frequency PWM dimming.
- Timed Switching and OTA Firmware Upgrades: Offers scheduling features and firmware updates to enhance functionality and maintain up-to-date operations.

3. Windows Dynamic Lighting:

• Connecting devices:

Connect the DynamicBar's USB cable to the USB port of a Windows 11 computer.

Note: The ambient lamp will automatically detect that the connected device is a Windows 11 computer and switch to Windows Dynamic Lighting mode.

• Enter the Dynamic Lighting effect control interface:

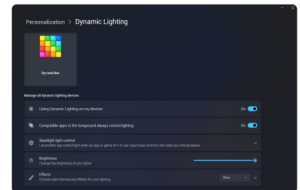
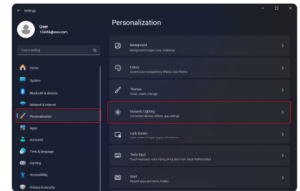

4. BanlanX App :



- DynamicBar supports App control for iOS and Android devices.
- Apple devices require iOS 10.0 or higher, and Android devices require Android 4.4 or higher.
- You can search "BanlanX" in App Store or Google Play to find the App, or scan the QR code to download and install.

On the App's Home Page, click the "Add Device" button in the center of the page, or click the "+" symbol in the upper right corner and select "Add Device" to enter the device search page. To ensure successful addition, please keep your phone as close to DynamicBar as possible. Find and select the device you wish to add from the search results list to complete the addition process.

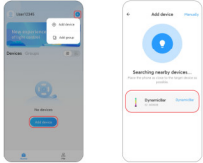

- One-click switch between Windows Dynamic Lighting effect mode and App control mode.

In Windows Dynamic Lighting Mode, click "Switch to App Control Mode" to switch to App Control Mode. In App control mode, click the Dynamic Lighting effect icon " " to cut back to Windows Dynamic Lighting effect mode.

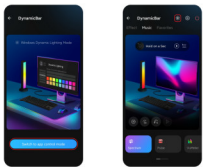

• Natural white illumination:



Click on the "Illumination" icon to illuminate the DynamicBar with white light, and click on the Brightness Settings icon to adjust the brightness of the light.



• Dynamic effect:



Slide the icon at the bottom of the interface to select other dynamic effects. You can adjust the brightness, speed, direction, effect color, and color combination of the effect using the Setting icons.



• Music effect:



Slide the effect icons at the bottom of the interface to select different musical effects. Detailed settings can be made using the Setting icons.



• Favorites:

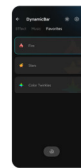

At the top right of any effect screen, click the "+" icon to add the current effect to your favorites list. Click the " " icon to cycle through all your favorite effects, click the " " icon to adjust the cycle time of a single effect, and long press on an effect in the list to manage your favorite effects.



• Settings:

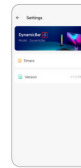

In the settings interface, you can modify the device naming, set the timer to turn On/Off automatically, and perform OTA upgrade of the firmware.



5. What is the box?

DynamicBar	1PC	USB port:	1PC
Base	1PC	Screen cushion:	1PC
Screen adhesive	1PC	Instructions:	1PC

6. Technical Parameters:

Input Voltage	5V	Maximum current	500mA
LED Type	ARGB LED + Cool White (5000-6500K)	Drive Type	DP+ PWM
Connection Method	USB, Bluetooth	Compatible System	Windows 11, iOS, Android
Size	88mm x 256mm	USB cable length	200 CM
Connection method	Connects to computer USB port / Adapter for 5V USB port		

FCC Caution:

This device complies with part 15 of the FCC Rules. Operation is subject to the following two conditions: (1) this device may not cause harmful interference, and (2) this device must accept any interference received, including interference that may cause undesired operation.

Any changes or modifications not expressly approved by the party responsible for compliance could void the user's authority to operate the equipment.

NOTE: This equipment has been tested and found to comply with the limits for a Class B digital device, pursuant to Part 15 of the FCC Rules. These limits are designed to provide reasonable protection against harmful interference in a residential installation. This equipment generates, uses and can radiate radio frequency energy and, if not installed and used in accordance with the instructions, may cause harmful interference to radio communications. However, there is no guarantee that interference will not occur in a particular installation.

If this equipment does cause harmful interference to radio or television reception, which can be determined by turning the equipment off and on, the user is encouraged to try to correct the interference by one or more of the following measures:

- Reorient or relocate the receiving antenna.
- Increase the separation between the equipment and receiver.
- Connect the equipment into an outlet on a circuit different from that to which the receiver is connected.
- Consult the dealer or an experienced radio/TV technician for help.

To maintain compliance with FCC's RF Exposure guidelines, This equipment should be installed and operated with minimum distance between 20cm the radiator your body: Use only the supplied antenna.