



Turntable with Stereo Speakers

User's Guide for Model ITTB751DW

For the most up-to-date version of this User's Guide, go to www.iliveelectronics.com

Safety Instructions & Warnings



WARNING: To reduce the risk of electric shock, do not remove cover (or back). No user-serviceable parts inside. Refer servicing to qualified service personnel.



The exclamation point within an equilateral triangle is intended to alert the user to the presence of important operating and maintenance (servicing) instructions in the literature accompanying the appliance.



The lightning flash with arrowhead symbol, within an equilateral triangle, is intended to alert the user to the presence of "dangerous voltage" within the product's enclosure that may be of sufficient magnitude to constitute a risk of electric shock to persons.



This symbol indicates that this product incorporates double insulation between hazardous mains voltage and user accessible parts.



This product utilizes a Class 1 laser to read Compact Discs. This laser Compact Disc Player is equipped with safety switches to avoid exposure when the CD door is open and the safety interlocks are defeated. Invisible laser radiation is present when the CD Player's lid is open and the system's interlock has failed or been defeated. It is very important that you avoid direct exposure to the laser beam at all times. Please do not attempt to defeat or bypass the safety switches.



WARNING : This product can expose you to chemicals including lead, which is known to the State of California to cause cancer and birth defects or other reproductive harm. For more information go to www.P65Warnings.ca.gov. **This product meets and complies with required Federal product guidelines**

Important Safety Instructions

- Read these Instructions.
- Keep these Instructions.
- Heed all Warnings.
- Follow all instructions.
- Do not use this apparatus near water.
- Clean only with a dry cloth.
- Do not block any ventilation openings. Install in accordance with the manufacturer's instructions.
- Do not install near any heat sources such as radiators, heat registers, stoves, or other apparatus (including amplifiers) that produce heat.
- Do not defeat the safety purpose of the polarized or grounding - type plug. A polarized plug has two blades with one wider than the other. A grounding type plug has two blades and a third grounding prong. The wide blade or the third prong are provided for your safety. When the provided plug does not fit into your outlet, consult an electrician for replacement of the obsolete outlet.
- Protect the power cord from being walked on or pinched particularly at plugs, convenience receptacles, and the point where they exit from the apparatus.
- Only use attachments/accessories specified by the manufacturer.
- Unplug this apparatus during lightning storms or when unused for long periods of time.
- Refer all servicing to qualified service personnel. Servicing is required when the apparatus has been damaged in any way, such as power-supply cord or plug is damaged, liquid has been spilled or objects have fallen into the apparatus, the apparatus has been exposed to rain or moisture, does not operate normally, or has been dropped.
- Use only with a cart, stand, tripod, bracket, or table specified by the manufacturer, or sold with the apparatus. When a cart is used, use caution when moving the cart/apparatus combination to avoid injury from tip-over.



FCC Warnings

Warning: Changes or modifications to this unit not expressly approved by the party responsible for compliance could void the user's authority to operate the equipment.

NOTE: This equipment has been tested and found to comply with the limits for a Class B digital device, pursuant to Part 15 of the FCC Rules. These limits are designed to provide reasonable protection against harmful interference in a residential installation. This equipment generates, uses, and can radiate radio frequency energy and, if not installed and used in accordance with the instructions, may cause harmful interference to radio communications. However, there is no guarantee that interference will not occur in a particular installation. If this equipment does cause harmful interference to radio or television reception, which can be determined by turning the equipment off and on, the user is encouraged to try to correct the interference by one or more of the following measures:

- Reorient or relocate the receiving antenna.
- Increase the separation between the equipment and receiver.
- Connect the equipment into an outlet on a circuit different from that to which the receiver is connected.
- Consult the dealer or an experienced radio/TV technician for help.

To comply with FCC RF exposure compliance requirements, this grant is applicable to only mobile configurations. The antennas used for this transmitter must be installed to provide a separation distance of at least 20cm from all persons and must not be co-located or operating in conjunction with any other antenna or transmitter.

Additional Warnings and Precautions

- **CAUTION: TO PREVENT ELECTRIC SHOCK, MATCH WIDE BLADE OF PLUG TO WIDE SLOT, FULLY INSERT.**
- Mains plug is used as disconnect device and it should remain readily operable during intended use. In order to disconnect the apparatus from the mains completely, the mains plug should be disconnected from the mains socket outlet completely.
- **CAUTION:** Use of controls or adjustments or performance of procedures other than those specified may result in hazardous radiation exposure.
- **WARNING:** Changes or modifications to this unit not expressly approved by the party responsible for compliance could void the user's authority to operate the equipment.
- **WARNING:** Use of this unit near fluorescent lighting may cause interference regarding use of the remote. If the unit is displaying erratic behavior move away from any fluorescent lighting, as it may be the cause.
- **WARNING:** Shock hazard - Do Not Open.
- Caution and marking information is located at the rear or bottom of the apparatus.
- **WARNING:** To reduce the risk of fire or electric shock, do not expose this apparatus to rain, moisture, dripping, or splashing.
- Objects filled with liquids, such as vases, shall not be placed on the apparatus.

Table of Contents

Setup	5
Includes	
Power	
Orientation	6
Features & Controls	
Assembly	8
Connecting to Devices	9
Pairing Bluetooth and Playing Audio Wirelessly	
Connecting the Speakers	
Using the Aux Out	
Operation	10
Playing a Record	
Recording (USB)	
Customer Support	12
Contact Information	
Warranty	
International Support	

Setup

Includes

- RCA stereo audio cable
- User's Guide
- 45 rpm adapter

Power

Plug the built in AC power cord into a standard wall outlet.

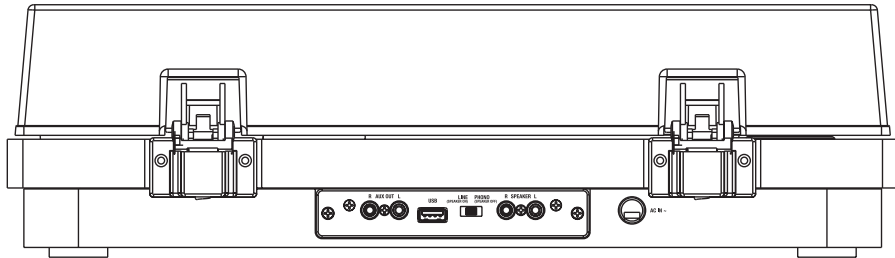

Orientation

Features & Controls

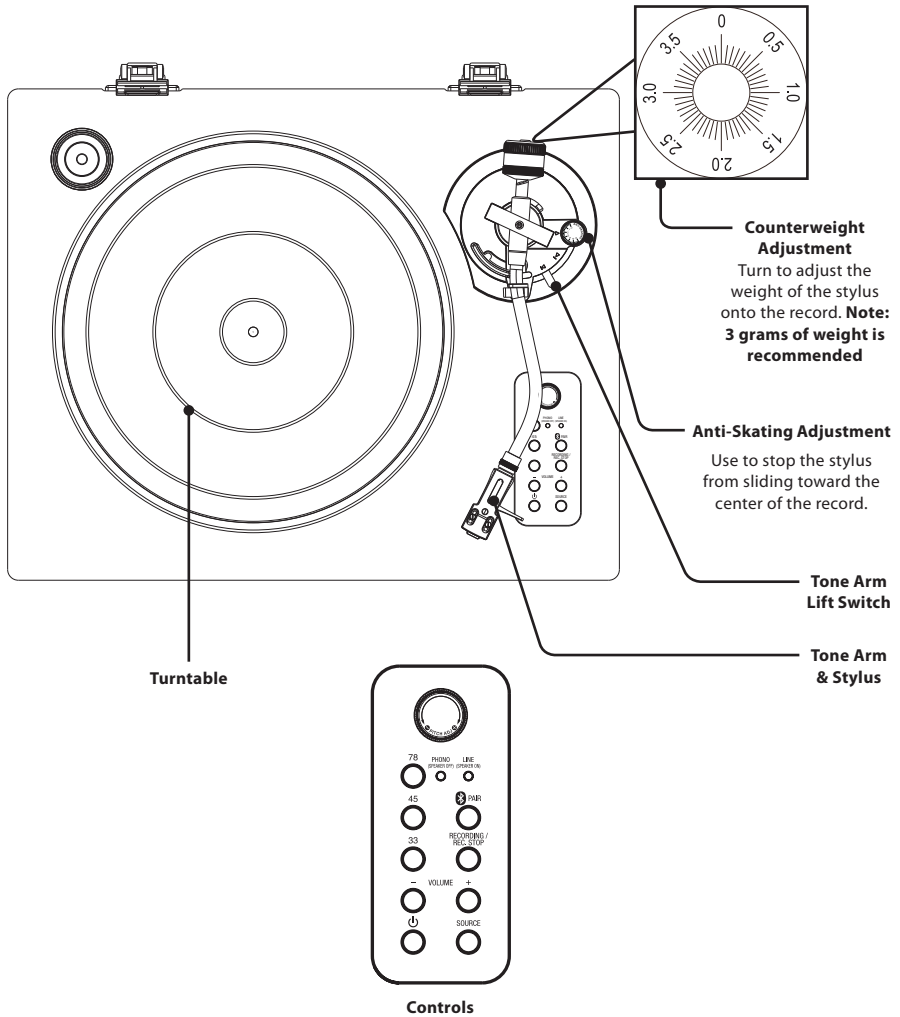

Pitch Adj.
Use to fine tune the speed of the turntable.

78/45/30
Press to select playback speed of a record.

Volume

Power
Press to power ON/OFF.

Rec. Stop
Press to stop recording music to a USB.

Recording
Press to start recording music to a USB drive.

Pair
Press and hold to begin pairing to a Bluetooth device.

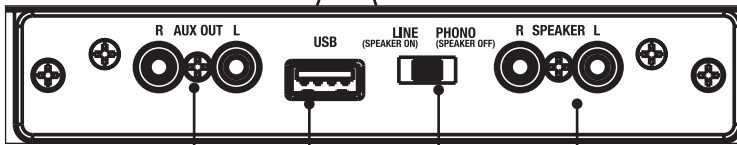
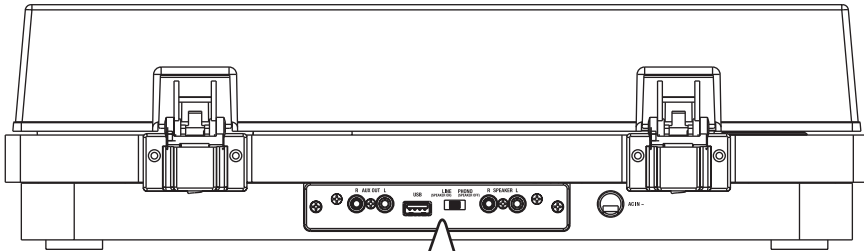

Aux Out

USB
Insert USB drive
to record audio
from turntable.

Playback Switch

Select **Line** If your
speaker system
(amplifier) does not have
phono inputs.

Select **Phono** if your
stereo system (amplifier)
has Phono inputs
connect your turntable
to the phono inputs on
your stereo system to
play music out loud.

Speaker Inputs

Assembly

Step 1

Place the Belt plate onto the main unit as seen below.

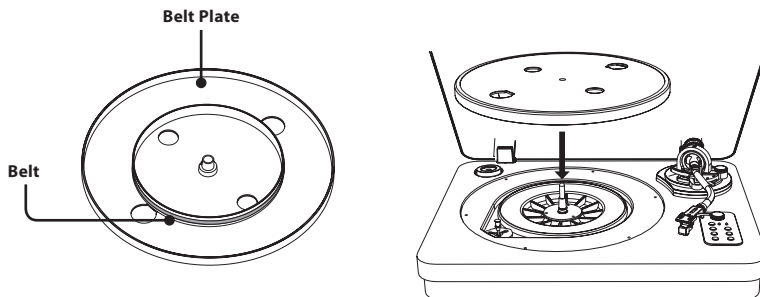

Step 2

Pull the **Belt** of the **Belt Plate** around the **Roller** as shown below.

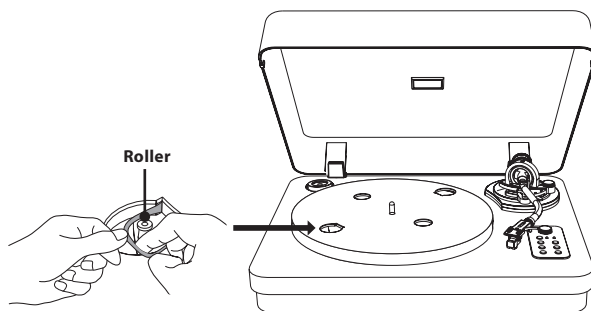

Step 3

Place the **Plate Cover** over the **Belt Plate** as shown below. You may now load a record onto the turntable.

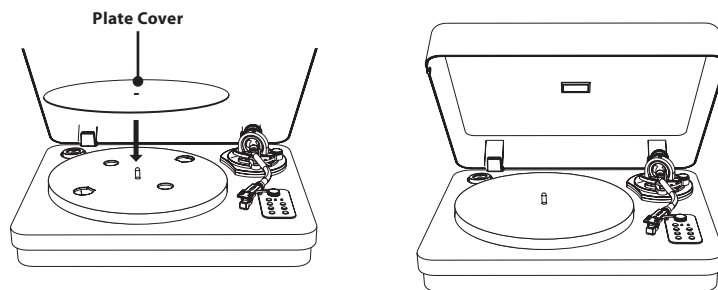

Connecting to Devices

Pairing Bluetooth and Playing Audio Wirelessly

1. Power on the unit. Enter into Bluetooth mode by pressing the **Source** button, the pair button will begin quickly flashing blue. *When pairing, remain within 3 feet of the unit.*
2. Using the controls on your Bluetooth device, search for and select **ITTB751** in your Bluetooth settings to pair. *If need be, refer to the user's manual for your specific device for instructions on pairing and connecting Bluetooth devices.*
3. When successfully paired and connected, a voice prompt will sound and the **Pair** button will turn solid. After initial pairing, the unit will stay paired unless unpaired manually by the user or erased due to a reset of the device. If your device should become unpaired or you find it is unable to connect, repeat these steps.
4. Use the controls on your connected Bluetooth Device to select and begin playing audio. Play, pause or skip a selected track using the controls on the connected Bluetooth Device. Change volume level using both connected device and turntable.

After initial pairing, the unit will automatically connect to the last Bluetooth device used whenever it is powered on. If you would like to connect to a different device, turn off Bluetooth on the unwanted device and use the above steps to connect to a different device.

Connecting the Speakers

1. Connect each speaker to the speaker inputs on the back of the unit.
2. Set the **Playback Switch** to **Line mode**. The **Line** button will turn white.
3. Audio played through the turntable should now be heard through the connected speakers.

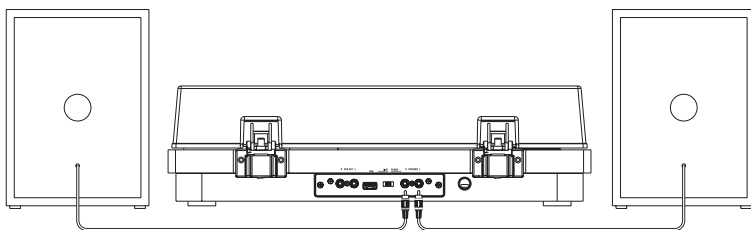

Using the Aux Out

Requires RCA audio cable (included).

1. Plug the included RCA audio cable into the **Aux Out** on the turntable and your amplifier.
2. Set the **Playback Switch** to **Phono** mode, the backlighting will turn white.
3. Audio from the record will now be heard through the connected amplifier/speakers.

Note: Select Phono on the Playback Switch if your stereo system (amplifier) has Phono inputs connect your turntable to the phono inputs on your stereo system to play music out loud.

If your stereo system (amplifier) does not have Phono inputs set the Playback Switch to Line.

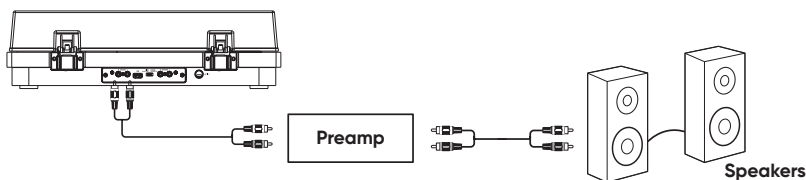

Operation

Playing a Record

It is recommended that you use extreme care when manipulating the tone arm, stylus, and other components of this turntable. These parts are very sensitive and can easily break or become damaged if they are carelessly handled.

1. Enter into **Turntable** mode by pressing the **Source** button.
2. Remove the shroud that protects the stylus and release the lock that holds the Tone Arm in place.
3. Use the **Tone Arm Lift Switch** to raise the **Tone Arm** from its catch.
4. Using your hand, *gently* swing the **Tone Arm** into the desired location over the record. The turntable will start spinning as the **Tone Arm** is moved into position.

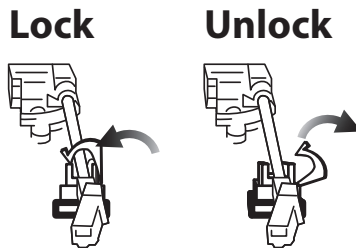

5. Use the **Tone Arm Lift Switch** to safely lower the stylus onto the record.
Using the Lift Switch instead of your hand will reduce the chance of accidentally damaging the record or the stylus.
6. When not in use, secure and lock the Tone Arm in its resting position and replace the protective shroud over the stylus. This will minimize the risk of accidental damage to these sensitive parts.

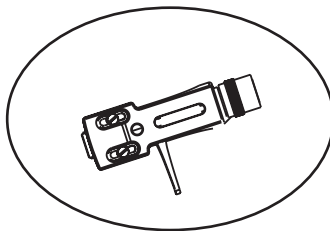

Stylus

Recording (USB)

Note: This unit can record playback from a record onto a USB drive to be saved via MP3 format.

Please Check to make sure Bluetooth is OFF.

1. Insert a USB drive into the rear of the unit.
2. Press the **Recording** button to begin recording the audio of the record being played. When recording the backlighting will turn red.
3. To pause recording, press the **Rec. Stop** button. The red backlighting will begin flashing slowly.
4. When the recording is finished or you want to stop it, press and hold the **Recording** button for 5 seconds, the red backlighting will turn off and the unit will exit recording mode.

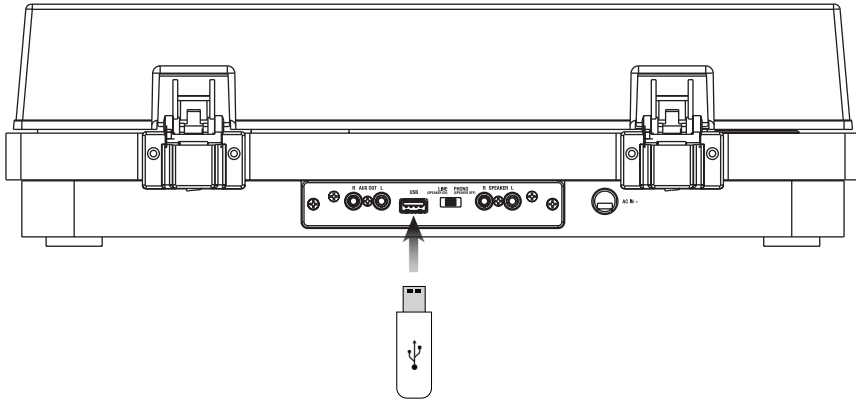

Customer Support

Contact Information

Website: www.iliveelectronics.com

Email Support: prodinfo@dpiinc.com

Email Parts: partsinfo@dpiinc.com

Phone Support: 1-888-999-4215

Warranty

For Warranty Information and the most up-to-date version of this User's Guide, go to:
www.iliveelectronics.com

International Support

To download this User's Guide in English, Spanish, and French, or to get answers to frequently asked questions, visit the support section at: www.iliveelectronics.com

Para descargar este Manual del Usuario en inglés, español y francés, o para obtener respuestas a preguntas frecuentes, visite la sección de apoyo en: www.iliveelectronics.com

Pour télécharger ce guide de l'utilisateur en anglais, espagnol ou français, ou pour obtenir des réponses à des questions fréquemment posées, consultez la rubrique d'assistance sur: www.iliveelectronics.com



***Protect for Today
Sustain for Tomorrow***

Copyright © 2021 Digital Products International (DPI, Inc.). All other trademarks appearing herein are the property of their respective owners. Specifications are subject to change without notice.
