

# Fan Heater

INSTRUCTION MANUAL

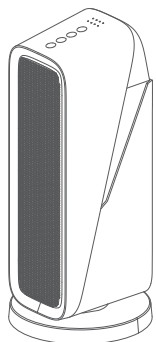

Model: H3

## 01/POINTS FOR ATTENTION

This appliance is not intended for use by persons (including children) with reduced physical, sensory or mental capabilities, or lack of experience and knowledge, unless they have been given supervision or instruction concerning use of the appliance by a person responsible for their safety. Children should be supervised to ensure that they do not play with the appliance. If the supply cord is damaged, it must be replaced by the manufacturer, its service agent or similarly qualified persons in order to avoid a hazard. When the appliance is not in use and before cleaning, unplug the appliance from the outlet firstly. **WARNING:** In order to avoid overheating, do not cover the heater. The heater must not be located immediately below a socket outlet.



Do not cover - do not use this heater in the immediate surroundings of a bath, a shower or a swimming pool. do not use this heater if it has been dropped;- do not use if there are visible signs of damage to the heater;- use this heater on a horizontal and stable surface, or fix it to the wall. **WARNING:** Do not use this heater in small rooms when they are occupied by persons not capable of leaving the room on their own, unless constant supervision is provided. **WARNING:** To reduce the risk of fire, keep textiles, curtains, or any other flammable material a minimum distance of 1 m from the air outlet.

Before using, please read this user manual carefully and keep it for future reference.

### Warning

1. To avoid electric shock and fire, do not allow water, liquid or any flammable detergent to get into or to clean the product.
2. Do not spray insecticide, perfume or other flammable spray around the products.

01

### Warning

Any Changes or modifications not expressly approved by the party responsible for compliance could void the user's authority to operate the equipment.

This device complies with Part 15 of the FCC Rules. Operation is subject to the following two conditions:

- (1) this device may not cause harmful interference, and
- (2) this device must accept any interference received, including interference that may cause undesired operation.

Note: This equipment has been tested and found to comply with the limits for a Class B digital device, pursuant to part 15 of the FCC Rules. These limits are designed to provide reasonable protection against harmful interference in a residential installation. This equipment generates uses and can radiate radio frequency energy and, if not installed and used in accordance with the instructions, may cause harmful interference to radio communications. However, there is no guarantee that interference will not occur in a particular installation. If this equipment does cause harmful interference to radio or television reception, which can be determined by turning the equipment off and on, the user is encouraged to try to correct the interference by one or more of the following measures:

- Reorient or relocate the receiving antenna.
- Increase the separation between the equipment and receiver.
- Connect the equipment into an outlet on a circuit different from that to which the receiver is connected.
- Consult the dealer or an experienced radio/TV technician for help.

To maintain compliance with FCC's RF exposure guidelines, the distance must be at least 20cm between the radiator and your body, and fully supported by the operating and installation configurations of the transmitter and its antenna(s).

02

### Notice

1. Before connecting the power supply, please check whether the voltage of the product is consistent with the local power supply voltage.
2. Please check the power cord before using, if damaged, it must be replaced by professional staffs to avoid danger.
3. Ensure the unit is used in a stable and horizontal level to avoid injury or fire caused by product dumping.
4. Do not spray the product with water to avoid dangers such as short circuit and electric shock.
5. Do not use the unit in high temperature, damp or other volatile place like acid, alkali or oil.
6. Do not use the unit around the bathtub, sprinkler or swimming pool.
7. Do not place the unit near the inflammable and explosive materials and use it in places with severe dust to avoid accident.
8. Do not put the unit under the air conditioner to prevent condensed water dripping into it.
9. Do not insert finger or other things into the air outlet/inlet when the unit is working to prevent physical damage or trouble.
10. Do not use the unit near the inflammable items and the suitable temperature should be below 30 degrees. Leaving at least 1 meter of space on the back and side of the unit to prevent fire.
11. Do not touch the vent grill and be sure it is installed in place before using the unit. The vent grill is used to prevent touching the heating element directly.
12. Do not touch the vent grill or cover the air outlet when using to avoid burning.
13. Ensure the unit is unplugged before cleaning or maintaining.
14. Do not pull the power cord to move the unit. Ensure the unit is unplugged if you need to move it.
15. People with physical or mental disability or without relevant experiences and skills (including children) should use it under guiding and instructing.
16. Children should be supervised to ensure they do not play with the unit.

03

## 02/ Product overview

The unit is designed with back power button and on/off button in the front, which is easy to operate and suitable in small area, like house, office and so on. Also the unit has anti-tilt function with wide-angle heating function and the body could be adjustable from 0 to 80 degrees.

### Components

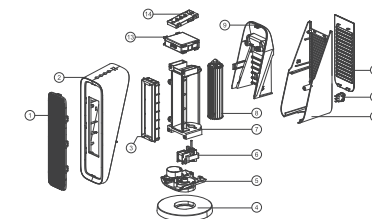

1. Iron net
2. Front shell
3. Heating module
4. Base module
5. Rotating module
6. Motor
7. Air duct
8. Wind wheel
9. Handle cover
10. Top cover
11. Rocker switch
12. Filter
13. Power module
14. Control panel module

### Control panel

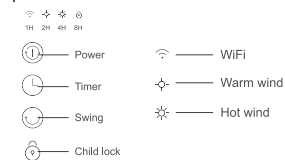

04

## 03/ Specifications

Model	H3
Dimensions	180x180x400mm
Weight	2.5kg
Rated voltage	120V ~ 60Hz
Power	1500W

## 04/ Function

### Power on:

After the unit is powered on and press Rocker Switch on the back, all the LEDs will be on for about 1s, then enter the standby state.

### Power Button

When the unit is turned on for the first time, all LED lights will be on for about 1s then enter the standby state.

### Switch/Mode Button

1. In the standby state, press the Switch/Mode button once, the unit will be turned on and enter the natural wind working mode (without indicator). Press this button again, the unit will switch to warm wind mode (with warm wind indicator lights on). Press this button thirdly, the unit will switch to hot wind mode (with hot wind indicator lights on). After the fourth press, the unit will back to natural wind mode (circulation). The buzzer will ring once when press the button.

2. In the power-on state, long press this button 3s, the unit will be standby state.

### Timer Button

When turned on, press the timer button once for timing 1H, then 2H, then 4H, then 8H (with the corresponding indicator lights on), and then cancel timer(with no indicator).

Long press the timer button for 5s to open the WiFi function. When the wifi indicator flashes 2 times per second (fast), it is in WiFi fast connection mode, and when the WiFi indicator flashes once per second (slow), it is in compatibility mode.

### Wide Angle Warming

This product could provide warm air from side to side in a wide-angle, as follows:

### Swing Button

When turned on, press the button to make the the device auto swing left and right. Press again to stop swinging. The buzzer will ring once when press the swing button.

### Child Lock Button

When turned on, long press the child lock button 3s to enter to the child lock state with the buzzer ring once (the other button can't work). Long press the button for 3s to cancel the child lock with the buzzer ring once.

Notice: The child lock will be cancel automatically when unplugged.

### Anti-pitch Protection

When the unit is overturned, the power will be cut off and the heating components, fans and head shaking will be turned off. The unit will beep for 1 minute and then enter the standby state.

### Overheat Protection

After turning on the warm wind or hot wind mode, long press the power button to shut down, the heating component will be shut down first. The fan will be turned off after one minute. All the light in the panel will blink for one minute and enter the standby state.

### Auto-shut off

When the unit runs continuously for 24 hours, it will shuts down automatically and enter to the standby state.

## 05/ Using Instruction

### Warning

- Do not cover the vent grill with anything to avoid fire.
- Do not block the air inlet and air outlet, keep a distance of at least 30cm on the back and side of the unit.
- Do not close to the air outlet for a long time to avoid scalding when the unit is working.
- Clean the filter regularly to ensure enough air volume and avoid overheating protection.
- Ensure the power cord is in good condition;
- Ensure the back power button is turned off.
- Before connecting the power supply, please check whether the voltage of the product is consistent with the local power supply voltage.

## 06/Wifi operation

1. Use your mobile phone to scan the QR code below to download the "Smart Life" APP. You can also search for "smart life" in the APP store or Google Play to install the APP.



2. Open the "Smart Life" APP and use your phone number or e-mail to register your "Smart Life" account, then login.

### Add appliance:

Connect your phone to your home WiFi and turn on bluetooth (please select 2.4ghz WiFi network) Open the "Smart Life" APP. Enter the homepage of the "Smart Life" APP. Click "+" to select to add a device, the APP will display manual addition and automatic discovery.

Automatic discovery: When the corresponding authority is turned on, the device can be automatically discovered, and the device needs to be in the network configuration state and turned on. Manually add: select the name corresponding to the product, WiFi+Bluetooth mode.

### Bluetooth configuration:

When confirming that the WiFi indicator of the device is flashing quickly, click OK, and then wait for the connection. (Recommended.) When "Successfully add 1 device" appears, it means the connection has been completed and your device will be listed in your APP list.

### Hotspot configuration network:

Click on the WiFi quick connection in the upper right corner to select the hotspot distribution network (compatibility mode), Confirm that the WiFi indicator of the device flashes slowly, click OK, and enter your home WiFi and WiFi password.

Next, click to connect to go to the WLAN setting interface of the phone, and then select the Wi-Fi network "SmartLife\_XXXX" to connect it.

Return to the "Smart Life" APP, the connection will start automatically. When appears "Add 1 device successfully", it means the connection is complete and Your device will be listed in your APP list. Now, you can control your smart device through the mobile APP anytime and anywhere (make sure your mobile phone and smart device are connected to the network, make sure your router name is changed to SmartLife\_XXXX)

## 07/ Maintenance

### Notice:

1. Unplug the unit and cool it down before maintenance or cleaning.
2. Do not immerse the unit into any liquid.
3. Do not use abrasive, corrosive or flammable cleansers (such as bleach or alcohol) to clean any part of the unit.
4. After cleaning the product, place it in a ventilated place to dry and avoid to dry it under sunshine directly.

### Notice:

1. Turn off the unit, unplug and cool it down.
2. Use a soft cloth with neutral cleanser to clean away any dust or debris from the surface of the unit and air inlet/outlet.

**Notice:** Please don't drop any water into the machine when clean the air outlet.