

NOTES:

- 1 INSTALL IN ACCORDANCE WITH SENSATA FITMENT GUIDELINES
- 2 OPERATING TEMPERATURE RANGE -40°C TO +85°C
- 3 OPERATING PRESSURE RANGE 0 Bar TO 13.915 Bar
- 4 STORAGE CONDITIONS:
 - a) TEMPERATURE: -10°C TO +55°C
 - b) RELATIVE HUMIDITY: 85% MAX
- 5 INGRESS PROTECTION RATING: IP67, IP6K9K
- 6 OUTPUT ACCURACY:
 - a) TEMPERATURE ±3°C
 - b) PRESSURE ±220mBar
- 7 BATTERY LIFE 7 YEARS

REV	REVISION DESCRIPTION	BY	ECO	DATE
01	INITIAL RELEASE	A.P.	DFCO08950	05/MAY/2022
02	UPDATE TABLE 1 WITH ANTRIM/MADE IN UK. SPECIFY MARKING FOR ITEMS F, H, K, L, P IN TABLE 3 AND MODEL VIEWS. REMOVE INSTALLATION TORQUE FROM VIEW AND TABLE 3.	A.P.	ECO-514856	01/SEP/2022
03	QR CODE DECREASED TO 7.5MM, TEXT AROUND QR CODE FLIPPED, UKCA AND CE RF APPROVALS ADDED, POSITION OF ANATEL AND IFT APPROVALS DEFINED BUT LEFT BLANK, LASER TEXT CALL-OUT NUMBERING CHANGED	T.W.	ECO-521798	19/10/2022

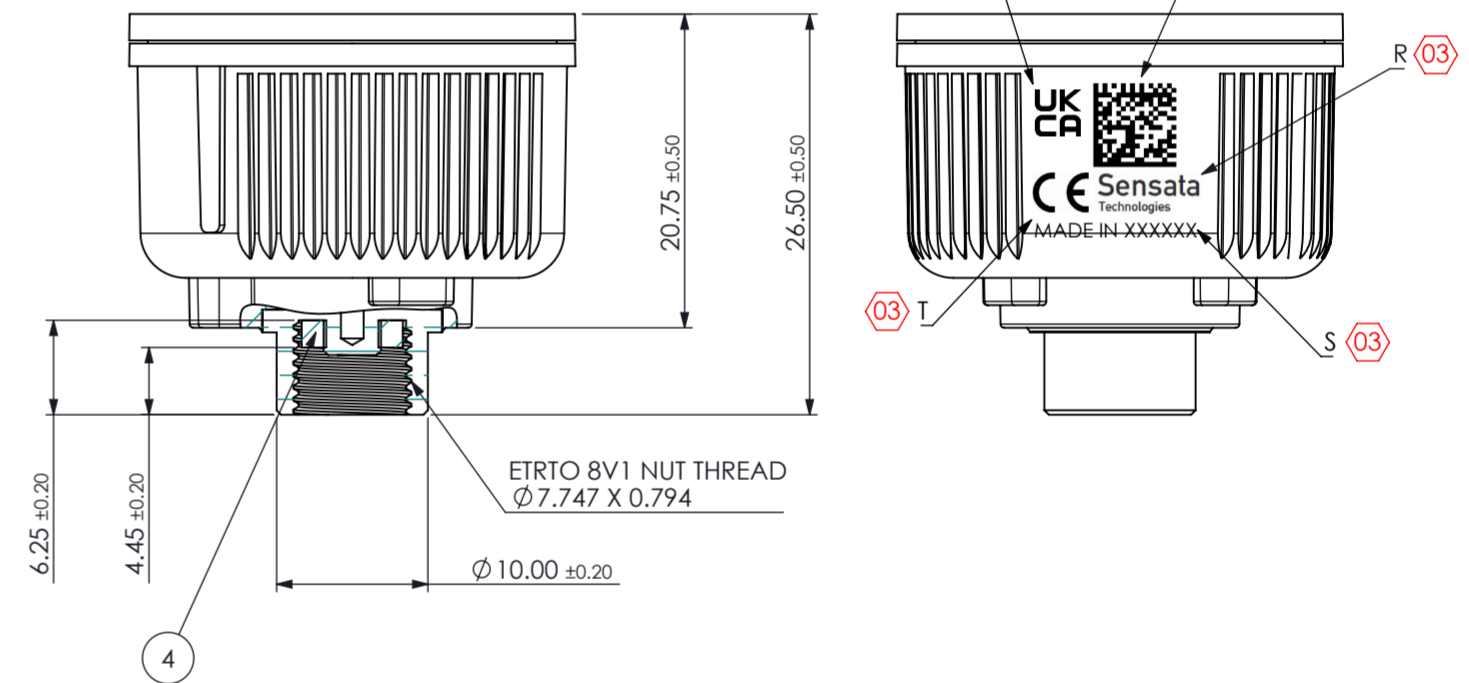
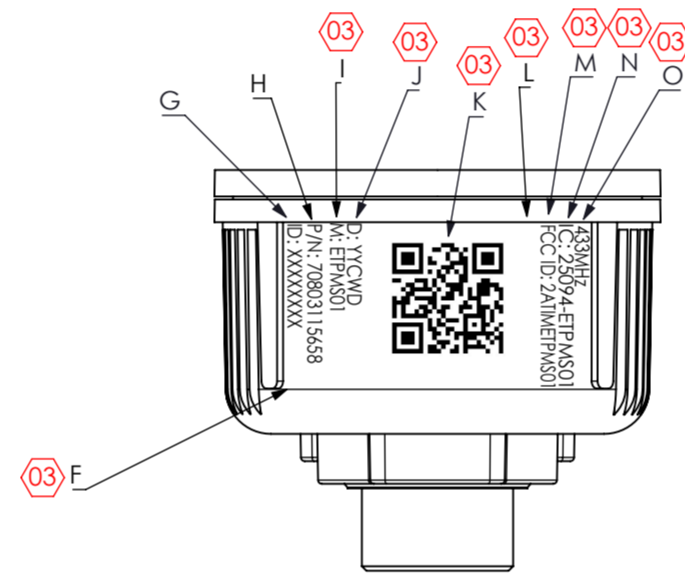
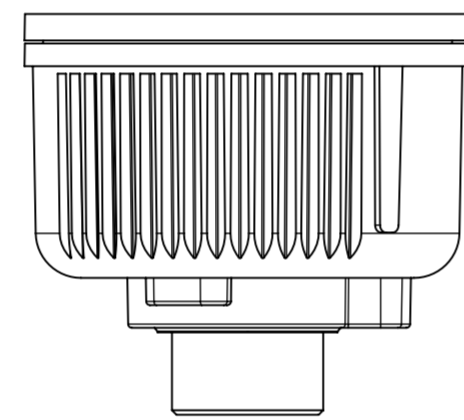
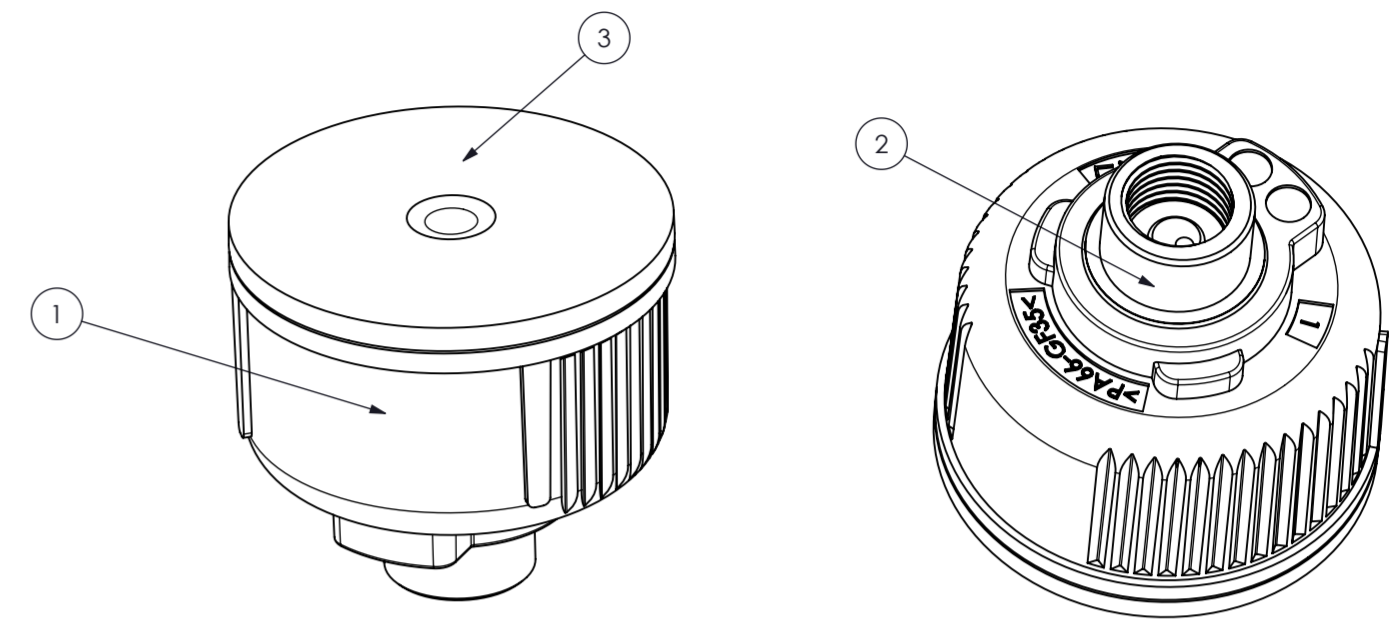
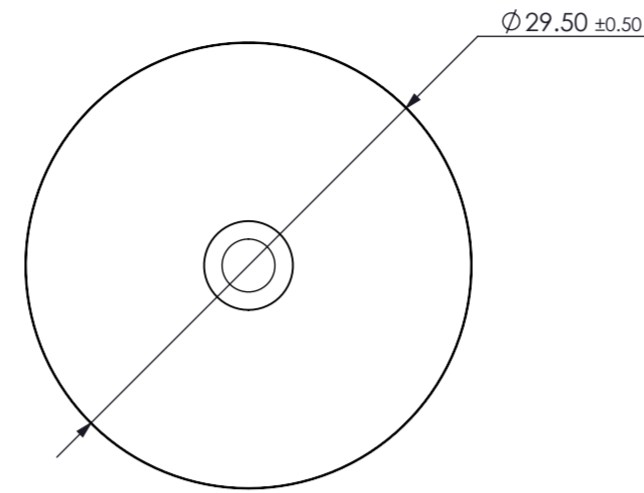

PRODUCTION LOCATION	COUNTRY OF MANUFACTURE
ANTRIM	MADE IN UK
AGUASCALIENTES	MADE IN MEXICO

ITEM	DESCRIPTION	MATERIAL	FINISH
1	ETPM ENCLOSURE	PA66-GF35	BLACK
2	ETPM 8V1 INSERT	BRASS	NATURAL
3	ETPM LID	PA66-GF35	BLACK
4	VALVE SEAL	N7534AA NBR	BLACK

ITEM	TYPE	DESCRIPTION	MARKING
A	MOULDED	DATE CLOCK	AS RECEIVED
B	MOULDED	REVISION CLOCK	AS RECEIVED
C	MOULDED	CAVITY NUMBER	1 - 4
D	MOULDED	MATERIAL CODE	>PA66-GF35<
E	MOULDED	BATTERY DISPOSAL SYMBOL	DISPOSAL LOGO
F	LASER	RF APPROVALS BRAZIL	DELIBERATELY LEFT BLANK UNTIL ANATEL NO. IS ISSUED
G	LASER	ASIC ID	ID: XXXXXXXX
H	LASER	ST PART NUMBER	P/N: 70803115658
I	LASER	MODEL No.	M: ETPMS01
J	LASER	DATE OF MANUFACTURE	D: YYCWD
K	LASER	QR CODE (7.5 X 7.5)	QR CODE
L	LASER	RF APPROVALS MEXICO	DELIBERATELY LEFT BLANK UNTIL IFT NO. IS ISSUED
M	LASER	RF APPROVALS USA	FCC ID: 2ATIMETPMS01
N	LASER	RF APPROVALS CANADA	IC:25094-ETPMS01
O	LASER	FREQUENCY	433MHz
P	LASER	RF APPROVALS UK	UKCA LOGO
Q	LASER	2D DATA MATRIX (5.6 X 5.6)	2D DATA MATRIX
R	LASER	MANUFACTURER	SENSATA LOGO
S	LASER	MANUFACTURING LOCATION	MADE IN XXXXXX
T	LASER	RF APPROVALS EUROPE	CE LOGO

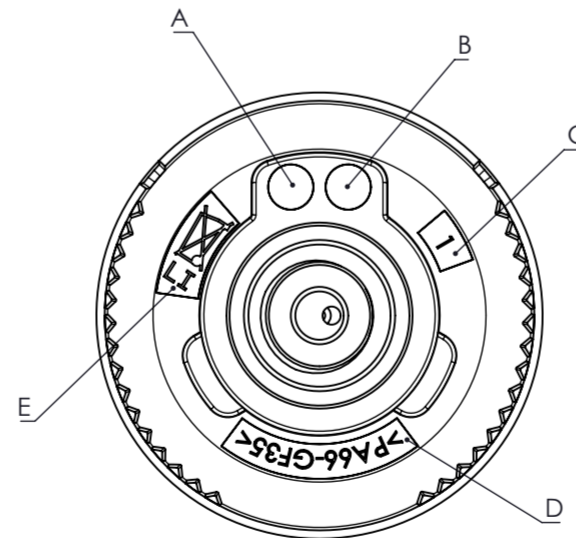

FOR REFERENCE ONLY. CHECK LATEST REVISION BEFORE USE. REFER TO PLM FOR CONTROLLED DATA, CHANGE HISTORY AND APPROVALS.		TECHNOLOGY PARK, ANTRIM, UK, BT41 1QS		
MATERIAL	SEE TABLE	PART NUMBER	70803115658	
MASS (g)	20.4	TITLE	ETPM SENSOR 8V1 INSERT CUSTOMER OFFER DRAWING	
PROJECT NO.	PRJ0014494	THIS DRAWING IS CONFIDENTIAL AND PROPRIETARY OF SCHRADER ELECTRONICS LIMITED. THE INFORMATION CONTAINED WITHIN IT MAY NOT BE USED, DISCLOSED OR REPRODUCED IN WHOLE OR PART, WITHOUT THE EXPRESSED WRITTEN CONSENT OF SCHRADER ELECTRONICS LIMITED. NO RIGHT IS GRANTED TO DISCLOSE OR USE ANY INFORMATION CONTAINED WITHIN THIS DRAWING. SCHRADER ELECTRONICS LIMITED IS PART OF THE SENSATA TECHNOLOGIES GROUP.		
REVISION SYMBOL		INTERPRET DRAWING PER ASME Y14.5-2009		
UNLESS OTHERWISE SPECIFIED DIMENSIONS ARE IN MILLIMETERS		DO NOT SCALE DRAWING	THIRD ANGLE PROJECTION	
SIZE	A2	DRAWING NO.	00018358	DRAWING REV. 03
SCALE 2:1		SOLIDWORKS 2020		SHEET 1 OF 1