

PfY

PHOTO FILM FOR YOU



FOCUS

2.4GHZ WIRELESS FOCUS CONTROL SYSTEM

QuickGuide

1 Description

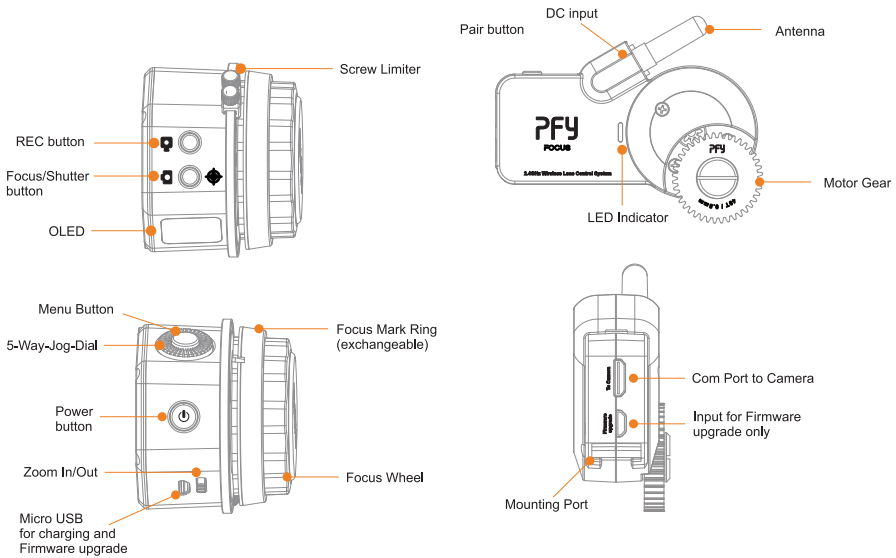

2 Quick Installation

The PFY Focus can be easily mounted with the equipped quick release system. You can mount it on the L-Arm of the Gimbal or with the Hotshoe on top of the camera. If you do not use a cine lens you can attach the universal gear ring to your lens. Ensure gear ring is tight fixed on the lens and the fixation lock is placed on an area where you will not need for the focus adjustment.

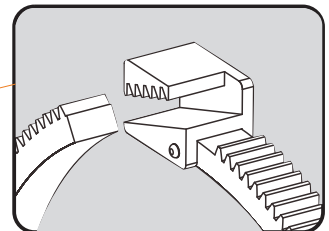

If you do not use a cine lens, then use the universal gear ring mount it on the lens and ensure it is tightened up.

3 Function of Menu Button and Jog-Dial

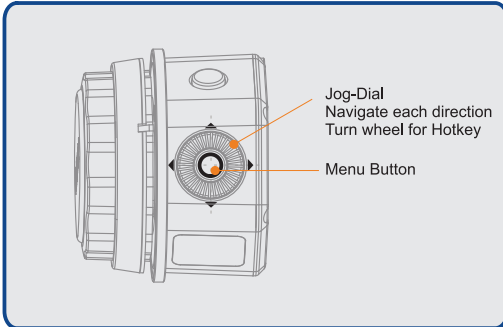

Menu button: Press the Menu button to enter the Settings Menu. Press and hold the button for 2-3 sec to lock system.

Jog-Dial: The Jog-Dial has multi-functional features. You can press on each arrow direction or turn the wheel.

- If you press and hold the arrow button you will select/de-select the Focus points A/B/C/D
- Navigate in Setup Menu by pressing arrow buttons up /down
- The wheel can be used as a hot key function. You can set several functions which you often use to the wheel and do not need to change it in the menu again.

4 OLED Overview

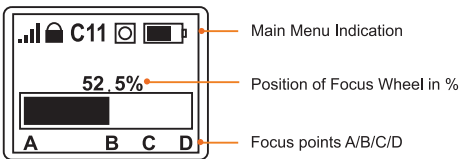

Icon	Function	Explanation
Signal strength icon	Signal Indicator	Signal strength indication
X icon	Not connecting to Motor	N/A
Lock icon	Jog-Dial is locked	No function if locked.
C11 icon	Motor channel	Active channel
Syncing icon	Syncing Indicator	Connection established
Battery icon	Power Indicator	Battery capacity

5 Connectivity / Charging / Firmware Upgrade

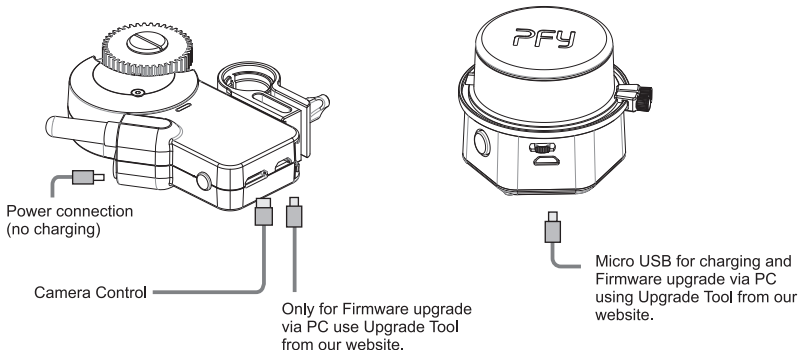

6 Camera connection cable

For Sony: Video REC / Focus / Shutter / Zoom In/Out support with motorized Lenses only

For Panasonic: Video REC / Focus / Shutter function.

For Canon: Video / Focus / Shutter function.

7 OLED Setup Description

Navigate with joystick through the OLED Setup Menu. Enter with OK and go back with RETURN button.

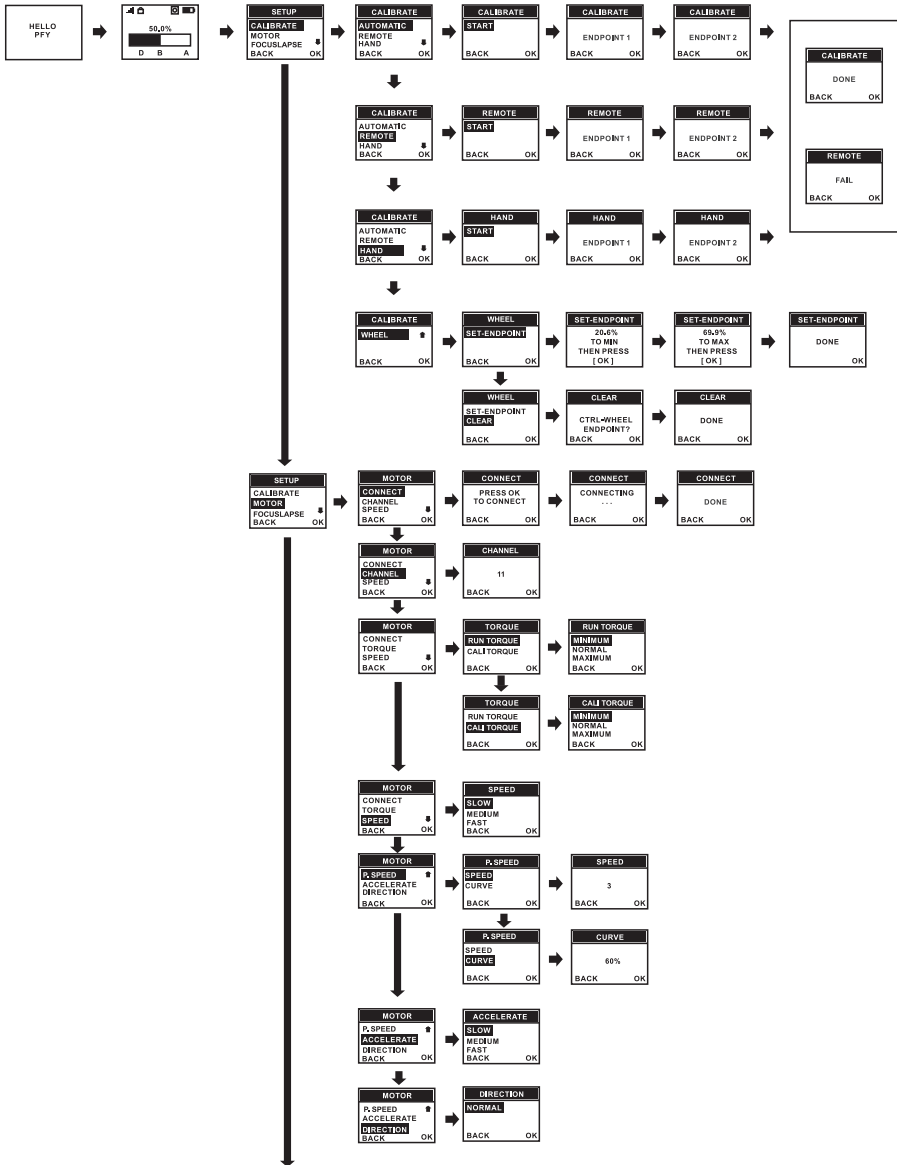

8 OLED Setup Description Part 2

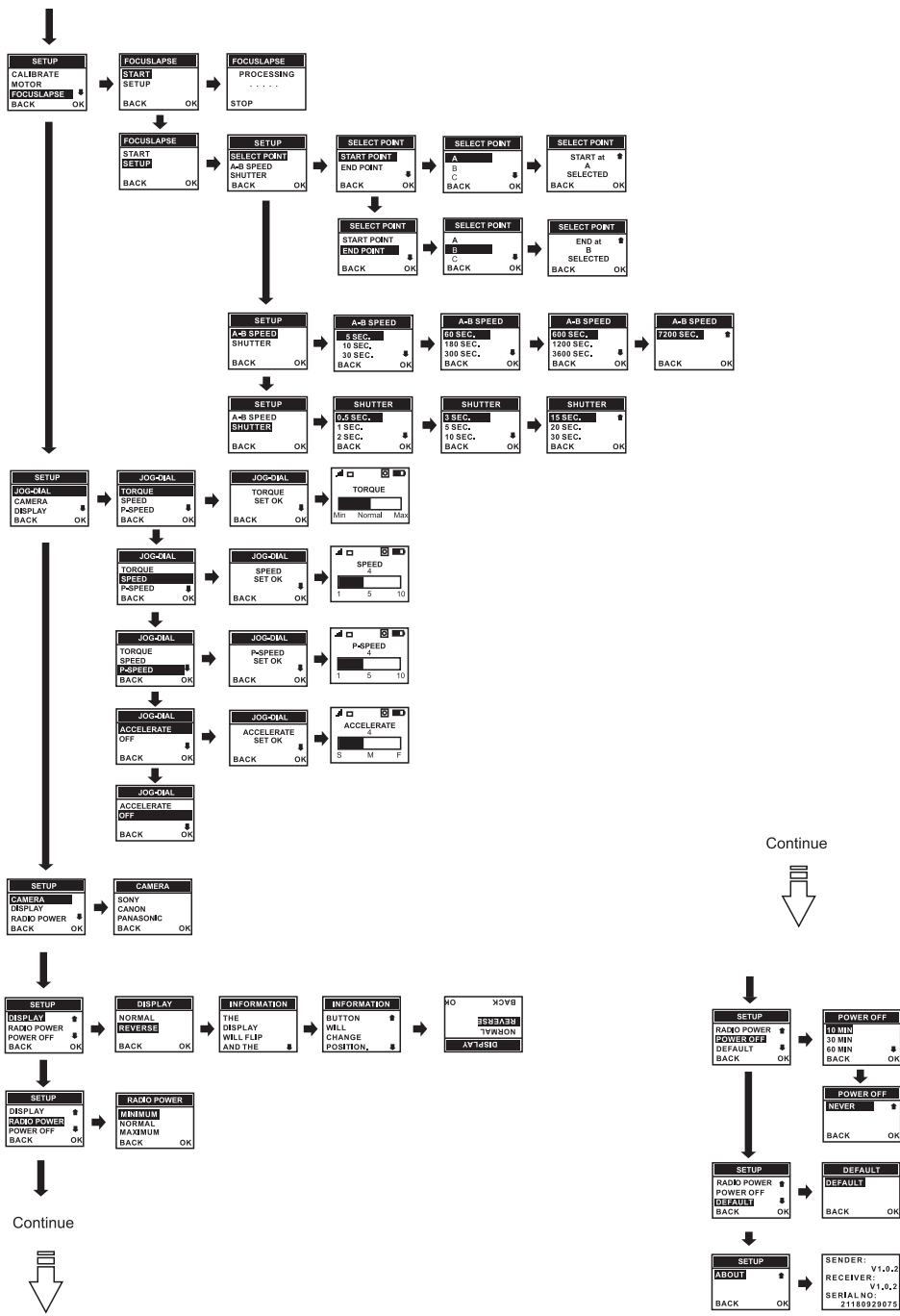

9 OLED Setup Description Part 3



Video tutorials



Software / Driver

10 Technical Details

Hand Wheel Controller

Dimensions:	55x55x45mm
Weight:	80gram
Operating Frequency:	2.4Ghz
Max Transmission:	50m
Emission Power:	30mW~200mW
Current:	0.08A
Voltage:	3.7V~5V
Battery:	3.7V 800mAh Li-Po
Operating Temperature:	0 - 40°C

Motor

Dimensions:	95x75x28mm
Weight:	110gram
Operating Frequency:	2.4Ghz
Max Transmission:	50m
Emission Power:	30mW~200mW
Current:	Idle Current 0.05A/14.8V Nominal Current 0.5A/14.8V Max. Current 2A/14.8V
Voltage:	7V~16V
Gear:	0.8 Teeth:40
Operating Temperature:	0 - 40°C

11 Safe Disposal



Endangering health and environment by accumulators and batteries!
 In the European Economic Area this symbol indicates that consumers are required by law to return all waste batteries to either a store or another collection point for waste batteries. Waste batteries should never be placed in the household garbage, or anywhere in the environment. This is indicated by the symbol comprising a crossed-out wheeled bin that appears on batteries and/or battery packaging. In the interest of facilitating waste battery collection, manufacturers of portable batteries have established a joint collection. Retailers are required by law to take back waste batteries free of charge. In Germany, collection boxes in which consumers can deposit waste portable batteries are available at all stores that sell portable batteries, e.g. supermarket, discounter, drugstore or construction market. Some municipalities take waste batteries back, e.g. via vehicles that make regular collections of hazardous waste, or recycling centres. The legal limit for mercury within button cells is 2 percent (20 grams per kilogram) of mercury, while the limit for all other types of batteries is 0.005 percent (5 milligrams per kilogram). Portable-battery cadmium content is limited to 0.002 percent (20 milligrams per kilogram). Batteries used for cordless power tools, emergency or alarm systems emergency lighting, and medical devices are exempt from this limit. For batteries whose mercury, cadmium or lead content exceeds specific limit values, this fact must be indicated on the battery or packaging, below the symbol of the crossed-out wheeled bin. Please take care e.g. by taping the individual connection poles that the batteries to be disposed of are unloaded and the connection poles are protected from short circuits.



Potential negative consequences to the environment and human health! In the European Economic Area this symbol indicates that this product shall not be treated as household waste. Instead it has to be taken to an applicable collection point for the recycling of electrical and electronic equipment. By ensuring this product is disposed correctly, you will help prevent potential negative consequences to the environment and human health, which could otherwise be caused by inappropriate waste handling of this product



In the European Economic Area this symbol indicates that you should dispose the packing materials environmentally sensible according to the local regulations.

12 Safety Guidelines

To avoid fire, serious injury, and property damage, observe the following safety guideline when using, charging or storing your batteries.

Important Safety Instructions (**READ BEFORE USE**):

1. DO NOT allow the batteries to come into contact with any kind of liquid. DO NOT leave batteries out in the rain or near a source of moisture. DO NOT drop the battery into water. If the inside of the battery comes into contact with water, chemical decomposition may occur, potentially resulting in the battery catching on fire, and may even lead to an explosion.
2. If the battery falls into water by accident, put it in safe and open area immediately, maintain a safe distance from the battery until it is completely dry. Never use the battery again and dispose the battery properly.
3. Extinguish fire on any battery by using CO₂, sand, fire blanket or a dry powder fire extinguisher.
4. Never use non-PILOTFLY batteries. Go to www.pilotfly.de or www.pfy-tech.com to purchase new batteries. PILOTFLY (PFY) takes no responsibility and is not liable for any damage caused by using non-PILOTFLY batteries.
5. Never use over charged swollen, leaky or damaged battery. If your batteries are abnormal, contact PILOTFLY (PFY) or a PILOTFLY (PFY) authorized dealer for further assistance.
6. The battery should be used in temperatures from -10°C to 50°C. Use of the battery in environments above 50°C can lead to a fire or explosion. Use of battery below -10°C can cause low performance or damage.
7. DO NOT use the battery in strong electrostatic or electromagnetic environments. Otherwise, the battery control board may malfunction.
8. Never disassemble or pierce the battery in any way or the battery may leak, catch fire, or explode.
9. DO NOT drop or strike batteries. DO NOT place heavy objects on the batteries or charger.
10. Electrolytes in the battery are highly corrosive. If any electrolytes make contact with your skin of eyes, immediately wash the affected area with fresh running water for at least 15 minutes, and then see a doctor immediately.
11. DO NOT use the battery if it received impact from a fall or other accidents.
12. DO NOT heat batteries. DO NOT put batteries in a microwave oven or in a pressurized container.
13. DO NOT place loose battery cells on any conductive surface, such as a metal table.
14. DO NOT manually short-circuit the batteries.
15. Clean battery terminals with a clean, dry cloth.

Battery charging:

1. DO NOT attach the batteries to wall outlets directly, and always use a PILOTFLY (PFY) approved adapter. PILOTFLY (PFY) takes no responsibility if the battery is charged using a non-PILOTFLY (PFY) charger.
2. Never leave the battery unattended during charging. DO NOT charge the battery near flammable materials or on flammable surfaces such as carpet or wood.
3. Charging the battery outside of the temperature range of 15°C to 40°C may lead to leakage, overheating, or battery damage.
4. Disconnect the charger when not in use. Examine the charger regularly for damage to the cord, plug, enclosure, or other parts. DO NOT clean the charger with denatured alcohol or other flammable solvents. Never use a damaged charger.
5. Accumulators getting hot when charging. Never touch hot accumulators! Otherwise there is the danger of burnings!

Battery storage:

1. Keep batteries out of the reach of children and pets.
2. DO NOT leave the battery near heat sources such as a furnace or heater. DO NOT leave the batteries inside of a vehicle on hot days. The ideal storage temperature is +20°C to 25°C.
3. Always keep the battery in a dry place.
4. DO NOT store the battery full discharged for long periods of times, otherwise it will over discharge and lead to permanent damage.
5. DO NOT store the battery full charged for long periods of times, keep the battery voltage on 15~15.4V as well.

Product name: _____

Model No.: _____

Serialnumber: _____

Purchase date: Day Month Year

Name: _____

Tel. No.: _____

E-mail: _____

Address: _____

Dealer Stamp

(This warranty is only valid with original Dealer's stamp,
signature and copy of the invoice)

Limited Warranty

1. The one year warranty is effective from the purchase date of the New PILOTFLY (PFY) Product and the start of the warranty period is determined by the original date of purchase.
2. Warranty claims must be accompanied by the original receipt or a copy thereof, showing the purchase date or device model and the warranty period will not extended, if the device is repaired or replaced at an authorized customer service center.
3. Any damage or defects caused by incorrect use, disobey important notes in the user manual and defects caused by the use of non-original parts or accessories, are not covered by the limited warranty. The Warranty does not cover any damage caused by external influences such as lightning, water, fire or any transport damage.
4. All warranty claims lapse, if the device is repaired, altered or rebuilt by the purchaser and if the device serial number ID altered, removed or illegible rendered.

Customer Support

1. Please contact us prior by email or phone before returning any equipment/device to our PILOTFLY (PFY) Customer Service for in-/out- warranty repair.
2. Out of warranty repair is also possible. You may still send us the defective unit for repair. Please note that repair is not free of charge. Quotation for the repair can be requested by E-mail.

FCC Caution.

§ 15.19 Labelling requirements.

This device complies with part 15 of the FCC Rules. Operation is subject to the following two conditions: (1) This device may not cause harmful interference, and (2) this device must accept any interference received, including interference that may cause undesired operation.

§ 15.21 Changes or modification warning.

Any Changes or modifications not expressly approved by the party responsible for compliance could void the user's authority to operate the equipment.

§ 15.105 Information to the user.

Note: This equipment has been tested and found to comply with the limits for a Class B digital device, pursuant to part 15 of the FCC Rules. These limits are designed to provide reasonable protection against harmful interference in a residential installation. This equipment generates uses and can radiate radio frequency energy and, if not installed and used in accordance with the instructions, may cause harmful interference to radio communications.

However, there is no guarantee that interference will not occur in a particular installation. If this equipment does cause harmful interference to radio or television reception, which can be determined by turning the equipment off and on, the user is encouraged to try to correct the interference by one or more of the following measures:

- Reorient or relocate the receiving antenna.
- Increase the separation between the equipment and receiver.
- Connect the equipment into an outlet on a circuit different from that to which the receiver is connected.
- Consult the dealer or an experienced radio/TV technician for help.

PfY Brings images to fly



Pilotfly GmbH

Biberkopfstr. 9, 86163 Augsburg, Germany

Visit our websites:
www.pilotfly.de
www.pfy-tech.com
www.pfy-tech.de

Technical Support via E-mail:
support@pilotfly.de
support@pfy-tech.com

Follow us on Social Media:
<http://www.facebook.com/pilotfly>
<http://www.instagram.com/pilotflyde>