



MAVERICK

HANDHELD 3AXIS STABILIZER FOR MIRRORLESS AND DSLR CAMERAS

QuickGuide

PfY MAVERICK

HANDHELD 3AXIS STABILIZER FOR MIRRORLESS CAMERAS AND DSLR

1 Description

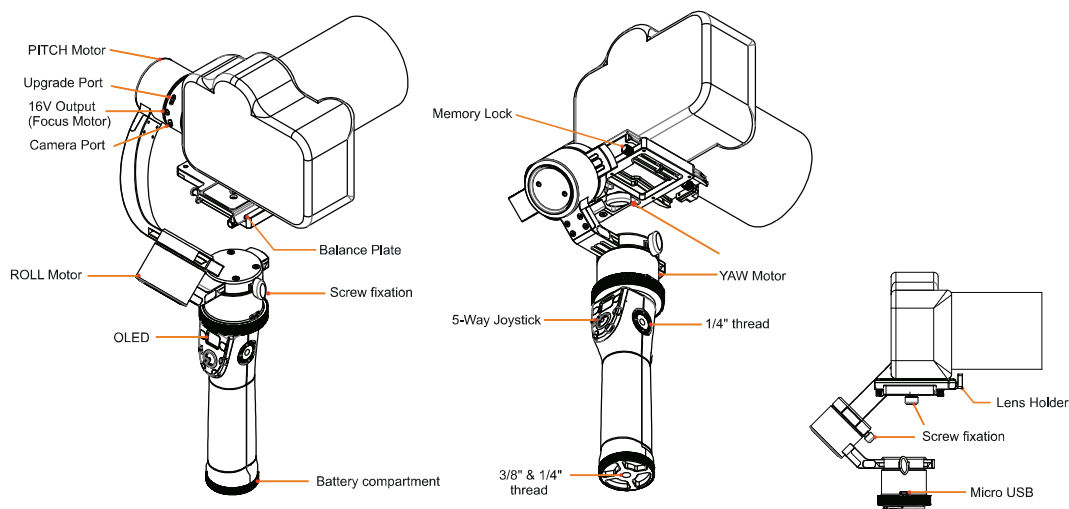

2 Quick Installation

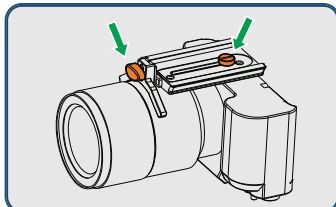

Install Quick Release Plate

Mount the adapter plate on the camera and ensure the plate is aligned & lens support is fixed properly. Slide the camera with the adapter plate into the quick release system and make sure that the safety lock is inside and holding the plate to prevent camera from falling down.

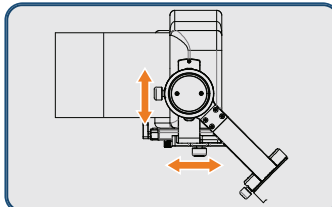

Mount Camera and Balance for Pitch and Roll

Make a precise front to back & left to right balance and tighten up the screws shown on the picture. If axes remain their position gimbal is keep balance.

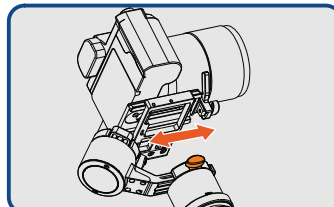

Balancing Yaw axis

Tilt the gimbal to 45 degrees to the right or to the left. Gimbal is balanced if YAW axis remains its position. If not, then balancing is necessary. Loosen slightly the screw on the YAW axis and shift the L-Arm to the position that YAW axis will not rotate anymore and keeps its position. Tighten gently the screw.

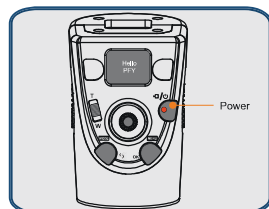

Press the Power button for 2sec to power on/off the System. Short press will start REC.

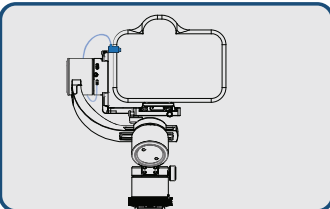

Connect control cable from gimbal to camera to establish the communication between camera and gimbal. Several cables are available for different cameras.



Please take special care for handle assembly. The handle consists of two knobs which prevents from interchanging and wrong assembly. Ensure that handle is powered off during the assembly / disassembly procedure.

QuickGuide

3 Function & Button Introduction

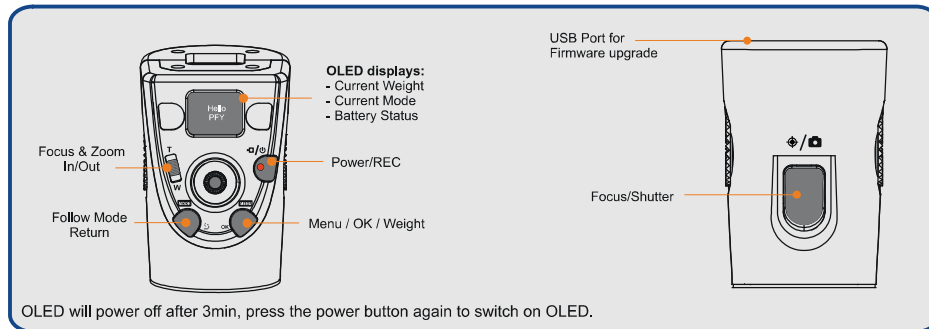

MENU Operating instruction of the "MENU" button.

Operation	Function	Weight	Explanation
Single tap	【Ultra Light Weight】	Around 500g	
Double tap	【Light Weight】	500g~1000g	
Triple tap	【Middle Weight】	1000g~1500g	
Quadruple tap	【Heavy Weight】	1500g~2000g	
Five times tap	【Ultra Heavy Weight】	more than 2kg	
Long press	【Enter Setup Menu】	Refer to page 3	

MODE Function of the "MODE" button.

Operation	Function	Explanation
Single tap	Mode PL 【Pitch Lock mode】	Gimbal is following your movements left / right but not tilting.
Double tap	Mode F 【Follow mode】	Gimbal is following your movements left / right & up / down.
Triple tap	Mode AL 【Lock mode】	Camera stays in it's current orientation. All motors locked.
Quadruple tap	Mode AF 【Follow Roll mode】	All three axes are following your movements.
Five times tap	Mode PF 【Follow Pitch mode】	Gimbal is following your movements up / down but no panning.
Six times tap	Mode DR 【Dutch Roll mode】	Hold gimbal parallel to the ground. Use Joystick to make your Roll.

Joystick Function of the "Joystick" button

Operation	Function	Explanation
Single click	【Home Move】	The gimbal moves to it's initial home position.
Double clicks	【Selfie Mode】	Gimbal rotates 180 degree for selfie recording.
Triple clicks	【Motors On / Off】	Toggle Motors On / Off to change lens or modify your setup.
Quadruple clicks	【Start Timelapse】	Setup and start Motion Time lapse function.
Five clicks	【Repeat Timelapse】	Repeats the last time-lapse motion sequence precisely.
Press & Hold >2sec	【Fast Follow Mode】	Temporarily follow fast the target.
9 short clicks then 10th long press	【Restore Settings】	Last used settings will be restored.

4 Camera connection cable

For Sony: Video REC / Focus / Shutter / Zoom In/Out support with motorized Lenses only

For Panasonic: Video REC / Focus / Shutter function.

For Canon: Video / Focus / Shutter function.

5 OLED Setup Description

Navigate with joystick through the OLED Setup Menu. Enter with OK and go back with RETURN button.

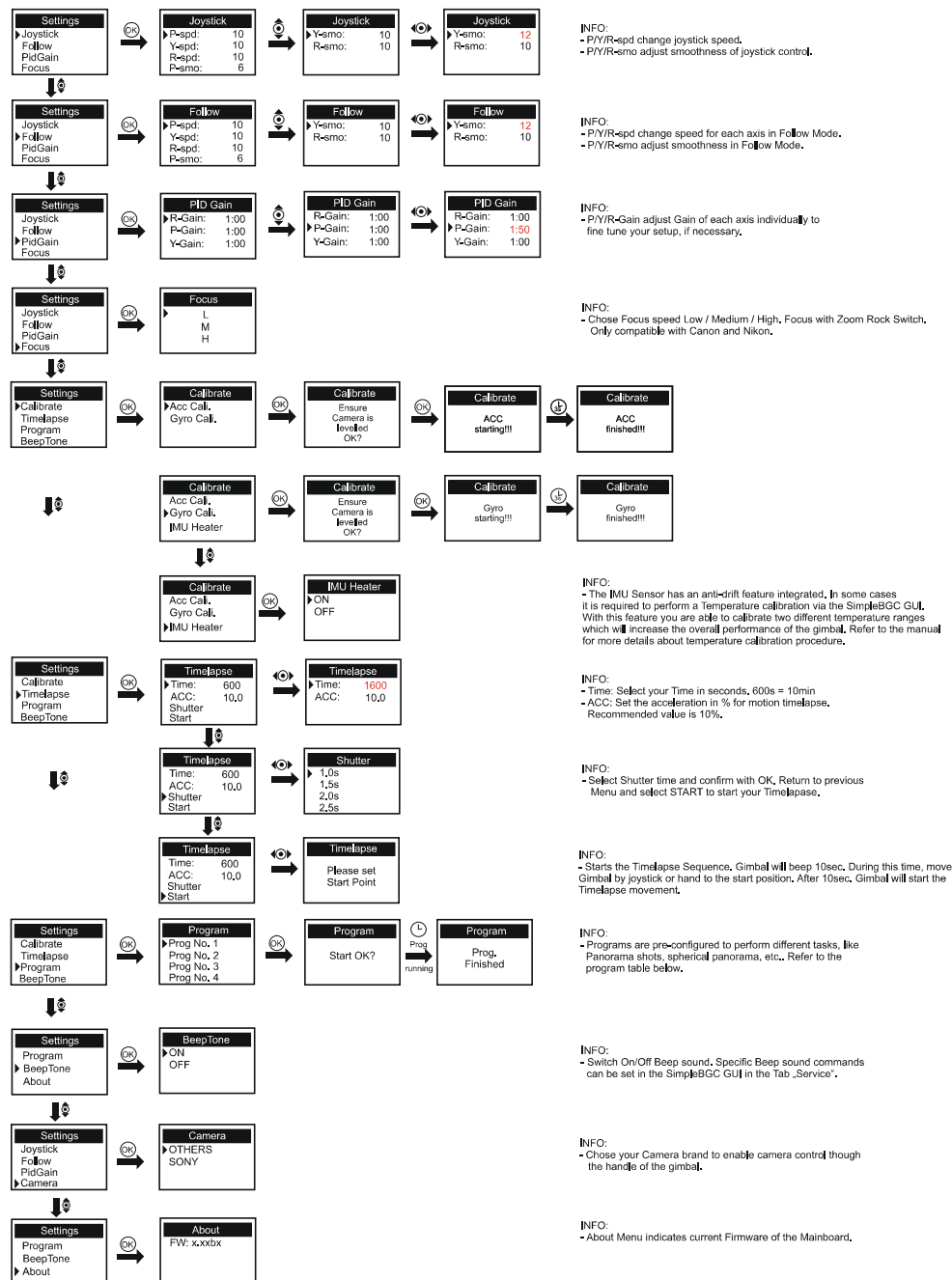

QuickGuide

6 Program Table for Panorama Feature

Program Table:

Prog No. 1: 3 x 3 Panorama

Prog No. 2: 360° Panorama with 20 degree steps.

Prog No. 3: 360° Panorama with 40 degree steps.

Prog No. 4: 360° Panorama with 60 degree steps.

Prog No. 5: Spherical Panorama

INFO:
- For the panorama creation you need to use a 3rd party software to stitch the photos.

7 Charger and Battery

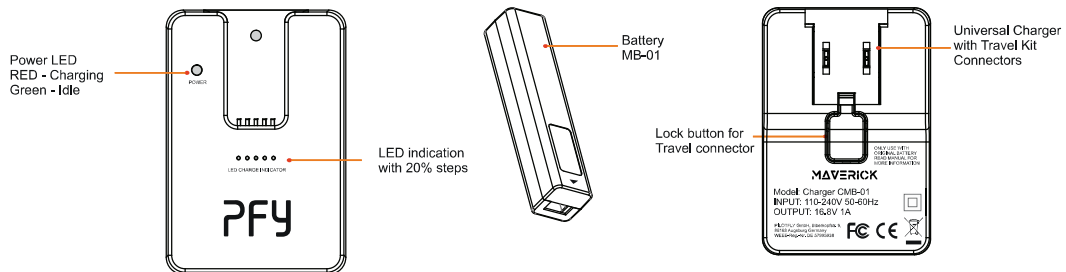

8 Upgrade Procedure of Hardware

The Maverick Gimbal is a very powerful product and we continuously develop it further and add e.g. new features to it. You will find on our website under Support the latest Firmware version and improvements for your product. You need to download the correct Firmware Upgrade Tool for your device from our website and follow the instruction.

The Maverick gimbal has two upgrade ports, one on the 1-Hand Handle and one on the Pitch Motor.

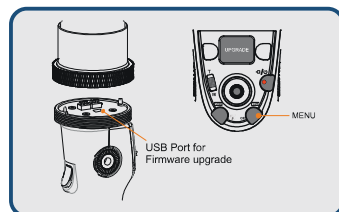

Connect Micro USB Cable to the Port and press the MENU Button same time. OLED will display UPGRADE. Open Firmware Upgrade Tool, select the FW file and Press UPGRADE.

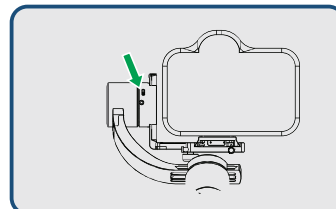

Connect Micro USB Cable to the Port. Open the Firmware Upgrade Tool, select the FW file and Press UPGRADE.

9 Connectivity to Software and Firmware upgrade of Software

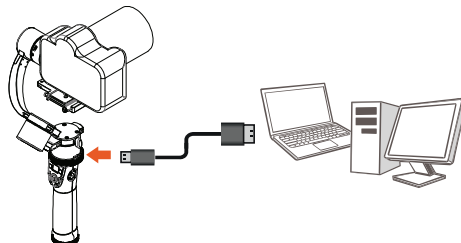

Connect the gimbal with PC or MAC via USB cable to adjust the settings or to upgrade the firmware.



Backup profiles to your computer before you change any settings.

10 Software / Driver / Tutorials



Video tutorials



Software / Driver

11 Specification

Size:	370 x 160 x 160 mm
Weight:	990 g (without battery)
Batteries:	14.8V 1600mAh Li-Po rechargeable battery Usage time ~12 h
Voltage range:	13~16.8V, Standard voltage 15.2V, 0.11A~0.8A
Movement range:	3 Axis Motor angle - 360° Precision / min ± 0.01° max ±0.04°
Operation System:	Windows, MAC OSX and LINUX
App Support:	under development

12 Safe Disposal



Endangering health and environment by accumulators and batteries!

In the European Economic Area this symbol indicates that consumers are required by law to return all waste batteries to either a store or another collection point for waste batteries. Waste batteries should never be placed in the household garbage, or anywhere in the environment. This is indicated by the symbol comprising a crossed-out wheeled bin that appears on batteries and/or battery packaging. In the interest of facilitating waste battery collection, manufacturers of portable batteries have established a joint collection. Retailers are required by law to take back waste batteries free of charge. In Germany, collection boxes in which consumers can deposit waste portable batteries are available at all stores that sell portable batteries, e.g. supermarket, discounter, drugstore or construction market. Some municipalities take waste batteries back, e.g. via vehicles that make regular collections of hazardous waste, or recycling centres. The legal limit for mercury within button cells is 2 percent (20 grams per kilogram) of mercury, while the limit for all other types of batteries is 0.005 percent (5 milligrams per kilogram). Portable-battery cadmium content is limited to 0.002 percent (20 milligrams per kilogram). Batteries used for cordless power tools, emergency or alarm systems emergency lighting, and medical devices are exempt from this limit. For batteries whose mercury, cadmium or lead content exceeds specific limit values, this fact must be indicated on the battery or packaging, below the symbol of the crossed-out wheeled bin. Please take care e. g. by taping the individual connection poles that the batteries to be disposed of are unloaded and the connection poles are protected from short circuits.



Potential negative consequences to the environment and human health! In the European Economic Area this symbol indicates that this product shall not be treated as household waste. Instead it has to be taken to an applicable collection point for the recycling of electrical and electronic equipment. By ensuring this product is disposed correctly, you will help prevent potential negative consequences to the environment and human health, which could otherwise be caused by inappropriate waste handling of this product



In the European Economic Area this symbol indicates that you should dispose the packing materials environmentally sensible according to the local regulations.

13 Safety Guidelines

To avoid fire, serious injury, and property damage, observe the following safety guideline when using, charging or storing your batteries.

Important Safety Instructions (**READ BEFORE USE**):

1. DO NOT allow the batteries to come into contact with any kind of liquid. DO NOT leave batteries out in the rain or near a source of moisture. DO NOT drop the battery into water. If the inside of the battery comes into contact with water, chemical decomposition may occur, potentially resulting in the battery catching on fire, and may even lead to an explosion.
2. If the battery falls into water by accident, put it in safe and open area immediately, maintain a safe distance from the battery until it is completely dry. Never use the battery again and dispose the battery properly.
3. Extinguish fire on any battery by using CO₂, sand, fire blanket or a dry powder fire extinguisher.
4. Never use non-PILOTFLY batteries. Go to www.pilotfly.de or www.pfy-tech.com to purchase new batteries. PILOTFLY (PFY) takes no responsibility and is not liable for any damage caused by using non-PILOTFLY batteries.
5. Never use over charged swollen, leaky or damaged battery. If your batteries are abnormal, contact PILOTFLY (PFY) or a PILOTFLY (PFY) authorized dealer for further assistance.
6. The battery should be used in temperatures from -10°C to 50°C. Use of the battery in environments above 50°C can lead to a fire or explosion. Use of battery below -10°C can cause low performance or damage.
7. DO NOT use the battery in strong electrostatic or electromagnetic environments. Otherwise, the battery control board may malfunction.
8. Never disassemble or pierce the battery in any way or the battery may leak, catch fire, or explode.
9. DO NOT drop or strike batteries. DO NOT place heavy objects on the batteries or charger.
10. Electrolytes in the battery are highly corrosive. If any electrolytes make contact with your skin or eyes, immediately wash the affected area with fresh running water for at least 15 minutes, and then see a doctor immediately.
11. DO NOT use the battery if it received impact from a fall or other accidents.
12. DO NOT heat batteries. DO NOT put batteries in a microwave oven or in a pressurized container.
13. DO NOT place loose battery cells on any conductive surface, such as a metal table.
14. DO NOT manually short-circuit the batteries.
15. Clean battery terminals with a clean, dry cloth.

Battery charging:

1. DO NOT attach the batteries to wall outlets directly, and always use a PILOTFLY (PFY) approved adapter. PILOTFLY (PFY) takes no responsibility if the battery is charged using a non-PILOTFLY (PFY) charger.
2. Never leave the battery unattended during charging. DO NOT charge the battery near flammable materials or on flammable surfaces such as carpet or wood.
3. Charging the battery outside of the temperature range of 15°C to 40°C may lead to leakage, overheating, or battery damage.
4. Disconnect the charger when not in use. Examine the charger regularly for damage to the cord, plug, enclosure, or other parts. DO NOT clean the charger with denatured alcohol or other flammable solvents. Never use a damaged charger.
5. Accumulators getting hot when charging. Never touch hot accumulators! Otherwise there is the danger of burnings!

Battery storage:

1. Keep batteries out of the reach of children and pets.
2. DO NOT leave the battery near heat sources such as a furnace or heater. DO NOT leave the batteries inside of a vehicle on hot days. The ideal storage temperature is +20°C to 25°C.
3. Always keep the battery in a dry place.
4. DO NOT store the battery full discharged for long periods of times, otherwise it will over discharge and lead to permanent damage.
5. DO NOT store the battery full charged for long periods of times, keep the battery voltage on 15~15.4V as well.

Product name: _____

Model No.: _____

Serialnumber: _____

Purchase date: Day Month Year

Name: _____

Tel. No.: _____

E-mail: _____

Address: _____

Dealer Stamp

(This warranty is only valid with original Dealers stamp,
signature and copy of the invoice)

Limited Warranty

1. The one year warranty is effective from the purchase date of the New PILOTFLY (PFY) Product and the start of the warranty period is determined by the original date of purchase.
2. Warranty claims must be accompanied by the original receipt or a copy thereof, showing the purchase date or device model and the warranty period will not extended, if the device is repaired or replaced at an authorized customer service center.
3. Any damage or defects caused by incorrect use, disobey important notes in the user manual and defects caused by the use of non-original parts or accessories, are not covered by the limited warranty. The Warranty does not cover any damage caused by external influences such as lightning, water, fire or any transport damage.
4. All warranty claims lapse, if the device is repaired, altered or rebuilt by the purchaser and if the device serial number ID altered, removed or illegible rendered.

Customer Support

1. Please contact us prior by email or phone before returning any equipment/device to our PILOTFLY (PFY) Customer Service for in-/out- warranty repair.
2. Out of warranty repair is also possible. You may still send us the defective unit for repair. Please note that repair is not free of charge. Quotation for the repair can be requested by E-mail.

FCC Caution.

§ 15.19 Labelling requirements.

This device complies with part 15 of the FCC Rules. Operation is subject to the following two conditions: (1) This device may not cause harmful interference, and (2) this device must accept any interference received, including interference that may cause undesired operation.

§ 15.21 Changes or modification warning.

Any Changes or modifications not expressly approved by the party responsible for compliance could void the user's authority to operate the equipment.

§ 15.105 Information to the user.

Note: This equipment has been tested and found to comply with the limits for a Class B digital device, pursuant to part 15 of the FCC Rules. These limits are designed to provide reasonable protection against harmful interference in a residential installation. This equipment generates uses and can radiate radio frequency energy and, if not installed and used in accordance with the instructions, may cause harmful interference to radio communications.

However, there is no guarantee that interference will not occur in a particular installation. If this equipment does cause harmful interference to radio or television reception, which can be determined by turning the equipment off and on, the user is encouraged to try to correct the interference by one or more of the following measures:

- Reorient or relocate the receiving antenna.
- Increase the separation between the equipment and receiver.
- Connect the equipment into an outlet on a circuit different from that to which the receiver is connected.
- Consult the dealer or an experienced radio/TV technician for help.

PFY Brings images to fly



Pilotfly GmbH

Biberkopfsstr. 9, 86163 Augsburg, Germany



Visit our websites:
www.pilotfly.de
www.pfy-tech.com
www.pfy-tech.de



Technical Support via E-mail:
support@pilotfly.de
support@pfy-tech.com



Follow us on Social Media:
<https://www.facebook.com/pilotfly>
<https://www.instagram.com/pilotflyde>